

Submit to Appropriate  
District Office  
State Lease - 6 copies  
Fee Lease - 5 copies

State of New Mexico  
Energy, Minerals and Natural Resources Department

Form C-101  
Revised 1-1-89

OIL CONSERVATION DIVISION

DISTRICT I  
P.O. Box 1980, Hobbs, NM 88240

P.O. Box 2088

Santa Fe, New Mexico 87504-2088

DISTRICT II  
P.O. Drawer DD, Artesia, NM 88210

DISTRICT III  
1000 Rio Brazos Rd., Aztec, NM 87410

API NO. (assigned by OCD on New Wells)

30-021-20234

5. Indicate Type of Lease

STATE ☒

FEE ☐

6. State Oil & Gas Lease No.

APPLICATION FOR PERMIT TO DRILL, DEEPEN, OR PLUG BACK

1a. Type of Work

DRILL ☒

RE-ENTER ☐

DEEPEN ☐

PLUG BACK ☐

b. Type of Well:

OIL  
WELL ☐

GAS  
WELL ☒

OTHER CO2

SINGLE  
ZONE ☒

MULTIPLE  
ZONE ☐

7. Lease Name or Unit Agreement Name

Bravo Dome Carbon Dioxide Gas Unit 2033

2. Name of Operator

Amoco Production Company

8. Well No.

2000-162K

3. Address of operator

P.O. Box 606 Clayton N. Mex. 88415

9. Pool name or Wildcat

Tubb

4. Well Location

Unit Letter G : 1980 Feet From The South Line and 1980 Feet From The West Line

Section 16 Township T 20 N Range R 33 E NMMPM Harding County

10. Proposed Depth

2508

11. Formation

Tubb

12. Rotary or C.T.

Rotary

13. Elevations (Show whether DF, RT, GR, etc.)

5029

14. Kind & Status Plug. Bond

Blanket On File

15. Drilling Contractor

N/A

16. Approx. Date Work well start

05-01-93

17.

PROPOSED CASING AND CEMENT PROGRAM

SIZE OF HOLE	SIZE OF CASING	WEIGHT PER FOOT	SETTING DEPTH	SACKS OF CEMENT	EST. TOP
12 1/4"	8 5/8" Steel	24#	700'	Circulate to Surface	Surface
7 7/8"	4 1/2" Fiberglass	2000# psi	2448'	Circulate to Surface	Surface

Propose to Drill & Equip well in the Tubb formation. To reach total depth, a 3 7/8" open hole will be air drilled approximately 60' below 4 1/2" casing.

Mud Program: 0-700' gel-Spud Mud  
700-2200' Starch/Gel  
2200-2325 Air

BOP Program Attached

APPROVAL 12-31-93  
UNIT'S DIVISION

IN ABOVE SPACE DESCRIBE PROPOSED PROGRAM: IF PROPOSAL IS TO DEEPEN OR PLUG BACK, GIVE DATA ON PRESENT PRODUCTIVE ZONE AND PROPOSED NEW PRODUCTIVE ZONE, GIVE BLOWOUT PREVENTER PROGRAM, IF ANY.

I hereby certify that the information above is true and complete to the best of my knowledge and belief.

SIGNATURE Joy Filkins TITLE Administrative Secretary DATE 3/18/93

TYPE OR PRINT NAME

Joy Filkins

TELEPHONE NO. (713) 556-3613

(This space for State Use)

APPROVED BY [Signature] TITLE DISTRICT SUPERVISOR DATE 3-23-93

CONDITIONS OF APPROVAL, IF ANY:

NEW MEXICO OIL CONSERVATION COMMISSION  
WELL LOCATION AND ACREAGE DEDICATION PLAT

Form C-102  
Supersedes C-128  
Effective 1-1-65

All distances must be from the outer boundaries of the Section.

Operator— AMOCO PRODUCTION COMPANY			Lease		Well No. 2033162K
Unit Letter K	Section 16	Township T 20 N	Range R 33 E	County HARDING	
Actual Footage Location of Well: 1980 feet from the SOUTH line and 1980 feet from the WEST line					
Ground Level Elev. 5029	Producing Formation		Pool	Dedicated Acreage: Acres	

1. Outline the acreage dedicated to the subject well by colored pencil or hatchure marks on the plat below.
2. If more than one lease is dedicated to the well, outline each and identify the ownership thereof (both as to working interest and royalty).
3. If more than one lease of different ownership is dedicated to the well, have the interests of all owners been consolidated by communitization, unitization, force-pooling, etc?

☐ Yes ☐ No If answer is "yes," type of consolidation \_\_\_\_\_

If answer is "no," list the owners and tract descriptions which have actually been consolidated. (Use reverse side of this form if necessary.) \_\_\_\_\_

No allowable will be assigned to the well until all interests have been consolidated (by communitization, unitization, forced-pooling, or otherwise) or until a non-standard unit, eliminating such interests, has been approved by the Commission.

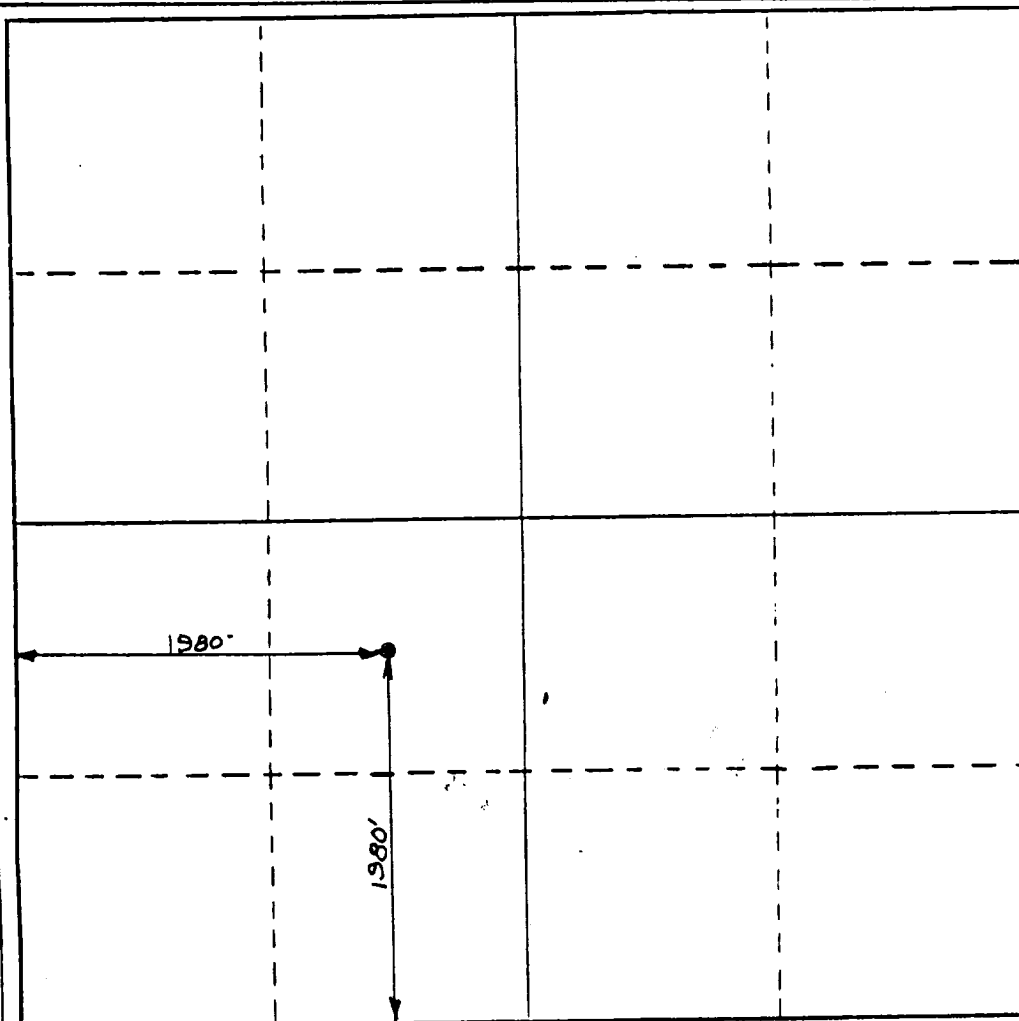

CERTIFICATION

I hereby certify that the information contained herein is true and complete to the best of my knowledge and belief.

*BE Pearson*  
Name  
*Field Foreman*  
Position  
*Amoco Prod. Co*  
Company  
*3/1/93*  
Date

I hereby certify that the well location shown on this plat was plotted from field notes of actual surveys made by me or under my supervision, and that the same is true and correct to the best of my knowledge and belief.

FEB 10, 1993

Date Surveyed

Registered Professional Engineer  
and/or Land Surveyor

*Jim Shields*  
Certificate No.  
M.M.L.S. NO. 5103