

Submit to Appropriate
District Office
State Lease - 6 copies
Fee Lease - 5 copies

State of New Mexico
Energy, Minerals and Natural Resources Department

Form C-101
Revised 1-1-89

OIL CONSERVATION DIVISION

DISTRICT I
P.O. Box 1980, Hobbs, NM 88240

P.O. Box 2088

Santa Fe, New Mexico 87504-2088

DISTRICT II
P.O. Drawer DD, Artesia, NM 88210

DISTRICT III
1000 Rio Brazos Rd., Aztec, NM 87410

API NO. (assigned by OCD on New Wells)

30-C21-20243

5. Indicate Type of Lease

STATE ☐

FEE ☒

6. State Oil & Gas Lease No.

APPLICATION FOR PERMIT TO DRILL, DEEPEN, OR PLUG BACK

1a. Type of Work

DRILL ☒

RE-ENTER ☐

DEEPEN ☐

PLUG BACK ☐

b. Type of Well:

OIL
WELL ☐

GAS
WELL ☒

OTHER CO2

SINGLE
ZONE ☒

MULTIPLE
ZONE ☐

7. Lease Name or Unit Agreement Name

Bravo Dome Carbon Dioxide Gas Unit 2033

2. Name of Operator

Amoco Production Company

8. Well No.

2000-211G

3. Address of operator

P.O. Box 606 Clayton N. Mex. 88415

9. Pool name or Wildcat

Tubb

4. Well Location

Unit Letter G : 1980 Feet From The North Line and 1980 Feet From The East Line

Section 21 Township T 20 N Range R 33 E NMPM Harding County

10. Proposed Depth

2522

11. Formation

Tubb

12. Rotary or C.T.

Rotary

13. Elevations (Show whether DF, RT, GR, etc.)

5022

14. Kind & Status Plug. Bond

Blanket On File

15. Drilling Contractor

N/A

16. Approx. Date Work well start

05-01-93

17.

PROPOSED CASING AND CEMENT PROGRAM

| SIZE OF HOLE | SIZE OF CASING | WEIGHT PER FOOT | SETTING DEPTH | SACKS OF CEMENT | EST. TOP |
|--------------|-------------------|-----------------|---------------|----------------------|----------|
| 12 1/4" | 8 5/8" Steel | 24# | 700' | Circulate to Surface | Surface |
| 7 7/8" | 4 1/2" Fiberglass | 2000# psi | 2452' | Circulate to Surface | Surface |
| | | | | | |

Propose to Drill & Equip well in the Tubb formation. To reach total depth, a 3 7/8" open hole will be air drilled approximately 70' below 4 1/2" casing.

Mud Program: 0-700' gel-Spud Mud
700-2200' Starch/Gel
2200-2325 Air

BOP Program Attached

IN ABOVE SPACE DESCRIBE PROPOSED PROGRAM: IF PROPOSAL IS TO DEEPEN OR PLUG BACK, GIVE DATA ON PRESENT PRODUCTIVE ZONE AND PROPOSED NEW PRODUCTIVE ZONE, GIVE BLOWOUT PREVENTER PROGRAM, IF ANY.

I hereby certify that the information above is true and complete to the best of my knowledge and belief.

SIGNATURE Joy Filkins TITLE Administrative Secretary DATE 3/18/93

TYPE OR PRINT NAME Joy Filkins TELEPHONE NO. (713) 556-3613

(This space for State Use)

APPROVED BY [Signature] TITLE DISTRICT SUPERVISOR DATE 3-23-93

CONDITIONS OF APPROVAL, IF ANY:

**NEW MEXICO OIL CONSERVATION COMMISSION
WELL LOCATION AND ACREAGE DEDICATION PLAT**

Form C-102
Supersedes C-128
Effective 1-4-85

All distances must be from the outer boundaries of the Section.

| | | | | | |
|--|----------------------|---------------------------|---|--------------------------|-----------------------------|
| Operator AMOCO PRODUCTION COMPANY | | | Lease | | Well No. 2033211G |
| Unit Letter G | Section 21 | Township T 20 N | Range R 33 E | County HARDING | |
| Actual Footage Location of Well: <div style="display: flex; justify-content: space-between;"> 1980 feet from the NORTH line and 1980 feet from the EAST line </div> | | | | | |
| Ground Level Elev. 5022 | Producing Formation | Pool | Dedicated Acreage: <div style="text-align: right;">Acres</div> | | |

1. Outline the acreage dedicated to the subject well by colored pencil or hatchure marks on the plat below.
2. If more than one lease is dedicated to the well, outline each and identify the ownership thereof (both as to working interest and royalty).
3. If more than one lease of different ownership is dedicated to the well, have the interests of all owners been consolidated by communitization, unitization, force-pooling, etc?

☐ Yes ☐ No If answer is "yes," type of consolidation _____

If answer is "no," list the owners and tract descriptions which have actually been consolidated. (Use reverse side of this form if necessary.) _____

No allowable will be assigned to the well until all interests have been consolidated (by communitization, unitization, forced-pooling, or otherwise) or until a non-standard unit, eliminating such interests, has been approved by the Commission.

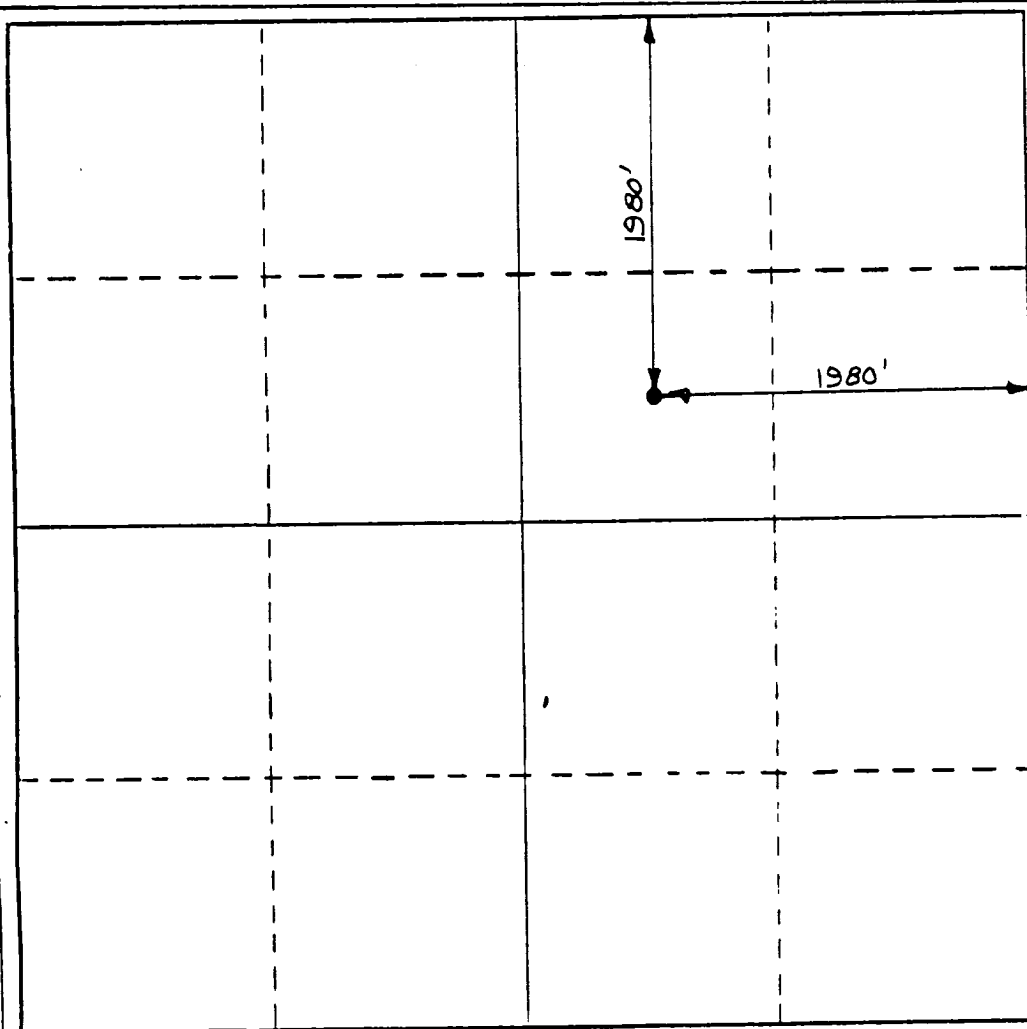

CERTIFICATION

I hereby certify that the information contained herein is true and complete to the best of my knowledge and belief.

Name *B. E. Pugh*

Position *Field Foreman*

Company *Amoco - Clayton*

Date *3/1/93*

I hereby certify that the well location shown on this plat was plotted from field notes of actual surveys made by me or under my supervision, and that the same is true and correct to the best of my knowledge and belief.

FEB. 9, 1993

Date Surveyed

Registered Professional Engineer and/or Land Surveyor

Jim Shields

Certificate No.
N.M.L.S. NO. 5103

0 330 660 990 1320 1650 1980 2310 2640 2970 3300 3630 3960 4290 4620 4950 5280 5610 5940 6270 6600

'90 MAR 26 AM 8 48

1. Blow-out preventers and master valve to be fluid operated and oil fittings must be in good condition, 3,000# W.P. (6,000 p.s.i. test), minimum.
2. Equipment through which bit must pass shall be as large as the inside diameter of the casing that is being drilled through.
3. Huddle above blow-out preventer shall be same size as casing being drilled through.
4. Kelly cock required, 3,000# W.P. (6,000 p.s.i. test) minimum.
5. OMSCO or comparable safety valve must be available on rig floor at all times with proper connection or sub, 3,000# W.P. (6,000 p.s.i. test), minimum.
6. Blow-out preventers and master valve while drilling intermediate hole to 6000' may be 2,000# W.P. (4,000 p.s.i. test), minimum.
7. Choke assembly, beyond second valve from cross, may be positioned (Optional) outside of derrick foundation.
8. Spool or cross may be eliminated if connections are available in the lower part of the blow-out preventer body.
9. Plug valves - gate valves are optional. Valves shown as 2" are minimum size.
10. Casing head and casing head spool, including attached valves, to be furnished by Amoco.
11. Rams in preventers will be installed as follows:

| | |
|---|---|
| When drilling, use: | When running casing, use: |
| Top Preventer - Drill pipe rams | Top Preventer - Casing rams |
| Bottom Preventer - Blind rams or master valve | Bottom Preventer - Blind rams or master valve |

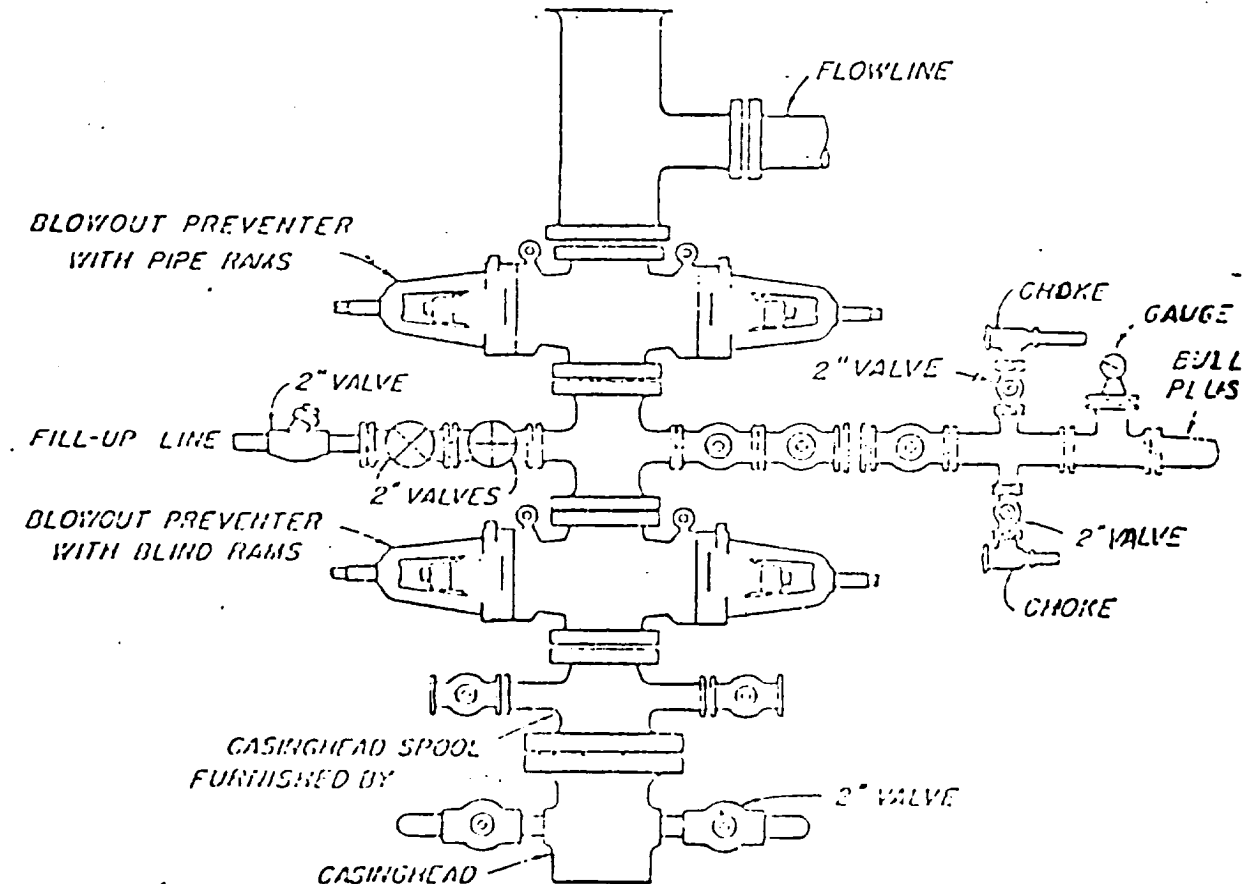

BLOWOUT PREVENTER HOOK-UP

Amoco Production Company

EXHIBIT D-I MODIFIED