

Submit to Appropriate  
District Office  
State Lease - 6 copies  
Fee Lease - 5 copies

State of New Mexico  
Energy, Minerals and Natural Resources Department

Form C-101  
Revised 1-1-89

OIL CONSERVATION DIVISION

DISTRICT I  
P.O. Box 1980, Hobbs, NM 88240

P.O. Box 2088

Santa Fe, New Mexico 87504-2088

DISTRICT II  
P.O. Drawer DD, Artesia, NM 88210

DISTRICT III  
1000 Rio Brazos Rd., Aztec, NM 87410

API NO. (assigned by OCD on New Wells)

30-021-20257

5. Indicate Type of Lease

STATE ☐

FEE ☒

6. State Oil & Gas Lease No.

APPLICATION FOR PERMIT TO DRILL, DEEPEN, OR PLUG BACK

1a. Type of Work

DRILL ☒

RE-ENTER ☐

DEEPEN ☐

PLUG BACK ☐

b. Type of Well:

OIL  
WELL ☐

GAS  
WELL ☒

OTHER CO2

SINGLE  
ZONE ☒

MULTIPLE  
ZONE ☐

7. Lease Name or Unit Agreement Name

Bravo Dome Carbon Dioxide Gas Unit - 2133

2. Name of Operator

Amoco Production Company

8. Well No.

051G

3. Address of operator

P.O. Box 606 Clayton N. Mex. 88415

9. Pool name or Wildcat

Tubb

4. Well Location

Unit Letter G : 1993 Feet From The East Line and 2024 Feet From The North Line

Section 5 Township T 21N Range R 33 E NMPM Harding County

10. Proposed Depth

2521

11. Formation

Tubb

12. Rotary or C.T.

Rotary

13. Elevations (Show whether DF, RT, GR, etc.)

4986

14. Kind & Status Plug. Bond

Blanket On File

15. Drilling Contractor

N/A

16. Approx. Date Work well start

07-15-93

17.

PROPOSED CASING AND CEMENT PROGRAM

SIZE OF HOLE	SIZE OF CASING	WEIGHT PER FOOT	SETTING DEPTH	SACKS OF CEMENT	EST. TOP
12 1/4"	8 5/8" Steel	24#	700'	Circulate to Surface	Surface
7 7/8"	4 1/2" Fiberglass	2000# psi	2361'	Circulate to Surface	Surface

Propose to Drill & Equip well in the Tubb formation. To reach total depth, a 3 7/8" open hole will be air drilled approximately 160' below 4 1/2" casing.

Mud Program: 0-700' gel-Spud Mud  
700-2200' Starch/Gel  
2200-2325 Air

BOP Program Attached

APPROVAL VALID FOR \_\_\_\_\_ DAYS  
PERMIT EXPIRES 12-31-93  
UNLESS DRILLING UNDERWAY

IN ABOVE SPACE DESCRIBE PROPOSED PROGRAM: IF PROPOSAL IS TO DEEPEN OR PLUG BACK, GIVE DATA ON PRESENT PRODUCTIVE ZONE AND PROPOSED NEW PRODUCTIVE ZONE, GIVE BLOWOUT PREVENTER PROGRAM, IF ANY.

I hereby certify that the information above is true and complete to the best of my knowledge and belief.

SIGNATURE Joy Filkins TITLE Administrative Secretary DATE 5-6-93

TYPE OR PRINT NAME Joy Filkins TELEPHONE NO. (713) 556-3613

(This space for State Use)

APPROVED BY [Signature] TITLE DISTRICT SUPERVISOR DATE 5-13-93

CONDITIONS OF APPROVAL, IF ANY:

Submit to Appropriate  
District Office  
State - 4 copies  
Per Lease - 5 copies

State of New Mexico  
Energy, Minerals and Natural Resources Department

Form C-123  
Revised 1-1-89

# OIL CONSERVATION DIVISION

DISTRICT I  
P.O. Box 1980, Hobbs, NM 88240

P.O. Box 2088  
Santa Fe, New Mexico 87504-2088

DISTRICT II  
P.O. Drawer DD, Artesia, NM 88210

DISTRICT III  
1000 Rte. Bureau Rd., Anton, NM 87418

## WELL LOCATION AND ACREAGE DEDICATION PLAT

All distances must be from the outer boundaries of the Section.

Operator <b>AMOCO PRODUCTION COMPANY</b>			Lease <b>BRAVO DOME CARBON DIOXIDE GAS UNIT</b>		Well No. <b>1</b>
Unit Letter <b>G</b>	Section <b>5</b>	Township <b>21 NORTH</b>	Range <b>33 EAST</b>	County <b>HARDING</b>	
Actual Footage Location of Well <b>1993</b> feet from the <b>EAST</b> line and <b>2024</b> feet from the <b>NORTH</b> line					
Ground Level Elev. <b>4972.10'</b>	Producing Formation <b>TUBB</b>		Pool <b>BRAVO DOME CARBON DIOXIDE GAS</b>	Dedicated Acreage <b>640</b> Acres	

1. Outline the acreage dedicated to the subject well by colored pencil or hatchure marks on the plat below.
2. If more than one lease is dedicated to the well, outline each and identify the ownership thereof (both as to working interest and royalty).
3. If more than one lease of different ownership is dedicated to the well, have the interests of all owners been consolidated by communitization, unitization, forced-pooling, etc?

☐ Yes ☐ No If answer is "yes," type of consolidation \_\_\_\_\_

If answer is "no," list the owners and tract descriptions which have actually been consolidated. (Use reverse side of this form if necessary.) \_\_\_\_\_

No allowable will be assigned to the well until all interests have been consolidated (by communitization, unitization, forced-pooling, or otherwise) or until a non-standard unit, eliminating such interests, has been approved by the Division.

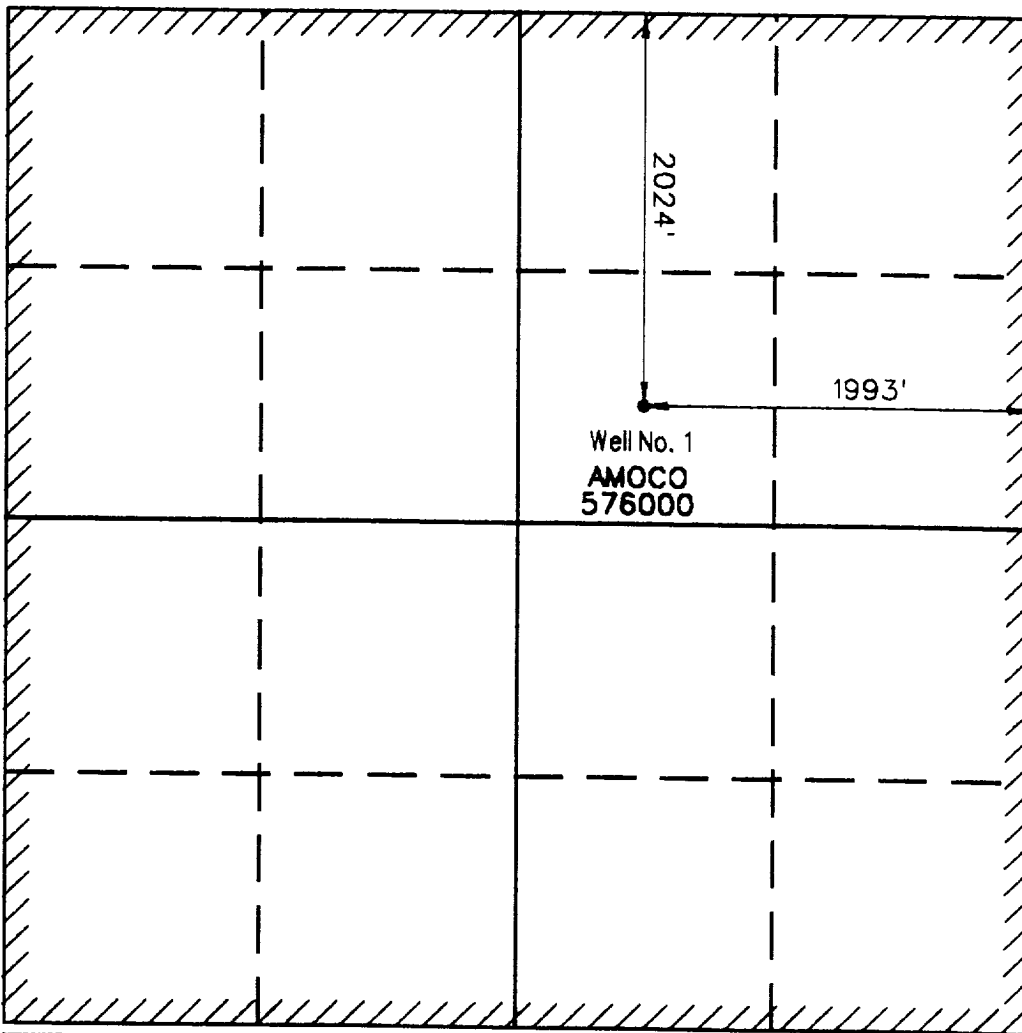

### OPERATOR CERTIFICATION

I hereby certify that the information contained herein is true and complete to the best of my knowledge and belief.

Signature  
*Jay Gillins*  
Printed Name  
**Jay Gillins**  
Position  
**Secretary**  
Company  
**Amoco Production**  
Date  
**5/6/93**

### SURVEYOR CERTIFICATION

I hereby certify that the well location shown on this plat was plotted from field notes of actual surveys made by me or under my supervision, and that the same is true and correct to the best of my knowledge and belief.

Date Surveyed  
**MARCH 15, 1993**  
Signature & Seal of  
Professional Surveyor  
*Larry A. Fisher*  
**LARRY A. FISHER**  
Certificate No.  
**11013**

# Attachment

1. Blow-out preventers and master valve to be fluid operated and oil fittings must be in good condition, 3,000# W.P. (6,000 p.s.i. test), minimum.
2. Equipment through which bit must pass shall be as large as the inside diameter of the casing that is being drilled through.
3. Nipple above blow-out preventer shall be same size as casing being drilled through.
4. Kelly cock required, 3,000# W.P. (6,000 p.s.i. test) minimum.
5. OHSO or comparable safety valve must be available on rig floor at all times with proper connection or sub, 3,000# W.P. (6,000 p.s.i. test), minimum.
6. Blow-out preventers and master valve while drilling intermediate hole to 6000' may be 2,000# W.P. (4,000 p.s.i. test), minimum.
7. Choke assembly, beyond second valve from cross, may be positioned (Optional) outside of derrick foundation.
8. Snool or cross may be eliminated if connections are available in the lower part of the blow-out preventer body.
9. Plug valves - gate valves are optional. Valves shown as 2" are minimum size.
10. Casing head and casing head spool, including attached valves, to be furnished by Amoco.
11. Rams in preventers will be installed as follows:  
 When drilling, use:  
 Top Preventer - Drill pipe rams  
 Bottom Preventer - Blind rams or master valve  
 When running casing, use:  
 Top Preventer - Casing rams  
 Bottom Preventer - Blind rams or master valve

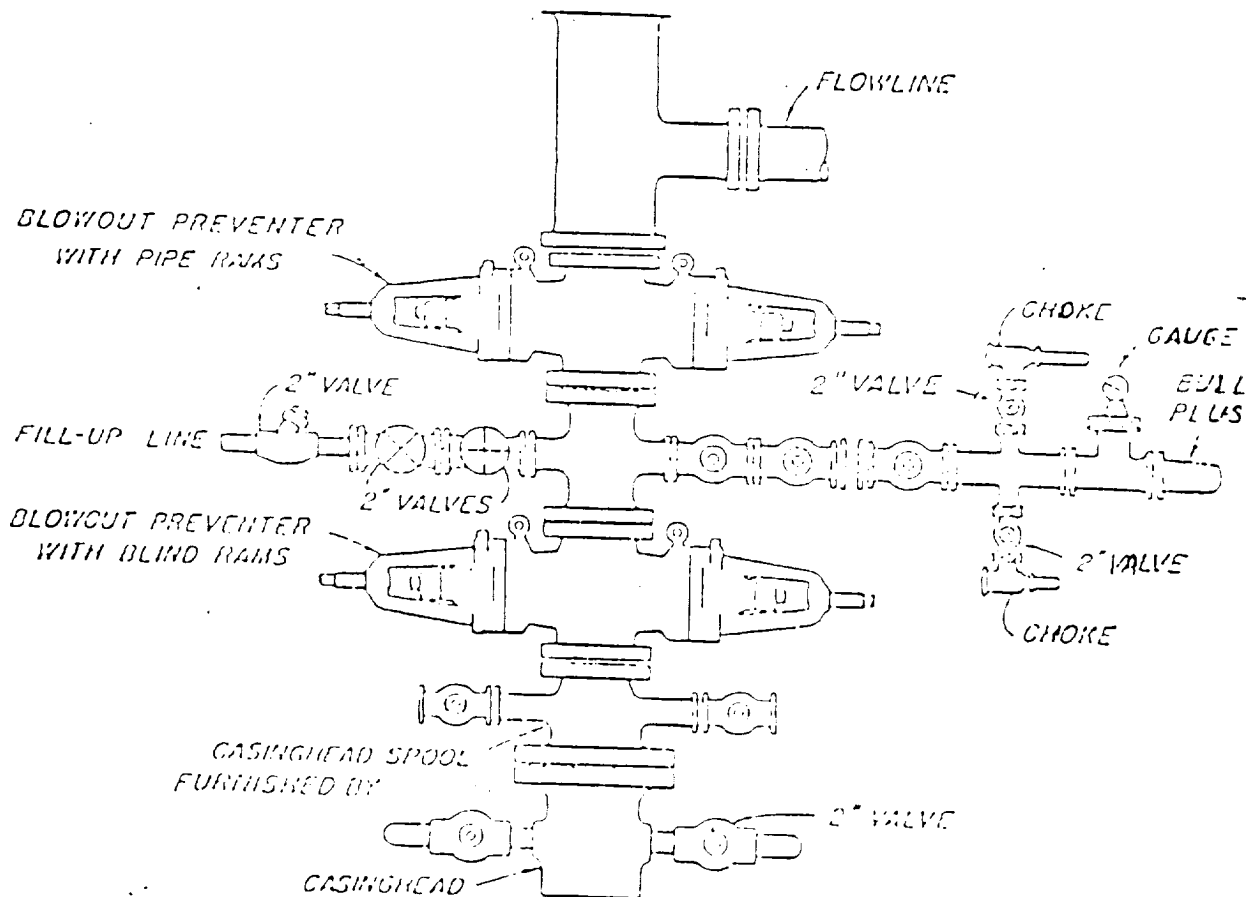

## BLOWOUT PREVENTER HOOK-UP

Amoco Production Company

EXHIBIT D-1 MODIFIED