

NO. OF COPIES RECEIVED	
DISTRIBUTION	
SANTA FE	
FILE	<input checked="" type="checkbox"/>
U.S.G.S.	
LAND OFFICE	
OPERATOR	

## NEW MEXICO OIL CONSERVATION COMMISSION

Form C-101  
Revised 1-1-65

5A. Indicate Type of Lease	
STATE <input type="checkbox"/>	FEE <input checked="" type="checkbox"/>
5. State Oil & Gas Lease No.	

## APPLICATION FOR PERMIT TO DRILL, DEEPEN, OR PLUG BACK

1a. Type of Work		7. Unit Agreement Name	
b. Type of Well DRILL <input checked="" type="checkbox"/> DEEPEN <input type="checkbox"/> PLUG BACK <input type="checkbox"/> OIL WELL <input type="checkbox"/> GAS WELL <input type="checkbox"/> OTHER CO <sub>2</sub> SINGLE ZONE <input checked="" type="checkbox"/> MULTIPLE ZONE <input type="checkbox"/>		8. Farm or Lease Name Clyde Berlier	
2. Name of Operator Mobil Oil Corporation		9. Well No. 1	
3. Address of Operator 3 Greenway Plaza East, Suite 800, Houston, Texas 77046		10. Field and Pool, or Wildcat Wildcat	
4. Location of Well UNIT LETTER M LOCATED 660 FEET FROM THE south LINE AND 330 FEET FROM THE west LINE OF SEC. 12 TWP. 19N RGE. 21E NMPM		12. County Mora	
19. Proposed Depth 3500		19A. Formation Sangre DeCristo	20. Rotary or C.T. Rotary
21. Elevations (Show whether DF, RT, etc.) Ground - 6504	21A. Kind & Status Plug. Bond On File	21B. Drilling Contractor Aztec Well Servicing Co.	22. Approx. Date Work will start As Soon As Possible

## PROPOSED CASING AND CEMENT PROGRAM

SIZE OF HOLE	SIZE OF CASING	WEIGHT PER FOOT	SETTING DEPTH	SACKS OF CEMENT	EST. TOP
11"	8-5/8	23# Misco	0-350	Circulate	Surface
7-7/8	4-1/2	9.5# K-55	0-3500	Circulate	Surface

## BLOWOUT PREVENTER PROGRAM:

<u>Casing String</u>	<u>Equip. Size &amp; API Series</u>	<u>No. &amp; Type</u>	<u>Test Pressure PSI</u>
Surface	8" 600	1MG & 1PR	3000

Permit Expires 9/17/77  
Unless Drilling Has Commenced

IN ABOVE SPACE DESCRIBE PROPOSED PROGRAM: IF PROPOSAL IS TO DEEPEN OR PLUG BACK, GIVE DATA ON PRESENT PRODUCTIVE ZONE AND PROPOSED NEW PRODUCTIVE ZONE. GIVE BLOWOUT PREVENTER PROGRAM, IF ANY.

I hereby certify that the information above is true and complete to the best of my knowledge and belief.

Signed A. D. Bond A. D. Bond Title Regulatory Engineering Coordinator Date June 10, 1977

(This space for State Use)

APPROVED BY Daniel S. Nutter TITLE CHIEF ENGINEER DATE 6/17/77

COLLECT AND SAVE SAMPLES FOR  
NEW MEXICO OIL CONSERVATION COMMISSION, ALBUQUERQUE

**NEW MEXICO OIL CONSERVATION COMMISSION**  
**WELL LOCATION AND ACREAGE DEDICATION PLAT**

Form C-102  
 Supersedes C-128  
 Effective 1-1-65

All distances must be from the outer boundaries of the Section.

Operator <b>Mobil Oil Corporation</b>			Lease <b>Clyde Berlier</b>		Well No. <b>1</b>
Unit Letter <b>M</b>	Section <b>12</b>	Township <b>19N</b>	Range <b>21E</b>	County <b>Mora</b>	
Actual Footage Location of Well: <b>660</b> feet from the <b>south</b> line and <b>330</b> feet from the <b>west</b> line					
Ground Level Elev. <b>6504</b>	Producing Formation <b>Sangre DeCristo</b>		Pool <b>Wildcat</b>		Dedicated Acreage: <b>40</b> Acres

1. Outline the acreage dedicated to the subject well by colored pencil or hachure marks on the plat below.
2. If more than one lease is dedicated to the well, outline each and identify the ownership thereof (both as to working interest and royalty).
3. If more than one lease of different ownership is dedicated to the well, have the interests of all owners been consolidated by communitization, unitization, force-pooling, etc?

☐ Yes   ☐ No   If answer is "yes," type of consolidation \_\_\_\_\_

If answer is "no," list the owners and tract descriptions which have actually been consolidated. (Use reverse side of this form if necessary.) \_\_\_\_\_

No allowable will be assigned to the well until all interests have been consolidated (by communitization, unitization, forced-pooling, or otherwise) or until a non-standard unit, eliminating such interests, has been approved by the Commission.

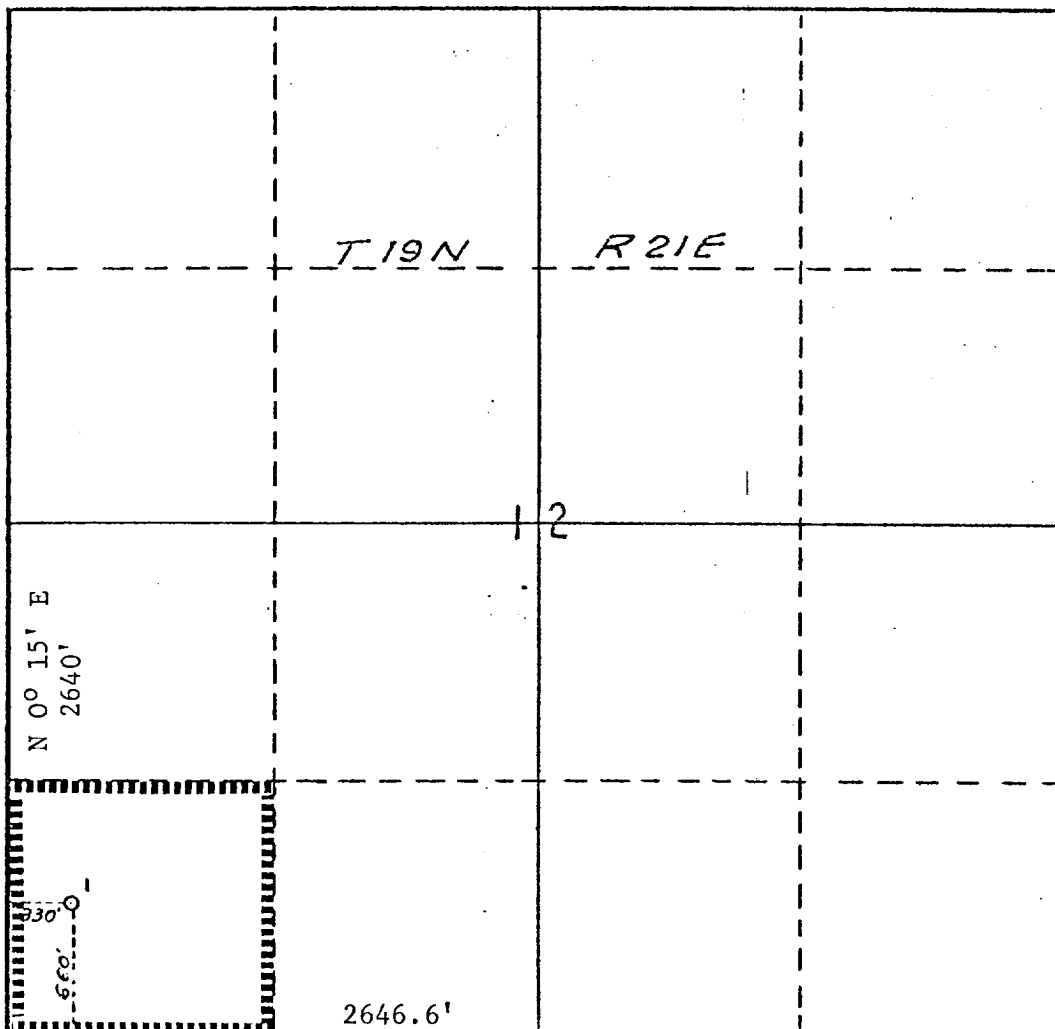

**CERTIFICATION**

*I hereby certify that the information contained herein is true and complete to the best of my knowledge and belief.*

*A. D. Bond*

Name  
**A. D. Bond**  
 Position **Regulatory Engineering Coordinator**  
 Company  
**Mobil Oil Corporation**

Date  
**June 10, 1977**

*I hereby certify that the well location shown on this plat was plotted from field notes of actual surveys made by me or under my supervision, and that the same is true and correct to the best of my knowledge and belief.*

Date Surveyed  
**May 31, 1977**

Registered Professional Engineer and/or Land Surveyor

**Curtis A. Callaway**

Certificate No.  
**3342**

0 330 660 990 1320 1650 1980 2310 2640 2000 1500 1000 500 0