

| | |
|------------------------|--|
| NO. OF COPIES RECEIVED | |
| DISTRIBUTION | |
| SANTA FE | |
| FILE | |
| U.S.G.S. | |
| LAND OFFICE | |
| OPERATOR | |

NEW MEXICO OIL CONSERVATION COMMISSION

API # 30-033-20044

Form C-101
Revised 1-1-65

5A. Indicate Type of Lease
STATE ☐ FEE ☒

5. State Oil & Gas Lease No.

APPLICATION FOR PERMIT TO DRILL, DEEPEN, OR PLUG BACK

| | | |
|--|--|---|
| 1a. Type of Work DRILL <input checked="" type="checkbox"/> DEEPEN <input type="checkbox"/> PLUG BACK <input type="checkbox"/> | | 7. Unit Agreement Name |
| b. Type of Well OIL WELL <input type="checkbox"/> GAS WELL <input checked="" type="checkbox"/> OTHER CO ₂ SINGLE ZONE <input checked="" type="checkbox"/> MULTIPLE ZONE <input type="checkbox"/> | | 8. Farm or Lease Name R.S. Coon, et al |
| 2. Name of Operator Mobil Oil Corporation | | 9. Well No. 1-Y |
| 3. Address of Operator 3 Greenway Plaza-E, Suite 800, Houston, Texas 77046 | | 10. Field and Pool, or Wildcat Wildcat |
| 4. Location of Well UNIT LETTER P LOCATED 775 FEET FROM THE South LINE AND 980 FEET FROM THE East LINE OF SEC. 22 TWP. 20N RGE. 23E NMPM | | 12. County Mora |
| 19. Proposed Depth 3200 | | 19A. Formation Sangre De Cristo |
| 20. Rotary or C.T. Rotary | | |
| 21. Elevations (Show whether DF, RT, etc.) Ground - 6180 | 21A. Kind & Status Plug. Bond On File | 21B. Drilling Contractor |
| 22. Approx. Date Work will start As soon as possible | | |

23.

PROPOSED CASING AND CEMENT PROGRAM

| SIZE OF HOLE | SIZE OF CASING | WEIGHT PER FOOT | SETTING DEPTH | SACKS OF CEMENT | EST. TOP |
|--------------|----------------|-----------------|---------------|-----------------|--------------|
| 14-3/4" | 10-3/4" | 32.75# H-40 | 0-200' | Circulate | Surface |
| 9-1/2" | 7-5/8" | 26.4# K-55 | 0-1600' | Circulate | Surface |
| 6-3/4" | 5-1/2" Liner | 14# K-55 | 1500-3200' | Circulate | Top of Liner |

BLOWOUT PREVENTER PROGRAM

| Casing String | Equip. Size & API Series | No. & Type | Test Pressure - PSI |
|---------------|--------------------------|------------|-----------------------------|
| Surface | 8" | 600 | 1 Master Gate 1 Pipe Ram |
| | | | 3000 |

This well is being drilled as a replacement for Well #1 which had to be abandoned because of junk in the hole.

IN ABOVE SPACE DESCRIBE PROPOSED PROGRAM: IF PROPOSAL IS TO DEEPEN OR PLUG BACK, GIVE DATA ON PRESENT PRODUCTIVE ZONE AND PROPOSED NEW PRODUCTIVE ZONE. GIVE BLOWOUT PREVENTER PROGRAM, IF ANY.

I hereby certify that the information above is true and complete to the best of my knowledge and belief.

Signed A. D. Bond A.D. Bond Title Regulatory Engineering Coord. Date November 1, 1977
(This space for State Use)

APPROVED BY Carl Wilcox TITLE MANAGER DATE 11/8/77
CONDITIONS OF APPROVAL, IF ANY:

**NEW MEXICO OIL CONSERVATION COMMISSION
WELL LOCATION AND ACREAGE DEDICATION PLAT**

Form C-102
Supersedes C-128
Effective 1-1-65

All distances must be from the outer boundaries of the Section.

| | | | | | |
|---|--|------------------------|---------------------------------------|-----------------------|--|
| Operator Mobil Oil Corporation | | | Lease R. S. Coon, et al | | |
| Unit Letter P | Section 22 | Township 20N | Range 23E | County Mora | |
| Actual Footage Location of Well: <div style="display: flex; justify-content: space-between;"> 775' feet from the South line and 980 feet from the East line </div> | | | | | |
| Ground Level Elev: 6180' | Producing Formation Sangre De Cristo | Pool Wildcat | Dedicated Acreage: 40 Acres | | |

1. Outline the acreage dedicated to the subject well by colored pencil or hachure marks on the plat below.
2. If more than one lease is dedicated to the well, outline each and identify the ownership thereof (both as to working interest and royalty).
3. If more than one lease of different ownership is dedicated to the well, have the interests of all owners been consolidated by communitization, unitization, force-pooling, etc?

☐ Yes ☐ No If answer is "yes," type of consolidation _____

If answer is "no," list the owners and tract descriptions which have actually been consolidated. (Use reverse side of this form if necessary.) _____

No allowable will be assigned to the well until all interests have been consolidated (by communitization, unitization, forced-pooling, or otherwise) or until a non-standard unit, eliminating such interests, has been approved by the Commission.

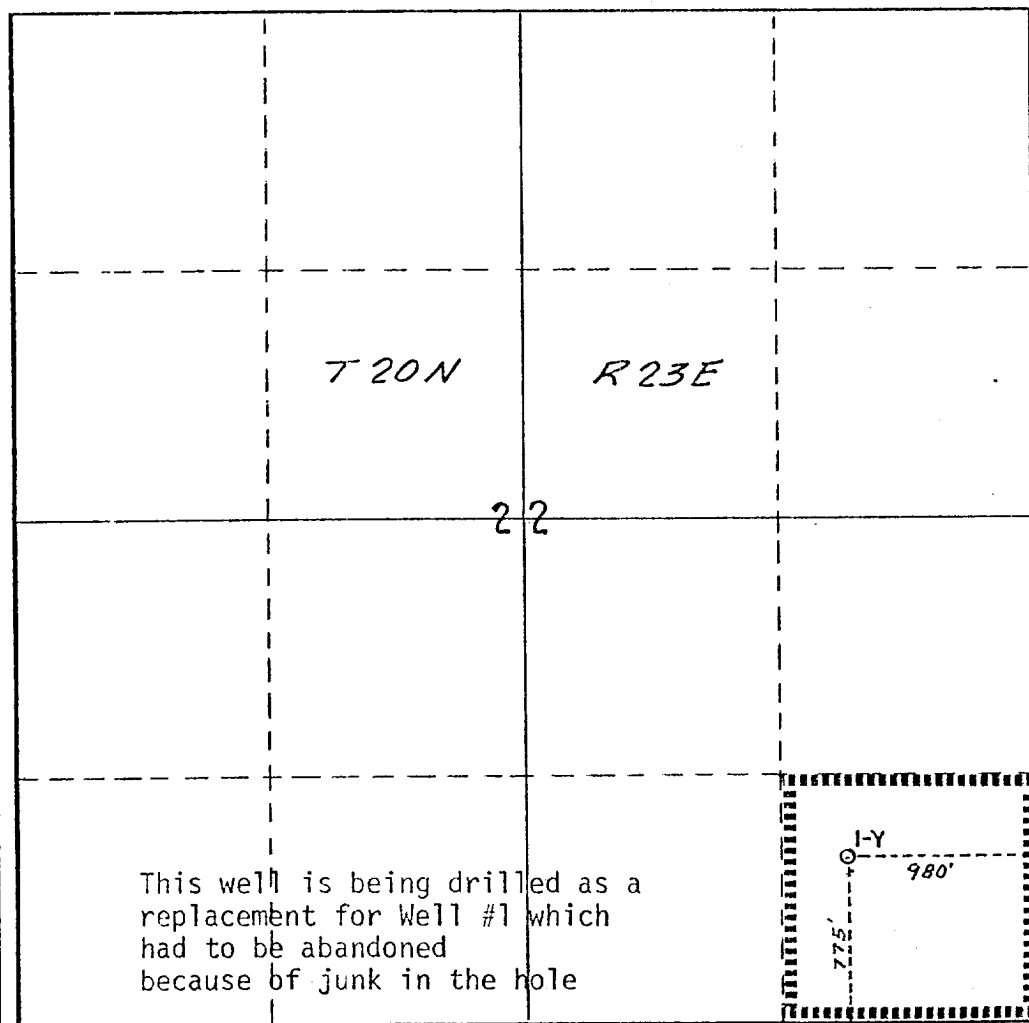

CERTIFICATION

I hereby certify that the information contained herein is true and complete to the best of my knowledge and belief.

A. D. Bond

Name
A. D. Bond

Position
**Coordinator
Regulatory Engineering**

Company
Mobil Oil Corporation

Date
November 1, 1977

I hereby certify that the well location shown on this plat was plotted from field notes of actual surveys made by me or under my supervision, and that the same is true and correct to the best of my knowledge and belief.

Date Surveyed **Well #1**
June 21, 1977

Registered Professional Engineer
and/or Land Surveyor

J. F. Godfrey, Jr.

Certificate No.
2663

0 330 660 990 1320 1650 1980 2310 2640 2970 3300 3630 3960 4290 4620 4950 5280 5610 5940 6270 6600