

NEW MEXICO OIL CONSERVATION COMMISSION
WELL LOCATION AND ACREAGE DEDICATION PLAT

Form C-102
Supersedes C-128
Effective 1-1-65

All distances must be from the outer boundaries of the Section.

Operator CORONADO EXPLORATION CORP.		Lease CLYDE BERLIER		Well No. 1	
Unit Letter	Section 21	Township 21N	Range 21E	County Mora	
Actual Footage Location of Well: 1320.0 feet from the south line and 1320.0 feet from the west line					
Ground Level Elev. 6380	Producing Formation Dakota-Morrison		Pool Wagon Mound-Dakota Morrison		Dedicated Acreage: 160 Acres

1. Outline the acreage dedicated to the subject well by colored pencil or hachure marks on the plat below.
2. If more than one lease is dedicated to the well, outline each and identify the ownership thereof (both as to working interest and royalty).
3. If more than one lease of different ownership is dedicated to the well, have the interests of all owners been consolidated by communitization, unitization, force-pooling, etc?

☒ Yes ☐ No If answer is "yes," type of consolidation All leases owned by operator

and participating parties

If answer is "no," list the owners and tract descriptions which have actually been consolidated. (Use reverse side of this form if necessary.)

No allowable will be assigned to the well until all interests have been consolidated (by communitization, unitization, forced-pooling, or otherwise) or until a non-standard unit, eliminating such interests, has been approved by the Commission.

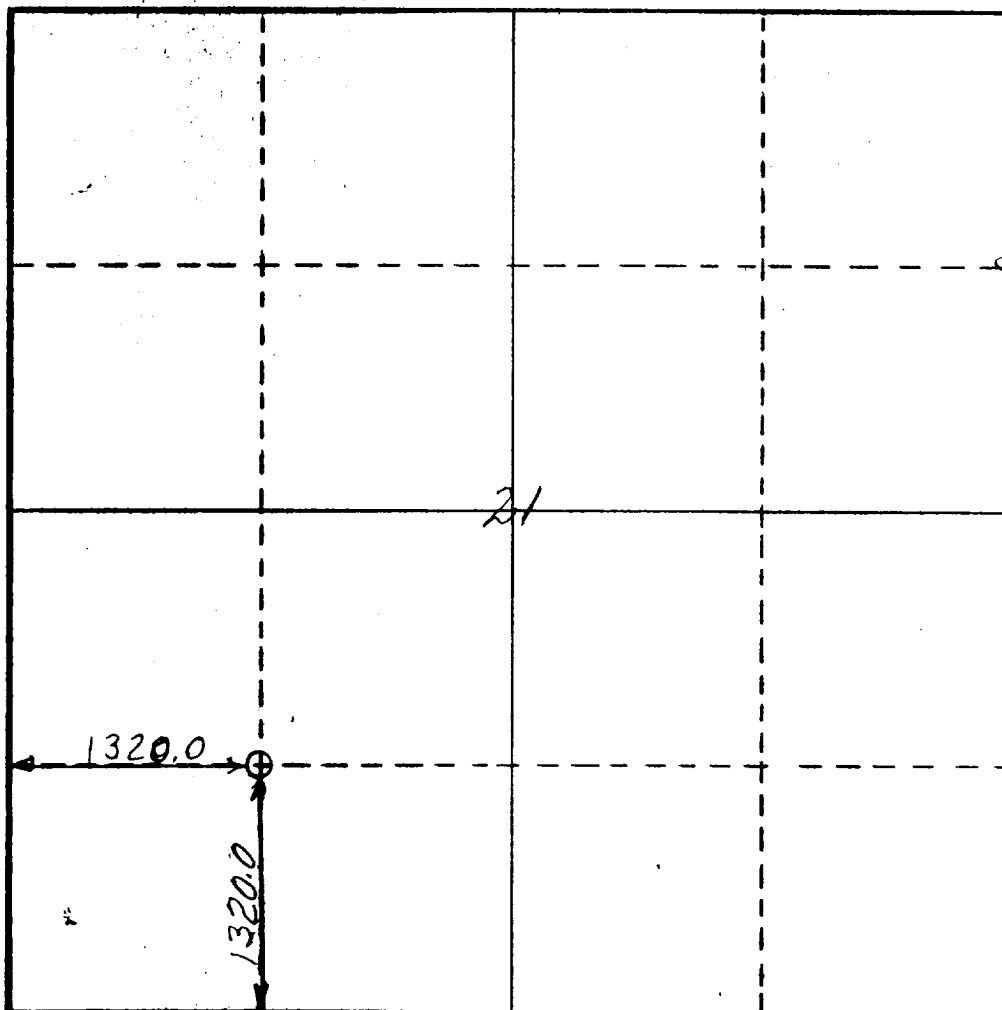

CERTIFICATION

I hereby certify that the information contained herein is true and complete to the best of my knowledge and belief.

Name

Position

President

Company

Coronado Exploration Corp.

Date

November 3, 1978

I hereby certify that the well location shown on this plat was plotted from field notes of actual surveys made by me or under my supervision, and that the same is true and correct to the best of my knowledge and belief.

Date Surveyed

Oct 31, 1978

Registered Professional Engineer and/or Land Surveyor

Charles L. Hudson

Certificate No.

L.S.L.C. 1489