

NEW MEXICO OIL CONSERVATION COMMISSION  
Santa Fe, New Mexico

Form C-101  
Revised (12/1/55)

NOTICE OF INTENTION TO DRILL

Notice must be given to the District Office of the Oil Conservation Commission and approval obtained before drilling or recompletion begins. If changes in the proposed plan are considered advisable, a copy of this notice showing such changes will be returned to the sender. Submit this notice in QUINTUPLICATE. One copy will be returned following approval. See additional instructions in Rules and Regulations of the Commission. If State Land submit 6 Copies Attach Form C-128 in triplicate to first 3 copies of form C-101

Colmar, New Mexico

April 14, 1959

(Place)

(Date)

OIL CONSERVATION COMMISSION  
SANTA FE, NEW MEXICO

Gentlemen:

You are hereby notified that it is our intention to commence the Drilling of a well to be known as  
R. W. Filkey Partnership

(Company or Operator)

Jeoffroy

Well No. 1

M

(Unit)

located 660 feet from the South line and 660 feet from the West line of Section 21, T. 23 N., R. 22 E., NMPM.

(GIVE LOCATION FROM SECTION LINE)

Colmar Wildcat Pool, Mora County

D	C	B	A
E	F	G	H
L	K	J	I
M	N	O	P

If State Land the Oil and Gas Lease is No.

If patented land the owner is Roy Jeoffroy

Address Colmar, New Mexico

We propose to drill well with drilling equipment as follows:

Rotary

The status of plugging bond is Blanket

Drilling Contractor O. D. Fee

We intend to complete this well in the Dakota SS

formation at an approximate depth of 940 - 1125' feet.

CASING PROGRAM

We propose to use the following strings of Casing and to cement them as indicated:

Size of Hole	Size of Casing	Weight per Foot	New or Second Hand	Depth	Sacks Cement
7 7/8	5 1/2"	15.5	New	TD	40 neat
11"	8 5/8	?	NEW	60	15 Circ.

If changes in the above plans become advisable we will notify you immediately.

ADDITIONAL INFORMATION (If recompletion give full details of proposed plan of work.)

Approved April 20, 1959

Except as follows:

COLLECT AND SACK SAMPLES FOR

NEW MEXICO BUREAU OF MINES, SOCORRO

AT AT LEAST TEN FOOT INTERVALS

Circulate surface cement  
OIL CONSERVATION COMMISSION

By

Sincerely yours,

R. W. Filkey Partnership

(Company or Operator)

By Roscoe Pursley

Position Superintendent

Send Communications regarding well to

Name Roscoe Pursley

Address 1145 So. Quivas, Denver, Colorado

NEW MEXICO OIL CONSERVATION COMMISSION  
Well Location and Acreage Dedication Plat

Section A. 17

Date April 14, 1959

Operator R. W. Filkey Partnership Lease Jeoffroy  
Well No. 1 Unit Letter M Section Sec. 21 Township 23 N Range 22 East NMPN  
Located 660 Feet From South Line, 660 Feet From West Line  
County Mora G. L. Elevation \_\_\_\_\_ Dedicated Acreage 40 Acres  
Name of Producing Formation Dakota SS Pool Colmer

1. Is the Operator the only owner\* in the dedicated acreage outlined on the plat below?  
Yes Yes No \_\_\_\_\_.
2. If the answer to question one is "no," have the interests of all the owners been consolidated by communitization agreement or otherwise? Yes \_\_\_\_\_ No \_\_\_\_\_. If answer is "yes," Type of Consolidation \_\_\_\_\_
3. If the answer to question two is "no," list all the owners and their respective interests below:

Owner

Land Description

Section B

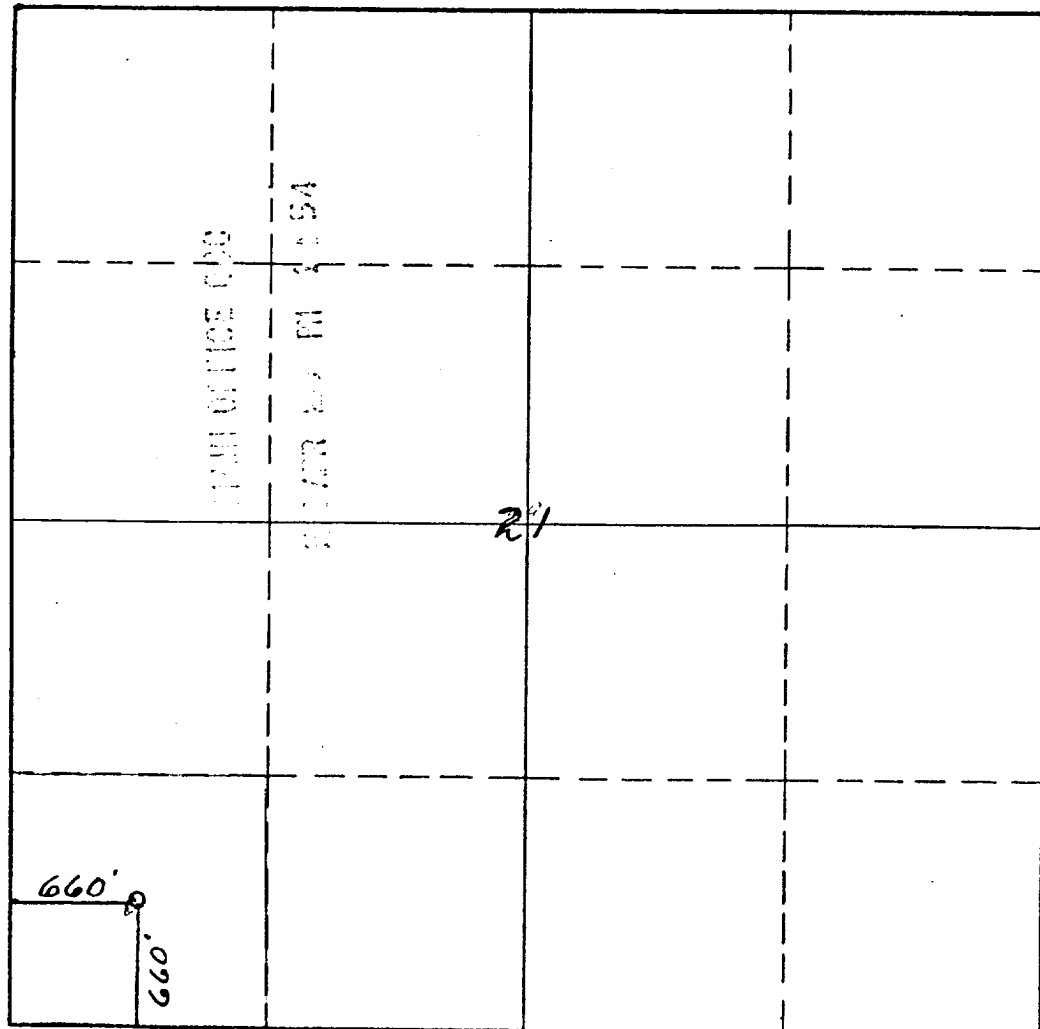

This is to certify that the information in Section A above is true and complete to the best of my knowledge and belief.

R. W. Filkey Partnership  
(Operator)  
Roscoe Pursley  
(Representative)

1145 So. Quivas, Denver, Colo  
Address

This is to certify that the well location shown on the plat in Section B was plotted from field notes of actual surveys made by me or under my supervision and that the same is true and correct to the best of my knowledge and belief.

Date Surveyed Oct. 13, 1958

P. M. Bowen  
Registered Professional  
Engineer and/or Land Surveyor.

Certificate No. 22

### INSTRUCTIONS FOR COMPLETION:

1. Operator shall furnish and certify to the information called for in Section A.
2. Operator shall outline the dedicated acreage for both oil and gas wells on the plat in Section B.
3. A registered professional engineer or land surveyor registered in the State of New Mexico or approved by the Commission shall show on the plat the location of the well and certify this information in the space provided.
4. All distances shown on the plat must be from the outer boundaries of Section.
5. If additional space is needed for listing owners and their respective interests as required in question 3, Section A, please use space below

\* "Owner" means the person who has the right to drill into and to produce from any pool and to appropriate the production either for himself or for himself and another. (65-3-29 (e) NMSA 1953 Comp.)