

30-031-20,000

OCT 30 1969

NO. OF COPIES RECEIVED	
DISTRIBUTION	
SANTA FE	
FILE	✓
U.S.G.S.	
LAND OFFICE	
OPERATOR	

NEW MEXICO OIL CONSERVATION COMMISSION

Form C-101
Revised 1-1-65

5A. Indicate Type of Lease	
STATE <input checked="" type="checkbox"/>	FEE <input type="checkbox"/>
5. State Oil & Gas Lease No.	
L-73	

APPLICATION FOR PERMIT TO DRILL, DEEPEN, OR PLUG BACK

1a. Type of Work		7. Unit Agreement Name	
b. Type of Well OIL WELL <input checked="" type="checkbox"/> GAS WELL <input type="checkbox"/> OTHER <input type="checkbox"/>		8. Farm or Lease Name	
DRILL <input checked="" type="checkbox"/> DEEPEN <input type="checkbox"/> PLUG BACK <input type="checkbox"/>		New Mexico - State	
2. Name of Operator		9. Well No.	
POWERS AND POWERS		2	
3. Address of Operator		10. Field and Pool, or Wildcat	
10180 VALLEY BLVD. EL MONTE, CALIF.		Wildcat	
4. Location of Well UNIT LETTER <u>K</u> LOCATED <u>1934</u> FEET FROM THE <u>West</u> LINE		12. County	
AND <u>2400</u> FEET FROM THE <u>South</u> LINE OF SEC. <u>28</u> TWP. <u>15 N</u> RGE. <u>34 E</u> NMPM		Quay	
19. Proposed Depth		19A. Formation	20. Rotary or C.T.
1500		San Andres	Rotary
21. Elevations (Show whether DF, RT, etc.)	21A. Kind & Status Plug. Bond	21B. Drilling Contractor	22. Approx. Date Work will start
4052 G.L.	Blanket	Concore	On Approval

23.

PROPOSED CASING AND CEMENT PROGRAM

SIZE OF HOLE	SIZE OF CASING	WEIGHT PER FOOT	SETTING DEPTH	SACKS OF CEMENT	EST. TOP
11"	8-5/8	20	300	300	circulated
7-7/8"	4-1/2	9.5	1500	100	1300

It is proposed to drill the captioned well to the depth stated above to test the San Andres. If information is obtained to indicate production casing will be run as shown above and the well perforated and treated for completion.

APPROVAL VALID
FOR 90 DAYS UNLESS
DRILLING COMMENCED,

EXPIRES Jan 29 1970

IN ABOVE SPACE DESCRIBE PROPOSED PROGRAM: IF PROPOSAL IS TO DEEPEN OR PLUG BACK, GIVE DATA ON PRESENT PRODUCTIVE ZONE AND PROPOSED NEW PRODUCTIVE ZONE. GIVE BLOWOUT PREVENTER PROGRAM, IF ANY.

I hereby certify that the information above is true and complete to the best of my knowledge and belief.

Signed N.S. McCoy Title Agent Date 10-29-69

(This space for State Use)

APPROVED BY J. E. Teptina TITLE Oil & Gas Inspector DATE 10/31/69

CONDITIONS OF APPROVAL, IF ANY:
COLLECT AND SAVE SAMPLES FOR
NEW MEXICO BUREAU OF MINES, SOCORRO
AT AT LEAST 100 FOOT INTERVALS

**NEW MEXICO OIL CONSERVATION COMMISSION
WELL LOCATION AND ACREAGE DEDICATION PLAT**

OCT 29 1969

Form C-102
Supersedes C-128
Effective 1-1-65

All distances must be from the outer boundaries of the Section.

Operator POWER AND POWERS			Lease NEW MEXICO STATE		Well No. 2
Unit Letter K	Section 10	Township 15 N	Range 24 E	County JOHN	
Actual Footage Location of Well: 1934.5 feet from the WEST line and 2400.4 feet from the SOUTH line					
Ground Level Elev. 4052.56	Producing Formation SAN JUAN	Pool WILCUT	Dedicated Acreage: 40 Acres		

1. Outline the acreage dedicated to the subject well by colored pencil or hachure marks on the plat below.
2. If more than one lease is dedicated to the well, outline each and identify the ownership thereof (both as to working interest and royalty).
3. If more than one lease of different ownership is dedicated to the well, have the interests of all owners been consolidated by communitization, unitization, force-pooling, etc?

☐ Yes ☐ No If answer is "yes," type of consolidation _____

If answer is "no," list the owners and tract descriptions which have actually been consolidated. (Use reverse side of this form if necessary.) _____

No allowable will be assigned to the well until all interests have been consolidated (by communitization, unitization, forced-pooling, or otherwise) or until a non-standard unit, eliminating such interests, has been approved by the Commission.

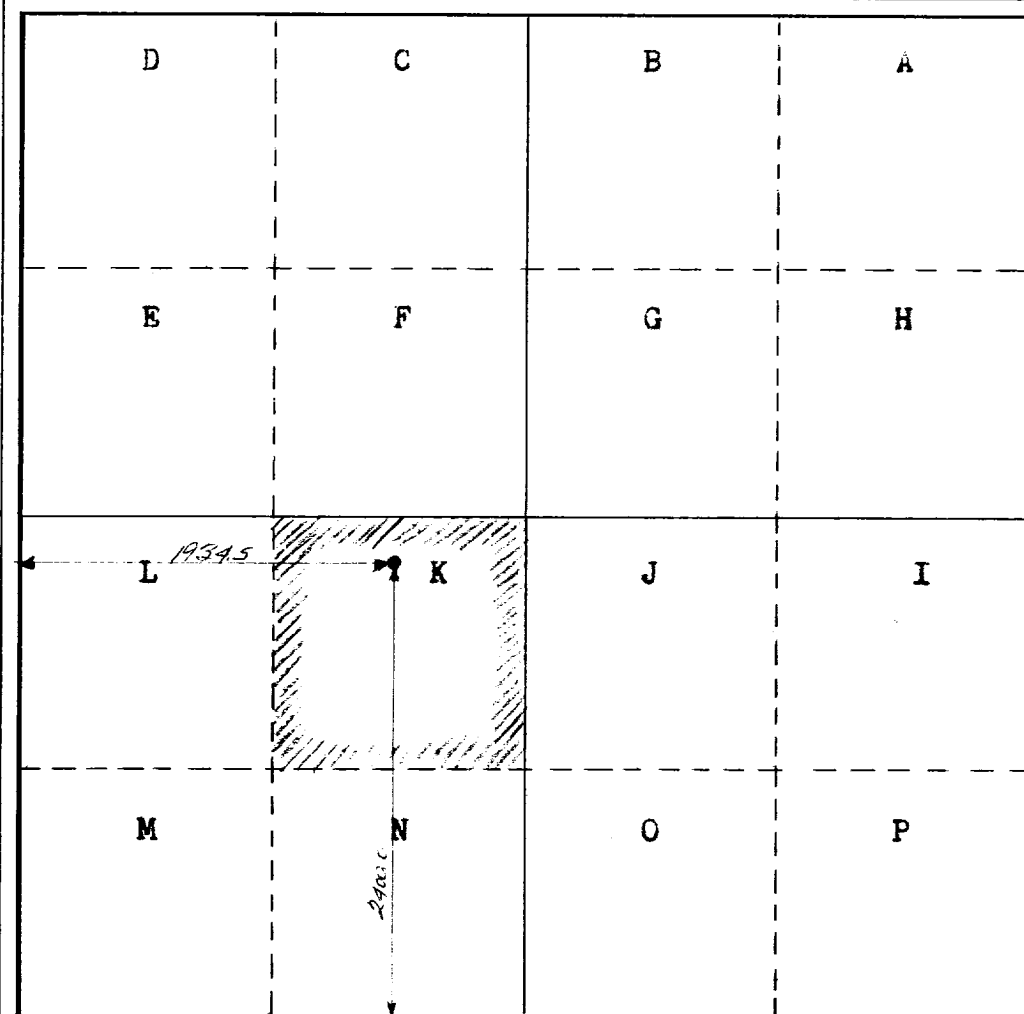

CERTIFICATION

I hereby certify that the information contained herein is true and complete to the best of my knowledge and belief.

Name *W.B. McCarty*

Position *Agent*

Company *Powers & Powers*

Date *10-27-69*

I hereby certify that the well location shown on this plat was plotted from field notes of actual surveys made by me or under my supervision, and that the same is true and correct to the best of my knowledge and belief.

Date Surveyed

28 OCT, 1969

Registered Professional Engineer and/or Land Surveyor

Robert L. Lydick

Certificate No.

2221