

|                        |   |
|------------------------|---|
| NO. OF COPIES RECEIVED |   |
| DISTRIBUTION           |   |
| SANTA FE               |   |
| FILE                   | ✓ |
| U.S.G.S.               |   |
| LAND OFFICE            |   |
| OPERATOR               |   |

# NEW MEXICO OIL CONSERVATION COMMISSION

Form C-101

Revised 1-1-81

API # 30-059-20121

## APPLICATION FOR PERMIT TO DRILL, DEEPEN, OR PLUG BACK

|   |  |   |  |
|---|--|---|--|
| 1a. Type of Work  |  | 7. Unit Agreement Name                        |  |
| b. Type of Well<br>DRILL <input checked="" type="checkbox"/> DEEPEN <input type="checkbox"/> PLUG BACK <input type="checkbox"/><br>OIL WELL <input type="checkbox"/> GAS WELL <input checked="" type="checkbox"/> CO2 OTHER <input type="checkbox"/> SINGLE ZONE <input checked="" type="checkbox"/> MULTIPLE ZONE <input type="checkbox"/> |  | 8. Farm or Lease Name<br>J. D. Ellis          |  |
| 2. Name of Operator<br>Amoco Production Company   |  | 9. Well No.<br>1                              |  |
| 3. Address of Operator<br>P. O. Box 68 Hobbs, NM 88240  |  | 10. Field and Pool, or Well-leaf<br>Und. Tubb |  |
| 4. Location of Well<br>UNIT LETTER G LOCATED 1980 FEET FROM THE North LINE<br>AND 1980 FEET FROM THE East LINE OF SEC. 5 TWP. 19-N RGE. 35-E NMPM   |  | 12. County<br>Union                           |  |
| 19. Proposed Depth<br>2600'   |  | 19A. Formation<br>Tubb                        |  |
| 21. Elevations (Show whether DT, RL, etc.)<br>4672 GL   |  | 20. Rotary or C.T.<br>Rotary                  |  |
| 21A. Kind & Status Plug. Bond<br>Blanket-on-file  |  | 22. Approx. Date Work will start<br>3-16-81   |  |

## PROPOSED CASING AND CEMENT PROGRAM

| SIZE OF HOLE | SIZE OF CASING | WEIGHT PER FOOT | SETTING DEPTH | SACKS OF CEMENT    | EST. TOP   |
|--------------|----------------|-----------------|---------------|--------------------|------------|
| 12-1/4"      | 8-5/8"         | 24#             | 700'          | Circ.              | Surface    |
| 7-7/8"       | 5-1/2"         | 14#             | 2600'         | Tie back to 8-5/8" | BTM 8-5/8" |

Propose to drill and equip well in the Tubb formation. After reaching TD logs will be run and evaluated. Perforate and stimulate as necessary in attempting commercial production.

MUD PROGRAM: 0'-700' Native mud and fresh water  
 700'-TD Commercial mud and brine with minimum properties for safe hole conditions.

BOP Program attached.  
 Gas is not dedicated.

APPROVAL VALID FOR 180 DAYS  
 PERMIT EXPIRES 9-9-81  
 UNLESS DRILLING UNDERWAY

0+2-NMOCD, SF 1-Hou 1-Susp 1-BD

OIL CONSERVATION COMMISSION  
 WITHIN 24 HOURS OF RECEIVING OF APPLICATION

IN ABOVE SPACE DESCRIBE PROPOSED PROGRAM: IF PROPOSAL IS TO DEEPEN OR PLUG BACK, GIVE DATA ON PRESENT PRODUCTIVE ZONE AND PROPOSED NEW PRODUCTIVE ZONE. GIVE BLOWOUT PREVENTER PROGRAM, IF ANY.

I hereby certify that the information above is true and complete to the best of my knowledge and belief.

Signed Bob Laws Title Admin. Analyst Date 3-10-81

(This space for State Use)

APPROVED BY Carl Ulvog TITLE SENIOR PETROLEUM GEOLOGIST DATE 3/13/81  
 CONDITIONS OF APPROVAL, IF ANY:

NEW MEXICO OIL CONSERVATION COMMISSION  
WELL LOCATION AND ACREAGE DEDICATION PLAT

Form C-102  
Supersedes C-128  
Effective 1-1-65

All distances must be from the outer boundaries of the Section.

|  |                             |                      |                                 |                  |
|--|-----------------------------|----------------------|---------------------------------|------------------|
| Operator<br>AMOCO  |                             | Lease<br>J. D. ELLIS |                                 | Well No.<br>1001 |
| Unit Letter<br>G   | Section<br>5                | Township<br>T19N     | Range<br>R35E                   | County<br>UNION  |
| Actual Footage Location of Well:<br>1980 feet from the NORTH line and 1980 feet from the EAST line |                             |                      |                                 |                  |
| Ground Level Elev.<br>4672   | Producing Formation<br>Tubb | Pool<br>Und. Tubb    | Dedicated Acreage:<br>160 Acres |                  |

1. Outline the acreage dedicated to the subject well by colored pencil or hatchure marks on the plat below.
2. If more than one lease is dedicated to the well, outline each and identify the ownership thereof (both as to working interest and royalty).
3. If more than one lease of different ownership is dedicated to the well, have the interests of all owners been consolidated by communitization, unitization, force-pooling, etc?

☐ Yes ☐ No If answer is "yes," type of consolidation \_\_\_\_\_

If answer is "no," list the owners and tract descriptions which have actually been consolidated. (Use reverse side of this form if necessary.) \_\_\_\_\_

No allowable will be assigned to the well until all interests have been consolidated (by communitization, unitization, forced-pooling, or otherwise) or until a non-standard unit, eliminating such interests, has been approved by the Commission.

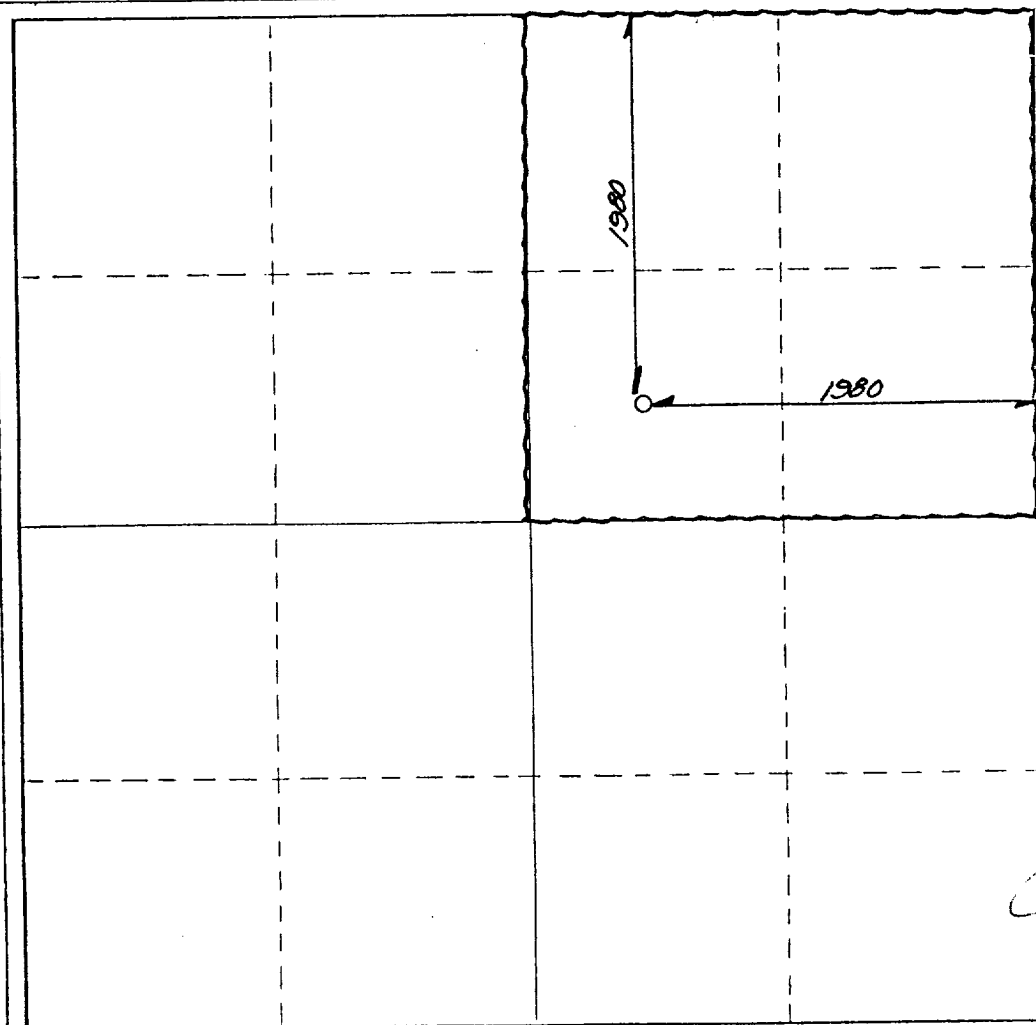

CERTIFICATION

I hereby certify that the information contained herein is true and complete to the best of my knowledge and belief.

Name Bob Davis  
Position Admin. Analyst  
Company Amoco Production Company  
Date 3-10-81

I hereby certify that the well location shown on this plat was plotted from field notes of actual surveys made by me or under my supervision, and that the same is true and correct to the best of my knowledge and belief.

DATE SURVEYED MARCH 27 1981

REGISTERED PROFESSIONAL ENGINEER  
and/or LAND SURVEYOR

N.M.L.S. NO. 5103

Certificate No. \_\_\_\_\_

0 330 660 990 1320 1650 1980 2310 2640 2970 3300 3630 3960 4290 4620 4950 5280 5610 5940 6270 6600

1. Blow-out preventers and master valve to be fluid operated and oil fittings must be in good condition, 3,000# W.P. (6,000 p.s.i. test), minimum.
2. Equipment through which bit must pass shall be as large as the inside diameter of the casing that is being drilled through.
3. Nipple above blow-out preventer shall be same size as casing being drilled through.
4. Kelly cock required, 3,000# W.P. (6,000 p.s.i. test) minimum.
5. OHSO or comparable safety valve must be available on rig floor at all times with proper connection or sub, 3,000# W.P. (6,000 p.s.i. test), minimum.
6. Blow-out preventers and master valve while drilling intermediate hole to 6000' may be 2,000# W.P. (4,000 p.s.i. test), minimum.
7. Choke assembly, beyond second valve from cross, may be positioned (Optional) outside of derrick foundation.
8. Spool or cross may be eliminated if connections are available in the lower part of the blow-out preventer body.
9. Plug valves - gate valves are optional. Valves shown as 2" are minimum size.
10. Casing head and casing head spool, including attached valves, to be furnished by Amoco.
11. Rams in preventers will be installed as follows:  

|   |   |
|---|---|
| When drilling, use:                           | When running casing, use:                     |
| Top Preventer - Drill pipe rams               | Top Preventer - Casing rams                   |
| Bottom Preventer - Blind rams or master valve | Bottom Preventer - Blind rams or master valve |

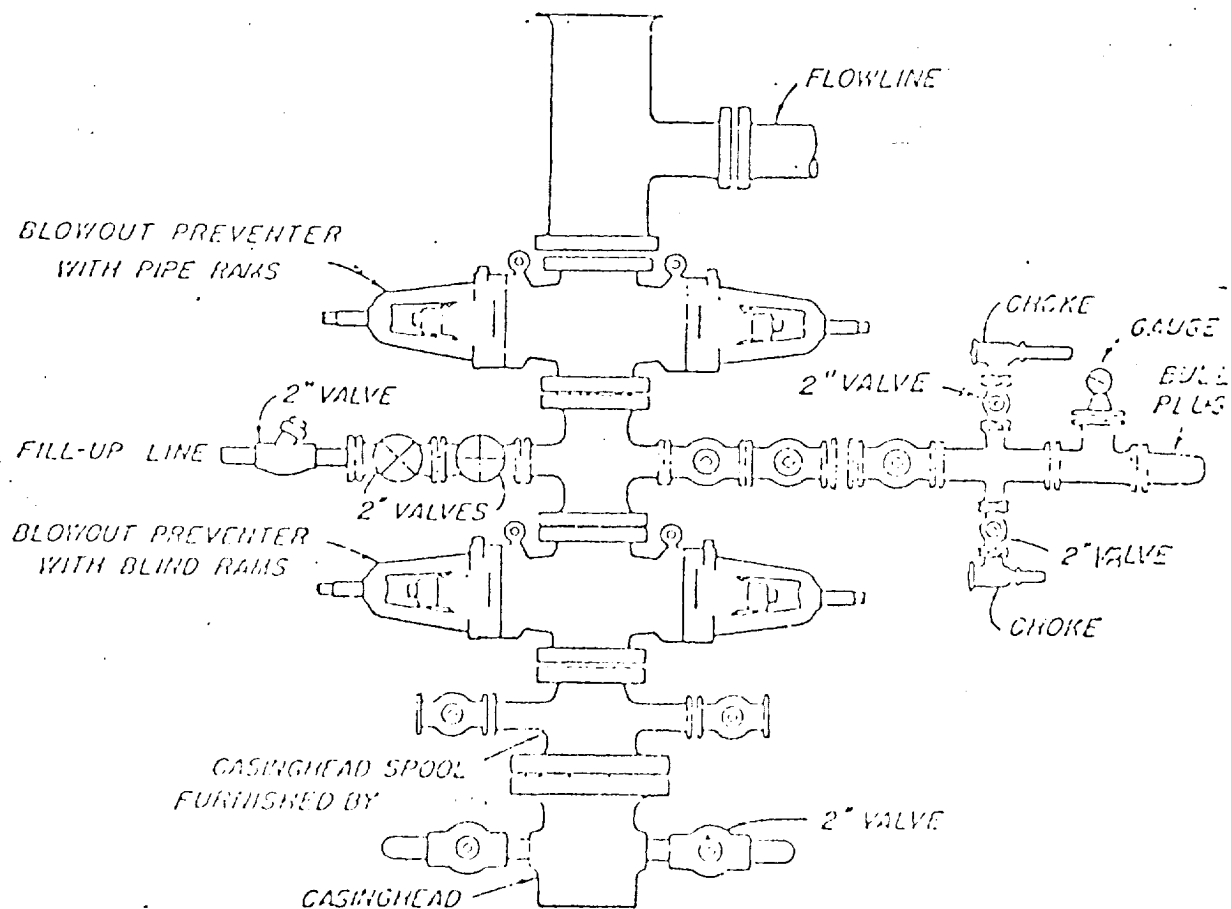

## BLOWOUT PREVENTER HOOK-UP

AMOCO FIELD SERVICE COMPANY

## EXHIBIT D-1 MODIFIED

JUNE 1, 1962