

NM1 - 30

**MONITORING
REPORT**

YEAR(S):

2011 - 2012



RECEIVED OCD

2013 MAR 22 A 8:29

March 18, 2013

VIA US CERTIFIED MAIL

Mr. Brad Jones
Environmental Engineer
New Mexico Oil Conservation Division
1220 So. St. Francis Drive
Santa Fe, New Mexico 87505

Re: Laboratory Analytical Results for 4th Quarter 2012 Vadose Samples, R360 Artesia, LLC Landfarm (NM-01-30-0) Unit A (NE/4, NE/4), Section 7, Township 17 South, Range 32 East, Lea County, New Mexico

Dear Mr. Jones:

This letter transmits the laboratory results of vadose samples collected at the R360 Artesia LLC Landfarm during the fourth (4th) on November 19, 2012. The landfarm is located in Unit A (NE/4, NE/4), Section 7, Township 17 South, Range 32 East in Lea County, New Mexico. The landfarm operates under New Mexico Oil Conservation Division (OCD) permit NM-01-30-0. The vadose samples were collected from approximately 2 to 3 feet below Cells 1 through 6 and submitted under preservation and chain of custody to DHL Analytical located in Round Rock, Texas. The laboratory analyzed the samples for benzene, toluene, ethylbenzene, xylenes (BTEX), total petroleum hydrocarbons (TPH), including gasoline range organics (GRO) and diesel range organics (DRO), metals (arsenic, barium, cadmium, calcium, chromium, lead, manganese, mercury, potassium, selenium, silver and sodium) and major ions (chloride, sulfate and alkalinity). Table 1 presents a BTEX and TPH analytical data summary. Table 2 presents a metals analytical data summary. Table 3 presents an analytical data summary for the major ions. Figure 1 presents a topographic map. Figure 2 presents an aerial photograph. Figure 3 presents the sample locations. Attachment A presents the laboratory report. Please contact Mr. Zack Davis with R360 at (281) 873-3200 or me at (432) 687-0901 should have any questions or require additional information.

Sincerely,

Larson & Associates, Inc.

A handwritten signature in black ink, appearing to read 'Mark J. Larson', enclosed within a hand-drawn oval.

Mark J. Larson, P.G.
Sr. Project Manager
Mark@laenvironmental.com

Enclosure

cc: Zack Davis – R360

Tables

Table 1
Summary of BTEX Analyses of Soil Samples
R360 Artesia, LLC Landfarm (NM-01-30-0)
Lea County, New Mexico

Sample	Cell Number	Date	Depth	Benzene	Ethylbenzene	Total Xylenes	GRO (C6 - C10)	DRO (>C10 - C28)	TPH (C-6 - C28)
Background:									
--									
WQCC Limit:									
				0.01	0.75	0.62			
C-1 (2 - 3')	C-1	11/19/12	2 - 3	<0.00289	<0.00477	<0.00477	<0.102	7.80	7.80
C-2 (2 - 3')	C-2	11/19/12	2 - 3	<0.00313	<0.00522	<0.00522	<0.106	9.71	9.71
C-3 (2 - 3')	C-3	11/19/12	2 - 3	<0.00302	<0.00503	<0.00503	<0.0910	9.42	9.42
C-4 (2 - 3')	C-4	11/19/12	2 - 3	<0.00275	<0.00458	<0.00458	<0.0990	7.80	7.80
C-5 (2 - 3')	C-5	11/19/12	2 - 3	<0.00314	<0.00523	<0.00523	<0.0108	27.6	27.6
C-6 (2 - 3')	C-6	11/19/12	2 - 3	<0.00293	<0.00488	<0.00488	<0.0959	14.1	14.1

Notes: Analysis performed by DHL Analytical, Inc., Round Rock, TX and Trace Analysis, Midland, TX

Results are reported in milligram per Kilograms (mg/Kg).

Depth is in feet below native ground surface

BTEX analysis was performed by SW846 method 8021B

1. < Less than method detection limit

2. -- No data available

Table 2
Summary of Metals Analysis of Soil Samples
R360 Artesia, LLC Landfarm (NM-01-30-0)
Lea County, New Mexico

Sample	Cell Number	Date	Depth	Arsenic	Barium	Cadmium	Calcium	Chromium	Lead	Magnesium	Mercury	Potassium	Selenium	Silver	Sodium
Background:															
WQCC Limit:															
				0.1	1.0	0.01	--	0.05	0.05	--	0.002	--	0.05	0.05	--
C-1 (2 - 3')	C-1	11/19/12	2 - 3	2.31	174	<0.105	149,000	5.53	2.82	2,730	<0.0142	1,590	0.398	<0.105	75.5
C-2 (2 - 3')	C-2	11/19/12	2 - 3	3.67	137	<0.103	127,000	8.23	3.83	3,920	<0.0149	2,430	0.455	<0.103	906
C-3 (2 - 3')	C-3	11/19/12	2 - 3	1.65	41	<0.0896	7,710	5.78	2.88	1,360	<0.0145	1,590	0.37	<0.0896	964
C-4 (2 - 3')	C-4	11/19/12	2 - 3	1.02	16.4	<0.0909	525	4.21	2.08	814	<0.0148	1,020	0.245	<0.0909	75
C-5 (2 - 3')	C-5	11/19/12	2 - 3	1.94	605	0.181	32,100	7.19	4.12	2,970	<0.0153	1,600	0.453	<0.105	2,160
C-6 (2 - 3')	C-6	11/19/12	2 - 3	1.21	19.4	<0.0873	668	4.02	2.15	663	<0.0136	884	0.276	<0.0873	23.6

Notes: Analysis performed by DHL Analytical, Inc., Round Rock, TX and Trace Analysis, Midland, TX

Results are reported in milligram per Kilograms (mg/Kg).

Metals analysis was performed by SW846 method 6020

Mercury analysis was performed by SW846 method 7471A

1. <: Less than method detection limit

2. --: No data available

Table 3
Summary of Anion Analyses of Soil Samples
R360 Artesia, LLC Landfarm (NM-01-30-0)
Lea County, New Mexico

Sample	Cell Number	Date	Depth	Alkalinity	Chloride	Sulfate
Background:						
				--	31.86	--
WQCC Limit:						
				--	250	600
C-1 (2 - 3')	C-1	11/19/12	2 - 3	809	7.51	20
C-2 (2 - 3')	C-2	11/19/12	2 - 3	1,380	59.9	320
C-3 (2 - 3')	C-3	11/19/12	2 - 3	1,470	181	345
C-4 (2 - 3')	C-4	11/19/12	2 - 3	71.0	72.1	77.6
C-5 (2 - 3')	C-5	11/19/12	2 - 3	562	2,020	1,770
C-6 (2 - 3')	C-6	11/19/12	2 - 3	84.7	58.9	22.5

Notes: Analysis performed by DHL Analytical, Inc., Round Rock, TX

Depth is in feet below native ground surface

Results are reported in milligram per Kilograms (mg/Kg).

Anion analysis was performed by SW846 method 9056

1. < Less than method detection limit
2. -- No data available

Figures



Figure 1 - Topographic Map



Legend

MW-2 - Monitoring Well Location

Graphic Scale in Feet
0 250
R 360 Artesia LLC Landfill
ULA (NE/4, NE/4) Sec. 7, T-17-S, R-32-E
Lea County, New Mexico

Larson & Associates, Inc.
Environmental Consultants

Figure 2 - Aerial Map

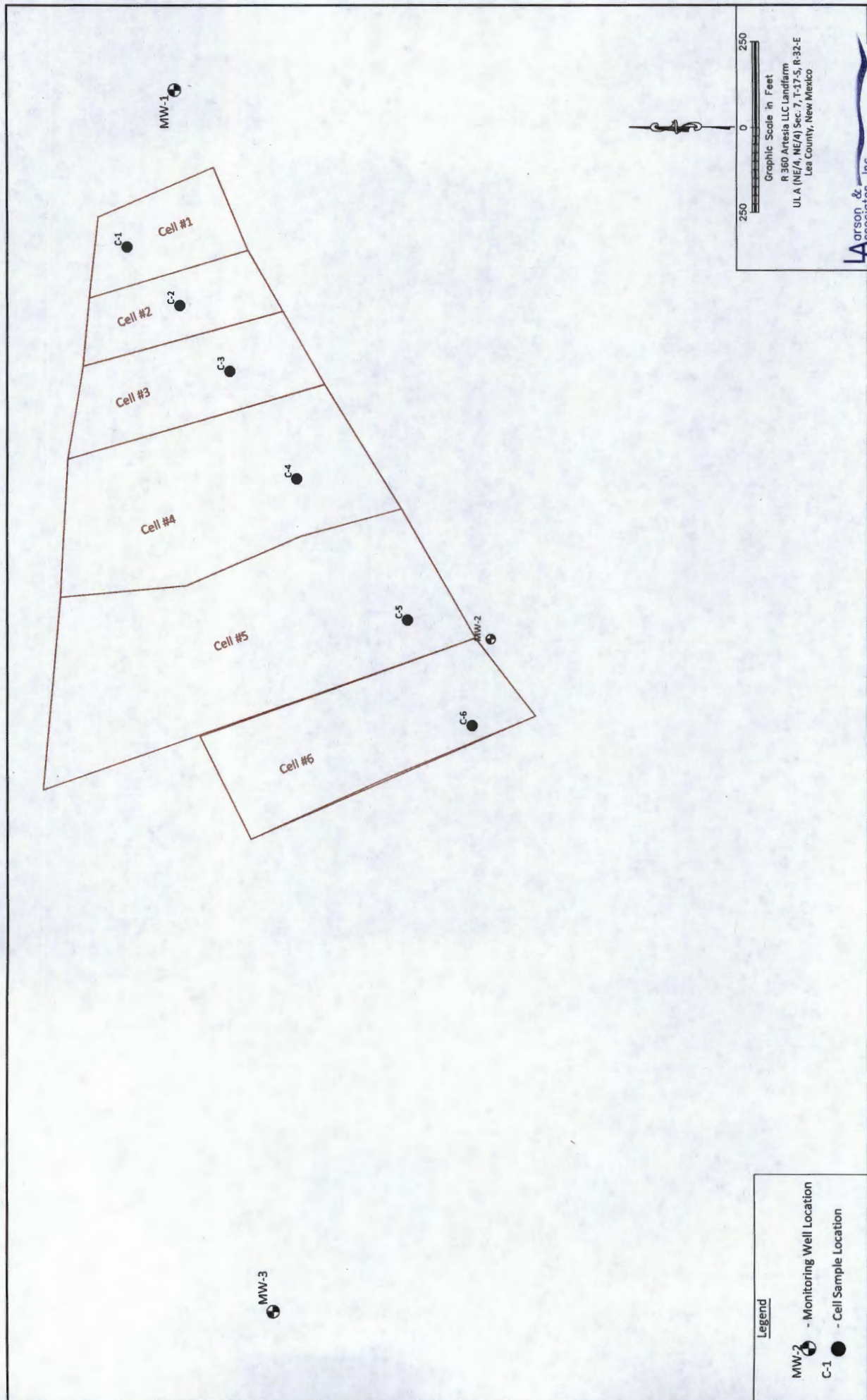

Figure 3 - Site Map

ATTACHEMENT A

Laboratory Report



December 03, 2012

Coty Woolf
Larson & Associates
507 N. Marienfeld #200
Midland, TX 79701

TEL: (432) 687-0901

FAX (432) 687-0456

Order No.: 1211199

RE: R360-Artesia Aeration Landfarm

Dear Coty Woolf:

DHL Analytical, Inc. received 6 sample(s) on 11/21/2012 for the analyses presented in the following report.

There were no problems with the analyses and all data met requirements of NELAC except where noted in the Case Narrative. All non-NELAC methods will be identified accordingly in the case narrative and all estimated uncertainties of test results are within method or EPA specifications.

If you have any questions regarding these tests results, please feel free to call. Thank you for using DHL Analytical.

Sincerely,

John DuPont
General Manager

This report was performed under the accreditation of the State of Texas Laboratory Certification Number: T104704211-12-8



Table of Contents

Miscellaneous Documents	3
CaseNarrative 1211199	6
WorkOrderSampleSummary 1211199	8
PrepDatesReport 1211199	9
AnalyticalDatesReport 1211199	12
Analytical Report 1211199	15
AnalyticalQCSummaryReport 1211199	27

CHAIN-OF-CUSTODY

Arison & Associates, Inc.
Environmental Consultants
507 N. Marientfeld, Ste. 200
Midland, TX 79701
432-687-0901

Data Reported to: **Coty Wolff**

DATE: **11/20/12** PAGE **1** OF **1**
 PO #: **1211194** LAB WORK ORDER #: **1211194**
 PROJECT LOCATION OR NAME: **R360 - Artesia Aeration Landfarm**
 LAI PROJECT #: **11-0109-06** COLLECTOR: **J. Fergerson**

TRRP report? <input type="checkbox"/> Yes <input checked="" type="checkbox"/> No	S=SOIL W=WATER A=AIR	P=PAINT SL=SLUDGE OT=OTHER	# of Containers	PRESERVATION				Matrix	Time	Date	Lab #	Field I.D.	FIELD NOTES
				HCl	HNO ₃	H ₂ O ₂ NaOH	ICE						
			3				S	1210	11/19/12	01	C-1 (2-3)		
			3				S	1240	11/19/12	02	C-2 (2-3)		
			3				S	1305	11/19/12	03	C-3 (2-3)		
			3				S	1325	11/19/12	04	C-4 (2-3)		
			3				S	1345	11/19/12	05	C-5 (2-3)		
			3				S	1405	11/19/12	06	C-6 (2-3)		
TOTAL													

RELINQUISHED BY: (Signature) **[Signature]** DATE/TIME **11/20/12 1700** RECEIVED BY: (Signature) **[Signature]**
 RELINQUISHED BY: (Signature) **[Signature]** DATE/TIME **11/21/12 930** RECEIVED BY: (Signature) **[Signature]**
 RELINQUISHED BY: (Signature) **[Signature]** DATE/TIME **11/21/12 930** RECEIVED BY: (Signature) **[Signature]**

LABORATORY USE ONLY:
 RECEIVING TEMP: **4.8** THERM #: **57**
 CUSTODY SEALS - BROKEN INTACT NOT USED
 CARRIER BILL # **[Signature]**
 HAND DELIVERED



WWW.LSO.COM
 Questions? Call 800-800-8984
 Airbill No. 47376908



1. To: Print Name (Person) Jennifer Barker Phone (Important)
 Company Name: **DHL Analytical**
 Street Address: **2300 Double Creek Drive**
 Suite / Floor: _____
 City: **Round Rock** State: **TX** Zip: **78664**

2. From: Print Name (Person) John Ferguson Phone (Important) 432-687-0911
 Company Name: **ARSON & ASSOCIATES**
 Street Address: **307 NORTH MARLENFELD**
 Suite / Floor: _____
 City: **MIDLAND** State: **TX** Zip: **79701**

3. Service: Visit www.lso.com for availability of services to your destination and enjoy added features by creating your shipping label online.

By 10:30 am Delivery Check availability at www.lso.com **Saturday Delivery** Check availability at www.lso.com
(Extra charge, no signature obtained) (Extra charge, not available on Ground) Other: _____

By 8:30 am Delivery Check availability at www.lso.com
(Extra charge, no signature obtained)

By 3:00 pm Delivery Assumed 10:30 a.m. service unless otherwise noted.
 Ground (next day to most cities)

Deliver Without Delivery Signature (See Limits of Liability below)

____ x W ____ x H _____
 Release Signature

4. Package: Your Company's Billing Reference Information **50 lbs**
 Weight: **50 lbs**
 Shp. Date: (mm/dd/yyyy) **11 20 12**

5. Payment:

Courier Number _____
 Check here if LSO Supplies are used with Ground Service.
Pick-up Location _____
Date: _____
Time: _____
City Code: _____

FOR COURIER USE ONLY

LIMIT OF LIABILITY: We are not responsible for claims in excess of \$100 for any reason unless you: 1) declare a greater value (not to exceed \$25,000); 2) pay an additional fee; 3) and document your actual loss in manner. We will not pay any claim in excess of the actual loss. We are not liable for any special or consequential damages. Additional limitations of liability are contained in our current Service Guide. NO DELIVERY SIGNATURE WILL BE OBTAINED FOR 08:30 AM DELIVERY. PROVIDED BY LSO IS NOT INTENDED FOR USE ON GROUND SERVICE. OVERSIZE RATES MAY APPLY. DELIVERY COMMITMENTS MAY VARY. ADDITIONAL FEES APPLY.

CUSTOMER SEAL

DATE

SIGNATURE

11/20/12

[Signature]

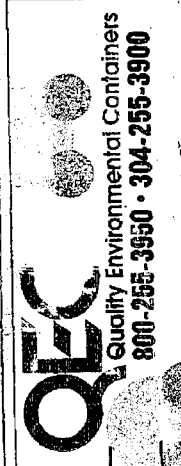

Quality Environmental Containers
 800-255-3950 • 304-255-3900

DHL Analytical, Inc.

Sample Receipt Checklist

Client Name **Larson & Associates**

Date Received: **11/21/2012**

Work Order Number **1211199**

Received by **JB**

Checklist completed by: *[Signature]* 11/21/2012
Signature Date

Reviewed by *[Initials]* 11/21/2012
Initials Date

Carrier name: LoneStar

- Shipping container/cooler in good condition? Yes No Not Present
- Custody seals intact on shipping container/cooler? Yes No Not Present
- Custody seals intact on sample bottles? Yes No Not Present
- Chain of custody present? Yes No
- Chain of custody signed when relinquished and received? Yes No
- Chain of custody agrees with sample labels? Yes No
- Samples in proper container/bottle? Yes No
- Sample containers intact? Yes No
- Sufficient sample volume for indicated test? Yes No
- All samples received within holding time? Yes No
- Container/Temp Blank temperature in compliance? Yes No 4.8 °C
- Water - VOA vials have zero headspace? Yes No No VOA vials submitted
- Water - pH acceptable upon receipt? Yes No Not Applicable

Adjusted? _____ Checked by _____

Any No response must be detailed in the comments section below.

Client contacted _____ Date contacted: _____ Person contacted _____

Contacted by: _____ Regarding: _____

Comments: _____

Corrective Action _____

CLIENT: Larson & Associates
Project: R360-Artesia Aeration Landfarm
Lab Order: 1211199

CASE NARRATIVE

Sample was analyzed using the methods outlined in the following references:

Method SW6020A - Metals Analysis
Method SW7471B - Mercury Analysis
Method SW8021B - Volatile Organics by GC
Method SW9056A - Anions Analysis
Method M8015D - DRO Analysis
Method M8015V - GRO Analysis
Method M2320 B - Soluble Alkalinity of Soil Analysis
Method D2216 - Percent Moisture

LOG IN

The samples were received and log-in performed on 11/21/2012. A total of 6 samples were received and analyzed. The time of collection was Mountain Standard Time. The samples arrived in good condition and were properly packaged.

DRO ANALYSIS

For DRO Analysis, the recovery of surrogate Octacosane for Sample C-6 (2-3'), the Matrix Spike and Matrix Spike Duplicate (1211150-03 MS/MSD) was above the method control limits. These are flagged accordingly in the Analytical Data report and the QC Summary Report. The remaining surrogate was within method control limits. No further corrective actions were taken.

For DRO Analysis, the recoveries of the Matrix Spike and Matrix Spike Duplicate (1211150-03 MS/MSD) were above the method control limits. These are flagged accordingly in the QC Summary Report. The associated LCS was within method control limits. No further corrective actions were taken.

For DRO Analysis, diesel hydrocarbons were detected below the reporting limit for Method Blank-54818. The associated samples may be biased high. No further corrective action was taken.

METALS ANALYSIS

For Metals Analysis, the recoveries of a few analytes for the Matrix Spike and Matrix Spike Duplicate (1211176-03 MS/MSD) were outside of the method control limits. These are flagged accordingly in the QC Summary report. These elements are within method control limits in the associated LCS. The reference sample selected for the QC sample was from this work order. No further corrective actions were taken.

CLIENT: Larson & Associates
Project: R360-Artesia Aeration Landfarm
Lab Order: 1211199

CASE NARRATIVE

For Metals Analysis, the RPD's of three analytes for the Serial Dilution (1211176-03 SD) were above the method control limit. These are flagged accordingly in the QC Summary Report. These analytes are within method control limits in the associated Post Digestion Spike. No further corrective actions were taken.

For Metals Analysis, performed on 11/29/12 and 11/30/12, the recoveries of a couple of analytes for various Low Calibration Verifications Level were outside of the method control limits. The associated samples have greater than 10x the amount detected in the LCVL and the recoveries of these analytes are within method control limits in the associated CCV's. No further corrective action was taken.

CLIENT: Larson & Associates
Project: R360-Artesia Aeration Landfarm
Lab Order: 1211199

Work Order Sample Summary

Lab Smp ID	Client Sample ID	Tag Number	Date Collected	Date Recved
1211199-01	C-1 (2-3')		11/19/12 12:10 PM	11/21/2012
1211199-02	C-2 (2-3')		11/19/12 12:40 PM	11/21/2012
1211199-03	C-3 (2-3')		11/19/12 01:05 PM	11/21/2012
1211199-04	C-4 (2-3')		11/19/12 01:25 PM	11/21/2012
1211199-05	C-5 (2-3')		11/19/12 01:45 PM	11/21/2012
1211199-06	C-6 (2-3')		11/19/12 02:05 PM	11/21/2012

DHL Analytical, Inc.

03-Dec-12

Lab Order: 1211199
Client: Larson & Associates
Project: R360-Artesia Aeration Landfarm

PREP DATES REPORT

Sample ID	Client Sample ID	Collection Date	Matrix	Test Number	Test Name	Prep Date	Batch ID
1211199-01A	C-1 (2-3')	11/19/12 12:10 PM	Soil	USDA 60	1:5 Water Extract	11/27/12 09:38 AM	54879
	C-1 (2-3')	11/19/12 12:10 PM	Soil	SW9056A	Anion Prep	11/27/12 09:37 AM	54878
	C-1 (2-3')	11/19/12 12:10 PM	Soil	SW5030A	Purge and Trap Soils GC	11/21/12 09:23 AM	54824
	C-1 (2-3')	11/19/12 12:10 PM	Soil	SW5030A	Purge and Trap Soils GC- Gas	11/26/12 11:48 AM	54862
1211199-01B	C-1 (2-3')	11/19/12 12:10 PM	Soil	SW7471A	Mercury Soil Prep, Total	11/27/12 09:00 AM	54836
	C-1 (2-3')	11/19/12 12:10 PM	Soil	D2216	Moisture Preparation	11/27/12 05:25 PM	54885
	C-1 (2-3')	11/19/12 12:10 PM	Soil	SW3050B	Soil Prep Total Metals: ICP-MS	11/26/12 09:00 AM	54804
	C-1 (2-3')	11/19/12 12:10 PM	Soil	SW3050B	Soil Prep Total Metals: ICP-MS	11/26/12 09:00 AM	54804
	C-1 (2-3')	11/19/12 12:10 PM	Soil	SW3050B	Soil Prep Total Metals: ICP-MS	11/26/12 09:00 AM	54804
1211199-01C	C-1 (2-3')	11/19/12 12:10 PM	Soil	SW3550C	Soil Prep Sonication: DRO	11/21/12 07:32 AM	54818
1211199-02A	C-2 (2-3')	11/19/12 12:40 PM	Soil	USDA 60	1:5 Water Extract	11/27/12 09:38 AM	54879
	C-2 (2-3')	11/19/12 12:40 PM	Soil	SW9056A	Anion Prep	11/27/12 09:37 AM	54878
	C-2 (2-3')	11/19/12 12:40 PM	Soil	SW5030A	Purge and Trap Soils GC	11/21/12 09:23 AM	54824
	C-2 (2-3')	11/19/12 12:40 PM	Soil	SW5030A	Purge and Trap Soils GC- Gas	11/26/12 11:48 AM	54862
1211199-02B	C-2 (2-3')	11/19/12 12:40 PM	Soil	SW7471A	Mercury Soil Prep, Total	11/27/12 09:00 AM	54836
	C-2 (2-3')	11/19/12 12:40 PM	Soil	D2216	Moisture Preparation	11/27/12 05:25 PM	54885
	C-2 (2-3')	11/19/12 12:40 PM	Soil	SW3050B	Soil Prep Total Metals: ICP-MS	11/26/12 09:00 AM	54804
	C-2 (2-3')	11/19/12 12:40 PM	Soil	SW3050B	Soil Prep Total Metals: ICP-MS	11/26/12 09:00 AM	54804
	C-2 (2-3')	11/19/12 12:40 PM	Soil	SW3050B	Soil Prep Total Metals: ICP-MS	11/26/12 09:00 AM	54804
1211199-02C	C-2 (2-3')	11/19/12 12:40 PM	Soil	SW3550C	Soil Prep Sonication: DRO	11/21/12 07:32 AM	54818
1211199-03A	C-3 (2-3')	11/19/12 01:05 PM	Soil	USDA 60	1:5 Water Extract	11/27/12 09:38 AM	54879
	C-3 (2-3')	11/19/12 01:05 PM	Soil	SW9056A	Anion Prep	11/27/12 09:37 AM	54878
	C-3 (2-3')	11/19/12 01:05 PM	Soil	SW5030A	Purge and Trap Soils GC	11/21/12 09:23 AM	54824
	C-3 (2-3')	11/19/12 01:05 PM	Soil	SW5030A	Purge and Trap Soils GC- Gas	11/26/12 11:48 AM	54862
1211199-03B	C-3 (2-3')	11/19/12 01:05 PM	Soil	SW7471A	Mercury Soil Prep, Total	11/27/12 09:00 AM	54836
	C-3 (2-3')	11/19/12 01:05 PM	Soil	D2216	Moisture Preparation	11/27/12 05:25 PM	54885
	C-3 (2-3')	11/19/12 01:05 PM	Soil	SW3050B	Soil Prep Total Metals: ICP-MS	11/26/12 09:00 AM	54804
	C-3 (2-3')	11/19/12 01:05 PM	Soil	SW3050B	Soil Prep Total Metals: ICP-MS	11/26/12 09:00 AM	54804

Lab Order: 1211199
 Client: Larson & Associates
 Project: R360-Artesia Aeration Landfarm

PREP DATES REPORT

Sample ID	Client Sample ID	Collection Date	Matrix	Test Number	Test Name	Prep Date	Batch ID
1211199-03B	C-3 (2-3')	11/19/12 01:05 PM	Soil	SW3050B	Soil Prep Total Metals: ICP-MS	11/26/12 09:00 AM	54804
1211199-03C	C-3 (2-3')	11/19/12 01:05 PM	Soil	SW3550C	Soil Prep Sonication: DRO	11/21/12 07:32 AM	54818
1211199-04A	C-4 (2-3')	11/19/12 01:25 PM	Soil	USDA 60	1:5 Water Extract	11/27/12 09:38 AM	54879
	C-4 (2-3')	11/19/12 01:25 PM	Soil	SW9056A	Anion Prep	11/27/12 09:37 AM	54878
	C-4 (2-3')	11/19/12 01:25 PM	Soil	SW5030A	Purge and Trap Soils GC	11/21/12 09:23 AM	54824
	C-4 (2-3')	11/19/12 01:25 PM	Soil	SW5030A	Purge and Trap Soils GC- Gas	11/26/12 11:48 AM	54862
1211199-04B	C-4 (2-3')	11/19/12 01:25 PM	Soil	SW7471A	Mercury Soil Prep, Total	11/27/12 09:00 AM	54836
	C-4 (2-3')	11/19/12 01:25 PM	Soil	D2216	Moisture Preparation	11/27/12 05:25 PM	54885
	C-4 (2-3')	11/19/12 01:25 PM	Soil	SW3050B	Soil Prep Total Metals: ICP-MS	11/26/12 09:00 AM	54804
	C-4 (2-3')	11/19/12 01:25 PM	Soil	SW3050B	Soil Prep Total Metals: ICP-MS	11/26/12 09:00 AM	54804
	C-4 (2-3')	11/19/12 01:25 PM	Soil	SW3050B	Soil Prep Total Metals: ICP-MS	11/26/12 09:00 AM	54804
1211199-04C	C-4 (2-3')	11/19/12 01:25 PM	Soil	SW3550C	Soil Prep Sonication: DRO	11/21/12 07:32 AM	54818
1211199-05A	C-5 (2-3')	11/19/12 01:45 PM	Soil	USDA 60	1:5 Water Extract	11/27/12 09:38 AM	54879
	C-5 (2-3')	11/19/12 01:45 PM	Soil	SW9056A	Anion Prep	11/27/12 09:37 AM	54878
	C-5 (2-3')	11/19/12 01:45 PM	Soil	SW5030A	Purge and Trap Soils GC	11/21/12 09:23 AM	54824
	C-5 (2-3')	11/19/12 01:45 PM	Soil	SW5030A	Purge and Trap Soils GC- Gas	11/26/12 11:48 AM	54862
1211199-05B	C-5 (2-3')	11/19/12 01:45 PM	Soil	SW7471A	Mercury Soil Prep, Total	11/27/12 09:00 AM	54836
	C-5 (2-3')	11/19/12 01:45 PM	Soil	D2216	Moisture Preparation	11/27/12 05:25 PM	54885
	C-5 (2-3')	11/19/12 01:45 PM	Soil	SW3050B	Soil Prep Total Metals: ICP-MS	11/26/12 09:00 AM	54804
	C-5 (2-3')	11/19/12 01:45 PM	Soil	SW3050B	Soil Prep Total Metals: ICP-MS	11/26/12 09:00 AM	54804
	C-5 (2-3')	11/19/12 01:45 PM	Soil	SW3050B	Soil Prep Total Metals: ICP-MS	11/26/12 09:00 AM	54804
1211199-05C	C-5 (2-3')	11/19/12 01:45 PM	Soil	SW3550C	Soil Prep Sonication: DRO	11/21/12 07:32 AM	54818
1211199-06A	C-6 (2-3')	11/19/12 02:05 PM	Soil	USDA 60	1:5 Water Extract	11/27/12 09:38 AM	54879
	C-6 (2-3')	11/19/12 02:05 PM	Soil	SW9056A	Anion Prep	11/27/12 09:37 AM	54878
	C-6 (2-3')	11/19/12 02:05 PM	Soil	SW5030A	Purge and Trap Soils GC	11/21/12 09:23 AM	54824
	C-6 (2-3')	11/19/12 02:05 PM	Soil	SW5030A	Purge and Trap Soils GC- Gas	11/26/12 11:48 AM	54862
1211199-06B	C-6 (2-3')	11/19/12 02:05 PM	Soil	SW7471A	Mercury Soil Prep, Total	11/27/12 09:00 AM	54836
	C-6 (2-3')	11/19/12 02:05 PM	Soil	D2216	Moisture Preparation	11/27/12 05:25 PM	54885

Lab Order: 1211199
Client: Larson & Associates
Project: R360-Artesia Aeration Landfarm

PREP DATES REPORT

Sample ID	Client Sample ID	Collection Date	Matrix	Test Number	Test Name	Prep Date	Batch ID
1211199-06B	C-6 (2-3')	11/19/12 02:05 PM	Soil	SW3050B	Soil Prep Total Metals: ICP-MS	11/26/12 09:00 AM	54804
	C-6 (2-3')	11/19/12 02:05 PM	Soil	SW3050B	Soil Prep Total Metals: ICP-MS	11/26/12 09:00 AM	54804
	C-6 (2-3')	11/19/12 02:05 PM	Soil	SW3050B	Soil Prep Total Metals: ICP-MS	11/26/12 09:00 AM	54804
1211199-06C	C-6 (2-3')	11/19/12 02:05 PM	Soil	SW3550C	Soil Prep Sonication: DRO	11/21/12 07:32 AM	54818

DHL Analytical, Inc.

03-Dec-12

Lab Order: 1211199
Client: Larson & Associates
Project: R360-Artesia Aeration Landfarm

ANALYTICAL DATES REPORT

Sample ID	Client Sample ID	Matrix	Test Number	Test Name	Batch ID	Dilution	Analysis Date	Run ID
1211199-01A	C-1 (2-3')	Soil	SW9056A	Anions by IC method - Soil	54878	1	11/28/12 10:09 AM	IC2_121128A
	C-1 (2-3')	Soil	M2320 B	Soluble Alkalinity of Soil	54879	1	11/29/12 11:52 AM	TITRATOR_121129A
	C-1 (2-3')	Soil	M8015V	TPH Purgeable by GC - Soil	54862	1	11/26/12 04:08 PM	GC4_121126A
	C-1 (2-3')	Soil	SW8021B	Volatile Organics by GC	54824	1	11/21/12 07:37 PM	GC4_121121B
1211199-01B	C-1 (2-3')	Soil	D2216	Percent Moisture	54885	1	11/28/12 09:20 AM	PMOIST_121127A
	C-1 (2-3')	Soil	SW7471B	Total Mercury: Soil/Solid	54836	1	11/28/12 11:51 AM	CETAC_HG_121128A
	C-1 (2-3')	Soil	SW6020A	Trace Metals: ICP-MS - Solid	54804	250	11/29/12 10:35 PM	ICP-MS2_121129A
	C-1 (2-3')	Soil	SW6020A	Trace Metals: ICP-MS - Solid	54804	5	11/30/12 02:23 AM	ICP-MS2_121129A
	C-1 (2-3')	Soil	SW6020A	Trace Metals: ICP-MS - Solid	54804	5	11/30/12 01:59 PM	ICP-MS2_121130B
1211199-01C	C-1 (2-3')	Soil	M8015D	TPH Extractable by GC - Soil	54818	1	11/26/12 03:39 PM	GC15_121126B
1211199-02A	C-2 (2-3')	Soil	SW9056A	Anions by IC method - Soil	54878	1	11/28/12 11:07 AM	IC2_121128A
	C-2 (2-3')	Soil	M2320 B	Soluble Alkalinity of Soil	54879	1	11/29/12 12:07 PM	TITRATOR_121129A
	C-2 (2-3')	Soil	M8015V	TPH Purgeable by GC - Soil	54862	1	11/26/12 04:33 PM	GC4_121126A
	C-2 (2-3')	Soil	SW8021B	Volatile Organics by GC	54824	1	11/21/12 08:02 PM	GC4_121121B
1211199-02B	C-2 (2-3')	Soil	D2216	Percent Moisture	54885	1	11/28/12 09:20 AM	PMOIST_121127A
	C-2 (2-3')	Soil	SW7471B	Total Mercury: Soil/Solid	54836	1	11/28/12 11:53 AM	CETAC_HG_121128A
	C-2 (2-3')	Soil	SW6020A	Trace Metals: ICP-MS - Solid	54804	5	11/30/12 02:29 AM	ICP-MS2_121129A
	C-2 (2-3')	Soil	SW6020A	Trace Metals: ICP-MS - Solid	54804	5	11/30/12 02:05 PM	ICP-MS2_121130B
	C-2 (2-3')	Soil	SW6020A	Trace Metals: ICP-MS - Solid	54804	250	11/29/12 10:41 PM	ICP-MS2_121129A
1211199-02C	C-2 (2-3')	Soil	M8015D	TPH Extractable by GC - Soil	54818	1	11/26/12 03:48 PM	GC15_121126B
1211199-03A	C-3 (2-3')	Soil	SW9056A	Anions by IC method - Soil	54878	1	11/28/12 11:21 AM	IC2_121128A
	C-3 (2-3')	Soil	M2320 B	Soluble Alkalinity of Soil	54879	1	11/29/12 12:14 PM	TITRATOR_121129A
	C-3 (2-3')	Soil	M8015V	TPH Purgeable by GC - Soil	54862	1	11/26/12 04:59 PM	GC4_121126A
	C-3 (2-3')	Soil	SW8021B	Volatile Organics by GC	54824	1	11/21/12 08:28 PM	GC4_121121B
1211199-03B	C-3 (2-3')	Soil	D2216	Percent Moisture	54885	1	11/28/12 09:20 AM	PMOIST_121127A
	C-3 (2-3')	Soil	SW7471B	Total Mercury: Soil/Solid	54836	1	11/28/12 11:55 AM	CETAC_HG_121128A
	C-3 (2-3')	Soil	SW6020A	Trace Metals: ICP-MS - Solid	54804	250	11/29/12 10:47 PM	ICP-MS2_121129A
	C-3 (2-3')	Soil	SW6020A	Trace Metals: ICP-MS - Solid	54804	5	11/30/12 02:35 AM	ICP-MS2_121129A

DHL Analytical, Inc.

03-Dec-12

Lab Order: 1211199
Client: Larson & Associates
Project: R360-Artesia Aeration Landfarm

ANALYTICAL DATES REPORT

Sample ID	Client Sample ID	Matrix	Test Number	Test Name	Batch ID	Dilution	Analysis Date	Run ID
1211199-03B	C-3 (2-3')	Soil	SW6020A	Trace Metals: ICP-MS - Solid	54804	5	11/30/12 02:10 PM	ICP-MS2_121130B
1211199-03C	C-3 (2-3')	Soil	M8015D	TPH Extractable by GC - Soil	54818	1	11/26/12 03:57 PM	GC15_121126B
1211199-04A	C-4 (2-3')	Soil	SW9056A	Anions by IC method - Soil	54878	1	11/28/12 11:36 AM	IC2_121128A
	C-4 (2-3')	Soil	M2320 B	Soluble Alkalinity of Soil	54879	1	11/29/12 12:16 PM	TITRATOR_121129A
	C-4 (2-3')	Soil	M8015V	TPH Purgeable by GC - Soil	54862	1	11/26/12 05:25 PM	GC4_121126A
	C-4 (2-3')	Soil	SW8021B	Volatile Organics by GC	54824	1	11/21/12 08:54 PM	GC4_121121B
1211199-04B	C-4 (2-3')	Soil	D2216	Percent Moisture	54885	1	11/28/12 09:20 AM	PMOIST_121127A
	C-4 (2-3')	Soil	SW7471B	Total Mercury: Soil/Solid	54836	1	11/28/12 11:58 AM	CETAC_HG_121128A
	C-4 (2-3')	Soil	SW6020A	Trace Metals: ICP-MS - Solid	54804	250	11/29/12 10:53 PM	ICP-MS2_121129A
	C-4 (2-3')	Soil	SW6020A	Trace Metals: ICP-MS - Solid	54804	5	11/30/12 02:40 AM	ICP-MS2_121129A
	C-4 (2-3')	Soil	SW6020A	Trace Metals: ICP-MS - Solid	54804	5	11/30/12 02:16 PM	ICP-MS2_121130B
1211199-04C	C-4 (2-3')	Soil	M8015D	TPH Extractable by GC - Soil	54818	1	11/26/12 04:06 PM	GC15_121126B
1211199-05A	C-5 (2-3')	Soil	SW9056A	Anions by IC method - Soil	54878	10	11/28/12 02:17 PM	IC2_121128A
	C-5 (2-3')	Soil	M2320 B	Soluble Alkalinity of Soil	54879	1	11/29/12 12:21 PM	TITRATOR_121129A
	C-5 (2-3')	Soil	M8015V	TPH Purgeable by GC - Soil	54862	1	11/26/12 05:50 PM	GC4_121126A
	C-5 (2-3')	Soil	SW8021B	Volatile Organics by GC	54824	1	11/21/12 09:18 PM	GC4_121121B
1211199-05B	C-5 (2-3')	Soil	D2216	Percent Moisture	54885	1	11/28/12 09:20 AM	PMOIST_121127A
	C-5 (2-3')	Soil	SW7471B	Total Mercury: Soil/Solid	54836	1	11/28/12 12:00 PM	CETAC_HG_121128A
	C-5 (2-3')	Soil	SW6020A	Trace Metals: ICP-MS - Solid	54804	5	11/30/12 02:46 AM	ICP-MS2_121129A
	C-5 (2-3')	Soil	SW6020A	Trace Metals: ICP-MS - Solid	54804	5	11/30/12 02:22 PM	ICP-MS2_121130B
1211199-05C	C-5 (2-3')	Soil	SW6020A	Trace Metals: ICP-MS - Solid	54804	250	11/29/12 10:59 PM	ICP-MS2_121129A
1211199-06A	C-6 (2-3')	Soil	M8015D	TPH Extractable by GC - Soil	54818	1	11/26/12 04:24 PM	GC15_121126B
	C-6 (2-3')	Soil	SW9056A	Anions by IC method - Soil	54878	1	11/28/12 02:32 PM	IC2_121128A
	C-6 (2-3')	Soil	M2320 B	Soluble Alkalinity of Soil	54879	1	11/29/12 12:24 PM	TITRATOR_121129A
	C-6 (2-3')	Soil	M8015V	TPH Purgeable by GC - Soil	54862	1	11/26/12 06:15 PM	GC4_121126A
	C-6 (2-3')	Soil	SW8021B	Volatile Organics by GC	54824	1	11/21/12 09:44 PM	GC4_121121B
1211199-06B	C-6 (2-3')	Soil	D2216	Percent Moisture	54885	1	11/28/12 09:20 AM	PMOIST_121127A
	C-6 (2-3')	Soil	SW7471B	Total Mercury: Soil/Solid	54836	1	11/28/12 11:37 AM	CETAC_HG_121128A

Lab Order: 1211199
Client: Larson & Associates
Project: R360-Artesia Aeration Landfarm

ANALYTICAL DATES REPORT

Sample ID	Client Sample ID	Matrix	Test Number	Test Name	Batch ID	Dilution	Analysis Date	Run ID
1211199-06B	C-6 (2-3')	Soil	SW6020A	Trace Metals: ICP-MS - Solid	54804	250	11/29/12 11:05 PM	ICP-MS2_121129A
	C-6 (2-3')	Soil	SW6020A	Trace Metals: ICP-MS - Solid	54804	5	11/30/12 02:52 AM	ICP-MS2_121129A
	C-6 (2-3')	Soil	SW6020A	Trace Metals: ICP-MS - Solid	54804	5	11/30/12 02:28 PM	ICP-MS2_121130B
1211199-06C	C-6 (2-3')	Soil	M8015D	TPH Extractable by GC - Soil	54818	1	11/26/12 04:15 PM	GC15_121126B

DHL Analytical, Inc.

Date: 03-Dec-12

CLIENT: Larson & Associates
Project: R360-Artesia Aeration Landfarm
Project No: 11-0109-06
Lab Order: 1211199

Client Sample ID: C-1 (2-3')
Lab ID: 1211199-01
Collection Date: 11/19/12 12:10 PM
Matrix: SOIL

Analyses	Result	MDL	RL	Qual	Units	DF	Date Analyzed
TPH EXTRACTABLE BY GC - SOIL		M8015D					Analyst: DO
TPH-DRO C10-C28	7.80	3.16	10.5	J	mg/Kg-dry	1	11/26/12 03:39 PM
Surr: Isopropylbenzene	70.7	0	47-142		%REC	1	11/26/12 03:39 PM
Surr: Octacosane	127	0	25-162		%REC	1	11/26/12 03:39 PM
TPH PURGEABLE BY GC - SOIL		M8015V					Analyst: DEW
Gasoline Range Organics	ND	0.102	0.204		mg/Kg-dry	1	11/26/12 04:08 PM
Surr: Tetrachlorethene	107	0	70-134		%REC	1	11/26/12 04:08 PM
VOLATILE ORGANICS BY GC		SW8021B					Analyst: DEW
Benzene	ND	0.00286	0.00477		mg/Kg-dry	1	11/21/12 07:37 PM
Ethylbenzene	ND	0.00477	0.0143		mg/Kg-dry	1	11/21/12 07:37 PM
Toluene	ND	0.00477	0.0143		mg/Kg-dry	1	11/21/12 07:37 PM
Xylenes, Total	ND	0.00477	0.0143		mg/Kg-dry	1	11/21/12 07:37 PM
Surr: Tetrachloroethene	103	0	79-135		%REC	1	11/21/12 07:37 PM
TOTAL MERCURY: SOIL/SOLID		SW7471B					Analyst: LM
Mercury	ND	0.0142	0.0354		mg/Kg-dry	1	11/28/12 11:51 AM
TRACE METALS: ICP-MS - SOLID		SW6020A					Analyst: SW
Arsenic	2.31	0.525	1.05		mg/Kg-dry	5	11/30/12 02:23 AM
Barium	174	26.2	105		mg/Kg-dry	250	11/29/12 10:35 PM
Cadmium	ND	0.105	0.315		mg/Kg-dry	5	11/30/12 02:23 AM
Calcium	149000	656	656		mg/Kg-dry	250	11/29/12 10:35 PM
Chromium	5.53	0.525	2.10		mg/Kg-dry	5	11/30/12 02:23 AM
Lead	2.82	0.105	0.315		mg/Kg-dry	5	11/30/12 01:59 PM
Magnesium	2730	656	656		mg/Kg-dry	250	11/29/12 10:35 PM
Potassium	1590	656	656		mg/Kg-dry	250	11/29/12 10:35 PM
Selenium	0.398	0.157	0.525	J	mg/Kg-dry	5	11/30/12 01:59 PM
Silver	ND	0.105	0.210		mg/Kg-dry	5	11/30/12 02:23 AM
Sodium	75.5	13.1	13.1		mg/Kg-dry	5	11/30/12 02:23 AM
ANIONS BY IC METHOD - SOIL		SW9056A					Analyst: JBC
Chloride	7.51	5.30	5.30		mg/Kg-dry	1	11/28/12 10:09 AM
Sulfate	19.6	10.6	10.6		mg/Kg-dry	1	11/28/12 10:09 AM
SOLUBLE ALKALINITY OF SOIL		M2320 B					Analyst: JBC
Alkalinity, Bicarbonate (As CaCO3)	590	52.7	52.7		mg/L-dry	1	11/29/12 11:52 AM
Alkalinity, Carbonate (As CaCO3)	219	52.7	52.7		mg/L-dry	1	11/29/12 11:52 AM
Alkalinity, Hydroxide (As CaCO3)	ND	52.7	52.7		mg/L-dry	1	11/29/12 11:52 AM
Alkalinity, Total (As CaCO3)	809	52.7	52.7		mg/L-dry	1	11/29/12 11:52 AM

Qualifiers:

- * Value exceeds TCLP Maximum Concentration Level
- C Sample Result or QC discussed in the Case Narrative
- E TPH pattern not Gas or Diesel Range Pattern
- MDL Method Detection Limit
- RL Reporting Limit
- N Parameter not NELAC certified
- B Analyte detected in the associated Method Blank
- DF Dilution Factor
- J Analyte detected between MDL and RL
- ND Not Detected at the Method Detection Limit
- S Spike Recovery outside control limits

DHL Analytical, Inc.

Date: 03-Dec-12

CLIENT:	Larson & Associates	Client Sample ID:	C-1 (2-3')
Project:	R360-Artesia Aeration Landfarm	Lab ID:	1211199-01
Project No:	11-0109-06	Collection Date:	11/19/12 12:10 PM
Lab Order:	1211199	Matrix:	SOIL

Analyses	Result	MDL	RL	Qual	Units	DF	Date Analyzed
PERCENT MOISTURE		D2216					Analyst: MK
Percent Moisture	5.68	0	0		WT%	1	11/28/12 09:20 AM

Qualifiers:	* Value exceeds TCLP Maximum Concentration Level	B Analyte detected in the associated Method Blank
	C Sample Result or QC discussed in the Case Narrative	DF Dilution Factor
	E TPH pattern not Gas or Diesel Range Pattern	J Analyte detected between MDL and RL
	MDL Method Detection Limit	ND Not Detected at the Method Detection Limit
	RL Reporting Limit	S Spike Recovery outside control limits
	N Parameter not NELAC certified	

DHL Analytical, Inc.

Date: 03-Dec-12

CLIENT: Larson & Associates
Project: R360-Artesia Aeration Landfarm
Project No: 11-0109-06
Lab Order: 1211199

Client Sample ID: C-2 (2-3')
Lab ID: 1211199-02
Collection Date: 11/19/12 12:40 PM
Matrix: SOIL

Analyses	Result	MDL	RL	Qual	Units	DF	Date Analyzed
TPH EXTRACTABLE BY GC - SOIL		M8015D			Analyst: DO		
TPH-DRO C10-C28	9.71	3.21	10.7	J	mg/Kg-dry	1	11/26/12 03:48 PM
Surr: Isopropylbenzene	84.9	0	47-142		%REC	1	11/26/12 03:48 PM
Surr: Octacosane	147	0	25-162		%REC	1	11/26/12 03:48 PM
TPH PURGEABLE BY GC - SOIL		M8015V			Analyst: DEW		
Gasoline Range Organics	ND	0.106	0.212		mg/Kg-dry	1	11/26/12 04:33 PM
Surr: Tetrachlorethene	108	0	70-134		%REC	1	11/26/12 04:33 PM
VOLATILE ORGANICS BY GC		SW8021B			Analyst: DEW		
Benzene	ND	0.00313	0.00522		mg/Kg-dry	1	11/21/12 08:02 PM
Ethylbenzene	ND	0.00522	0.0157		mg/Kg-dry	1	11/21/12 08:02 PM
Toluene	ND	0.00522	0.0157		mg/Kg-dry	1	11/21/12 08:02 PM
Xylenes, Total	ND	0.00522	0.0157		mg/Kg-dry	1	11/21/12 08:02 PM
Surr: Tetrachloroethene	106	0	79-135		%REC	1	11/21/12 08:02 PM
TOTAL MERCURY: SOIL/SOLID		SW7471B			Analyst: LM		
Mercury	ND	0.0149	0.0371		mg/Kg-dry	1	11/28/12 11:53 AM
TRACE METALS: ICP-MS - SOLID		SW6020A			Analyst: SW		
Arsenic	3.67	0.517	1.03		mg/Kg-dry	5	11/30/12 02:29 AM
Barium	137	25.9	103		mg/Kg-dry	250	11/29/12 10:41 PM
Cadmium	ND	0.103	0.310		mg/Kg-dry	5	11/30/12 02:29 AM
Calcium	127000	647	647		mg/Kg-dry	250	11/29/12 10:41 PM
Chromium	8.23	0.517	2.07		mg/Kg-dry	5	11/30/12 02:29 AM
Lead	3.83	0.103	0.310		mg/Kg-dry	5	11/30/12 02:05 PM
Magnesium	3920	647	647		mg/Kg-dry	250	11/29/12 10:41 PM
Potassium	2430	647	647		mg/Kg-dry	250	11/29/12 10:41 PM
Selenium	0.455	0.155	0.517	J	mg/Kg-dry	5	11/30/12 02:05 PM
Silver	ND	0.103	0.207		mg/Kg-dry	5	11/30/12 02:29 AM
Sodium	906	647	647		mg/Kg-dry	250	11/29/12 10:41 PM
ANIONS BY IC METHOD - SOIL		SW9056A			Analyst: JBC		
Chloride	59.9	5.46	5.46		mg/Kg-dry	1	11/28/12 11:07 AM
Sulfate	320	10.9	10.9		mg/Kg-dry	1	11/28/12 11:07 AM
SOLUBLE ALKALINITY OF SOIL		M2320 B			Analyst: JBC		
Alkalinity, Bicarbonate (As CaCO3)	1130	54.7	54.7		mg/L-dry	1	11/29/12 12:07 PM
Alkalinity, Carbonate (As CaCO3)	246	54.7	54.7		mg/L-dry	1	11/29/12 12:07 PM
Alkalinity, Hydroxide (As CaCO3)	ND	54.7	54.7		mg/L-dry	1	11/29/12 12:07 PM
Alkalinity, Total (As CaCO3)	1380	54.7	54.7		mg/L-dry	1	11/29/12 12:07 PM

Qualifiers:

- * Value exceeds TCLP Maximum Concentration Level
- C Sample Result or QC discussed in the Case Narrative
- E TPH pattern not Gas or Diesel Range Pattern
- MDL Method Detection Limit
- RL Reporting Limit
- N Parameter not NELAC certified
- B Analyte detected in the associated Method Blank
- DF Dilution Factor
- J Analyte detected between MDL and RL
- ND Not Detected at the Method Detection Limit
- S Spike Recovery outside control limits

DHL Analytical, Inc.

Date: 03-Dec-12

CLIENT: Larson & Associates
Project: R360-Artesia Aeration Landfarm
Project No: 11-0109-06
Lab Order: 1211199

Client Sample ID: C-2 (2-3')
Lab ID: 1211199-02
Collection Date: 11/19/12 12:40 PM
Matrix: SOIL

Analyses	Result	MDL	RL	Qual	Units	DF	Date Analyzed
PERCENT MOISTURE		D2216					Analyst: MK
Percent Moisture	8.84	0	0		WT%	1	11/28/12 09:20 AM

- Qualifiers:**
- * Value exceeds TCLP Maximum Concentration Level
 - C Sample Result or QC discussed in the Case Narrative
 - E TPH pattern not Gas or Diesel Range Pattern
 - MDL Method Detection Limit
 - RL Reporting Limit
 - N Parameter not NELAC certified
 - B Analyte detected in the associated Method Blank
 - DF Dilution Factor
 - J Analyte detected between MDL and RL
 - ND Not Detected at the Method Detection Limit
 - S Spike Recovery outside control limits

DHL Analytical, Inc.

Date: 03-Dec-12

CLIENT: Larson & Associates
Project: R360-Artesia Aeration Landfarm
Project No: 11-0109-06
Lab Order: 1211199

Client Sample ID: C-3 (2-3')
Lab ID: 1211199-03
Collection Date: 11/19/12 01:05 PM
Matrix: SOIL

Analyses	Result	MDL	RL	Qual	Units	DF	Date Analyzed
TPH EXTRACTABLE BY GC - SOIL		M8015D					Analyst: DO
TPH-DRO C10-C28	9.42	2.95	9.83	J	mg/Kg-dry	1	11/26/12 03:57 PM
Surr: Isopropylbenzene	85.7	0	47-142		%REC	1	11/26/12 03:57 PM
Surr: Octacosane	151	0	25-162		%REC	1	11/26/12 03:57 PM
TPH PURGEABLE BY GC - SOIL		M8015V					Analyst: DEW
Gasoline Range Organics	ND	0.0910	0.182		mg/Kg-dry	1	11/26/12 04:59 PM
Surr: Tetrachlorethene	110	0	70-134		%REC	1	11/26/12 04:59 PM
VOLATILE ORGANICS BY GC		SW8021B					Analyst: DEW
Benzene	ND	0.00302	0.00503		mg/Kg-dry	1	11/21/12 08:28 PM
Ethylbenzene	ND	0.00503	0.0151		mg/Kg-dry	1	11/21/12 08:28 PM
Toluene	ND	0.00503	0.0151		mg/Kg-dry	1	11/21/12 08:28 PM
Xylenes, Total	ND	0.00503	0.0151		mg/Kg-dry	1	11/21/12 08:28 PM
Surr: Tetrachloroethene	97.3	0	79-135		%REC	1	11/21/12 08:28 PM
TOTAL MERCURY: SOIL/SOLID		SW7471B					Analyst: LM
Mercury	ND	0.0145	0.0362		mg/Kg-dry	1	11/28/12 11:55 AM
TRACE METALS: ICP-MS - SOLID		SW6020A					Analyst: SW
Arsenic	1.65	0.448	0.896		mg/Kg-dry	5	11/30/12 02:35 AM
Barium	40.7	0.448	1.79		mg/Kg-dry	5	11/30/12 02:35 AM
Cadmium	ND	0.0896	0.269		mg/Kg-dry	5	11/30/12 02:35 AM
Calcium	7710	560	560		mg/Kg-dry	250	11/29/12 10:47 PM
Chromium	5.78	0.448	1.79		mg/Kg-dry	5	11/30/12 02:35 AM
Lead	2.88	0.0896	0.269		mg/Kg-dry	5	11/30/12 02:35 AM
Magnesium	1360	560	560		mg/Kg-dry	250	11/29/12 10:47 PM
Potassium	1590	560	560		mg/Kg-dry	250	11/29/12 10:47 PM
Selenium	0.370	0.134	0.448	J	mg/Kg-dry	5	11/30/12 02:10 PM
Silver	ND	0.0896	0.179		mg/Kg-dry	5	11/30/12 02:35 AM
Sodium	964	560	560		mg/Kg-dry	250	11/29/12 10:47 PM
ANIONS BY IC METHOD - SOIL		SW9056A					Analyst: JBC
Chloride	181	5.11	5.11		mg/Kg-dry	1	11/28/12 11:21 AM
Sulfate	345	10.2	10.2		mg/Kg-dry	1	11/28/12 11:21 AM
SOLUBLE ALKALINITY OF SOIL		M2320 B					Analyst: JBC
Alkalinity, Bicarbonate (As CaCO3)	1040	50.7	50.7		mg/L-dry	1	11/29/12 12:14 PM
Alkalinity, Carbonate (As CaCO3)	427	50.7	50.7		mg/L-dry	1	11/29/12 12:14 PM
Alkalinity, Hydroxide (As CaCO3)	ND	50.7	50.7		mg/L-dry	1	11/29/12 12:14 PM
Alkalinity, Total (As CaCO3)	1470	50.7	50.7		mg/L-dry	1	11/29/12 12:14 PM

Qualifiers:

*	Value exceeds TCLP Maximum Concentration Level	B	Analyte detected in the associated Method Blank
C	Sample Result or QC discussed in the Case Narrative	DF	Dilution Factor
E	TPH pattern not Gas or Diesel Range Pattern	J	Analyte detected between MDL and RL
MDL	Method Detection Limit	ND	Not Detected at the Method Detection Limit
RL	Reporting Limit	S	Spike Recovery outside control limits
N	Parameter not NELAC certified		

DHL Analytical, Inc.

Date: 03-Dec-12

CLIENT: Larson & Associates
Project: R360-Artesia Aeration Landfarm
Project No: 11-0109-06
Lab Order: 1211199

Client Sample ID: C-3 (2-3')
Lab ID: 1211199-03
Collection Date: 11/19/12 01:05 PM
Matrix: SOIL

Analyses	Result	MDL	RL	Qual	Units	DF	Date Analyzed
PERCENT MOISTURE		D2216					Analyst: MK
Percent Moisture	2.98	0	0		WT%	1	11/28/12 09:20 AM

- Qualifiers:**
- * Value exceeds TCLP Maximum Concentration Level
 - C Sample Result or QC discussed in the Case Narrative
 - E TPH pattern not Gas or Diesel Range Pattern
 - MDL Method Detection Limit
 - RL Reporting Limit
 - N Parameter not NELAC certified
 - B Analyte detected in the associated Method Blank
 - DF Dilution Factor
 - J Analyte detected between MDL and RL
 - ND Not Detected at the Method Detection Limit
 - S Spike Recovery outside control limits

DHL Analytical, Inc.

Date: 03-Dec-12

CLIENT: Larson & Associates
Project: R360-Artesia Aeration Landfarm
Project No: 11-0109-06
Lab Order: 1211199

Client Sample ID: C-4 (2-3')
Lab ID: 1211199-04
Collection Date: 11/19/12 01:25 PM
Matrix: SOIL

Analyses	Result	MDL	RL	Qual	Units	DF	Date Analyzed
TPH EXTRACTABLE BY GC - SOIL		M8015D					Analyst: DO
TPH-DRO C10-C28	7.82	2.85	9.49	J	mg/Kg-dry	1	11/26/12 04:06 PM
Surr: Isopropylbenzene	84.0	0	47-142		%REC	1	11/26/12 04:06 PM
Surr: Octacosane	146	0	25-162		%REC	1	11/26/12 04:06 PM
TPH PURGEABLE BY GC - SOIL		M8015V					Analyst: DEW
Gasoline Range Organics	ND	0.0990	0.198		mg/Kg-dry	1	11/26/12 05:25 PM
Surr: Tetrachlorethene	98.6	0	70-134		%REC	1	11/26/12 05:25 PM
VOLATILE ORGANICS BY GC		SW8021B					Analyst: DEW
Benzene	ND	0.00275	0.00458		mg/Kg-dry	1	11/21/12 08:54 PM
Ethylbenzene	ND	0.00458	0.0137		mg/Kg-dry	1	11/21/12 08:54 PM
Toluene	ND	0.00458	0.0137		mg/Kg-dry	1	11/21/12 08:54 PM
Xylenes, Total	ND	0.00458	0.0137		mg/Kg-dry	1	11/21/12 08:54 PM
Surr: Tetrachloroethene	96.6	0	79-135		%REC	1	11/21/12 08:54 PM
TOTAL MERCURY: SOIL/SOLID		SW7471B					Analyst: LM
Mercury	ND	0.0148	0.0369		mg/Kg-dry	1	11/28/12 11:58 AM
TRACE METALS: ICP-MS - SOLID		SW6020A					Analyst: SW
Arsenic	1.02	0.454	0.909		mg/Kg-dry	5	11/30/12 02:40 AM
Barium	16.4	0.454	1.82		mg/Kg-dry	5	11/30/12 02:40 AM
Cadmium	ND	0.0909	0.273		mg/Kg-dry	5	11/30/12 02:40 AM
Calcium	525	11.4	11.4		mg/Kg-dry	5	11/30/12 02:40 AM
Chromium	4.21	0.454	1.82		mg/Kg-dry	5	11/30/12 02:40 AM
Lead	2.08	0.0909	0.273		mg/Kg-dry	5	11/30/12 02:40 AM
Magnesium	814	568	568		mg/Kg-dry	250	11/29/12 10:53 PM
Potassium	1020	568	568		mg/Kg-dry	250	11/29/12 10:53 PM
Selenium	0.245	0.136	0.454	J	mg/Kg-dry	5	11/30/12 02:16 PM
Silver	ND	0.0909	0.182		mg/Kg-dry	5	11/30/12 02:40 AM
Sodium	75.0	11.4	11.4		mg/Kg-dry	5	11/30/12 02:40 AM
ANIONS BY IC METHOD - SOIL		SW9056A					Analyst: JBC
Chloride	72.1	5.09	5.09		mg/Kg-dry	1	11/28/12 11:36 AM
Sulfate	77.6	10.2	10.2		mg/Kg-dry	1	11/28/12 11:36 AM
SOLUBLE ALKALINITY OF SOIL		M2320 B					Analyst: JBC
Alkalinity, Bicarbonate (As CaCO3)	71.0	50.3	50.3		mg/L-dry	1	11/29/12 12:16 PM
Alkalinity, Carbonate (As CaCO3)	ND	50.3	50.3		mg/L-dry	1	11/29/12 12:16 PM
Alkalinity, Hydroxide (As CaCO3)	ND	50.3	50.3		mg/L-dry	1	11/29/12 12:16 PM
Alkalinity, Total (As CaCO3)	71.0	50.3	50.3		mg/L-dry	1	11/29/12 12:16 PM

Qualifiers: * Value exceeds TCLP Maximum Concentration Level
C Sample Result or QC discussed in the Case Narrative
E TPH pattern not Gas or Diesel Range Pattern
MDL Method Detection Limit
RL Reporting Limit
N Parameter not NELAC certified
B Analyte detected in the associated Method Blank
DF Dilution Factor
J Analyte detected between MDL and RL
ND Not Detected at the Method Detection Limit
S Spike Recovery outside control limits

DHL Analytical, Inc.

Date: 03-Dec-12

CLIENT: Larson & Associates	Client Sample ID: C-4 (2-3')
Project: R360-Artesia Aeration Landfarm	Lab ID: 1211199-04
Project No: 11-0109-06	Collection Date: 11/19/12 01:25 PM
Lab Order: 1211199	Matrix: SOIL

Analyses	Result	MDL	RL	Qual	Units	DF	Date Analyzed
PERCENT MOISTURE		D2216					Analyst: MK
Percent Moisture	1.77	0	0		WT%	1	11/28/12 09:20 AM

- | | | |
|--------------------|---|---|
| Qualifiers: | * Value exceeds TCLP Maximum Concentration Level | B Analyte detected in the associated Method Blank |
| | C Sample Result or QC discussed in the Case Narrative | DF Dilution Factor |
| | E TPH pattern not Gas or Diesel Range Pattern | J Analyte detected between MDL and RL |
| | MDL Method Detection Limit | ND Not Detected at the Method Detection Limit |
| | RL Reporting Limit | S Spike Recovery outside control limits |
| | N Parameter not NELAC certified | |

DHL Analytical, Inc.

Date: 03-Dec-12

CLIENT: Larson & Associates
Project: R360-Artesia Aeration Landfarm
Project No: 11-0109-06
Lab Order: 1211199

Client Sample ID: C-5 (2-3')
Lab ID: 1211199-05
Collection Date: 11/19/12 01:45 PM
Matrix: SOIL

Analyses	Result	MDL	RL	Qual	Units	DF	Date Analyzed
TPH EXTRACTABLE BY GC - SOIL							
		M8015D					Analyst: DO
TPH-DRO C10-C28	27.6	3.22	10.7		mg/Kg-dry	1	11/26/12 04:24 PM
Surr: Isopropylbenzene	59.5	0	47-142		%REC	1	11/26/12 04:24 PM
Surr: Octacosane	155	0	25-162		%REC	1	11/26/12 04:24 PM
TPH PURGEABLE BY GC - SOIL							
		M8015V					Analyst: DEW
Gasoline Range Organics	ND	0.108	0.217		mg/Kg-dry	1	11/26/12 05:50 PM
Surr: Tetrachlorethene	111	0	70-134		%REC	1	11/26/12 05:50 PM
VOLATILE ORGANICS BY GC							
		SW8021B					Analyst: DEW
Benzene	ND	0.00314	0.00523		mg/Kg-dry	1	11/21/12 09:18 PM
Ethylbenzene	ND	0.00523	0.0157		mg/Kg-dry	1	11/21/12 09:18 PM
Toluene	ND	0.00523	0.0157		mg/Kg-dry	1	11/21/12 09:18 PM
Xylenes, Total	ND	0.00523	0.0157		mg/Kg-dry	1	11/21/12 09:18 PM
Surr: Tetrachloroethene	107	0	79-135		%REC	1	11/21/12 09:18 PM
TOTAL MERCURY: SOIL/SOLID							
		SW7471B					Analyst: LM
Mercury	ND	0.0153	0.0383		mg/Kg-dry	1	11/28/12 12:00 PM
TRACE METALS: ICP-MS - SOLID							
		SW6020A					Analyst: SW
Arsenic	1.94	0.523	1.05		mg/Kg-dry	5	11/30/12 02:46 AM
Barium	605	26.1	105		mg/Kg-dry	250	11/29/12 10:59 PM
Cadmium	0.181	0.105	0.314	J	mg/Kg-dry	5	11/30/12 02:46 AM
Calcium	32100	654	654		mg/Kg-dry	250	11/29/12 10:59 PM
Chromium	7.19	0.523	2.09		mg/Kg-dry	5	11/30/12 02:46 AM
Lead	4.12	0.105	0.314		mg/Kg-dry	5	11/30/12 02:46 AM
Magnesium	2970	654	654		mg/Kg-dry	250	11/29/12 10:59 PM
Potassium	1600	654	654		mg/Kg-dry	250	11/29/12 10:59 PM
Selenium	0.453	0.157	0.523	J	mg/Kg-dry	5	11/30/12 02:22 PM
Silver	ND	0.105	0.209		mg/Kg-dry	5	11/30/12 02:46 AM
Sodium	2160	654	654		mg/Kg-dry	250	11/29/12 10:59 PM
ANIONS BY IC METHOD - SOIL							
		SW9056A					Analyst: JBC
Chloride	2020	55.0	55.0		mg/Kg-dry	10	11/28/12 02:17 PM
Sulfate	1770	110	110		mg/Kg-dry	10	11/28/12 02:17 PM
SOLUBLE ALKALINITY OF SOIL							
		M2320 B					Analyst: JBC
Alkalinity, Bicarbonate (As CaCO3)	438	55.4	55.4		mg/L-dry	1	11/29/12 12:21 PM
Alkalinity, Carbonate (As CaCO3)	124	55.4	55.4		mg/L-dry	1	11/29/12 12:21 PM
Alkalinity, Hydroxide (As CaCO3)	ND	55.4	55.4		mg/L-dry	1	11/29/12 12:21 PM
Alkalinity, Total (As CaCO3)	562	55.4	55.4		mg/L-dry	1	11/29/12 12:21 PM

Qualifiers:	* Value exceeds TCLP Maximum Concentration Level	B Analyte detected in the associated Method Blank
	C Sample Result or QC discussed in the Case Narrative	DF Dilution Factor
	E TPH pattern not Gas or Diesel Range Pattern	J Analyte detected between MDL and RL
	MDL Method Detection Limit	ND Not Detected at the Method Detection Limit
	RL Reporting Limit	S Spike Recovery outside control limits
	N Parameter not NELAC certified	

DHL Analytical, Inc.

Date: 03-Dec-12

CLIENT: Larson & Associates	Client Sample ID: C-5 (2-3')
Project: R360-Artesia Aeration Landfarm	Lab ID: 1211199-05
Project No: 11-0109-06	Collection Date: 11/19/12 01:45 PM
Lab Order: 1211199	Matrix: SOIL

Analyses	Result	MDL	RL	Qual	Units	DF	Date Analyzed
PERCENT MOISTURE		D2216					Analyst: MK
Percent Moisture	9.78	0	0		WT%	1	11/28/12 09:20 AM

- | | | |
|--------------------|---|---|
| Qualifiers: | * Value exceeds TCLP Maximum Concentration Level | B Analyte detected in the associated Method Blank |
| | C Sample Result or QC discussed in the Case Narrative | DF Dilution Factor |
| | E TPH pattern not Gas or Diesel Range Pattern | J Analyte detected between MDL and RL |
| | MDL Method Detection Limit | ND Not Detected at the Method Detection Limit |
| | RL Reporting Limit | S Spike Recovery outside control limits |
| | N Parameter not NELAC certified | |

DHL Analytical, Inc.

Date: 03-Dec-12

CLIENT: Larson & Associates
Project: R360-Artesia Aeration Landfarm
Project No: 11-0109-06
Lab Order: 1211199

Client Sample ID: C-6 (2-3')
Lab ID: 1211199-06
Collection Date: 11/19/12 02:05 PM
Matrix: SOIL

Analyses	Result	MDL	RL	Qual	Units	DF	Date Analyzed
TPH EXTRACTABLE BY GC - SOIL							
		M8015D					Analyst: DO
TPH-DRO C10-C28	14.1	3.00	10.0		mg/Kg-dry	1	11/26/12 04:15 PM
Surr: Isopropylbenzene	81.9	0	47-142		%REC	1	11/26/12 04:15 PM
Surr: Octacosane	199	0	25-162	S	%REC	1	11/26/12 04:15 PM
TPH PURGEABLE BY GC - SOIL							
		M8015V					Analyst: DEW
Gasoline Range Organics	ND	0.0959	0.192		mg/Kg-dry	1	11/26/12 06:15 PM
Surr: Tetrachlorethene	109	0	70-134		%REC	1	11/26/12 06:15 PM
VOLATILE ORGANICS BY GC							
		SW8021B					Analyst: DEW
Benzene	ND	0.00293	0.00488		mg/Kg-dry	1	11/21/12 09:44 PM
Ethylbenzene	ND	0.00488	0.0146		mg/Kg-dry	1	11/21/12 09:44 PM
Toluene	ND	0.00488	0.0146		mg/Kg-dry	1	11/21/12 09:44 PM
Xylenes, Total	ND	0.00488	0.0146		mg/Kg-dry	1	11/21/12 09:44 PM
Surr: Tetrachloroethene	101	0	79-135		%REC	1	11/21/12 09:44 PM
TOTAL MERCURY: SOIL/SOLID							
		SW7471B					Analyst: LM
Mercury	ND	0.0136	0.0341		mg/Kg-dry	1	11/28/12 11:37 AM
TRACE METALS: ICP-MS - SOLID							
		SW6020A					Analyst: SW
Arsenic	1.21	0.437	0.873		mg/Kg-dry	5	11/30/12 02:52 AM
Barium	19.4	0.437	1.75		mg/Kg-dry	5	11/30/12 02:52 AM
Cadmium	ND	0.0873	0.262		mg/Kg-dry	5	11/30/12 02:52 AM
Calcium	668	546	546		mg/Kg-dry	250	11/29/12 11:05 PM
Chromium	4.02	0.437	1.75		mg/Kg-dry	5	11/30/12 02:52 AM
Lead	2.15	0.0873	0.262		mg/Kg-dry	5	11/30/12 02:52 AM
Magnesium	663	546	546		mg/Kg-dry	250	11/29/12 11:05 PM
Potassium	884	546	546		mg/Kg-dry	250	11/29/12 11:05 PM
Selenium	0.276	0.131	0.437	J	mg/Kg-dry	5	11/30/12 02:28 PM
Silver	ND	0.0873	0.175		mg/Kg-dry	5	11/30/12 02:52 AM
Sodium	23.6	10.9	10.9		mg/Kg-dry	5	11/30/12 02:52 AM
ANIONS BY IC METHOD - SOIL							
		SW9056A					Analyst: JBC
Chloride	58.9	5.09	5.09		mg/Kg-dry	1	11/28/12 02:32 PM
Sulfate	22.5	10.2	10.2		mg/Kg-dry	1	11/28/12 02:32 PM
SOLUBLE ALKALINITY OF SOIL							
		M2320 B					Analyst: JBC
Alkalinity, Bicarbonate (As CaCO3)	84.7	50.4	50.4		mg/L-dry	1	11/29/12 12:24 PM
Alkalinity, Carbonate (As CaCO3)	ND	50.4	50.4		mg/L-dry	1	11/29/12 12:24 PM
Alkalinity, Hydroxide (As CaCO3)	ND	50.4	50.4		mg/L-dry	1	11/29/12 12:24 PM
Alkalinity, Total (As CaCO3)	84.7	50.4	50.4		mg/L-dry	1	11/29/12 12:24 PM

Qualifiers:

- * Value exceeds TCLP Maximum Concentration Level
- C Sample Result or QC discussed in the Case Narrative
- E TPH pattern not Gas or Diesel Range Pattern
- MDL Method Detection Limit
- RL Reporting Limit
- N Parameter not NELAC certified
- B Analyte detected in the associated Method Blank
- DF Dilution Factor
- J Analyte detected between MDL and RL
- ND Not Detected at the Method Detection Limit
- S Spike Recovery outside control limits

DHL Analytical, Inc.

Date: 03-Dec-12

CLIENT: Larson & Associates
Project: R360-Artesia Aeration Landfarm
Project No: 11-0109-06
Lab Order: 1211199

Client Sample ID: C-6 (2-3')
Lab ID: 1211199-06
Collection Date: 11/19/12 02:05 PM
Matrix: SOIL

Analyses	Result	MDL	RL	Qual	Units	DF	Date Analyzed
PERCENT MOISTURE		D2216					Analyst: MK
Percent Moisture	2.15	0	0		WT%	1	11/28/12 09:20 AM

- Qualifiers:**
- * Value exceeds TCLP Maximum Concentration Level
 - C Sample Result or QC discussed in the Case Narrative
 - E TPH pattern not Gas or Diesel Range Pattern
 - MDL Method Detection Limit
 - RL Reporting Limit
 - N Parameter not NELAC certified
 - B Analyte detected in the associated Method Blank
 - DF Dilution Factor
 - J Analyte detected between MDL and RL
 - ND Not Detected at the Method Detection Limit
 - S Spike Recovery outside control limits

CLIENT: Larson & Associates
Work Order: 1211199
Project: R360-Artesia Aeration Landfarm

ANALYTICAL QC SUMMARY REPORT

RunID: GC15_121126B

The QC data in batch 54818 applies to the following samples: 1211199-01C, 1211199-02C, 1211199-03C, 1211199-04C, 1211199-05C, 1211199-06C

Sample ID: LCS-54818	Batch ID: 54818	TestNo: M8015D	Units: mg/Kg							
SampType: LCS	Run ID: GC15_121126B	Analysis Date: 11/26/2012 3:12:47 PM	Prep Date: 11/21/2012							
Analyte	Result	RL	SPK value	Ref Val	%REC	LowLimit	HighLimit	%RPD	RPDLimit	Qual
TPH-DRO C10-C28	104	10.0	125.0	0	83.4	50	114			
Surr: Isopropylbenzene	5.08		7.500		67.8	47	142			
Surr: Octacosane	10.3		7.500		138	25	162			

Sample ID: MB-54818	Batch ID: 54818	TestNo: M8015D	Units: mg/Kg							
SampType: MBLK	Run ID: GC15_121126B	Analysis Date: 11/26/2012 3:30:45 PM	Prep Date: 11/21/2012							
Analyte	Result	RL	SPK value	Ref Val	%REC	LowLimit	HighLimit	%RPD	RPDLimit	Qual
TPH-DRO C10-C28	3.38	10.0								
Surr: Isopropylbenzene	6.05		7.500		80.7	47	142			
Surr: Octacosane	8.76		7.500		117	25	162			

Sample ID: 1211150-03BMS	Batch ID: 54818	TestNo: M8015D	Units: mg/Kg-dry							
SampType: MS	Run ID: GC15_121126B	Analysis Date: 11/26/2012 5:04:02 PM	Prep Date: 11/21/2012							
Analyte	Result	RL	SPK value	Ref Val	%REC	LowLimit	HighLimit	%RPD	RPDLimit	Qual
TPH-DRO C10-C28	1240	46.3	115.8	1295	-43.7	50	114			S
Surr: Isopropylbenzene	7.48		6.950		108	47	142			
Surr: Octacosane	20.5		6.950		295	25	162			S

Sample ID: 1211150-03BMSD	Batch ID: 54818	TestNo: M8015D	Units: mg/Kg-dry							
SampType: MSD	Run ID: GC15_121126B	Analysis Date: 11/26/2012 5:13:01 PM	Prep Date: 11/21/2012							
Analyte	Result	RL	SPK value	Ref Val	%REC	LowLimit	HighLimit	%RPD	RPDLimit	Qual
TPH-DRO C10-C28	1230	47.9	119.7	1295	-50.1	50	114	0.751	30	S
Surr: Isopropylbenzene	7.81		7.182		109	47	142	0	0	
Surr: Octacosane	18.6		7.182		259	25	162	0	0	S

Qualifiers: B Analyte detected in the associated Method Blank
 J Analyte detected between MDL and RL
 ND Not Detected at the Method Detection Limit
 RL Reporting Limit
 J Analyte detected between SDL and RL
 DF Dilution Factor
 MDL Method Detection Limit
 R RPD outside accepted control limits
 S Spike Recovery outside control limits
 N Parameter not NELAC certified

CLIENT: Larson & Associates
Work Order: 1211199
Project: R360-Artesia Aeration Landfarm

ANALYTICAL QC SUMMARY REPORT

RunID: GC15_121126B

Sample ID: ICV-121126 DRO	Batch ID: R63635	TestNo: M8015D	Units: mg/Kg
SampType: ICV	Run ID: GC15_121126B	Analysis Date: 11/26/2012 2:47:59 PM	Prep Date:

Analyte	Result	RL	SPK value	Ref Val	%REC	LowLimit	HighLimit	%RPD	RPDLimit	Qual
TPH-DRO C10-C28	275	10.0	250.0	0	110	80	120			
Surr: Isopropylbenzene	12.5		12.50		99.9	47	142			
Surr: Octacosane	14.4		12.50		116	25	162			

Sample ID: CCV1-121126	Batch ID: R63635	TestNo: M8015D	Units: mg/Kg
SampType: CCV	Run ID: GC15_121126B	Analysis Date: 11/26/2012 5:30:58 PM	Prep Date:

Analyte	Result	RL	SPK value	Ref Val	%REC	LowLimit	HighLimit	%RPD	RPDLimit	Qual
TPH-DRO C10-C28	252	10.0	250.0	0	101	80	120			
Surr: Isopropylbenzene	12.4		12.50		99.0	47	142			
Surr: Octacosane	15.5		12.50		124	25	162			

Qualifiers: B Analyte detected in the associated Method Blank J Analyte detected between MDL and RL ND Not Detected at the Method Detection Limit RL Reporting Limit J Analyte detected between SDL and RL	DF Dilution Factor MDL Method Detection Limit R RPD outside accepted control limits S Spike Recovery outside control limits N Parameter not NELAC certified
--	---

CLIENT: Larson & Associates
 Work Order: 1211199
 Project: R360-Artesia Aeration Landfarm

ANALYTICAL QC SUMMARY REPORT

RunID: GC4_121121B

The QC data in batch 54824 applies to the following samples: 1211199-01A, 1211199-02A, 1211199-03A, 1211199-04A, 1211199-05A, 1211199-06A

Sample ID: LCS-54824	Batch ID: 54824	TestNo: SW8021B	Units: mg/Kg
SampType: LCS	Run ID: GC4_121121B	Analysis Date: 11/21/2012 2:05:24 PM	Prep Date: 11/21/2012

Analyte	Result	RL	SPK value	Ref Val	%REC	LowLimit	HighLimit	%RPD	RPDLimit	Qual
Benzene	0.0923	0.00500	0.1000	0	92.3	65	113			
Toluene	0.0922	0.0150	0.1000	0	92.2	73	115			
Ethylbenzene	0.0957	0.0150	0.1000	0	95.7	74	118			
Xylenes, Total	0.286	0.0150	0.3000	0	95.2	73	119			
Surr: Tetrachloroethene	0.183		0.2000		91.3	79	135			

Sample ID: MB-54824	Batch ID: 54824	TestNo: SW8021B	Units: mg/Kg
SampType: MBLK	Run ID: GC4_121121B	Analysis Date: 11/21/2012 2:56:32 PM	Prep Date: 11/21/2012

Analyte	Result	RL	SPK value	Ref Val	%REC	LowLimit	HighLimit	%RPD	RPDLimit	Qual
Benzene	ND	0.00500								
Toluene	ND	0.0150								
Ethylbenzene	ND	0.0150								
Xylenes, Total	ND	0.0150								
Surr: Tetrachloroethene	0.182		0.2000		90.9	79	135			

Sample ID: 1211198-06AMS	Batch ID: 54824	TestNo: SW8021B	Units: mg/Kg-dry
SampType: MS	Run ID: GC4_121121B	Analysis Date: 11/21/2012 5:54:14 PM	Prep Date: 11/21/2012

Analyte	Result	RL	SPK value	Ref Val	%REC	LowLimit	HighLimit	%RPD	RPDLimit	Qual
Benzene	0.109	0.00509	0.1017	0	107	65	113			
Toluene	0.106	0.0153	0.1017	0	104	73	115			
Ethylbenzene	0.108	0.0153	0.1017	0	106	74	118			
Xylenes, Total	0.323	0.0153	0.3052	0	106	73	119			
Surr: Tetrachloroethene	0.208		0.2035		102	79	135			

Sample ID: 1211198-06AMSD	Batch ID: 54824	TestNo: SW8021B	Units: mg/Kg-dry
SampType: MSD	Run ID: GC4_121121B	Analysis Date: 11/21/2012 6:19:59 PM	Prep Date: 11/21/2012

Analyte	Result	RL	SPK value	Ref Val	%REC	LowLimit	HighLimit	%RPD	RPDLimit	Qual
Benzene	0.101	0.00473	0.09467	0	107	65	113	7.77	30	
Toluene	0.100	0.0142	0.09467	0	106	73	115	5.54	30	
Ethylbenzene	0.101	0.0142	0.09467	0	106	74	118	6.58	30	
Xylenes, Total	0.304	0.0142	0.2840	0	107	73	119	5.99	30	
Surr: Tetrachloroethene	0.196		0.1893		103	79	135	0	0	

Qualifiers: B Analyte detected in the associated Method Blank J Analyte detected between MDL and RL ND Not Detected at the Method Detection Limit RL Reporting Limit J Analyte detected between SDL and RL	DF Dilution Factor MDL Method Detection Limit R RPD outside accepted control limits S Spike Recovery outside control limits N Parameter not NELAC certified
--	---

CLIENT: Larson & Associates
Work Order: 1211199
Project: R360-Artesia Aeration Landfarm

ANALYTICAL QC SUMMARY REPORT

RunID: GC4_121121B

Sample ID: ICV-121121	Batch ID: R63599	TestNo: SW8021B	Units: mg/Kg
SampType: ICV	Run ID: GC4_121121B	Analysis Date: 11/21/2012 9:23:59 AM	Prep Date:

Analyte	Result	RL	SPK value	Ref Val	%REC	LowLimit	HighLimit	%RPD	RPDLimit	Qual
Benzene	0.182	0.00500	0.2000	0	91.1	80	120			
Toluene	0.177	0.0150	0.2000	0	88.3	80	120			
Ethylbenzene	0.179	0.0150	0.2000	0	89.3	80	120			
Xylenes, Total	0.537	0.0150	0.6000	0	89.6	80	120			
Surr: Tetrachloroethene	0.176		0.2000		88.0	79	135			

Sample ID: CCV2-121121	Batch ID: R63599	TestNo: SW8021B	Units: mg/Kg
SampType: CCV	Run ID: GC4_121121B	Analysis Date: 11/21/2012 6:46:12 PM	Prep Date:

Analyte	Result	RL	SPK value	Ref Val	%REC	LowLimit	HighLimit	%RPD	RPDLimit	Qual
Benzene	0.0985	0.00500	0.1000	0	98.5	80	120			
Toluene	0.0988	0.0150	0.1000	0	98.8	80	120			
Ethylbenzene	0.102	0.0150	0.1000	0	102	80	120			
Xylenes, Total	0.303	0.0150	0.3000	0	101	80	120			
Surr: Tetrachloroethene	0.182		0.2000		90.9	79	135			

Sample ID: CCV3-121121	Batch ID: R63599	TestNo: SW8021B	Units: mg/Kg
SampType: CCV	Run ID: GC4_121121B	Analysis Date: 11/21/2012 10:35:34 P	Prep Date:

Analyte	Result	RL	SPK value	Ref Val	%REC	LowLimit	HighLimit	%RPD	RPDLimit	Qual
Benzene	0.101	0.00500	0.1000	0	101	80	120			
Toluene	0.100	0.0150	0.1000	0	100	80	120			
Ethylbenzene	0.102	0.0150	0.1000	0	102	80	120			
Xylenes, Total	0.306	0.0150	0.3000	0	102	80	120			
Surr: Tetrachloroethene	0.196		0.2000		97.9	79	135			

Qualifiers: B Analyte detected in the associated Method Blank J Analyte detected between MDL and RL ND Not Detected at the Method Detection Limit RL Reporting Limit J Analyte detected between SDL and RL	DF Dilution Factor MDL Method Detection Limit R RPD outside accepted control limits S Spike Recovery outside control limits N Parameter not NELAC certified
--	---

CLIENT: Larson & Associates

Work Order: 1211199

Project: R360-Artesia Aeration Landfarm

ANALYTICAL QC SUMMARY REPORT

RunID: GC4_121126A

The QC data in batch 54862 applies to the following samples: 1211199-01A, 1211199-02A, 1211199-03A, 1211199-04A, 1211199-05A, 1211199-06A

Sample ID: LCS-54862	Batch ID: 54862	TestNo: M8015V	Units: mg/Kg
SampType: LCS	Run ID: GC4_121126A	Analysis Date: 11/26/2012 1:04:23 PM	Prep Date: 11/26/2012

Analyte	Result	RL	SPK value	Ref Val	%REC	LowLimit	HighLimit	%RPD	RPDLimit	Qual
Gasoline Range Organics	4.97	0.200	5.000	0	99.4	68	126			
Surr: Tetrachlorethene	0.407		0.4000		102	70	134			

Sample ID: MB-54862	Batch ID: 54862	TestNo: M8015V	Units: mg/Kg
SampType: MBLK	Run ID: GC4_121126A	Analysis Date: 11/26/2012 1:55:30 PM	Prep Date: 11/26/2012

Analyte	Result	RL	SPK value	Ref Val	%REC	LowLimit	HighLimit	%RPD	RPDLimit	Qual
Gasoline Range Organics	ND	0.200								
Surr: Tetrachlorethene	0.379		0.4000		94.7	70	134			

Sample ID: 1211199-06AMS	Batch ID: 54862	TestNo: M8015V	Units: mg/Kg-dry
SampType: MS	Run ID: GC4_121126A	Analysis Date: 11/26/2012 6:41:25 PM	Prep Date: 11/26/2012

Analyte	Result	RL	SPK value	Ref Val	%REC	LowLimit	HighLimit	%RPD	RPDLimit	Qual
Gasoline Range Organics	3.74	0.185	4.637	0	80.7	68	126			
Surr: Tetrachlorethene	0.371		0.3709		99.9	70	134			

Sample ID: 1211199-06AMSD	Batch ID: 54862	TestNo: M8015V	Units: mg/Kg-dry
SampType: MSD	Run ID: GC4_121126A	Analysis Date: 11/26/2012 7:07:16 PM	Prep Date: 11/26/2012

Analyte	Result	RL	SPK value	Ref Val	%REC	LowLimit	HighLimit	%RPD	RPDLimit	Qual
Gasoline Range Organics	4.25	0.202	5.049	0	84.2	68	126	12.7	30	
Surr: Tetrachlorethene	0.402		0.4039		99.5	70	134	0	0	

- Qualifiers:**
- B Analyte detected in the associated Method Blank
 - J Analyte detected between MDL and RL
 - ND Not Detected at the Method Detection Limit
 - RL Reporting Limit
 - J Analyte detected between SDL and RL
 - DF Dilution Factor
 - MDL Method Detection Limit
 - R RPD outside accepted control limits
 - S Spike Recovery outside control limits
 - N Parameter not NELAC certified

CLIENT: Larson & Associates
Work Order: 1211199
Project: R360-Artesia Aeration Landfarm

ANALYTICAL QC SUMMARY REPORT

RunID: GC4_121126A

Sample ID: ICV-121126	Batch ID: R63628	TestNo: M8015V	Units: mg/Kg							
SampType: ICV	Run ID: GC4_121126A	Analysis Date: 11/26/2012 12:39:16 P	Prep Date:							
Analyte	Result	RL	SPK value	Ref Val	%REC	LowLimit	HighLimit	%RPD	RPDLimit	Qual
Gasoline Range Organics	8.46	0.200	10.00	0	84.6	80	120			
Surr: Tetrachlorethene	0.390		0.4000		97.5	70	134			

Sample ID: CCV1-121126	Batch ID: R63628	TestNo: M8015V	Units: mg/Kg							
SampType: CCV	Run ID: GC4_121126A	Analysis Date: 11/26/2012 7:32:56 PM	Prep Date:							
Analyte	Result	RL	SPK value	Ref Val	%REC	LowLimit	HighLimit	%RPD	RPDLimit	Qual
Gasoline Range Organics	4.77	0.200	5.000	0	95.5	80	120			
Surr: Tetrachlorethene	0.377		0.4000		94.3	70	134			

Qualifiers:	B Analyte detected in the associated Method Blank J Analyte detected between MDL and RL ND Not Detected at the Method Detection Limit RL Reporting Limit J Analyte detected between SDL and RL	DF Dilution Factor MDL Method Detection Limit R RPD outside accepted control limits S Spike Recovery outside control limits N Parameter not NELAC certified
--------------------	---	--

CLIENT: Larson & Associates
 Work Order: 1211199
 Project: R360-Artesia Aeration Landfarm

ANALYTICAL QC SUMMARY REPORT

RunID: **CETAC_HG_121128A**

The QC data in batch 54836 applies to the following samples: 1211199-01B, 1211199-02B, 1211199-03B, 1211199-04B, 1211199-05B, 1211199-06B

Sample ID: MB-54836	Batch ID: 54836	TestNo: SW7471B	Units: mg/Kg
SampType: MBLK	Run ID: CETAC_HG_121128A	Analysis Date: 11/28/2012 10:55:36 A	Prep Date: 11/27/2012

Analyte	Result	RL	SPK value	Ref Val	%REC	LowLimit	HighLimit	%RPD	RPDLimit	Qual
Mercury	ND	0.0400								

Sample ID: LCS-54836	Batch ID: 54836	TestNo: SW7471B	Units: mg/Kg
SampType: LCS	Run ID: CETAC_HG_121128A	Analysis Date: 11/28/2012 11:01:43 A	Prep Date: 11/27/2012

Analyte	Result	RL	SPK value	Ref Val	%REC	LowLimit	HighLimit	%RPD	RPDLimit	Qual
Mercury	0.213	0.0400	0.2000	0	106	85	115			

Sample ID: LCSD-54836	Batch ID: 54836	TestNo: SW7471B	Units: mg/Kg
SampType: LCSD	Run ID: CETAC_HG_121128A	Analysis Date: 11/28/2012 11:03:44 A	Prep Date: 11/27/2012

Analyte	Result	RL	SPK value	Ref Val	%REC	LowLimit	HighLimit	%RPD	RPDLimit	Qual
Mercury	0.217	0.0400	0.2000	0	108	85	115	1.86	25	

Sample ID: 1211199-06B SD	Batch ID: 54836	TestNo: SW7471B	Units: mg/Kg-dry
SampType: SD	Run ID: CETAC_HG_121128A	Analysis Date: 11/28/2012 11:39:27 A	Prep Date: 11/27/2012

Analyte	Result	RL	SPK value	Ref Val	%REC	LowLimit	HighLimit	%RPD	RPDLimit	Qual
Mercury	0	0.170	0	0				0	10	

Sample ID: 1211199-06B PDS	Batch ID: 54836	TestNo: SW7471B	Units: mg/Kg-dry
SampType: PDS	Run ID: CETAC_HG_121128A	Analysis Date: 11/28/2012 11:45:39 A	Prep Date: 11/27/2012

Analyte	Result	RL	SPK value	Ref Val	%REC	LowLimit	HighLimit	%RPD	RPDLimit	Qual
Mercury	0.235	0.0341	0.2129	0	110	85	115			

Sample ID: 1211199-06B MS	Batch ID: 54836	TestNo: SW7471B	Units: mg/Kg-dry
SampType: MS	Run ID: CETAC_HG_121128A	Analysis Date: 11/28/2012 11:47:42 A	Prep Date: 11/27/2012

Analyte	Result	RL	SPK value	Ref Val	%REC	LowLimit	HighLimit	%RPD	RPDLimit	Qual
Mercury	0.196	0.0341	0.1704	0	115	80	120			

Sample ID: 1211199-06B MSD	Batch ID: 54836	TestNo: SW7471B	Units: mg/Kg-dry
SampType: MSD	Run ID: CETAC_HG_121128A	Analysis Date: 11/28/2012 11:49:45 A	Prep Date: 11/27/2012

Analyte	Result	RL	SPK value	Ref Val	%REC	LowLimit	HighLimit	%RPD	RPDLimit	Qual
Mercury	0.195	0.0343	0.1714	0	113	80	120	0.677	25	

Qualifiers: B Analyte detected in the associated Method Blank J Analyte detected between MDL and RL ND Not Detected at the Method Detection Limit RL Reporting Limit J Analyte detected between SDL and RL	DF Dilution Factor MDL Method Detection Limit R RPD outside accepted control limits S Spike Recovery outside control limits N Parameter not NELAC certified
--	---

CLIENT: Larson & Associates
Work Order: 1211199
Project: R360-Artesia Aeration Landfarm

ANALYTICAL QC SUMMARY REPORT

RunID: CETAC_HG_121128A

Sample ID: ICV-121128	Batch ID: R63662	TestNo: SW7471B	Units: mg/Kg							
SampType: ICV	Run ID: CETAC_HG_121128A	Analysis Date: 11/28/2012 10:49:28 A	Prep Date:							
Analyte	Result	RL	SPK value	Ref Val	%REC	LowLimit	HighLimit	%RPD	RPDLimit	Qual
Mercury	0.00421	0.0400	0.004000	0	105	90	110			

Sample ID: CCV1-121128	Batch ID: R63662	TestNo: SW7471B	Units: mg/Kg							
SampType: CCV	Run ID: CETAC_HG_121128A	Analysis Date: 11/28/2012 11:13:59 A	Prep Date:							
Analyte	Result	RL	SPK value	Ref Val	%REC	LowLimit	HighLimit	%RPD	RPDLimit	Qual
Mercury	0.00211	0.0400	0.002000	0	106	90	110			

Sample ID: CCV2-121128	Batch ID: R63662	TestNo: SW7471B	Units: mg/Kg							
SampType: CCV	Run ID: CETAC_HG_121128A	Analysis Date: 11/28/2012 11:41:31 A	Prep Date:							
Analyte	Result	RL	SPK value	Ref Val	%REC	LowLimit	HighLimit	%RPD	RPDLimit	Qual
Mercury	0.00218	0.0400	0.002000	0	109	90	110			

Sample ID: CCV3-121128	Batch ID: R63662	TestNo: SW7471B	Units: mg/Kg							
SampType: CCV	Run ID: CETAC_HG_121128A	Analysis Date: 11/28/2012 12:04:12 P	Prep Date:							
Analyte	Result	RL	SPK value	Ref Val	%REC	LowLimit	HighLimit	%RPD	RPDLimit	Qual
Mercury	0.00220	0.0400	0.002000	0	110	90	110			

Qualifiers: B Analyte detected in the associated Method Blank J Analyte detected between MDL and RL ND Not Detected at the Method Detection Limit RL Reporting Limit J Analyte detected between SDL and RL	DF Dilution Factor MDL Method Detection Limit R RPD outside accepted control limits S Spike Recovery outside control limits N Parameter not NELAC certified
--	---

CLIENT: Larson & Associates
Work Order: 1211199
Project: R360-Artesia Aeration Landfarm

ANALYTICAL QC SUMMARY REPORT

RunID: ICP-MS2_121129A

The QC data in batch 54804 applies to the following samples: 1211199-01B, 1211199-02B, 1211199-03B, 1211199-04B, 1211199-05B, 1211199-06B

Sample ID: MB-54804	Batch ID: 54804	TestNo: SW6020A	Units: mg/Kg
SampType: MBLK	Run ID: ICP-MS2_121129A	Analysis Date: 11/29/2012 11:36:00 A	Prep Date: 11/26/2012

Analyte	Result	RL	SPK value	Ref Val	%REC	LowLimit	HighLimit	%RPD	RPDLimit	Qual
Arsenic	ND	1.00								
Barium	ND	2.00								
Cadmium	ND	0.300								
Calcium	ND	12.5								
Chromium	ND	2.00								
Lead	ND	0.300								
Magnesium	ND	12.5								
Potassium	ND	12.5								
Selenium	ND	0.500								
Silver	ND	0.200								
Sodium	ND	12.5								

Sample ID: LCS-54804	Batch ID: 54804	TestNo: SW6020A	Units: mg/Kg
SampType: LCS	Run ID: ICP-MS2_121129A	Analysis Date: 11/29/2012 11:42:00 A	Prep Date: 11/26/2012

Analyte	Result	RL	SPK value	Ref Val	%REC	LowLimit	HighLimit	%RPD	RPDLimit	Qual
Arsenic	50.7	1.00	50.00	0	101	80	120			
Barium	49.2	2.00	50.00	0	98.3	80	120			
Cadmium	50.0	0.300	50.00	0	100	80	120			
Calcium	264	12.5	250.0	0	106	80	120			
Chromium	51.2	2.00	50.00	0	102	80	120			
Lead	48.8	0.300	50.00	0	97.7	80	120			
Magnesium	257	12.5	250.0	0	103	80	120			
Potassium	260	12.5	250.0	0	104	80	120			
Selenium	49.6	0.500	50.00	0	99.2	80	120			
Silver	49.5	0.200	50.00	0	99.0	80	120			
Sodium	254	12.5	250.0	0	101	80	120			

Sample ID: LCSD-54804	Batch ID: 54804	TestNo: SW6020A	Units: mg/Kg
SampType: LCSD	Run ID: ICP-MS2_121129A	Analysis Date: 11/29/2012 11:48:00 A	Prep Date: 11/26/2012

Analyte	Result	RL	SPK value	Ref Val	%REC	LowLimit	HighLimit	%RPD	RPDLimit	Qual
Arsenic	50.2	1.00	50.00	0	100	80	120	0.941	20	
Barium	48.4	2.00	50.00	0	96.9	80	120	1.43	20	
Cadmium	50.4	0.300	50.00	0	101	80	120	0.747	20	
Calcium	268	12.5	250.0	0	107	80	120	1.31	20	
Chromium	52.2	2.00	50.00	0	104	80	120	2.08	20	
Lead	49.8	0.300	50.00	0	99.5	80	120	1.83	20	
Magnesium	255	12.5	250.0	0	102	80	120	0.782	20	
Potassium	258	12.5	250.0	0	103	80	120	0.964	20	

Qualifiers: B Analyte detected in the associated Method Blank J Analyte detected between MDL and RL ND Not Detected at the Method Detection Limit RL Reporting Limit J Analyte detected between SDL and RL	DF Dilution Factor MDL Method Detection Limit R RPD outside accepted control limits S Spike Recovery outside control limits N Parameter not NELAC certified
--	---

CLIENT: Larson & Associates
 Work Order: 1211199
 Project: R360-Artesia Aeration Landfarm

ANALYTICAL QC SUMMARY REPORT

RunID: ICP-MS2_121129A

Sample ID: LCSD-54804	Batch ID: 54804	TestNo: SW6020A	Units: mg/Kg
SampType: LCSD	Run ID: ICP-MS2_121129A	Analysis Date: 11/29/2012 11:48:00 A	Prep Date: 11/26/2012

Analyte	Result	RL	SPK value	Ref Val	%REC	LowLimit	HighLimit	%RPD	RPDLimit	Qual
Selenium	48.8	0.500	50.00	0	97.6	80	120	1.58	20	
Silver	49.0	0.200	50.00	0	98.0	80	120	0.965	20	
Sodium	255	12.5	250.0	0	102	80	120	0.492	20	

Sample ID: 1211176-03C SD	Batch ID: 54804	TestNo: SW6020A	Units: mg/Kg-dry
SampType: SD	Run ID: ICP-MS2_121129A	Analysis Date: 11/29/2012 12:06:00 P	Prep Date: 11/26/2012

Analyte	Result	RL	SPK value	Ref Val	%REC	LowLimit	HighLimit	%RPD	RPDLimit	Qual
Arsenic	7.06	5.58	0	6.518				7.93	10	
Barium	58.9	11.2	0	59.29				0.732	10	
Cadmium	0	1.67	0	0.1431				0	10	
Lead	14.5	1.67	0	14.40				1.00	10	
Selenium	1.95	2.79	0	1.351				36.1	10	R
Silver	0	1.12	0	0				0	10	

Sample ID: 1211176-03C PDS	Batch ID: 54804	TestNo: SW6020A	Units: mg/Kg-dry
SampType: PDS	Run ID: ICP-MS2_121129A	Analysis Date: 11/29/2012 1:05:00 PM	Prep Date: 11/26/2012

Analyte	Result	RL	SPK value	Ref Val	%REC	LowLimit	HighLimit	%RPD	RPDLimit	Qual
Arsenic	56.8	1.12	55.78	6.518	90.2	80	120			
Barium	114	2.23	55.78	59.29	98.5	80	120			
Cadmium	51.6	0.335	55.78	0.1431	92.2	80	120			
Lead	66.8	0.335	55.78	14.40	93.9	80	120			
Selenium	49.5	0.558	55.78	1.351	86.3	80	120			
Silver	49.5	0.223	55.78	0	88.8	80	120			

Sample ID: 1211176-03C MS	Batch ID: 54804	TestNo: SW6020A	Units: mg/Kg-dry
SampType: MS	Run ID: ICP-MS2_121129A	Analysis Date: 11/29/2012 1:10:00 PM	Prep Date: 11/26/2012

Analyte	Result	RL	SPK value	Ref Val	%REC	LowLimit	HighLimit	%RPD	RPDLimit	Qual
Arsenic	57.6	1.12	55.78	6.518	91.6	80	120			
Barium	110	2.23	55.78	59.29	91.0	80	120			
Cadmium	54.1	0.335	55.78	0.1431	96.6	80	120			
Calcium	83400	13.9	278.9	84840	-520	80	120			S
Chromium	82.6	2.23	55.78	39.05	78.2	80	120			S
Lead	68.8	0.335	55.78	14.40	97.6	80	120			
Magnesium	3090	13.9	278.9	2730	130	80	120			S
Potassium	4210	13.9	278.9	3793	149	80	120			S
Selenium	50.0	0.558	55.78	1.351	87.2	80	120			
Silver	51.3	0.223	55.78	0	92.0	80	120			
Sodium	1090	13.9	278.9	911.5	63.2	80	120			S

Qualifiers: B Analyte detected in the associated Method Blank J Analyte detected between MDL and RL ND Not Detected at the Method Detection Limit RL Reporting Limit J Analyte detected between SDL and RL	DF Dilution Factor MDL Method Detection Limit R RPD outside accepted control limits S Spike Recovery outside control limits N Parameter not NELAC certified
--	---

CLIENT: Larson & Associates
 Work Order: 1211199
 Project: R360-Artesia Aeration Landfarm

ANALYTICAL QC SUMMARY REPORT

RunID: ICP-MS2_121129A

Sample ID: 1211176-03C MSD		Batch ID: 54804		TestNo: SW6020A		Units: mg/Kg-dry				
SampType: MSD		Run ID: ICP-MS2_121129A		Analysis Date: 11/29/2012 1:16:00 PM		Prep Date: 11/26/2012				
Analyte	Result	RL	SPK value	Ref Val	%REC	LowLimit	HighLimit	%RPD	RPDLimit	Qual
Arsenic	56.0	1.11	55.27	6.518	89.5	80	120	2.83	20	
Barium	123	2.21	55.27	59.29	116	80	120	11.4	20	
Cadmium	52.2	0.332	55.27	0.1431	94.2	80	120	3.43	20	
Calcium	82300	13.8	276.3	84840	-912	80	120	1.29	20	S
Chromium	81.4	2.21	55.27	39.05	76.7	80	120	1.50	20	S
Lead	67.5	0.332	55.27	14.40	96.1	80	120	1.90	20	
Magnesium	3060	13.8	276.3	2730	120	80	120	1.01	20	
Potassium	4180	13.8	276.3	3793	141	80	120	0.591	20	S
Selenium	49.5	0.553	55.27	1.351	87.2	80	120	0.977	20	
Silver	50.7	0.221	55.27	0	91.7	80	120	1.25	20	
Sodium	1070	13.8	276.3	911.5	58.0	80	120	1.49	20	S

Sample ID: 1211176-03C SD		Batch ID: 54804		TestNo: SW6020A		Units: mg/Kg-dry				
SampType: SD		Run ID: ICP-MS2_121129A		Analysis Date: 11/29/2012 10:29:00 P		Prep Date: 11/26/2012				
Analyte	Result	RL	SPK value	Ref Val	%REC	LowLimit	HighLimit	%RPD	RPDLimit	Qual
Calcium	118000	3490	0	119000				0.800	10	
Chromium	0	558	0	54.04				0	10	
Magnesium	4390	3490	0	3853				13.1	10	R
Potassium	5780	3490	0	5356				7.58	10	
Sodium	4710	3490	0	2028				79.7	10	R

Sample ID: 1211176-03C PDS		Batch ID: 54804		TestNo: SW6020A		Units: mg/Kg-dry				
SampType: PDS		Run ID: ICP-MS2_121129A		Analysis Date: 11/29/2012 11:11:00 P		Prep Date: 11/26/2012				
Analyte	Result	RL	SPK value	Ref Val	%REC	LowLimit	HighLimit	%RPD	RPDLimit	Qual
Calcium	183000	697	69730	119000	92.3	80	120			
Chromium	2740	112	2789	54.04	96.2	80	120			
Magnesium	68800	697	69730	3853	93.2	80	120			
Potassium	73200	697	69730	5356	97.3	80	120			
Sodium	66300	697	69730	2028	92.1	80	120			

Qualifiers: B Analyte detected in the associated Method Blank DF Dilution Factor
 J Analyte detected between MDL and RL MDL Method Detection Limit
 ND Not Detected at the Method Detection Limit R RPD outside accepted control limits
 RL Reporting Limit S Spike Recovery outside control limits
 J Analyte detected between SDL and RL N Parameter not NELAC certified

CLIENT: Larson & Associates
 Work Order: 1211199
 Project: R360-Artesia Aeration Landfarm

ANALYTICAL QC SUMMARY REPORT

RunID: ICP-MS2_121129A

Sample ID: LCVL-121129	Batch ID: R63678	TestNo: SW6020A	Units: mg/L							
SampType: LCVL	Run ID: ICP-MS2_121129A	Analysis Date: 11/29/2012 11:24:00 A	Prep Date:							
Analyte	Result	RL	SPK value	Ref Val	%REC	LowLimit	HighLimit	%RPD	RPDLimit	Qual
Arsenic	0.00529	0.00500	0.00500	0	106	70	130			
Barium	0.00489	0.0100	0.00500	0	97.8	70	130			
Cadmium	0.00108	0.00100	0.00100	0	108	70	130			
Calcium	0.0900	0.300	0.100	0	90.0	70	130			
Chromium	0.00528	0.00500	0.00500	0	106	70	130			
Lead	0.000970	0.00100	0.00100	0	97.0	70	130			
Magnesium	0.106	0.300	0.100	0	106	70	130			
Potassium	0.108	0.300	0.100	0	108	70	130			
Selenium	0.00544	0.00500	0.00500	0	109	70	130			
Silver	0.00193	0.00200	0.00200	0	96.7	70	130			
Sodium	0.0944	0.300	0.100	0	94.4	70	130			

Sample ID: CCV1-121129	Batch ID: R63678	TestNo: SW6020A	Units: mg/L							
SampType: CCV	Run ID: ICP-MS2_121129A	Analysis Date: 11/29/2012 1:28:00 PM	Prep Date:							
Analyte	Result	RL	SPK value	Ref Val	%REC	LowLimit	HighLimit	%RPD	RPDLimit	Qual
Arsenic	0.206	0.00500	0.200	0	103	90	110			
Barium	0.193	0.0100	0.200	0	96.4	90	110			
Cadmium	0.202	0.00100	0.200	0	101	90	110			
Calcium	5.24	0.300	5.00	0	105	90	110			
Chromium	0.204	0.00500	0.200	0	102	90	110			
Lead	0.193	0.00100	0.200	0	96.4	90	110			
Magnesium	5.14	0.300	5.00	0	103	90	110			
Potassium	5.22	0.300	5.00	0	104	90	110			
Selenium	0.212	0.00500	0.200	0	106	90	110			
Silver	0.191	0.00200	0.200	0	95.7	90	110			
Sodium	5.14	0.300	5.00	0	103	90	110			

Sample ID: LCVL1-121129	Batch ID: R63678	TestNo: SW6020A	Units: mg/L							
SampType: LCVL	Run ID: ICP-MS2_121129A	Analysis Date: 11/29/2012 1:46:00 PM	Prep Date:							
Analyte	Result	RL	SPK value	Ref Val	%REC	LowLimit	HighLimit	%RPD	RPDLimit	Qual
Arsenic	0.00532	0.00500	0.00500	0	106	70	130			
Barium	0.00497	0.0100	0.00500	0	99.3	70	130			
Cadmium	0.00108	0.00100	0.00100	0	108	70	130			
Calcium	0.144	0.300	0.100	0	144	70	130			S
Chromium	0.00523	0.00500	0.00500	0	105	70	130			
Lead	0.000972	0.00100	0.00100	0	97.2	70	130			
Magnesium	0.104	0.300	0.100	0	104	70	130			
Potassium	0.111	0.300	0.100	0	111	70	130			
Selenium	0.00582	0.00500	0.00500	0	116	70	130			

Qualifiers:

B	Analyte detected in the associated Method Blank	DF	Dilution Factor
J	Analyte detected between MDL and RL	MDL	Method Detection Limit
ND	Not Detected at the Method Detection Limit	R	RPD outside accepted control limits
RL	Reporting Limit	S	Spike Recovery outside control limits
J	Analyte detected between SDL and RL	N	Parameter not NELAC certified

CLIENT: Larson & Associates
 Work Order: 1211199
 Project: R360-Artesia Aeration Landfarm

ANALYTICAL QC SUMMARY REPORT

RunID: ICP-MS2_121129A

Sample ID: LCVL1-121129	Batch ID: R63678	TestNo: SW6020A	Units: mg/L
SampType: LCVL	Run ID: ICP-MS2_121129A	Analysis Date: 11/29/2012 1:46:00 PM	Prep Date:

Analyte	Result	RL	SPK value	Ref Val	%REC	LowLimit	HighLimit	%RPD	RPDLimit	Qual
Silver	0.00199	0.00200	0.00200	0	99.4	70	130			
Sodium	0.0830	0.300	0.100	0	83.0	70	130			

Sample ID: LCVL4-121129	Batch ID: R63678	TestNo: SW6020A	Units: mg/L
SampType: LCVL	Run ID: ICP-MS2_121129A	Analysis Date: 11/29/2012 9:41:00 PM	Prep Date:

Analyte	Result	RL	SPK value	Ref Val	%REC	LowLimit	HighLimit	%RPD	RPDLimit	Qual
Arsenic	0.00505	0.00500	0.00500	0	101	70	130			
Barium	0.00494	0.0100	0.00500	0	98.7	70	130			
Cadmium	0.00104	0.00100	0.00100	0	104	70	130			
Calcium	0.114	0.300	0.100	0	114	70	130			
Chromium	0.00510	0.00500	0.00500	0	102	70	130			
Lead	0.000971	0.00100	0.00100	0	97.1	70	130			
Magnesium	0.106	0.300	0.100	0	106	70	130			
Potassium	0.107	0.300	0.100	0	107	70	130			
Selenium	0.00579	0.00500	0.00500	0	116	70	130			
Silver	0.00189	0.00200	0.00200	0	94.6	70	130			
Sodium	0.188	0.300	0.100	0	188	70	130			S

Sample ID: CCV5-121129	Batch ID: R63678	TestNo: SW6020A	Units: mg/L
SampType: CCV	Run ID: ICP-MS2_121129A	Analysis Date: 11/29/2012 11:23:00 P	Prep Date:

Analyte	Result	RL	SPK value	Ref Val	%REC	LowLimit	HighLimit	%RPD	RPDLimit	Qual
Barium	0.192	0.0100	0.200	0	95.8	90	110			
Calcium	5.01	0.300	5.00	0	100	90	110			
Chromium	0.196	0.00500	0.200	0	98.2	90	110			
Magnesium	4.94	0.300	5.00	0	98.9	90	110			
Potassium	5.16	0.300	5.00	0	103	90	110			
Sodium	4.96	0.300	5.00	0	99.2	90	110			

Sample ID: LCVL5-121129	Batch ID: R63678	TestNo: SW6020A	Units: mg/L
SampType: LCVL	Run ID: ICP-MS2_121129A	Analysis Date: 11/29/2012 11:59:00 P	Prep Date:

Analyte	Result	RL	SPK value	Ref Val	%REC	LowLimit	HighLimit	%RPD	RPDLimit	Qual
Barium	0.00483	0.0100	0.00500	0	96.6	70	130			
Calcium	0.0903	0.300	0.100	0	90.3	70	130			
Chromium	0.00500	0.00500	0.00500	0	99.9	70	130			
Magnesium	0.105	0.300	0.100	0	105	70	130			
Potassium	0.105	0.300	0.100	0	105	70	130			
Sodium	0.114	0.300	0.100	0	114	70	130			

Qualifiers: B Analyte detected in the associated Method Blank J Analyte detected between MDL and RL ND Not Detected at the Method Detection Limit RL Reporting Limit J Analyte detected between SDL and RL	DF Dilution Factor MDL Method Detection Limit R RPD outside accepted control limits S Spike Recovery outside control limits N Parameter not NELAC certified
--	---

CLIENT: Larson & Associates
Work Order: 1211199
Project: R360-Artesia Aeration Landfarm

ANALYTICAL QC SUMMARY REPORT

RunID: ICP-MS2_121129A

Sample ID: CCV6-121129	Batch ID: R63678	TestNo: SW6020A	Units: mg/L
SampType: CCV	Run ID: ICP-MS2_121129A	Analysis Date: 11/30/2012 1:29:00 AM	Prep Date:

Analyte	Result	RL	SPK value	Ref Val	%REC	LowLimit	HighLimit	%RPD	RPDLimit	Qual
Arsenic	0.200	0.00500	0.200	0	99.8	90	110			
Barium	0.194	0.0100	0.200	0	97.0	90	110			
Cadmium	0.196	0.00100	0.200	0	98.0	90	110			
Calcium	4.99	0.300	5.00	0	99.7	90	110			
Chromium	0.197	0.00500	0.200	0	98.4	90	110			
Lead	0.191	0.00100	0.200	0	95.6	90	110			
Magnesium	5.02	0.300	5.00	0	100	90	110			
Silver	0.187	0.00200	0.200	0	93.4	90	110			
Sodium	5.02	0.300	5.00	0	100	90	110			

Sample ID: LCVL6-121129	Batch ID: R63678	TestNo: SW6020A	Units: mg/L
SampType: LCVL	Run ID: ICP-MS2_121129A	Analysis Date: 11/30/2012 2:05:00 AM	Prep Date:

Analyte	Result	RL	SPK value	Ref Val	%REC	LowLimit	HighLimit	%RPD	RPDLimit	Qual
Arsenic	0.00525	0.00500	0.00500	0	105	70	130			
Barium	0.00479	0.0100	0.00500	0	95.8	70	130			
Cadmium	0.00108	0.00100	0.00100	0	108	70	130			
Calcium	0.0902	0.300	0.100	0	90.2	70	130			
Chromium	0.00498	0.00500	0.00500	0	99.5	70	130			
Lead	0.000952	0.00100	0.00100	0	95.2	70	130			
Magnesium	0.106	0.300	0.100	0	106	70	130			
Silver	0.00188	0.00200	0.00200	0	93.8	70	130			
Sodium	0.0961	0.300	0.100	0	96.1	70	130			

Sample ID: CCV7-121129	Batch ID: R63678	TestNo: SW6020A	Units: mg/L
SampType: CCV	Run ID: ICP-MS2_121129A	Analysis Date: 11/30/2012 3:22:00 AM	Prep Date:

Analyte	Result	RL	SPK value	Ref Val	%REC	LowLimit	HighLimit	%RPD	RPDLimit	Qual
Arsenic	0.199	0.00500	0.200	0	99.6	90	110			
Barium	0.194	0.0100	0.200	0	97.0	90	110			
Cadmium	0.193	0.00100	0.200	0	96.4	90	110			
Calcium	4.99	0.300	5.00	0	99.7	90	110			
Chromium	0.195	0.00500	0.200	0	97.4	90	110			
Lead	0.186	0.00100	0.200	0	93.1	90	110			
Silver	0.188	0.00200	0.200	0	93.8	90	110			
Sodium	4.94	0.300	5.00	0	98.9	90	110			

Sample ID: LCVL7-121129	Batch ID: R63678	TestNo: SW6020A	Units: mg/L
SampType: LCVL	Run ID: ICP-MS2_121129A	Analysis Date: 11/30/2012 3:58:00 AM	Prep Date:

Analyte	Result	RL	SPK value	Ref Val	%REC	LowLimit	HighLimit	%RPD	RPDLimit	Qual
---------	--------	----	-----------	---------	------	----------	-----------	------	----------	------

Qualifiers: B Analyte detected in the associated Method Blank J Analyte detected between MDL and RL ND Not Detected at the Method Detection Limit RL Reporting Limit J Analyte detected between SDL and RL	DF Dilution Factor MDL Method Detection Limit R RPD outside accepted control limits S Spike Recovery outside control limits N Parameter not NELAC certified
--	---

CLIENT: Larson & Associates
Work Order: 1211199
Project: R360-Artesia Aeration Landfarm

ANALYTICAL QC SUMMARY REPORT

RunID: ICP-MS2_121129A

Sample ID: LCVL7-121129	Batch ID: R63678	TestNo: SW6020A	Units: mg/L
SampType: LCVL	Run ID: ICP-MS2_121129A	Analysis Date: 11/30/2012 3:58:00 AM	Prep Date:

Analyte	Result	RL	SPK value	Ref Val	%REC	LowLimit	HighLimit	%RPD	RPDLimit	Qual
Arsenic	0.00515	0.00500	0.00500	0	103	70	130			
Barium	0.00492	0.0100	0.00500	0	98.3	70	130			
Cadmium	0.000877	0.00100	0.00100	0	87.7	70	130			
Calcium	0.102	0.300	0.100	0	102	70	130			
Chromium	0.00505	0.00500	0.00500	0	101	70	130			
Lead	0.000933	0.00100	0.00100	0	93.3	70	130			
Silver	0.00182	0.00200	0.00200	0	90.8	70	130			
Sodium	0.0942	0.300	0.100	0	94.2	70	130			

Sample ID: ICV1-121129	Batch ID: R63678	TestNo: SW6020A	Units: mg/L
SampType: ICV	Run ID: ICP-MS2_121129A	Analysis Date: 11/29/2012 11:12:00 A	Prep Date:

Analyte	Result	RL	SPK value	Ref Val	%REC	LowLimit	HighLimit	%RPD	RPDLimit	Qual
Arsenic	0.0985	0.00500	0.100	0	98.5	90	110			
Barium	0.0940	0.0100	0.100	0	94.0	90	110			
Cadmium	0.0965	0.00100	0.100	0	96.5	90	110			
Calcium	2.38	0.300	2.50	0	95.2	90	110			
Chromium	0.101	0.00500	0.100	0	101	90	110			
Lead	0.0914	0.00100	0.100	0	91.4	90	110			
Magnesium	2.45	0.300	2.50	0	97.9	90	110			
Potassium	2.48	0.300	2.50	0	99.1	90	110			
Selenium	0.106	0.00500	0.100	0	106	90	110			
Silver	0.0945	0.00200	0.100	0	94.5	90	110			
Sodium	2.44	0.300	2.50	0	97.7	90	110			

Sample ID: CCV4-121129	Batch ID: R63678	TestNo: SW6020A	Units: mg/L
SampType: CCV	Run ID: ICP-MS2_121129A	Analysis Date: 11/29/2012 9:05:00 PM	Prep Date:

Analyte	Result	RL	SPK value	Ref Val	%REC	LowLimit	HighLimit	%RPD	RPDLimit	Qual
Arsenic	0.204	0.00500	0.200	0	102	90	110			
Barium	0.195	0.0100	0.200	0	97.6	90	110			
Cadmium	0.193	0.00100	0.200	0	96.7	90	110			
Calcium	5.06	0.300	5.00	0	101	90	110			
Chromium	0.197	0.00500	0.200	0	98.7	90	110			
Lead	0.190	0.00100	0.200	0	95.0	90	110			
Magnesium	5.07	0.300	5.00	0	101	90	110			
Potassium	5.28	0.300	5.00	0	106	90	110			
Selenium	0.218	0.00500	0.200	0	109	90	110			
Silver	0.186	0.00200	0.200	0	93.0	90	110			
Sodium	5.22	0.300	5.00	0	104	90	110			

Qualifiers:	B Analyte detected in the associated Method Blank J Analyte detected between MDL and RL ND Not Detected at the Method Detection Limit RL Reporting Limit J Analyte detected between SDL and RL	DF Dilution Factor MDL Method Detection Limit R RPD outside accepted control limits S Spike Recovery outside control limits N Parameter not NELAC certified
--------------------	--	---

CLIENT: Larson & Associates
 Work Order: 1211199
 Project: R360-Artesia Aeration Landfarm

ANALYTICAL QC SUMMARY REPORT

RunID: ICP-MS2_121130B

Sample ID: LCVL-121130	Batch ID: R63706	TestNo: SW6020A	Units: mg/L
SampType: LCVL	Run ID: ICP-MS2_121130B	Analysis Date: 11/30/2012 1:47:00 PM	Prep Date:

Analyte	Result	RL	SPK value	Ref Val	%REC	LowLimit	HighLimit	%RPD	RPDLimit	Qual
Calcium	0.0593	0.300	0.100	0	59.3	70	130			S
Lead	0.00103	0.00100	0.00100	0	103	70	130			
Magnesium	0.109	0.300	0.100	0	109	70	130			
Selenium	0.00555	0.00500	0.00500	0	111	70	130			
Sodium	0.0973	0.300	0.100	0	97.3	70	130			

Sample ID: CCV1-121130	Batch ID: R63706	TestNo: SW6020A	Units: mg/L
SampType: CCV	Run ID: ICP-MS2_121130B	Analysis Date: 11/30/2012 3:04:00 PM	Prep Date:

Analyte	Result	RL	SPK value	Ref Val	%REC	LowLimit	HighLimit	%RPD	RPDLimit	Qual
Calcium	4.85	0.300	5.00	0	97.0	90	110			
Lead	0.190	0.00100	0.200	0	95.2	90	110			
Magnesium	4.93	0.300	5.00	0	98.6	90	110			
Selenium	0.194	0.00500	0.200	0	97.0	90	110			
Sodium	5.15	0.300	5.00	0	103	90	110			

Sample ID: LCVL1-121130	Batch ID: R63706	TestNo: SW6020A	Units: mg/L
SampType: LCVL	Run ID: ICP-MS2_121130B	Analysis Date: 11/30/2012 3:35:00 PM	Prep Date:

Analyte	Result	RL	SPK value	Ref Val	%REC	LowLimit	HighLimit	%RPD	RPDLimit	Qual
Calcium	0.0556	0.300	0.100	0	55.6	70	130			S
Lead	0.00104	0.00100	0.00100	0	104	70	130			
Magnesium	0.110	0.300	0.100	0	110	70	130			
Selenium	0.00555	0.00500	0.00500	0	111	70	130			
Sodium	0.0949	0.300	0.100	0	94.9	70	130			

Sample ID: ICV1-121130	Batch ID: R63706	TestNo: SW6020A	Units: mg/L
SampType: ICV	Run ID: ICP-MS2_121130B	Analysis Date: 11/30/2012 1:35:00 PM	Prep Date:

Analyte	Result	RL	SPK value	Ref Val	%REC	LowLimit	HighLimit	%RPD	RPDLimit	Qual
Calcium	2.41	0.300	2.50	0	96.5	90	110			
Lead	0.0952	0.00100	0.100	0	95.2	90	110			
Magnesium	2.51	0.300	2.50	0	100	90	110			
Selenium	0.0987	0.00500	0.100	0	98.7	90	110			
Sodium	2.53	0.300	2.50	0	101	90	110			

Qualifiers: B Analyte detected in the associated Method Blank J Analyte detected between MDL and RL ND Not Detected at the Method Detection Limit RL Reporting Limit J Analyte detected between SDL and RL	DF Dilution Factor MDL Method Detection Limit R RPD outside accepted control limits S Spike Recovery outside control limits N Parameter not NELAC certified
--	---

CLIENT: Larson & Associates
 Work Order: 1211199
 Project: R360-Artesia Aeration Landfarm

ANALYTICAL QC SUMMARY REPORT

RunID: IC2_121128A

The QC data in batch 54878 applies to the following samples: 1211199-01A, 1211199-02A, 1211199-03A, 1211199-04A, 1211199-05A, 1211199-06A

Sample ID: LCS-54878	Batch ID: 54878	TestNo: SW9056A	Units: mg/Kg							
SampType: LCS	Run ID: IC2_121128A	Analysis Date: 11/28/2012 9:01:43 AM	Prep Date: 11/27/2012							
Analyte	Result	RL	SPK value	Ref Val	%REC	LowLimit	HighLimit	%RPD	RPDLimit	Qual
Chloride	52.6	5.00	50.00	0	105	80	120			
Sulfate	151	10.0	150.0	0	101	80	120			

Sample ID: LCSD-54878	Batch ID: 54878	TestNo: SW9056A	Units: mg/Kg							
SampType: LCSD	Run ID: IC2_121128A	Analysis Date: 11/28/2012 9:16:18 AM	Prep Date: 11/27/2012							
Analyte	Result	RL	SPK value	Ref Val	%REC	LowLimit	HighLimit	%RPD	RPDLimit	Qual
Chloride	53.2	5.00	50.00	0	106	80	120	1.11	15	
Sulfate	152	10.0	150.0	0	102	80	120	0.770	15	

Sample ID: MB-54878	Batch ID: 54878	TestNo: SW9056A	Units: mg/Kg							
SampType: MBLK	Run ID: IC2_121128A	Analysis Date: 11/28/2012 9:30:52 AM	Prep Date: 11/27/2012							
Analyte	Result	RL	SPK value	Ref Val	%REC	LowLimit	HighLimit	%RPD	RPDLimit	Qual
Chloride	ND	5.00								
Sulfate	ND	10.0								

Sample ID: 1211199-01A DUP	Batch ID: 54878	TestNo: SW9056A	Units: mg/Kg-dry							
SampType: DUP	Run ID: IC2_121128A	Analysis Date: 11/28/2012 10:23:39 A	Prep Date: 11/27/2012							
Analyte	Result	RL	SPK value	Ref Val	%REC	LowLimit	HighLimit	%RPD	RPDLimit	Qual
Chloride	7.40	5.27	0	7.507				1.37	10	
Sulfate	18.8	10.5	0	19.61				4.31	10	

Sample ID: 1211199-01A MS	Batch ID: 54878	TestNo: SW9056A	Units: mg/Kg-dry							
SampType: MS	Run ID: IC2_121128A	Analysis Date: 11/28/2012 10:38:13 A	Prep Date: 11/27/2012							
Analyte	Result	RL	SPK value	Ref Val	%REC	LowLimit	HighLimit	%RPD	RPDLimit	Qual
Chloride	61.0	5.30	53.01	4.500	107	80	120			
Sulfate	174	10.6	159.0	11.77	102	80	120			

Sample ID: 1211199-01A MSD	Batch ID: 54878	TestNo: SW9056A	Units: mg/Kg-dry							
SampType: MSD	Run ID: IC2_121128A	Analysis Date: 11/28/2012 10:52:48 A	Prep Date: 11/27/2012							
Analyte	Result	RL	SPK value	Ref Val	%REC	LowLimit	HighLimit	%RPD	RPDLimit	Qual
Chloride	61.4	5.30	53.01	4.500	107	80	120	0.707	15	
Sulfate	175	10.6	159.0	11.77	103	80	120	0.860	15	

Qualifiers: B Analyte detected in the associated Method Blank J Analyte detected between MDL and RL ND Not Detected at the Method Detection Limit RL Reporting Limit J Analyte detected between SDL and RL	DF Dilution Factor MDL Method Detection Limit R RPD outside accepted control limits S Spike Recovery outside control limits N Parameter not NELAC certified
--	---

CLIENT: Larson & Associates
Work Order: 1211199
Project: R360-Artesia Aeration Landfarm

ANALYTICAL QC SUMMARY REPORT

RunID: IC2_121128A

Sample ID: ICV-121128	Batch ID: R63658	TestNo: SW9056A	Units: mg/Kg							
SampType: ICV	Run ID: IC2_121128A	Analysis Date: 11/28/2012 8:44:33 AM	Prep Date:							
Analyte	Result	RL	SPK value	Ref Val	%REC	LowLimit	HighLimit	%RPD	RPDLimit	Qual
Chloride	26.6	5.00	25.00	0	106	90	110			
Sulfate	77.3	10.0	75.00	0	103	90	110			

Sample ID: CCV1-121128	Batch ID: R63658	TestNo: SW9056A	Units: mg/Kg							
SampType: CCV	Run ID: IC2_121128A	Analysis Date: 11/28/2012 2:00:45 PM	Prep Date:							
Analyte	Result	RL	SPK value	Ref Val	%REC	LowLimit	HighLimit	%RPD	RPDLimit	Qual
Chloride	10.8	5.00	10.00	0	108	90	110			
Sulfate	31.1	10.0	30.00	0	104	90	110			

Sample ID: CCV2-121128	Batch ID: R63658	TestNo: SW9056A	Units: mg/Kg							
SampType: CCV	Run ID: IC2_121128A	Analysis Date: 11/28/2012 2:47:06 PM	Prep Date:							
Analyte	Result	RL	SPK value	Ref Val	%REC	LowLimit	HighLimit	%RPD	RPDLimit	Qual
Chloride	10.9	5.00	10.00	0	109	90	110			
Sulfate	31.2	10.0	30.00	0	104	90	110			

Qualifiers: B Analyte detected in the associated Method Blank DF Dilution Factor
 J Analyte detected between MDL and RL MDL Method Detection Limit
 ND Not Detected at the Method Detection Limit R RPD outside accepted control limits
 RL Reporting Limit S Spike Recovery outside control limits
 J Analyte detected between SDL and RL N Parameter not NELAC certified

CLIENT: Larson & Associates
Work Order: 1211199
Project: R360-Artesia Aeration Landfarm

ANALYTICAL QC SUMMARY REPORT

RunID: PMOIST_121127A

The QC data in batch 54885 applies to the following samples: 1211199-01B, 1211199-02B, 1211199-03B, 1211199-04B, 1211199-05B, 1211199-06B

Sample ID: 1211212-01A-DUP	Batch ID: 54885	TestNo: D2216	Units: WT%							
SampType: DUP	Run ID: PMOIST_121127A	Analysis Date: 11/28/2012 9:20:00 AM	Prep Date: 11/27/2012							
Analyte	Result	RL	SPK value	Ref Val	%REC	LowLimit	HighLimit	%RPD	RPDLimit	Qual
Percent Moisture	23.0	0	0	22.85				0.482	30	

Qualifiers:	B Analyte detected in the associated Method Blank J Analyte detected between MDL and RL ND Not Detected at the Method Detection Limit RL Reporting Limit J Analyte detected between SDL and RL	DF Dilution Factor MDL Method Detection Limit R RPD outside accepted control limits S Spike Recovery outside control limits N Parameter not NELAC certified
--------------------	--	---

CLIENT: Larson & Associates
Work Order: 1211199
Project: R360-Artesia Aeration Landfarm

ANALYTICAL QC SUMMARY REPORT

RunID: TITRATOR_121129A

The QC data in batch 54879 applies to the following samples: 1211199-01A, 1211199-02A, 1211199-03A, 1211199-04A, 1211199-05A, 1211199-06A

Sample ID: LCS-54879	Batch ID: 54879	TestNo: M2320 B	Units: mg/L							
SampType: LCS	Run ID: TITRATOR_121129A	Analysis Date: 11/29/2012 11:44:00 A	Prep Date: 11/27/2012							
Analyte	Result	RL	SPK value	Ref Val	%REC	LowLimit	HighLimit	%RPD	RPDLimit	Qual
Alkalinity, Total (As CaCO3)	267	50.0	250.0	0	107	81.6	123			

Sample ID: MB-54879	Batch ID: 54879	TestNo: M2320 B	Units: mg/L							
SampType: MBLK	Run ID: TITRATOR_121129A	Analysis Date: 11/29/2012 11:46:00 A	Prep Date: 11/27/2012							
Analyte	Result	RL	SPK value	Ref Val	%REC	LowLimit	HighLimit	%RPD	RPDLimit	Qual
Alkalinity, Bicarbonate (As CaCO3)	ND	50.0								
Alkalinity, Carbonate (As CaCO3)	ND	50.0								
Alkalinity, Hydroxide (As CaCO3)	ND	50.0								
Alkalinity, Total (As CaCO3)	ND	50.0								

Sample ID: 1211199-01A DUP	Batch ID: 54879	TestNo: M2320 B	Units: mg/L-dry							
SampType: DUP	Run ID: TITRATOR_121129A	Analysis Date: 11/29/2012 11:59:00 A	Prep Date: 11/27/2012							
Analyte	Result	RL	SPK value	Ref Val	%REC	LowLimit	HighLimit	%RPD	RPDLimit	Qual
Alkalinity, Bicarbonate (As CaCO3)	636	52.9	0	589.7				7.62	0	
Alkalinity, Carbonate (As CaCO3)	183	52.9	0	219.2				18.1	0	
Alkalinity, Hydroxide (As CaCO3)	0	52.9	0	0				0	0	
Alkalinity, Total (As CaCO3)	819	52.9	0	808.9				1.27	25	

Qualifiers: B Analyte detected in the associated Method Blank J Analyte detected between MDL and RL ND Not Detected at the Method Detection Limit RL Reporting Limit J Analyte detected between SDL and RL	DF Dilution Factor MDL Method Detection Limit R RPD outside accepted control limits S Spike Recovery outside control limits N Parameter not NELAC certified
--	---

CLIENT: Larson & Associates
Work Order: 1211199
Project: R360-Artesia Aeration Landfarm

ANALYTICAL QC SUMMARY REPORT

RunID: TITRATOR_121129A

Sample ID: ICV-121129	Batch ID: R63677	TestNo: M2320 B	Units: mg/L
SampType: ICV	Run ID: TITRATOR_121129A	Analysis Date: 11/29/2012 11:41:00 A	Prep Date: 11/29/2012

Analyte	Result	RL	SPK value	Ref Val	%REC	LowLimit	HighLimit	%RPD	RPDLimit	Qual
Alkalinity, Bicarbonate (As CaCO3)	35.0	20.0	0							
Alkalinity, Carbonate (As CaCO3)	66.9	20.0	0							
Alkalinity, Hydroxide (As CaCO3)	0	20.0	0							
Alkalinity, Total (As CaCO3)	102	20.0	100.0	0	102	98	102			

Sample ID: CCV-121129	Batch ID: R63677	TestNo: M2320 B	Units: mg/L
SampType: CCV	Run ID: TITRATOR_121129A	Analysis Date: 11/29/2012 12:30:00 P	Prep Date: 11/29/2012

Analyte	Result	RL	SPK value	Ref Val	%REC	LowLimit	HighLimit	%RPD	RPDLimit	Qual
Alkalinity, Bicarbonate (As CaCO3)	40.1	20.0	0							
Alkalinity, Carbonate (As CaCO3)	60.6	20.0	0							
Alkalinity, Hydroxide (As CaCO3)	0	20.0	0							
Alkalinity, Total (As CaCO3)	101	20.0	100.0	0	101	90	110			

Qualifiers:	B Analyte detected in the associated Method Blank J Analyte detected between MDL and RL ND Not Detected at the Method Detection Limit RL Reporting Limit J Analyte detected between SDL and RL	DF Dilution Factor MDL Method Detection Limit R RPD outside accepted control limits S Spike Recovery outside control limits N Parameter not NELAC certified	
--------------------	--	---	--

ARTESTA AERATION
~~LONESTAR CONSTRUCTION, LLC~~

FACSIMILE TRANSMITTAL COVER SHEET

TO: BRAD JONES

FAX#: 505-476-3462

NUMBER OF PAGES INCLUDING COVER SHEET: 11

FROM: JIM WILSON

FAX#: 575-391-0778

PHONE#: 575-631-2442

MESSAGE:

The information contained in this facsimile message is privileged and confidential information intended for the use of the individual or entity named above. If the reader of this message is not the intended recipient, or the employee or agent responsible to deliver it to the intended recipient, you are hereby notified that any dissemination, distribution or copying of this communication is strictly prohibited. If you have received this communication in error, please immediately notify us by telephone so we may arrange to retrieve this transmission at no cost to you.



PHONE (575) 393-2326 • 101 E. MARLAND • HOBBS, NM 88240

August 12, 2011

Cliff Brunson
BBC International, Inc.
P.O. Box 805
Hobbs, NM 88241

RE: ARTESIA AERATION LLC

Enclosed are the results of analyses for samples received by the laboratory on 08/09/11 17:03.

Cardinal Laboratories is accredited through Texas NELAP for:

Method SW-846 8021	Benzene, Toluene, Ethyl Benzene, and Total Xylenes
Method SW-846 8260	Benzene, Toluene, Ethyl Benzene, and Total Xylenes
Method TX 1005	Total Petroleum Hydrocarbons

Certificate number T104704398-08-TX. Accreditation applies to solid and chemical materials and non-potable water matrices.

Cardinal Laboratories is accredited through the State of Colorado Department of Public Health and Environment for:

Method EPA 552.2	Haloacetic Acids (HAA-5)
Method EPA 524.2	Total Trihalomethanes (TTHM)
Method EPA 524.4	Regulated VOCs (V2, V3)

Accreditation applies to public drinking water matrices.

This report meets NELAP requirements and is made up of a cover page, analytical results, and a copy of the original chain-of-custody. If you have any questions concerning this report, please feel free to contact me.

Sincerely,

A handwritten signature in black ink that reads "Celey D. Keene".

Celey D. Keene
Lab Director/Quality Manager



PHONE (575) 393-2326 • 101 E. MARLAND • HOBBS, NM 88240

Analytical Results For:

BBC International, Inc.
Cliff Brunson
P.O. Box 805
Hobbs NM, 88241
Fax To: (505) 397-0397

Received:	08/09/2011	Sampling Date:	08/09/2011
Reported:	08/12/2011	Sampling Type:	Soil
Project Name:	ARTESIA AERATION LLC	Sampling Condition:	Cool & Intact
Project Number:	NONE GIVEN	Sample Received By:	Jodi Henson
Project Location:	MALJAMAR, NM		

Sample ID: CELL #1 (H101669-01)

BTEX 8021B		mg/kg		Analyzed By: CMS					
Analyte	Result	Reporting Limit	Analyzed	Method Blank	BS	% Recovery	True Value QC	RPD	Qualifier
Benzene*	<0.050	0.050	08/11/2011	ND	1.97	98.7	2.00	6.67	
Toluene*	<0.050	0.050	08/11/2011	ND	1.88	94.0	2.00	8.55	
Ethylbenzene*	<0.050	0.050	08/11/2011	ND	1.90	95.2	2.00	9.19	
Total Xylenes*	<0.150	0.150	08/11/2011	ND	5.67	94.6	6.00	9.32	

Surrogate: 4-Bromofluorobenzene (PIL) 95.1 % 70-130

TPM 8015M		mg/kg		Analyzed By: ab					
Analyte	Result	Reporting Limit	Analyzed	Method Blank	BS	% Recovery	True Value QC	RPD	Qualifier
GRO C6-C10	<50.0	50.0	08/11/2011	ND	191	95.7	200	0.390	
DRO >C10-C29	649	50.0	08/11/2011	ND	185	92.4	200	0.435	

Surrogate: 1-Chlorooctane 119 % 70-130

Surrogate: 1-Chlorooctadecane 139 % 70-130

Cardinal Laboratories

*Accredited Analyte

PLEASE NOTE: Liability and Damages: Cardinal accepts and clients acknowledge hereby for any claim arising, whether based in contract or tort, shall be limited to the amount paid for these analyses. All claims, including those for negligence and any other cause whatsoever shall be limited to the amount paid and received by Cardinal within thirty (30) days after completion of the applicable service. In no event shall Cardinal be liable for incidental or consequential damages, including without limitation, business interruption, loss of use, or loss of profits incurred by clients, the subsidiaries, affiliates or successors arising out of or related to the performance of the services provided by Cardinal, regardless of whether such claim is based upon any of the above stated reasons or otherwise, and shall relate only to the services mentioned herein. This report shall not be re-released except in full with written approval of Cardinal Laboratories.

Celey D. Keene, Lab Director/Quality Manager

Page 2 of 11



PHONE (575) 393-2326 * 101 E. MARLAND * HOBBS, NM 88240

Analytical Results For:

BBC International, Inc.
 Cliff Brunson
 P.O. Box 805
 Hobbs NM, 88241
 Fax To: (505) 397-0397

Received:	08/09/2011	Sampling Date:	08/09/2011
Reported:	08/12/2011	Sampling Type:	Soil
Project Name:	ARTESIA AERATION LLC	Sampling Condition:	Cool & Intact
Project Number:	NONE GIVEN	Sample Received By:	Jodi Henson
Project Location:	MALJAMAR, NM		

Sample ID: CELL #2 (H101669-02)

STEX 60218		mg/kg		Analyzed By: CMS						
Analyte	Result	Reporting Limit	Analyzed	Method Blank	BS	% Recovery	True Value QC	RPD	Qualifier	
Benzene*	<0.050	0.050	08/11/2011	ND	1.97	98.7	2.00	6.67		
Toluene*	<0.050	0.050	08/11/2011	ND	1.88	94.0	2.00	8.55		
Ethylbenzene*	<0.050	0.050	08/11/2011	ND	1.90	95.2	2.00	9.19		
Total Xylenes*	<0.150	0.150	08/11/2011	ND	5.67	94.6	6.00	9.32		

TPH 8015M		mg/kg		Analyzed By: ab						
Analyte	Result	Reporting Limit	Analyzed	Method Blank	BS	% Recovery	True Value QC	RPD	Qualifier	
GRO C6-C10	<10.0	10.0	08/11/2011	ND	191	95.7	200	0.390		
DRO >C10-C28	12.1	10.0	08/11/2011	ND	185	92.4	200	0.435		

Surrogate: 4-Bromofluorobenzene (PIL) 99.0 % 70-130
 Surrogate: 1-Chlorooctane 101 % 70-130
 Surrogate: 1-Chlorooctadecane 128 % 70-130

Cardinal Laboratories

*=Accredited Analyte

PLEASE NOTE: Liability and Damages. Cardinal's liability and client's exclusive remedy for any claim arising, whether based in contract or tort, shall be limited to the amount paid by client to Cardinal. All claims, including those for negligence and the other cause whatsoever shall be deemed waived unless made in writing and received by Cardinal within thirty (30) days after completion of the applicable service. In no event shall Cardinal be liable for incidental or consequential damages, including without limitation, business interruption, loss of use, or loss of profits incurred by client, its subsidiaries, affiliates or successors arising out of or related to the performance of the services hereunder by Cardinal, regardless of whether such claim is based upon any of the above noted theories of recovery. Results shall only be for the specific identified client. This report shall not be reproduced except in full with written approval of Cardinal Laboratories.

Coley D. Keene

Coley D. Keene, Lab Director/Quality Manager



PHONE (575) 393-2326 • 101 E. MARLAND • HOBBS, NM 88240

Analytical Results For:

BBC International, Inc.
 Cliff Brunson
 P.O. Box 805
 Hobbs NM, 88241
 Fax To: (505) 397-0397

Received:	08/09/2011	Sampling Date:	08/09/2011
Reported:	08/12/2011	Sampling Type:	Soil
Project Name:	ARTESIA AERATION LLC	Sampling Condition:	Cool & Intact
Project Number:	NONE GIVEN	Sample Received By:	Jodi Henson
Project Location:	MAJAMAR, NM		

Sample ID: CELL #3 (H101669-03)

BTEX 8021B		mg/kg		Analyzed By: CMS					
Analyte	Result	Reporting Limit	Analyzed	Method Blank	BS	% Recovery	True Value QC	RPD	Qualifier
Benzene*	<0.050	0.050	08/11/2011	ND	1.97	98.7	2.00	6.67	
Toluene*	<0.050	0.050	08/11/2011	ND	1.88	94.0	2.00	8.55	
Ethylbenzene**	<0.050	0.050	08/11/2011	ND	1.90	95.2	2.00	9.19	
Total Xylenes*	<0.150	0.150	08/11/2011	ND	3.67	94.6	6.00	9.32	

Surrogate: 4-Bromofluorobenzene (PIL) 97.6 % 70-130

TPH 8015M		mg/kg		Analyzed By: ab					
Analyte	Result	Reporting Limit	Analyzed	Method Blank	BS	% Recovery	True Value QC	RPD	Qualifier
GRO C6-C10	<10.0	10.0	08/11/2011	ND	191	95.7	200	0.390	
DRO >C10-C26	73.4	10.0	08/11/2011	ND	185	92.4	200	0.435	

Surrogate: 1-Chlorooctane 116 % 70-130

Surrogate: 1-Chlorooctadecane 125 % 70-130

Cardinal Laboratories

*=Accredited Analyte

WARRANTY: Liability and Damages. Cardinal's reports and client's exclusive remedy for any claim arising, whether based in contract or tort, shall be limited to the amount paid by client for analyses. All claims, including claims for negligent and any other cause whatsoever shall be deemed waived unless made in writing and received by Cardinal within thirty (30) days after completion of the applicable service. In no event shall Cardinal be liable for incidental or consequential damages, including, without limitation, business interruptions, loss of use, or loss of profits incurred by client, or consequential, special or punitive damages arising out of or related to the performance of the services hereunder by Cardinal, regardless of whether such claim is based upon any of the above stated warranties or otherwise. Results relate only to the samples identified above. This report shall not be reproduced except in full with written approval of Cardinal Laboratories.

Celey D. Keene, Lab Director/Quality Manager



PHONE (575) 393-2326 • 101 E. MARLAND • HOBBS, NM 88240

Analytical Results For:

BBC International, Inc.
 Cliff Brunson
 P.O. Box 805
 Hobbs NM, 88241
 Fax To: (505) 397-0397

Received:	08/09/2011	Sampling Date:	08/09/2011
Reported:	08/12/2011	Sampling Type:	Soil
Project Name:	ARTESIA AERATION LLC	Sampling Condition:	Cool & Intact
Project Number:	NONE GIVEN	Sample Received By:	Jodi Henson
Project Location:	MALJAMAR, NM		

Sample ID: CELL #4 (H101669-04)

BTEX 80210		mg/kg		Analyzed By: CMS						
Analyte	Result	Reporting Limit	Analyzed	Method Blank	BS	% Recovery	True Value QC	RPD	Qualifier	
Benzene*	<0.050	0.050	08/11/2011	ND	1.97	98.7	2.00	6.67		
Toluene*	<0.050	0.050	08/11/2011	ND	1.88	94.0	2.00	8.55		
Ethylbenzene*	<0.050	0.050	08/11/2011	ND	1.90	95.2	2.00	9.19		
Total Xylenes*	<0.150	0.150	08/11/2011	ND	5.67	94.6	6.00	9.32		

TPH 8015M		mg/kg		Analyzed By: ab						
Analyte	Result	Reporting Limit	Analyzed	Method Blank	BS	% Recovery	True Value QC	RPD	Qualifier	
Surrogate: 4-Bromofluorobenzene (PIL)	96.8 %	70-130								
GR0 C6-C10	<10.0	10.0	08/12/2011	ND	191	95.7	200	0.390		
DR0 >C10-C28	96.8	10.0	08/12/2011	ND	185	92.4	200	0.435		
Surrogate: 1-Chlorooctane	100 %	70-130								
Surrogate: 1-Chlorooctadecane	125 %	70-130								

Cardinal Laboratories

*=Accredited Analyte

PLEASE NOTE: Lability and Demerit. Cardinal Laborte and other exclusive liability for any data arising, whether based in contract or not, shall be limited to the amount paid by client for analysis. All claims, including those for negligence and any other cause whatsoever shall be deemed waived unless made in writing and received by Cardinal within thirty (30) days after completion of the applicable service. In no event shall Cardinal be liable for incidental or consequential damages, including, without limitation, business interruptions, loss of use, or loss of profits incurred by clients as a result of, or arising out of or relative to the performance of the ANALYSIS furnished by Cardinal, regardless of whether such claim is based upon any of the above stated warranties or otherwise. Results relate only to the samples identified above. This report shall not be reproduced except in full with written approval of Cardinal Laboratories.

Celey D. Keene

Celey D. Keene, Lab Director/Quality Manager



PHONE (575) 393-2326 • 101 E. MARLAND • HOBBS, NM 88240

Analytical Results For:

BBC International, Inc.
Cliff Brunson
P.O. Box 805
Hobbs NM, 88241
Fax To: (505) 397-0397

Received:	08/09/2011	Sampling Date:	08/09/2011
Reported:	08/12/2011	Sampling Type:	Soil
Project Name:	ARTESIA AERATION LLC	Sampling Condition:	Cool & Intact
Project Number:	NONE GIVEN	Sample Received By:	Jodi Henson
Project Location:	MALJAMAR, NM		

Sample ID: CELL #5 (H101669-05)

BTEX 8021B		mg/kg		Analyzed By: CMS						
Analyte	Result	Reporting Limit	Analyzed	Method Blank	BS	% Recovery	True Value QC	RPD	Qualifier	
Benzene*	<0.050	0.050	08/11/2011	ND	1.97	98.7	2.00	6.67		
Toluene*	<0.050	0.050	08/11/2011	ND	1.88	94.0	2.00	8.55		
Ethylbenzene*	<0.050	0.050	08/11/2011	ND	1.90	95.2	2.00	9.19		
Total Xylenes*	<0.150	0.150	08/11/2011	ND	5.67	94.6	6.00	9.32		

Surrogate: 4-Bromofluorobenzene (PLI) 94.9 % 70-130

TFM 8015M		mg/kg		Analyzed By: ab						
Analyte	Result	Reporting Limit	Analyzed	Method Blank	BS	% Recovery	True Value QC	RPD	Qualifier	
GRO C6-C10	<10.0	10.0	08/12/2011	ND	191	95.7	200	0.390		
DRO >C10-C28	357	10.0	08/12/2011	ND	185	92.4	200	0.435		

Surrogate: 1-Chlorooctane 112 % 70-130

Surrogate: 1-Chlorooctadecane 122 % 70-130

Cardinal Laboratories

*=Accredited Analyte

PLEASE NOTE: Liability and Coverage. Cardinal's liability and client's exclusive remedy for any claim arising, whether based in contract or tort, shall be limited to the amount paid by client for analysis. All claims, including those for negligence and any other cause whatsoever shall be deemed waived unless made in writing and received by Cardinal within thirty (30) days after completion of the applicable service. In no event shall Cardinal be liable for potential or consequential damages, including, without limitation, business interruption, loss of use, or loss of profits incurred by client, its subsidiaries, affiliates or licensees arising out of or related to the performance of the services rendered by Cardinal, regardless of whether such claim is based upon any of the above stated causes of damages. Results relate only to the samples identified above. This report shall not be reproduced except in full with written approval of Cardinal Laboratories.

Celey D. Keene, Lab Director/Quality Manager

08/14/2011 20:20 5053970397



PHONE (575) 393-2326 • 101 E. MARLAND • HOBBS, NM 88240

Analytical Results For:

BCC International, Inc.
Cliff Brunson
P.O. Box 805
Hobbs NM, 88241
Fax To: (505) 397-0397

Received:	08/09/2011	Sampling Date:	08/09/2011
Reported:	08/12/2011	Sampling Type:	Soil
Project Name:	ARTESIA AERATION LLC	Sampling Condition:	Cool & Intact
Project Number:	NONE GIVEN	Sample Received By:	Jodi Henson
Project Location:	MALJAMAR, NM		

Sample ID: CELL #5B (H101669-06)

BTEX 8021B		mg/kg		Analyzed By: CMS					
Analyte	Result	Reporting Limit	Analyzed	Method Blank	BS	% Recovery	True Value QC	RPD	Qualifier
Benzene*	<0.050	0.050	08/12/2011	ND	1.97	98.7	2.00	6.67	
Toluene*	<0.050	0.050	08/12/2011	ND	1.88	94.0	2.00	8.55	
Ethylbenzene*	<0.050	0.050	08/12/2011	ND	1.90	95.2	2.00	9.19	
Total Xylenes*	<0.150	0.150	08/12/2011	ND	5.67	94.6	6.00	9.32	

Surrogate: 4-Bromofluorobenzene (PIL) 96.9 % 70-130

YPH 8015M		mg/kg		Analyzed By: ab					
Analyte	Result	Reporting Limit	Analyzed	Method Blank	BS	% Recovery	True Value QC	RPD	Qualifier
GRO C6-C10	<10.0	10.0	08/12/2011	ND	191	95.7	200	0.390	
PRO >C10-C28	57.1	10.0	08/12/2011	ND	185	92.4	200	0.435	

Surrogate: 1-Chlorooctane 101 % 70-130

Surrogate: 1-Chlorooctadecane 112 % 70-130

Cardinal Laboratories

* = Accredited Analyte

PLEASE NOTE: Liability and coverage. Cardinal's liability and coverage includes liability for any data errors, whether caused in sampling or test, shall be limited to the amount paid by client for analysis. All errors, including those for negligence and any other cause whatsoever shall be deemed waived unless made in writing and received by Cardinal within thirty (30) days after completion of the applicable activity. In no event shall Cardinal be liable for incidental or consequential damages, including without limitation, business interruptions, loss of use, or loss of profits incurred by client, its suppliers, affiliates or successors arising out of or related to the performance of the services rendered by Cardinal, regardless of whether such claim is based upon any of the above stated reasons or otherwise. Results relate only to the samples identified above. This report shall not be reproduced except in full with written approval of Cardinal Laboratories.

Celey D. Keane, Lab Director/Quality Manager

Page 7 of 11



PHONE (575) 393-2326 • 101 E. MARLAND • HOBBS, NM 88240

Analytical Results For:

BBC International, Inc.
 Cliff Brunson
 P.O. Box 805
 Hobbs NM, 88241
 Fax To: (505) 397-0397

Received:	08/09/2011	Sampling Date:	08/09/2011
Reported:	08/12/2011	Sampling Type:	Soil
Project Name:	ARTESIA AERATION LLC	Sampling Condition:	Cool & Intact
Project Number:	NONE GIVEN	Sample Received By:	Jodi Henson
Project Location:	MALJAMAR, NM		

Sample ID: CELL #6 (H101669-07)

BTEX 8021B		mg/kg		Analyzed By: CMS						
Analyte	Result	Reporting Limit	Analyzed	Method Blank	BS	% Recovery	True Value QC	RPD	Qualifier	
Benzene*	<0.050	0.050	08/12/2011	ND	1.97	98.7	2.00	6.67		
Toluene*	<0.050	0.050	08/12/2011	ND	1.88	94.0	2.00	8.55		
Ethylbenzene*	<0.050	0.050	08/12/2011	ND	1.90	95.2	2.00	9.19		
Total Xylenes*	<0.150	0.150	08/12/2011	ND	5.67	94.6	6.00	9.32		

Surrogate: 4-Bromofluorobenzene (PIL) 96.1 % 70-130

YPH 8015M		mg/kg		Analyzed By: sb						
Analyte	Result	Reporting Limit	Analyzed	Method Blank	BS	% Recovery	True Value QC	RPD	Qualifier	
GRO C6-C10	<50.0	50.0	08/12/2011	ND	191	95.7	200	0.390		
DRO >C10-C28	742	50.0	08/12/2011	ND	185	92.4	200	0.435		

Surrogate: 1-Chlorooctane 118 % 70-130

Surrogate: 1-Chlorooctadecane 127 % 70-130

Cardinal Laboratories

*=Accredited Analyte

PLEASE NOTE: Liability and Damages. Cardinal's liability and client's analysis remedy for any claim which, whether based in contract or tort, shall be limited to the amount paid by client for analysis. All claims, including those for negligence and any other cause whatsoever shall be deemed waived unless made in writing and received by Cardinal within thirty (30) days after completion of the applicable service. In no event shall Cardinal be liable for incidental or consequential damages, including without limitation, business interruption, loss of use, or loss of profits incurred by client, its subsidiaries, affiliates or successors arising out of or related to the performance of the services hereunder by Cardinal, regardless of whether such claim is based upon any of the above stated remedies or otherwise. Results refer only to the elements identified above. This report shall not be reproduced except in full with written approval of Cardinal Laboratories.

Celley D. Keene

Celley D. Keene, Lab Director/Quality Manager



PHONE (575) 393-2326 • 101 E. MARLAND • HOBBS, NM 88240

Analytical Results For:

BBC International, Inc.
 Cliff Brunson
 P.O. Box 805
 Hobbs NM, 88241
 Fax To: (505) 397-0397

Received: 08/09/2011
 Reported: 08/12/2011
 Project Name: ARTESIA AERATION LLC
 Project Number: NONE GIVEN
 Project Location: MALJAMAR, NM

Sampling Date: 08/09/2011
 Sampling Type: Soil
 Sampling Condition: Cool & Intact
 Sample Received By: Jodi Henson

Sample ID: CELL #6B (H101669-08)

BTEX 8021B		mg/kg		Analyzed By: CMS					
Analyte	Result	Reporting Limit	Analyzed	Method Blank	BS	% Recovery	True Value QC	RPD	Qualifier
Benzene*	<0.050	0.050	08/12/2011	ND	1.97	98.7	2.00	6.67	
Toluene*	<0.050	0.050	08/12/2011	ND	1.88	94.0	2.00	8.55	
Ethylbenzene*	<0.050	0.050	08/12/2011	ND	1.90	95.2	2.00	9.19	
Total Xylenes*	<0.150	0.150	08/12/2011	ND	5.67	94.6	6.00	9.32	

Surrogate: 4-Bromofluorobenzene (PIL) 97.0 % 70-130

TPH 8015M		mg/kg		Analyzed By: ab						S-06
Analyte	Result	Reporting Limit	Analyzed	Method Blank	BS	% Recovery	True Value QC	RPD	Qualifier	
GRO C6-C10	<50.0	50.0	08/12/2011	ND	191	95.7	200	0.390		
DRO >C10-C28	834	50.0	08/12/2011	ND	185	92.4	200	0.435		

Surrogate: 1-Chlorooctane 123 % 70-130

Surrogate: 1-Chlorooctadecane 134 % 70-130

Cardinal Laboratories

*=Accredited Analyte

PLEASE NOTE: Liability and Damages. Cardinal's liability and damages exclusive remedy to any claim arising, whether based in contract or tort, shall be limited to the amount paid by client for analysis. All claims, including those for negligence and any other cause whatsoever shall be deemed waived unless made in writing and received by Cardinal within thirty (30) days after completion of the applicable service. To no extent shall Cardinal be liable for incidental or consequential damages, including, without limitation, business interruptions, loss of use, or loss of profits incurred by client, its subsidiaries, affiliates or successors arising out of or related to the performance of the services hereunder by Cardinal, regardless of whether such claim is based upon any of the above stated causes of remedies. Results relate only to the samples identified above. This report shall not be reproduced except in full with written approval of Cardinal Laboratories.

Celey D. Keane

Celey D. Keane, Lab Director/Quality Manager

CHAIN-OF-CUSTODY AND ANALYSIS REQUEST

**ARDINAL LABORATORIES**101 East Marland, Hobbs, NM 88240
(505) 393-2326 FAX (505) 393-2476

Company Name: BBC International, Inc.		BILL TO				ANALYSIS REQUEST							
Project Manager: Cliff Brunson		P.O. #:		<div style="writing-mode: vertical-rl; transform: rotate(180deg);"> TPH CHLORIDE OTEX </div>									
Address: P.O. Box 805		Company:											
City: Hobbs State: NM Zip: 88241		Attn:											
Phone #: 575-397-6388 Fax #: 575-397-0397		Address: SAME											
Project #:		Project Owner: STEVE WILSON								City:			
Project Name: ARRESIA ADDITION		State: Zip:											
Project Location: AVALONIA NM		Phone #:											
Sampler Name: ROGER HERZBERG		Fax #:											
FOR LAB USE ONLY				MATRIX		PRESERV		SAMPLING					
Lab I.D.	Sample I.D.	(GRAB OR COMPOUND) # CONTAINERS	GROUNDWATER	WASTEWATER	SOIL	OIL	SLUDGE	OTHER:	ACID/BASE	ICE / COOL	OTHER:	DATE	TIME
H10104													
-1	CELL # 1											8/9/11	12:15
2	CELL # 2											8/9/11	12:35
3	CELL # 3											8/9/11	12:50
4	CELL # 4											8/9/11	1:15
5	CELL # 5											8/9/11	1:39
6	CELL # 5B											8/9/11	2:05
7	CELL # 6											8/9/11	2:35
8	CELL # 6B											8/9/11	3:15

PLEASE NOTE: Liability and Damages. Cardinal Analytical and clients exclude liability for any claim arising hereunder based on information provided to the client by the client for the analysis. All claims including those for negligence and any other cause shall be deemed waived unless made in writing and received by Cardinal within 90 days after completion of the analytical service. There shall be no liability for incidental or consequential damages, including without limitation, business interruptions, loss of use, or loss of profits incurred by client, its subsidiaries, affiliates or successors, or any other party related to the performance of services hereunder. Cardinal Analytical and clients shall be deemed to have agreed to the above stated terms and conditions.

Relinquished By: <i>[Signature]</i>	Date: 8/9/11 Time: 5:03	Received By: <i>[Signature]</i>	Phone Result: <input type="checkbox"/> Yes <input type="checkbox"/> No	Add'l Phone #:
Relinquished By:	Date:	Received By:	Fax Result: <input type="checkbox"/> Yes <input type="checkbox"/> No	Add'l Fax #:
Delivered By: (Circle One) Sampler - UPS - Bus - Other:			REMARKS: 8/9/11 5:40 * Roger called & changed analysis from CL- to OTEX. <i>[Signature]</i>	
Sample Condition: Cool <input type="checkbox"/> Intact <input type="checkbox"/> <input type="checkbox"/> Yes <input type="checkbox"/> No <input type="checkbox"/> Yes <input type="checkbox"/> No		CHECKED BY: <i>[Signature]</i>		

† Cardinal cannot accept verbal changes. Please fax written changes to 505-393-2476

#26

08/15/2011 MON 07:58

[TX/RX NO 8685]

011

011

LONESTAR CONSTRUCTION

08/15/2011 13:27 FAX 5753910778

Artesia Area
~~LONESTAR CONSTRUCTION, LLC~~

FACSIMILE TRANSMITTAL COVER SHEET

TO: Brad Jones

FAX#: 505-476-3462

NUMBER OF PAGES INCLUDING COVER SHEET: 12

FROM: JIM WILSON

FAX#: 575-391-0778

PHONE#: 575-631-2442

MESSAGE:

The information contained in this facsimile message is privileged and confidential information intended for the use of the individual or entity named above. If the reader of this message is not the intended recipient, or the employee or agent responsible to deliver it to the intended recipient, you are hereby notified that any dissemination, distribution or copying of this communication is strictly prohibited. If you have received this communication in error, please immediately notify us by telephone so we may arrange to retrieve this transmission at no cost to you.



PHONE (575) 393-2326 • 101 E. MARLAND • HOBBS, NM 88240

April 21, 2011

Cliff Brunson
BBC International, Inc.
P.O. Box 805
Hobbs, NM 88241

RE: ARTESIA AERATION LLC

Enclosed are the results of analyses for samples received by the laboratory on 04/19/11 14:06.

Cardinal Laboratories is accredited through Texas NELAP for:

Method SW-846 8021	Benzene, Toluene, Ethyl Benzene, and Total Xylenes
Method SW-846 8260	Benzene, Toluene, Ethyl Benzene, and Total Xylenes
Method TX 1005	Total Petroleum Hydrocarbons

Certificate number T104704398-08-TX. Accreditation applies to solid and chemical materials and non-potable water matrices.

Cardinal Laboratories is accredited through the State of Colorado Department of Public Health and Environment for:

Method EPA 552.2	Haloacetic Acids (HAA-5)
Method EPA 524.2	Total Trihalomethanes (TTHM)
Method EPA 524.4	Regulated VOCs (V2, V3)

Accreditation applies to public drinking water matrices.

This report meets NELAP requirements and is made up of a cover page, analytical results, and a copy of the original chain-of-custody. If you have any questions concerning this report, please feel free to contact me.

Sincerely,

A handwritten signature in cursive script that reads "Celey D. Keene".

Celey D. Keene
Lab Director/Quality Manager



PHONE (575) 393-2326 • 101 E. MARLAND • HOBBS, NM 88240

Analytical Results For:

BBC International, Inc.
 Cliff Brunson
 P.O. Box 805
 Hobbs NM, 88241
 Fax To: (505) 397-0397

Received:	04/19/2011	Sampling Date:	04/13/2011
Reported:	04/21/2011	Sampling Type:	Soil
Project Name:	ARTESIA AERATION LLC	Sampling Condition:	Cool & Intact
Project Number:	NONE GIVEN	Sample Received By:	Jodi Henson
Project Location:	MALJAMAR, NM		

Sample ID: CELL 1 @ 3' (H100792-01)

BTEX 8021B		mg/kg		Analyzed By: CMS						
Analyte	Result	Reporting Limit	Analyzed	Method Blank	BS	% Recovery	True Value QC	RPD	Qualifier	
Benzene*	<0.050	0.050	04/20/2011	ND	2.35	119	2.00	15.9		
Toluene*	0.144	0.050	04/20/2011	ND	2.32	116	2.00	16.4		
Ethylbenzene*	0.066	0.050	04/20/2011	ND	2.31	115	2.00	14.4		
Total Xylenes*	0.169	0.150	04/20/2011	ND	6.84	114	6.00	14.1		

Surrogate: 4-Bromofluorobenzene (PIL)		89.4 %		70-130						
Chloride, SM4500Cl-B		mg/kg		Analyzed By: HM						
Analyte	Result	Reporting Limit	Analyzed	Method Blank	BS	% Recovery	True Value QC	RPD	Qualifier	
Chloride	352	16.0	04/20/2011	ND	416	104	400	3.77		

TPH 801SM		mg/kg		Analyzed By: AB						
Analyte	Result	Reporting Limit	Analyzed	Method Blank	BS	% Recovery	True Value QC	RPD	Qualifier	
GRO C6-C10	<10.0	10.0	04/21/2011	ND	214	107	200	0.816		
DRO >C10-C28	75.8	10.0	04/21/2011	ND	220	110	200	0.774		

Surrogate: 1-Chlorooctane 81.2 % 70-130
 Surrogate: 1-Chlorooctadecane 86.5 % 70-130

Cardinal Laboratories

*=Accredited Analyte

PLEASE NOTE: Liability and Damages. Cardinal's liability and clients exclusive remedy for any claim arising, whether based in contract or tort, shall be limited to the amount paid by client for analysis. All claims, including those for negligence and any other cause whatsoever shall be deemed waived unless made in writing and received by Cardinal within thirty (30) days after completion of the applicable service. In no event shall Cardinal be liable for incidental or consequential damages, including, without limitation, business interruptions, loss of use, or loss of profit incurred by client, its subcontractors, affiliates or successors arising out of or related to the performance of the services hereunder by Cardinal, regardless of whether such claim is based upon any of the above stated reasons or otherwise. Liability shall be limited to the samples identified above. This report shall not be reproduced except in full with written approval of Cardinal Laboratories.

Celey D. Keene, Lab Director/Quality Manager



PHONE (575) 393-2326 • 101 E. MARLAND • HOBBS, NM 88240

Analytical Results For:

BBC International, Inc.
 Cliff Brunson
 P.O. Box 805
 Hobbs NM, 88241
 Fax To: (505) 397-0397

Received:	04/19/2011	Sampling Date:	04/13/2011
Reported:	04/21/2011	Sampling Type:	Soil
Project Name:	ARTESIA AERATION LLC	Sampling Condition:	Cool & Intact
Project Number:	NONE GIVEN	Sample Received By:	Jodi Henson
Project Location:	MALJAMAR, NM		

Sample ID: CELL 2 @ 3' (H100792-02)

BTEX 8021B		mg/kg		Analyzed By: CMS						
Analyte	Result	Reporting Limit	Analyzed	Method Blank	BS	% Recovery	True Value QC	RPD	Qualifier	
Benzene*	<0.050	0.050	04/20/2011	ND	2.35	118	2.00	15.9		
Toluene*	<0.050	0.050	04/20/2011	ND	2.32	116	2.00	16.4		
Ethylbenzene*	<0.050	0.050	04/20/2011	ND	2.31	115	2.00	14.4		
Total Xylenes*	<0.150	0.150	04/20/2011	ND	6.84	114	6.00	14.1		

Surrogate: 4-Bromofluorobenzene (PIL) 94.3 % 70-130

Chloride, SM4500Cl-B		mg/kg		Analyzed By: HM						
Analyte	Result	Reporting Limit	Analyzed	Method Blank	BS	% Recovery	True Value QC	RPD	Qualifier	
Chloride	192	16.0	04/20/2011	ND	416	104	400	3.77		

TPH 8015M		mg/kg		Analyzed By: AB						
Analyte	Result	Reporting Limit	Analyzed	Method Blank	BS	% Recovery	True Value QC	RPD	Qualifier	
GRO C6-C10	<10.0	10.0	04/21/2011	ND	214	107	200	0.816		
DRO >C10-C28	37.0	10.0	04/21/2011	ND	220	110	200	0.774		

Surrogate: 1-Chlorooctane 104 % 70-130

Surrogate: 1-Chlorooctadecane 107 % 70-130

Cardinal Laboratories

*=Accredited Analyte

PLEASE NOTE: Liability and Damages. Cardinal's liability and client's exclusive remedy for any claim arising, whether based in contract or tort, shall be limited to the amount paid by client for analysis. All claims, including those for negligence and any other cause whatsoever shall be deemed waived unless made in writing and received by Cardinal within thirty (30) days after completion of the applicable service. In no event shall Cardinal be liable for incidental or consequential damages, including, without limitation, business interruptions, loss of use, or loss of profits incurred by client, its subsidiaries, affiliates or successors arising out of or related to the performance of the services hereunder by Cardinal, regardless of whether such claim is based upon any of the above stated causes or otherwise. Results relate only to the samples identified above. This report shall not be reproduced except in full with approval of Cardinal Laboratories.

Celey D. Keene, Lab Director/Quality Manager



PHONE (575) 393-2326 • 101 E. MARLAND • HOBBS, NM 88240

Analytical Results For:

BBC International, Inc.
 Cliff Brunson
 P.O. Box 805
 Hobbs NM, 88241
 Fax To: (505) 397-0397

Received:	04/19/2011	Sampling Date:	04/13/2011
Reported:	04/21/2011	Sampling Type:	Soil
Project Name:	ARTESIA AERATION LLC	Sampling Condition:	Cool & Intact
Project Number:	NONE GIVEN	Sample Received By:	Jodi Henson
Project Location:	MALJAMAR, NM		

Sample ID: CELL 3 @ 3' (H100792-03)

STEX 8021B		mg/kg		Analyzed By: CMS						
Analyte	Result	Reporting Limit	Analyzed	Method Blank	BS	% Recovery	True Value QC	RPD	Qualifier	
Benzene*	<0.050	0.050	04/20/2011	ND	2.35	118	2.00	15.9		
Toluene*	<0.050	0.050	04/20/2011	ND	2.32	116	2.00	16.4		
Ethylbenzene*	<0.050	0.050	04/20/2011	ND	2.31	115	2.00	14.4		
Total xylenes*	<0.150	0.150	04/20/2011	ND	6.84	114	6.00	14.1		

Surrogate: 4-Bromofluorobenzene (PIE) 93.3 % 70-130

Chloride, SM4500C-B		mg/kg		Analyzed By: HM						
Analyte	Result	Reporting Limit	Analyzed	Method Blank	BS	% Recovery	True Value QC	RPD	Qualifier	
Chloride	32.0	16.0	04/20/2011	ND	416	104	400	3.77		

TPH 8015M		mg/kg		Analyzed By: AB						
Analyte	Result	Reporting Limit	Analyzed	Method Blank	BS	% Recovery	True Value QC	RPD	Qualifier	
GRD C6-C10	<10.0	10.0	04/21/2011	ND	214	107	200	0.816		
DRO >C10-C28	<10.0	10.0	04/21/2011	ND	220	110	200	0.774		

Surrogate: 1-Chlorooctane 100 % 70-130

Surrogate: 1-Chlorooctadecane 101 % 70-130

Cardinal Laboratories

*=Accredited Analyte

PUBLIC NOTE: Liability and Damages. Cardinal's liability and client's exclusive remedy for any claim arising, whether based in contract or tort, shall be limited to the amount paid by client for analyses. All claims, including those for negligence and any other cause whatsoever shall be deemed waived unless raised in writing and received by Cardinal within thirty (30) days after completion of the applicable parties. In no event shall Cardinal be liable for incidental or consequential damages, including, without limitation, business interruptions, loss of use, or loss of profits incurred by client, its subsidiaries, affiliates or successors arising out of or related to the performance of the services hereunder by Cardinal, regardless of whether such claim is based upon any of the above stated reasons or otherwise. Results relate only to the samples identified above. This report shall not be reproduced without the full written approval of Cardinal Laboratories.

Celey D. Keene, Lab Director/Quality Manager



PHONE (575) 393-2326 • 101 E. MARLAND • HOBBS, NM 88240

Analytical Results For:

BBC International, Inc.
 Cliff Brunson
 P.O. Box 805
 Hobbs NM, 88241
 Fax To: (505) 397-0397

Received: 04/19/2011
 Reported: 04/21/2011
 Project Name: ARTESIA AERATION LLC
 Project Number: NONE GIVEN
 Project Location: MALJAMAR, NM

Sampling Date: 04/13/2011
 Sampling Type: Soil
 Sampling Condition: Cool & Intact
 Sample Received By: Jodi Henson

Sample ID: CELL 4 @ 3' (H100792-04)

BTEX 8021B		mg/kg		Analyzed By: CMS						
Analyte	Result	Reporting Limit	Analyzed	Method Blank	BS	% Recovery	True Value QC	RPD	Qualifier	
Benzene*	<0.050	0.050	04/20/2011	ND	2.35	118	2.00	15.9		
Toluene*	<0.050	0.050	04/20/2011	ND	2.32	116	2.00	16.4		
Ethylbenzene*	<0.050	0.050	04/20/2011	ND	2.31	115	2.00	14.4		
Total Xylenes*	<0.150	0.150	04/20/2011	ND	6.84	114	6.00	14.1		

Surrogate: 4-Bromofluorobenzene (PIL) 95.5 % 70-130

Chloride, SM4300Cl-B		mg/kg		Analyzed By: HM						
Analyte	Result	Reporting Limit	Analyzed	Method Blank	BS	% Recovery	True Value QC	RPD	Qualifier	
Chloride	608	16.0	04/20/2011	ND	416	104	400	3.77		

TPH 8015M		mg/kg		Analyzed By: AB						
Analyte	Result	Reporting Limit	Analyzed	Method Blank	BS	% Recovery	True Value QC	RPD	Qualifier	
GRO C6-C10	<10.0	10.0	04/21/2011	ND	214	107	200	0.816		
DRO >C10-C28	160	10.0	04/21/2011	ND	220	110	200	0.774		

Surrogate: 1-Chlorooctane 84.4 % 70-130

Surrogate: 1-Chlorooctadecane 86.7 % 70-130

Cardinal Laboratories

*=Accredited Analyte

PLEASE NOTE: Liability and Damages. Cardinal's liability and client's exclusive remedy for any claim arising, whether based in contract or tort, shall be limited to the amount paid by client for analysis. All claims, including those for negligence and any other cause whatsoever shall be deemed waived unless made in writing and received by Cardinal within thirty (30) days after completion of the applicable service. In no event shall Cardinal be liable for incidental or consequential damages, including, without limitation, business interruptions, loss of use, or loss of profits incurred by client, its subsidiaries, affiliates or successors arising out of or relating to the performance of the services hereunder by Cardinal, regardless of whether such claim is based upon any of the above stated reasons or otherwise. Results apply only to the samples identified above. This report shall not be reproduced except in full with written approval of Cardinal Laboratories.

Caley D. Keene, Lab Director/Quality Manager



PHONE (575) 393-2326 • 101 E. MARLAND • HOBBS, NM 88240

Analytical Results For:

BBC International, Inc.
 Cliff Brunson
 P.O. Box 805
 Hobbs NM, 88241
 Fax To: (505) 397-0397

Received:	04/19/2011	Sampling Date:	04/13/2011
Reported:	04/21/2011	Sampling Type:	Soil
Project Name:	ARTESIA AERATION LLC	Sampling Condition:	Cool & Intact
Project Number:	NONE GIVEN	Sample Received By:	Jodi Henson
Project Location:	MALJAMAR, NM		

Sample ID: CELL 5 @ 3' (H100792-05)

BTEX 8021B		mg/kg		Analyzed By: CMS						
Analyte	Result	Reporting Limit	Analyzed	Method Blank	BS	% Recovery	True Value QC	RPD	Qualifier	
Benzene*	<0.050	0.050	04/20/2011	ND	2.35	118	2.00	15.9		
Toluene*	<0.050	0.050	04/20/2011	ND	2.32	116	2.00	16.4		
Ethylbenzene*	<0.050	0.050	04/20/2011	ND	2.31	115	2.00	14.4		
Total Xylenes*	<0.150	0.150	04/20/2011	ND	6.84	114	6.00	14.1		

Surrogate: 4-Bromofluorobenzene (PIL) 95.9% 70-130

Chloride, SMASOCl-B		mg/kg		Analyzed By: MM						
Analyte	Result	Reporting Limit	Analyzed	Method Blank	BS	% Recovery	True Value QC	RPD	Qualifier	
Chloride	816	16.0	04/20/2011	ND	416	104	400	3.77		

TPH 8015M		mg/kg		Analyzed By: AB						
Analyte	Result	Reporting Limit	Analyzed	Method Blank	BS	% Recovery	True Value QC	RPD	Qualifier	
GRO C6-C10	<10.0	10.0	04/21/2011	ND	214	107	200	0.816		
DRO >C10-C28	203	10.0	04/21/2011	ND	220	110	200	0.774		

Surrogate: 1-Chlorooctane 92.5% 70-130

Surrogate: 1-Chlorooctadecane 93.1% 70-130

Cardinal Laboratories

*=Accredited Analyte

PLEASE NOTE: Liability and Damages. Cardinal's liability and client's exclusive remedy for any claim arising, whether based in contract or tort, shall be limited to the amount paid by client for analysis. All claims, including those for negligence and any other cause whatsoever shall be deemed waived unless made in writing and received by Cardinal within thirty (30) days after completion of the applicable services. In no event shall Cardinal be liable for incidental or consequential damages, including, without limitation, business interruptions, loss of use, or loss of profits incurred by client, its subsidiaries, affiliates or successors arising out of or related to the performance of the services hereunder by Cardinal, regardless of whether such claim is based upon any of the above stated claims or otherwise. Results relate only to the samples identified above. This report shall not be reproduced or used in full without written approval of Cardinal Laboratories.

Celey D. Keene, Lab Director/Quality Manager



PHONE (575) 393-2326 * 101 E. MARLAND * HOBBS, NM 88240

Analytical Results For:

BBC International, Inc.
 Cliff Brunson
 P.O. Box 805
 Hobbs NM, 88241
 Fax To: (505) 397-0397

Received:	04/19/2011	Sampling Date:	04/13/2011
Reported:	04/21/2011	Sampling Type:	Soil
Project Name:	ARTESIA AERATION LLC	Sampling Condition:	Cool & Intact
Project Number:	NONE GIVEN	Sample Received By:	Jodi Henson
Project Location:	MALJAMAR, NM		

Sample ID: CELL 5B @ 3' (H100792-06)

BTEX 8021B		mg/kg		Analyzed By: CMS						
Analyte	Result	Reporting Limit	Analyzed	Method Blank	BS	% Recovery	True Value QC	RPD	Qualifier	
Benzene*	<0.050	0.050	04/20/2011	ND	2.35	118	2.00	15.9		
Toluene*	<0.050	0.050	04/20/2011	ND	2.32	115	2.00	16.4		
Ethylbenzene*	<0.050	0.050	04/20/2011	ND	2.31	115	2.00	14.4		
Total Xylenes*	<0.150	0.150	04/20/2011	ND	6.84	114	6.00	14.1		

Chloride, SM4500C-B		mg/kg		Analyzed By: HM						
Analyte	Result	Reporting Limit	Analyzed	Method Blank	BS	% Recovery	True Value QC	RPD	Qualifier	
Chloride	32.0	16.0	04/20/2011	ND	416	104	400	3.77		

TPH 8015M		mg/kg		Analyzed By: AB						
Analyte	Result	Reporting Limit	Analyzed	Method Blank	BS	% Recovery	True Value QC	RPD	Qualifier	
GRO C6-C10	<10.0	10.0	04/21/2011	ND	214	107	200	0.816		
DRO >C10-C28	10.3	10.0	04/21/2011	ND	220	110	200	0.774		

Surrogate: 1-Chlorooctane 100 % 70-130
 Surrogate: 1-Chlorodecane 103 % 70-130

Cardinal Laboratories

*=Accredited Analyte

PLEASE NOTE: Liability and Damages. Cardinal's liability and client's exclusive remedy for any claim arising, whether based in contract or tort, shall be limited to the amount paid by client for analysis. All claims, including those for negligence and any other cause whatsoever shall be deemed waived unless made in writing and received by Cardinal within thirty (30) days after completion of the applicable service. In no event shall Cardinal be liable for incidental or consequential damages, including, without limitation, business interruptions, loss of use, or loss of profits incurred by client, its subsidiaries, affiliates or successors arising out of or related to the performance of the services rendered by Cardinal, regardless of whether such claim is based upon any of the above stated warranties or otherwise. Results are only for the samples identified above. This report shall not be reproduced, revised or used without approval of Cardinal Laboratories.

Celey D. Keene, Lab Director/Quality Manager



PHONE (575) 393-2326 • 101 E. MARLAND • HOBBS, NM 88240

Analytical Results For:

BBC International, Inc.
 Cliff Brunson
 P.O. Box 805
 Hobbs NM, 88241
 Fax To: (505) 397-0397

Received:	04/19/2011	Sampling Date:	04/13/2011
Reported:	04/21/2011	Sampling Type:	Soil
Project Name:	ARTESIA AERATION LLC	Sampling Condition:	Cool & Intact
Project Number:	NONE GIVEN	Sample Received By:	Jodi Henson
Project Location:	MALJAMAR, NM		

Sample ID: CELL 6 @ 3' (H100792-07)

BTEX 8021B		mg/kg		Analyzed By: CMS						
Analyte	Result	Reporting Limit	Analyzed	Method Blank	BS	% Recovery	True Value QC	RPD	Qualifier	
Benzene*	<0.050	0.050	04/20/2011	ND	2.35	118	2.00	15.9		
Toluene*	<0.050	0.050	04/20/2011	ND	2.32	116	2.00	16.4		
Ethylbenzene*	<0.050	0.050	04/20/2011	ND	2.31	115	2.00	14.4		
Total Xylenes*	<0.150	0.150	04/20/2011	ND	6.84	114	6.00	14.1		

Surrogate: 4-Bromofluorobenzene (PIL) 92.1 % 70-130

Chloride, SM4500Cl-B		mg/kg		Analyzed By: NM						
Analyte	Result	Reporting Limit	Analyzed	Method Blank	BS	% Recovery	True Value QC	RPD	Qualifier	
Chloride	400	16.0	04/20/2011	ND	416	104	400	3.77		

TPH 8015M		mg/kg		Analyzed By: AB						
Analyte	Result	Reporting Limit	Analyzed	Method Blank	BS	% Recovery	True Value QC	RPD	Qualifier	
GRO C6-C10	<10.0	10.0	04/21/2011	ND	214	107	200	0.816		
DRO >C10-C28	771	10.0	04/21/2011	ND	220	110	200	0.774		

Surrogate: 1-Chlorooctane 93.5 % 70-130

Surrogate: 1-Chlorooctadecane 99.3 % 70-130

Cardinal Laboratories

Accredited Analyte

PLEASE NOTE: Liability and coverage. Cardinal's liability and coverage exclusive remedy for any claim arising, whether based in contract or tort, shall be limited to the amount paid by client for analysis. All claims, including those for negligence and any other cause whatsoever shall be deemed waived unless made in writing and received by Cardinal within thirty (30) days after completion of the applicable service. In no event shall Cardinal be liable for incidental or consequential damages, including, without limitation, business interruptions, loss of use, or loss of profits incurred by client, its subsidiaries, affiliates or successors arising out of or related to the performance of the services hereunder by Cardinal, regardless of whether such claim is based upon any of the above stated reasons or otherwise. Results relate only to the samples identified above. This report shall not be reproduced except by full written approval of Cardinal Laboratories.

Celey D. Keene, Lab Director/Quality Manager



PHONE (575) 393-2326 • 101 E. MARLAND • HOBBS, NM 88240

Analytical Results For:

BBC International, Inc.
 Cliff Brunson
 P.O. Box 805
 Hobbs NM, 88241
 Fax To: (505) 397-0397

Received:	04/19/2011	Sampling Date:	04/13/2011
Reported:	04/21/2011	Sampling Type:	Soil
Project Name:	ARTESIA AERATION LLC	Sampling Condition:	Cool & Intact
Project Number:	NONE GIVEN	Sample Received By:	Jodi Henson
Project Location:	MALJAMAR, NM		

Sample ID: CELL 6B @ 3' (H100792-08)

BTEX 8021B		mg/kg		Analyzed By: CMS						
Analyte	Result	Reporting Limit	Analyzed	Method Blank	BS	% Recovery	True Value QC	RPD	Qualifier	
Benzene*	<0.050	0.050	04/20/2011	ND	2.35	118	2.00	15.9		
Toluene*	<0.050	0.050	04/20/2011	ND	2.32	116	2.00	16.4		
Ethylbenzene*	<0.050	0.050	04/20/2011	ND	2.31	115	2.00	14.4		
Total Xylenes*	<0.150	0.150	04/20/2011	ND	6.84	114	6.00	14.1		

Surrogate: 4-Bromofluorobenzene (PIL) 92.3 % 70-130

Chloride, SM4500Cl-B		mg/kg		Analyzed By: HM						
Analyte	Result	Reporting Limit	Analyzed	Method Blank	BS	% Recovery	True Value QC	RPD	Qualifier	
Chloride	1090	16.0	04/20/2011	ND	416	104	400	3.77		

TPH 8015M		mg/kg		Analyzed By: AB						
Analyte	Result	Reporting Limit	Analyzed	Method Blank	BS	% Recovery	True Value QC	RPD	Qualifier	
GRO C6-C10	<10.0	10.0	04/21/2011	ND	214	107	200	0.816		
DRO >C10-C28	202	10.0	04/21/2011	ND	220	110	200	0.774		

Surrogate: 1-Chloronaphthalene 94.7 % 70-130

Surrogate: 1-Chlorooctadecane 111 % 70-130

Cardinal Laboratories

*=Accredited Analyte

PLEASE NOTE: Liability and Damages: CARDINAL'S LIABILITY AND CLIENT'S REMEDY FOR ANY CLAIM ARISING, WHETHER BASED IN CONTRACT OR TORT, SHALL BE LIMITED TO THE AMOUNT PAID BY CLIENT FOR ANALYSIS. ALL CLAIMS, INCLUDING THOSE FOR NEGLIGENCE AND ANY OTHER CAUSE WHATSOEVER, SHALL BE DEEMED WAIVED UNLESS MADE IN WRITING AND RECEIVED BY CARDINAL WITHIN TWENTY (20) DAYS AFTER COMPLETION OF THE APPLICABLE SERVICE. IN NO EVENT SHALL CARDINAL BE LIABLE FOR INCIDENTAL OR CONSEQUENTIAL DAMAGES, INCLUDING, WITHOUT LIMITATION, BUSINESS INTERRUPTION, LOSS OF USE, OR LOSS OF PROFIT INCURRED BY CLIENT, ITS SUBSIDIARIES, AFFILIATES OR SUCCESSORS ARISING OUT OF OR RELATED TO THE PERFORMANCE OF THE SERVICES HEREUNDER BY CARDINAL, REGARDLESS OF WHETHER SUCH CLAIM IS BASED UPON ANY OF THE ABOVE CITED REASONS OR OTHERWISE. RESULTS RELATE ONLY TO THE SAMPLES IDENTIFIED ABOVE. THIS REPORT SHALL NOT BE REPRODUCED EXCEPT IN FULL WITH WRITTEN APPROVAL OF CARDINAL LABORATORIES.

Celey D. Keene, Lab Director/Quality Manager





CHAIN-OF-CUSTODY AND ANALYSIS REQUEST

101 East Marland, Hobbs, NM 88240
(575) 393-2326 FAX (575) 393-2476

Company Name: BBC International		BILL TO		ANALYSIS REQUEST											
Project Manager: Cliff Branson		P.O. #:													
Address: 1324		Company:													
City: Hobbs State: NM Zip: 88240		Attn: SAME													
Phone #: _____ Fax #: _____		Address: SAME													
Project #: _____ Project Owner: _____		City: _____													
Project Name: Artesia Aeration		State: _____ Zip: _____													
Project Location: Alamogordo NH		Phone #: _____													
Sampler Name: Regen Headers		Fax #: _____													

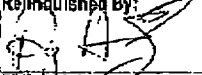
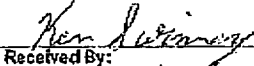
Lab I.D.	Sample I.D.	CONTAINERS (GRAB OR C/COMP)	MATRIX					PRESERV		SAMPLING		DATE	TIME	TPH	BTEX	CL-
			GROUNDWATER	WASTEWATER	SOIL	SOIL	SLUDGE	OTHER	ACID/BASE	ICE/COOL	OTHER					
#1001921	CELL 1 @ 3'	G1									4-13-11	1:10	/	/	/	
2	CELL 2 @ 3'	G1									4-13-11	1:30	/	/	/	
3	CELL 3 @ 3'	G1									4-13-11	1:50	/	/	/	
4	CELL 4 @ 3'	G1									4-13-11	2:05	/	/	/	
5	CELL 5 @ 3'	G1									4-13-11	2:20	/	/	/	
6	CELL 5b @ 3'	G1									4-13-11	2:40	/	/	/	
7	CELL 6 @ 3'	G1									4-13-11	2:55	/	/	/	
8	CELL 6b @ 3'	G1									4-13-11	3:20	/	/	/	

PLEASE NOTE: Liability and Damages. Cardinal's liability and client's exclusive remedy for any data analysis is based on contract or tort, shall be limited to the amount paid by the client for the analysis. All data is subject to audit and other cause of action shall be deemed waived unless made in writing and received by Cardinal within 30 days after completion of the analytical service. No warranty is made for incidental or consequential damages, including without limitation, business interruption, loss of use, or loss of profits incurred by client. The laboratories, suppliers or processors of data or other related to the performance of analysis are not held liable by Cardinal, suppliers of value for such data is based upon any of the above stated reasons or otherwise.

Relinquished By: 	Date: 4-14-11	Received By: 	Phone Result: <input type="checkbox"/> Yes <input type="checkbox"/> No Add'l Phone #:
Relinquished By: 	Date: 4-13-11	Received By: 	Fax Result: <input type="checkbox"/> Yes <input type="checkbox"/> No Add'l Fax #:
Delivered By: (Circle One)	Time: 4:00	Time: 2:06	REMARKS:
Sampler - UPS - Bus - Other:	Sample Condition: -40	CHECKED BY: 	

† Cardinal cannot accept verbal changes. Please fax written changes to 505-393-2476

011 LONESTAR CONSTRUCTION 04/22/2011 FRI 07:01 [TX/RX NO 8608] 011 28/28 12:58 FAX 5753910778 11/11

04/21/2011 19:25 5053970997 BBC INTERNATIONAL PAGE 11/11



PHONE (575) 393-2326 • 101 E. MARLAND • HOBBS, NM 88240

Analytical Results For:

BBC International, Inc.
 Cliff Brunson
 P.O. Box 805
 Hobbs NM, 88241
 Fax To: (505) 397-0397

Received: 04/19/2011
 Reported: 04/21/2011
 Project Name: ARTESIA AERATION LLC
 Project Number: NONE GIVEN
 Project Location: MALJAMAR, NM

Sampling Date: 04/13/2011
 Sampling Type: Soil
 Sampling Condition: Cool & Intact
 Sample Received By: Jodi Henson

Sample ID: CELL 6B @ 3' (H100792-08)

BTEX 8021B		mg/kg		Analyzed By: CMS						
Analyte	Result	Reporting Limit	Analyzed	Method Blank	BS	% Recovery	True Value QC	RPD	Qualifier	
Benzene*	<0.050	0.050	04/20/2011	ND	2.35	118	2.00	15.9		
Toluene*	<0.050	0.050	04/20/2011	ND	2.32	116	2.00	16.4		
Ethylbenzene*	<0.050	0.050	04/20/2011	ND	2.31	115	2.00	14.4		
Total Xylenes*	<0.150	0.150	04/20/2011	ND	6.84	114	6.00	14.1		

Surrrogate: 4-Bromofluorobenzene (PIL) 92.3 % 70-130

Chloride, SM4500Cl-B		mg/kg		Analyzed By: HM						
Analyte	Result	Reporting Limit	Analyzed	Method Blank	BS	% Recovery	True Value QC	RPD	Qualifier	
Chloride	1090	16.0	04/20/2011	ND	416	104	400	3.77		

TPH 8015M		mg/kg		Analyzed By: AB						
Analyte	Result	Reporting Limit	Analyzed	Method Blank	BS	% Recovery	True Value QC	RPD	Qualifier	
GRO C6-C10	<10.0	10.0	04/21/2011	ND	214	107	200	0.816		
DRO >C10-C28	202	10.0	04/21/2011	ND	220	110	200	0.774		

Surrrogate: 1-Chlorooctane 94.7 % 70-130

Surrrogate: 1-Chlorooctadecane 111 % 70-130

Cardinal Laboratories

*=Accredited Analyte

PLEASE NOTE: Liability and Damages. Cardinal's liability and client's exclusive remedy for any claim arising, whether based in contract or tort, shall be limited to the amount paid by client for analysis. All claims, including those for negligence and any other cause whatsoever shall be deemed waived unless made in writing and received by Cardinal within thirty (30) days after completion of the applicable service. In no event shall Cardinal be liable for incidental or consequential damages, including, without limitation, business interruptions, loss of use, or loss of profits incurred by client, its subsidiaries, affiliates or successors arising out of or related to the performance of the services hereunder by Cardinal, regardless of whether such claim is based upon any of the above stated remedies or otherwise. Results relate only to the samples identified above. This report shall not be reproduced except in full with written approval of Cardinal Laboratories.

Celey D. Keene, Lab Director/Quality Manager

Attn: BRAD JONES

From:

ARTESIA AREA TION



PHONE (575) 393-2326 • 201 E. MARLAND • HOBBS, NM 88240

Analytical Results For:

BBC International, Inc.
 Cliff Brunson
 P.O. Box 805
 Hobbs NM, 88241
 Fax To: (505) 397-0397

Received:	02/09/2011	Sampling Date:	02/08/2011
Reported:	02/11/2011	Sampling Type:	Soil
Project Name:	ARTESIA AERATION LLC	Sampling Condition:	Cool & Intact
Project Number:	NONE GIVEN	Sample Received By:	Jodi Henson
Project Location:	MALJAMAR, NM		

Sample ID: CELL 1 @ 3' (H100253-02)

BTEX 8021B		mg/kg		Analyzed By: CMS						
Analyte	Result	Reporting Limit	Analyzed	Method Blank	BS	% Recovery	True Value QC	RPD	Qualifier	
Benzene*	0.172	0.050	02/10/2011	ND	2.22	111	2.00	21.6		
Toluene*	0.055	0.050	02/10/2011	ND	2.22	111	2.00	22.9		
Ethylbenzene*	<0.050	0.050	02/10/2011	ND	2.27	114	2.00	23.4		
Total Xylenes*	<0.150	0.150	02/10/2011	ND	6.68	111	6.00	23.0		

Surrogate: 4-Bromofluorobenzene (PIL) 90.9 % 70-130

Chloride, SM4500Cl-B		mg/kg		Analyzed By: HM						
Analyte	Result	Reporting Limit	Analyzed	Method Blank	BS	% Recovery	True Value QC	RPD	Qualifier	
Chloride	272	16.0	02/10/2011	ND	432	108	400	3.77		

TPH 8015M

TPH 8015M		mg/kg		Analyzed By: AB						
Analyte	Result	Reporting Limit	Analyzed	Method Blank	BS	% Recovery	True Value QC	RPD	Qualifier	
GRO C6-C10	156	100	02/10/2011	ND	201	101	200	1.33		
DRO >C10-C28	9980	100	02/10/2011	ND	199	99.7	200	2.54		

Surrogate: 1-Chlorooctane 99.3 % 70-130

Surrogate: 1-Chlorooctadecane 94.2 % 70-130

Cardinal Laboratories

*=Accredited Analyte

PLEASE NOTE: Cardinal Laboratories, Inc. and its employees shall not be held liable for any data arising, whether based in contract or tort, shall be limited to the amount paid by client for analysis. All data, including data for analytical and any other cause whatsoever shall be deemed waived unless made in writing and received by Cardinal within thirty (30) days after completion of the applicable service. In no event shall Cardinal be liable for accidental or consequential damages, including, without limitation, business interruption, loss of use, or loss of profits incurred by client, its subsidiaries, affiliates or successors acting out of or related to the performance of the services hereunder by Cardinal, regardless of whether such claim is based in contract or tort or any other cause whatsoever. Results relate only to the samples identified above. This report shall not be reproduced except in full with written approval of Cardinal Laboratories.

Coley D. Keene, Lab Director/Quality Manager



PHONE (575) 303-2326 • 101 E. MARLAND • HOBBS, NM 88240

Analytical Results For:

BBC International, Inc.
 Cliff Brunson
 P.O. Box 805
 Hobbs NM, 88241
 Fax To: (505) 397-0397

Received:	02/09/2011	Sampling Date:	02/08/2011
Reported:	02/11/2011	Sampling Type:	Soil
Project Name:	ARTESIA AERATION LLC	Sampling Condition:	Cool & Intact
Project Number:	NONE GIVEN	Sample Received By:	Jodi Menson
Project Location:	MALJAMAR, NM		

Sample ID: CELL 1 @ 3' (H100253-02)

BTEX 8021B		mg/kg		Analyzed By: CMS						
Analyte	Result	Reporting Limit	Analyzed	Method Blank	BS	% Recovery	True Value QC	RPD	Qualifier	
Benzene*	0.172	0.050	02/10/2011	ND	2.22	111	2.00	21.6		
Toluene*	0.055	0.050	02/10/2011	ND	2.22	111	2.00	22.9		
Ethylbenzene*	<0.050	0.050	02/10/2011	ND	2.27	114	2.00	23.4		
Total Xylenes*	<0.150	0.150	02/10/2011	ND	6.68	111	6.00	23.0		

Surrogate: 4-Bromofluorobenzene (PIL) 90.9 % 70-130

Chloride, SM4500Cl-B		mg/kg		Analyzed By: HM						
Analyte	Result	Reporting Limit	Analyzed	Method Blank	BS	% Recovery	True Value QC	RPD	Qualifier	
Chloride	272	16.0	02/10/2011	ND	432	108	400	3.77		

TPH 8015M

TPH 8015M		mg/kg		Analyzed By: AB						
Analyte	Result	Reporting Limit	Analyzed	Method Blank	BS	% Recovery	True Value QC	RPD	Qualifier	
GRO C6-C10	156	100	02/10/2011	ND	201	101	200	1.33		
DRO >C10-C28	9980	100	02/10/2011	ND	199	99.7	200	2.54		

Surrogate: 1-Chlorooctane 99.9 % 70-130

Surrogate: 1-Chlorooctadecane 94.2 % 70-130

Cardinal Laboratories

*=Accredited Analyte

DISCLAIMER NOTICE: Liability and Damages. Cardinal's liability and client's exclusive remedy for any claim arising, whether based in contract or tort, shall be limited to the amount paid by client for analyses. All claims, including those for negligent bill any other cause whatsoever shall be deemed waived unless made in writing and received by Cardinal within thirty (30) days after completion of the applicable service. In no event shall Cardinal be liable for incidental or consequential damages, including, without limitation, business interruptions, loss of use, or loss of profits incurred by client, its subsidiaries, affiliates or successors arising out of or related to the performance of the service hereunder by Cardinal, regardless of whether such claim is based upon any of the above stated causes of damages. Results relate only to the samples identified above. This report shall not be reproduced except in full with written approval of Cardinal Laboratories.

Celest D. Keene

Celest D. Keene, Lab Director/Quality Manager



PHONE (575) 298-2326 • 103 E. MARLAND • MC986, NM 88249

Analytical Results For:

BBC International, Inc.
Cliff Brunson
P.O. Box 805
Hobbs NM, 88241
Fax To: (505) 397-0397

Received:	02/09/2011	Sampling Date:	02/08/2011
Reported:	02/11/2011	Sampling Type:	Soil
Project Name:	ARTESIA AERATION LLC	Sampling Condition:	Cool & Intact
Project Number:	NONE GIVEN	Sample Received By:	Jodi Henson
Project Location:	MALJAMAR, NM		

Sample ID: CELL 3 @ 3' (M100253-06)

BTEX 8021B		mg/kg		Analyzed By: CMS						
Analyte	Result	Reporting Limit	Analyzed	Method Blank	BS	% Recovery	True Value QC	RPD	Qualifier	
Benzene*	<0.050	0.050	02/10/2011	ND	2.22	111	2.00	21.6		
Toluene*	<0.050	0.050	02/10/2011	ND	2.22	111	2.00	22.9		
Ethylbenzene*	<0.050	0.050	02/10/2011	ND	2.27	114	2.00	23.4		
Total Xylenes*	<0.150	0.150	02/10/2011	ND	6.68	111	6.00	29.0		

Surrogate: 4-Bromofluorobenzene (PIL) 98.8 % 70-130

Chloride, SM4500Cl-B		mg/kg		Analyzed By: NM						
Analyte	Result	Reporting Limit	Analyzed	Method Blank	BS	% Recovery	True Value QC	RPD	Qualifier	
Chloride	272	16.0	02/10/2011	ND	432	108	400	3.77		

TPH 8015M		mg/kg		Analyzed By: AB						
Analyte	Result	Reporting Limit	Analyzed	Method Blank	BS	% Recovery	True Value QC	RPD	Qualifier	
GRO C6-C10	<50.0	50.0	02/10/2011	ND	201	101	200	1.33		
DRO >C10-C28	274	50.0	02/10/2011	ND	199	99.7	200	2.54		

Surrogate: 1-Chlorooctane 98.6 % 70-130

Surrogate: 1-Chlorooctadecane 97.0 % 70-130

Cardinal Laboratories

*=Accredited Analyte

PLEASE NOTE: Liability and Damages. Cardinal's liability and client's exclusive remedy for any claim arising, whether based in contract or tort, shall be limited to the amount paid by client for analysis. All claims, including those for negligence and any other cause whatsoever shall be deemed waived unless made in writing and received by Cardinal within thirty (30) days after completion of the applicable service. In no event shall Cardinal be liable for incidental or consequential damages, including, without limitation, business interruptions, loss of use, or loss of profits incurred by client, its subsidiaries, affiliates or successors arising out of or related to the performance of the services hereunder by Cardinal, regardless of whether such claim is based upon any of the above stated releases or otherwise. Remedies shall not be deemed exhausted by this notice unless authorized by Cardinal, regardless of whether such claim is based upon any of the above stated releases or otherwise.

Caley D. Keene, Lab Director/Quality Manager

Page 7 of 16



PHONE (575) 397-2326 • 101 E. MARLAND • HOORS, NM 88240

Analytical Results For:

BBC International, Inc.
Cliff Brunson
P.O. Box 805
Hobbs NM, 88241
Fax To: (505) 397-0397

Received:	02/09/2011	Sampling Date:	02/08/2011
Reported:	02/11/2011	Sampling Type:	Soil
Project Name:	ARTESIA AERATION LLC	Sampling Condition:	Cool & Intact
Project Number:	NONE GIVEN	Sample Received By:	Jadl Henson
Project Location:	MALJAMAR, NM		

Sample ID: CELL 4 @ 3' (H100253-06)

BTX 8021B		mg/kg		Analyzed By: CMS						
Analyte	Result	Reporting Limit	Analyzed	Method Blank	BS	% Recovery	True Value QC	RPD	Qualifier	
Benzene*	<0.050	0.050	02/10/2011	ND	2.22	111	2.00	21.6		
Toluene*	<0.050	0.050	02/10/2011	ND	2.22	111	2.00	22.9		
Ethylbenzene*	<0.050	0.050	02/10/2011	ND	2.27	114	2.00	23.4		
Total Xylenes*	<0.150	0.150	02/10/2011	ND	6.68	111	6.00	23.0		

Surrogate: 4-Bromofluorobenzene (PIL) 94.5 % 70-130

Chloride, SM4500Cl-B		mg/kg		Analyzed By: MM						
Analyte	Result	Reporting Limit	Analyzed	Method Blank	BS	% Recovery	True Value QC	RPD	Qualifier	
Chloride	160	16.0	02/10/2011	ND	432	108	400	3.77		

TFH 8015M		mg/kg		Analyzed By: AB						
Analyte	Result	Reporting Limit	Analyzed	Method Blank	BS	% Recovery	True Value QC	RPD	Qualifier	
GRO C6-C10	<50.0	50.0	02/10/2011	ND	201	101	200	1.33		
DRO >C10-C28	522	50.0	02/10/2011	ND	199	99.7	200	2.54		

Surrogate: 1-Chlorooctane 112 % 70-130

Surrogate: 1-Chlorooctadecane 107 % 70-130

Cardinal Laboratories

*=Accredited Analyte

PLEASE NOTE: Liability and damages. Cardinal's liability and checks are limited to the amount paid by client for analysis. All claims, including those for negligence and any other cause whatsoever shall be deemed waived unless made in writing and received by Cardinal within three (3) days after completion of the analytical services. It is the client's responsibility to make an investigation of commercial damages, including, without limitation, business interruptions, loss of use, or loss of profits incurred by client, its subsidiaries, affiliates or successors arising out of or related to the performance of the services performed by Cardinal, regardless of whether such claim is based upon any of the above stated methods or substances. Sample return may be the recipient's responsibility. This report shall not be reproduced except in full form without approval of Cardinal Laboratories.

Caley D. Keene, Lab Director/Quality Manager



PHONE (575) 393-2226 * 101 E. MARLAND * HOBBS, NM 88240

Analytical Results For:

BBC International, Inc.
 Cliff Brunson
 P.O. Box 805
 Hobbs NM, 88241
 Fax To: (505) 397-0397

Received:	02/09/2011	Sampling Date:	02/08/2011
Reported:	02/11/2011	Sampling Type:	Soil
Project Name:	ARTESIA AERATION LLC	Sampling Condition:	Cool & Intact
Project Number:	NONE GIVEN	Sample Received By:	Jodi Henson
Project Location:	MALJAMAR, NM		

Sample ID: CELL 5B @ 3' (H100253-10)

BTEX 80218		mg/kg		Analyzed By: CMS						
Analyte	Result	Reporting Limit	Analyzed	Method Blank	BS	% Recovery	True Value QC	RPD	Qualifier	
Benzene*	<0.050	0.050	02/10/2011	ND	2.22	111	2.00	21.6		
Toluene*	<0.050	0.050	02/10/2011	ND	2.22	111	2.00	22.9		
Ethylbenzene*	<0.050	0.050	02/10/2011	ND	2.27	114	2.00	23.4		
Total Xylenes*	<0.150	0.150	02/10/2011	ND	6.68	111	6.00	23.0		

Surrogate: 4-Bromofluorobenzene (PIL) 98.5% 70-130

Chloride, SM4500Cl-B		mg/kg		Analyzed By: HM						
Analyte	Result	Reporting Limit	Analyzed	Method Blank	BS	% Recovery	True Value QC	RPD	Qualifier	
Chloride	2160	16.0	02/10/2011	ND	432	108	400	3.77		

TPH 8015M mg/kg Analyzed By: AB

Analyte	Result	Reporting Limit	Analyzed	Method Blank	BS	% Recovery	True Value QC	RPD	Qualifier
GRO C6-C10	<10.0	10.0	02/11/2011	ND	201	101	200	1.33	
DRO >C10-C28	97.2	10.0	02/11/2011	ND	199	99.7	200	2.54	

Surrogate: 1-Chlorooctane 92.1% 70-130
 Surrogate: 1-Chloroodecane 88.8% 70-130

Cardinal Laboratories

*=Accredited Analyte

PLEASE NOTE: Liability and Damages. Cardinal's liability and ability to provide remedy for any claim arising, whether stated in contract or not, shall be limited to the amount paid by client for analysis. All claims, including those for negligence and any other cause whatsoever shall be deemed waived unless made in writing and received by Cardinal within sixty (60) days after completion of the applicable service. In no event shall Cardinal be liable for incidental or consequential damages, including, without limitation, business interruptions, loss of use, or loss of profits incurred by client, its subsidiaries, affiliates or successors arising out of or related to the performance of the services hereunder by Cardinal, regardless of whether such claim is based upon any of the above stated theories of recovery. Results relate only to the samples described herein. This report shall not be reproduced, copied, in full or without approval of Cardinal Laboratories.

Celley D. Keene

Celley D. Keene, Lab Director/Quality Manager



PHONE (505) 393-2326 * 101 E. MARLAND * HOBBS, NM 88240

Analytical Results For:

BBC International, Inc.
 Cliff Brunson
 P.O. Box 805
 Hobbs NM, 88241
 Fax To: (505) 397-0397

Received:	02/09/2011	Sampling Date:	02/08/2011
Reported:	02/11/2011	Sampling Type:	Soil
Project Name:	ARTESIA AERATION LLC	Sampling Condition:	Cool & Intact
Project Number:	NONE GIVEN	Sample Received By:	Jodi Henson
Project Location:	MALJAMAR, NM		

Sample ID: CELL 6B @ 3' (H100253-12)

BTEX 8021B		mg/kg		Analyzed By: CMS					
Analyte	Result	Reporting Limit	Analyzed	Method Blank	BS	% Recovery	True Value QC	RPD	Qualifier
Benzene*	<0.050	0.050	02/10/2011	ND	2.22	111	2.00	21.6	
Toluene*	<0.050	0.050	02/10/2011	ND	2.22	111	2.00	22.9	
Ethylbenzene*	<0.050	0.050	02/10/2011	ND	2.27	114	2.00	23.4	
Total Xylenes*	<0.150	0.150	02/10/2011	ND	6.68	111	6.00	23.0	

Surrogate: 4-Bromofluorobenzene (PIL) 97.3 % 70-130

Chloride, SM4500Cl-B		mg/kg		Analyzed By: HM					
Analyte	Result	Reporting Limit	Analyzed	Method Blank	BS	% Recovery	True Value QC	RPD	Qualifier
Chloride	528	16.0	02/10/2011	ND	432	108	400	3.77	

TPH 8015M		mg/kg		Analyzed By: AB					
Analyte	Result	Reporting Limit	Analyzed	Method Blank	BS	% Recovery	True Value QC	RPD	Qualifier
GRO C6-C10	<50.0	50.0	02/11/2011	ND	201	101	200	1.33	
DRO >C10-C28	714	50.0	02/11/2011	ND	199	99.7	200	2.54	

Surrogate: 1-Chlorooctane 103 % 70-130

Surrogate: 1-Chlorooctadecane 102 % 70-130

Cardinal Laboratories

*=Accredited Analyte

LABORATORY NOTE: Liberty and Demajia, Cardinal's liability and client's exclusive remedy for any claim arising, whether based in contract or tort, shall be limited to the amount paid by client for analysis. All claims, including those for negligence and any other cause whatsoever, shall be deemed waived unless made in writing and received by Cardinal within thirty (30) days after completion of the applicable service. In no event shall Cardinal be liable for incidental or consequential damages, including, without limitation, business interruptions, loss of use, or loss of profit incurred by client, its subsidiaries, affiliates or employees arising out of or related to the performance of the services rendered by Cardinal, regardless of whether such claim is based upon any of the above stated remedies or otherwise. Results relate only to the samples identified above. This report shall not be reproduced without the written approval of Cardinal Laboratories.

Coley D. Keone

Coley D. Keone, Lab Director/Quality Manager

Page 13 of 16

Attn: BRAD JONES

ARTESIA AREATION



PHONE (505) 383-2835 • 305 E. MARLAND • HOBBS, NM 88240

Analytical Results For:

BBC International, Inc.
Cliff Brunson
P.O. Box 805
Hobbs NM, 88241
Fax To: (505) 397-0397

Received:	02/14/2011	Sampling Date:	02/11/2011
Reported:	02/15/2011	Sampling Type:	Soil
Project Name:	ARTESIA AERATION LLC	Sampling Condition:	Cool & Intact
Project Number:	NONE GIVEN	Sample Received By:	Jodi Henson
Project Location:	MALJAMAR, NM		

Sample ID: CELL 5 @ 3' (H100287-01)

BTEX 8021B		mg/kg		Analyzed By: CMS						
Analyte	Result	Reporting Limit	Analyzed	Method Blank	BS	% Recovery	True Value QC	RPD	Qualifier	
Benzene*	0.065	0.050	02/14/2011	ND	2.13	106	2.00	1.96		
Toluene*	<0.050	0.050	02/14/2011	ND	2.12	106	2.00	1.07		
EthylBenzene*	<0.050	0.050	02/14/2011	ND	2.15	107	2.00	1.25		
Total Xylenes*	<0.150	0.150	02/14/2011	ND	6.41	107	6.00	0.261		

Surrogate: 4-Bromofluorobenzene (PIL) 91.3 % 70-130

Chloride, SM4500C-B		mg/kg		Analyzed By: HM						
Analyte	Result	Reporting Limit	Analyzed	Method Blank	BS	% Recovery	True Value QC	RPD	Qualifier	
Chloride	2520	16.0	02/14/2011	ND	416	104	400	10.9		

TPH 8015M		mg/kg		Analyzed By: AB						
Analyte	Result	Reporting Limit	Analyzed	Method Blank	BS	% Recovery	True Value QC	RPD	Qualifier	
GRO C6-C10	<10.0	10.0	02/14/2011	ND	214	107	200	0.929		
DRO >C10-C28	120	10.0	02/14/2011	ND	226	113	200	1.74		

Surrogate: 1-Chlorooctane 77.1 % 70-130

Surrogate: 1-Chloroadecane 102 % 70-130

Cardinal Laboratories

* = Accredited Analyte

MASS NOTE: Liability and Damages: Cardinal's liability and client's exclusive remedy for any cause arising, whether based in contract or tort, shall be limited to the amount paid by client for analyses. All claims, including those for negligence and any other cause whatsoever shall be deemed waived unless made in writing and received by Cardinal within thirty (30) days after completion of the applicable service. In no event shall Cardinal be liable for incidental or consequential damages, including, without limitation, lost profit, loss of use, or loss of profits incurred by client. Its employees, agents or accessories acting out of or related to the performance of the services hereunder by Cardinal, regardless of whether such claim is based upon any of the above stated results or otherwise, shall not be liable to the client. This report shall not be construed or used in any way without approval of Cardinal Laboratories.

Celey D. Keena, Lab Director/Quality Manager

Page 2 of 5



PHONE (972) 893-2328 • 101 E. MAULDAN • HOBBS, NM 88340

Analytical Results For:

BBC International, Inc.
Cliff Brunson
P.O. Box 805
Hobbs NM, 88241
Fax To: (505) 397-0397

Received: 02/14/2011
Reported: 02/15/2011
Project Name: ARTESIA AERATION LLC
Project Number: NONE GIVEN
Project Location: MALJAMAR, NM
Sampling Date: 02/11/2011
Sampling Type: Soil
Sampling Condition: Cool & Intact
Sample Received By: Jodi Henson

Sample ID: CELL 6 @ 3' (H100297-02)

BTEX 80218 mg/kg Analyzed By: CMS

Analyte	Result	Reporting Limit	Analyzed	Method Blank	BS	% Recovery	True Value QC	RPD	Qualifier
Benzene*	<0.050	0.050	02/14/2011	ND	2.13	106	2.00	1.96	
Toluene*	<0.050	0.050	02/14/2011	ND	2.12	106	2.00	1.07	
Ethylbenzene*	<0.050	0.050	02/14/2011	ND	2.15	107	2.00	1.25	
Total Xylenes*	<0.150	0.150	02/14/2011	ND	6.41	107	6.00	0.261	

Surrogate: 4-Bromofluorobenzene (PIL) 96.4 % 70-130

Chloride, SM4500Cl-B mg/kg Analyzed By: HM

Analyte	Result	Reporting Limit	Analyzed	Method Blank	BS	% Recovery	True Value QC	RPD	Qualifier
Chloride	592	16.0	02/14/2011	ND	416	104	400	10.9	

TPM 8015M mg/kg Analyzed By: AB

Analyte	Result	Reporting Limit	Analyzed	Method Blank	BS	% Recovery	True Value QC	RPD	Qualifier
GR0 C6-C10	<50.0	50.0	02/14/2011	ND	214	107	200	0.929	
DRO >C10-C28	664	50.0	02/14/2011	ND	226	113	200	1.74	

Surrogate: 1-Chlorooctane 90.3 % 70-130
Surrogate: 1-Chlorooctadecane 110 % 70-130

Cardinal Laboratories

*=Accredited Analyte

PLEASE NOTE: Quality and integrity. Cardinal's liability and the user's exclusive remedy for any data arising, whether based in contract or tort, shall be limited to the amount paid by client for analyses. All claims, including those for negligence and any other claim whatsoever shall be deemed waived unless made in writing and received by Cardinal within thirty (30) days after completion of the applicable service. In no event shall Cardinal be liable for incidental or consequential damages, including, without limitation, business interruptions, loss of use, or loss of profit incurred by client, its subsidiaries, affiliates or licensees arising out of or related to the performance of the services hereunder by Cardinal, regardless of whether such claim is based upon any of the above stated means of redress. Results relate only to the samples furnished herein. This report shall not be reproduced except in full with written approval of Cardinal Laboratories.

Celest D. Keene

Celest D. Keene, Lab Director/Quality Manager