

1R - 43

# REPORTS

DATE:

11/13/1996

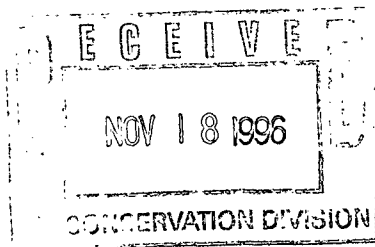

Nov 13, 1996

Mr. William Olson, Hydrogeologist  
State of New Mexico  
Energy, Mineral and Natural Resources Department  
Oil Conservation Division  
2040 S. Pacheco  
Santa Fe, New Mexico 87505

Dear Mr. Olson:

Baker Oil Tools is submitting the fourth required monitoring in response to the NMOCD request of June 20, 1995 to provide quarterly monitoring data for groundwater contamination in the direct vicinity of the former disposal pit on the property located at 2800 W. Marland in Hobbs, New Mexico. The NMOCD requested the following three items from BOT for each monitoring session:

1. A brief description of all monitoring activities which occurred during the quarter.

BOT performed sampling on October 23, 1996. Each well was bailed of three volumes and allowed to equalize prior to sampling except for WW-1 which is a 125' deep water well (only 1 volume was removed). The wells were gauged for depth and bailed on the 23rd with sampling occurring on the 23rd. The Hobbs district office of the NMOCD was notified prior to sampling as required. Samples were packaged and submitted to the laboratory for analysis.

2. A summary of the laboratory analytical results of water quality sampling of the monitoring wells. The data will be presented in tabular form showing past and present sampling results.

Tables 1a through 1g present the sampling data.

Table 1a  
BENZENE (µg/L)

Well ID	Previous Nov. 17, 1994	Quarter 1 July 17, 1995	Quarter 2 October 29, 1995	Quarter 3 January 11, 1996	Quarter 4 April 4, 1996	Quarter 5 July 29, 1996	Quarter 6 October 23, 1996
Trip Blank	<0.5	<2	<2	<0.5	<2.0	NA	<2
MW-1	<0.5	<2	<2	<0.5	<2.0	<1.0	<2
MW-2	<0.5	<2	<2	<0.5	<2.0	<1.0	<2
MW-3	<0.5	<2	<2	<0.5	<2.0	<1.0	<2
WW-1	260	51	<2	0.5	<2.0	6.7	27
R-1	<0.5	<2	<20	1.3	10	1.3	<2

Table 1b  
TOLUENE (µg/L)

Well ID	Previous Nov. 17, 1994	Quarter 1 July 17, 1995	Quarter 2 October 29, 1995	Quarter 3 January 11, 1996	Quarter 4 April 4, 1996	Quarter 5 July 29, 1996	Quarter 6 October 23, 1996
Trip Blank	<0.5	<2	<2	<0.5	<2.0	NA	<2
MW-1	<0.5	<2	<2	<0.5	<2.0	<1.0	<2
MW-2	0.5	<2	<2	<0.5	<2.0	<1.0	<2
MW-3	<0.5	<2	<2	<0.5	<2.0	<1.0	<2
WW-1	1.9	<2	<2	<0.5	<2.0	<1.0	<2
R-1	3.0	<2	<20	1.9	<2.0	1.6	<2

Table 1c  
ETHYL BENZENE (µg/L)

Well ID	Previous Nov. 17, 1994	Quarter 1 July 17, 1995	Quarter 2 October 29, 1995	Quarter 3 January 11, 1996	Quarter 4 April 4, 1996	Quarter 5 July 29, 1996	Quarter 6 October 23, 1996
Trip Blank	<0.5	<2	<2	<0.5	<2.0	NA	<2
MW-1	<0.5	<2	<2	<0.5	<2.0	<1.0	<2
MW-2	<0.5	<2	<2	<0.5	<2.0	<1.0	<2
MW-3	<0.5	<2	<2	<0.5	<2.0	<1.0	<2
WW-1	180	<2	<2	1.0	<2.0	<1.0	7
R-1	49	52	46	40.0	16	45	230

Table 1d  
XYLENE (µg/L)

Well ID	Previous Nov. 17, 1994	Quarter 1 July 17, 1995	Quarter 2 October 26, 1995	Quarter 3 January 11, 1996	Quarter 4 April 4, 1996	Quarter 5 July 29, 1996	Quarter 6 October 23, 1996
Trip Blank	<0.5	<2	<2	<0.5	<2.0	NA	<2
MW-1	1.2	<2	<2	<0.5	<2.0	<1.0	<2
MW-2	0.5	<2	<2	<0.5	<2.0	<1.0	<2
MW-3	0.8	<2	<2	<0.5	<2.0	<1.0	<2
WW-1	7.0	<2	<2	0.6	<2.0	1.8	<2
R-1	94	64	72	67.0	20	41	410

Table 1e  
MTBE (µg/L)

Well ID	Previous Nov. 17, 1994	Quarter 1 July 17, 1995	Quarter 2 October 26, 1995	Quarter 3 January 11, 1996	Quarter 4 April 4, 1996	Quarter 5 July 29, 1996	Quarter 6 October 23, 1996
Trip Blank	<2.5	<2	<2	<2.5	<2.0	NA	<2
MW-1	<2.5	<2	<2	<2.5	<2.0	<10.0	<2
MW-2	<2.5	<2	<2	<2.5	<2.0	<10.0	<2
MW-3	2.6	<2	<2	<2.5	<2.0	<10.0	<2
WW-1	4.1	<2	<2	<2.5	<2.0	<10.0	15
R-1	<2.5	21	<20	<2.5	<2.0	<10.0	<5

Table 1f  
NAPHTHALENE (µg/L)

Well ID	Previous Nov. 17, 1994	Quarter 1 July 17, 1995	Quarter 2 October 28, 1995	Quarter 3 January 11, 1996	Quarter 4 April 4, 1996	Quarter 5 July 29, 1996	Quarter 6 October 23, 1996
Trip Blank	<0.3	<5	not analyzed	<0.5	not analyzed	NA	NA
MW-1	<0.3	<5	<10	<0.5	<5.0	nd	<10
MW-2	<0.3	<5	<10	<0.5	<5.0	nd	<10
MW-3	<0.3	not available*	<10	<0.5	<5.0	nd	<10
WW-1	46	12.9	<10	<0.5	<5.0	nd	<10
R-1	240	101	39.4	140.0	33.0	81	140

\*sample broke during shipment

Table 1g  
2-METHYL NAPHTHALENE (µg/L)

Well ID	Previous Nov. 17, 1994	Quarter 1 July 17, 1995	Quarter 2 October 28, 1995	Quarter 3 January 11, 1996	Quarter 4 April 4, 1996	Quarter 5 July 29, 1996	Quarter 6 October 23, 1996
Trip Blank	<0.3	<5	not analyzed	<1.0	not analyzed	NA	NA
MW-1	<0.3	<5	<10	<1.0	<10.0	nd	<10
MW-2	<0.3	<5	<10	<1.0	<10.0	nd	<10
MW-3	1.0	not available*	<10	<1.0	<10.0	nd	<10
WW-1	14	<5	<10	<1.0	<10.0	nd	<10
R-1	360	115	56.2	170.0	35	113	240

\*sample broke during shipment

3. A ground water elevation map using the water table elevation of the ground water in all monitoring wells.

Figure 1 presents the water elevation data as requested. Table 2 lists the well number, the depth of the well, the depth to the top of the water, the elevation of the well casing and the actual depth to ground water.

The previous quarter sampling was performed by New Mexico Environmental Department (NMED) and those results, which were just received (Nov 12, 1996), are presented as well.

If you have any questions or require additional information, please do not hesitate in contacting me at (713)466-2520.

Sincerely,  
For Baker Oil Tools

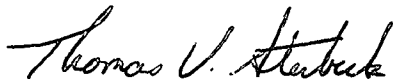

Thomas V. Stenbeck  
Manager of Health, Safety and Environment

Table 2  
Ground Water Elevation Data

Well ID	Well Elevation	Quarter 1	Quarter 2	Quarter 3	Quarter 4	Quarter 5	Quarter 6						
	Depth	gauged depth	actual depth	gauged depth	actual depth	gauged depth	actual depth						
MW-1	46.0	33.2	66.99	32.5	67.69	32.32	67.87	32.7	67.49	32.96	67.23	33.10	67.09
MW-2	45.7	32.5	67.06	32.0	67.56	31.97	67.59	32.4	67.16	32.63	66.93	32.70	66.86
MW-3	39.3	32.7	66.45	32.0	67.15	31.55	67.60	32.0	67.15	32.26	66.89	32.30	66.85
WW-1	125.0	32.3	67.22	31.8	67.72	31.65	67.87	32.0	67.52	32.34	67.18	32.40	67.12
R-1	40.0	33.0	67.03	32.8	67.23	32.24	67.79	32.9	67.13	32.96	67.07	33.10	66.93

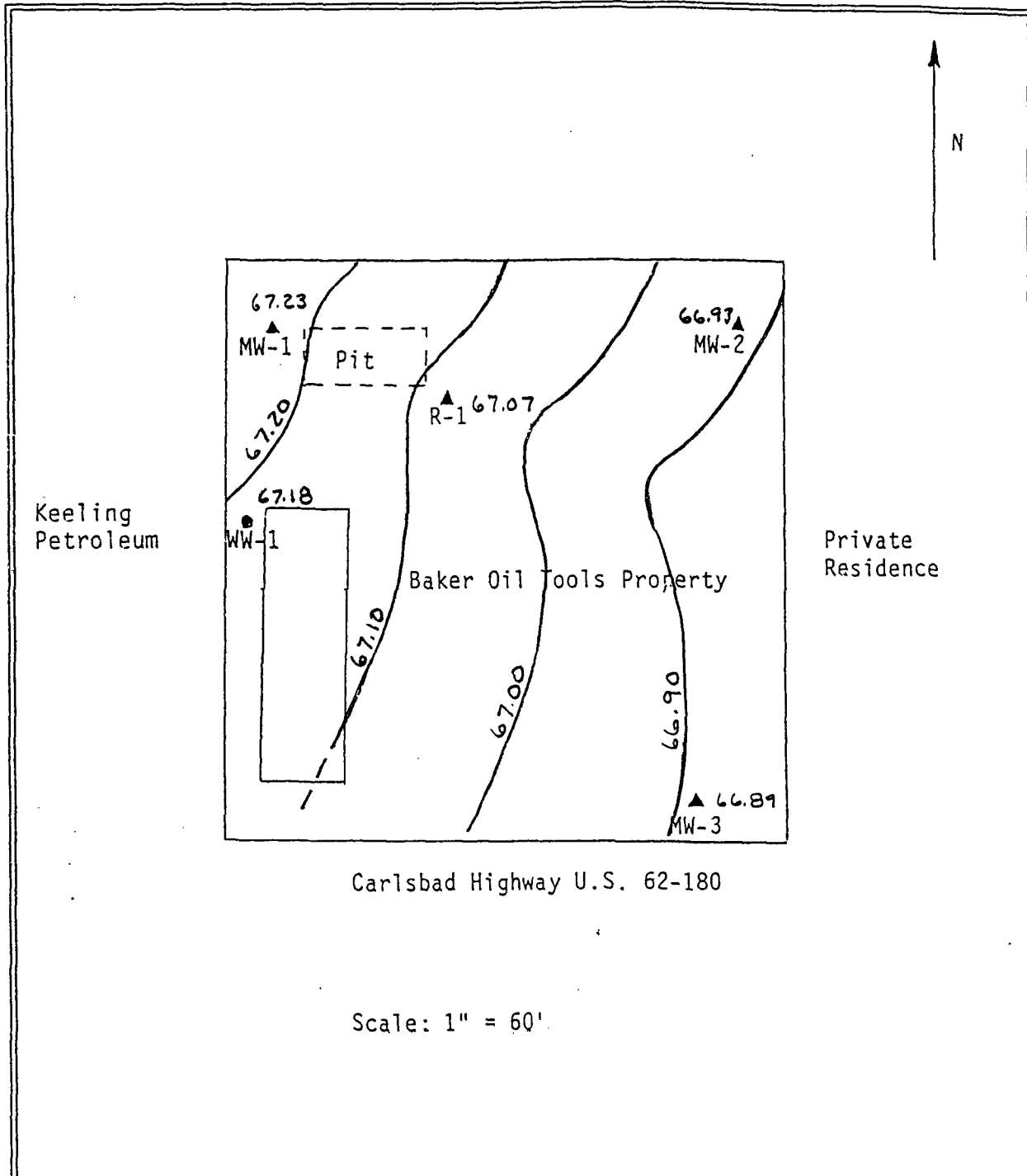

<p>Figure No. 1 Qtr. 5</p>	<p>Qtr. 5. Water Elevation Site Map</p>	<p>Baker Oil Tools 2800 W. Marland Hobbs, NM</p>
------------------------------------	---------------------------------------------	----------------------------------------------------------



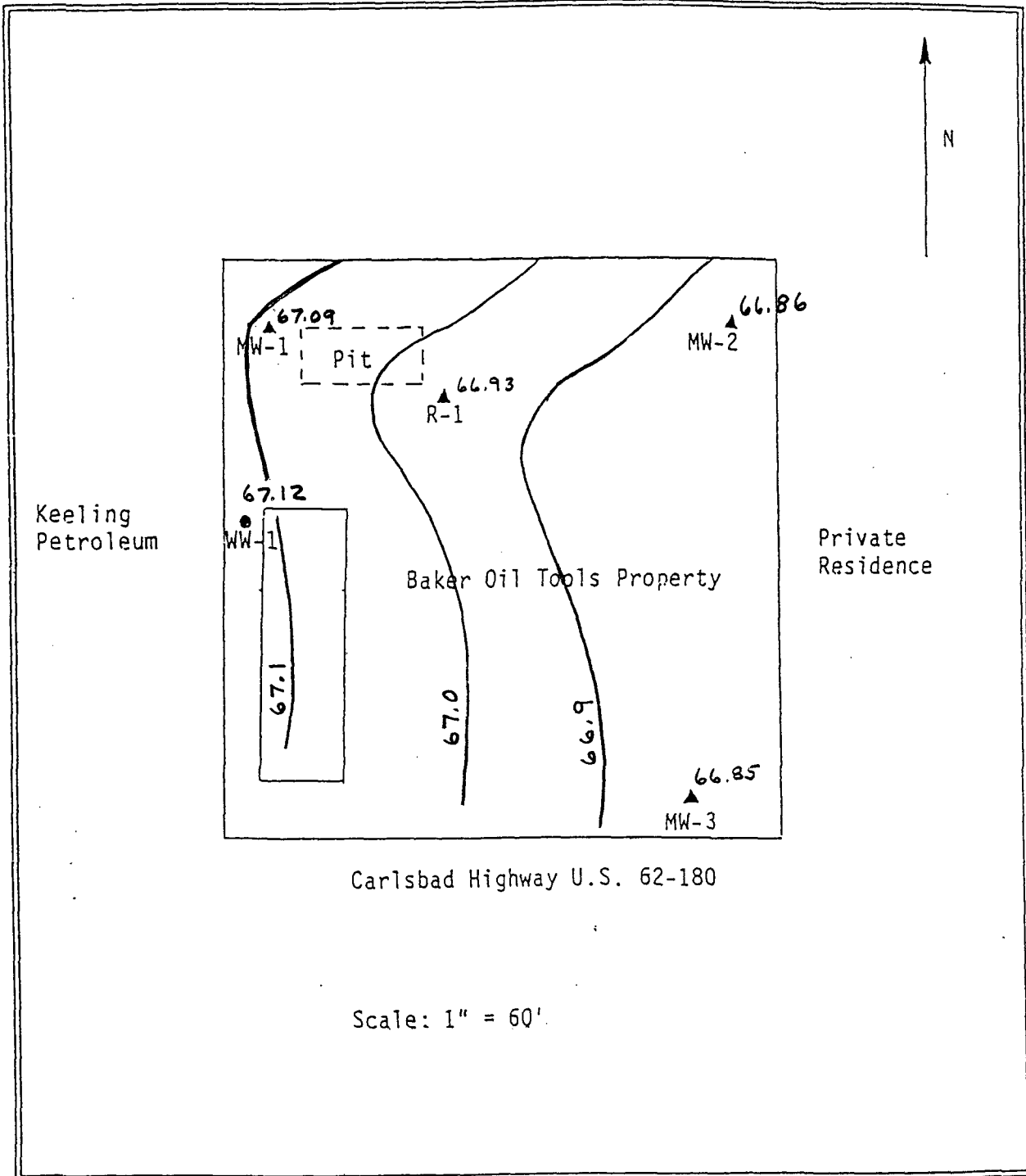

<p>Figure No. 1 Qtr. 6</p>	<p><b>Qtr 6 - Water Elevation</b> Site Map</p>	<p>Baker Oil Tools 2800 W. Marland Hobbs, NM</p>
------------------------------------	----------------------------------------------------	----------------------------------------------------------