

3R - 165

REPORTS

DATE:

July, 1996

August 20, 1996

Mr. Bill Olson
New Mexico Oil Conservation Division
2040 South Pacheco Street
Santa Fe, New Mexico 87505

RECEIVED

AUG 20 1996

Environmental Bureau
Oil Conservation Division

RE: Production Pit Closure Submittal

Dear Mr. Olson:

Enclosed herein are data packages for work completed at El Paso Field Services (EPFS) production pit locations where shallow groundwater was encountered during closure operations. The data included within indicate that these sites merit closure per the New Mexico Oil Conservation Division's (NMOCD) Vulnerable Area Orders and EPFS's closure plan submitted to the NMOCD. In front of each data package is a site specific checklist that indicates the work completed at each location. Each checklist is followed by a short summary of the activities and results of data collected to support closure.

Sincerely,

El Paso Field Services

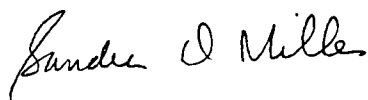

Sandra Miller
Senior Environmental Manager

j:\16297\sm

SAN JUAN BASIN PIT CLOSURES
San Juan Basin, New Mexico

Pit Closure Report

July 1996

Prepared For

El Paso Field Services
Farmington, New Mexico

Project 16297

PHILIP
ENVIRONMENTAL

OK

Closure Checklist

Meter Code

74289

Summary
Site Map
Site Assessment Sheet

<input checked="" type="checkbox"/>
<input checked="" type="checkbox"/>
<input checked="" type="checkbox"/>

Phase I Excavation

yes

closure form
soil analytical results
soil chain-of-custody
groundwater analytical results
groundwater chain-of-custody
bills of lading

<input checked="" type="checkbox"/>
<input checked="" type="checkbox"/>
<input checked="" type="checkbox"/>
<input type="checkbox"/>
<input type="checkbox"/>
<input checked="" type="checkbox"/>

Phase II Soil Boring

yes

boring log
soil analytical results
soil chain-of-custody
well installation form
development form
groundwater analytical
groundwater chain-of-custody

<input checked="" type="checkbox"/>
<input type="checkbox"/>
<input type="checkbox"/>
<input type="checkbox"/>
<input type="checkbox"/>
<input type="checkbox"/>
<input type="checkbox"/>

Phase III Excavation

yes

closure form
soil analytical results
soil chain-of-custody
groundwater analytical
groundwater chain of-custody
bills of lading

<input checked="" type="checkbox"/>
<input checked="" type="checkbox"/>
<input checked="" type="checkbox"/>
<input type="checkbox"/>
<input type="checkbox"/>
<input checked="" type="checkbox"/>

Recon performed

yes

groundwater analytical
soil-gas analytical

<input checked="" type="checkbox"/>
<input type="checkbox"/>

If item boxes are not checked they are not applicable

Cutler No. 2
Meter Code 74289

Pit was excavated to 12 feet beneath ground surface. Headspace soil readings from excavation bottom were 147 parts per million. Soil analytical from composite were as follows; benzene - < .5 mg/kg, total BTEX - 7.9 mg/kg, TPH - 3,500 mg/kg.

One soil boring was completed and no monitoring well installed. Groundwater was encountered at 15 feet. No soil or groundwater samples were collected.

Pit was re-excavated to 18 feet beneath ground surface. Headspace soil readings were as follows: pit bottom composite- 576 ppm. Soil analytical from composite were as follows; benzene - < .5 mg/kg, total BTEX - 49.7 mg/kg, TPH - 1,710 mg/kg.

A RECON® survey was conducted and four groundwater samples were collected between the pit and Largo wash. The samples were collected and analyzed using a laboratory-grade gas chromatograph by Philip Environmental's RECON® System. The on-site analytical results are as follows; PH-01 benzene - 4 ug/L, toluene - 32 ug/L, ethylbenzene - 4 ug/L, xylenes - 21 ug/l, PH-02 benzene <1 ug/L, toluene - 9 ug/L, ethylbenzene - 3 ug/L, xylenes - 12 ug/l, PH-03 benzene <1 ug/L, toluene - 6 ug/L, ethylbenzene - 1 ug/L, xylenes - 6 ug/l, PH-04 benzene - <1 ug/L, toluene - 6 ug/L, ethylbenzene - 1 ug/L, xylenes - 8 ug/l.

FIELD PIT SITE ASSESSMENT FORM

GENERAL	Meter: <u>74-289</u> Location: <u>Cutler #2</u> Operator #: <u>5764</u> Operator Name: <u>Mam Prod. P/L</u> District: <u>Ballard</u> Coordinates: Letter: <u>A</u> Section <u>14</u> Township: <u>24</u> Range: <u>6</u> Or Latitude _____ Longitude _____ Pit Type: Dehydrator _____ Location Drip: <u>X</u> Line Drip: _____ Other: _____ Site Assessment Date: <u>7/29/94</u> Area: <u>07</u> Run: <u>61-019 F1</u>	
	NMOCD Zone: (From NMOCD Maps) Inside <input checked="" type="checkbox"/> (1) Outside <input type="checkbox"/> (2) Land Type: BLM <input checked="" type="checkbox"/> (1) State <input type="checkbox"/> (2) Fee <input type="checkbox"/> (3) Indian _____ Depth to Groundwater Less Than 50 Feet (20 points) <input checked="" type="checkbox"/> (1) 50 Ft to 99 Ft (10 points) <input type="checkbox"/> (2) Greater Than 100 Ft (0 points) <input type="checkbox"/> (3) Wellhead Protection Area : Is it less than 1000 ft from wells, springs, or other sources of fresh water extraction? , or ; Is it less than 200 ft from a private domestic water source? <input type="checkbox"/> (1) YES (20 points) <input checked="" type="checkbox"/> (2) NO (0 points) Horizontal Distance to Surface Water Body Less Than 200 Ft (20 points) <input checked="" type="checkbox"/> (1) 200 Ft to 1000 Ft (10 points) <input type="checkbox"/> (2) Greater Than 1000 Ft (0 points) <input type="checkbox"/> (3) Name of Surface Water Body <u>Largo Wash</u> (Surface Water Body : Perennial Rivers, Major Wash, Streams, Creeks, Irrigation Canals, Ditches, Lakes, Ponds) Distance to Nearest Ephemeral Stream <input type="checkbox"/> (1) < 100' (Navajo Pits Only) <input type="checkbox"/> (2) > 100' TOTAL HAZARD RANKING SCORE: <u>40</u> POINTS	
SITE ASSESSMENT		
REMARKS	Remarks : <u>Redline Book - Outside</u> <u>Vulnerable Zone Type - Inside</u> <u>One pit, pit has liquid in it, will close one pit.</u>	

74289

ORIGINAL PIT LOCATION

Original Pit : a) Degrees from North 124° Footage from Wellhead 214'
b) Length : 22' Width : 23' Depth : 3'

ORIGINAL PIT LOCATION

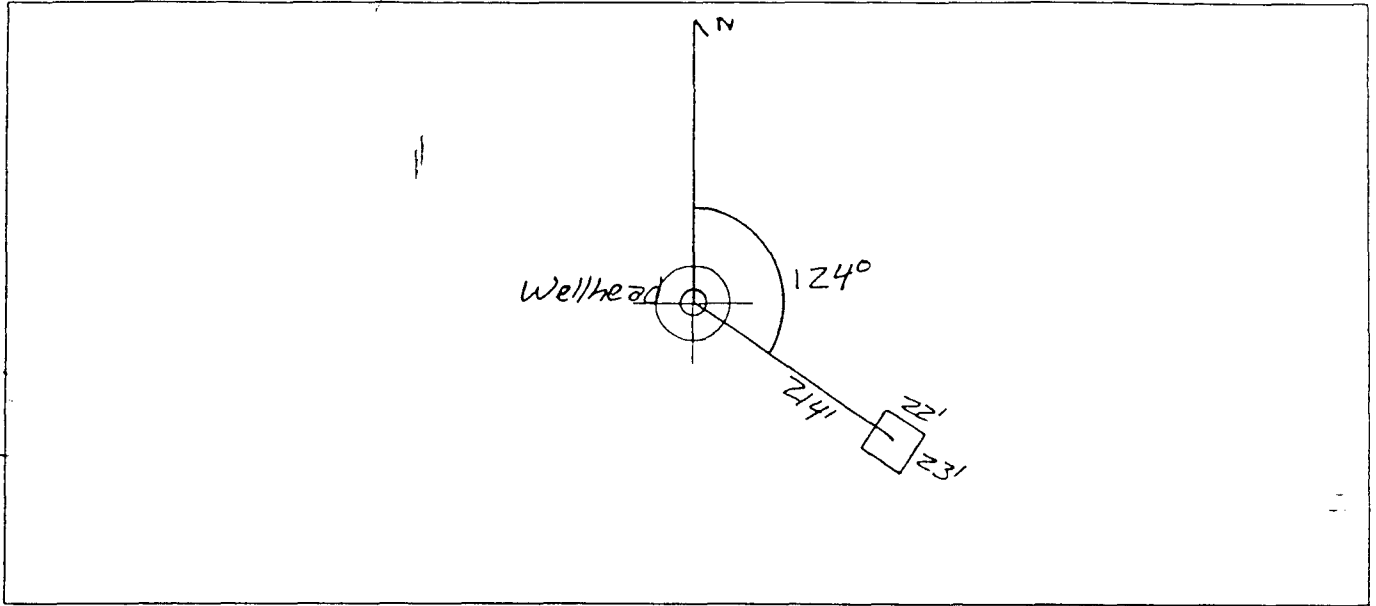

Remarks :

Pictures @ 1253 (4-7, Roll 12)
Dump Truck

REMARKS

Completed By:

Sarah Kelly
Signature

7/29/94
D. I.

Phase I Excavation

FIELD PIT REMEDIATION/CLOSURE FORM

GENERAL

Meter: 74289 Location: CUTLER #2

Coordinates: Letter: A Section 14 Township: 24 Range: 6

Or Latitude _____ Longitude _____

Date Started : 8-30-94 Run: 07 61-014F1

FIELD OBSERVATIONS

Sample Number(s): KP 213

Sample Depth: 12' Feet

Final PID Reading 147 PID Reading Depth 12' Feet

Yes No

Groundwater Encountered ☐ ☒ Approximate Depth _____ Feet

CLOSURE

Remediation Method :

Excavation ☒ Approx. Cubic Yards 110

Onsite Bioremediation ☐

Backfill Pit Without Excavation ☐

Soil Disposition:

Envirotech ☒ ☐ Tierra

Other Facility ☐ Name: _____

Pit Closure Date: 8-30-94 Pit Closed By: B.E.I

REMARKS

Remarks : Some Line markers Pit Has oil & water.
1 load to mix up to haul off. At 12' All 4 wall and floor
of Pit are still BLACK. with a light smell.

Signature of Specialist: Kelly Padilla



FIELD SERVICES LABORATORY

ANALYTICAL REPORT

PIT CLOSURE PROJECT - Soil Samples Inside the GWV Zone

SAMPLE IDENTIFICATION

	Field ID	Lab ID
SAMPLE NUMBER:	KP213	946035
MTR CODE SITE NAME:	74289	Cutler #2
SAMPLE DATE TIME (Hrs):	08/30/94	1455
PROJECT:	Phase I	
DATE OF TPH EXT. ANAL.:	09/01/94	09/01/94
DATE OF BTEX EXT. ANAL.:	09/11/94	09/11/94
TYPE DESCRIPTION:	VC	Brown fine sand & clay

Field Remarks: _____

RESULTS

PARAMETER	RESULT	UNITS	QUALIFIERS			
			DF	Q	M(g)	V(ml)
BENZENE	<0.025	MG/KG	1			
TOLUENE	1.5	MG/KG	1			
ETHYL BENZENE	0.8	MG/KG	1			
TOTAL XYLENES	5.6	MG/KG	1			
TOTAL BTEX	7.9	MG/KG				
TPH (418.1)	3500	MG/KG			2.02	28
HEADSPACE PID	147	PPM				
PERCENT SOLIDS	85.3	%				

-- TPH is by EPA Method 418.1 and BTEX is by EPA Method 8020 --

Surrogate Recovery was at 48 % for this sample All QA/QC was acceptable.

Narrative:

performed analyses. Surrogate recovery was outside ATI QC limits due to matrix interference.

DF = Dilution Factor Used

Approved By: _____

Date: _____

7/18/96



Page _____ of _____

White • Testing Laboratory Canary • EPNG Lab Pink • Field Sampler

STRAIGHT BILL OF LADING

ORIGINAL - NOT NEGOTIABLE

Shipper's No. 14-8813

CARRIER: DOUG FORTZ CONSTRUCTION

Carrier's No. SCAC

Date 8-30-94

TO:

Consignee ENVIROTECH
5796 US HIGHWAY 64
Street FARMINGTON, NM 87401
Destination Zip

FROM:

Shipper EL PASO NATURAL GAS COMPANY
Street P.O. BOX 4990
Origin FARMINGTON, NM 87499-4990
Zip

Route:

Vehicle Number 1314 U.S. DOT Hazmat Reg. No. -131-

No. Shipping Units	HM	Kind of Packages, Description of Articles (If Hazardous Materials - Proper Shipping Name)	HAZARD CLASS	ID. Number	PACKING GROUP	WEIGHT (subject to correction)	RATE	LABELS REQUIRED (or exemption)
1		CANYON Large #302/ENVIROTECH CM	EXEMPT HYDRO-CARBON CONTAMINATED SOIL	93793	N/A	10	YD	N/A
1		CUTLER #2/ENVIROTECH CM	EXEMPT HYDRO-CARBON CONTAMINATED SOIL	74284	N/A	10	YD	N/A
1		ANYON Large #302/ENVIROTECH CM	EXEMPT HYDRO-CARBON CONTAMINATED SOIL	93788	N/A	10	YD	N/A
1		ENVIROTECH CANYON Large #302	BACKFILL	93793	N/A	10	YD	N/A
1		ENVIROTECH CANYON Large #313	BACKFILL	94345	N/A	10	YD	N/A
1		ENVIROTECH CANYON Large #304	BACKFILL	93788	N/A	10	YD	N/A
			BACKFILL		N/A		YD	N/A
			BACKFILL		N/A		YD	N/A
			BACKFILL		N/A		YD	N/A

Remit C.O.D. to:

C.O.D. Amt: \$

C.O.D. FEE: \$

FREIGHT CHARGES ☒ PREPAID ☐ COLLECT

Address: State: Zip:

NOTE: Where the rate is dependent on value, shippers are required to state specifically in writing the agreed or declared value of the property. The agreed or declared value of the property is hereby specifically stated by the shipper to be not exceeding \$ Per

Subject to the conditions of the bill of lading, the shipper warrants that the property is not dangerous, inflammable, explosive, or otherwise subject to the provisions of the Hazardous Materials Regulations (49 CFR 172.101-172.102) and that the property is not otherwise subject to the provisions of the Hazardous Materials Regulations (49 CFR 172.101-172.102).

RECEIVED: subject to the classifications and lawfully filed bills in effect on the date of issue of this Bill of Lading, the property described above in apparent good order, except as noted (contents and condition of contents of packages unknown), marked, consigned, and delivered as indicated above when said carrier (the word carrier being understood throughout this contract as meaning any person or company engaged in the transportation of goods by motor vehicle, vessel, aircraft, or any other mode of transport) agrees to carry to its usual place of delivery at said destination, if on its route, otherwise to deliver to another carrier on the route to said destination. It is mutually agreed that each carrier shall be responsible for the proper care, custody, and protection of the property under all governing classification on the date of shipment.

Shipper hereby certifies that he is familiar with all the bill of lading terms and conditions in the governing classification and the said terms and conditions are hereby agreed to by the shipper and accepted for himself and his assigns.

SHIPPER: EL PASO NATURAL GAS COMPANY

CARRIER: X Fortz 10/25/94

PER: SANDRA MILLER DATE:

PER: MARK FARRAGHER DATE: 8-30-94

EMERGENCY RESPONSE EL PASO NATURAL GAS 505/599-2141
TELEPHONE NUMBER: (505) 326-2262 BURLINGTON ENVIRO. Including storage in transit to transportation (172.604).

STRAIGHT BILL OF LADING

ORIGINAL - NOT NEGOTIABLE

A 8819

Shipper's No. _____

Carrier's No. _____

Date 8-30-94

CARRIER: DOUG FOUTZ CONSTRUCTION

SCAC

FROM: Shipper EL PASO NATURAL GAS COMPANY
Street P.O. BOX 4990
Origin FARMINGTON, NM

Consignee ENVIROTECH
Street 5796 US HIGHWAY 64
Destination FARMINGTON, NM

Zip 87401

Zip 87499-4990

U.S. DOT Hazmat Reg. No. _____

No. Shipping Units	HM (if HAZARDOUS MATERIALS - PROPER SHIPPING NAME)	Kind of Packages, Description of Articles	HAZARD CLASS	I.D. Number	PACKING GROUP	WEIGHT (subject to correction)	RATE	LABELS REQUIRED (or exemption)
1		CANYON LARGE 302 / ENVIROTECH CM	EXEMPT HYDRO-CARBON CONTAMINATED SOIL	93793	N/A	10	YD	N/A
1		CUTLER #2 / ENVIROTECH CM	EXEMPT HYDRO-CARBON CONTAMINATED SOIL	94-285	N/A	10	YD	N/A
1		CANYON LARGE UNIT 304 CM	EXEMPT HYDRO-CARBON CONTAMINATED SOIL	93788	N/A	10	YD	N/A
1		ENVIROTECH / CANYON LARGE 302	EXEMPT HYDRO-CARBON CONTAMINATED SOIL	93793	N/A	10	YD	N/A
1		ENVIROTECH / CUTLER #2	EXEMPT HYDRO-CARBON CONTAMINATED SOIL	94-285	N/A	10	YD	N/A
1		ENVIROTECH / CUTLER #2	EXEMPT HYDRO-CARBON CONTAMINATED SOIL	94-285	N/A	10	YD	N/A
1		BACKFILL	BACKFILL		N/A		YD	N/A
1		BACKFILL	BACKFILL		N/A		YD	N/A
1		BACKFILL	BACKFILL		N/A		YD	N/A

Remit C.O.D. to: _____

Address: _____

City: _____ State: _____ Zip: _____

C.O.D. Amt: \$ _____

C.O.D. FEE: \$ _____

FREIGHT CHARGES

Prepaid ☒ Collect ☐

PREPAID ☐ COLLECT ☐

NOTE: Where the rate is dependent on value, shippers are required to state specifically in writing the agreed or declared value of the property. The agreed or declared value of the property is hereby specifically stated by the shipper to be not exceeding \$ _____ Per _____

RECEIVED: subject to the classification and liability filed tariffs in effect on the date of issue of this bill of lading, the property described above in apparent good order, except as noted (contents and condition of contents of packages unknown), marked, consigned, and destined as indicated above which said carrier (the word carrier being understood throughout this contract as meaning any person or corporation in possession of the property under the contract) agrees to carry to its usual place of delivery at said destination, it on its route, otherwise to deliver to another carrier on the route to said destination, it is mutually agreed as to each carrier of all or any of said property over all or any portion of said route to destination and as to each party at any time interested in all or any said property, that every service to be performed hereunder, shall be subject to all the bill of lading terms and conditions in the governing classification on the date of shipment.

Shipper hereby certifies that he is familiar with all the bill of lading terms and conditions in the governing classification and the said terms and conditions are hereby agreed to by the shipper and accepted for himself and his assigns.

This is to certify that the above named materials are properly classified, described, packaged, marked and labeled and are in proper condition for transportation according to the applicable regulations of the Department of Transportation.

SHIPPER: EL PASO NATURAL GAS COMPANY

PER: SANDRA MILLER

DATE: _____

CARRIER: DOUG FOUTZ CONSTRUCTION

PER: _____

DATE: 8-30-94

TELEPHONE: _____

ER: (505) 326-2262 BURLINGTON ENVIRO.

Shipper's No.

SCAC

Carrier's No. 343637

Date 8-30-94

FROM: EL PASO NATURAL GAS COMPANY
Shipper P.O. BOX 4990
Street FARMINGTON, NM 87499-4990
Origin

24324

Route:	171	Vehicle Number	U.S. DOT Hazmat Reg. No.
--------	-----	----------------	--------------------------

13 1/4 hrs

U.S. DOT Hazmat Reg. No.
N/A

No. Shipping Units	HM	Kind of Packages, Description of Articles (If HAZARDOUS MATERIALS - PROPER SHIPPING NAME)	HAZARD CLASS	I.D. Number	PACKING GROUP	WEIGHT (Subject to correction)	RATE	LABELS REQUIRED (or exemption)
1		CANYON LARGO UNIT 302 / ENVINOTED CM	EXEMPT HYDRO-CARBON CONTAMINATED SOIL	93793	N/A	10	YD	N/A
1		COTLER #2 / ENVINOTED CM	EXEMPT HYDRO-CARBON CONTAMINATED SOIL	74289	N/A	10	YD	N/A
1		CUTLER #2 / ENVINOTED CM	EXEMPT HYDRO-CARBON CONTAMINATED SOIL	74289	N/A	10	YD	N/A
1		CANYON LARGO #304 / ENVINOTED CM	EXEMPT HYDRO-CARBON CONTAMINATED SOIL	93793	N/A	10	YD	N/A
1		ENVINOTED / CANYON LARGO UNIT 302	BACKFILL	93793	N/A	10	YD	N/A
1		ENVINOTED / CUTLER #2	BACKFILL	74289	N/A	10	YD	N/A
1		ENVINOTED / CANYON LARGO UNIT 302	BACKFILL	93793	N/A	10	YD	N/A
1		ENVINOTED / CANYON LARGO UNIT 304	BACKFILL	93793	N/A	10	YD	N/A

Remit C.O.D. to:
Address:
City: State: Zip:

C.O.D. Amt:	C.O.D. FEE:	FREIGHT CHARGES
Prepaid <input checked="" type="checkbox"/> Collect <input type="checkbox"/>	\$	<input type="checkbox"/> PREPAID <input type="checkbox"/> COLLECT
\$		<input checked="" type="checkbox"/> <input type="checkbox"/>

[illegible]

RECEIVED. subject to the classifications and lawfully filed tariffs in effect on the date of issue of this Bill of Lading, the property described above in apparent good order, except as noted (contents and condition of contents or packages unknown), consigned, and destined as indicated above, which said carrier (the word carrier being understood throughout this contract as meaning any person or corporation in possession of the property under the contract) agrees to carry to its usual place of delivery at said destination, if on its route, otherwise to deliver to another carrier on the route to said destination. It is mutually agreed as to each carrier of all or any portion of said route to destination and as to each party at any time interested in all or any said property, that every service to be performed hereunder shall be subject to all the bill of lading terms and conditions in the governing classification on the date of shipment.

Shipper hereby certifies that the above named materials are properly classified, described, packaged, marked and labeled and are in proper condition for transportation according to the applicable regulations of the Department of Transportation.

PLACARDS REQUIRED	N/A	PLACARDS SUPPLIED	YES <input checked="" type="checkbox"/>	NO <input type="checkbox"/>
			FURNISHED BY CARRIER	
			DOWNGRADE	

SHIPPER: EL PASO NATURAL GAS COMPANY
CARRIER: X Doug Fouts Cons-1
DATE: 8-30-04

EMERGENCY RESPONSE EL PASO NATURAL GAS 505/599-2141	DATE:	
PERF. # 1100	<i>J. S. [Signature]</i>	DATE: 8-28-77
TELEPHONE N° ER: / 505 826-7262 BURLINGTON ENVIRONMENTAL STORAGE	Monitored at all times - the Hazardous Material is in transportation including storage in tail to transportation (172.604).	

STRAIGHT BILL OF LADING

ORIGINAL - NOT NEGOTIABLE

Shipper's No. _____

CARRIER: DOUG FOUTZ CONSTRUCTION

SCAC

Carrier's No. _____

Date 31 Aug. 1994

TO: Consignee
Street 5796 US HIGHWAY 64
Destination FARMINGTON, NM Zip 87401

FROM: Shipper
Street EL PASO NATURAL GAS COMPANY
P.O. BOX 4990
Origin FARMINGTON, NM

24324
Zip 87499-4990
U.S. DOT Hazmat Reg. No. _____

11 1/4 hrs

Vehicle Number 935

No. Shipping Units	Kind of Packages, Description of Articles (If Hazardous Materials - Proper Shipping Name)	Hazard Class	ID. Number	Packing Group	Weight (subject to correction)	Rate	Labels Required (or exemption)
1	1200ADA MESA # 2 / ENVIRONMENTAL HYDRO-CARBON CONTAMINATED SOIL	EXEMPT HYDRO-CARBON CONTAMINATED SOIL	824AD	N/A	10	YD	N/A
1	LAPOUL LAKED # 304 / ENVIRONMENTAL HYDRO-CARBON CONTAMINATED SOIL	EXEMPT HYDRO-CARBON CONTAMINATED SOIL	93788	N/A	10	YD	N/A
1	LAT LICE LAIR 22-22 / ENVIRONMENTAL HYDRO-CARBON CONTAMINATED SOIL	EXEMPT HYDRO-CARBON CONTAMINATED SOIL	N/A	N/A	10	YD	N/A
1	ENVIRONMENTAL CUTTER # 2	BACKFILL	74289	N/A	10	YD	N/A
1	ENVIRONMENTAL / LAT. LIVE WIP 22-22	BACKFILL	N/A	N/A	10	YD	N/A
1	ENVIRONMENTAL / LAPOUL LAKED # 304	BACKFILL	93788	N/A	10	YD	N/A
1	BACKFILL	BACKFILL	N/A	N/A	YD	N/A	N/A

Remit C.O.D. to:
Address:
City:
State:
Zip:

C.O.D. Amt: \$

C.O.D. FEE: Prepaid ☒ Collect ☐

FREIGHT CHARGES: ☒ PREPAID ☐ COLLECT

NOTE: Where the rate is dependent on value, shippers are required to state specifically in writing the agreed or declared value of the property. The agreed or declared value of the property is hereby specifically stated by the shipper to be not exceeding \$ _____ Per _____ (Signature of Consignor)

RECEIVED: subject to the classification and liability limit in effect on the date of issue of this bill of lading, the property described above in apparent good order, except as noted (contents and condition of contents of packages unknown), marked, consigned, and delivered as indicated above which said carrier (the word carrier being understood throughout this contract as meaning any person or corporation in possession of the property under the contract) agrees to carry to its usual place of delivery at said destination, it on its route, otherwise to deliver to another carrier on the route to said destination. It is mutually agreed as to each carrier of all or any of said property over all or any portion of said route to destination and as to each party at any time interested in all or any said property, that every service to be performed hereunder shall be subject to all the bill of lading terms and conditions in the governing classification on the date of shipment.

Shipper hereby certifies that he is familiar with all the bill of lading terms and conditions in the governing classification and the said terms and conditions are hereby agreed to by the shipper and accepted for himself and his assigns.

This is to certify that the above named materials are properly marked, packaged, labeled and are in proper condition for transportation according to the applicable regulations of the Department of Transportation.

PLACARDS REQUIRED ☒ N/A

PLACARDS SUPPLIED ☐ YES ☒ NO - FURNISHED BY CARRIER

DRIVERS SIGNATURE: _____

SHIPPER: EL PASO NATURAL GAS COMPANY
PER: SANDRA MILLER
DATE: _____

CARRIER: DOUG FOUTZ CONSTRUCTION
PER: _____
DATE: 31 Aug 94

EMERGENCY RESPONSE EL PASO NATURAL GAS 505/599-2141
TELEPHONE NO. R: (505) 326-2262 BURLINGTON ENVIRO.

Monitored at all times - Hazardous Material is in transportation
if to transportation (172.604).

ORIGINAL - NOT NEGOTIABLE

Shipper's No.

SCAC

Carrier's No. 45373

Date 8-30-74

FROM:

Shipper	EL PASO NATURAL GAS COMPANY	24324
Street	P.O. BOX 4990	
Origin	FARMINGTON, NM 87499-4990	
		Zip

24324
-zip

Vehicle Number

U.S. DOT Hazmat Reg. No.

No. Shipping Units	HM	Kind of Packages, Description of Articles (If HAZARDOUS MATERIALS - PROPER SHIPPING NAME)	HAZARD CLASS	I.D. Number	PACKING GROUP	WEIGHT (Subject to correction)	RATE	LABELS REQUIRED (or exemption)
1		Cutter #2 / ENVIROTECH CM	EXEMPT HYDRO- CARBON CONTAMI- NATED SOIL	74289	N/A	10	YD	N/A
1		Cutter #2 / ENVIROTECH CM	EXEMPT HYDRO- CARBON CONTAMI- NATED SOIL	74289	N/A	10	YD	N/A
			EXEMPT HYDRO- CARBON CONTAMI- NATED SOIL		N/A		YD	N/A
			EXEMPT HYDRO- CARBON CONTAMI- NATED SOIL		N/A		YD	N/A
11		ENVIROTECH / 2C-90 Lined	BACKFILL	2C90	N/A	10	YD	N/A
1		ENVIROTECH / Cutter #2	BACKFILL	74289	N/A	10	YD	N/A
			BACKFILL		N/A		YD	N/A
			BACKFILL		N/A		YD	N/A
			BACKFILL		N/A		YD	N/A

State:

Zip:

C.O.D. Amt:

C.O.D. Fee:	XX	\$
Prepaid		
Collect		

FREIGHT CHARGES
☒ PREPAID ☐ COLLECT

Subject to Section 7 of the conditions, if this equipment is to be delivered to the consignee without recourse on the consignee, the consignor shall sign the following statement

The carrier shall not make delivery of this equipment without payment of freight and all other lawful charges

(Signature of Consignor)

Where the applicable law provides for a limitation of the carrier's liability under NACM item 172, if there is no release or value declaration by the shipper, and the shipper does not declare a value or release the carrier's liability, that liability shall be limited to the extent provided by NACM item 172. California interstate shippers must comply with NACM item 173.

issue of this Bill of Lading, the proper
the word carrier being understood to
use to deliver to another carrier on the
or any said property, that every ser-

N/A

PLACARDS
SLIPPIEN

as noted (contents and condition of contents of
incorporation in possession of the property under all
each carrier of all or any of said property over the
to all the bill of lading terms and conditions in the

☐ YES ☒ NO - FURNISHED BY CARRIER

SHIPPER and accepted for himself and his assigns

CARRIER: X Douc Fort Cost

75 T

DATE:

PER: James O. Brown

DATE: 9-30-94

Monitored at all times; the Hazardous Material is in transportation including storage in total transportation (172.604).

transportation
34}).

STRAIGHT BILL OF LADING

ORIGINAL - NOT NEGOTIABLE

Shipper's No. _____

Carrier's No. _____

Date: 30 Apr 1994

SCAC

Carrier's No. _____

Date: 30 Apr 1994

CARRIER: DOUG FOUTZ CONSTRUCTION

TO: Consignee ENVIROTECH
Street 5796 US HIGHWAY 64
Destination FARMINGTON, NM Zip 87401

FROM: Shipper EL PASO NATURAL GAS COMPANY
Street P.O. BOX 4990
Origin FARMINGTON, NM Zip 87499-4990

Route: _____

No. Shipping Units	HM	Kind of Packages, Description of Articles (IF HAZARDOUS MATERIALS - PROPER SHIPPING NAME)	HAZARD CLASS	I.D. Number	PACKING GROUP	WEIGHT (subject to correction)	RATE	LABELS REQUIRED (or exemption)
1		CAVPOD LABED #313/ENVIROTECH	EXEMPT HYDRO-CARBON CONTAMINATED SOIL	94345	N/A	10	YD	N/A
1		OUTLE #2 / ENVIROTECH	EXEMPT HYDRO-CARBON CONTAMINATED SOIL	74289	N/A	10	YD	N/A
1		HAT 2C-22 DR/ENVIROTECH	EXEMPT HYDRO-CARBON CONTAMINATED SOIL	—	N/A	10	YD	N/A
1		ENVIROTECH/CAVPOD LABED #313	BACKFILL	94345	N/A	10	YD	N/A
1		ENVIROTECH/CAVPOD LABED #313	BACKFILL	94345	N/A	10	YD	N/A
1		ENVIROTECH/OUTLE #2	BACKFILL	74289	N/A	10	YD	N/A
1		BACKFILL	BACKFILL	N/A	N/A	YD	N/A	N/A

Remit C.O.D. to: _____

Address: _____

City: _____ State: _____ Zip: _____

C.O.D. Amt: \$ _____ C.O.D. FEE: \$ _____

Freight Charges: ☒ PREPAID ☐ COLLECT

NOTE: Where the rate is dependent on value, shippers are required to state specifically in writing the agreed or declared value of the property. The agreed or declared value of the property is hereby specifically stated by the shipper to be not exceeding \$ _____

RECEIVED: subject to the classifications and lawfully tied tariffs in effect on the date of issue of this Bill of Lading, the property described above in apparent good order, except as noted (contents and condition of contents of packages unknown), marked, consigned, and destined as indicated above which said carrier (the word carrier being understood throughout this contract as meaning any person or corporation in possession of the property under the contract) agrees to carry to its usual place of delivery at said destination, if on its route, otherwise to deliver to another carrier on the route to said destination. It is mutually agreed as to each carrier of all or any of, said property over all or any portion of said route to destination and as to each party at any time interested in all or any said property, that every service to be performed hereunder shall be subject to all the bill of lading terms and conditions in the governing classification on the date of shipment.

Shipper hereby certifies that he is familiar with all the bill of lading terms and conditions in the governing classification and the said terms and conditions are hereby agreed to by the shipper and accepted for himself and his assigns.

This is to certify that the above named materials are properly classified, described, packaged, marked and labeled and are in proper condition for transportation according to the applicable regulations of the Department of Transportation.

PLACARDS REQUIRED ☒ N/A

PLACARDS SUPPLIED ☐ YES ☒ NO - FURNISHED BY CARRIER

DRIVERS SIGNATURE: _____

SHIPPER: EL PASO NATURAL GAS COMPANY

PER: SANDRA MILLER DATE: _____

CARRIER: DOUG FOUTZ CONSTRUCTION

PER: 30 Apr 1994

EMERGENCY RESPONSE EL PASO NATURAL GAS 505/599-2141

TELEPHONE: (505) 326-2262 BURLINGTON ENVIRO.

Monitored at all times "the Hazardous Material is in transportation including storage" (172.604).

STRAIGHT BILL OF LADING

ORIGINAL - NOT NEGOTIABLE

Shipper's No. _____

CARRIER: DOUG FOUTZ CONSTRUCTION

SCAC

Carrier's No. 343637

Date 8-30-94

TO:

Consignee ENVITECH
Street 5796 US HIGHWAY 64
Destination FARMINGTON, NM Zip 87401

FROM:

Shipper EL PASO NATURAL GAS COMPANY
Street P.O. BOX 4990
Origin FARMINGTON, NM

Route:

12 hrs.

Vehicle Number 934

U.S. DOT Hazmat Reg. No. _____

No. Shipping Units	Kind of Packages, Description of Articles (If Hazardous Materials - Proper Shipping Name)	Hazard Class	I.D. Number	Packing Group	Weight (subject to correction)	Rate	Labels Required (or exemption)
--------------------	---	--------------	-------------	---------------	--------------------------------	------	--------------------------------

1	Canyon Largo #313 <i>ENVITECH</i>	EXEMPT HYDRO-CARBON CONTAMINATED SOIL	94395	N/A	10	YD	N/A
1	Cutter #2 / ENVITECH <i>ENV</i>	EXEMPT HYDRO-CARBON CONTAMINATED SOIL	74289	N/A	10	YD	N/A
1	Lat 25-22 *2 LINE DRIVE / ENVITECH <i>ENV</i>	EXEMPT HYDRO-CARBON CONTAMINATED SOIL	N/A	N/A	10	YD	N/A
1	ENVITECH / CANYON LARGO #301	BACKFILL	93793	N/A	10	YD	N/A
1	ENVITECH / CANYON LARGO #315	BACKFILL	94395	N/A	10	YD	N/A
1	ENVITECH / Cutter #2	BACKFILL	74289	N/A	10	YD	N/A
1	ENVITECH / Cutter #2	BACKFILL	74289	N/A	10	YD	N/A
1	ENVITECH / Cutter #2	BACKFILL	74289	N/A	10	YD	N/A
1	ENVITECH / Cutter #2	BACKFILL	74289	N/A	10	YD	N/A

Remit C.O.D. to:

Address: _____ City: _____ State: _____ Zip: _____

C.O.D. Amt: \$ _____

C.O.D. FEE: Prepaid ☒ Collect ☐

FREIGHT CHARGES: ☒ PREPAID ☐ COLLECT

NOTE: Where the rate is dependent on value, shippers are required to state specifically in writing the agreed or declared value of the property. The agreed or declared value of the property is hereby specifically stated by the shipper to be not exceeding \$ _____

RECEIVED: subject to the classification and liability filed tariffs in effect on the date of issue of this Bill of Lading, the property described above in apparent good order, except as noted (contents and condition of contents of packages unknown), marked, consigned, and delivered as indicated above which said carrier (this word carrier being understood throughout this contract as meaning any person or corporation in possession of the property under the contract) agrees to carry to its usual place of delivery at said destination, it on its route, otherwise to deliver to another carrier on the route to said destination. It is mutually agreed as to each carrier of all or any of said property over all or any portion of said route to destination and as to each party at any time interested in all or any said property, that every service to be performed hereunder shall be subject to all the bill of lading terms and conditions in this governing classification on the date of shipment.

Shipper hereby certifies that he is familiar with all the bill of lading terms and conditions in the governing classification and the said terms and conditions are hereby agreed to by the shipper and accepted for himself and his assigns. This is to certify that the above named materials are properly classified, described, packaged, marked and labeled and are in proper condition for transportation according to the applicable regulations of the Department of Transportation.

PLACARDS REQUIRED

N/A

PLACARDS SUPPLIED

YES ☐

NO ☒

FURNISHED BY CARRIER

SHIPPER: EL PASO NATURAL GAS COMPANY

PER: SANDRA MILLER

DATE: 8-30-94

CARRIER: DOUG FOUTZ CONSTRUCTION

PER: Sandra Miller

DATE: 8-30-94

EMERGENCY RESPONSE EL PASO NATURAL GAS 505/599-2141

TELEPHONE NUMBER: (505) 326-2262 BURLINGTON ENVIRO.

Monitored at all times the Hazardous Material is in transportation

including storage in

at to transportation (172.604).

STRAIGHT BILL OF LADING

ORIGINAL - NOT NEGOTIABLE

Shipper's No. _____

CARRIER: DOUG FOUTZ CONSTRUCTION

Carrier's No. _____

Date 8-30-94

TO:

Consignee ENVIROTECH
Street 5796 US HIGHWAY 64
Destination FARMINGTON, NM Zip 87401

FROM:

Shipper EL PASO NATURAL GAS COMPANY
Street P.O. BOX 4990
Origin FARMINGTON, NM

24324

Zip 87499-4990

Route:

74 hrs

Vehicle Number 931

U.S. DOT Hazmat Reg. No. _____

No. Shipping Units	HM (If Hazardous Materials - Proper Shipping Name)	Kind of Packages, Description of Articles	HAZARD CLASS	I.D. Number	PACKING GROUP	WEIGHT (subject to correction)	RATE	LABELS REQUIRED (or exemption)
1		Carbon Largo #313 / Envirotech CM	EXEMPT HYDRO-CARBON CONTAMINATED SOIL	94345	N/A	10	YD	N/A
1		Carbon Largo #2 / Envirotech CM	EXEMPT HYDRO-CARBON CONTAMINATED SOIL	74298	N/A	10	YD	N/A
1		Envirotech / Carbon Largo #302	EXEMPT HYDRO-CARBON CONTAMINATED SOIL	93793	N/A	10	YD	N/A
1		Envirotech / Carbon Largo #2	EXEMPT HYDRO-CARBON CONTAMINATED SOIL	74298	N/A	10	YD	N/A
			BACKFILL		N/A		YD	N/A
			BACKFILL		N/A		YD	N/A
			BACKFILL		N/A		YD	N/A
			BACKFILL		N/A		YD	N/A
			BACKFILL		N/A		YD	N/A

Remit C.O.D. to:

Address:

City:

State:

C.O.D. Amt: \$

C.O.D. FEE: \$

FREIGHT CHARGES PREPAID COLLECT

NOTE - Where the rate is dependent on value, shippers are required to state specifically in writing the agreed or declared value of the property. The agreed or declared value of the property is hereby specifically stated by the shipper to be not exceeding \$ _____

RECEIVED - subject to the classifications and lawfully filed tariffs in effect on the date of issue of this Bill of Lading, the property described above in apparent good order, except as noted (contents and condition of contents of packages unknown), marked, consigned, and destined as indicated above which said carrier (the word carrier being understood throughout this contract as meaning any person or corporation in possession of all or any of said property over all or any portion of said route to destination and as to each party at any time interested in all or any said property, that every service to be performed hereunder shall be subject to all the bill of lading terms and conditions in the governing classification on the date of shipment.

Shipper hereby certifies that he is familiar with all the bill of lading terms and conditions in the governing classification and the said terms and conditions are hereby agreed to by the shipper and accepted for himself and his assigns.

This is to certify that the above named materials are properly classified, described, packaged, marked and labeled and are in proper condition for transportation according to the applicable regulations of the Department of Transportation.

SHIPPER: EL PASO NATURAL GAS COMPANY
PER: SANDRA MILLER
DATE: 8-30-94
EMERGENCY RESPONSE EL PASO NATURAL GAS 505/599-2141
TELEPHONE: (505) 326-2262 BURLINGTON ENVIRO.

CARRIER: Doug Foutz Construction
PER: Doug Foutz
DATE: 8-30-94
Monitored at all times by the Hazardous Material is in transportation
all to transportation (172.604).

ORIGINAL - NOT NEGOTIABLE

Carrier's No. 343637

8-30-94

SCAC

24324

OT Hazmat Rec
21P87499-4990

2

No. Shipping Units	HIM	Kind of Packages, Description of Articles (If HAZARDOUS MATERIALS - PROPER SHIPPING NAME)	HAZARD CLASS	I.D. Number	PACKING GROUP	WEIGHT (subject to correction)	RATE	LABELS REQUIRED (or exemption)
1		Canyon Largo #313 / Envirotech ^{CM}	EXEMPT HYDRO-CARBON CONTAMINATED SOIL.	99345	N/A	10	YD	N/A
1		LAT 2C-22 #2 LINE-DRIF / ENVIROtech	EXEMPT HYDRO-CARBON CONTAMINATED SOIL.	N/A	N/A	10	YD	N/A
			EXEMPT HYDRO-CARBON CONTAMINATED SOIL.		N/A		YD	N/A
			EXEMPT HYDRO-CARBON CONTAMINATED SOIL.		N/A		YD	N/A
1		Envirotech / Canyon Largo #302	BACKFILL	93793	N/A	10	YD	N/A
1		Envirotech / Cutler #2	BACKFILL	74284	N/A	10	YD	N/A
			BACKFILL		N/A		YD	N/A
			BACKFILL		N/A		YD	N/A
			BACKFILL		N/A		YD	N/A

1

where the applicable law provisions specify a limitation of the carrier's liability, NMFIC Item 172), there is no release or value declaration by the shipper, and the shipper does not declare a value or release the carrier's liability, that liability shall be limited to the extent provided by NMFIC Item 172.

RECEIVED, subject to the classifications and lawfully filed tariffs in effect on the date of issue of this Bill of Lading, the property described above in apparent good order, except as noted (conditions and condition of contents of packages unknown), carried, consigned, and delivered as indicated above which said carrier (the word carrier being understood throughout this contract as meaning any person or corporation in possession of the property under the contract) agrees to carry to its usual place of, and delivery at said destination, if on its route, interested to deliver to another carrier on the route to said destination. It is mutually agreed as to each carrier of all or any of said property over all or any portion of said route to destination and as to each party at any time interested in all or any said property, that every service to be performed hereunder shall be subject to all the bill of lading terms and conditions in the governing classification on the date of shipment.

Shipper hereby certifies that he is familiar with all the bill of lading terms and conditions in the governing classification and the said terms and conditions are hereby agreed to by the shipper and accepted for himself and his assigns.

This is to certify that the above-named materials are properly classified, described, packaged, marked and labeled and are in proper condition for transportation according to the applicable regulations of the Department of Transportation.

Y *Sh*

PLACARDS REQUIRED	PLACARDS SUBMITTED
YES <input type="checkbox"/>	YES <input checked="" type="checkbox"/>
NO <input checked="" type="checkbox"/>	NO <input type="checkbox"/>

17/78

2

DATE: 8-30-94

Monitored at all times the Hazardous Material is in transportation including storage in 'all to transportation (172.604).

STRAIGHT BILL OF LADING

ORIGINAL - NOT NEGOTIABLE

Shipper's No. _____

Carrier's No. 20000000

Date 8/24/84

SCAC

TO:

Consignee ENVIROTECH
Street 5796 US HIGHWAY 64
Destination FARMINGTON, NM 87401

FROM: Shipper EL PASO NATURAL GAS COMPANY
Street P.O. BOX 4990
Origin FARMINGTON, NM 87499-4990

Route:

Vehicle Number 1134hes U.S. DOT Hazmat Reg. No. _____

No. of Packages, Description of Articles
Shipping Units (if HAZARDOUS MATERIALS - PROPER SHIPPING NAME)

HAZARD CLASS I.D. Number PACKING GROUP WEIGHT (subject to correction) RATE LABELS REQUIRED (for exemption)

1	CANYON LARSO #302 / ENVIROTECH CM	EXEMPT HYDRO-CARBON CONTAMINATED SOIL	93793	N/A	10	YD	N/A
1	CUTLER #2 / ENVIROTECH CM	EXEMPT HYDRO-CARBON CONTAMINATED SOIL	74289	N/A	10	YD	N/A
1	LAT 22-22 LINDSEY / ENVIROTECH	EXEMPT HYDRO-CARBON CONTAMINATED SOIL	N/A	N/A	10	YD	N/A
1	ENVIROTECH / CANYON LARSO #302	EXEMPT HYDRO-CARBON CONTAMINATED SOIL	93793	N/A	10	YD	N/A
1	ENVIROTECH / CANYON LARSO #313	BACKFILL	94346	N/A	10	YD	N/A
1	ENVIROTECH / CUTLER #2	BACKFILL	74289	N/A	10	YD	N/A
1		BACKFILL		N/A		YD	N/A
1		BACKFILL		N/A		YD	N/A
1		BACKFILL		N/A		YD	N/A

Remit C.O.D. to:

C.O.D. Amt: \$

C.O.D. FEE: \$

FREIGHT CHARGES ☒ PREPAID ☐ COLLECT

Address:

City: State: Zip:

\$

Collect

\$

☒ PREPAID ☐ COLLECT

NOTE: Where the rate is dependent on value, shippers are required to state specifically in writing the agreed or declared value of the property. The agreed or declared value of the property is hereby specifically stated by the shipper to be not exceeding \$ _____

Signature of Shipper (Signature of Consignee)

When the bill of lading is received by the carrier, the shipper shall sign the following statement: "I hereby certify that the above named materials are properly classified, described, packaged, marked and labeled and are in proper condition for transportation according to the applicable regulations of the Department of Transportation."

RECEIVED: subject to the classifications and lawfully filed tariffs in effect on the date of issue of this Bill of Lading, the property described above in apparent good order, except as noted (contents and condition of contents of packages unknown), marked, consigned and destined as indicated above which said carrier (the word carrier being understood throughout this contract as meaning any person or corporation in possession of the property under the contract) agrees to carry to its usual place of delivery at said destination, it on its route, otherwise to deliver to another carrier on the route to said destination. It is mutually agreed as to each carrier of all or any of said property over all or any portion said route to destination and as to each party at any time interested in all or any said property, that every service to be performed hereunder shall be subject to all the bill of lading terms and conditions on the front of this bill of lading. Shipper hereby certifies that the bill of lading with all the bill of lading terms and conditions are hereby agreed to by the shipper and accepted for himself and his assigns.

This is to certify that the above named materials are properly classified, described, packaged, marked and labeled and are in proper condition for transportation according to the applicable regulations of the Department of Transportation.

PLACARDS REQUIRED

N/A

PLACARDS SUPPLIED

☐ YES ☒ NO - FURNISHED BY CARRIER

DRIVERS SIGNATURE: _____

SHIPPER: EL PASO NATURAL GAS COMPANY

CARRIER: X

DATE: 8/24/84

PER: SANDRA MILLER

DATE: 8/24/84

PER: 8/24/84

DATE: 8/24/84

EMERGENCY RESPONSE EL PASO NATURAL GAS 505/599-2141

TELEPHONE NUMBER: (505) 326-2262 BURLINGTON ENVIRO. Including storage in transportation (172.604).

Phase II Soil Boring

AUG 15 '95

14:53 No.001 P.03

Borehole # BH-1

Well #

Page 1 of 1

PHILIP ENVIRONMENTAL

6000 Morrow Road

Farmington, New Mexico 87401

TEL (505) 326-2282 FAX (505) 328-2388

Project Name

EPNG PITS

Project Number

14509

Phase

6000 77

Project Location

Curtler #2

74289

Well Logged By

CM Chance

Personnel On-Site

K Padilla, D. Charlie H. Keil

Contractors On-Site

Client Personnel On-Site

Elevation

Borehole Location

QA-S14-T24-R6

GWL Depth

Logged By

CM CHANCE

Drilled By

K Padilla

Date/Time Started

8/14/95 - 1115

Date/Time Completed

8/14/95 - 1200

Drilling Method

4 1/4" ID HSA

Air Monitoring Method

PID, CGI

Depth (Feet)	Sample Number	Sample Interval	Sample Type & Recovery (Inches)	Sample Description Classification System: USCS	USCS Symbol	Depth Lithology Change (feet)	Air Monitoring Units: PPM			Drilling Conditions & Blow Counts
0				Backfill to 12'						
5										
10										
15	1	15-17	12"	DK gray-bk SAND, v.f-f sand, abt silt, v. loose, saturated, odor			0	4	41 302	1128 saturated sample GW @ 15'
20				TOB 17'						
25										
30										
35										
40										

Comments:

Ground water at 15'. No sample due to encountering GW. Backfilled BH
w/ 4' of bentonite & grouted to surface. Hydrated bentonite w/ 5 gal
potable water.

Geologist Signature

Cory Chance

Phase III Excavation

FIELD PIT REMEDIATION/CLOSURE FORM/PHASE II

GENERAL

Meter: 74289 Location: Cutler #2

Coordinates: Letter: A Section 14 Township: 24 Range: 06

Or Latitude _____ Longitude _____

Date Started : 10-30-95 Area: 07 Run: 61-014F1

FIELD OBSERVATIONS

Sample Number(s): 4P76

Sample Depth: 18 Feet

Final PID Reading 576 PID Reading Depth 18 Feet
Yes No

Groundwater Encountered: ☐ (1) ☒ (2) Approximate Depth _____ Feet

Final Dimensions: Length 30 Width 24 Depth 18

CLOSURE

Remediation Method :

Excavation ☒ (1) Approx. Cubic Yards 424 LT 11/2/95

Onsite Bioremediation ☐ (2)

Backfill Pit Without Excavation ☐ (3)

Overburden Cubic Yards _____

Soil Disposition:

Envirotech ☒ (1) ☐ (3) Tierra

Other Facility ☐ (2) Name: _____

Pit Closure Date: 10-31-95 Pit Closed By: Philip Env

Phase III

REMARKS

Remarks : Dug pit to 18ft and exposed 2-4" line on East + West side of pit, encountered ground water, but it was only a trickle, not enough to get a sample. Talked with Alton James there may be some confusion with

Signature of Specialist: James L. Farrow



FIELD SERVICES LABORATORY

ANALYTICAL REPORT

PIT CLOSURE PROJECT - Soil Samples Inside the GWV Zone

SAMPLE IDENTIFICATION

	Field ID	Lab ID
SAMPLE NUMBER:	JP76	947712
MTR CODE SITE NAME:	74289	Cutler #2
SAMPLE DATE TIME (Hrs):	10/31/95	1000
PROJECT:	Phase III Excavation	
DATE OF TPH EXT. ANAL.:	11/01/95	11/02/95
DATE OF BTEX EXT. ANAL.:	11/01/95	11/02/95
TYPE DESCRIPTION:	VC	Light brown sand & clay

Field Remarks: (N-56) (S-54) (E-134) (W-39)

RESULTS

PARAMETER	RESULT	UNITS	QUALIFIERS			
			DF	Q	M(g)	V(ml)
BENZENE	<0.5	MG/KG				
TOLUENE	3.3	MG/KG				
ETHYL BENZENE	4.8	MG/KG				
TOTAL XYLENES	41.6	MG/KG				
TOTAL BTEX	49.7	MG/KG				
TPH (418.1)	1710	MG/KG			2.06	28
HEADSPACE PID	576	PPM				
PERCENT SOLIDS	82.1	%				

— TPH is by EPA Method 418.1 and BTEX is by EPA Method 8020 —

The Surrogate Recovery was at 112 % for this sample All QA/QC was acceptable.
ative:

DF = Dilution Factor Used

Approved By:

John Larkin

Date:

7/18/96



El Paso
Natural Gas Company

CHAIN OF CUSTODY RECORD

Page _____ of _____

PROJECT NUMBER # 24324		PROJECT NAME Pit Closure Project				CONTRACT LABORATORY P. O. NUMBER					
SAMPLERS: (Signature)		DATE: 10-31-95				SEQUENCE #					
LAB ID	DATE	TIME	MATRIX	FIELD ID	TOTAL NUMBERS OF CONTAINERS	SAMPLE TYPE	TPH EPA 418.1	BTEX EPA 8020	LAB PID	REQUESTED ANALYSIS	REMARKS
	10-31-95	1000	soil	4P76	1	VC	X	X			Cutter #2 74289
	10-31-95	1444	soil	4P77	1	VC	X	X			2C-22#3 line drip
[The following rows of the table are crossed out with a large diagonal line.]											

RECEIVED BY: (Signature)		DATE/TIME		RECEIVED BY: (Signature)		DATE/TIME	
James F. Duran		10-31-95 1400		Julia D. Smith		11/1/95 9:10	
RECEIVED BY: (Signature)		DATE/TIME		RECEIVED BY: (Signature)		DATE/TIME	

REQUESTED TURNAROUND TIME:		RESULTS & INVOICES TO:	
<input type="checkbox"/> ROUTINE	<input type="checkbox"/> RUSH	FIELD SERVICES LABORATORY	
CARRIER CO.		EL PASO NATURAL GAS COMPANY	
BILL NO.:		P. O. BOX 4990	
		FARMINGTON, NEW MEXICO 87499	
		FAX: 505-599-2261	

CONTAINS HAZARDOUS MATERIALS

STRAIGHT BILL OF LADING
ORIGINAL - NOT NEGOTIABLE

Shipper's No. _____

CARRIER:

ENVIROTECH

(119577)

SCAC

Carrier's No. _____

Date 10-31-95

TO:

ENVIROTECH

5796 US HIGHWAY 64

FARMINGTON, NM 87401

Zip

FROM: EL PASO NATURAL GAS COMPANY

P.O. BOX 4990

Shipper Street FARMINGTON, NM 87499-4990

24324

Consignee

5796 US HIGHWAY 64

FARMINGTON, NM 87401

Zip

Destination

FARMINGTON, NM 87401

Zip

Origin

FARMINGTON, NM 87499-4990

Zip

Route:

Vehicle Number G-37

CONTAINS HAZARDOUS MAT LS

CONTAINS HAZARDOUS MATERIALS

No. Shipping Units	HM	Kind of Packages, Description of Articles (If HAZARDOUS MATERIALS - PROPER SHIPPING NAME)	HAZARD CLASS	I.D. Number	WEIGHT (subject to correction)	RATE	LABELS REQUIRED (or exemption)
778		Currier #2/Envirotech	EXEMPT HYDROCARBON CONTAMINATED SOIL	10/44	18	YD.	N/A
4		20-22 1/2 Line D.O.A. / Envirotech	EXEMPT HYDROCARBON CONTAMINATED SOIL	4/15	18	YD.	N/A
			EXEMPT HYDROCARBON CONTAMINATED SOIL			YD.	N/A
			EXEMPT HYDROCARBON CONTAMINATED SOIL			YD.	N/A
			EXEMPT HYDROCARBON CONTAMINATED SOIL			YD.	N/A
			EXEMPT HYDROCARBON CONTAMINATED SOIL			YD.	N/A

Remit C.O.D. to:

Address:

City:

State:

Zip:

COD

Amt:

\$

C.O.D. FEE:

Prepaid ☒ Collect ☐

FREIGHT CHARGES

REPAID ☒ COLLECT ☐

NOTE: Where the rate is dependent on value, shippers are required to state specifically in writing the agreed or declared value of the property. The agreed or declared value of the property is hereby specifically stated by the shipper to be not exceeding \$ _____ Per _____ (Signature of Shipper)

RECEIVED: subject to the classification and liability limit limits in effect on the date of issue of this Bill of Lading, the carrier described above in apparent good order, receipt as noted (contents of packages unknown), marked, consigned, and delivered as indicated above which said carrier (the word carrier being understood throughout this contract as meaning any person or corporation in possession of all or any of said property over all or any portion of said route to destination and as to each party at any time interested in all or any said property, that every service to be performed hereunder shall be subject to all the bill of lading terms and conditions in the governing classification and the date of shipment. Shipper hereby certifies that he is familiar with all the bill of lading terms and conditions in the governing classification and the said terms and conditions are hereby agreed to by the shipper and accepted for himself and his assigns.

The is to certify that the above named materials are properly classified, described, marked, and labeled in accordance with the requirements of the Department of Transportation.

PLACARDS REQUIRED

N/A

PLACARDS SUPPLIED

☐ YES ☒ NO - FURNISHED BY CARRIER DRIVER SIGNATURE

SHIPPER:

EL PASO NATURAL GAS COMPANY

PER:

SANDRA MILLER

DATE 10-31-95

CARRIER:

ENVIROTECH

PER:

Sandra Miller

DATE 10-31-95

EMERGENCY RESPONSE (EL PASO NATURAL GAS (505) 589-2141

505 328-2282 PHILIP ENVIRONMENTAL

MONITORED AT ALL TIMES THE HAZARDOUS MATERIAL IS IN TRANSPORTATION, INCLUDING STORAGE

CONTAINS HAZARDOUS MATERIALS

CONTAINS HAZARDOUS MATERIALS

STRAIGHT BILL OF LADING

ORIGINAL - NOT NEGOTIABLE

2082

Shipper's No.

CARRIER: ENVIROTECH

(11967)

SCAC

Carrier's No.

Date 10-31-95

TO: ENVIROTECH

Consignee 5796 US HIGHWAY 64

Street FARMINGTON, NM 87401

Destination

FROM: EL PASO NATURAL GAS COMPANY
Shipper P.O. BOX 4990
Street FARMINGTON, NM 87499-4990
Origin

Zip

Route:

Vehicle Number 65-37

CONTAINS HAZARDOUS MAT

No. Shipping Units	H/M	Kind of Packages, Description of Articles (If HAZARDOUS MATERIALS - PROPER SHIPPING NAME)	HAZARD CLASS	I.D. Number	WEIGHT (subject to correction)	RATE	LABELS REQUIRED (or exemption)
55		Envirotech / cutter #3 BACKFILL ENVIROTECH / 20.22 #3 live air BACKFILL	ENVIROTECH	74289	18	YD.	N/A
			BACKFILL			YD.	N/A
			BACKFILL			YD.	N/A
			BACKFILL			YD.	N/A
			BACKFILL			YD.	N/A

Remit C.O.D. to:

Address:

City:

COD Amt:

\$

C.O.D. FEE:

Prepaid ☒ Collect ☐

\$

NOTE - Where the rate is dependent on value, shippers are required to state specifically in writing the agreed or declared value of the property. The agreed or declared value of the property is hereby specifically stated by the shipper to be not exceeding \$

Subject to Section 2 of the Uniform Code of Sales, the shipper is to be delivered to the consignee without recourse on the property. The shipper, in signing the bill of lading, certifies that the property is as described and is in the possession of the shipper at the time of delivery. The shipper, in signing the bill of lading, certifies that the property is as described and is in the possession of the shipper at the time of delivery. The shipper, in signing the bill of lading, certifies that the property is as described and is in the possession of the shipper at the time of delivery.

FREIGHT CHARGES ☒ PREPAID ☐ COLLECT

RECEIVED subject to the classifications and liability listed in effect on the date of issue of this Bill of Lading, the property described above in apparent good order, except as noted (contents and condition of contents of packages and of the property are not guaranteed by the shipper, as receiving any person or corporate entity in possession of the property under the contract agrees to carry to its usual place of delivery at said destination, if on its route, otherwise to deliver to another carrier on the route, is hereby agreed to by the shipper. The shipper hereby certifies that he is familiar with all the bill of lading terms and conditions in the governing classification on the date of shipment. Shipper hereby certifies that he is familiar with all the bill of lading terms and conditions in the governing classification and the said terms and conditions are hereby agreed to by the shipper and accepted for himself and his assigns.

This is to certify that the above named materials are properly classified, packaged, marked and labeled and are in proper condition for transportation according to the applicable regulations of the Department of Transportation.

PLACARDS REQUIRED

N/A

PLACARDS SUPPLIED

☐ YES ☒ NO - FURNISHED BY CARRIER DRIVER SIGNATURE:

SHIPPER: EL PASO NATURAL GAS COMPANY

PER: SANDRA MILLER

DATE: 10-31-95

CARRIER: ENVIROTECH

PER: Sandra Miller

DATE: 10-31-95

EMERGENCY RESPONSE EL PASO NATURAL GAS (505) 588-2141 MONITORED AT ALL TIMES THE HAZARDOUS MATERIAL IS IN TRANSPORTATION, INCLUDING STORAGE
TELEPHONE NUMBER: 505 328-2262 PHILIP ENVIRONMENTAL INCIDENTAL TO TRANSPORTATION (172 604)

CONTAINS HAZARDOUS MATERIALS

CONTAINS HAZARDOUS MATERIALS

Shipper's No.

10-31-55

Zip 24324

Vehicle Number

CONTAINS HAZARDOUS MATERIALS

C.O.D. FEE:
 Prepaid ☒
 Collect ☐ \$

FREIGHT CHARGES
☒ PREPAID ☐ COLLECT

RECEIVED subject to the classifications and lawfully filed tariffs in effect on the date of issue of this Bill of Lading. The property described above in apparent good order, except as noted (tonnage and condition of contents of packages unknown), marked, consigned and destined as indicated above which said carrier the word "carrier" being understood throughout. This contract, as meaning any person or corporation in possession of the property (hereinafter called "shipper") agrees to carry to its usual place of delivery at said destination, if on its route, otherwise to deliver to another carrier on the route to said destination. It is mutually agreed as to each carrier of all or any of said property over all or any portion of said route to destination and as to each party at any time interested in all or any said property, that every service to be performed hereunder shall be subject to all the published shipping terms and conditions in the governing classification on the date of shipment. Shipper hereby certifies that he is familiar with all the bill of lading terms and conditions in the governing classification and the said terms and conditions are hereby agreed to by the shipper and accepted for himself and/or his assigns.

☐ YES ☒ NO -- FURNISHED BY CARRIER

DATE: 10-31-58

CONTAINS HAZARDOUS MATERIALS

CONTAINS HAZARDOUS MATERIALS

STRAIGHT BILL OF LADING
ORIGINAL - NOT NEGOTIABLE

Shipper's No. _____

CARRIER:

ENVIROTECH

(11957)

SCAC

Carrier's No. _____

Date

10-31-95

TO:

ENVIROTECH
5796 US HIGHWAY 64
FARMINGTON, NM 87401
Street
DestinationFROM: EL PASO NATURAL GAS COMPANY
Shipper P.O. BOX 4990
Street FARMINGTON, NM 87499-4990
Origin

24324

Zip

Route:

Vehicle Number 1601

CONTAINS HAZARDOUS MATERIALS

No. Shipping Units	HM	Kind of Packages, Description of Articles (If HAZARDOUS MATERIALS - PROPER SHIPPING NAME)	HAZARD CLASS	I.D. Number	WEIGHT (subject to correction)	RATE	LABELS REQUIRED (or exemption)
440		Envinorect/Cutter #2	BACKFILL 3MM	74288	18	YD.	N/A
440		Envinorect/20-22 1/2 Line	BACKFILL 3MM	N/A	15	YD.	N/A
440		Envinorect/20-22 1/2 Line	BACKFILL 3MM	N/A	18	YD.	N/A
		BACKFILL				YD.	N/A
		BACKFILL				YD.	N/A
		BACKFILL				YD.	N/A

Remit C.O.D. to:
Address:
City:

State:

Zip:

COD Amt: \$

C.O.D. FEE:
Prepaid ☒
Collect ☐ \$

NOTE - Where the rate is dependent on value, shippers are required to state specifically in writing the agreed or declared value of the property. The agreed or declared value of the property is hereby specifically stated by the shipper to be not exceeding \$ _____ Per _____

Subject to Section 7 of the conditions of this Bill of Lading, the shipper agrees to be delivered to the consignee without recourse on the cargo, and to hold the consignee harmless from all claims, damages, losses, and expenses, including freight, demurrage, and other charges, which may be incurred by the consignee in connection with the transportation of the cargo.

FREIGHT CHARGES
☒ PREPAID ☐ COLLECT

RECEIVED - Subject to the classifications and liability listed herein in effect on the date of issue of this Bill of Lading, the property described above in apparent good order, except as noted hereon, and condition of contents under the contract) agrees to carry to its usual place of delivery at said destination, if on its route, otherwise to deliver to another carrier on the route to said destination. It is mutually agreed as to each carrier of all or any of said property over all or any portion of said route to destination and as to each party at any time interested in all or any said property, that every service to be performed hereunder shall be subject to all the bill of lading terms and conditions in the governing classification on the date of shipment. Shipper hereby certifies that he is familiar with all the bill of lading terms and conditions in the governing classification and the said terms and conditions are hereby agreed to by the shipper and accepted for himself and his assigns.

This is to certify that the above named materials are properly classified, described, packaged, marked and labeled in accordance with the applicable provisions of the Department of Transportation.

PLACARDS REQUIRED

N/A

PLACARDS SUPPLIED

☐ YES ☒ NO - FURNISHED BY CARRIER
DRIVER SIGNATURE:

SHIPPER:

EL PASO NATURAL GAS COMPANY
PER: SANDRA MILLER
DATE: 10-31-95CARRIER: ENVIROTECH
PER: [Signature]
DATE: 10-31-95EMERGENCY RESPONSE (505) 328-2262 PHILIP ENVIRONMENTAL
TELEPHONE NUMBER: 505 328-2262MONITORED AT ALL TIMES - THE HAZARDOUS MATERIAL IS IN TRANSPORTATION, INCLUDING STORAGE
INCIDENTAL TO TRANSPORTATION (172.604)

CONTAINS HAZARDOUS MATERIALS

CONTAINS HAZARDOUS MATERIALS

CONTAINS HAZARDOUS MATERIALS

STRAIGHT BILL OF LADING
ORIGINAL - NOT NEGOTIABLE

Shipper's No. _____

CARRIER:

ENVIROTECH

(119577)

SCAC

Carrier's No. _____
Date

10 31 95

TO:

ENVIROTECH
5796 US HIGHWAY 64
FARMINGTON, NM 87401
Zip

FROM: EL PASO NATURAL GAS COMPANY

24324

Consignee

Shipper P.O. BOX 4990
Street FARMINGTON, NM 87499-4990
Origin Zip

Route:

Vehicle
Number

E48

CONTAINS HAZARDOUS MATERIALS

No. Shipping Units	HM	Kind of Packages, Description of Articles (If HAZARDOUS MATERIALS - PROPER SHIPPING NAME)	HAZARD CLASS	I.D. Number	WEIGHT (subject to correction)	RATE	LABELS REQUIRED (for exemption)
444		Carter #2 Envirotech	EXEMPT HYDROCARBON CONTAMINATED SOIL	1044	18	YD.	N/A
444		2c-22# 3 line Envirotech	EXEMPT HYDROCARBON CONTAMINATED SOIL	1044	18	YD.	N/A
444		2c-22# 5 line Envirotech	EXEMPT HYDROCARBON CONTAMINATED SOIL	1044	18	YD.	N/A
			EXEMPT HYDROCARBON CONTAMINATED SOIL			YD.	N/A
			EXEMPT HYDROCARBON CONTAMINATED SOIL			YD.	N/A
			EXEMPT HYDROCARBON CONTAMINATED SOIL			YD.	N/A

Remit C.O.D. to:

Address:

State:

Zip:

COD

Amt: \$

C.O.D. FEE:

Prepaid ☒ Collect ☐

\$

NOTE: Where the rate is dependent on value, shippers are required to state specifically in writing the agreed or declared value of the property. The agreed or declared value of the property is hereby specifically stated by the shipper to be not exceeding \$ _____ Per _____

Subject to Section 7 of the Uniform Code of Sales, if the shipment is to be delivered to the consignee without recourse on the basis of a bill of lading, the shipper shall not make delivery of the shipment without payment of freight and all other charges.

FREIGHT CHARGES
☒ PREPAID ☐ COLLECT

RECEIVED: Subject to the classifications and lawfully filed tariffs in effect on the date of issue of this Bill of Lading, the property described above in apparent good order, except as noted (contents and condition of contents of packages untoward, marked, consigned, and destined as indicated above which said carrier (the word carrier being understood throughout this contract as meaning any person or corporation in possession of the property) is not to be liable for loss of or damage to the property or for delay in delivery of the property to the consignee on the date of destination. It is mutually agreed as to each carrier of all or any of said property over all or any portion of said route to destination and as to each party at any time interested in all or any said property, that every service to be performed hereunder shall be subject to all the bill of lading terms and conditions on the governing classification on the date of shipment.

Shipper hereby certifies that he is familiar with all the bill of lading terms and conditions in the governing classification and the said terms and conditions are hereby agreed to by the shipper and accepted by himself and his assigns.

This is to certify that the above named materials are properly classified, described, packaged, marked and labeled and are in proper condition for transportation according to the applicable regulations of the Department of Transportation.

Per

Sandra Miller

PLACARDS REQUIRED

N/A

PLACARDS SUPPLIED

☐ YES ☒ NO - FURNISHED BY CARRIER
DRIVER SIGNATURE: *Sandra Miller*

SHIPPER:

EL PASO NATURAL GAS COMPANY
PER: SANDRA MILLER

DATE: 10 31 95

CARRIER: ENVIROTECH

PER: Sandra Miller

DATE: 10 31 95

EMERGENCY RESPONSE: EL PASO NATURAL GAS (505) 589-2141
TELEPHONE NUMBER: 505 326-2262 PHILIP ENVIRONMENTAL

MONITORED AT ALL TIMES THE HAZARDOUS MATERIAL IS IN TRANSPORTATION, INCLUDING STORAGE INCIDENTAL TO TRANSPORTATION (172 604)

CONTAINS HAZARDOUS MATERIALS

CONTAINS HAZARDOUS MATERIALS

STRAIGHT BILL OF LADING
ORIGINAL - NOT NEGOTIABLE

ORIGINAL - NOT NEGOTIABLE

Shipper's No

CARRIER: ENVIROTECH

(11957) SCAC

Carrier's No. 10 21 03
Date _____

TO: **ENVIROTECH**

FROM: EL PASO NATURAL GAS COMPANY 24324

FARMINGTON NM 87401

Street **FARMINGTON NM 87499-4990**

Zip

Origin	Zip
--------	-----

Route:

Vehicle Number E 48

No. Shipping Units	HM	Kind of Packages, Description of Articles (If HAZARDOUS MATERIALS - PROPER SHIPPING NAME)	HAZARD CLASS	I.D. Number	WEIGHT (Subject to correction)	RATE	LABELS REQUIRED (for exemption)
434		Envirotech / Currier #2	BACKFILL EMW	74289	18 [✓] YD.	N/A	
444		Envirotech / ac-223 th line drp	BACKFILL EMW	N/A	18 YD.	N/A	
444		Envirotech / ac-223 th line drp	BACKFILL EMW	N/A	18 YD.	N/A	
			BACKFILL		YD.	N/A	
			BACKFILL		YD.	N/A	

Remit C.O.D. to:

Address:

State: _____ Zip: _____

GOD Amt: \$

C.O.D. FEE:
Prepaid ☒
Collect ☐ \$

NOTE — Where the rate is dependent on value, shippers are required to state specifically writing the agreed or declared value of the property. The agreed or declared value of the property is hereby specifically stated by the shipper to be not exceeding \$ _____ Per _____

Subject to Section 7 of the conditions, if the shipment is to be delivered to the consignee without release on the consignee's behalf, the consignee shall sign the following statement:

The carrier shall not make delivery of this shipment without payment of freight and all other lawful charges.

Signature of Consignee:

FREIGHT CHARGES
☒ PREPAID ☐ COLLECT

RECEIVED. Subject to the classifications and lawfully filed tariff in effect on the date of issue of this Bill of Lading, the property described above in apparent good order, except as noted (contents and condition of contents of packages unknown), marked, consigned, and destined as indicated above which said carrier (the word "carrier" being understood throughout this contract as meaning any person or corporation in possession of the property under the contract) agrees to carry to its usual place of delivery at said destination, if on its route, otherwise to deliver to another carrier on the route to said destination. It is mutually agreed as to each carrier of all or any of said property over all or any portion of said route to date of shipment and conditions in the governing classification on the date of shipment of lading terms and conditions in the governing classification and the said terms and conditions are hereby agreed to by the shipper and accepted for himself and his assigns.

This is to certify that the above named materials are properly classified, described, packaged, marked and labeled and are in proper condition for transportation according to the applicable regulations of the Department of Transportation

Per *Joe E. Beckman*

**PLACARDS
REQUIRED**

N/A

**PLACARDS
SUPPLIED**

☐ YES ☒ NO — FURNISHED BY CARRIER
DRIVER SIGNATURE: *[Signature]*

SHIPPER: EL PASO NATURAL GAS COMPANY
PER: SANDRA MILLER DATE: /

CARRIER: ENVIROTECH
PER: Jim [Signature]

DATE: 10 31 85

EMERGENCY RESPONSE EL PASO NATURAL GAS (505) 589-2141
TELEPHONE NUMBER: (505) 328-2282 PHILLIP ENVIRONMENT

MONITORED AT ALL TIMES. THE HAZARDOUS MATERIAL IS IN TRANSPORTATION. INCLUDING STORAGE INCIDENTAL TO TRANSPORTATION (1172 604)

.CONTAINS HAZARDOUS MATERIALS

CONTAINS HAZARDOUS MATERIALS

CONTAINS HAZARDOUS MATERIALS

STRAIGHT BILL OF LADING
ORIGINAL - NOT NEGOTIABLE

ORIGINAL - NOT NEGOTIABLE

Shipper's No.

CARRIER: ENVIROTECH

(11957)) SCAC

Carrier's No. _____
Date _____

10-31-95

TO: ENVIROTECH

FROM: EL PASO NATURAL GAS COMPANY 24324

Consignee
Street
5796 US HIGHWAY 64
FARMINGTON, NM 87401

Destination Zip

Shipper P.O. BOX 4990
Street FARMINGTON, NM 87499-4990
Origin

zip

Route:

Vehicle Number
E-594527

No. Shipping Units	HM	Kind of Packages, Description of Articles (If Hazardous Materials - Proper Shipping Name)	Hazard Class	I.D. Number	Weight (Subject to correction)	Rate	Labels Required (for exemption)
438		Cutler #2 / Enviroseal	EXEMPT HYDROCARBON CONTAMINATED SOIL	10-45	15	YD.	N/A
2910		26-22 #3 Line	EXEMPT HYDROCARBON CONTAMINATED SOIL	1135	18	YD.	N/A
444		26-22 #3 Enviroseal	EXEMPT HYDROCARBON CONTAMINATED SOIL	117A	18	YD.	N/A
4410		26-22 #3 Enviroseal	EXEMPT HYDROCARBON CONTAMINATED SOIL	4440	18	YD.	N/A
44		26-22 #3 Enviroseal	EXEMPT HYDROCARBON CONTAMINATED SOIL			YD.	N/A
			EXEMPT HYDROCARBON CONTAMINATED SOIL			YD.	N/A
			EXEMPT HYDROCARBON CONTAMINATED SOIL			YD.	N/A
			EXEMPT HYDROCARBON CONTAMINATED SOIL			YD.	N/A

Remit C.O.D. to:
Address:
City:

State: Zip:

GOD
Amt:

5

C.O.D.	<input type="checkbox"/>	FEE:	
Prepaid	<input checked="" type="checkbox"/>		
Collect	<input type="checkbox"/>		\$

NOTE — Where the rate is dependent on value, shippers are required to state specifically in writing the agreed or declared value of the property. The agreed or declared value of the property is hereby specifically stated by the shipper to be not exceeding \$ _____ Per _____

Volunteers to determine if the "graduation" of this shipment is to be classified in the "volunteer" without "extraordinary" or "exceptional" status. The following statement is the "volunteer" statement of the "volunteer" without "extraordinary" or "exceptional" status.

FREIGHT CHARGES
☒ PREPAID ☐ COLLECT

RECEIVED subject to the classifications and lawfully filed tariffs in effect on the date of issue of this Bill of Lading, the Property described above in agreement good order, except as noted (contents and condition of contents of packages, unknown), marked, consigned and destined as indicated above, which said carrier the word carrier being understood throughout this contract as meaning any person or corporation in possession of the property under the contract agrees to carry to its usual place of delivery at said destination, if on its route, otherwise to deliver to another carrier on the route to said destination. It is mutually agreed as to each corner of all or any of said property over all or any portion of said route to destination and as to each liability at any time interested in all or any said property that every service to be performed hereunder shall be subject to all the bill of lading terms and conditions in the governing classification on the date of shipment. Shipper hereby certifies that he is familiar with all the bill of lading terms and conditions in the governing classification and the said terms and conditions are hereby agreed to by the Shipper and accepted for himself and his assigns.

This is to certify that the above named materials are properly classified (marked and packaged) and are in proper condition for transportation according to the applicable regulations of the Department of Transportation

Per: [Signature]

**PLACARDS
REQUIRED**

N/A

**PLACARDS
SUPPLIED**

☐ YES ☒ NO — FURNISHED BY CARRIER
DRIVER SIGNATURE.

SHIPPER: EL PASO NATURAL GAS COMPANY
PER: SANDRA MILLER DATE: / /

CARRIER: ENVIROTECH
PER: *Envirotech*

DATE: 10-31-99

EMERGENCY RESPONSE (EL PASO NATURAL GAS (505) 589-2141
TELEPHONE NUMBER: 505) 328-2282 PHILIP ENVIRONMENT

MONITORED AT ALL TIMES THE HAZARDOUS MATERIAL IS IN TRANSPORTATION, INCLUDING STORAGE INCIDENTAL TO TRANSPORTATION (172 604)

CONTAINS HAZARDOUS MATERIALS

CONTAINS HAZARDOUS MATERIALS

22

Shipper's No.

CARRIER: ENVIROTECH

(1957) SCAC

Carrier's No. _____
Date 10-31-95

TO: ENVIROTECH
Consignee 5796 US HIGHWAY 64
Street FARMINGTON, NM 87401
Destination Zlp

FROM: EL PASO NATURAL GAS COMPANY 24324
Shipper P.O. BOX 4990
Street FARMINGTON, NM 87499-4990
Origin Zip

Route:

Chris

Vehicle Number E-594527

No. Shipping Units	HM	Kind of Packages, Description of Articles (If HAZARDOUS MATERIALS - PROPER SHIPPING NAME)	HAZARD CLASS	I.D. Number	WEIGHT (subject to correction)	RATE	LABELS REQUIRED (for exemption)
1		Emviretech / Cutler #2	BACKFILL	2489	18	YD.	N/A
4		Emviretech / ac-22 #3 line	BACKFILL	N/A	18	YD.	N/A
6		Emviretech / ac-22 #3 line	BACKFILL	N/A	18	YD.	N/A
			BACKFILL			YD.	N/A
			BACKFILL			YD.	N/A

Remit C.O.D. to:
Address:
City:

State: Zip:

GOD **Amt:** **\$**

C.O.D. FEE:
Prepaid ☒
Collect ☐ \$

NOTE -- Where the rate is dependent on value, shippers are required to state specifically in writing the agreed or declared value of the property. The agreed or declared value of the property is hereby specifically stated by the shipper to be not exceeding \$ _____ Per _____

Subject to Section 7 of the conditions if this Impound is to be delivered to the consignee without release by the consignee, the consignee shall sign the following statement:

The consignee shall not receive delivery of this Impound without payment of freight and other lawful charges.

(Signature of Consignee)

FREIGHT CHARGES
☒ PREPAID ☐ COLLECT

RECEIVED, subject to the classifications and taxably fixed tariffs in effect on the date of issue of this Bill of Lading, the property described above in apparent good order, except as noted hereon and conditions of contents of packages (unknown), marked, consigned and destined as indicated above which said carrier, the world carrier being understood throughout this contract as meaning any person or corporation in possession of the property under the contract agrees to carry to its usual place of delivery at said destination. It is its route, otherwise to deliver to another carrier on the route to said destination. It is mutually agreed as to each carrier of all or any of said property over all or any portion of said route to destination and as to each party at any time interested in all or any said property, that every service to be performed hereunder shall be subject to all the bill of lading terms and conditions in the governing classification on the date of shipment.

Shipper hereby certifies that he is familiar with all the bill of lading terms and conditions in the governing classification and the said terms and conditions are hereby agreed to by the shipper and accepted for himself and his assignor.

This is to certify that the above named materials are properly classified, described, packaged, marked and labeled and are in proper condition for transportation according to the applicable regulations of the Department of Transportation

**PLACARDS
REQUIRED**

N/A

**PLACARDS
SUPPLIED**

☐ YES ☒ NO

FURNISHED BY CARRIER

SHIPPER: EL PASO NATURAL GAS COMPANY
PER: SANDRA MILLER DATE: /

CARRIER: ENVIROTECH
PER: J. Williams

DATE: 10-31-05

EMERGENCY RESPONSE (EL PASO NATURAL GAS (505) 588-2141
TELEPHONE NUMBER: (505) 328-2282 PHILLIP ENVIRONMENT

MONITORED AT ALL TIMES THE HAZARDOUS MATERIAL IS IN TRANSPORTATION, INCLUDING STORAGE INCIDENTAL TO TRANSPORTATION (172 604)

CONTAINS HAZARDOUS MATERIALS

CONTAINS HAZARDOUS MATERIAL

CONTAINS HAZARDOUS MATERIALS

CONTAINS HAZARDOUS MATERIALS

STRAIGHT BILL OF LADING

ORIGINAL - NOT NEGOTIABLE

2062

Shipper's No. _____

CARRIER: ENVIROTECH

(11957)

SCAC

Carrier's No. _____

Date 10-30-95

TO: ENVIROTECH

 Consignee
 5796 US HIGHWAY 64
 FARMINGTON, NM 87401
 Street
 Zip

 FROM: EL PASO NATURAL GAS COMPANY
 Shipper P.O. BOX 4990
 Street FARMINGTON, NM 87499-4990
 Origin
 Zip

Route:

Vehicle Number

2061

CONTAINS HAZARDOUS MATERIALS

No. Shipping Units	HM	Kind of Packages, Description of Articles (If HAZARDOUS MATERIALS - PROPER SHIPPING NAME)	HAZARD CLASS	I.D. Number	WEIGHT (Subject to correction)	RATE	LABELS REQUIRED (or exemption)
1330		ENVIROTECH/Casey Lane U#302	BACKFILL	93739	18	YD.	N/A
1535		Envirotech/Cutler #2	BACKFILL	74289	18	YD.	N/A
			BACKFILL			YD.	N/A
			BACKFILL			YD.	N/A
			BACKFILL			YD.	N/A

Remit C.O.D. to:

Address:

City:

State:

Zip:

COD

Amt: \$

\$

C.O.D. FEE:

Prepaid ☒ Collect ☐

\$

FREIGHT CHARGES

☒ REPAID ☐ COLLECT

NOTE — Where the rate is dependent on value, shippers are required to state specifically in writing the agreed or declared value of the property. The agreed or declared value of the property is hereby specifically stated by the shipper to be not exceeding \$ _____ Per _____

RECEIVED subject to the classification and handling and tariffs in effect on the date of issue of this Bill of Lading, the property described above in apparent good order, except as noted (contents and condition of contents of packages unknown), marked, counted and delivered as stated, with the understanding that the shipper, under the contract, agrees to carry to its usual place of delivery at said destination, if on its route, otherwise to deliver to another carrier on the route to said destination, it is mutually agreed and accepted by all parties of said property over all or any portion of said route to destination and as to each party at any time interested in all or any said property, that every service to be performed hereunder shall be subject to all the bill of lading terms and conditions in the governing classification on the date of shipment.

Shipper hereby certifies that he is familiar with all the bill of lading terms and conditions in the governing classification and the said terms and conditions are hereby agreed to by the shipper and accepted for himself and his assigns.

This is to certify that the above named materials are properly classified, described, packaged, marked and labeled and are in proper condition for transportation, according to the applicable regulations of the Department of Transportation.

PLACARDS REQUIRED

N/A

PLACARDS SUPPLIED

☐ YES ☒ NO — FURNISHED BY CARRIER
 DRIVER SIGNATURE: _____

SHIPPER: EL PASO NATURAL GAS COMPANY

PER: SANDRA MILLER

DATE: 10-30-95

CARRIER: ENVIROTECH

PER: Sandra Miller

DATE: 10-30-95

 EMERGENCY RESPONSE (505) 326-2262 PHILIP ENVIRONMENTAL
 TELEPHONE NUMBER: 505 326-2262

 MONITORED AT THE TIMES THE HAZARDOUS MATERIAL IS IN TRANSPORTATION INCLUDING STORAGE
 INCIDENTAL TO TRANSPORTATION (172.604)

CONTAINS HAZARDOUS MATERIALS

CONTAINS HAZARDOUS MATERIALS

CONTAINS HAZARDOUS MATERIALS

STRAIGHT BILL OF LADING
ORIGINAL - NOT NEGOTIABLE

Shipper's No. _____

CARRIER:

ENVIROTECH

(11957)

SCAC

Carrier's No. _____
Date

10-30-95

TO:

Consignee
Street
DestinationENVIROTECH
5796 US HIGHWAY 64
FARMINGTON, NM 87401
ZipFROM: EL PASO NATURAL GAS COMPANY
Shipper P.O. BOX 4990
Street FARMINGTON, NM 87499-4990
Origin

Zip

Route:

(11.0) Hrs.

Vehicle Number
1559No.
Shipping
UnitsHM
(If Hazardous Materials - Proper Shipping Name)HAZARD
CLASSI.D.
NumberWEIGHT
(subject to
correction)

RATE

LABELS REQUIRED
(or exemption)

N/A

N/A

N/A

N/A

N/A

N/A

N/A

N/A

N/A

N/A

Canyon Largo 11 # 301/Envirotech

1021 L
8/21/55EXEMPT HYDROCARBON
CONTAMINATED SOIL

93788

18

YD.

N/A

N/A

N/A

N/A

N/A

N/A

N/A

N/A

N/A

N/A

Canyon Largo 11 # 301/Envirotech

1021 L
8/21/55EXEMPT HYDROCARBON
CONTAMINATED SOIL

93789

18

YD.

N/A

N/A

N/A

N/A

N/A

N/A

N/A

N/A

N/A

N/A

Canyon Largo 11 # 301/Envirotech

1021 L
8/21/55EXEMPT HYDROCARBON
CONTAMINATED SOIL

74289

18

YD.

N/A

N/A

N/A

N/A

N/A

N/A

N/A

N/A

N/A

N/A

Remit C.O.D. to:
Address:
City:
State:
Zip:

City:

State:

Zip:

COD Amt: \$

C.O.D. FEE:
Prepaid ☒
Collect ☐ \$

NOTE: Where the rate is dependent on value, shippers are required to state specifically in writing the agreed or declared value of the property. The agreed or declared value of the property is hereby specifically stated by the shipper to be not exceeding \$ _____

Subject to Section 2 of the conditions of this agreement, the shipper agrees to indemnify the carrier for the full amount of any claim for damage to or loss of the property of the carrier or its employees, agents, independent contractors, or subcontractors, arising out of or in connection with the transportation of the property hereunder, including reasonable attorney's fees and costs of defense, investigation, and settlement.

FREIGHT CHARGES
☒ PREPAID ☐ COLLECT

RECEIVED: subject to the classifications and lawfully filed tariffs in effect on the date of issue of this Bill of Lading, the property described above in apparent good order, except as noted hereon, is hereby received by the carrier in its usual place of delivery at said destination, if on its route, otherwise to deliver to another carrier on the route to said destination. It is mutually agreed as to each carrier of all or any portion of said route to destination and as to each party at any time interested in all or any said property, that every service to be performed hereunder shall be subject to all the bill of lading terms and conditions. Shipper hereby certifies that he is familiar with all the bill of lading terms and conditions in the governing classification and the said terms and conditions are hereby agreed to by the shipper and accepted for himself and his assigns.

This is to certify that the above named materials are properly classified, described, packaged, marked and labeled and are in proper condition for transport according to the applicable regulations of the Department of Transportation.

Per

Sandra Miller

PLACARDS
REQUIRED

N/A

PLACARDS
SUPPLIED☐ YES ☒ NO - FURNISHED BY CARRIER
DRIVER SIGNATURE:

SHIPPER: EL PASO NATURAL GAS COMPANY

PER: SANDRA MILLER

DATE: 10-30-95

CARRIER: ENVIROTECH

PER: Sandra Miller

DATE: 10-30-95

EMERGENCY RESPONSE: EL PASO NATURAL GAS (505) 588-2141
TELEPHONE NUMBER: 505 328-2282 PHILIP ENVIRONMENTAL

MONITORED AT ALL TIMES THE HAZARDOUS MATERIAL IS IN TRANSPORTATION, INCLUDING STORAGE INCIDENT TO TRANSPORTATION (172.604)

CONTAINS HAZARDOUS MATERIALS

CONTAINS HAZARDOUS MATERIALS

CONTAINS HAZARDOUS MATERIALS

STRAIGHT BILL OF LADING
ORIGINAL - NOT NEGOTIABLE

2862

Shipper's No. _____

CARRIER: ENVIROTECH

(11957)

SCAC

Carrier's No. _____

Date 10-30-95

TO: ENVIROTECH

Consignee
5796 US HIGHWAY 64
Street
FARMINGTON, NM 87401
ZipFROM: EL PASO NATURAL GAS COMPANY 24324
Shipper P.O. BOX 4990
Street
FARMINGTON, NM 87499-4990
Origin
Zip

Route: _____

Vehicle Number

L-54-60000

CONTAINS HAZARDOUS MATERIALS

No. Shipping Units	Kind of Packages, Description of Articles (If HAZARDOUS MATERIALS - PROPER SHIPPING NAME)	HAZARD CLASS	I.D. Number	WEIGHT (subject to correction)	RATE	LABELS REQUIRED (or exemption)
448	Envirotech / Canyon Largo #302	BACKFILL	93788	18	YD.	N/A
53	Envirotech / Canyon Largo #302	BACKFILL	93739	18	YD.	N/A
120	Envirotech / Canyon Largo #302	BACKFILL	74259	18	YD.	N/A
1538	Envirotech / Canyon Largo #302	BACKFILL			YD.	N/A
		BACKFILL			YD.	N/A
		BACKFILL			YD.	N/A

Remit C.O.D. to: _____

Address: _____

City: _____

State: _____

Zip: _____

COD

Amt: \$

\$

C.O.D. FEE: _____

Prepaid ☒ Collect ☐

C.O.D. FEE: _____

\$

FREIGHT CHARGES

Prepaid ☒ Collect ☐

\$

Collect ☐

NOTE: Where the rate is dependent on value, shippers are required to state specifically in writing the agreed or declared value of the property. The agreed or declared value of the property is hereby specifically stated by the shipper to be not exceeding \$ _____ Per _____

Subject to the provisions of the Bill of Lading, the shipper warrants that the property described above is in apparent good order, except as noted (contents and condition of contents are the responsibility of the shipper and are not to be determined by the carrier). The shipper warrants that the property is not subject to any lien or claim of any kind, and that the property is not subject to any other claim of any kind.

RECEIVED subject to the classification and liability limit stated on the date of issue of this Bill of Lading, the property described above in apparent good order, except as noted (contents and condition of contents are the responsibility of the shipper and are not to be determined by the carrier). The shipper warrants that the property is not subject to any lien or claim of any kind, and that the property is not subject to any other claim of any kind.

The shipper warrants that the property is not subject to any lien or claim of any kind, and that the property is not subject to any other claim of any kind.

This is to certify that the above named materials are properly classified, described, packaged, marked and labeled and are in proper condition for transportation according to the applicable regulations of the Department of Transportation.

Per _____

Signature

PLACARDS REQUIRED

N/A

PLACARDS SUPPLIED

☐ YES ☒ NO

FURNISHED BY CARRIER DRIVER SIGNATURE: _____

SHIPPER: EL PASO NATURAL GAS COMPANY

PER: SANDRA MILLER

DATE: 10-30-95

CARRIER: ENVIROTECH

PER: Sandra Miller

DATE: 10-30-95

EMERGENCY RESPONSE EL PASO NATURAL GAS (505) 589-2141

MONITORED AT ALL TIMES THE HAZARDOUS MATERIAL IS IN TRANSPORTATION, INCLUDING STORAGE

TELEPHONE NUMBER: (505) 326-2282 PHILIP ENVIRONMENTAL INCIDENTIAL TO TRANSPORTATION (172 604)

CONTAINS HAZARDOUS MATERIALS

CONTAINS HAZARDOUS MATERIALS

CONTAINS HAZARDOUS MATERIALS

STRAIGHT BILL OF LADING

ORIGINAL - NOT NEGOTIABLE

Shipper's No. _____

CARRIER:

ENVIROTECH *Dob's*

(119571)

SCAC

Carrier's No. _____

Date *10-30-95*

TO:

ENVIROTECH

5796 US HIGHWAY 64

FARMINGTON, NM 87401

FROM: EL PASO NATURAL GAS COMPANY

24324

Consignee

5796 US HIGHWAY 64

FARMINGTON, NM 87401

Shipper P.O. BOX 4990

Street FARMINGTON, NM 87499-4990

Zip

Destination

FARMINGTON, NM 87401

Origin

Zip

Route:

*10*Vehicle Number *103*

No. of Packages, Description of Articles
Shipping Units **H/M** (If HAZARDOUS MATERIALS - PROPER SHIPPING NAME)

HAZARD CLASS

I.D. Number

WEIGHT (subject to correction)

RATE

LABELS REQUIRED (for exemption)

*1515**Canyon Largo 11 301/Envirotech*

EXEMPT HYDROCARBON CONTAMINATED SOIL

*93788**18**18*

YD.

N/A

*1521**Canyon Largo 11 301/Envirotech*

EXEMPT HYDROCARBON CONTAMINATED SOIL

*93739**18**18*

YD.

N/A

*1536**Cutter #2/Envirotech*

EXEMPT HYDROCARBON CONTAMINATED SOIL

*74289**18**18*

YD.

N/A

*1536**Cutter #2/Envirotech*

EXEMPT HYDROCARBON CONTAMINATED SOIL

*74289**18**18*

YD.

N/A

Remit C.O.D. to:

Address:

State:

Zip:

COD

Amt: \$

\$

C.O.D. FEE:

Prepaid ☒Collect ☐

\$

City:

State:

Zip:

COD

Amt: \$

\$

C.O.D. FEE:

Prepaid ☒Collect ☐

\$

NOTE — Where the rate is dependent on value, shippers are required to state specifically in writing the agreed or declared value of the property. The agreed or declared value of the property is hereby specifically stated by the shipper to be not exceeding \$ _____

Subject to Section 1 of the Uniform Code of Sales, the carrier shall not be liable for the loss or damage to the property unless the carrier has been notified in writing of the value of the property and the carrier has agreed to carry the property at that value.

FREIGHT CHARGES
☒ PREPAID ☐ COLLECT

RECEIVED subject to the classification and liability, filed herein in effect on the date of issue of this Bill of Lading, the property described above in apparent good order, except as noted hereon and conditions of contents of this Bill of Lading are hereby accepted by the carrier and the carrier shall not be liable for the loss or damage to the property unless the carrier has been notified in writing of the value of the property and the carrier has agreed to carry the property at that value.

This is to certify that the above named materials are properly classified, described, packaged, marked and labeled and are in proper condition for transportation according to the applicable regulations of the Department of Transportation.

PLACARDS REQUIRED

N/A

PLACARDS SUPPLIED

☐ YES ☒ NO — FURNISHED BY CARRIER
DRIVER SIGNATURE: _____

SHIPPER:

EL PASO NATURAL GAS COMPANY

CARRIER: ENVIROTECH

PER:

SANDRA MILLER

DATE: *10-30-95*PER: *Sandra Miller*DATE: *10-30-95*

EMERGENCY RESPONSE

EL PASO NATURAL GAS (505) 598-2141

MONITORED AT ALL TIMES THE HAZARDOUS MATERIAL IS IN TRANSPORTATION, INCLUDING STORAGE

INCIDENTAL TO TRANSPORTATION (172.804)

CONTAINS HAZARDOUS MATERIALS

CONTAINS HAZARDOUS MATERIALS

STRAIGHT BILL OF LADING
ORIGINAL - NOT NEGOTIABLE

ORIGINAL - NOT NEGOTIABLE

Shipper's No

CARRIER:

ENVIROTECH

(1957)

SCAC

Carrier's No
Date

B 10-30-45

10:

ENVIROTECH

5796 US HIGHWAY 64

Street
Destination

FARMINGTON, NM 87401
Zip

FROM: EL PASO NATURAL GAS COMPANY
Shipper
Street P.O. BOX 4990
Origin FARMINGTON, NM 87499-4990

24324

Route:

Vehicle Number **D3**

No. Shipping Units	HM	Kind of Packages, Description of Articles (If HAZARDOUS MATERIALS - PROPER SHIPPING NAME)	HAZARD CLASS	I.D. Number	WEIGHT (Subject to correction)	RATE	LABELS REQUIRED (for exemption)
12-21		ENVIROTECH / CANISTER 1A900 1 st 302	BACKFILL	93737	18	YD.	N/A
15-30		ENVIROTECH / CANISTER #2	BACKFILL	71289	18	YD.	N/A
			BACKFILL			YD.	N/A
			BACKFILL			YD.	N/A
			BACKFILL			YD.	N/A

Remit C.O.D. to:
Address:

City:

State:

zip:

Good

Amit

4

C.O.D. FEE:
 Prepaid ☒
 Collect ☐ \$

NOTE — Where the rate is dependent on value, shippers are required to state specifically writing the agreed or declared value of the property. The agreed or declared value of the property is hereby specifically stated by the shipper to be not exceeding \$ _____ Per _____

Subject to the conditions, if the Shipment is to be delivered to the consignee without receipt on the part of the consignee, and any of the following statement

The carrier shall not make delivery of this Shipment without payment of freight and all other lawful charges

(Signature of Consignor)

FREIGHT CHARGES
☒ **XX** PREPAID ☐ COLLECT

RECEIVED, subject to the classifications and lawfully tied tariffs in effect on the date of issue of this Bill of lading, the Property described above in apparent good order, except as noted (contents and condition of contents of packages unknown), marked, consigned, and destined as indicated above which said carrier (the word carrier being understood throughout this contract as meaning any person or corporation in possession of the property) hereby agrees to carry to its usual place of delivery at said destination, if on its route, otherwise to deliver to another carrier on the route to said destination. It is mutually agreed as to each carrier of all or any portion of said route to destination and as to each party at any time thereafter in all or any said property, that every service to be performed hereunder shall be subject to all the bills of lading terms and conditions in the governing classification on the date of shipment.

Shipper hereby certifies that he is familiar with all the bill of lading terms and conditions in the governing classification and the said terms and conditions are hereby agreed to by the Shipper and accepted for himself and his assigns.

This is to certify that the above named materials are properly classified, described, packaged, marked and labeled and are in proper condition for transportation according to the applicable regulations of the Department of Transportation

Per: Steve Dobbs

**PLACARDS
REQUIRED**

N/A

**PLACARDS
SUPPLIED**

☐ YES ☒ NO — FURNISHED BY CARRIER

DRIVER SIGNATURE:

SHIPPER: EL PASO NATURAL GAS COMPANY
PER: SANDRA MILLER DATE: /

CARRIER: ENVIROTECH
PER: *[Signature]*

DATE: 10-30-95

EMERGENCY RESPONSE (505) 398-2114
TELEPHONE NUMBER: (505) 328-2262 PHILIP ENVIRONNEMENT

MONITORED AT ALL TIMES. THE HAZARDOUS MATERIAL IS IN TRANSPORTATION, INCLUDING STORAGE INCIDENTAL TO TRANSPORTATION (172 604)

.CONTAINS HAZARDOUS MATERIALS

CONTAINS HAZARDOUS MATERIAL

CONTAINS HAZARDOUS MATERIALS

STRAIGHT BILL OF LADING
ORIGINAL - NOT NEGOTIABLE

ORIGINAL - NOT NEGOTIABLE

252

Shipper's No.

10-30-95

FROM: EL PASO NATURAL GAS COMPANY 24324

zip

Route:

Vehicle Number

45

LABELS REQUIRED
(or exemption)

N/A

N/A

N/A

N/A

N/A

C.O.D. FEE:
Prepaid ☒

Collect ☐ \$

NOTE — Where the rate is dependent on value, shippers are required to state specifically in writing the agreed or declared value of the property. The agreed or declared value of the property hereby specifically stated by the shipper to be not exceeding \$ _____ Per _____

Signature of Comptroller

FREIGHT CHARGES

☒ PREPAID ☐ COLLECT

RECEIVED subject to the classifications and liability filed tariffs in effect on the date of issue of this Bill of Lading, the property described above in apparent good order, except as noted (contents and condition of contents of packages unknown), marked, consigned, and destined as indicated above which said carrier, being understood throughout this contract as meaning any person or corporation in possession of the property under the contract, agrees to carry to its usual place of delivery at said destination, on its route, otherwise to deliver to another carrier on the route to said destination. It is mutually agreed as to each carrier of all or any of said property over all or any portion of said route to destination and as to each party at any time interested in all or any said property, that every service to be performed hereunder shall be subject to all the bills of lading terms and conditions in the governing classification on the date of shipment.

Shipper hereby certifies that he is familiar with all the bill of lading terms and conditions in the governing classification and the said terms and conditions are hereby agreed to by the shipper and accepted for himself and his assigns.

This is to certify that the above-named materials are properly classified, described, packaged, marked and labeled and are in proper condition for transportation according to the applicable regulations of the Department of Transportation.

**PLACARDS
REQUIRED**

N/A

PLACARDS

☐ YES ☒ NO — FURNISHED BY CARRIER

SHIPPER: EL PASO NATURAL GAS COMPANY

CARRIER: ENVIROTECH

SANDRA MILLER

DATE: 10-30-95

PER: *Personnel*

DATE: 10-30-95

EMERGENCY RESPONSE EL PASO NATURAL GAS (505) 588-2141
TELEPHONE NUMBER: (505) 328-2262 PHILIP ENVIRONMENT

MONITORED AT ALL TIMES THE HAZARDOUS MATERIAL IS IN TRANSPORTATION. INCLUDING STORAGE INCIDENTAL TO TRANSPORTATION. (177 604)

CONTAINS HAZARDOUS MATERIALS

CONTAINS HAZARDOUS MAT

CONTAINS HAZARDOUS MATERIALS

CONTAINS HAZARDOUS MATERIALS

STRAIGHT BILL OF LADING
ORIGINAL - NOT NEGOTIABLE

1062

Shipper's No. _____

CARRIER:

ENVIROTECH

(11957)

SCAC

Carrier's No. _____

Date 10-30-95

TO:

Consignee
Street
DestinationENVIROTECH
5796 US HIGHWAY 64
FARMINGTON, NM 87401

Zip

FROM: EL PASO NATURAL GAS COMPANY
Shipper P.O. BOX 4990
Street FARMINGTON, NM 87499-4990
Origin

Zip

Route:

Vehicle
Number

E-47

No.
Shipping
UnitsKind of Packages, Description of Articles
(If HAZARDOUS MATERIALS - PROPER SHIPPING NAME)HAZARD
CLASSI.D.
NumberWEIGHT
(subject to
correction)

RATE

LABELS REQUIRED
(for exemption)

430	Canyon Largo 14302/Envirotech	11301	EXEMPT HYDROCARBON CONTAMINATED SOIL	73793	18	YD.	N/A
430	Carter #2/Envirotech	11302	EXEMPT HYDROCARBON CONTAMINATED SOIL	74289	18	YD.	N/A
430			EXEMPT HYDROCARBON CONTAMINATED SOIL			YD.	N/A
430			EXEMPT HYDROCARBON CONTAMINATED SOIL			YD.	N/A
430			EXEMPT HYDROCARBON CONTAMINATED SOIL			YD.	N/A

Remit C.O.D. to:

Address:

State:

Zip:

COD

Amt: \$

C.O.D. FEE:
Prepaid ☒
Collect ☐ \$

NOTE — Where the rate is dependent on value, shippers are required to state specifically in writing the agreed or declared value of the property. The agreed or declared value of the property is hereby specifically stated by the shipper to be not exceeding \$ _____ Per _____

Subject to Section 1 of the Uniform Code of Sales, the shipper is to be obligated to the consignee without recourse on the basis of the value of the property. The shipper shall not be liable for the value of the property in the event of loss or damage to the property without payment of the agreed or declared value of the property.

FREIGHT CHARGES
☒ PREPAID ☐ COLLECT

RECEIVED — subject to the classifications and liability filed herein in effect on the date of issue of this Bill of Lading, the property described above in apparent good order, except as noted (contents and condition of contents of packages unknown), marked, consigned, and destined as indicated above, which said carrier (the word carrier being understood throughout this contract as meaning any person or corporation in possession of the property of the shipper) has received from the shipper, and is hereby acknowledged by the carrier, to be the property of the shipper, and the carrier is not to be liable for the value of the property in the event of loss or damage to the property without payment of the agreed or declared value of the property. The shipper hereby certifies that he is familiar with all the bill of lading terms and conditions in the governing classification and the said terms and conditions are hereby agreed to by the shipper and accepted for himself and his assigns.

This is to certify that the above named material is properly classified, marked, packaged, marked and labeled and are in proper condition for transportation according to the applicable regulations of the Department of Transportation.

PLACARDS
REQUIRED

N/A

PLACARDS
SUPPLIED☐ YES ☒ NO — FURNISHED BY CARRIER
DRIVER SIGNATURE: _____

SHIPPER:

EL PASO NATURAL GAS COMPANY
PER: SANDRA MILLER

DATE: 10-30-95

CARRIER:

ENVIROTECH
PER: _____

DATE: 10-30-95

EMERGENCY RESPONSE
TELEPHONE NUMBER:EL PASO NATURAL GAS (505) 588-2141
505-328-2262 PHILIP ENVIROMENTALMONITORED AT ALL TIMES THIS HAZARDOUS MATERIAL IS IN TRANSPORTATION, INCLUDING STORAGE
INCIDENTAL TO TRANSPORTATION (1772 604)

CONTAINS HAZARDOUS MATERIALS

CONTAINS HAZARDOUS MATERIALS

STRAIGHT BILL OF LADING
ORIGINAL - NOT NEGOTIABLE

ORIGINAL - NOT NEGOTIABLE

ENVIROTECH

(1957)

SCAC

Carrier's No. _____
Date _____

100-01

ENVIROTECH

Consignee	5796 US HIGHWAY 64
Street	FARMINGTON, NM 87401
Destination	Zip

FROM: EL PASO NATURAL GAS COMPANY 24324
Shipper P.O. BOX 4990
Street FARMINGTON, NM 87499-4990
Origin Zip

Route:

Vehicle Number

E-47

No. Shipping Units	HM	Kind of Packages, Description of Articles (If HAZARDOUS MATERIALS - PROPER SHIPPING NAME)	HAZARD CLASS	I.D. Number	WEIGHT (Subject to correction)	RATE	LABELS REQUIRED (or exemption)
444							
1030		Envirotech/Campylobacter #302	BACKFILL	93793	18	YD.	N/A
444							
1530		Envirotech/Campylobacter #302	BACKFILL	74289	15	YD.	N/A
			BACKFILL			YD.	N/A
			BACKFILL			YD.	N/A
			BACKFILL			YD.	N/A

Remit C.O.D. to:
Address:
City:

State:

Zip:

FOI

Amt:

C.O.D. FEE:
Prepaid ☒
Collect ☐ \$

NOTE - Where the rate is dependent on value, shippers are required to state specifically in writing the agreed or declared value of the property. The agreed or declared value of the property is hereby specifically stated by the shipper to be not exceeding \$ Per

believe no version of the conclusion if this argument is to be directed to the "conscience" without "erring alongside the conscience," still sign the following statement:

The writer shall not make reference to this argument without judgment of "being good and able to be of benefit."

Signatures of Conscience!

FREIGHT CHARGES
☒ PREPAID ☐ COLLECT

RECEIVED subject to the classifications and lawfully filed tariffs in effect on the date of issue of this Bill of Lading, the property described above in apparent good order, except as noted (contents and condition of contents of packages unknown), marked, consigned, and destined as indicated above which said carrier, being understood throughout this contract as meaning any person or corporation in possession of the property, hereby agrees to carry to its usual place of delivery at said destination, or in its route otherwise to deliver to another carrier on the route to said destination. It is mutually agreed as to each carrier of all or any of said property over all or any portion of said route to destination and as to each party at any time interested in all or any said property that every service to be performed hereunder shall be subject to all the bills of lading terms and conditions in the governing classification on the date of shipment. Shipper hereby certifies that he is familiar with all the bill of lading terms and conditions in the governing classification and the said terms and conditions are hereby agreed to by the shipper and accepted for himself and his assigns.

This is to certify that the above named materials are properly classified, prescribed, packaged, marked and labeled and are in proper condition for transportation according to the applicable regulations of the Department of Transportation.

PLACARDS

NIA

PLACARDS

☐ YES ☒ NO -- FURNISHED BY CARRIER

SHIPPER:

EL PASO NATURAL GAS COMPANY

CARRIER. / ENVIROTECH

PER:

SANDRA MILLER

DATE: 10-30-91

PER: /

2

DATE: 11-30-55

EMERGENCY RESPONSE EL PASO NATURAL GAS (505) 589-2141
TELEPHONE NUMBER: (505) 328-2262 PHILLIP ENVIRONMENT

MONITORED AT ALL TIMES THE HAZARDOUS MATERIAL IS IN TRANSPORTATION, INCLUDING STORAGE INCIDENTAL TO TRANSPORTATION. (1172 604)

CONTAINS HAZARDOUS MATERIALS

CONTAINS HAZARDOUS MATERIALS

Shipper's No

S. NO. _____
Date 10-31-88

24324

zip

6-65

C.O.D. FEE:
Prepaid ☒
Collect ☐ \$

FREIGHT CHARGES

☒ PREPAID ☐ COLLECT

☐ YES ☒ NO — FURNISHED BY CARRIER

100

DATE: 10/30/95

MATERIAL IS IN TRANSPORTATION, INCLUDING STORAGE

CONTAINS HAZARDOUS MATERIALS

CONTAINS HAZARDOUS MATERIALS

STRAIGHT BILL OF LADING

ORIGINAL - NOT NEGOTIABLE

Shipper's No. _____

Carrier's No. _____

Date 10/30/95

SCAC

(11957)

CARRIER:

ENVIROTECH

TO:

ENVIROTECH

Consignee

5796 US HIGHWAY 64

Street

FARMINGTON, NM 87491

Zip

FROM:

EL PASO NATURAL GAS COMPANY

Shipper P.O. BOX 4990

Street

FARMINGTON, NM 87499-4990

Zip

Route:

Vehicle Number

L-65

No. of Shipping Units

Kind of Packages, Description of Articles (If HAZARDOUS MATERIALS - PROPER SHIPPING NAME)

HAZARD CLASS

I.D. Number

WEIGHT (subject to correction)

RATE

LABELS REQUIRED (or exemption)

35

10/30

ENVIROTECH / CAVALLERIE # 302

BACKFILL

93731

18

YD.

N/A

1590

Envirotech / Cutler #2 ET

BACKFILL

74289

18

YD.

N/A

BACKFILL

YD.

N/A

BACKFILL

YD.

N/A

BACKFILL

YD.

N/A

Remit C.O.D. to:

Address:

State:

Zip:

COD

Amt:

\$

C.O.D. FEE:

Prepaid ☒ Collect ☐

\$

NOTE - Where the rate is dependent on value, shippers are required to state specifically in writing the agreed or declared value of the property. The agreed or declared value of the property is hereby specifically stated by the shipper to be not exceeding \$ _____ Per _____

Subject to Section 7 of the conditions, a shipper is to be deemed to be the consignee unless required in writing to deliver the property to a consignee other than the shipper. The shipper is to be deemed to be the consignee unless required in writing to deliver the property to a consignee other than the shipper. The shipper is to be deemed to be the consignee unless required in writing to deliver the property to a consignee other than the shipper.

FREIGHT CHARGES ☒ PREPAID ☐ COLLECT

RECEIVED - subject to the classifications and lawfully filed tariffs in effect on the date of issue of this Bill of Lading, the property described above in apparent good order, except as noted (contents and condition of contents of packages unknown), marked, consigned, and delivered as indicated above which said carrier (the word carrier being understood throughout this contract as meaning any person or corporation in possession of the property under the contract) agrees to carry to its usual place of delivery at said destination, if on its route, otherwise to deliver to another carrier on the route to said destination. It is mutually agreed as to each carrier of all or part of said property that the carrier of said property shall be subject to all the bill of lading conditions and terms and conditions of the carrier of said property. Shipper hereby certifies that he is familiar with all the bill of lading terms and conditions in the governing classification and the said terms and conditions are hereby agreed to by the shipper and accepted for himself and his assigns.

This is to certify that the above named materials are properly classified, described, packaged, marked and labeled and are in proper condition for transportation according to applicable regulations of the Department of Transportation.

PLACARDS REQUIRED

N/A

PLACARDS SUPPLIED

☐ YES ☒ NO - FURNISHED BY CARRIER DRIVER SIGNATURE: _____

SHIPPER: EL PASO NATURAL GAS COMPANY

PER: SANDRA MILLER

DATE: 10/30/95

CARRIER: ENVIROTECH

PER: TRAVIS Hamblin

DATE: 10/30/95

EMERGENCY RESPONSE EL PASO NATURAL GAS (505) 589-2141

MONITORED AT ALL TIMES THE HAZARDOUS MATERIAL IS IN TRANSPORTATION, INCLUDING STORAGE

TELEPHONE NUMBER: 505 326-2282 PHILIP ENVIRONMENTAL INCIDENTAL TO TRANSPORTATION (172 604)

CONTAINS HAZARDOUS MATERIALS

CONTAINS HAZARDOUS MATERIALS

CONTAINS HAZARDOUS MATERIALS

CONTAINS HAZARDOUS MATERIALS

STRAIGHT BILL OF LADING
ORIGINAL - NOT NEGOTIABLE

Shipper's No. _____

CARRIER:

ENVIROTECH

(119571)

SCAC

Carrier's No. _____
Date

11-30-95

TO:

Consignee
Street
DestinationENVIROTECH
5796 US HIGHWAY 64
FARMINGTON, NM 87401FROM: EL PASO NATURAL GAS COMPANY
Shipper P.O. BOX 4990
Street FARMINGTON, NM 87499-4990
Zip

Route:

Vehicle
Number 37

CONTAINS HAZARDOUS MAT

No. Shipping Units	H/M	Kind of Packages, Description of Articles (If Hazardous Materials - Proper Shipping Name)	HAZARD CLASS	I.D. Number	WEIGHT (Subject to correction)	RATE	LABELS REQUIRED (or exemption)
0910		Canpen 1000 11/30/95	EXEMPT HYDROCARBON CONTAMINATED SOIL	93768	18	YD.	N/A
0910		Canpen 1000 11/30/95	EXEMPT HYDROCARBON CONTAMINATED SOIL	93739	18	YD.	N/A
0910		Canpen 1000 11/30/95	EXEMPT HYDROCARBON CONTAMINATED SOIL	74289	15	YD.	N/A
0910		Canpen 1000 11/30/95	EXEMPT HYDROCARBON CONTAMINATED SOIL			YD.	N/A

Remit C.O.D. to:

Address:

City:

State:

Zip:

COD

Amt: \$

C.O.D. FEE:
Prepaid ☒ Collect ☐FREIGHT CHARGES
☒ PREPAID ☐ COLLECT

NOTE — Where the rate is dependent on value, shippers are required to state specifically in writing the agreed or declared value of the property. The agreed or declared value of the property is hereby specifically stated by the shipper to be not exceeding \$ _____ Per _____

Signature of Shipper
The shipper certifies that the above described materials are in proper condition for transportation according to the applicable regulations of the Department of Transportation.

RECEIVED subject to the classification and handling listed herein in effect on the date of issue of this Bill of Lading, the property described above in apparent good order, except as noted hereon and conditions of contents under the contract agrees to carry to its usual place of delivery at said destination, if on its route, otherwise to deliver to another carrier on the route to said destination. It is mutually agreed as to each carrier of all or any of, said property over all or any portion of said route to destination and as to each party at any time interested in all or any said property that every service to be performed hereunder shall be subject to all the bill of lading terms and conditions in the governing classification on the date of shipment. Shipper hereby certifies that he is familiar with all the bill of lading terms and conditions in the governing classification and the said terms and conditions are hereby agreed to by the shipper and accepted for himself and his assigns.

This is to certify that the above named materials are properly classified, described, packaged, marked and labeled and are in proper condition for transportation according to the applicable regulations of the Department of Transportation.

PLACARDS
REQUIRED

N/A

PLACARDS
SUPPLIED☐ YES ☒ NO — FURNISHED BY CARRIER
DRIVER SIGNATURE: _____

SHIPPER:

PER: SANDRA MILLER

DATE: 11-30-95

CARRIER: ENVIROTECH

PER: Sandra Miller

DATE: 11-30-95

EMERGENCY RESPONSE
TELEPHONE NUMBER: 505 328-2283 PHILIP ENVIRONMENTALEL PASO NATURAL GAS COMPANY
505 589-2141MONITORED AT ALL TIMES THE HAZARDOUS MATERIAL IS IN TRANSPORTATION INCLUDING STORAGE
INDIVIDUAL TO TRANSPORTATION (172 B04)

CONTAINS HAZARDOUS MATERIALS

CONTAINS HAZARDOUS MATERIALS

CONTAINS HAZARDOUS MATERIALS

STRAIGHT BILL OF LADING

ORIGINAL - NOT NEGOTIABLE

Shipper's No. _____

CARRIER:

ENVIROTECH

(119571)

SCAC

Carrier's No. _____

Date 10-30-95

TO:

ENVIROTECH

FROM: EL PASO NATURAL GAS COMPANY 24324

Consignee

5796 US HIGHWAY 64

Shipper P.O. BOX 4990

Street

FARMINGTON, NM 87401

Street

FARMINGTON, NM 87499-4990

Zip

Route:

Vehicle Number 237

CONTAINS HAZARDOUS MAT

CONTAINS HAZARDOUS MATERIALS

No. Shipping Units	Kind of Packages, Description of Articles (If HAZARDOUS MATERIALS - PROPER SHIPPING NAME)	HAZARD CLASS	I.D. Number	WEIGHT (Subject to correction)	RATE	LABELS REQUIRED (or exemption)
1111	Canyon Largo 4 #302 Envirotech	EXEMPT HYDROCARBON CONTAMINATED SOIL	43773	10	YD.	N/A
1111	Canyon Largo 4 #302 Envirotech	EXEMPT HYDROCARBON CONTAMINATED SOIL	43773	10	YD.	N/A
1111	Cutter #2 / Envirotech	EXEMPT HYDROCARBON CONTAMINATED SOIL	44289	10	YD.	N/A
		EXEMPT HYDROCARBON CONTAMINATED SOIL			YD.	N/A
		EXEMPT HYDROCARBON CONTAMINATED SOIL			YD.	N/A

Remit C.O.D. to:

Address:

City:

State:

Zip:

COD Amt: \$

C.O.D. FEE: Prepaid ☒ Collect ☐

NOTE - Where the rate is dependent on value, shippers are required to state specifically in writing the agreed or declared value of the property. The agreed or declared value of the property is hereby specifically stated by the shipper to be not exceeding \$ _____ Per _____

Subject to Section 7 of the conditions of this bill of lading, the shipper is to be delivered to the consignee without recourse on the property described herein, subject to the following: The shipper shall retain title to the property until payment in full has been received by the shipper. The shipper shall retain title to the property until payment in full has been received by the shipper. The shipper shall retain title to the property until payment in full has been received by the shipper.

FREIGHT CHARGES: ☒ PREPAID ☐ COLLECT

RECEIVED - subject to the classifications and liability filed tariffs in effect on the date of issue of this Bill of Lading, the property described above in apparent good order, except as noted (contents and condition of contents of packages unknown, marked, consigned, and destined as indicated above which said carrier (the word carrier being understood throughout this contract as meaning any person or corporation in possession of the property under the contract) agrees to carry to its usual place of delivery at said destination, if on its route, otherwise to deliver to another carrier on the route to said destination. It is mutually agreed as to each carrier of all or any of said property over all or any portion of said route to destination and as to each party at any time interested in all or any said property, that every service to be performed hereunder shall be subject to all the bill of lading terms and conditions in the governing classification on the date of shipment.

The shipper certifies that he is familiar with all the above-mentioned terms and conditions in the governing classification and the said terms and conditions are hereby agreed to by the shipper and accepted for himself and his assigns.

PLACARDS REQUIRED

N/A

PLACARDS SUPPLIED

☐ YES ☒ NO - FURNISHED BY CARRIER DRIVER SIGNATURE: _____

SHIPPER:

EL PASO NATURAL GAS COMPANY

CARRIER: ENVIROTECH

PER:

SANDRA MILLER

DATE 10-30-95

PER: Sandra Miller

DATE 10-30-95

EMERGENCY RESPONSE

EL PASO NATURAL GAS (505) 598-2141

MONITORED AT ALL TIMES THE HAZARDOUS MATERIAL IS IN TRANSPORTATION, INCLUDING STORAGE

INCIDENTAL TO TRANSPORTATION (172 504)

CONTAINS HAZARDOUS MATERIALS

CONTAINS HAZARDOUS MATERIALS

STRAIGHT BILL OF LADING

ORIGINAL - NOT NEGOTIABLE

Shipper's No. _____

CARRIER: ENVIROTECH Bar 37 (11957)) SCAC

Carrier's No. _____
Date 10/30/95

TO: ENVIROTECH
Consignee 5796 US HIGHWAY 64
Street FARMINGTON, NM 87401
Destination Zip

FROM: EL PASO NATURAL GAS COMPANY 24324
Shipper P.O. BOX 4990
Street FARMINGTON, NM 87499-4990
Origin Zip

Route: _____

Vehicle Number L-64

CONTAINS HAZARDOUS MATERIALS

CONTAINS HAZARDOUS MATERIALS

No. Shipping Units	HM	Kind of Packages, Description of Articles (If HAZARDOUS MATERIALS - PROPER SHIPPING NAME)	HAZARD CLASS	I.D. Number	WEIGHT (subject to correction)	RATE	LABELS REQUIRED (for exemption)
1015		Canyon Largo 14 th 302/Envirotech	EXEMPT HYDROCARBON CONTAMINATED SOIL	7373	10	YD.	N/A
1110		Canyon Largo 14 th 302/Envirotech	EXEMPT HYDROCARBON CONTAMINATED SOIL	7373	10	YD.	N/A
1620		Cutter # 2/Envirotech	EXEMPT HYDROCARBON CONTAMINATED SOIL	74259	10	YD.	N/A
			EXEMPT HYDROCARBON CONTAMINATED SOIL			YD.	N/A
			EXEMPT HYDROCARBON CONTAMINATED SOIL			YD.	N/A

Remit C.O.D. to:

Address: _____

City: _____

State: _____

Zip: _____

C.O.D. FEE: Prepaid ☒ Collect ☐

NOTE — Where the rate is dependent on value, shippers are required to state specifically in writing the agreed or declared value of the property. The agreed or declared value of the property is hereby specifically stated by the shipper to be not exceeding \$ _____

Subject to Section 7 of the conditions, if any, hereinafter it is to be delivered to the consignee without recourse on the part of the shipper, the consignee shall sign the following statement: I hereby certify that the above described property is in conformity with the bill of lading and is in conformity with the bill of lading and is in conformity with the bill of lading.

FREIGHT CHARGES: ☒ PREPAID ☐ COLLECT

RECEIVED, subject to the classifications and lawfully filed tariffs in effect on the date of issue of this Bill of Lading, the property described above in apparent good order, except as noted hereon, and condition of contents of packages unknown, marked, consigned, and delivered as indicated above, which said carrier (the word carrier being understood throughout this contract as meaning any person or corporation in possession of the property or any of said property over all or any portion of said route to destination and as to each party at any time interested in all or any said property, that every service to be performed hereunder shall be subject to all the bill of lading terms and conditions in the governing classification on the date of shipment and the said terms and conditions are hereby agreed to by the shipper and accepted by himself and his assigns.

This is to certify that the above named materials are properly classified, described, marked, and labeled and are in proper condition for transportation according to applicable regulations of the Department of Transportation.

PLACARDS REQUIRED

N/A

PLACARDS SUPPLIED

☐ YES ☒ NO — FURNISHED BY CARRIER DRIVER SIGNATURE: _____

SHIPPER: EL PASO NATURAL GAS COMPANY

PER: SANDRA MILLER DATE: 10/30/95

CARRIER: ENVIROTECH

PER: Sandra Miller DATE: 10/30/95

EMERGENCY RESPONSE: EL PASO NATURAL GAS (505) 598-2141

MONITORED AT ALL TIMES THE HAZARDOUS MATERIAL IS IN TRANSPORTATION, INCLUDING STORAGE INCIDENTAL TO TRANSPORTATION (172 604)

CONTAINS HAZARDOUS MATERIALS

CONTAINS HAZARDOUS MATERIAL

291

S. NO. 11-20-95
Date 11-20-95

24324

Zip

4087

CONTAINS HAZARDOUS MATERIALS

C.O.D. FEE: ☒ Prepaid ☐ Collect \$

FREIGHT CHARGES

☒ PREPAID ☐ COLLECT

contents and condition of contents in possession of the property need as to each carrier of all or shall be subject to all the bill and accepted for himself and

☐ YES ☒ NO — FURNISHED BY CARRIER

DATE: 6-30-25

MATERIAL IS IN TRANSPORTATION, INCLUDING STORAGE

CONTAINS HAZARDOUS MATERIALS

CONTAINS HAZARDOUS MATERIALS

STRAIGHT BILL OF LADING

ORIGINAL - NOT NEGOTIABLE



Shipper's No. _____

CARRIER:

ENVIROTECH

(11957)

SCAC

Carrier's No. _____
Date _____

10-30-85

TO:

ENVIROTECH

Consignee
5796 US HIGHWAY 64
FARMINGTON, NM 87401
Street
DestinationFROM: EL PASO NATURAL GAS COMPANY
Shipper P.O. BOX 4990
Street FARMINGTON, NM 87499-4990
Origin
Zip

Route:

Vehicle
Number

41087

No. of Packages, Description of Articles
Shipping Unit (If HAZARDOUS MATERIALS - PROPER SHIPPING NAME)HAZARD
CLASSI.D.
NumberWEIGHT
(subject to
correction)

RATE

LABELS REQUIRED
(or exemption)

111	Envirotech Canyon Largo #302	BACKFILL	93753	10	YD.	N/A
1235	Envirotech Canyon Largo #302	BACKFILL	93753	10	YD.	N/A
1345	Envirotech Canyon Largo #302	BACKFILL	74289	10	YD.	N/A
		BACKFILL			YD.	N/A
		BACKFILL			YD.	N/A

Remit C.O.D. to:
Address:
City: State: Zip:

State:

Zip:

COD

Amt: \$

\$

C.O.D. FEE:
Prepaid ☒
Collect ☐ \$

NOTE - Where the rate is dependent on value, shippers are required to state specifically in writing the agreed or declared value of the property. The agreed or declared value of the property is hereby specifically stated by the shipper to be not exceeding \$ _____

Subject to Section 7 of the conditions of this Bill of Lading, the property described above in apparent good order, except as noted, contents and condition of contents under the contract agree to carry to its usual place of delivery at said destination, if on its route, otherwise to deliver to another carrier on the route to said destination. It is mutually agreed as to each carrier of all or any of said property over all or any portion of said route to destination and as to each party at any time interested in all or any said property, that every service to be performed hereunder shall be subject to all the bill of lading terms and conditions in the governing classification on the date of shipment.

FREIGHT CHARGES
☒ PREPAID ☐ COLLECT

The above described materials are property classified, described, packaged, marked and labeled and are in proper condition for transportation in accordance with the Department of Transportation.

PLACARDS
REQUIRED

N/A

PLACARDS
SUPPLIED☐ YES ☒ NO - FURNISHED BY CARRIER
DRIVER SIGNATURE: _____

SHIPPER: EL PASO NATURAL GAS COMPANY

CARRIER: ENVIROTECH

PER: SANDRA MILLER DATE: 10-30-85

PER: Sandra Miller DATE: 10-30-85

EMERGENCY RESPONSE EL PASO NATURAL GAS (505) 598-2141
TELEPHONE NUMBER: (505) 328-2282 PHILIP ENVIRONMENTALMONITORED AT ALL TIMES THE HAZARDOUS MATERIAL IS IN TRANSPORTATION, INCLUDING STORAGE
INCIDENTAL TO TRANSPORTATION (172 604)

CONTAINS HAZARDOUS MATERIALS

CONTAINS HAZARDOUS MATERIALS

CONTAINS HAZARDOUS MATERIALS

STRAIGHT BILL OF LADING

ORIGINAL - NOT NEGOTIABLE

Shipper's No. _____

CARRIER: DOUG FOUTZ CONSTRUCTION (11957-PITS) SCAC

Carrier's No. 10-30-93
Date

TO: ENVIROTECH

Consignee
5796 US HIGHWAY 64
Street
FARMINGTON, NM 87401
Destination
ZipFROM: EL PASO NATURAL GAS COMPANY 24324
Shipper P.O. BOX 4990
Street
FARMINGTON, NM 87499-4990
Origin
ZipRoute: 106f2114 hrs. Vehicle Number 72

No. Shipping Units	H/M	Kind of Packages, Description of Articles (If HAZARDOUS MATERIALS - PROPER SHIPPING NAME)	HAZARD CLASS	I.D. Number	WEIGHT (subject to correction)	RATE	LABELS REQUIRED (or exemption)
1005		Canyon Largo #302 Envinco	EXEMPT HYDROCARBON CONTAMINATED SOIL	53793	10	YD.	N/A
1115		Canyon Largo #302 Envinco	EXEMPT HYDROCARBON CONTAMINATED SOIL	53793	10	YD.	N/A
1135		Cutler #2 Envinco	EXEMPT HYDROCARBON CONTAMINATED SOIL	74289	10	YD.	N/A
			EXEMPT HYDROCARBON CONTAMINATED SOIL			YD.	N/A
			EXEMPT HYDROCARBON CONTAMINATED SOIL			YD.	N/A
			EXEMPT HYDROCARBON CONTAMINATED SOIL			YD.	N/A

Remit C.O.D. to:

Address:

City:

State:

Zip:

COD Amt: \$

C.O.D. FEE:
Prepaid ☒
Collect ☐ \$

NOTE - Where the rate is dependent on value, shippers are required to state specifically in writing the agreed or declared value of the property. The agreed or declared value of the property is hereby specifically stated by the shipper to be not exceeding \$ _____ Per _____ (Signature of Shipper)

Subject to Section 7 of the conditions, if the shipper is to be delivered to the consignee without release on the bill of lading, the shipper shall sign the bill of lading with the signature of the shipper and the signature of the consignee. The bill of lading shall be signed by the shipper and the consignee. The bill of lading shall be signed by the shipper and the consignee. The bill of lading shall be signed by the shipper and the consignee.

FREIGHT CHARGES
☒ PREPAID ☐ COLLECT

RECEIVED subject to the classifications and lawfully filed tariffs in effect on the date of issue of this Bill of Lading, the property described above in apparent good order, except as noted (contents and condition of contents of packages unknown), marked, consigned, and destined as indicated above which said carrier (the word carrier being understood throughout this contract as meaning any person or corporation in possession of the property under the contract) agrees to carry to its usual place of delivery at said destination, if on its route, otherwise to deliver to another carrier on the route to said destination. It is mutually agreed as to each carrier of all or any of said property over all or any portion of said route to destination and as to each party at any time interested in all or any said property, that every service to be performed hereunder shall be subject to all the bill of lading terms and conditions in the governing classification on the date of shipment. Shading terms and conditions that the shipper certifies that he is familiar with all the bill of lading terms and conditions in the governing classification and the said terms and conditions are hereby agreed to by the shipper and accepted for himself and his assigns.

This is to certify that the above named materials are properly classified, described, marked and labeled and are in proper condition for transportation according to the applicable regulations of the Department of Transportation.

PLACARDS REQUIRED

N/A

PLACARDS SUPPLIED

☐ YES ☒ NO - FURNISHED BY CARRIER DRIVER SIGNATURE: _____

SHIPPER: EL PASO NATURAL GAS COMPANY

PER: SANDRA MILLER

DATE:

CARRIER: DOUG FOUTZ CONSTRUCTION

PER: 10-30-93DATE: 10-30-93EMERGENCY RESPONSE (EL PASO NATURAL GAS (505) 588-2141
TELEPHONE NUMBER: 505 308-2262 PHILIP ENVIROMENTAL

MONITORED AT ALL TIMES THE HAZARDOUS MATERIAL IS IN TRANSPORTATION, INCLUDING STORAGE INCIDENT TO TRANSPORTATION (172 604)

CONTAINS HAZARDOUS MATERIALS

CONTAINS HAZARDOUS MATERIALS

CONTAINS HAZARDOUS MATERIALS

CONTAINS HAZARDOUS MATERIALS

STRAIGHT BILL OF LADING
ORIGINAL - NOT NEGOTIABLE

Shipper's No. _____

CARRIER: DOUG FOUTZ CONSTRUCTION (11957 - PITS)CAC

Carrier's No. _____
Date 10-30-93TO: ENVIROTECH
Consignee 5796 US HIGHWAY 64
Street FARMINGTON, NM 87401
Destination ZipFROM: EL PASO NATURAL GAS COMPANY 24324
Shipper P.O. BOX 4990
Street FARMINGTON, NM 87499-4990
Origin ZipRoute: 2052Vehicle Number 72

CONTAINS HAZARDOUS MAT

CONTAINS HAZARDOUS MATERIALS

No. Shipping Units	HM	Kind of Packages, Description of Articles (If Hazardous Materials - Proper Shipping Name)	HAZARD CLASS	I.D. Number	WEIGHT (subject to correction)	RATE	LABELS REQUIRED (or exemption)
1005		Envirotech Canyon Canyon #302 BACKFILL		93795	10	YD.	N/A
1315		Envirotech Canyon Canyon #302 BACKFILL		93795	10	YD.	N/A
1425		Envirotech Canyon Canyon #302 BACKFILL		74359	10	YD.	N/A
		BACKFILL				YD.	N/A
		BACKFILL				YD.	N/A
		BACKFILL				YD.	N/A

Remit C.O.D. to:
Address:
City:

State: Zip:

C.O.D. Amt: \$

C.O.D. FEE:
Prepaid ☒ Collect ☐ \$

NOTE: Where the rate is dependent on value, shippers are required to state specifically in writing the agreed or declared value of the property. The agreed or declared value of the property is hereby specifically stated by the shipper to be not exceeding \$ _____ Per _____

Subject to Section 7 of the Uniform Code of Sales, the shipper is to be delivered to the consignee without recourse on the terms, which are hereby agreed to by the shipper, without payment of freight and all other charges.

FREIGHT CHARGES
☒ PREPAID ☐ COLLECT

RECEIVED: subject to the classifications and lawfully filed tariffs in effect on the date of issue of this Bill of Lading, the property described above in apparent good order, except as noted (contents and condition of contents of packages unknown), marked, consigned and destined as indicated above which said carrier (the word carrier being understood throughout this contract as meaning any person or corporation in possession of the property of said property over all or any portion of said route to destination and as to each party at any time interested in all or any said property, that every service to be performed hereunder shall be subject to all the bill of lading terms and conditions in the governing classification on the date of shipment. Shipper hereby certifies that he is familiar with all the bill of lading terms and conditions in the governing classification and the said terms and conditions are hereby agreed to by the shipper and accepted for himself and his assigns.

This is to certify that the above named materials are properly classified, described, packaged, marked and labeled and are in proper condition for transportation according to the applicable regulations of the Department of Transportation.

PLACARDS REQUIRED

N/A

PLACARDS SUPPLIED

☐ YES ☒ NO - FURNISHED BY CARRIER DRIVER SIGNATURE: _____SHIPPER: EL PASO NATURAL GAS COMPANY
PER: SANDRA MILLER DATE:CARRIER: DOUG FOUTZ CONSTRUCTION
PER: 2052 DATE: 10-30-93EMERGENCY RESPONSE: EL PASO NATURAL GAS (505) 599-2141
TELEPHONE NUMBER: 505 326-2262 PHILIP ENVIRONMENTAL

MONITORED AT ALL TIMES THE HAZARDOUS MATERIAL IS IN TRANSPORTATION, INCLUDING STORAGE INCIDENTAL TO TRANSPORTATION (172.604)

CONTAINS HAZARDOUS MATERIALS

CONTAINS HAZARDOUS MATERIALS

STRAIGHT BILL OF LADING

ORIGINAL - NOT NEGOTIABLE

Shipper's No. _____

CARRIER:

DOUG FOUTZ CONSTRUCTION (11957-PTS) SCAC

Carrier's No. _____

Date 10-30-95

TO:

Consignee
Street
DestinationENVIROTECH
5796 US HIGHWAY 64
FARMINGTON, NM 87401
ZipFROM: EL PASO NATURAL GAS COMPANY
Shipper P.O. BOX 4990
Street FARMINGTON, NM 87499-4990
Origin Zip

24324

Route:

1 of 2

11 hrs

Vehicle Number

132

Shipping Unit	HM	Kind of Packages, Description of Articles (If HAZARDOUS MATERIALS - PROPER SHIPPING NAME)	HAZARD CLASS	I.D. Number	WEIGHT (subject to correction)	RATE	LABELS REQUIRED (for exemption)
1020		Canopy bargain #302/Envirotech	EXEMPT HYDROCARBON CONTAMINATED SOIL	93753	10	YD.	N/A
1310		Canopy bargain #303/Envirotech	EXEMPT HYDROCARBON CONTAMINATED SOIL	93793	10	YD.	N/A
1330		Cutter #2/Envirotech	EXEMPT HYDROCARBON CONTAMINATED SOIL	74289	10	YD.	N/A
			EXEMPT HYDROCARBON CONTAMINATED SOIL			YD.	N/A
			EXEMPT HYDROCARBON CONTAMINATED SOIL			YD.	N/A
			EXEMPT HYDROCARBON CONTAMINATED SOIL			YD.	N/A

Remit C.O.D. to:
Address:
City:
State:
Zip:

C.O.D. Amt: \$

C.O.D. FEE:
Prepaid ☒
Collect ☐ \$

NOTE — Where the rate is dependent on value, shippers are required to state specifically in writing the agreed or declared value of the property. The agreed or declared value of the property is hereby specifically stated by the shipper to be not exceeding \$ _____ Per _____

Signature of Shipper

FREIGHT CHARGES
☒ PREPAID ☐ COLLECT

RECEIVED — subject to the classification and liability filed tariffs in effect on the date of issue of this Bill of Lading, the carrier described above in apparent good order, except as noted hereon, and condition of contents under the contract agrees to carry to its usual place of delivery at said destination, if on its route, otherwise to deliver to another carrier on the route to said destination. It is mutually agreed as to each carrier of all or of loading terms and conditions in the governing classification on the date of shipment.

The shipper warrants that he is familiar with all the bill of lading terms and conditions in the governing classification and the said terms and conditions, are hereby agreed to by the shipper and accepted by himself and his assigns.

This is the same as the bill of lading for the property described above, and the shipper and carrier agree to be bound by the terms and conditions of the bill of lading for the property described above, and the shipper and carrier agree to be bound by the terms and conditions of the bill of lading for the property described above.

PLACARDS REQUIRED

N/A

PLACARDS SUPPLIED

☐ YES ☒ NO — FURNISHED BY CARRIER
DRIVER SIGNATURE: _____

SHIPPER: EL PASO NATURAL GAS COMPANY

CARRIER: DOUG FOUTZ CONSTRUCTION

PER: SANDRA MILLER

PER: Sandra MillerDATE: 10-30-95EMERGENCY RESPONSE (505) 589-2141
TELEPHONE NUMBER: (505) 326-2282 PHILIP ENVIRONMENTALMONITORED AT ALL TIMES THE HAZARDOUS MATERIAL IS IN TRANSPORTATION, INCLUDING STORAGE
INCIDENTAL TO TRANSPORTATION (172 604)

CONTAINS HAZARDOUS MATERIALS

CONTAINS HAZARDOUS MATERIALS

STRAIGHT BILL OF LADING
ORIGINAL - NOT NEGOTIABLE

CARRIER: DOUG FOUTZ CONSTRUCTION (11957 - PITTSBURGH) CAC

Carrier's No. _____
Date 10-30-85

TO: ENVIROTECH

Consignee	5796 US HIGHWAY 64
Street	FARMINGTON, NM 87401
Destination	Zip

FROM: EL PASO NATURAL GAS COMPANY 24324
Shipper P.O. BOX 4990
Street FARMINGTON, NM 87499-4990
Origin Zip

Route: 2012

Venice Number	132
---------------	-----

No. Shipping Units	HM	Kind of Packages, Description of Articles (If HAZARDOUS MATERIALS - PROPER SHIPPING NAME)	HAZARD CLASS	I.D. Number	WEIGHT (subject to correction)	RATE	LABELS REQUIRED (for exemption)
9411							
020		Carinated/campenlarged #302	BACKFILL	93793	10	YD.	N/A
9410							
1310		Carinated/campenlarged #302	BACKFILL	93793	10	YD.	N/A
9410							
1550		Carinated/cutler #2	BACKFILL	74289	10	YD.	N/A
			BACKFILL			YD.	N/A
			BACKFILL			YD.	N/A

Remit C.O.D. to:
Address:
City:

State: Zip:

GOD Amt: \$

C.O.D. FEE:
Prepaid ☒
Collect ☐ \$

NOTE - Where the rate is dependent on value, shippers are required to state specifically writing the agreed or declared value of the property. The agreed or declared value of the property is hereby specifically stated by the shipper to be not exceeding \$ Per

(Signature of Sergeant)

FREIGHT CHARGES
☒ PREPAID ☐ COLLECT

RECEIVED subject to the classifications and lawfully filed tariffs in effect on the date of issue of this Bill of Lading, the E-goods described above in agreement good order, except as noted (contents and condition of contents of packages unknown), marked, consigned and delivered above which said carrier, the word carrier being understood throughout this contract as meaning any person or corporation in possession of the property under the contract agrees to carry to its usual place of delivery at said destination, it on its route, otherwise to deliver to another carrier on the route to said destination. It is mutually agreed as to each carrier of all or any of said property over all or any portion of said route to destination and as to each party at any time interested in all or any said property, that every service to be performed hereunder shall be subject to all the bills of lading terms and conditions in the governing classification on the date of shipment.

Shipper hereby certifies that he is familiar with all the bill of lading terms and conditions in the governing classification and the said terms and conditions are hereby agreed to by the shipper and accepted for himself and his assigns.

This is to certify that the above named materials are properly classified, described, packaged, marked and labeled and are in proper condition for transportation according to the applicable regulations of the Department of Transportation.

PLACARDS REQUIRED

NWA

PLACARDS CLIPPED

☐ YES ☒ NO -- FURNISHED BY CARRIER

SHIPPER: EL PASO NATURAL GAS COMPANY

CARRIER: DOUG FOUTZ CONSTRUCTION

PER:	SANDRA MILLER	DATE:
------	---------------	-------

PER: KE Bland DATE: 10-30-95

EMERGENCY RESPONSE
TELEPHONE NUMBER: (505) 326-2262 PHILLIP ENVIRONMENT

MONITORED AT ALL TIMES THE HAZARDOUS MATERIAL IS IN TRANSPORTATION, INCLUDING STORAGE INCIDENTAL TO TRANSPORTATION (172.604)

CONTAINS HAZARDOUS MATERIALS

CONTAINS HAZARDOUS MATERIALS

CONTAINS HAZARDOUS MATERIALS

STRAIGHT BILL OF LADING
ORIGINAL - NOT NEGOTIABLE

Shipper's No. _____

CARRIER:

DOUG FOULTZ CONSTRUCTION

(11957 - PITSSCAC)

Carrier's No. _____
Date 10-30-95

TO:

Consignee
Street
DestinationENVIROTECH
5796 US HIGHWAY 64
FARMINGTON, NM 87401
ZipFROM: EL PASO NATURAL GAS COMPANY
Shipper P.O. BOX 4990
Street FARMINGTON, NM 87499-4990
Origin Zip

Route:

20f2Vehicle Number 432No. of Packages, Description of Articles
Shipping Units (IF HAZARDOUS MATERIALS - PROPER SHIPPING NAME)

HAZARD CLASS

I.D. Number

WEIGHT (subject to correction)

RATE

LABELS REQUIRED (for exemption)

10000 Envinorated Canyon large #302 BACKFILL

73773

10

YD.

N/A

1315 Envinorated Canyon large #302 BACKFILL

93773

10

YD.

N/A

1005 Envinorated/Cutler #2 BACKFILL

74259

10

YD.

N/A

BACKFILL

YD.

YD.

N/A

BACKFILL

YD.

YD.

N/A

Remit C.O.D. to:

Address:

City:

State:

Zip:

COD

Amt: \$

C.O.D. FEE:
Prepaid ☒
Collect ☐ \$

NOTE - Where the rate is dependent on value, shippers are required to state specifically in writing the agreed or declared value of the property. The agreed or declared value of the property is hereby specifically stated by the shipper to be not exceeding \$ _____ Per _____

Subject to Section 7 of the conditions, if any, shipment is to be delivered to the consignee without recourse on the part of the shipper. The shipper warrants that the property is not subject to any lien or other claim of any kind.

FREIGHT CHARGES
☒ PREPAID ☐ COLLECT

RECEIVED, subject to the classifications and lawfully filed tariffs in effect on the date of issue of this Bill of Lading, the property described above in apparent good order, except as noted (contents and condition of contents of packages unknown), marked, consigned, and destined as indicated above which said carrier (the word carrier being understood throughout this contract as meaning any person or corporation in possession of the property under the contract) agrees to carry to its usual place of delivery at said destination, if on its route, otherwise to deliver to another carrier on the route to said destination. It is mutually agreed as to each carrier of all or any of said property over all or any portion of said route to destination and as to each party at any time interested in all or any said property, that every service to be performed hereunder shall be subject to all the bill of lading terms and conditions in the governing classification and the said terms and conditions are hereby agreed to by the shipper and accepted for himself and his assigns.

This is to certify that the above named materials are properly classified, described, marked and labeled and are in proper condition for transportation according to the applicable regulations of the Department of Transportation.

PLACARDS REQUIRED

N/A

PLACARDS SUPPLIED

☐ YES ☒ NO - FURNISHED BY CARRIER
DRIVER SIGNATURE: _____

SHIPPER:

EL PASO NATURAL GAS COMPANY
PER: SANDRA MILLER DATE: _____

CARRIER: DOUG FOULTZ CONSTRUCTION

PER: AI [Signature] DATE: 10-30-95EMERGENCY RESPONSE (EL PASO NATURAL GAS (505) 589-2141
TELEPHONE NUMBER: 505 328-2262 PHILIP ENVIRONMENTALMONITORED AT ALL TIMES THE HAZARDOUS MATERIAL IS IN TRANSPORTATION, INCLUDING STORAGE
INCIDENTAL TO TRANSPORTATION (177 604)

CONTAINS HAZARDOUS MATERIALS

CONTAINS HAZARDOUS MATERIALS

CONTAINS HAZARDOUS MATERIALS

CONTAINS HAZARDOUS MATERIALS

STRAIGHT BILL OF LADING

ORIGINAL - NOT NEGOTIABLE

Shipper's No. _____

CARRIER: DOUG FOUTZ CONSTRUCTION (11967 - PIT\$CAC)

Carrier's No. _____
Date 10-30

TO: ENVIROTECH

Consignee 5796 US HIGHWAY 64
Street FARMINGTON, NM 87401
Destination ZipFROM: EL PASO NATURAL GAS COMPANY 24324
Shipper P.O. BOX 4990
Street FARMINGTON, NM 87499-4990
Origin Zip

Route: 2 of 2

Vehicle Number 731

CONTAINS HAZARDOUS MATERIALS

No. Shipping Units	Kind of Packages, Description of Articles (If HAZARDOUS MATERIALS - PROPER SHIPPING NAME)	HAZARD CLASS	I.D. Number	WEIGHT (Subject to correction)	RATE	LABELS REQUIRED (or exemption)
11980	Envirotech Canyon bagroll #302	BACKFILL		93793	10	YD. N/A
11980	Envirotech Canyon bagroll #302	BACKFILL		93793	10	YD. N/A
11980	Envirotech Canyon bagroll #302	BACKFILL		74285	10	YD. N/A
11980	Envirotech Canyon bagroll #302	BACKFILL				YD. N/A
11980	Envirotech Canyon bagroll #302	BACKFILL				YD. N/A
11980	Envirotech Canyon bagroll #302	BACKFILL				YD. N/A

Remit C.O.D. to:

Address:

City: State: Zip:

COD Amt: \$

C.O.D. FEE: Prepaid ☒ Collect ☐

NOTE - Where the rate is dependent on value, shippers are required to state specifically in writing the agreed or declared value of the property. The agreed or declared value of the property is hereby specifically stated by the shipper to be not exceeding \$ _____

Subject to Section 7 of the conditions of this bill of lading, the shipper is to be addressed to the consignee without recourse on the property. The consignee shall sign the following statement: "I hereby acknowledge receipt of the property in the condition and quantity stated on this bill of lading."

FREIGHT CHARGES ☒ PREPAID ☐ COLLECT

RECEIVED - subject to the classifications and liability limit tariffs in effect on the date of issue of this Bill of Lading, the property described above in apparent good order, except as noted (contents and condition of contents of packages unknown, marked, consigned, and destined as indicated above which said carrier (the word carrier being understood throughout this contract as meaning any person or corporation in possession of the property under the contract) agrees to carry to its usual place of delivery at said destination, if on its route, otherwise to deliver to another carrier on the route to said destination. It is mutually agreed as to each carrier of all or any of said property over all or any portion of said route to destination and as to each party at any time interested in all or any said property, that every service to be performed hereunder shall be subject to all the bill of lading terms and conditions in the governing classification on the date of shipment. Shipment is hereby certified that the shipper is familiar with all the bill of lading terms and conditions in the governing classification and the said terms and conditions are hereby agreed to by the shipper and accepted for himself and his assigns.

This is to certify that the above named materials are properly classified, packaged, marked and labeled and are in proper condition for transportation according to the applicable regulations of the Department of Transportation.

PLACARDS REQUIRED

N/A

PLACARDS SUPPLIED

☐ YES ☒ NO - FURNISHED BY CARRIER DRIVER SIGNATURE: _____

SHIPPER: EL PASO NATURAL GAS COMPANY

PER: SANDRA MILLER DATE:

CARRIER: DOUG FOUTZ CONSTRUCTION

PER: Doug Foutz DATE: 10-30

EMERGENCY RESPONSE (EL PASO NATURAL GAS (505) 588-2141

MONITORED AT ALL TIMES THE HAZARDOUS MATERIAL IS IN TRANSPORTATION, INCLUDING STORAGE TELEPHONE NUMBER: (505) 308-0280 PHILIP ENVIRONMENTAL INCIDENTAL TO TRANSPORTATION (192 604)

CONTAINS HAZARDOUS MATERIALS

CONTAINS HAZARDOUS MATERIALS

CONTAINS HAZARDOUS MATERIALS

STRAIGHT BILL OF LADING
ORIGINAL - NOT NEGOTIABLE

Shipper's No. _____

CARRIER: DOUG FOUTZ CONSTRUCTION (11957-PITS) SCAC

Carrier's No. _____
Date 10-30-94

TO: ENVIROTECH
Consignee 5796 US HIGHWAY 64
Street FARMINGTON, NM 87401
Destination Zip

FROM: EL PASO NATURAL GAS COMPANY 24324
Shipper P.O. BOX 4990
Street FARMINGTON, NM 87499-4990
Origin Zip

Route: 1 of 2

11 hrs.

Vehicle Number

835

No. Shipping Units	Kind of Packages, Description of Articles (If HAZARDOUS MATERIALS - PROPER SHIPPING NAME)	HAZARD CLASS	I.D. Number	WEIGHT (subject to correction)	RATE	LABELS REQUIRED (or exemption)
1015	Canyon Largo #302/Envirotech	EXEMPT HYDROCARBON CONTAMINATED SOIL	93793	10	YD.	N/A
1016	Canyon Largo #302/Envirotech	EXEMPT HYDROCARBON CONTAMINATED SOIL	93793	10	YD.	N/A
1017	Canyon Largo #302/Envirotech	EXEMPT HYDROCARBON CONTAMINATED SOIL	93793	10	YD.	N/A
1018	Canyon Largo #302/Envirotech	EXEMPT HYDROCARBON CONTAMINATED SOIL	93793	10	YD.	N/A
1019	Canyon Largo #302/Envirotech	EXEMPT HYDROCARBON CONTAMINATED SOIL	93793	10	YD.	N/A
1020	Canyon Largo #302/Envirotech	EXEMPT HYDROCARBON CONTAMINATED SOIL	93793	10	YD.	N/A
1021	Canyon Largo #302/Envirotech	EXEMPT HYDROCARBON CONTAMINATED SOIL	93793	10	YD.	N/A
1022	Canyon Largo #302/Envirotech	EXEMPT HYDROCARBON CONTAMINATED SOIL	93793	10	YD.	N/A
1023	Canyon Largo #302/Envirotech	EXEMPT HYDROCARBON CONTAMINATED SOIL	93793	10	YD.	N/A
1024	Canyon Largo #302/Envirotech	EXEMPT HYDROCARBON CONTAMINATED SOIL	93793	10	YD.	N/A
1025	Canyon Largo #302/Envirotech	EXEMPT HYDROCARBON CONTAMINATED SOIL	93793	10	YD.	N/A
1026	Canyon Largo #302/Envirotech	EXEMPT HYDROCARBON CONTAMINATED SOIL	93793	10	YD.	N/A
1027	Canyon Largo #302/Envirotech	EXEMPT HYDROCARBON CONTAMINATED SOIL	93793	10	YD.	N/A
1028	Canyon Largo #302/Envirotech	EXEMPT HYDROCARBON CONTAMINATED SOIL	93793	10	YD.	N/A
1029	Canyon Largo #302/Envirotech	EXEMPT HYDROCARBON CONTAMINATED SOIL	93793	10	YD.	N/A
1030	Canyon Largo #302/Envirotech	EXEMPT HYDROCARBON CONTAMINATED SOIL	93793	10	YD.	N/A

Remit C.O.D. to:
Address:
City: State: Zip:

COD Amt: \$

C.O.D. FEE:
Prepaid ☒ Collect ☐

NOTE: Where the rate is dependent on value, shippers are required to state specifically in writing the agreed or declared value of the property. The agreed or declared value of the property is hereby specifically stated by the shipper to be not exceeding \$ Per

RECEIVED: Subject to the classification and liability limit in effect on the date of issue of this Bill of Lading, the property described above is received in good order, except as noted hereon, and condition of contents is not known. Shipper hereby certifies that he is familiar with all the bill of lading terms and conditions in the governing classification and the said terms and conditions are hereby agreed to by the shipper and accepted for himself and his assigns.

This is to certify that the above named materials are properly classified, described and packaged, marked and labeled in accordance with the applicable provisions of the Department of Transportation. Per Elmer M. Miller

PLACARDS REQUIRED

N/A

PLACARDS SUPPLIED

☐ YES ☒ NO - FURNISHED BY CARRIER DRIVER SIGNATURE:

SHIPPER: EL PASO NATURAL GAS COMPANY
PER: SANDRA MILLER DATE:

CARRIER: DOUG FOUTZ CONSTRUCTION
PER: Elmer M. Miller DATE: 10-30-94

EMERGENCY RESPONSE (505) 599-2141
TELEPHONE NUMBER: 505-326-2262 PHILIP ENVIRONMENTAL
MONITORED AT ALL TIMES THE HAZARDOUS MATERIAL IS IN TRANSPORTATION, INCLUDING STORAGE

CONTAINS HAZARDOUS MATERIALS

CONTAINS HAZARDOUS MATERIALS

CONTAINS HAZARDOUS MATERIALS

CONTAINS HAZARDOUS MATERIALS

STRAIGHT BILL OF LADING

ORIGINAL - NOT NEGOTIABLE

Shipper's No. _____

CARRIER: DOUG FOUTZ CONSTRUCTION (11967 - PITSCAC)

Carrier's No. _____
Date 11-10-94

TO: ENVIROTECH
 Consignee 5796 US HIGHWAY 64
 Street FARMINGTON, NM 87401
 Destination Zip

FROM: EL PASO NATURAL GAS COMPANY 24324
 Shipper P.O. BOX 4990
 Street FARMINGTON, NM 87499-4990
 Origin Zip

Route: 2 of 2

No. Shipping Units	HM	Kind of Packages, Description of Articles (If HAZARDOUS MATERIALS - PROPER SHIPPING NAME)	HAZARD CLASS	I.D. Number	WEIGHT (Subject to correction)	RATE	VEHICLE Number	LABELS REQUIRED (or exemption)
1015		Envirotech Canyonburg #302	BACKFILL	93753	10	YD.		N/A
1010		Envirotech Canyonburg #302	BACKFILL	93795	10	YD.		N/A
1008		Envirotech/Cutter #2 ET	BACKFILL	74387	10	YD.		N/A
			BACKFILL			YD.		N/A
			BACKFILL			YD.		N/A
			BACKFILL			YD.		N/A

Remit C.O.D. to:
Address:
City:

State: Zip:

COD Amt. \$

C.O.D. FEE:
Prepaid ☒
Collect ☐ \$

NOTE: - Where the rate is dependent on value, shippers are required to state specifically in writing the agreed or declared value of the property. The agreed or declared value of the property is hereby specifically stated by the shipper to be not exceeding \$ _____ Per _____

Subject to Section 7 of the Uniform Code of Sales, the shipper is to be delivered to the consignee without recourse on the property described herein, and the shipper shall remain liable for the property described herein.

FREIGHT CHARGES
☒ PREPAID ☐ COLLECT

RECEIVED, subject to the classifications and lawfully tied tariffs in effect on the date of issue of this Bill of Lading, the contents described above in apparent good order, except as noted (contents and condition of contents of packages unknown, marked, consigned and delivered as indicated above when said carrier (the word carrier being understood throughout this contract as meaning any person or corporation in possession of the property under the contract agreement) carry to its usual place of delivery at said destination, it on its route, otherwise to deliver to another carrier on the route to said destination. It is mutually agreed as to each carrier of all or part of the property described herein, that every service to be performed hereunder shall be subject to all the bill of lading terms and conditions in the governing classification on the date of shipment. Shipper hereby certifies that he is familiar with all the bill of lading terms and conditions in the governing classification and the said terms and conditions are hereby agreed to by the shipper and accepted for himself and his assigns.

This is to certify that the above named materials are properly classified, described, packaged, marked and labeled, and are in proper condition for transportation according to the applicable provisions of the Department of Transportation.

PLACARDS REQUIRED

N/A

PLACARDS SUPPLIED

☐ YES ☒ NO - FURNISHED BY CARRIER
DRIVER SIGNATURE: _____SHIPPER: EL PASO NATURAL GAS COMPANY
PER: SANDRA MILLER DATE:CARRIER: DOUG FOUTZ CONSTRUCTION
PER: _____ DATE: 11-10-94EMERGENCY RESPONSE EL PASO NATURAL GAS (505) 588-2141
TELEPHONE NUMBER: (505) 378-2262 BILLIP ENVIRONMENTALMONITORED AT ALL TIMES THE HAZARDOUS MATERIAL IS IN TRANSPORTATION, INCLUDING STORAGE
INCIDENTAL TO TRANSPORTATION (172 604)

CONTAINS HAZARDOUS MATERIALS

CONTAINS HAZARDOUS MATERIALS

CONTAINS HAZARDOUS MATERIALS

CONTAINS HAZARDOUS MATERIALS

STRAIGHT BILL OF LADING

ORIGINAL - NOT NEGOTIABLE

Shipper's No. _____

CARRIER: DOUG FOULTZ CONSTRUCTION (11957-PITS) SCAC

Carrier's No. _____

Date 10-30-95

TO: ENVIROTECH

FROM: EL PASO NATURAL GAS COMPANY 24324

Consignee 5796 US HIGHWAY 64

Shipper P.O. BOX 4990

Street FARMINGTON, NM 87401

Street FARMINGTON, NM 87499-4990

Zip

Route: 1 of 2

11 hrs

Vehicle Number

934

CONTAINS HAZARDOUS MATERIALS

No. Shipping Units	HM	Kind of Packages, Description of Articles (If HAZARDOUS MATERIALS - PROPER SHIPPING NAME)	HAZARD CLASS	I.D. Number	WEIGHT (subject to correction)	RATE	LABELS REQUIRED (for exemption)
11000		Canyon Largo 11300 Envirotech	EXEMPT HYDROCARBON CONTAMINATED SOIL	93793	10	YD.	N/A
11500		Canyon Largo 91430 Envirotech	EXEMPT HYDROCARBON CONTAMINATED SOIL	93793	10	YD.	N/A
1600		Cutter #2 / Envirotech	EXEMPT HYDROCARBON CONTAMINATED SOIL	71289	10	YD.	N/A
		ET	EXEMPT HYDROCARBON CONTAMINATED SOIL			YD.	N/A
			EXEMPT HYDROCARBON CONTAMINATED SOIL			YD.	N/A

Remit C.O.D. to:

Address:

City:

State:

COD Amt: \$

C.O.D. FEE: Prepaid ☒ Collect ☐

NOTE — Where the rate is dependent on value, shippers are required to state specifically in writing the agreed or declared value of the property. The agreed or declared value of the property is hereby specifically stated by the shipper to be not exceeding \$ _____

Signature of Shipper

FREIGHT CHARGES ☒ PREPAID ☐ COLLECT

RECEIVED, subject to the classification and liability filed herein, in effect on the date of issue of this Bill of Lading, the property described above in apparent good order, except as noted hereon, and condition of contents under the contract agrees to carry to its usual place of delivery at said destination, if on its route, otherwise to deliver to another carrier on the route to said destination. It is mutually agreed as to each carrier of all or any of said property over all or any portion of said route to destination and as to each party at any time interested in all or any said property, that every service to be performed hereunder shall be subject to all the bill of lading terms and conditions in the governing classification on the date of shipment.

Shipper hereby certifies that he is familiar with all the bill of lading terms and conditions in the governing classification and the said terms and conditions are hereby agreed to by the shipper and accepted for himself and his assigns.

This is to certify that the above named materials are properly classified, described, packaged, marked and labeled in accordance with the applicable regulations of the Department of Transportation.

PLACARDS REQUIRED

N/A

PLACARDS SUPPLIED

☐ YES ☒ NO — FURNISHED BY CARRIER DRIVER SIGNATURE: _____

SHIPPER: EL PASO NATURAL GAS COMPANY

CARRIER: DOUG FOULTZ CONSTRUCTION

PER: SANDRA MILLER DATE: _____

PER: Sandra Miller DATE: 10-30-95

EMERGENCY RESPONSE (EL PASO NATURAL GAS (505) 508-2141

MONITORED AT ALL TIMES THE HAZARDOUS MATERIAL IS IN TRANSPORTATION, INCLUDING STORAGE INCIDENTAL TO TRANSPORTATION (172 604)

CONTAINS HAZARDOUS MATERIALS

CONTAINS HAZARDOUS MATERIALS

STRAIGHT BILL OF LADING
ORIGINAL - NOT NEGOTIABLE

CARRIER: DOUG FOUTZ CONSTRUCTION (11957 - PITTSBURGH) CAC

Carrier's No. 10-36-95
Date

ENVIRONMENTAL
5796 US HIGHWAY 64
FARMINGTON, NM 87401
ZIP

FROM: EL PASO NATURAL GAS COMPANY 24324
Shipper P.O. BOX 4990
Street FARMINGTON, NM 87499-4990
Origin Zip

Route: 2 of 2

Vehicle Number 934

No. Shipping Units	HM	Kind of Packages, Description of Articles (If Hazardous Materials - Proper Shipping Name)	Hazard Class	I.D. Number	Weight (subject to correction)	Rate	Labels Required (for exemption)
450							
200		Envirotech / Canyon Large #502	BACKFILL	93793	10	YD.	N/A
448							
1300		Envirotech / Canyon Large #1302	BACKFILL	93793	10	YD.	N/A
448							
1200		Envirotech / Cutler #2 ET	BACKFILL	74059	10	YD.	N/A
			BACKFILL			YD.	N/A
			BACKFILL			YD.	N/A

Remit C.O.D. to:

Address:

City:

State:

Zip:

GOD Amt: \$

C.O.D. FEE:
Prepaid ☒
Collect ☐ \$

NOTE -- Where the rate is dependent on value, shippers are required to state specifically writing the agreed or declared value of the property. The agreed or declared value of the property is hereby specifically stated by the shipper to be not exceeding \$ _____ Per _____

Signature of Contractor

FREIGHT CHARGES
☒ PREPAID ☐ COLLECT

RECEIVED subject to the classifications and lawfully tied tariffs in effect on the date of issue of this Bill of Lading, the property described above in apparent order, except as noted hereunder, and condition of container or packages unknown, marked, consigned and directed as indicated above which said carrier (the word carrier being understood throughout this contract as meaning any corporation in possession of the property under the contract) agrees to carry to its usual place of delivery at said destination, if on its route, or otherwise to deliver to another carrier on the route to said destination. It is mutually agreed as to each carrier of all or any of, said property over all or any portion of said route to destination, and as to each party at any time interested in all or any said property, that every service to be performed hereunder shall be subject to the bill of lading terms and conditions in the governing classification on the date of shipment.

Shipper hereby certifies that he is familiar with all the bill of lading terms and conditions in the governing classification and the said terms and conditions are hereby agreed to by the shipper and accepted for himself and his assigns.

This is to certify that the above named materials are properly classified, described, packaged, marked and labeled and are in proper condition for transportation according to the applicable regulations of the Department of Transportation

**PLACARDS
REQUIRED**

N/A

**PLACARDS
SUPPLIED**

☐ YES ☒ NO — FURNISHED BY CARRIER

SHIPPER: EL PASO NATURAL GAS COMPANY

PER:	SANDRA MILLER	DATE:
------	---------------	-------

CARRIER: DOUG FOUTZ CONSTRUCTION
PER: J. Foutz DA

DATE: 10-30-85

EMERGENCY RESPONSE (EL PASO NATURAL GAS (505) 589-2141
TELEPHONE NUMBER: 505 328-2282 PHILIP ENVIRONMENT

MONITORED AT ALL TIMES THE HAZARDOUS MATERIAL IS IN TRANSPORTATION, INCLUDING STORAGE INCIDENTAL TO TRANSPORTATION (172 604)

CONTAINS HAZARDOUS MATERIALS

CONTAINS HAZARDOUS MATERIALS

CONTAINS HAZARDOUS MATERIALS

Carrier's No. 380
Date Oct 1995

1957 PHS
(~~1957~~) SCAC

FROM: EL PASO NATURAL GAS COMPANY **24324**
Shipper P.O. BOX 4990

Shipper	P.O. BOX 4990
Street	FARMINGTON, NM 87499-4990
Origin	

d17

Vehicle Number	935
----------------	-----

No. Shipping Units	HIM	Kind of Packages - Description of Articles (If HAZARDOUS MATERIALS - PROPER SHIPPING NAME)	HAZARD CLASS	I.O. Number	WEIGHT (subject to correction)	RATE	LABELS REQUIRED (or exemption)
7341		Envirotech/Canyonburg #302	BACKFILL	93773	10	YD.	N/A
0930		Envirotech/Canyonburg #302	BACKFILL	93773	10	YD.	N/A
1335		Envirotech/Canyonburg #2	BACKFILL	74289	10	YD.	N/A
1545		Envirotech/Canyonburg #2	BACKFILL			YD.	N/A
			BACKFILL			YD.	N/A

Address: _____
City: _____
State: _____
Zip: _____

GOD Amt: \$

C.O.D. FEE:
 Prepaid ☒
 Collect ☐ \$

Subject to section 7 of the Conditions, it is important to be delivered to the consignee without recourse on the consignee, the consignee, that is, the following statement (the carrier, that is, the delivery of the shipment without payment of freight and other lawful charges)

(Signature of Carrier)

FREIGHT CHARGES
☒ PREPAID ☐ COLLECT

RECEIVED, subject to the classifications and lawfully filed tariffs in effect on the date of issue of this Bill of Lading, the property described above in apparent good order, except as noted hereon and condition of contents of packages unknown, marked, consigned, and destined as indicated above which said carrier (the word carrier being understood throughout this contract as meaning any person or corporation in possession of the property under the contract) agrees to carry to its usual place of delivery at said destination, it on its route, otherwise to deliver to another carrier on the route to said destination. It is mutually agreed as to each carrier of all or any of said property over all or any portion of said route to destination and as to each party at any time interested in all or any said property, that every service to be performed hereunder shall be subject to all the bill of lading terms and conditions in the governing classification on the date of shipment.

Shipper hereby certifies that he is familiar with all the bill of lading terms and conditions in the governing classification and the said terms and conditions are hereby agreed to by the shipper and accepted for himself and his assigns.

This is to certify that the above named materials are properly classified, described, packaged, marked and labeled and are in proper condition for transportation according to the applicable regulations of the Department of Transportation

**PLACARDS
REQUIRED**

N/A

**PLACARDS
SUPPLIED**

☐ YES ☒ NO — FURNISHED BY CARRIER

DRIVER SIGNATURE: _____

SHIPPER: EL PASO NATURAL GAS COMPANY

CARRIER: DOUG FOUTZ CONSTRUCTION

PER: SANDRA MILLER
DATE:

PER: [Signature]

DATE: 30/07/99

EMERGENCY RESPONSE EL PASO NATURAL GAS (505) 598-214
TELEPHONE NUMBER: (505) 326-2282 PHILIP ENVIRONNEMENT

MONITORED AT ALL TIMES THE HAZARDOUS MATERIAL IS IN TRANSPORTATION, INCLUDING STORAGE INCIDENTAL TO TRANSPORTATION. (172 604)

CONTAINS HAZARDOUS MATERIALS

CONTAINS HAZARDOUS MATERIALS

CONTAINS HAZARDOUS MATERIALS

STRAIGHT BILL OF LADING
ORIGINAL - NOT NEGOTIABLE

Shipper's No. _____

CARRIER: DOUG FOUTZ CONSTRUCTION (11957-PITS) SCAC

Carrier's No. _____
Date 10/30/95TO: ENVIROTECH
Consignee 5796 US HIGHWAY 64
Street FARMINGTON, NM 87401
Destination ZipFROM: EL PASO NATURAL GAS COMPANY 24324
Shipper P.O. BOX 4990
Street FARMINGTON, NM 87499-4990
Origin Zip

Route: 1 of 2

11 hrs Vehicle Number 71

No. Shipping Unit	Kind of Packages, Description of Articles (If HAZARDOUS MATERIALS - PROPER SHIPPING NAME)	HAZARD CLASS	I.D. Number	WEIGHT (subject to correction)	RATE	LABELS REQUIRED (or exemption)
435	CAVYOL LAGAO UNIT 302 / ENVIROTECH	EXEMPT HYDROCARBON CONTAMINATED SOIL	93793	18	YD.	N/A
435	Canyon Lagoon #302 / ENVIROTECH	EXEMPT HYDROCARBON CONTAMINATED SOIL	93793	18	YD.	N/A
435	Curley #2 / ENVIROTECH	EXEMPT HYDROCARBON CONTAMINATED SOIL	74287	18	YD.	N/A
		EXEMPT HYDROCARBON CONTAMINATED SOIL			YD.	N/A
		EXEMPT HYDROCARBON CONTAMINATED SOIL			YD.	N/A

Remit C.O.D. to:
Address:
City: State: Zip:

COD Amt: \$

C.O.D. FEE:
Prepaid ☒
Collect ☐ \$

NOTE - Where the rate is dependent on value, shippers are required to state specifically in writing the agreed or declared value of the property. The agreed or declared value of the property is hereby specifically stated by the shipper to be not exceeding \$ _____ Per _____

Subject to Section 7 of the conditions of this bill of lading, it is agreed that the shipper shall be responsible for the payment of freight and all other charges and expenses.

FREIGHT CHARGES
PREPAID ☒ COLLECT ☐

RECEIVED - subject to the classifications and liability limit tariffs in effect on the date of issue of this Bill of Lading, the property described above in apparent good order, except as noted hereon, and condition of contents under the contract agrees to carry to its usual place of delivery at said destination, if on its route, otherwise to deliver to another carrier on the route to said destination. It is mutually agreed as to each carrier of all or any of said property over all or any portion of said route to destination and as to each party at any time interested in all or any said property, that every service to be performed hereunder shall be subject to all the bill of lading terms and conditions in the governing classification on the date of shipment. Shipper hereby certifies that he is familiar with all the bill of lading terms and conditions in the governing classification and the said terms and conditions are hereby agreed to by the shipper and accepted for himself and his assigns.

This is to certify that the above named materials are properly classified, described, packaged, marked and labeled in accordance with the applicable regulations of the Department of Transportation.

PLACARDS REQUIRED

N/A

PLACARDS SUPPLIED

☐ YES ☒ NO - FURNISHED BY CARRIER
DRIVER SIGNATURE: _____

SHIPPER: EL PASO NATURAL GAS COMPANY

CARRIER: DOUG FOUTZ CONSTRUCTION

PER: SANDRA MILLER DATE:

PER: Sandra Miller DATE: 10/30/95

EMERGENCY RESPONSE (EL PASO NATURAL GAS (505) 599-2141
TELEPHONE NUMBER: 505 326-2262 PHILIP EMMONSONMENTALMONITORED AT ALL TIMES THE HAZARDOUS MATERIAL IS IN TRANSPORTATION, INCLUDING STORAGE
INCIDENTAL TO TRANSPORTATION (177 604)

CONTAINS HAZARDOUS MATERIALS

CONTAINS HAZARDOUS MATERIALS

CONTAINS HAZARDOUS MATERIALS

CONTAINS HAZARDOUS MATERIALS

STRAIGHT BILL OF LADING

ORIGINAL - NOT NEGOTIABLE

Shipper's No. _____

CARRIER: DOUG FOULTZ CONSTRUCTION (11957-PITS) SCAC

Carrier's No. _____
Date 5 Oct 95
 TO: ENVIROTECH
 Consignee 5796 US HIGHWAY 64
 Street FARMINGTON, NM 87401
 Destination Zip

 FROM: EL PASO NATURAL GAS COMPANY 24324
 Shipper P.O. BOX 4990
 Street FARMINGTON, NM 87499-4990
 Origin Zip

Route: 1 of 2

9 1/2 hrs. Vehicle Number 531

CONTAINS HAZARDOUS MATT

No. Shipping Units	HM (if HAZARDOUS MATERIALS - PROPER SHIPPING NAME)	Kind of Packages - Description of Articles	HAZARD CLASS	I.D. Number	WEIGHT (subject to correction)	RATE	VEHICLE NUMBER	LABELS REQUIRED (for exemption)
1035		Canyon Largo U#302/Envirotech	EXEMPT HYDROCARBON CONTAMINATED SOIL	93793	18		YD.	N/A
1036		Canyon Largo U#302/Envirotech	EXEMPT HYDROCARBON CONTAMINATED SOIL	93793	18		YD.	N/A
1037		Canyon Largo U#302/Envirotech	EXEMPT HYDROCARBON CONTAMINATED SOIL	74269	18		YD.	N/A
1038		Canyon Largo U#302/Envirotech	EXEMPT HYDROCARBON CONTAMINATED SOIL				YD.	N/A
1039		Canyon Largo U#302/Envirotech	EXEMPT HYDROCARBON CONTAMINATED SOIL				YD.	N/A
1040		Canyon Largo U#302/Envirotech	EXEMPT HYDROCARBON CONTAMINATED SOIL				YD.	N/A

Remit C.O.D. to:

Address:

City: State: Zip: COD Amt: \$

C.O.D. FEE: Prepaid ☒ Collect ☐ \$

NOTE - Where the rate is dependent on value, shippers are required to state specifically in writing the agreed or declared value of the property. The agreed or declared value of the property is hereby specifically stated by the shipper to be not exceeding \$ _____

Subject to Section 7 of the conditions of this agreement, if the shipper is to be delivered to the consignee without release on the bill of lading, the consignee shall sign the following statement: (Signature of Consignee)

FREIGHT CHARGES ☒ PREPAID ☐ COLLECT

RECEIVED - subject to the classification and lawfully filed tariffs in effect on the date of issue of this bill of lading, the carrier, by accepting this bill of lading, agrees to carry to its usual place of delivery at said destination, if on its route, otherwise to deliver to another carrier on the route to said destination. It is mutually agreed as to each carrier of all or any of said property over all or any portion of said route to destination and as to each party at any time interested in all or any said property, that every service to be performed hereunder shall be subject to all the bills of lading terms and conditions in the governing classification on the date of shipment.

Shipper hereby certifies that he is familiar with all the bill of lading terms and conditions in the governing classification and the said terms and conditions are hereby agreed to by the shipper and accepted for himself and his assigns.

This is to certify that the above named materials are properly classified, described, packaged, marked, and labeled in accordance with the applicable regulations of the Department of Transportation.

PLACARDS REQUIRED

N/A

PLACARDS SUPPLIED

☐ YES ☒ NO - FURNISHED BY CARRIER DRIVER SIGNATURE: _____

SHIPPER: EL PASO NATURAL GAS COMPANY

CARRIER: DOUG FOULTZ CONSTRUCTION

PER: SANDRA MILLER DATE: _____

PER: Gay St DATE: 5 Oct 95

CONTAINS HAZARDOUS MATERIALS

CONTAINS HAZARDOUS MATERIALS

CONTAINS HAZARDOUS MATERIALS

STRAIGHT BILL OF LADING

ORIGINAL - NOT NEGOTIABLE

Shipper's No. _____

CARRIER: DOUG FOUTZ CONSTRUCTION (11957 - PITSCAC)

Carrier's No. _____
Date 30 Oct 95
 TO: ENVIROTECH
 Consignee 5796 US HIGHWAY 64
 Street FARMINGTON, NM 87401
 Destination Zip

 FROM: EL PASO NATURAL GAS COMPANY 24324
 Shipper P.O. BOX 4990
 Street FARMINGTON, NM 87499-4990
 Origin Zip
Route: 20f2Vehicle Number 551

CONTAINS HAZARDOUS MATERIALS

CONTAINS HAZARDOUS MATERIALS

No. Shipping Units	HM	Kind of Packages, Description of Articles (If HAZARDOUS MATERIALS - PROPER SHIPPING NAME)	HAZARD CLASS	I.D. Number	WEIGHT (subject to correction)	RATE	LABELS REQUIRED (or exemption)
1035		Envirotech Canyon Largo 4	#302 BACKFILL		93793	18 YD.	N/A
744		Envirotech Canyon Largo 4	#302 BACKFILL		93793	18 YD.	N/A
1330		Envirotech Canyon Largo 4	BACKFILL		74285	18 YD.	N/A
978		Envirotech Canyon Largo 4	BACKFILL				N/A
11610		Envirotech Canyon Largo 4	BACKFILL				N/A
			BACKFILL				N/A
			BACKFILL				N/A
			BACKFILL				N/A

Remit C.O.D. to:

Address:

City:

State:

Zip:

C.O.D. FEE: Prepaid ☒ Collect ☐

NOTE: Where the rate is dependent on value, shippers are required to state specifically in writing the agreed or declared value of the property. The agreed or declared value of the property is hereby specifically stated by the shipper to be not exceeding \$ _____

Signature of Shipper: _____
Signature of Carrier: _____
Signature of Consignee: _____FREIGHT CHARGES: ☒ PREPAID ☐ COLLECT

RECEIVED, subject to the classification and liability limit in effect on the date of issue of this Bill of Lading, the property described above in apparent good order, except as noted (contents and condition of contents of containers and packages are subject to inspection by the carrier at the time of delivery and the carrier is not bound to inspect the contents of containers or packages at the time of delivery).

Under the terms of this Bill of Lading, the carrier is not bound to deliver the property to the consignee at the place of destination unless the property is delivered to the consignee at the place of destination in accordance with the terms of this Bill of Lading.

SHIPPER'S CERTIFICATE: I hereby certify that the above named property is properly classified, packaged, marked and labeled and is in proper condition for transportation in accordance with applicable regulations of the Department of Transportation.

SHIPPER: EL PASO NATURAL GAS COMPANY

PLACARDS REQUIRED

N/A

PLACARDS SUPPLIED

☐ YES ☒ NO - FURNISHED BY CARRIER DRIVER SIGNATURE: _____

PER: SANDRA MILLER DATE: _____

CARRIER: DOUG FOUTZ CONSTRUCTION

DATE: 30 Oct 95

EMERGENCY RESPONSE: EL PASO NATURAL GAS (505) 589-2141

MONITORED AT ALL TIMES THE HAZARDOUS MATERIAL IS IN TRANSPORTATION, INCLUDING STORAGE

CONTAINS HAZARDOUS MATERIALS

CONTAINS HAZARDOUS MATERIALS

STRAIGHT BILL OF LADING
ORIGINAL - NOT NEGOTIABLE

Shipper's No. _____

Carrier's No. 10/30/95
Date

CARRIER: DOUG FOUTZ CONSTRUCTION (11957-PITS) SCAC

TO: ENVIROTECH 26324
5796 US HIGHWAY 64
Street FARMINGTON, NM 87401FROM: EL PASO NATURAL GAS COMPANY
Shipper P.O. BOX 4990
Street FARMINGTON, NM 87499-4990
Origin ZipRoute: 10f2 11 hrs Vehicle Number 832

No. Shipping Units	HM	Kind of Packages, Description of Articles (If HAZARDOUS MATERIALS - PROPER SHIPPING NAME)	HAZARD CLASS	I.D. Number	WEIGHT (Subject to correction)	RATE	LABELS REQUIRED (or exemption)
477		Canyon bargo 4 1/2 sack/1 sack	EXEMPT HYDROCARBON CONTAMINATED SOIL	93773	18	YD.	N/A
1300		Canyon bargo 4 1/2 sack/1 sack	EXEMPT HYDROCARBON CONTAMINATED SOIL	93773	18	YD.	N/A
477		Cutler #2/Envirotech	EXEMPT HYDROCARBON CONTAMINATED SOIL	74389	18	YD.	N/A
477		ET	EXEMPT HYDROCARBON CONTAMINATED SOIL			YD.	N/A
			EXEMPT HYDROCARBON CONTAMINATED SOIL			YD.	N/A

Remit C.O.D. to:

Address: _____
City: _____ State: _____ Zip: _____

COD Amt: \$

C.O.D. FEE:

Prepaid ☒ Collect ☐ \$

NOTE: Where the rate is dependent on value, shippers are required to state specifically in writing the agreed or declared value of the property. The agreed or declared value of the property is hereby specifically stated by the shipper to be not exceeding \$ _____ Per _____

Labels: The labels of the hazardous materials to be placed on the container without reference to the container shall appear on the shipping documents and on the container.

FREIGHT CHARGES
☒ PREPAID ☐ COLLECT

RECEIVED: subject to the classifications and liability listed in effect on the date of issue of this Bill of Lading, the property described above in apparent good order, except as noted hereon, and condition of contents of packages and materials, conveyed, and delivered as indicated above, which said carrier, the word carrier being understood throughout this contract as meaning any person or corporation in possession of the property at the time of receipt thereof, and the shipper, the word shipper being understood throughout this contract as meaning any person or corporation in possession of the property at the time of delivery thereof, shall be liable for any loss or damage to the property or any of said property over all or any portion of said route to destination and as to each party at any time interested in all or any said property, that every service to be performed hereunder shall be subject to all the bill of lading terms and conditions in the governing classification on the date of shipment.

Shipper hereby certifies that he is familiar with all the bill of lading terms and conditions in the governing classification and the said terms and conditions are hereby agreed to by the shipper and accepted for himself and his assigns.

PLACARDS REQUIRED

N/A

PLACARDS SUPPLIED

☐ YES ☒ NO - FURNISHED BY CARRIER
DRIVER SIGNATURE: _____SHIPPER: EL PASO NATURAL GAS COMPANY
PER: SANDRA MILLER DATE: _____CARRIER: DOUG FOUTZ CONSTRUCTION
PER: LOVY DATE: 10/30/95EMERGENCY RESPONSE: EL PASO NATURAL GAS (505) 589-2141
TELEPHONE NUMBER: 505 398-2282 PHILIP ENVIROMENTAL
MONITORED AT ALL TIMES THE HAZARDOUS MATERIAL IS IN TRANSPORTATION, INCLUDING STORAGE
INCIDENTAL TO TRANSPORTATION (172 604)

CONTAINS HAZARDOUS MATERIALS

CONTAINS HAZARDOUS MATERIALS

CONTAINS HAZARDOUS MATERIALS

CONTAINS HAZARDOUS MATERIALS

Shipper's No.

CARRIER: DOUG FOUTZ CONSTRUCTION (11957 - PITSCAC

Carrier's No. 10-30-95
Date

TO: ENVIROTECH

Consignee	5796 US HIGHWAY 64
Street	FARMINGTON, NM 87401
Destination	ZIP

FROM: EL PASO NATURAL GAS COMPANY 24324
Shipper P.O. BOX 4990
Street FARMINGTON, NM 87499-4990
Origin Zip

Route: 2 of 2

Vehicle Number 833

No. Shipping Units	HWM	Kind of Packages, Description of Articles (If HAZARDOUS MATERIALS - PROPER SHIPPING NAME)	HAZARD CLASS	I.D. Number	WEIGHT (subject to correction)	RATE	LABELS REQUIRED (or exemption)
7440		Envirotech Canyonborgall #300	BACKFILL	93773	18	YD.	N/A
6950		Envirotech Canyonborgall #300	BACKFILL	93793	18	YD.	N/A
7440		Envirotech Canyonborgall #300	BACKFILL	74289	18	YD.	N/A
1530		Envirotech Cutter #2 ET	BACKFILL			YD.	N/A
			BACKFILL			YD.	N/A

Remit C.O.D. to:

Address:

State: Zip:

GOD
Amt:

C.O.D. FEE:

Prepaid	<input checked="" type="checkbox"/>	
Collect	<input type="checkbox"/>	\$

NOTE - Where the rate is dependent on value, shippers are required to state specifically in writing the agreed or declared value of the property. The agreed or declared value of the property is hereby specifically stated by the shipper to be not exceeding \$ _____ Per _____

Argument of (convergence)

Support for 'convergence' of this argument is based on the convergence of the convergence rate. The rate of convergence will be the same for all countries. The rate of convergence will be the same for all countries. The rate of convergence will be the same for all countries.

FREIGHT CHARGES
☒ PREPAID ☐ COLLECT

I am to certify that the above named motorist, are properly classified, described, packaged, marked and labeled and are in proper condition for transportation according to the applicable regulations of the Department of Transportation.

PLACARDS REQUIRED

NVA

**PLACARDS
SUPPLIED**

☐ YES ☒ NO — FURNISHED BY CARRIER

SHIPPER: EL PASO NATURAL GAS COMPANY

PER: SANDRA MILLER

DATE: _____

CARRIER: DOUG EOUTZ CONSTRUCTION

PER: / s k h 11 / 2006 / 0000

DATE: 10-30-95

EMERGENCY RESPONSE EL PASO NATURAL GAS (505) 588-2141
TELEPHONE NUMBER: (505) 328-3283 PHILLIP ENVIRONMENT

MONITORED AT ALL TIMES. THE HAZARDOUS MATERIAL IS IN TRANSPORTATION. INCLUDING STORAGE INCIDENTAL TO TRANSPORTATION (117 604)

[illegible]

CONTAINS HAZARDOUS MATERIALS

CONTAINS HAZARDOUS MATERIALS

CONTAINS HAZARDOUS MATERIALS

CONTAINS HAZARDOUS MATERIALS

STRAIGHT BILL OF LADING
ORIGINAL - NOT NEGOTIABLE

Shipper's No. _____

CARRIER: DOUG FOUTZ CONSTRUCTION (11957-PITS) SCAC

Carrier's No. _____
Date 10-30-85TO: ENVIROTECH
Consignee 5796 US HIGHWAY 64
Street FARMINGTON, NM 87401
Destination ZipFROM: EL PASO NATURAL GAS COMPANY
Shipper P.O. BOX 4990
Street FARMINGTON, NM 87499-4990
Origin ZipRoute: 108210314hrs.Vehicle Number 834No. of Shipping Units HM Kind of Packages, Description of Articles (If Hazardous Materials - Proper Shipping Name)

HAZARD CLASS

I.D. Number

WEIGHT (subject to correction)

RATE

LABELS REQUIRED (for exemption)

130 CAUTION LAGO 302 ENVIROTECH EXEMPT HYDROCARBON 93773 18 YD. N/A1240 Campuranga 11302/Envirotech EXEMPT HYDROCARBON 93773 18 YD. N/A1540 Cutler #2/Envirotech EXEMPT HYDROCARBON 74289 18 YD. N/A1540 Cutler #2/Envirotech EXEMPT HYDROCARBON 74289 18 YD. N/A1540 Cutler #2/Envirotech EXEMPT HYDROCARBON 74289 18 YD. N/A1540 Cutler #2/Envirotech EXEMPT HYDROCARBON 74289 18 YD. N/ARemit C.O.D. to: Address: City: State: Zip: **COD** Amt: \$**COD**

Amt: \$

C.O.D. FEE: Prepaid ☒ Collect ☐ \$

NOTE: Where the rate is dependent on value, shippers are required to state specifically in writing the agreed or declared value of the property. The agreed or declared value of the property is hereby specifically stated by the shipper to be not exceeding \$ _____

Subject to Section 1 of the Uniform Code of Sales, the shipper is to be deemed to have warranted the accuracy of the information furnished on this bill of lading, and the shipper is to be deemed to have warranted the accuracy of the information furnished on this bill of lading.

FREIGHT CHARGES ☒ PREPAID ☐ COLLECT

RECEIVED: subject to the classification and lawfully filed tariffs in effect on the date of issue of this Bill of Lading, the property described above in apparent good order, except as noted (contents and condition of contents of packages (unknown) marked, consigned, and destined as indicated above which said carrier (the word carrier being understood throughout this contract as meaning any person or corporation in possession of the property and the vessel or conveyance in which the property is being transported) is not to be liable for loss of or damage to the property or for delay in delivery at said destination, it on its route, otherwise to deliver to another carrier on the route to said destination. It is mutually agreed as to each carrier of all or any part of the property, that every service to be performed hereunder shall be subject to all the bill of lading terms and conditions in the governing classification on the date of shipment. Shipper hereby certifies that he is familiar with all the bill of lading terms and conditions and the said terms and conditions are hereby agreed to by the shipper and accepted for himself and his assigns.

This is to certify that the above named materials are properly classified, described, packaged, marked and labeled and are in proper condition for transportation according to the applicable regulations of the Department of Transportation.

PLACARDS REQUIRED

N/A

PLACARDS SUPPLIED

☐ YES ☒ NO - FURNISHED BY CARRIER DRIVER SIGNATURE: _____SHIPPER: EL PASO NATURAL GAS COMPANY
PER: SANDRA MILLER DATE: _____CARRIER: DOUG FOUTZ CONSTRUCTION
PER: 10314 DATE: 10-30-85EMERGENCY RESPONSE: EL PASO NATURAL GAS (505) 598-2141
TELEPHONE NUMBER: (505) 326-2282 PHILIP ENVIRONMENTALMONITORED AT ALL TIMES IF HAZARDOUS MATERIAL IS IN TRANSPORTATION INCLUDING STORAGE
INCIDENTAL TO TRANSPORTATION (172.604)

CONTAINS HAZARDOUS MATERIALS

CONTAINS HAZARDOUS MATERIALS

CONTAINS HAZARDOUS MATERIALS

CONTAINS HAZARDOUS MATERIALS

STRAIGHT BILL OF LADING

ORIGINAL - NOT NEGOTIABLE

Shipper's No. _____

CARRIER:

DOUG FOUTZ CONSTRUCTION

(11957 - PIT)CAC

Carrier's No. _____
Date _____

10-30-95

TO:

Consignee
Street
DestinationENVIROTECH
5796 US HIGHWAY 64
FARMINGTON, NM 87401
ZipFROM: EL PASO NATURAL GAS COMPANY
Shipper P.O. BOX 4990
Street FARMINGTON, NM 87499-4990
Origin Zip

24324

Route:

2082

Vehicle
Number

834

CONTAINS HAZARDOUS MAT

CONTAINS HAZARDOUS MATERIALS

No. Shipping Units	Kind of Packages, Description of Articles (If Hazardous Materials - Proper Shipping Name)	HAZARD CLASS	I.D. Number	WEIGHT (subject to correction)	RATE	LABELS REQUIRED (or exemption)
9380	ENVIROTECH / Canyon Cutler #2	BACKFILL	93793	18	YD.	N/A
1290	Envirotech / Canyon Cargo #2	BACKFILL	93793	18	YD.	N/A
1340	Envirotech / Cutler #2	BACKFILL	74257	18	YD.	N/A
		BACKFILL			YD.	N/A
		BACKFILL			YD.	N/A
		BACKFILL			YD.	N/A

Remit C.O.D. to:

Address:

City:

State:

Zip:

COD

Amt: \$

C.O.D. FEE:
Prepaid ☒ Collect ☐

NOTE - Where the rate is dependent on value, shippers are required to state specifically in writing the agreed or declared value of the property. The agreed or declared value of the property is hereby specifically stated by the shipper to be not exceeding \$ _____ Per _____

Subject to Section 2 of the conditions of this bill of lading, the property described above, in apparent good order, except as noted (contents and condition of contents, packages, markings, labels, etc.) is hereby delivered to the consignee, who is to receive the same in full payment of the freight and charges thereon. The shipper is not responsible for the loss of or damage to the property in transit, except as noted (contents and condition of contents, packages, markings, labels, etc.)

FREIGHT CHARGES
☒ PREPAID ☐ COLLECT

RECEIVED, subject to the classifications and lawfully filed tariffs in effect on the date of issue of this Bill of Lading, the property described above, in apparent good order, except as noted (contents and condition of contents, packages, markings, labels, etc.) is hereby delivered to the consignee, who is to receive the same in full payment of the freight and charges thereon. The shipper is not responsible for the loss of or damage to the property in transit, except as noted (contents and condition of contents, packages, markings, labels, etc.)

This is to certify that the above named materials are properly classified, described, packaged, marked and labeled and are in proper condition for transportation according to the applicable regulations of the Department of Transportation.

Per

Signature

Signature

PLACARDS REQUIRED

N/A

PLACARDS SUPPLIED

☐ YES ☒ NO - FURNISHED BY CARRIER DRIVER SIGNATURE

SHIPPER:

EL PASO NATURAL GAS COMPANY

CARRIER:

DOUG FOUTZ CONSTRUCTION

PER:

SANDRA MILLER

DATE:

PER:

Signature

DATE: 10-3-95

EMERGENCY RESPONSE
TELEPHONE NUMBER:EL PASO NATURAL GAS (505) 588-2141
505 328-2282 PHILIP ENVIRONMENTALMONITORED AT ALL TIMES / THE HAZARDOUS MATERIAL IS IN TRANSPORTATION INCLUDING STORAGE
INCIDENTAL TO TRANSPORTATION (172 6041)

CONTAINS HAZARDOUS MATERIALS

RECON®

TITLE:
CUTLER NO. 2
METER 74289

SCALE	AS NOTED	DATE	PROJECT NO:
DWN:	M.R.W.	11/29/95	13947
DES:			EPNG-RECON PITS
CHKD:	K.B.G.	12/4/95	
APPD:			

REV: 0
FIGURE 20

T24 R6 SEC 14 UNIT A

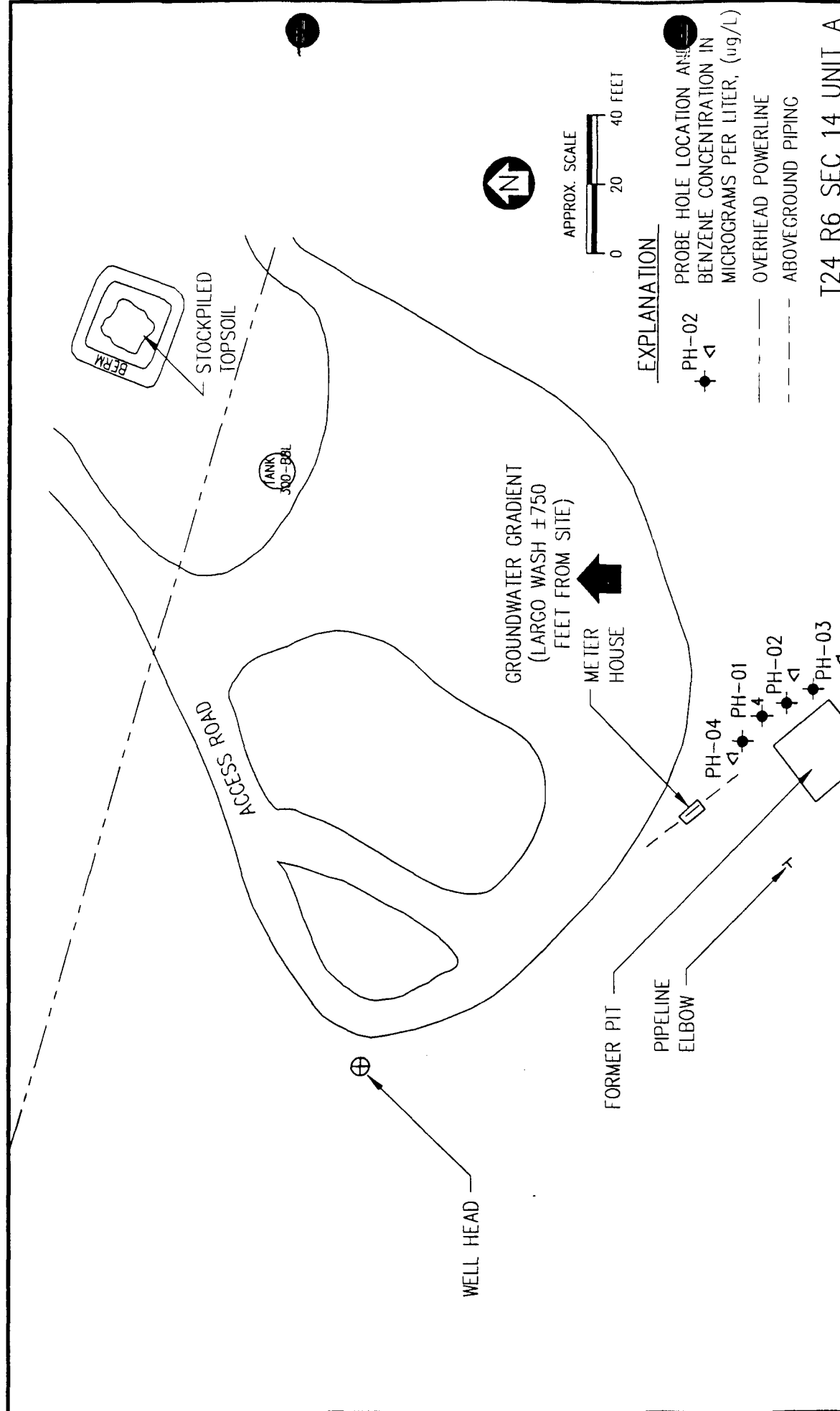

- EXPLANATION**
- PH-02 PROBE HOLE LOCATION AND BENZENE CONCENTRATION IN MICROGRAMS PER LITER, (ug/L)
 - OVERHEAD POWERLINE
 - ABOVEGROUND PIPING

RECON SAMPLE ANALYSIS

DATA SUMMARY TABLE

Project: 13947

Sample I.D.	Probe Hole Number	Depth (feet)	Benzene (ug/L)	Toluene (ug/L)	Ethyl benzene (ug/L)	m+p-Xylene (ug/L)	o-Xylene (ug/L)	Comments
HOWELL#3LD-01	PH-01	21-27	<1	9	3	11	6	Groundwater
HOWELL#3LD-02	PH-02	21-27	<1	12	4	15	6	Groundwater
HOWELL#3LD-03	PH-03	21-27	2	19	3	16	5	Groundwater
HOWELL#3LD-03-D	PH-03	21-27	2	24	5	22	6	QC - Duplicate
Blank-54	N/A	N/A	ND(1)	ND(1)	ND(1)	ND(1)	ND(1)	QC - System Blank
QCRT-21	N/A	N/A	211	262	390	410	466	QC - Retention Times
LATERAL2C-1-05	PH-02	3	ND(1)	ND(1)	ND(1)	ND(1)	ND(1)	Soil-gas
LATERAL2C-1-06	PH-02	6	ND(1)	ND(1)	ND(1)	ND(1)	ND(1)	Soil-gas
LATERAL2C-1-07	PH-02	9	ND(1)	ND(1)	ND(1)	ND(1)	ND(1)	Soil-gas
LATERAL2C-1-08	PH-02	12	ND(1)	ND(1)	ND(1)	ND(1)	ND(1)	Soil-gas
LATERAL2C-1-09	PH-03	3	ND(1)	ND(1)	ND(1)	ND(1)	ND(1)	Soil-gas
LATERAL2C-1-10	PH-03	6	ND(1)	ND(1)	ND(1)	ND(1)	ND(1)	Soil-gas
LATERAL2C-1-11	PH-03	9	ND(1)	ND(1)	ND(1)	ND(1)	ND(1)	Soil-gas
LATERAL2C-1-12	PH-03	12	ND(1)	ND(1)	ND(1)	<1	ND(1)	Soil-gas
LATERAL2C-1-12-D	PH-03	12	ND(1)	ND(1)	ND(1)	<1	ND(1)	QC - Duplicate
Blank-55	N/A	N/A	ND(1)	ND(1)	ND(1)	ND(1)	ND(1)	QC - System Blank
QCRT-22	N/A	N/A	243	263	306	312	334	QC - Retention Times
Blank-56	N/A	N/A	ND(1)	ND(1)	ND(1)	ND(1)	ND(1)	QC - System Blank
STD-1117	N/A	N/A	232	232	232	232	232	Calibration Standard
Blank-57	N/A	N/A	ND(1)	ND(1)	ND(1)	ND(1)	ND(1)	QC - System Blank
Blank-58	N/A	N/A	ND(1)	ND(1)	ND(1)	ND(1)	ND(1)	QC - Probe Rod Blank
CUTTER2-01	PH-01	24-27	4	32	4	15	6	Groundwater
CUTTER2-02	PH-02	24-27	<1	9	3	8	4	Groundwater
CUTTER2-03	PH-03	24-27	<1	6	1	4	2	Groundwater
CUTTER2-04	PH-04	24-27	<1	6	1	6	2	Groundwater
L2C-22No3LD-01	PH-01	21-24	<1	5	1	8	3	Groundwater
L2C-22No3LD-02	PH-02	21-24	<1	4	<1	7	3	Groundwater
L2C-22No3LD-03	PH-03	18-21	<1	-5-4	<1	5	2	Groundwater

D = duplicate analysis.

QC = quality control.

ug/L = micrograms of compound detected per liter of soil or groundwater vapor analyzed.

ND = not detected at the lower quantifiable limit indicated in parenthesis.

NA = not applicable.

QA Review:

Paul G. Anderson

Review Date:

1-31-96 2X 2/13/96