

3R - 173

# REPORTS

DATE:

July, 1996



STATE OF NEW MEXICO  
ENERGY, MINERALS AND NATURAL RESOURCES DEPARTMENT

OIL CONSERVATION DIVISION

2040 S. PACHECO  
SANTA FE, NEW MEXICO 87505  
(505) 827-7131

January 24, 1997

**CERTIFIED MAIL**

**RETURN RECEIPT NO. P-269-269-241**

Ms. Sandra Miller  
El Paso Field Services  
P.O. Box 4990  
Farmington, New Mexico 87499

**RE: FINAL SAN JUAN BASIN PIT CLOSURE REPORTS**

Dear Ms. Miler:

The New Mexico Oil Conservation Division (OCD) has completed a review of El Paso Field Services (EPFS) August 20, 1996 "PRODUCTION PIT CLOSURE SUBMITTAL" and July 1996 "SAN JUAN BASIN PIT CLOSURES, SAN JUAN BASIN, NEW MEXICO, PIT CLOSURE REPORT". These documents contain the results of pit closure activities at 39 sites which encountered shallow ground water.

The OCD's review of the above referenced documents is addressed below:

A. The pit closure/remediation activities conducted at the sites listed below are **approved**.

1. Apache Federal #4 (Drip pit)	Unit M, Sec. 07, T24N, R05W.
2. Argo #1E (Dehy pit)	Unit N, Sec. 18, T27N, R10W.
3. Burroughs Com #1 (Drip pit)	Unit H, Sec. 36, T27N, R08W.
4. Candelaria Gas Com C#1 (Drip pit)	Unit C, Sec. 27, T29N, R10W.
5. Canyon Largo Unit #298 (Drip pit)	Unit A, Sec. 03, T24N, R06W.
6. Canyon Largo Unit #302 (Drip pit)	Unit J, Sec. 03, T24N, R06W.
7. Canyon Largo Unit #336 (Drip pit)	Unit C, Sec. 24, T25N, R06W.
8. Charley Pah #4 (Drip pit)	Unit K, Sec. 12, T27N, R09W.
9. Cleveland No.6 (Drip pit)	Unit B, Sec. 21, T27N, R09W.
10. Cutler #2 (Drip pit)	Unit A, Sec. 14, T24N, R06W.
11. Federal 6 #32 CH (Drip pit)	Unit G, Sec. 06, T26N, R07W.
12. Federal R#2 (Drip pit)	Unit P, Sec. 15, T27N, R08W.
13. Flora Vista #1 (Dehy pit)	Unit F, Sec. 22, T30N, R12W.
14. Gartner LS #7 (Dehy pit)	Unit K, Sec. 26, T30N, R08W.
15. Grace Pearce #1 (Drip pit)	Unit O, Sec. 22, T29N, R11W.
16. Green Com #1 (Drip pit)	Unit E, Sec. 36, T29N, R09W.
17. Hammond Fed #1 (Drip pit)	Unit L, Sec. 25, T27N, R08W.
18. Hammond Fed #5 (Drip pit)	Unit D, Sec. 25, T27N, R08W.
19. Hammond #7 (Drip pit)	Unit G, Sec. 26, T27N, R08W.
20. Hammond #92 (Drip pit)	Unit O, Sec. 25, T27N, R08W.
21. Howell #3 (Drip pit)	Unit C, Sec. 03, T27N, R08W.
22. Krause WN Federal #1E (Drip pit)	Unit C, Sec. 32, T28N, R11W.
23. Lat 2C-55 Line Drip (Drip pit)	Unit F, Sec. 17, T25N, R07W.
24. Lindrith Unit #23 (Drip pit)	Unit O, Sec. 09, T24N, R03W.

Ms. Sandra Miller  
January 24, 1997  
Page 2

25. Marshall "B" #1J (Drip pit)	Unit O, Sec. 14, T27N, R09W.
26. Ona McGee #1 (Dehy pit)	Unit P, Sec. 04, T30N, R11W.
27. Price #3 (Dehy pit)	Unit A, Sec. 15, T28N, R08W.
28. Sanchez Gas Com C#1 (Drip pit)	Unit A, Sec. 28, T29N, R10W.
29. Valdez #2 (Drip pit)	Unit G, Sec. 24, T29N, R11W.

Please be advised that OCD approval does not relieve EPFS of liability if remaining contaminants are found to pose a future threat to surface water, ground water, human health or the environment. In addition, OCD approval does not relieve EPFS of responsibility for compliance with any other federal, state or local laws and/or regulations.

- B. Ground waters at the sites listed below are contaminated with petroleum related constituents in excess of New Mexico Water Quality Control Commission ground water standards. At these sites, subsequent closure monitoring was not performed or the extent of ground water contamination at the sites was not been determined. Therefore, approval of these pit closure forms is denied. The OCD requests that, as necessary, EPFS investigate the extent of contamination, perform subsequent closure monitoring and/or remediate contaminated ground water pursuant to EPFS's November 29, 1995 ground water investigation/remediation work plan which was approved by the OCD on November 30, 1995.

1. 2C-22 #3 Line Drip (Drip pit)	Unit G, Sec. 13, T24N, R06W.
2. 2C-45 Line Drip (Drip pit)	Unit P, Sec. 13, T25N, R06W.
3. Canyon Largo Unit #304 (Drip pit)	Unit C, Sec. 11, T24N, R06W.
4. Gallegoc Canyon Unit #188E (Dehy)	Unit B, Sec. 30, T29N, R12W.
5. Graham #53 (Dehy pit)	Unit L, Sec. 10, T27N, R08W.
6. K-17 Line Drip (Drip pit)	Unit C, Sec. 26, T27N, R08W.
7. McGrath #1 (Drip pit)	Unit F, Sec. 07, T30N, R11W.
8. Miles Federal #1E (Dehy pit)	Unit N, Sec. 05, T26N, R07W.
9. Trunk D Line Drip (Loop D-8) (Drip)	Unit F, Sec. 20, T28N, R08W.
10. Trujillo Gas Com A#1 (Drip pit)	Unit C, Sec. 28, T29N, R10W.

If you have any questions, please call me at (505) 827-7154.

Sincerely,

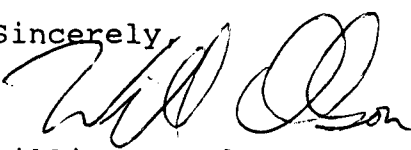
  
William C. Olson  
Hydrogeologist  
Environmental Bureau

xc: OCD Aztec District Office  
Bill Liess, BLM Farmington District Office  
David Deardorff, New Mexico State Land Office  
Charmaine Tso, Navajo Nation EPA  
Kurt Sandoval, Jicarilla Apache EPO

August 20, 1996

Mr. Bill Olson  
New Mexico Oil Conservation Division  
2040 South Pacheco Street  
Santa Fe, New Mexico 87505

**RECEIVED**

AUG 20 1996

Environmental Bureau  
Oil Conservation Division

**RE: Production Pit Closure Submittal**

Dear Mr. Olson:

Enclosed herein are data packages for work completed at El Paso Field Services (EPFS) production pit locations where shallow groundwater was encountered during closure operations. The data included within indicate that these sites merit closure per the New Mexico Oil Conservation Division's (NMOCD) Vulnerable Area Orders and EPFS's closure plan submitted to the NMOCD. In front of each data package is a site specific checklist that indicates the work completed at each location. Each checklist is followed by a short summary of the activities and results of data collected to support closure.

Sincerely,

**El Paso Field Services**

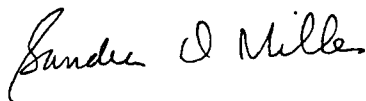

Sandra Miller  
Senior Environmental Manager

j:\16297\sm

**SAN JUAN BASIN PIT CLOSURES**  
**San Juan Basin, New Mexico**

**Pit Closure Report**

**July 1996**

**Prepared For**

**El Paso Field Services**  
**Farmington, New Mexico**

**Project 16297**

**PHILIP**  
**ENVIRONMENTAL**

O/C

## Closure Checklist

### Meter Code

75718

Summary  
Site Map  
Site Assessment Sheet

<input checked="" type="checkbox"/>
<input checked="" type="checkbox"/>
<input checked="" type="checkbox"/>

### Phase I Excavation

Yes

closure form  
soil analytical results  
soil chain-of-custody  
groundwater analytical results  
groundwater chain-of-custody  
bills of lading

<input checked="" type="checkbox"/>
<input checked="" type="checkbox"/>
<input checked="" type="checkbox"/>
<input type="checkbox"/>
<input type="checkbox"/>
<input checked="" type="checkbox"/>

### Phase II Soil Boring

Yes

boring log  
soil analytical results  
soil chain-of-custody  
well installation form  
development form  
groundwater analytical  
groundwater chain-of-custody

<input checked="" type="checkbox"/>
<input type="checkbox"/>
<input type="checkbox"/>
<input type="checkbox"/>
<input type="checkbox"/>
<input type="checkbox"/>
<input type="checkbox"/>
<input type="checkbox"/>

### Phase III Excavation

Yes

closure form  
soil analytical results  
soil chain-of-custody  
groundwater analytical  
groundwater chain of-custody  
bills of lading

<input checked="" type="checkbox"/>
<input checked="" type="checkbox"/>
<input checked="" type="checkbox"/>
<input type="checkbox"/>
<input type="checkbox"/>
<input type="checkbox"/>
<input checked="" type="checkbox"/>

### Recon performed

Yes

groundwater analytical  
soil-gas analytical

<input checked="" type="checkbox"/>
<input type="checkbox"/>

If item boxes are not checked they are not applicable

**Flora Vista No. 1**  
**Meter Code 75718**

Pit was excavated to 12 feet beneath ground surface. Headspace soil readings from excavation bottom were 195 parts per million. Soil analytical were as follows; benzene - < 0.5 mg/kg, total BTEX - 515 mg/kg, TPH - 8,030 mg/kg.

One soil boring was completed and no monitoring well installed. Groundwater was encountered at 17.5 feet. No soil or groundwater samples were collected.

Pit was re-excavated to 20 feet beneath ground surface. A headspace soil reading was as follows: pit bottom composite- 1,045 ppm. Soil analytical from composite were as follows; benzene - < .5 mg/kg, total BTEX - 22.2 mg/kg, TPH - 1,460 mg/kg.

A RECON® survey was conducted and three groundwater samples were collected between the pit and valley bottom. The samples were collected and analyzed using a laboratory-grade gas chromatograph by Philip Environmental's RECON® System. The on-site analytical results are as follows; PH-01 benzene - <1 ug/L, toluene - 1 ug/L, ethylbenzene - <1 ug/L, xylenes - 3 ug/l, PH-02 benzene 1 ug/L, toluene - 2 ug/L, ethylbenzene - <1 ug/L, xylenes - 2 ug/l, PH-03 benzene <1 ug/L, toluene - ND, ethylbenzene-ND, xylenes-ND.

# FIELD PIT SITE ASSESSMENT FORM

GENERAL	<p>Meter: <u>75718</u> Location: <u>FLORA VISTA #1</u></p> <p>Operator #: <u>8367</u> Operator Name: <u>SOUTHLAND ROYALTY</u> P/L District: <u>KUTZ</u></p> <p>Coordinates: Letter: <u>E</u> Section <u>22</u> Township: <u>30</u> Range: <u>12</u></p> <p>Or Latitude _____ Longitude _____</p> <p>Pit Type: Dehydrator <input checked="" type="checkbox"/> Location Drip: _____ Line Drip: _____ Other: _____</p> <p>Site Visit Date: <u>3.31.94</u> Run: <u>02</u> <u>63</u></p>
SITE ASSESSMENT	<p>NMOCD Zone: Inside Land Type: BLM <input type="checkbox"/>          (From NMOCD Vulnerable State <input type="checkbox"/>          Maps) Zone <input checked="" type="checkbox"/> Fee <input checked="" type="checkbox"/>          Outside <input type="checkbox"/> Indian _____</p> <p>Depth to Groundwater          Less Than 50 Feet (20 points) <input checked="" type="checkbox"/>          50 Ft to 99 Ft (10 points) <input type="checkbox"/>          Greater Than 100 Ft (0 points) <input type="checkbox"/></p> <p>Wellhead Protection Area :          Is it less than 1000 ft from wells, springs, or other sources of          fresh water extraction? , or ; Is it less than 200 ft from a privat          domestic water source? <input type="checkbox"/> YES (20 points) <input checked="" type="checkbox"/> NO (0 points)</p> <p>Horizontal Distance to Surface Water Body          Less Than 200 Ft (20 points) <input type="checkbox"/>          200 Ft to 1000 Ft (10 points) <input type="checkbox"/>          Greater Than 1000 Ft (0 points) <input checked="" type="checkbox"/></p> <p>Name of Surface Water Body _____</p> <p>(Surface Water Body : Perennial Rivers, Major Wash, Streams, Creeks,          Irrigation Canals, Ditches, Lakes, Ponds)</p> <p>TOTAL HAZARD RANKING SCORE: <u>20</u> POINTS</p>
REMARKS	<p>Remarks : <u>ONLY PIT ON LOCATION. PIT IS DRY. LOCATION</u>  <u>IS IN FLORA VISTA ABOUT A 1/4 MILE SOUTH OF HWY. 55</u></p>

75718

## ORIGINAL PIT LOCATION

Original Pit : a) Degrees from North 133° Footage to Wellhead 16  
b) Degrees from North \_\_\_\_\_ Footage to Dogleg \_\_\_\_\_  
Dogleg Name \_\_\_\_\_  
c) Length : 18' Width : 16' Depth : 3'

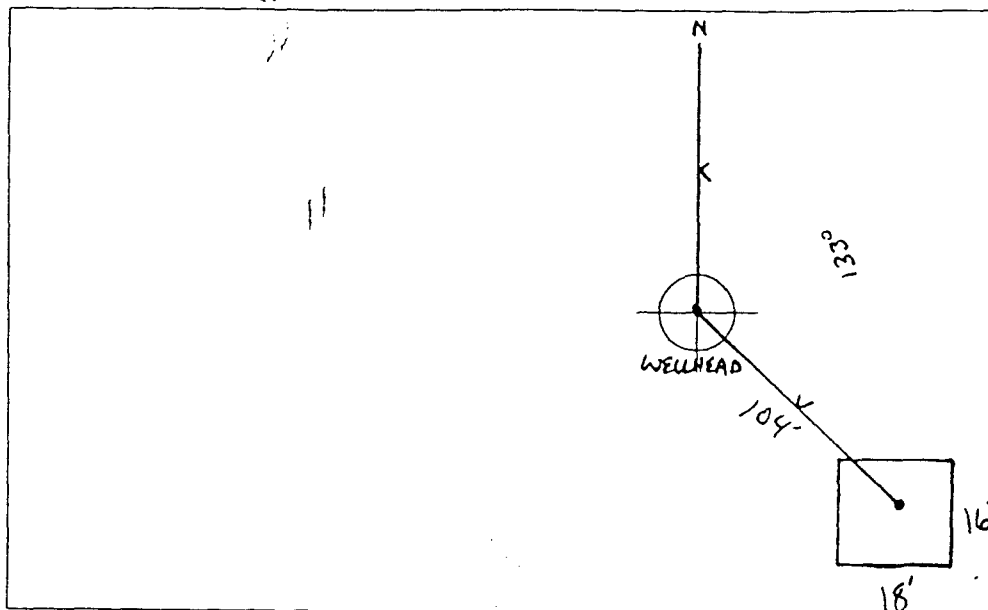

ORIGINAL PIT LOCATION

Remarks :

STARTED TAKING PICTURES AT 3:25 P.M.END DUMP

REMARKS

Completed By:

Robert Thompson  
Signature3-31-94

Date

---

---

## **Phase I Excavation**

---

---

# FIELD PIT REMEDIATION/CLOSURE FORM

GENERAL

Meter: 75718 Location: Flora Vista #1  
 Coordinates: Letter: P Section 22 Township: 30 Range: 12  
 Or Latitude \_\_\_\_\_ Longitude \_\_\_\_\_  
 Date Started : 4-26-94 Area: 02 Run: 63

FIELD OBSERVATIONS

Sample Number(s): VW32  
 Sample Depth: 12 Feet  
 Final PID Reading 195 PID Reading Depth 12 Feet  
 Yes No  
 Groundwater Encountered ☐ (1) ☒ (2) Approximate Depth \_\_\_\_\_ Feet

CLOSURE

Remediation Method :  
 Excavation ☒ (1) Approx. Cubic Yards 45  
 Onsite Bioremediation ☐ (2)  
 Backfill Pit Without Excavation ☐ (3)  
 Soil Disposition:  
 Envirotech ☐ (1) ☒ (3) Tierra  
 Other Facility ☐ (2) Name: \_\_\_\_\_  
 Pit Closure Date: 4-26-94 Pit Closed By: BEI

REMARKS

Remarks : No Line Markers. Pit discolored  
 \_\_\_\_\_  
 \_\_\_\_\_

Signature of Specialist: Vale Wilson



## FIELD SERVICES LABORATORY

## ANALYTICAL REPORT

## PIT CLOSURE PROJECT - Soil Samples Inside the GWV Zone

## SAMPLE IDENTIFICATION

SAMPLE NUMBER:	Field ID <b>VW32</b>	Lab ID <b>945020</b>
MTR CODE   SITE NAME:	<b>75718</b>	<b>Flora Vista #1</b>
SAMPLE DATE   TIME (Hrs):	<b>04/26/94</b>	<b>1340</b>
PROJECT:	<b>Phase I</b>	
DATE OF TPH EXT.   ANAL.:	<b>04/28/94</b>	<b>04/28/94</b>
DATE OF BTEX EXT.   ANAL.:	<b>05/09/94</b>	<b>05/10/94</b>
TYPE   DESCRIPTION:	<b>VC</b>	<b>Brown fine sand</b>

Field Remarks: \_\_\_\_\_

## RESULTS

PARAMETER	RESULT	UNITS	QUALIFIERS			
			DF	Q	M(g)	V(ml)
BENZENE	<0.50	MG/KG		X10		
TOLUENE	32	MG/KG		X10		
ETHYL BENZENE	42	MG/KG		X10		
TOTAL XYLENES	440	MG/KG		X10		
TOTAL BTEX	515	MG/KG				
TPH (418.1)	8030	MG/KG			1.0	28
HEADSPACE PID	195	PPM				
PERCENT SOLIDS	82	%				

-- TPH is by EPA Method 418.1 and BTEX is by EPA Method 8020 --

Surrogate Recovery was at 130 % for this sample All QA/QC was acceptable.  
Narrative:

performed analyses. Surrogate recovery was outside ATI QC limits due to matrix interference.

DF = Dilution Factor Used

Approved By: John LuederDate: 7/18/94

[illegible]



**ORIGINAL - NOT NEGOTIABLE**

Shipper's No.

SCAC

Carrier's No.

Date 4-26-84

**FROM:**

EL PASO NATURAL GAS COMPANY

24324

Shipp  
Street

P.O. BOX 4990  
FARMINGTON, NM 87499-4990

Destination	Zip
-------------	-----

Origin

Zip

Route:

3/1

Vehicle Number,

U.S. DOT Hazmat Reg. No.

No. Shipping Units	HM	Kind of Packages, Description of Articles (IF HAZARDOUS MATERIALS - PROPER SHIPPING NAME)	HAZARD CLASS	I.D. Number	PACKING GROUP	WEIGHT (subject to correction)	RATE	LABELS REQUIRED (or exemption)
✓		TIERRA JOHNSON D1	EXEMPT HYDRO-CARBON CONTAMINATED SOIL	N/A	N/A	15	YD	N/A
			EXEMPT HYDRO-CARBON CONTAMINATED SOIL	N/A	N/A		YD	N/A
			EXEMPT HYDRO-CARBON CONTAMINATED SOIL	N/A	N/A		YD	N/A
			EXEMPT HYDRO-CARBON CONTAMINATED SOIL	N/A	N/A		YD	N/A
			EXEMPT HYDRO-CARBON CONTAMINATED SOIL	N/A	N/A		YD	N/A
1		TIERRA STANBLYN B#1	BACKFILL	N/A	N/A	15	YD	N/A
			BACKFILL	N/A	N/A		YD	N/A
			BACKFILL	N/A	N/A		YD	N/A
			BACKFILL	N/A	N/A		YD	N/A

Permit C.O.D. to

Address

State

zip

6

6

Collect \$

Collect \$

100

100

NOTE - Where the rate is dependent on value, shippers are required to state specifically in writing the agreed or declared value of the property. The agreed or declared value of the property is hereby specifically stated by the shipper to be not exceeding \$ \_\_\_\_\_ Per \_\_\_\_\_

Subject to Section 7 of the conditions, if this shipment is to be on the consignor, the consignor shall sign the following statement. The carrier shall not make delivery of this shipment without pay.

Where the applicable tariff provisions specify a limitation of the carrier's liability, NADIC item 172<sup>1</sup> if there is no release or value declaration by the shipper, and the shipper does not declare a value or release the carrier's liability, that liability shall be limited to the extent provided by NADIC item 172<sup>1</sup>. Caltrans intrastate shipments must comply with NADIC item 173<sup>1</sup>.

**RECEIVED.** subject to the classifications and lawfully filed tariffs in effect on the date of issue of this Bill of Lading, the property described above in apparent good order, except as noted (contents and condition of contents of packages unknown), marked, consigned, and destined as indicated above which said carrier, through its servants or agents, hereby undertakes to deliver at such destination, if on its route, otherwise to deliver to another carrier on the route to said destination. It is mutually agreed as to each carrier of all or any of said property over all or any portion of said route to its destination and as to each party at any time transferred in full or in part hereunder shall be subject to the bill of lading terms and conditions in the contract.

The Shipper hereby certifies that he is familiar with all the bill of lading terms and conditions in the governing classification and the said terms and conditions are hereby agreed to by the shipper and accepted for himself and his assigns.

This is to certify that the above named materials are properly classified, described, packaged, marked and labeled and are in proper condition for transportation according to the applicable regulations of the Department of Transportation

X *[Signature]*

**PLACARDS REQUIRED** N/A

**PLACARDS SUPPLIED** ☐ YES ☒ NO **FURNISHED BY CARRIER**

SHIPPER: EL PASO NATURAL GAS COMPANY

CARRIER: X

ccy

PER: SANDRA MILLER DATE:

PER: J.P. [Signature]

DATE: 4-26-84

EMERGENCY RESPONSE	EL PASO NATURAL GAS (505) 599-2141	Monitored at all times the Hazardous Material is in transportation
TELEPHONE NUMBER:	( 505 ) 326-2262 BURLINGTON ENVIRO. including storage incld	1 to transportation (172.604).

9-BLS-B3 (REV

# STRAIGHT BILL OF LADING

## ORIGINAL - NOT NEGOTIABLE

Shipper's No. \_\_\_\_\_

CARRIER: DOUG FOULTZ CONSTRUCTION CO. INC.

SCAC

Carrier's No. 343637

Date 4-26-94

TO: TIERRA ENVIRONMENTAL CORPORATION  
 Consignee 909 WEST APACHE  
 Street FARMINGTON, NM 87401  
 Destination Zip

FROM: EL PASO NATURAL GAS COMPANY  
 Shipper P.O. BOX 4990  
 Street FARMINGTON, NM 87499-4990  
 Origin Zip

Route: \_\_\_\_\_ Vehicle Number 934 hrs. U.S. DOT Hazmat Reg. No. 432

No. Shipping Units	HM (If Hazardous Materials - Proper Shipping Name)	Hazard Class	I.D. Number	Packing Group	Weight (subject to correction)	Rate	Labels Required (or exemption)
	Flora Vista #1 / Tierra	EXEMPT HYDRO-CARBON CONTAMINATED SOIL	N/A	N/A	15	YD	N/A
	Sandia Fed #1 / Tierra	EXEMPT HYDRO-CARBON CONTAMINATED SOIL	N/A	N/A	15	YD	N/A
		EXEMPT HYDRO-CARBON CONTAMINATED SOIL	N/A	N/A		YD	N/A
		EXEMPT HYDRO-CARBON CONTAMINATED SOIL	N/A	N/A		YD	N/A
		EXEMPT HYDRO-CARBON CONTAMINATED SOIL	N/A	N/A		YD	N/A
	Tierra / Johnson O-1	BACKFILL	N/A	N/A	5	YD	N/A
	Tierra / Flora Vista #1	BACKFILL	N/A	N/A	10	YD	N/A
	Tierra / Sandia Fed #1	BACKFILL	N/A	N/A	15	YD	N/A
		BACKFILL	N/A	N/A		YD	N/A

Permit C.O.D. to:

Address:

City:

State:

C.O.D. Amt: \$

C.O.D. FEE: \$

FREIGHT CHARGES  
☒ PREPAID ☐ COLLECT

NOTE: Where the rate is dependent on value, shippers are required to state specifically in writing the agreed or declared value of the property. The agreed or declared value of the property is hereby specifically stated by the shipper to be not exceeding \$ \_\_\_\_\_ Per \_\_\_\_\_

Signature of Consignor

Where the applicable rate provisions specify a limitation of the carrier's liability, the shipper does not declare a value or value declaration by the shipper and the shipper does not declare a value or value declaration by the shipper. The shipper hereby certifies that the property is not hazardous material as defined by the Department of Transportation.

RECEIVED: subject to the classification and lawfully filed tariffs in effect on the date of issue of this bill of lading, the property described above in apparent good order, except as noted (contents and condition of contents of packages unknown), marked, consigned, and destined as indicated above which said carrier (the word carrier being understood throughout this contract as meaning any person or corporation in possession of the property under the contract) agrees to carry to its usual place of delivery at said destination, if on its route, otherwise to deliver to another carrier on the route to said destination. It is mutually agreed as to each carrier of all or any of said property over all or any portion of said route to destination and as to each party at any time interested in all or any said property, that every service to be performed hereunder shall be subject to all the bill of lading terms and conditions in the governing classification on the date of shipment.

Shipper hereby certifies that he is familiar with all the bill of lading terms and conditions in the governing classification and the said terms and conditions are hereby agreed to by the shipper and accepted for himself and his assigns.

The shipper certifies that the above named materials are properly classified, described, packaged, marked and labeled and are in proper condition for transportation and that the shipper is not aware of any other applicable regulations of the Department of Transportation.

By X Chabala y Leguon

PLACARDS REQUIRED

N/A

PLACARDS SUPPLIED

YES ☐ NO ☒ FURNISHED BY CARRIER  
 DRIVERS SIGNATURE:

SHIPPER: EL PASO NATURAL GAS COMPANY

PER: SANDRA MILLER

DATE:

EMERGENCY RESPONSE EL PASO NATURAL GAS (505) 599-2141

TELEPHONE NUMBER: (505) 326-2262 BURLINGTON ENVIRO.

CARRIER: X Doug Foltz Const.

PER: Chabala y Leguon

DATE: 4-26-94

Monitored at all times the Hazardous Material is in transportation including storage (172.604).

# STRAIGHT BILL OF LADING

## ORIGINAL - NOT NEGOTIABLE

Shipper's No.

CARRIER: DOUG FOUTZ CONSTRUCTION CO. INC.

SCAC

Carrier's No.

AMSCC 43313

Date 4-26-94

TO: TIERRA ENVIRONMENTAL CORPORATION  
909 WEST APACHE  
STREET FARMINGTON, NM 87401

FROM: EL PASO NATURAL GAS COMPANY  
P.O. BOX 4990  
STREET FARMINGTON, NM 87499-4990

Zip

Route:

10 hrs.

Vehicle Number #24

U.S. DOT Hazmat Reg. No.

No. of Packages, Description of Articles  
Shipping Units (IF HAZARDOUS MATERIALS - PROPER SHIPPING NAME)

HAZARD CLASS

ID. Number

PACKING GROUP

WEIGHT (subject to correction)

RATE

LABELS REQUIRED (or exemption)

1 Hampton #3 - Tierra

EXEMPT HYDRO-CARBON CONTAMINATED SOIL

N/A

N/A

10

YD

N/A

1 Hampton #3 - Tierra

EXEMPT HYDRO-CARBON CONTAMINATED SOIL

N/A

N/A

10

YD

N/A

1 Tierra #1A - Tierra

EXEMPT HYDRO-CARBON CONTAMINATED SOIL

N/A

N/A

10

YD

N/A

1 Tierra - Johnson Gas Com #1E

EXEMPT HYDRO-CARBON CONTAMINATED SOIL

N/A

N/A

10

YD

N/A

1 Tierra - Hampton #3

BACKFILL

N/A

N/A

10

YD

N/A

1 Tierra - Hampton #3

BACKFILL

N/A

N/A

10

YD

N/A

1 Tierra - Hampton #3

BACKFILL

N/A

N/A

10

YD

N/A

1 Tierra - Tierra #1A

BACKFILL

N/A

N/A

10

YD

N/A

Unit C.O.D. to:

C.O.D. Amt:

C.O.D. FEE: Prepaid ☒ Collect ☐

10

YD

N/A

Address:

City:

State:

Zip:

\$

\$

NOTE: Where the rate is dependent on value, shippers are required to state specifically in writing the agreed or declared value of the property. The agreed or declared value of the property is hereby specifically stated by the shipper to be not exceeding \$

Signature of Shipper

Signature of Consignee

Where the applicable tariff provisions specify a limitation of the carrier's liability, that limitation shall not apply to the extent that the shipper or consignee has elected to insure the property and liability shall be limited to the amount provided by the carrier's tariff.

Where the applicable tariff provisions specify a limitation of the carrier's liability, that limitation shall not apply to the extent that the shipper or consignee has elected to insure the property and liability shall be limited to the amount provided by the carrier's tariff.

Where the applicable tariff provisions specify a limitation of the carrier's liability, that limitation shall not apply to the extent that the shipper or consignee has elected to insure the property and liability shall be limited to the amount provided by the carrier's tariff.

RECEIVED: subject to the classifications and lawfully filed tariffs in effect on the date of issue of this Bill of Lading, the property described above in apparent good order, except as noted (contents and condition of contents of packages unknown), marked, consigned, and destined as indicated above which said carrier (the word carrier being understood throughout this contract as meaning any person or corporation in possession of the property under the contract) agrees to carry to its usual place of delivery at said destination, it on its route, otherwise to deliver to another carrier on the route to said destination. It is mutually agreed as to each carrier of all or any of, said property over all or any portion of said route to destination and as to each party at any time interested in all or any said property, that every service to be performed hereunder shall be subject to all the bill of lading terms and conditions in the governing classification on the date of shipment.

Shipper hereby certifies that he is familiar with all the bill of lading terms and conditions in the governing classification and the said terms and conditions are hereby agreed to by the shipper and accepted for himself and his assigns.

This is to certify that the above named material is properly classified, marked and labeled and is in proper condition for transportation according to the applicable regulations of the Department of Transportation.

PLACARDS REQUIRED

N/A

PLACARDS SUPPLIED

YES ☒ NO ☐ FURNISHED BY CARRIER

SHIPPER: EL PASO NATURAL GAS COMPANY

PER: SANDRA MILLER

DATE:

CARRIER: Doug Foutz Const

PER: Doug Foutz

DATE: 4-26-94

EMERGENCY RESPONSE EL PASO NATURAL GAS (505) 599-2141

TELEPHONE NUMBER: (505) 326-2262 BURLINGTON ENVIRO.

Monitored at all times the Hazardous Material is in transportation including storage incident to transportation (172.604).

9-BLS-B3 (REV)

---

---

## **Phase II Soil Boring**

---

---

# RECORD OF SUBSURFACE EXPLORATION

Philip Environmental Services Corp.

1 Monroe Road

Farmington, New Mexico 87401

(505) 326-2262 FAX (505) 326-2388

Borehole #

BH-1

Well #

Page

1 of 1

Project Name

EPNG Pits

Project Number

14509

Phase

601 6000

Project Location

Flora Vista #1, 75718

Elevation

Borehole Location

T30, R12, S.22, F

GWL Depth

Logged By

S. Kelly

Drilled By

M. Donohue

Date/Time Started

10/5/95, 1315

Date/Time Completed

10/5/95, 1415

Well Logged By

S. Kelly

Personnel On-Site

M. Donohue, J. Long

Contractors On-Site

Client Personnel On-Site

Drilling Method

4 1/4" ID HSA

Air Monitoring Method

CGI, PID

Depth (Feet)	Sample Number	Sample Interval	Sample Type & Recovery (inches)	Sample Description Classification System: USCS	USCS Symbol	Depth Lithology Change (feet)	Air Monitoring Units: NDU BZ BH S			Drilling Conditions & Blow Counts
0				Backfill						
5				to 12'						
10										
15				Hit water at 17.5' waited 10min. rose to 17.1' did not take split spoon sample due to water in hole.						
20				TOB- 18.0'						
25										
30										
35										
40										

Comments:

No sample collected due to hitting water before the  
first split-spoon was driven. BH grouted to surface.

Geologist Signature

10/5/95

---

---

## **Phase III Excavation**

---

---

# FIELD PIT REMEDIATION/CLOSURE FORM/PHASE II

Meter: 75718 Location: Flora Vista #1

Coordinates: Letter: F Section 22 Township: 30 Range: 12

Or Latitude \_\_\_\_\_ Longitude \_\_\_\_\_

Date Started : 11-28-95 Area: 02 Run: 63

Sample Number(s): 4P93

Sample Depth: 20 Feet

Final PID Reading 1045 PID Reading Depth 20 Feet  
Yes No

Groundwater Encountered ☐ (1) ☒ (2) Approximate Depth \_\_\_\_\_ Feet

Final Dimensions: Length 39 Width 30 Depth 20

## Remediation Method :

Excavation ☒ (1) Approx. Cubic Yards 850 LT <sup>12/1/95</sup>

Onsite Bioremediation ☐ (2)

Backfill Pit Without Excavation ☐ (3)

Overburden Cubic Yards 32 LT <sup>12/1/95</sup>

## Soil Disposition:

Envirotech ☐ (1) ☒ (3) Tierra

Other Facility ☐ (2) Name: \_\_\_\_\_

Pit Closure Date: 11-29-95 Pit Closed By: Philip Env

Phase III Used 100 Lbs Fertilizer

Remarks : Dug to 20 Ft, did not encounter groundwater  
Took PID N wall 1231 ppm S wall 01 ppm E wall 03 ppm  
W wall 1028 ppm Bot 576 ppm Comp 1045 ppm. Had to  
stop digging North + West walls due to compressor + meter  
Run positions.

Signature of Specialist: James F. Tenor



FIELD SERVICES LABORATORY

ANALYTICAL REPORT

PIT CLOSURE PROJECT - Soil Samples Inside the GWV Zone

SAMPLE IDENTIFICATION

	Field ID	Lab ID
SAMPLE NUMBER:	JP93	947815
MTR CODE   SITE NAME:	75718	Flora Vista #1
SAMPLE DATE   TIME (Hrs):	11/29/95	1015
PROJECT:	Phase III Excavation	
DATE OF TPH EXT.   ANAL.:	11/30/95	12/02/95
DATE OF BTEX EXT.   ANAL.:	12/01/95	12/01/95
TYPE   DESCRIPTION:	VC	Brown sand & clay

Field Remarks:

RESULTS

PARAMETER	RESULT	UNITS	QUALIFIERS			
			DF	Q	M(g)	V(ml)
BENZENE	<0.5	MG/KG				
TOLUENE	<0.5	MG/KG				
ETHYL BENZENE	1.1	MG/KG				
TOTAL XYLENES	21.1	MG/KG				
TOTAL BTEX	22.2	MG/KG				
TPH (418.1)	1460	MG/KG			2.11	28
HEADSPACE PID	1045	PPM				
PERCENT SOLIDS	84.2	%				

-- TPH is by EPA Method 418.1 and BTEX is by EPA Method 8020 --

Surrogate Recovery was at 90 % for this sample All QA/QC was acceptable.  
Narrative:

DF = Dilution Factor Used

Approved By:

*John Sandoz*

Date:

7/18/95



Natural Gas Company

CHAIN OF CUSTODY RECORD

Page \_\_\_\_\_ of \_\_\_\_\_

PROJECT NUMBER		PROJECT NAME		CONTACT LABORATORY P. O. NUMBER	
24324		Pit Closure Project # 24324			
SAMPLERS: (Signature)		DATE:			
		11-29-95			
LAB ID	DATE	TIME	MATRIX	SAMPLE NUMBER	REMARKS
	11-29-95	10:15	40V	4P93	Flora Vista # 75718
	11-29-95	11:17	40V	4P94	84 Upgrave Gas Com #A 89915
[Large diagonal line across the table]					

REQUESTED ANALYSIS		SAMPLE TYPE		TOTAL NUMBER OF CONTAINERS		RECEIVED BY: (Signature)		DATE/TIME		RECEIVED BY: (Signature)	
TPH	EPA 418.1	BTEX	EPA 8020								
X	X	X	X	1	VC				11/29/95		
X	X	X	X	1	VC				11/29/95		
[Large diagonal line across the table]											

REQUESTED TURNAROUND TIME:		SAMPLE RECEIPT REMARKS		RESULTS & INVOICES TO:	
<input type="checkbox"/> ROUTINE	<input type="checkbox"/> RUSH			FIELD SERVICES LABORATORY	
CARRIER CO.				EL PASO NATURAL GAS COMPANY	
BILL NO.:				P. O. BOX 4990	
				FARMINGTON, NEW MEXICO 87499	

505-599-2144 FAX: 505-599-2261

CONTAINS HAZARDOUS MATERIALS

# STRAIGHT BILL OF LADING

ORIGINAL - NOT NEGOTIABLE

Shipper's No. \_\_\_\_\_

CARRIER:

DOUG FOUTZ CONSTRUCTION

(11957 - PITSSCAC

Carrier's No. \_\_\_\_\_

Date 24 Nov 1995

TO:

Consignee  
Street  
DestinationTIERRA ENVIRONMENTAL CORP.  
909 WEST APACHE  
FARMINGTON, NM 87409  
ZipFROM: EL PASO NATURAL GAS COMPANY 24324  
Shipper P.O. BOX 4990  
Street FARMINGTON, NM 87499-4990  
Origin ZipRoute: 2012

Vehicle Number

935

No. Shipping Units	HM	Kind of Packages, Description of Articles (If HAZARDOUS MATERIALS - PROPER SHIPPING NAME)	HAZARD CLASS	I.D. Number	WEIGHT (subject to correction)	RATE	LABELS REQUIRED (or exemption)
157	29	Tierra / Flora Vista #1	BACKFILL	75718	10	YD.	N/A
113	29	Tierra / Flora Vista #1	BACKFILL	75718	10	YD.	N/A
113	29	Tierra / Flora Vista #1	BACKFILL	75718	10	YD.	N/A
105	29	Tierra / Flora Vista #1	BACKFILL	75718	10	YD.	N/A
		BACKFILL				YD.	N/A

Remit C.O.D. to:

Address:

City:

State:

Zip:

C.O.D. Amt: \$

C.O.D. FEE:  
Prepaid ☒ Collect ☐ \$

NOTE: Where the rate is dependent on value, shippers are required to state specifically in writing the agreed or declared value of the property. The agreed or declared value of the property is hereby specifically stated by the shipper to be not exceeding \$

Subject to Section 1 of the conditions of this bill of lading, the property described above in apparent good order, except as noted (contents and condition of contents are stated in the bill of lading) is being delivered to the consignee without recourse on the part of the shipper, and the shipper shall not be liable for any loss or damage to the property or its contents, whether by fire, theft, or any other cause, until the property is delivered to the consignee and is received by him.

FREIGHT CHARGES  
☒ PREPAID ☐ COLLECT

RECEIVED: Subject to the classifications and liability filed herein in effect on the date of issue of this Bill of Lading, the property described above in apparent good order, except as noted (contents and condition of contents are stated in the bill of lading) is being delivered to the consignee without recourse on the part of the shipper, and the shipper shall not be liable for any loss or damage to the property or its contents, whether by fire, theft, or any other cause, until the property is delivered to the consignee and is received by him.

Under the contract, the shipper agrees to carry this usual place of delivery at said destination and as to each party at any time interested in all or any said property, that every service to be performed hereunder shall be subject to all the bill of lading terms and conditions in the governing classification on the date of shipment.

Shipper hereby certifies that he is familiar with all the bill of lading terms and conditions in the governing classification and the said terms and conditions are hereby agreed to by the shipper and accepted for himself and his assigns.

This is to certify that the above named materials are properly classified, described, packaged, marked and labeled and are in proper condition for transportation in accordance with the applicable regulations of the Department of Transportation.

Per El Paso

PLACARDS REQUIRED

N/A

PLACARDS SUPPLIED

☐ YES ☒ NO - FURNISHED BY CARRIER DRIVER SIGNATURE:

SHIPPER:

EL PASO NATURAL GAS COMPANY

DATE:

CARRIER:

Doug Foutz Const.DATE: 24 Nov 1995

PER:

SANDRA MILLER

DATE:

EMERGENCY RESPONSE: EL PASO NATURAL GAS (505) 599-2141

MONITORED AT ALL TIMES THE HAZARDOUS MATERIAL IS IN TRANSPORTATION, INCLUDING STORAGE

TELEPHONE NUMBER: 1 505 326-2262 PHILIP ENVIRONMENTAL

INCIDENTAL TO TRANSPORTATION (172 604)

CONTAINS HAZARDOUS MATERIALS

CONTAINS HAZARDOUS MATERIALS

CONTAINS HAZARDOUS MATERIALS

## CONTAINS HAZARDOUS MATERIALS

STRAIGHT BILL OF LADING  
ORIGINAL - NOT NEGOTIABLE

Shipper's No. \_\_\_\_\_

CARRIER: DOUG FOULTZ CONSTRUCTION (11957-PITS) SCAC

Carrier's No. \_\_\_\_\_  
Date 11-29-95TO: TIERRA ENVIRONMENTAL CORP.  
Consignee 909 WEST APACHE  
Street FARMINGTON, NM 87409  
Destination ZipFROM: EL PASO NATURAL GAS COMPANY 24324  
Shipper P.O. BOX 4990  
Street FARMINGTON, NM 87499-4990  
Origin Zip

Route: 1 of 3

10hrs. Vehicle Number 22

CONTAINS HAZARDOUS MAT

CONTAINS HAZARDOUS MATERIALS

No. Shipping Units	HM	Kind of Packages, Description of Articles (If HAZARDOUS MATERIALS - PROPER SHIPPING NAME)	HAZARD CLASS	LD. Number	WEIGHT (Subject to correction)	RATE	LABELS REQUIRED (or exemption)
8145		El Paso Vista #1 / TIERRA	EXEMPT HYDROCARBON CONTAMINATED SOIL	75718	1 C	YD.	N/A
6150		El Paso Vista #1 / TIERRA	EXEMPT HYDROCARBON CONTAMINATED SOIL	75718	10	YD.	N/A
10500		El Paso Vista #1 / TIERRA	EXEMPT HYDROCARBON CONTAMINATED SOIL	75718	10	YD.	N/A
12100		El Paso Vista #1 / TIERRA	EXEMPT HYDROCARBON CONTAMINATED SOIL	75718	10	YD.	N/A
14100		El Paso Vista #1 / TIERRA	EXEMPT HYDROCARBON CONTAMINATED SOIL	75718	10	YD.	N/A
14100		El Paso Vista #1 / TIERRA	EXEMPT HYDROCARBON CONTAMINATED SOIL	75718	10	YD.	N/A

Remit C.O.D. to: Address: City: State: Zip: C.O.D. Amt: \$

COD Amt: \$

C.O.D. FEE: Prepaid ☒ Collect ☐

NOTE: Where the rate is dependent on value, shippers are required to state specifically in writing the agreed or declared value of the property. The agreed or declared value of the property is hereby specifically stated by the shipper to not exceed \$ \_\_\_\_\_ Per \_\_\_\_\_

Signature of Shipper: \_\_\_\_\_

FREIGHT CHARGES ☒ PREPAID ☐ COLLECT

RECEIVED subject to the classification and liability of the date of issue of this Bill of Lading, the property described above in apparent good order, except as noted hereon, and condition of contents of packages (unknown) marked "contents" and delivered as indicated above, when received by the carrier, the carrier undertakes to deliver to the consignee in possession of the property under the contract, subject to the usual place of delivery at said destination, if on its route, otherwise to deliver to another carrier on the route to said destination. It is mutually agreed as to each party of all or any of said property over all or any portion of said route to destination and as to each party at any time interested in all or any said property, that every service to be performed hereunder shall be subject to all the bill of lading terms and conditions in the governing classification on the date of shipment. Shipper hereby certifies that he is familiar with all the bill of lading terms and conditions in the governing classification and the said terms and conditions are hereby agreed to by the shipper and accepted for himself and his assigns.

This is to certify that the above named materials are properly classified, described, packaged, marked and labeled and are in proper condition for transportation according to the applicable regulations of the Department of Transportation.

PLACARDS REQUIRED

N/A

PLACARDS SUPPLIED

☐ YES ☒ NO - FURNISHED BY CARRIER DRIVER SIGNATURE: \_\_\_\_\_SHIPPER: EL PASO NATURAL GAS COMPANY  
PER: SANDRA MILLER DATE: \_\_\_\_\_CARRIER: Doug Foltz  
PER: Doug Foltz DATE: 11-29-95EMERGENCY RESPONSE: EL PASO NATURAL GAS (505) 599-2141  
TELEPHONE NUMBER: 505 326-2262 PHILLIP ENVIRONMENTAL  
MONITORED AT ALL TIMES THE HAZARDOUS MATERIAL IS IN TRANSPORTATION, INCLUDING STORAGE  
INCIDENTAL TO TRANSPORTATION (177 604)

CONTAINS HAZARDOUS MATERIALS

ORIGINAL - NOT NEGOTIABLE

**CONTAINS HAZARDOUS MATERIALS**

Shipper's No.

Carrier's No. \_\_\_\_\_  
Date \_\_\_\_\_

S. No. 11-29-45  
Date

**FROM:** EL PASO NATURAL GAS COMPANY 24324  
Shipper P.O. BOX 4990

Origin

V.

Vehicle Number

No. Shipping Units	HM	Kind of Packages, Description of Articles (If Hazardous Materials - Proper Shipping Name)	Hazard Class	I.D. Number	WEIGHT (subject to correction)	RATE	LABELS REQUIRED (or exemption)
9.00		Tierra / Tierra Vista #1 BACKFILL		75718	10	YD.	N/A
9.00		Tierra / Tierra Vista #1 BACKFILL		75718	10	YD.	N/A
10.00		Tierra / Tierra Vista #1 BACKFILL		75718	10	YD.	N/A
12.38		Tierra / Tierra Vista #1 BACKFILL		75718	10	YD.	N/A
12.38		Tierra / Tierra Vista #1 BACKFILL		75718	10	YD.	N/A

1. b

# GOO

**Amt: \$**

**C.O.D. FEE:**  
Prepaid ☒ **XX**  
Collect ☐ \$

Subject to Section 7 of the conditions, if this shipment is to be delivered to the consignee without receipt or the consignee, the consignee undertakes the following statement:

The carrier, both not and delivery of this shipment without payment of freight and all other kind of charges.

Signature of Consignor:

**FREIGHT CHARGES**

☒ PREPAID ☐ COLLECT

RECEIVED subject to the classifications and lawfully filed tariffs in effect on the date of issue of this Bill of Lading, the property described above in apparent good order, except as noted (contents and condition of contents of packages unknown, marked, consigned, and destined as indicated above which said carrier, the world carrier being understood throughout this contract as meaning any person or corporation in possession of the property under the contract) agrees to carry to its usual place of delivery at said destination, if on its route, otherwise to deliver to another carrier on the route to said destination. It is mutually agreed as to each carrier of all or any of said property over all or any portion of said route to destination and as to each party at any time interested in all or any said property, that every service to be performed hereunder shall be subject to all the bill of lading terms and conditions in the governing classification on the date of shipment.

Shipper hereby certifies that he is familiar with all the bill of lading terms and conditions in the governing classification and the said terms and conditions are hereby agreed to by the shipper and accepted for himself and his assigns.

**PLACARDS  
REQUIRED**

N/A

**PLACARDS  
SUPPLIED**

☐ YES ☒ NO — FURNISHED BY CARRIER

CARRIER:

PER: h

MONITORED AT ALL TIMES THE HAZARDOUS  
INCIDENTAL TO TRANSPORTATION (172.604)

MATERIAL IS IN TRANSPORTATION, INCLUDING STORAGE

**CONTAINS HAZARDOUS MATERIALS**

**CONTAINS HAZARDOUS MATERIALS**

**CONTAINS HAZARDOUS MATERIALS**

Shipper's No.

CARRIER: DOUG FOUTZ CONSTRUCTION (11957-PITS) SCAC

Carrier's NO. 29  
Date 10/19/95

TO:	TERRA ENVIRONMENTAL CORP
Consignee	909 WEST APACHE
Street	FARMINGTON, NM 87409
Destination	Zip

**FROM:** EL PASO NATURAL GAS COMPANY 24324  
Shipper P.O. BOX 4990  
Street FARMINGTON, NM 87499-4990  
Origin Zip

Route: 1072

5/4 hrs	Vehicle Number	935
---------	----------------	-----

Id. Shipping Units	H/M	Kind of Packages, Description of Articles (If Hazardous Materials - Proper Shipping Name)	Hazard Class	I.D. Number	Weight (subject to correction)	Rate	Labels Required (or exemption)
0.30	083	From Vista #1 / Tierra	EXEMPT HYDROCARBON CONTAMINATED SOIL	75718	10	YD.	N/A
11.00	083	From Vista #1 / <del>Tierra</del>	EXEMPT HYDROCARBON CONTAMINATED SOIL	75718	10	YD.	N/A
10.00	083	From Vista #1 / <del>Tierra</del>	EXEMPT HYDROCARBON CONTAMINATED SOIL	75718	10	YD.	N/A
10.00	083	From Vista #1 / <del>Tierra</del>	EXEMPT HYDROCARBON CONTAMINATED SOIL	75718	10	YD.	N/A
10.00	083	From Vista #1 / <del>Tierra</del>	EXEMPT HYDROCARBON CONTAMINATED SOIL	75718	10	YD.	N/A

Remit C.O.D. to  
Address:  
City:

State: \_\_\_\_\_ Zip: \_\_\_\_\_

**GOD** Amt: \$

**C.O.D. FEE:**  
 Prepaid ☒  
 Collect ☐ \$

**NOTE —** Where the rate is dependent on value, shippers are required to state specifically writing the agreed or declared value of the property. The agreed or declared value of the property is hereby specifically stated by the shipper to be not exceeding \$ \_\_\_\_\_ Per \_\_\_\_\_

**Signature of Contractor**

**FREIGHT CHARGES** ☒ PREPAID ☐ COLLECT

RECEIVED, subject to the classifications and lawfully filed tariffs in effect on the date of issue of this Bill of Lading, the property described above in apparent good order, except as noted (contents and condition of contents of packages unexamined, marked, consigned and destined as indicated above which said carrier, the word carrier being understood throughout this contract as meaning any person or corporation in possession of the property under the contract agreement, to carry to its usual place of delivery at said destination, if on its route, otherwise to deliver to another carrier on the route to said destination. It is mutually agreed as to each carrier of all or any of said property over all or any portion of said route to destination and as to each party at any time interested in all or any said property, that every service to be performed hereunder shall be subject to all the bill of lading terms and conditions in the governing classification on the date of shipment.

Shipper hereby certifies that he is familiar with all the bill of lading terms and conditions in the governing classification and the said terms and conditions are hereby agreed to by the shipper and accepted for himself and his assigns.

This is to certify that the above named materials are properly classified, described, packaged, marked and labeled and are in proper condition for transportation according to the applicable regulations of the Department of Transportation

## PLACARDS REQUIRED

N/A

## PLACARDS SLIPPED

☐ YES ☒ NO - FURNISHED BY CARRIE

SHIPPER: EL PASO NATURAL GAS COMPANY  
PER: SANDRA MILLER DATE:

CARRIER: WELLS FARGO BANK  
PER: WELLS FARGO BANK DATE: \_\_\_\_\_

DATE: 29/01/98

EMERGENCY RESPONSE  
TELEPHONE NUMBER: (505) 326-2262 PHILIP ENVIRONMENT  
EL PASO NATURAL GAS (505) 599-2141

MONITORED AT ALL TIMES THE HAZARDOUS MATERIAL IS IN TRANSPORTATION, INCLUDING STORAGE INCIDENTAL TO TRANSPORTATION (172 604)

**CONTAINS HAZARDOUS MATERIALS**

**CONTAINS HAZARDOUS MATERIALS**

**CONTAINS HAZARDOUS MATERIALS**

## CONTAINS HAZARDOUS MATERIALS

STRAIGHT BILL OF LADING  
ORIGINAL - NOT NEGOTIABLE

Shipper's No. \_\_\_\_\_

CARRIER: DOUG FOUTZ CONSTRUCTION (11957 - PITSCAC)

Carrier's No. 343687  
Date 11-29-96TO: TIERRA ENVIRONMENTAL CORP.  
Consignee 909 WEST APACHE  
Street FARMINGTON, NM 87409  
Destination ZipFROM: EL PASO NATURAL GAS COMPANY 24324  
Shipper P.O. BOX 4990  
Street FARMINGTON, NM 87499-4990  
Origin ZipRoute: 2 of 2

No. Shipping Units	HM	Kind of Packages, Description of Articles (If Hazardous Materials - Proper Shipping Name)	HAZARD CLASS	I.D. Number	WEIGHT (Subject to Correction)	RATE	VEHICLE Number	LABELS REQUIRED (or exemption)
14299		Tierra / Tierra Vista #1	BACKFILL	75718	10	YD.		N/A
92899		Tierra / Tierra Vista #1	BACKFILL	75718	10	YD.		N/A
113028		Tierra / Tierra Vista #1	BACKFILL	75718	10	YD.		N/A
113028		Tierra / Tierra Vista #1	BACKFILL	75718	10	YD.		N/A
113028		Tierra / Tierra Vista #1	BACKFILL	75718	10	YD.		N/A
113028		Tierra / Tierra Vista #1	BACKFILL	75718	10	YD.		N/A

Remit C.O.D. to:  
Address:  
City: State: Zip:

City: State: Zip:

COD Amt: \$

C.O.D. FEE:  
Prepaid ☒ Collect ☐

NOTE — Where the rate is dependent on value, shippers are required to state specifically in writing the agreed or declared value of the property. The agreed or declared value of the property is hereby specifically stated by the shipper to be not exceeding \$ \_\_\_\_\_ Per \_\_\_\_\_

Shipper is hereby certifying that the property described above is in apparent good order, except as noted hereon, and condition of contents under the contract agrees to carry to its usual place of delivery at said destination, if on its route, otherwise to deliver to another carrier on the route to said destination. It is mutually agreed as to each carrier of all or any of said property over all or any portion of said route to destination and as to each party at any time interested in all or any said property, that every service to be performed hereunder shall be subject to all the bill of lading terms and conditions in the governing classification on the date of shipment.

FREIGHT CHARGES  
☒ PREPAID ☐ COLLECT

This is to certify that the above named materials are properly classified, described, packaged, marked and labeled in accordance with the applicable regulations of the Department of Transportation.

PLACARDS REQUIRED

N/A

PLACARDS SUPPLIED

DRIVER SIGNATURE: ☐ YES ☒ NO — FURNISHED BY CARRIERSHIPPER: EL PASO NATURAL GAS COMPANY  
PER: SANDRA MILLER DATE:CARRIER: Doug Foutz Const.  
PER: C. Foutz Signature DATE: 11-29-95EMERGENCY RESPONSE (EL PASO NATURAL GAS (505) 599-2141  
TELEPHONE NUMBER: 505 326-2262 PHILIP ENVIRONMENTALMONITORED AT ALL TIMES. THE HAZARDOUS MATERIAL IS IN TRANSPORTATION, INCLUDING STORAGE  
INCIDENTAL TO TRANSPORTATION (172 604)

CONTAINS HAZARDOUS MATERIALS

CONTAINS HAZARDOUS MATERIALS

CONTAINS HAZARDOUS MAT 6

**STRAIGHT BILL OF LADING**  
**ORIGINAL - NOT NEGOTIABLE**

**ORIGINAL - NOT NEGOTIABLE**

Shipper's No

CARRIER: DOUG FOUTZ CONSTRUCTION (11957-PITS) SCAC

Carrier's No. 343637  
Date 11-29-95

TO: TIERRA ENVIRONMENTAL CORP

Consignee	909 WEST APACHE
Street	FARMINGTON, NM 87409
Destination	Zip

**FROM:** EL PASO NATURAL GAS COMPANY 24324  
Shipper P.O. BOX 4990  
Street FARMINGTON, NM 87499-4990  
Origin Zip

Route: 101

6 1/2 hrs.	Vehicle Number	831
------------	----------------	-----

No. Shipping Units	HM	Kind of Packages, Description of Articles (If HAZARDOUS MATERIALS - PROPER SHIPPING NAME)	HAZARD CLASS	I.D. Number	WEIGHT (subject to correction)	RATE	LABELS REQUIRED (or exemption)
8.46		Empty VISTA #1 / TIERA	EXEMPT HYDROCARBON CONTAMINATED SOIL	75718	10	YD.	N/A
9.38		Empty VISTA #1 / TIERA	EXEMPT HYDROCARBON CONTAMINATED SOIL	75718	10	YD.	N/A
10.38		Empty VISTA #1 / TIERA	EXEMPT HYDROCARBON CONTAMINATED SOIL	75718	10	YD.	N/A
11.46		Empty VISTA #1 / TIERA	EXEMPT HYDROCARBON CONTAMINATED SOIL	75718	10	YD.	N/A
12.53		Empty VISTA #1 / TIERA	EXEMPT HYDROCARBON CONTAMINATED SOIL	75718	10	YD.	N/A

Address:  
City:

State:

Zip:

**GOD** Amt: \$

**C.O.D. FEE:**  
 Prepaid ☒  
 Collect ☐ \$

**NOTE** — Where the rate is dependent on value, shippers are required to state specifically writing the agreed or declared value of the property. The agreed or declared value of the property is hereby specifically stated by the shipper to be not exceeding \$ \_\_\_\_\_ Per \_\_\_\_\_

Subject to Section 2 of the conditions, if this shipment is to be returned to the consignee without recourse on the consignee, the consignee shall sign the following statement:

The consignee shall not make delivery of this shipment without payment of freight and other lawful charges.

Signature of Consignee:

**FREIGHT CHARGES**  
☒ PREPAID    ☐ COLLECT

This is to certify that the above named materials are properly classified, described, packaged, marked and labeled and are in proper condition for transportation according to the applicable regulations of the Department of Transportation

## PLACARDS REQUIRED

N/A

**PLACARDS  
SUPPLIED**

☐ YES ☒ NO — FURNISHED BY CARRIER

SHIPPER: EL PASO NATURAL GAS COMPANY

CARRIER Doug Foots Const.

PER: SANDRA MILLER DATE:

PER: *C. Paulo* & *Erasmus* DATE: *11-29-95*

EMERGENCY RESPONSE (EL PASO NATURAL GAS (505) 599-2141)  
TELEPHONE NUMBER: 505 326-2262 PHILIP FENYRONMENT

MONITORED AT ALL TIMES THE HAZARDOUS MATERIAL IS IN TRANSPORTATION, INCLUDING STORAGE INCIDENTAL TO TRANSPORTATION (172 604)

**CONTAINS HAZARDOUS MATERIALS**

**CONTAINS HAZARDOUS MATERIALS**

**CONTAINS HAZARDOUS MATERIALS**

Carrier's No. \_\_\_\_\_  
Date 1-29-93

**TO:** TIERRA ENVIRONMENTAL CORP.

---

**FROM:** EL PASO NATURAL GAS COMPANY 24324

zip

Vehicle Number 934

**CONTAINS HAZARDOUS MATERIALS**

**C.O.D. FEE:**  
 Prepaid ☒  
 Collect ☐ \$

**FREIGHT CHARGES**  
☒ PREPAID ☐ COLLECT

RECEIVED, subject to the classifications and liability listed herein in effect on the date of issue of this bill of lading, the property described above in apparent good order, except as noted hereon and condition of contents of packages (unknown), marked, consigned and destined as indicated above which said carrier (the world career, being understood throughout this contract as meaning any person or corporation in possession of the property under the contract) agrees to carry to its usual place of delivery at said destination, if on its route, otherwise to deliver to another carrier on the route to said destination. It is mutually agreed as to each carrier of all or any of said property over all or any portion of said route to destination and as to each party at any time interested in all or any said property, that every service to be performed hereunder shall be subject to all the bills of lading terms and conditions on the governing classification on the date of shipment of adding terms and conditions in the governing classification and the said terms and conditions are hereby agreed to by the shipper and accepted for himself and his assigns.

☐ YES ☒ NO — FURNISHED BY CARRIER

DATE: 11-29-95

MONITORED AT ALL TIMES THE HAZARDOUS MATERIAL IS IN TRANSPORTATION, INCLUDING STORAGE INCIDENTAL TO TRANSPORTATION (172 604)

**CONTAINS HAZARDOUS MATERIALS**

**CONTAINS HAZARDOUS MATERIALS**

**STRAIGHT BILL OF LADING**  
**ORIGINAL - NOT NEGOTIABLE**

**ORIGINAL - NOT NEGOTIABLE**

Shipper's No

CARRIER: DOUG-FOUTZ CONSTRUCTION (11957-PITS) SCAC

Carrier's No. 11-70-95  
Date

**TO: TIERRA ENVIRONMENTAL CORP.**

309 WEST APACHE

**FROM:** EL PASO NATURAL GAS COMPANY 24324  
Shipper P.O. BOX 4990

Street FARMINGTON NM 87409

Street EARMINGTON NM 87499-4990

Destination

zip

## Origin

zip

Route: 1074

10/4 hrs

Number

20

No. Shipping Unit	HQ?	Kind of Packages, Description of Articles (If Hazardous Materials - Proper Shipping Name)	HAZARD CLASS	I.D. Number	WEIGHT (subject to correction)	RATE	LABELS REQUIRED (or exemption)
75718		FLORENCE #1 / TIERRA	EXEMPT HYDROCARBON CONTAMINATED SOIL	75718	10	YD.	N/A
75718		FLORENCE #1 / TIERRA	EXEMPT HYDROCARBON CONTAMINATED SOIL	75718	10	YD.	N/A
75718		FLORENCE #1 / TIERRA	EXEMPT HYDROCARBON CONTAMINATED SOIL	75718	10	YD.	N/A
75718		FLORENCE #1 / TIERRA	EXEMPT HYDROCARBON CONTAMINATED SOIL	75718	10	YD.	N/A
75718		FLORENCE #1 / TIERRA	EXEMPT HYDROCARBON CONTAMINATED SOIL	75718	10	YD.	N/A

Remit A. B. D. to:

Address:

State:

Zin

# 600

## Ami:

5

**CONFEE.**

Prepaid	<input checked="" type="checkbox"/>	\$
Collect	<input type="checkbox"/>	\$

5

**NOTE** — Where the rate is dependent on value, shippers are required to state specifically writing the agreed or declared value of the property. The agreed or declared value of the property hereby specifically stated by the shipper to be not exceeding \$ \_\_\_\_\_ Per \_\_\_\_\_

Subject to Section 7 of the conditions, if this document is to be delivered to the consignee without recourse on the consignee, the consignee shall give the following statement

The carrier shall not make delivery of this shipment without payment of freight and all other lawful charges

(Signature of Consignee)

**FREIGHT CHARGES** ☒ PREPAID ☐ COLLECT

RECEIVED subject to the classifications and liability limit (limits) in effect on the date of issue of this bill of lading, the property described above in apparent good order, except as noted (contents and condition of contents of packages unknown), marked, consigned, and destined as indicated above which said carrier, the word carrier being understood throughout this contract as meaning any person or corporation in possession of the property under the contract agrees to carry to its usual place of delivery at said destination, it on its route, otherwise to deliver to another carrier on the route to said destination. It is mutually agreed as to each carrier of all or any of said property over all or any portion of said route to destination and as to each party at any time interested in all or any said property, that every service to be performed hereunder shall be subject to all the bill of lading terms and conditions in the governing classification on the date of shipment.

Shipper hereby certifies that he is familiar with all the bill of lading terms and conditions in the governing classification and the said terms and conditions are hereby agreed to by the shipper and accepted for himself and

This is to certify that the above named materials are properly classified, described, packaged, marked and labeled and are in proper condition for transportation according to the applicable regulations of the Department of Transportation.

## PLACARDS

N/A

## PLACARDS

☐ YES ☒ NO — FURNISHED BY CARRIER

SHIPPER: EL PASO NATURAL GAS COMPANY

PER: SANDRA MILLER

DATE:

CARRIER: *Deerfoot Dairy*

PER: Y. P. [Signature]

DATE: 11-29-91

TELEPHONE NUMBER: (505) 599-2141  
EMERGENCY RESPONSE: EL PASO NATURAL GAS (505) 599-2141

MONITORED AT ALL TIMES THE HAZARDOUS MATERIAL IS IN TRANSPORTATION, INCLUDING STORAGE  
INCIDENTAL TO TRANSPORTATION (172 604)

**CONTAINS HAZARDOUS MATERIALS**

**CONTAINS HAZARDOUS MATERIALS**

## CONTAINS HAZARDOUS MATERIALS

STRAIGHT BILL OF LADING  
ORIGINAL - NOT NEGOTIABLE

Shipper's No. \_\_\_\_\_

CARRIER:

DOUG FOUJZ CONSTRUCTION

(11957 - PITSSCAG)

Carrier's No. \_\_\_\_\_  
Date \_\_\_\_\_

11-29-93

TO:

Consignee  
Street  
DestinationTIERRA ENVIRONMENTAL CORP.  
909 WEST APACHE  
FARMINGTON, NM 87409  
ZipFROM: EL PASO NATURAL GAS COMPANY  
Shipper P.O. BOX 4990  
Street FARMINGTON, NM 87499-4990  
Origin Zip

24324

Route: 30f4

Vehicle  
Number

834

No. of Packages, Description of Articles  
Shipping Units (If HAZARDOUS MATERIALS - PROPER SHIPPING NAME)HAZARD  
CLASSI.D.  
NumberWEIGHT  
(subject to  
correction)

RATE

LABELS REQUIRED  
(for exemption)

850	100	TIERRA / TIERRA VISITA #1	BACKFILL	75718	10	YD.	N/A
415	100	TIERRA / TIERRA VISITA #1	BACKFILL	75718	10	YD.	N/A
005000	100	TIERRA / TIERRA VISITA #1	BACKFILL	75718	10	YD.	N/A
005000	100	TIERRA / TIERRA VISITA #1	BACKFILL	75718	10	YD.	N/A
005000	100	TIERRA / TIERRA VISITA #1	BACKFILL	75718	10	YD.	N/A
005000	100	TIERRA / TIERRA VISITA #1	BACKFILL	75718	10	YD.	N/A

Remit C.O.D. to:

Address:

City:

State:

COD

Amt: \$

C.O.D. FEE:  
Prepaid ☒ Collect ☐

NOTE — Where the rate is dependent on value, shippers are required to state specifically in writing the agreed or declared value of the property. The agreed or declared value of the property is hereby specifically stated by the shipper to be not exceeding \$ \_\_\_\_\_ Per \_\_\_\_\_

Subject to Section 7 of the conditions of the bill of lading, the shipper is to be delivered to the consignee without recourse on the property, the consignee shall sign the following statement: "The carrier, vessel and its employees are not responsible for the loss of or damage to the property in transit."

FREIGHT CHARGES  
☒ PREPAID ☐ COLLECT

RECEIVED subject to the classifications and liability listed in this bill of lading, the property described above in apparent good order, except as noted hereon, and condition of contents under the contract, agrees to carry to its usual place of delivery at said destination, if on its route, otherwise to deliver to another carrier on the route to said destination. It is mutually agreed as to each carrier of all or any of said property over all or any portion of said route to destination and as to each party at any time interested in all or any said property, that every service to be performed hereunder shall be subject to all the terms, conditions and conditions in the governing classification on the date of shipment. Shipper hereby certifies that he is familiar with all the bill of lading terms and conditions in the governing classification and the said terms and conditions are hereby agreed to by the shipper and accepted for himself and his assigns.

PLACARDS  
REQUIRED

N/A

PLACARDS  
SUPPLIED☐ YES ☒ NO — FURNISHED BY CARRIER  
DRIVER SIGNATURE: \_\_\_\_\_

SHIPPER:

EL PASO NATURAL GAS COMPANY  
PER: SANDRA MILLER DATE: \_\_\_\_\_

CARRIER: Doug Foujz

PER: Doug Foujz DATE: 11-29-93

EMERGENCY RESPONSE ( 505 ) 326-2262 PHILIP ENVIRONMENTAL

MONITORED AT ALL TIMES THE HAZARDOUS MATERIAL IS IN TRANSPORTATION, INCLUDING STORAGE  
INCIDENTAL TO TRANSPORTATION (177 804)

CONTAINS HAZARDOUS MATERIALS

CONTAINS HAZARDOUS MATERIALS

CONTAINS HAZARDOUS MATERIALS

## CONTAINS HAZARDOUS MATERIALS

STRAIGHT BILL OF LADING  
ORIGINAL - NOT NEGOTIABLE

Shipper's No. \_\_\_\_\_

CARRIER: DOUG FOULTZ CONSTRUCTION (11957-PITS) SCAC

Carrier's No. \_\_\_\_\_  
Date 11-29-95TO: TIERRA ENVIRONMENTAL CORP.  
Consignee 909 WEST APACHE  
Street FARMINGTON, NM 87409  
Destination ZipFROM: EL PASO NATURAL GAS COMPANY 24324  
Shipper P.O. BOX 4990  
Street FARMINGTON, NM 87499-4990  
Origin ZipRoute: 106410 hrs Vehicle Number 835

CONTAINS HAZARDOUS MATERIALS

No. Shipping Units	HM (If Hazardous Materials - Proper Shipping Name)	Kind of Packages, Description of Articles	HAZARD CLASS	I.D. Number	WEIGHT (subject to correction)	RATE	LABELS REQUIRED (or exemption)
830		Flora Vista #1 / TIERRA	EXEMPT HYDROCARBON CONTAMINATED SOIL	75718	10	YD.	N/A
831		Flora Vista #1 / TIERRA	EXEMPT HYDROCARBON CONTAMINATED SOIL	75718	10	YD.	N/A
832		Flora Vista #1 / TIERRA	EXEMPT HYDROCARBON CONTAMINATED SOIL	75718	10	YD.	N/A
833		Flora Vista #1 / TIERRA	EXEMPT HYDROCARBON CONTAMINATED SOIL	75718	10	YD.	N/A
834		Flora Vista #1 / TIERRA	EXEMPT HYDROCARBON CONTAMINATED SOIL	75718	10	YD.	N/A
835		Flora Vista #1 / TIERRA	EXEMPT HYDROCARBON CONTAMINATED SOIL	75718	10	YD.	N/A
836		Flora Vista #1 / TIERRA	EXEMPT HYDROCARBON CONTAMINATED SOIL	75718	10	YD.	N/A
837		Flora Vista #1 / TIERRA	EXEMPT HYDROCARBON CONTAMINATED SOIL	75718	10	YD.	N/A
838		Flora Vista #1 / TIERRA	EXEMPT HYDROCARBON CONTAMINATED SOIL	75718	10	YD.	N/A
839		Flora Vista #1 / TIERRA	EXEMPT HYDROCARBON CONTAMINATED SOIL	75718	10	YD.	N/A
840		Flora Vista #1 / TIERRA	EXEMPT HYDROCARBON CONTAMINATED SOIL	75718	10	YD.	N/A

Address: \_\_\_\_\_  
City: \_\_\_\_\_ State: \_\_\_\_\_ Zip: \_\_\_\_\_

COD Amt: \$ \_\_\_\_\_

C.O.D. FEE: Prepaid ☒ Collect ☐ \$ \_\_\_\_\_

NOTE: Where the rate is dependent on value, shippers are required to state specifically in writing the agreed or declared value of the property. The agreed or declared value of the property is hereby specifically stated by the shipper to be not exceeding \$ \_\_\_\_\_ Per \_\_\_\_\_

Subject to Section 7 of the conditions, if this shipment is to be delivered to the consignee without release in the form of a bill of lading, the shipper agrees to indemnify the carrier for any loss or damage to the property of the consignee.

FREIGHT CHARGES ☒ PREPAID ☐ COLLECT

RECEIVED: subject to the classifications and lawfully filed tariffs, in effect on the date of issue of this Bill of Lading, the carrier described above in apparent good order, except as noted (contents and condition of contents under the contract) agrees to carry to its usual place of delivery at said destination, if on its route, otherwise to deliver to another carrier on the route to said destination. It is mutually agreed as to each carrier of all or any of said property over all or any portion of said route to destination and as to each party at any time interested in all or any said property that every service to be performed hereunder shall be subject to all the bill of lading terms and conditions in the governing classification on the date of shipment. Shipper hereby certifies that he is familiar with all the bill of lading terms and conditions in the governing classification and the said terms and conditions are hereby agreed to by the shipper and accepted for himself and his assigns.

This is to certify that the above named materials are properly classified, packaged, labeled and marked in accordance with the provisions of the Hazardous Materials Regulations of the Department of Transportation.

PLACARDS REQUIRED

N/A

PLACARDS SUPPLIED

☐ YES ☒ NO - FURNISHED BY CARRIER DRIVER SIGNATURE: \_\_\_\_\_

SHIPPER: EL PASO NATURAL GAS COMPANY

PER: SANDRA MILLER DATE: \_\_\_\_\_

CARRIER: Doug Foltz DATE: 11-29-95EMERGENCY RESPONSE (EL PASO NATURAL GAS (505) 599-2141  
TELEPHONE NUMBER: 505 326-2262 PHILIP ENVIRONMENTALMONITORED AT ALL TIMES THE HAZARDOUS MATERIAL IS IN TRANSPORTATION, INCLUDING STORAGE  
INCIDENTAL TO TRANSPORTATION (172 604)

CONTAINS HAZARDOUS MATERIALS

CONTAINS HAZARDOUS MATERIALS

## CONTAINS HAZARDOUS MATERIALS

STRAIGHT BILL OF LADING  
ORIGINAL - NOT NEGOTIABLE

Shipper's No. \_\_\_\_\_

CARRIER: DOUG FOUTZ CONSTRUCTION (11957 - PIT\$GAC)

Carrier's No. \_\_\_\_\_  
Date 11-29TO:  
Consignee  
Street  
Destination  
TIERRA ENVIRONMENTAL CORP.  
909 WEST APACHE  
FARMINGTON, NM 87409  
ZipFROM: EL PASO NATURAL GAS COMPANY 24324  
Shipper P.O. BOX 4990  
Street FARMINGTON, NM 87499-4990  
Origin Zip

Route: 304

Vehicle  
Number 731

No. Shipping Units	HM	Kind of Packages, Description of Articles (If HAZARDOUS MATERIALS - PROPER SHIPPING NAME)	HAZARD CLASS	I.D. Number	WEIGHT (subject to correction)	RATE	LABELS REQUIRED (or exemption)
845	99	TIERRA / NEOMA VISTA #1	BACKFILL	75718	10	YD.	N/A
990	99	TIERRA / FLOREN VISTA #1	BACKFILL	75718	10	YD.	N/A
1044	99	TIERRA / NEOMA VISTA #1	BACKFILL	75718	10	YD.	N/A
1149	99	TIERRA / FLOREN VISTA #1	BACKFILL	75718	10	YD.	N/A
1239	99	TIERRA / FLOREN VISTA #1	BACKFILL	75718	10	YD.	N/A

Remit d.d. to:

Address:

City:

State:

Zip:

COD Amt: \$

C.O.D. FEE:  
Prepaid ☒  
Collect ☐ \$

NOTE — Where the rate is dependent on value, shippers are required to state specifically in writing the agreed or declared value of the property. The agreed or declared value of the property is hereby specifically stated by the shipper to be not exceeding \$

Subject to Section 1 of the Uniform Code of Sales, the shipper is to be obligated to the consignee without recourse on the bill of lading and the carrier's liability for loss or damage to the property shall not be limited by the amount of the freight and other charges.

FREIGHT CHARGES  
☒ PREPAID ☐ COLLECT

RECEIVED: subject to the classifications and lawfully filed tariffs in effect on the date of issue of this Bill of Lading, the property described above in apparent good order, except as noted (contents and condition of contents of packages, unknown, marked, consigned, and delivered as indicated above which said carrier (the word carrier being understood throughout this contract as meaning any person or corporation in possession of the property) has received and delivered to the consignee in accordance with the bill of lading and the carrier's liability for loss or damage to the property shall not be limited by the amount of the freight and other charges. Shipper hereby certifies that he is familiar with all the bill of lading terms and conditions in the governing classification on the date of shipment.

This is to certify that the above named materials are properly classified, described, packaged, marked and labeled and are in proper condition for transportation according to the applicable regulations of the Department of Transportation.

PLACARDS  
REQUIRED

N/A

PLACARDS  
SUPPLIED☐ YES ☒ NO — FURNISHED BY CARRIER  
DRIVER SIGNATURE:SHIPPER: EL PASO NATURAL GAS COMPANY  
PER: SANDRA MILLER DATE:CARRIER: DFC  
PER: Sandra Miller DATE: 11-29EMERGENCY RESPONSE: EL PASO NATURAL GAS (505) 599-2141  
TELEPHONE NUMBER: 505 326-2262 PHILIP ENVIRONMENTALMONITORED AT ALL TIMES THE HAZARDOUS MATERIAL IS IN TRANSPORTATION, INCLUDING STORAGE  
INCIDENTAL TO TRANSPORTATION (172 504)

CONTAINS HAZARDOUS MATERIALS

CONTAINS HAZARDOUS MATERIALS

## CONTAINS HAZARDOUS MATERIALS

STRAIGHT BILL OF LADING  
ORIGINAL - NOT NEGOTIABLE

Shipper's No. \_\_\_\_\_

CARRIER: DOUG FOUZ CONSTRUCTION (11957-PTS) SCAC

Carrier's No. \_\_\_\_\_  
Date 11-29TO:  
Consignee  
Street  
Destination  
TIERRA ENVIRONMENTAL CORP.  
909 WEST APACHE  
FARMINGTON, NM 87409  
ZipFROM: EL PASO NATURAL GAS COMPANY 24324  
Shipper P.O. BOX 4990  
Street FARMINGTON, NM 87499-4990  
Origin  
Zip

Route: 1 of 4

Kohrs

Vehicle Number 73/

No. Shipping Units	HM	Kind of Packages - Description of Articles (If HAZARDOUS MATERIALS - PROPER SHIPPING NAME)	HAZARD CLASS	I.D. Number	WEIGHT (Subject to correction)	RATE	LABELS REQUIRED (for exemption)
15		Flammable Visk #1 / Terra	EXEMPT HYDROCARBON CONTAMINATED SOIL	75718	16	YD.	N/A
13		Flammable Visk #1 / Terra	EXEMPT HYDROCARBON CONTAMINATED SOIL	75718	10	YD.	N/A
10		Flammable Visk #1 / Terra	EXEMPT HYDROCARBON CONTAMINATED SOIL	75718	10	YD.	N/A
11		Flammable Visk #1 / Terra	EXEMPT HYDROCARBON CONTAMINATED SOIL	75718	10	YD.	N/A
15		Flammable Visk #1 / Terra	EXEMPT HYDROCARBON CONTAMINATED SOIL	75718	10	YD.	N/A

Remit C.O.D. to:

Address:  
City:  
State:  
Zip:

COD Amt: \$

C.O.D. FEE:  
Prepaid ☒  
Collect ☐ \$NOTE - Where the rate is dependent on value, shippers are required to state specifically in writing the agreed or declared value of the property. The agreed or declared value of the property is hereby specifically stated by the shipper to be not exceeding \$ \_\_\_\_\_  
Per \_\_\_\_\_  
Signature of ShipperRECEIVED - Subject to the classification and liability filed tariffs in effect on the date of issue of this Bill of Lading, the property described above in apparent good order, except as noted hereon, and condition of contents under the contract agrees to carry to its usual place of delivery at said destination, it on its route, otherwise to deliver to another carrier on the route to said destination. It is mutually agreed as to each carrier of all or any of said property over all or any portion of said route to destination and as to each party at any time interested in all or any said property, that every service to be performed hereunder shall be subject to all the bill of lading terms and conditions in the governing classification on the date of shipment.  
Shipper hereby certifies that he is familiar with all the bill of lading terms and conditions in the governing classification and the said terms and conditions are hereby agreed to by the shipper and accepted for himself and his assigns.This is to certify that the above named materials are properly classified, described, packaged, marked and labeled and are in proper condition for transportation according to the applicable regulations of the Department of Transportation.  
Per El Paso Natural Gas  
PLACARDS REQUIREDN/A  
PLACARDS SUPPLIED ☐ YES ☒ NO - FURNISHED BY CARRIER  
DRIVER SIGNATURE: \_\_\_\_\_SHIPPER: EL PASO NATURAL GAS COMPANY  
PER: SANDRA MILLER  
DATE:CARRIER: El Paso  
PER: El Paso  
DATE: 11-29EMERGENCY RESPONSE (EL PASO NATURAL GAS (505) 599-2141  
TELEPHONE NUMBER: 505 326-3263 PHILLIP ENVIRONMENTAL  
MONITORED AT ALL TIMES THE HAZARDOUS MATERIAL IS IN TRANSPORTATION, INCLUDING STORAGE  
INCIDENTAL TO TRANSPORTATION (172 604)

CONTAINS HAZARDOUS MATERIALS

CONTAINS HAZARDOUS MATERIALS

CONTAINS HAZARDOUS MATERIALS

CONTAINS HAZARDOUS MATERIALS

# STRAIGHT BILL OF LADING

## ORIGINAL - NOT NEGOTIABLE

Shipper's No. \_\_\_\_\_

CARRIER: DOUG FOUTZ CONSTRUCTION (11957 - PITSSCAC)

Carrier's No. \_\_\_\_\_  
Date 1-28-95

TO: TIERRA ENVIRONMENTAL CORP.

Consignee  
909 WEST APACHE  
STREET  
FARMINGTON, NM 87409  
ZipFROM: EL PASO NATURAL GAS COMPANY 24324  
Shipper P.O. BOX 4990  
STREET  
FARMINGTON, NM 87499-4990  
Zip

Route: 304

Vehicle Number 132

Shipping Units	HM	Kind of Packages, Description of Articles (If HAZARDOUS MATERIALS - PROPER SHIPPING NAME)	HAZARD CLASS	I.D. Number	WEIGHT (subject to correction)	RATE	LABELS REQUIRED (or exemption)
1152	1	Tierra / Tierra Vista #1	BACKFILL	75718	10	YD.	N/A
1151	1	Tierra / Tierra Vista #1	BACKFILL	75718	10	YD.	N/A
1150	1	Tierra / Tierra Vista #1	BACKFILL	75718	10	YD.	N/A
1149	1	Tierra / Tierra Vista #1	BACKFILL	75718	10	YD.	N/A
1148	1	Tierra / Tierra Vista #1	BACKFILL	75718	10	YD.	N/A

Remit P.D. to:

Address: \_\_\_\_\_  
City: \_\_\_\_\_ State: \_\_\_\_\_ Zip: \_\_\_\_\_

COD Amt: \$

C.O.D. FEE:  
Prepaid ☒ Collect ☐ \$NOTE: Where the rate is dependent on value, shippers are required to state specifically in writing the agreed or declared value of the property. The agreed or declared value of the property is hereby specifically stated by the shipper to be not exceeding \$ \_\_\_\_\_  
Per \_\_\_\_\_  
Signature of ShipperRECEIVED: subject to the classification and lawfully filed tariffs in effect on the date of issue of this Bill of Lading, the property described above in apparent good order, except as noted (contents and condition of contents of packages unknown), marked, consigned, and destined as indicated above which said carrier (the word carrier being understood throughout this contract as meaning any person or corporation in possession of the property under the contract) agrees to carry to its usual place of delivery at said destination, if on its route, otherwise to deliver to another carrier on the route to said destination. It is mutually agreed as to each carrier of all or any of said property over all or any portion of said route to destination and as to each party at any time interested in all or any said property, that every service to be performed hereunder shall be subject to all the bill of lading terms and conditions in the governing classification on the date of shipment.  
Shipper hereby certifies that he is familiar with all the bill of lading terms and conditions in the governing classification and the said terms and conditions are hereby agreed to by the shipper and accepted for himself and his assigns.This is to certify that the above named materials are properly classified, described, marked, packed and loaded and are in proper condition for transportation according to the applicable regulations of the Department of Transportation.  
Per \_\_\_\_\_  
Signature of Shipper

PLACARDS REQUIRED

N/A

PLACARDS SUPPLIED

☐ YES ☒ NO - FURNISHED BY CARRIER  
DRIVER SIGNATURE: \_\_\_\_\_

SHIPPER: EL PASO NATURAL GAS COMPANY

PER: SANDRA MILLER DATE: \_\_\_\_\_

CARRIER: Doug Foutz

PER: Doug Foutz DATE: 1-28-95

EMERGENCY RESPONSE: EL PASO NATURAL GAS (505) 599-2141  
TELEPHONE NUMBER: (505) 326-2262 PHILIP ENVIRONMENTAL (172 604)

CONTAINS HAZARDOUS MATERIALS

CONTAINS HAZARDOUS MATERIALS

CONTAINS HAZARDOUS MATERIALS

# STRAIGHT BILL OF LADING

## ORIGINAL - NOT NEGOTIABLE

Shipper's No. \_\_\_\_\_

CARRIER: DOUG FOUTZ CONSTRUCTION (11967-PITS) SCAC

Carrier's No. \_\_\_\_\_  
Date 11-28-95

TO: TIERRA ENVIRONMENTAL CORP.

909 WEST APACHE

FARMINGTON, NM 87409

Consignee

FROM: EL PASO NATURAL GAS COMPANY 24324  
Shipper P.O. BOX 4990  
Street FARMINGTON, NM 87499-4990

Destination

Zip

Route: 10f410 1/2 hrs

Vehicle Number

132

CONTAINS HAZARDOUS MATERIALS

No. Shipping Units	HM (If Hazardous Materials - Proper Shipping Name)	Kind of Packages, Description of Articles	HAZARD CLASS	I.D. Number	WEIGHT (Subject to correction)	RATE	LABELS REQUIRED (or exemption)
152	EX	100 lb. Vials #1 / Tierra	EXEMPT HYDROCARBON CONTAMINATED SOIL	75718	10	YD.	N/A
153	EX	100 lb. Vials #1 / Tierra	EXEMPT HYDROCARBON CONTAMINATED SOIL	75718	10	YD.	N/A
154	EX	100 lb. Vials #1 / Tierra	EXEMPT HYDROCARBON CONTAMINATED SOIL	75718	10	YD.	N/A
155	EX	100 lb. Vials #1 / Tierra	EXEMPT HYDROCARBON CONTAMINATED SOIL	75718	10	YD.	N/A
156	EX	100 lb. Vials #1 / Tierra	EXEMPT HYDROCARBON CONTAMINATED SOIL	75718	10	YD.	N/A
157	EX	100 lb. Vials #1 / Tierra	EXEMPT HYDROCARBON CONTAMINATED SOIL	75718	10	YD.	N/A
158	EX	100 lb. Vials #1 / Tierra	EXEMPT HYDROCARBON CONTAMINATED SOIL	75718	10	YD.	N/A
159	EX	100 lb. Vials #1 / Tierra	EXEMPT HYDROCARBON CONTAMINATED SOIL	75718	10	YD.	N/A
160	EX	100 lb. Vials #1 / Tierra	EXEMPT HYDROCARBON CONTAMINATED SOIL	75718	10	YD.	N/A

Remit D.O.D. to:

Address:

City: \_\_\_\_\_ State: \_\_\_\_\_ Zip: \_\_\_\_\_

COD Amt: \$

C.O.D. FEE: Prepaid ☒ Collect ☐

NOTE: Where the rate is dependent on value, shippers are required to state specifically in writing the agreed or declared value of the property. The agreed or declared value of the property is hereby specifically stated by the shipper to be not exceeding \$ \_\_\_\_\_ Per \_\_\_\_\_

Subject to Section 7 of the Uniform Code of Sales, the shipper warrants that the property is as described in the bill of lading and is free from all liens, claims, and other legal claims.

FREIGHT CHARGES ☒ PREPAID ☐ COLLECT

RECEIVED: Subject to the classification and lawfully filed tariffs in effect on the date of issue of this Bill of Lading, the property described above in apparent good order, except as noted (contents and condition of contents of packages unknown), marked, consigned, and destined as indicated above which said carrier (the word carrier meaning any person or corporation in possession of the property under the contract) agrees to carry to its usual place of delivery at said destination, if on its route, otherwise to deliver to another carrier on the route to said destination. It is mutually agreed as to each carrier of all or any portion of the property that the carrier shall be responsible for the property while in its possession and shall be liable for any loss or damage to the property while in its possession. The shipper hereby certifies that he is familiar with all the bill of lading terms and conditions in the governing classification and the said terms and conditions are hereby agreed to by the shipper and accepted for himself and his assigns.

This is to certify that the above named materials are properly classified, described, packaged, marked and labeled and are in proper condition for transportation according to the applicable regulations of the Department of Transportation.

PLACARDS REQUIRED

N/A

PLACARDS SUPPLIED

☐ YES ☒ NO - FURNISHED BY CARRIER DRIVER SIGNATURE: \_\_\_\_\_

SHIPPER: EL PASO NATURAL GAS COMPANY

PER: SANDRA MILLER DATE: \_\_\_\_\_

CARRIER: Doug Foutz

PER: SE Galt DATE: 11-28-95

EMERGENCY RESPONSE: EL PASO NATURAL GAS (505) 599-2141

MONITORED AT ALL TIMES THE HAZARDOUS MATERIAL IS IN TRANSPORTATION, INCLUDING STORAGE

TELEPHONE NUMBER: 505 326-2262 PHILIP ENVIRONMENTAL

CONTAINS HAZARDOUS MATERIALS

CONTAINS HAZARDOUS MATERIALS

CONTAINS HAZARDOUS MATERIALS

# STRAIGHT BILL OF LADING

## ORIGINAL - NOT NEGOTIABLE

Shipper's No. \_\_\_\_\_

CARRIER: DOUG FOUTZ CONSTRUCTION (11957 - PITSSC/CAC)

Carrier's No. \_\_\_\_\_

Date 11/29/95
**TO:**  
 Consignee  
 Street  
 Destination

**FROM:** EL PASO NATURAL GAS COMPANY 24324  
 Shipper P.O. BOX 4990  
 Street FARMINGTON, NM 87499-4990  
 Origin Zip
Route: 3014Vehicle Number 131

No. Shipping Units	Kind of Packages, Description of Articles (If HAZARDOUS MATERIALS - PROPER SHIPPING NAME)	HAZARD CLASS	I.D. Number	WEIGHT (subject to correction)	RATE	LABELS REQUIRED (for exemption)
103	Tierra / Tierra Vista #1	BACKFILL	75718	10	YD.	N/A
103	Tierra / Tierra Vista #1	BACKFILL	75718	10	YD.	N/A
		BACKFILL			YD.	N/A
		BACKFILL			YD.	N/A
		BACKFILL			YD.	N/A

Remit C.O.D. to:

Address: \_\_\_\_\_ State: \_\_\_\_\_ Zip: \_\_\_\_\_

C.O.D. Amt: \$ 000C.O.D. FEE: Prepaid ☒ Collect ☐ \$ \_\_\_\_\_

NOTE - Where the rate is dependent on value, shippers are required to state specifically in writing the agreed or declared value of the property. The agreed or declared value of the property is hereby specifically stated by the shipper to be not exceeding \$ \_\_\_\_\_

Freight to be paid by the shipper at the time of delivery of the property at the destination. The shipper shall not be liable for any loss or damage to the property during transit.

FREIGHT CHARGES ☒ PREPAID ☐ COLLECT

RECEIVED, subject to the classifications and lawfully tied tariffs in effect on the date of issue of this Bill of Lading, the property described above in apparent good order, except as noted hereon, and condition of contents under the contract agrees to carry to its usual place of delivery at said destination, if on its route, otherwise to deliver to another carrier on the route to said destination, in accordance with the terms of the bill of lading terms and conditions in the governing classification on the date of shipment. Shipper hereby certifies that he is familiar with all the bill of lading terms and conditions in the governing classification and the said terms and conditions are hereby agreed to by the shipper and accepted for himself and his assigns.

This is to certify that the above named materials are property classified, described, packaged, marked and labeled and are in proper condition for transportation according to the applicable regulations of the Department of Transportation.

PLACARDS REQUIRED

N/A

PLACARDS SUPPLIED

☐ YES ☒ NO - FURNISHED BY CARRIER DRIVER SIGNATURE: \_\_\_\_\_

SHIPPER: EL PASO NATURAL GAS COMPANY

CARRIER: DFC

DATE: 11/29/95

PER: SANDRA MILLER DATE: \_\_\_\_\_

EMERGENCY RESPONSE (505) 589-2141 EL PASO NATURAL GAS (505) 589-2141 MONITORED AT ALL TIMES THE HAZARDOUS MATERIAL IS IN TRANSPORTATION, INCLUDING STORAGE

CONTAINS HAZARDOUS MATERIALS

CONTAINS HAZARDOUS MATERIALS

CONTAINS HAZARDOUS MATERIALS

CONTAINS HAZARDOUS MATERIALS

# STRAIGHT BILL OF LADING

ORIGINAL - NOT NEGOTIABLE

Shipper's No. \_\_\_\_\_

CARRIER: DOUG FOULTZ CONSTRUCTION (11957-PITS) SCAC

Carrier's No. 11/24/95  
Date

TO: TIERRA ENVIRONMENTAL CORP.  
909 WEST APACHE  
Street FARMINGTON, NM 87409  
Destination Zip

FROM: EL PASO NATURAL GAS COMPANY 24324  
Shipper P.O. BOX 4990  
Street FARMINGTON, NM 87499-4990  
Origin Zip

Route: 2 of 4Vehicle Number 139

No. Shipping Units	Kind of Packages, Description of Articles (If Hazardous Materials - Proper Shipping Name)	HAZARD CLASS	I.D. Number	WEIGHT (subject to correction)	RATE	LABELS REQUIRED (or exemption)
103	Removal of Terra	EXEMPT HYDROCARBON CONTAMINATED SOIL	75718	10	YD.	N/A
221	Floral Vista Terra	EXEMPT HYDROCARBON CONTAMINATED SOIL	75718	10	YD.	N/A
		EXEMPT HYDROCARBON CONTAMINATED SOIL			YD.	N/A
		EXEMPT HYDROCARBON CONTAMINATED SOIL			YD.	N/A
		EXEMPT HYDROCARBON CONTAMINATED SOIL			YD.	N/A

Remit C.O.D. to:

Address: \_\_\_\_\_  
City: \_\_\_\_\_ State: \_\_\_\_\_ Zip: \_\_\_\_\_

COD Amt: \$

C.O.D. FEE: Prepaid ☒ Collect ☐

NOTE: Where the rate is dependent on value, shippers are required to state specifically in writing the agreed or declared value of the property. The agreed or declared value of the property is hereby specifically stated by the shipper to be not exceeding \$ \_\_\_\_\_ Per \_\_\_\_\_

Subject to Section 7 of the conditions of this bill of lading, the shipper is to be delivered to the consignee without recourse on the bill of lading, and the consignee shall not be liable for the return of the bill of lading.

FREIGHT CHARGES ☒ PREPAID ☐ COLLECT

RECEIVED: subject to the classification and liability limit of this bill of lading, the shipper hereby agrees to deliver to the consignee, and the consignee shall not be liable for the return of the bill of lading, and the consignee shall not be liable for the return of the bill of lading.

This is to certify that the above named materials are properly classified, packaged, marked and labeled in accordance with the applicable regulations of the Department of Transportation. Per \_\_\_\_\_

SHIPPER: EL PASO NATURAL GAS COMPANY

PLACARDS REQUIRED

N/A

PLACARDS SUPPLIED

☐ YES ☒ NO - FURNISHED BY CARRIER DRIVER SIGNATURE: \_\_\_\_\_

PER: SANDRA MILLER DATE: \_\_\_\_\_

CARRIER: DFC

DATE: 11/22/95EMERGENCY RESPONSE: EL PASO NATURAL GAS (505) 599-2141  
TELEPHONE NUMBER: 505 326-2262 PHILIP ENVIRONMENTAL

MONITORED AT ALL TIMES THE HAZARDOUS MATERIAL IS IN TRANSPORTATION, INCLUDING STORAGE INCIDENTAL TO TRANSPORTATION (172.604)

CONTAINS HAZARDOUS MATERIALS

CONTAINS HAZARDOUS MATERIALS

---

---

**RECON®**

---

---



TITLE:  
FLORA VISTA NO. 1  
METER 75718

SCALE	AS NOTED	DATE	PROJECT NO:
DWN:	M.R.W.	11/29/95	13947
DES:			EPNG-RECON PITS
CHKD:	K.B.G.	12/4/95	
APPD:			

REV: 0  
FIGURE 24

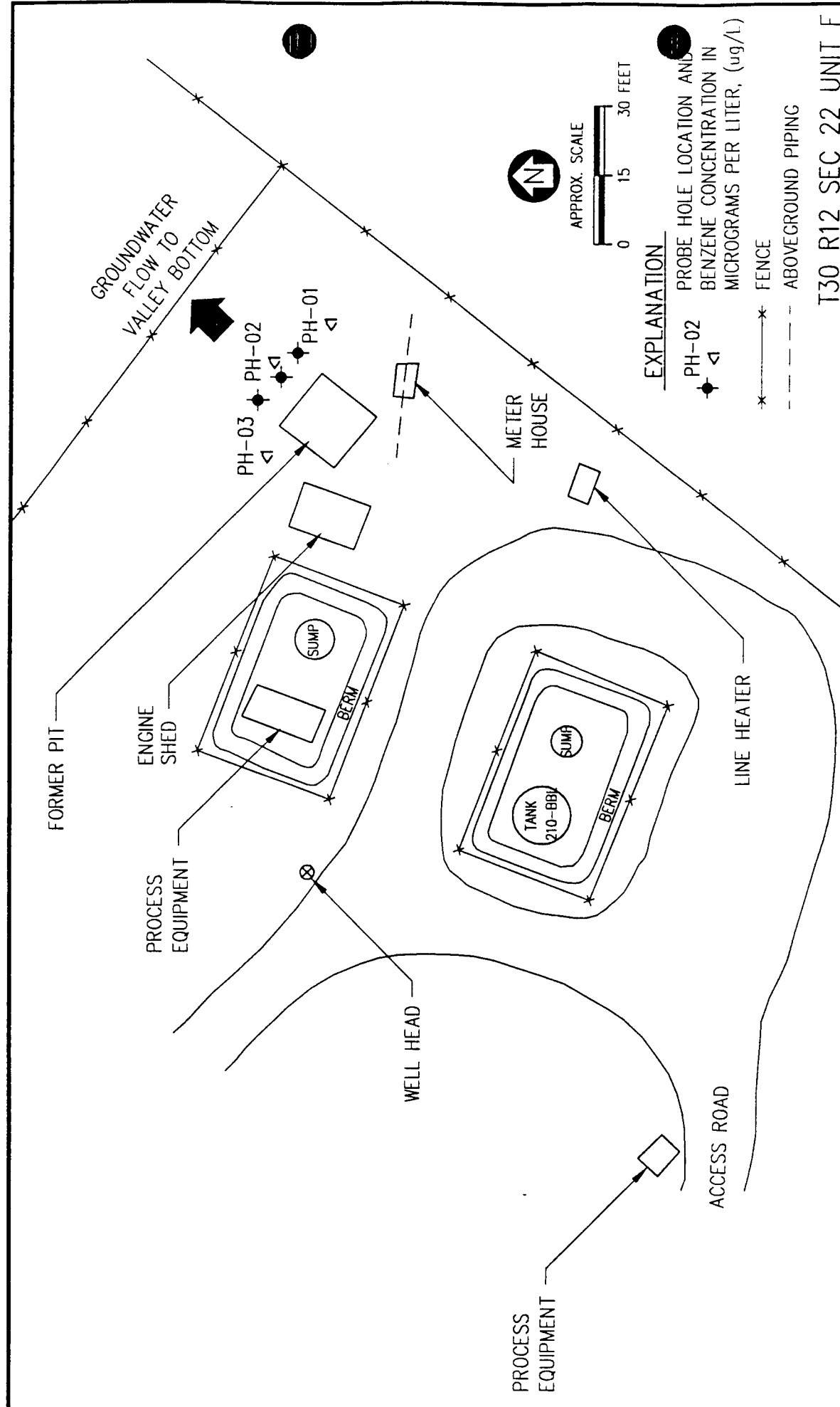

EXPLANATION

- PH-02 PROBE HOLE LOCATION AND BENZENE CONCENTRATION IN MICROGRAMS PER LITER, (ug/L)
- \*— FENCE
- - - ABOVEGROUND PIPING

T30 R12 SEC 22 UNIT F

## RECON SAMPLE ANALYSIS

### DATA SUMMARY TABLE

Project: 13947

Sample I.D.	Probe Hole Number	Depth (feet)	Benzene (ug/L)	Toluene (ug/L)	Ethyl benzene (ug/L)	m+p-Xylene (ug/L)	o-Xylene (ug/L)	Comments
L2C-22N03LD-03-D	PH-03	18-21	<1	5	1	6	2	QC - Duplicate
Blank-59	N/A	N/A	ND(1)	ND(1)	ND(1)	ND(1)	ND(1)	QC - System Blank
QCRT-23	N/A	N/A	203	211	208	207	207	QC - Retention Times
Blank-60	N/A	N/A	ND(1)	ND(1)	ND(1)	ND(1)	ND(1)	QC - System Blank
STD-1118	N/A	N/A	232	232	232	232	232	Calibration Standard
Blank-61	N/A	N/A	ND(1)	ND(1)	ND(1)	ND(1)	ND(1)	QC - System Blank
Blank-62	N/A	N/A	ND(1)	ND(1)	ND(1)	ND(1)	ND(1)	QC - System Blank
NICKELS#1DK-01	PH-01	12-15	2,406	2,159	134	1,122	313	QC - Probe Rod Blank
NICKELS#1DK-02	PH-02	12-15	2,521	196	232	1,638	481	Groundwater
NICKELS#1DK-03	PH-03	12-15	85	11	18	164	26	Groundwater
NICKELS#1DK-04	PH-04	12-15	<1	4	1	7	2	Groundwater
NICKELS#1DK-05	PH-05	12-15	<1	4	<1	3	1	Groundwater
NICKELS#1DK-05-D	PH-05	12-15	<1	4	<1	4	1	QC - Duplicate
Blank-63	N/A	N/A	ND(1)	ND(1)	ND(1)	ND(1)	ND(1)	QC - System Blank
QCRT-24	N/A	N/A	189	203	220	232	250	QC - Retention Times
Blank-64	N/A	N/A	ND(1)	ND(1)	ND(1)	ND(1)	ND(1)	QC - System Blank
STD-1120	N/A	N/A	232	232	232	232	232	Calibration Standard
Blank-65	N/A	N/A	ND(1)	ND(1)	ND(1)	ND(1)	ND(1)	QC - System Blank
Blank-66	N/A	N/A	ND(1)	ND(1)	ND(1)	ND(1)	ND(1)	QC - Probe Rod Blank
MACGRATH#1-01	PH-01	9	ND(1)	ND(1)	ND(1)	ND(1)	ND(1)	Soil-gas
MACGRATH#1-02	PH-02	9	ND(1)	ND(1)	ND(1)	ND(1)	ND(1)	Soil-gas
MACGRATH#1-03	PH-03	9	ND(1)	ND(1)	ND(1)	ND(1)	ND(1)	Soil-gas
FLORAVISTAFAT#01	PH-01	24-30	<1	1	<1	3	<1	Groundwater
FLORAVISTAFAT#02	PH-02	24-30	1	2	<1	2	<1	Groundwater
FLORAVISTAFAT#03	PH-03	24-30	<1	ND(1)	ND(1)	ND(1)	ND(1)	Groundwater
FLORAVISTAFAT#03D	PH-03	24-30	<1	ND(1)	ND(1)	ND(1)	ND(1)	QC - Duplicate
Blank-67	N/A	N/A	ND(1)	ND(1)	ND(1)	ND(1)	ND(1)	QC - System Blank
QCRT-25	N/A	N/A	190	189	175	169	160	QC - Retention Times

D = duplicate analysis.

QC = quality control.

ug/L = micrograms of compound detected per liter of soil or groundwater vapor analyzed.

ND = not detected at the lower quantifiable limit indicated in parenthesis.

N/A = not applicable.

QA Review:

*Paul G. Anderson*

Review Date:

1-31-96 EK 2/13/96