

District I
1625 N. French Dr., Hobbs, NM 88240
District II
811 S. First St., Artesia, NM 88210
District III
1000 Rio Brazos Road, Aztec, NM 87410
District IV
1220 S. St. Francis Dr., Santa Fe, NM 87505

State of New Mexico
Energy Minerals and Natural Resources
Department
Oil Conservation Division
1220 South St. Francis Dr.
Santa Fe, NM 87505

Form C-144
Revised June 6, 2013

For temporary pits, below-grade tanks, and multi-well fluid management pits, submit to the appropriate NMOCD District Office.
For permanent pits submit to the Santa Fe Environmental Bureau office and provide a copy to the appropriate NMOCD District Office.

Pit, Below-Grade Tank, or
Proposed Alternative Method Permit or Closure Plan Application

- Type of action: ☐ Below grade tank registration
☐ Permit of a pit or proposed alternative method
☒ Closure of a pit, below-grade tank, or proposed alternative method
☐ Modification to an existing permit/or registration
☐ Closure plan only submitted for an existing permitted or non-permitted pit, below-grade tank, or proposed alternative method

Instructions: Please submit one application (Form C-144) per individual pit, below-grade tank or alternative request

Please be advised that approval of this request does not relieve the operator of liability should operations result in pollution of surface water, ground water or the environment. Nor does approval relieve the operator of its responsibility to comply with any other applicable governmental authority's rules, regulations or ordinances.

1.	Operator: WHITING OIL & GAS CORPORATION OGRID #: 25078 Address: 400 W ILLINOIS STE 1300 MIDLAND, TEXAS 79701 Facility or well name: STATE 2028 36 WELL # 1 API Number: 30-021-20632 OCD Permit Number: 186172 U/L or Qtr/Qtr J Section 36 Township 20N Range 28E County: HARDING COUNTY Center of Proposed Design: Latitude 35.917536 Longitude -103.915078 NAD: <input checked="" type="checkbox"/> 1927 <input type="checkbox"/> 1983 Surface Owner: <input type="checkbox"/> Federal <input checked="" type="checkbox"/> State <input type="checkbox"/> Private <input type="checkbox"/> Tribal Trust or Indian Allotment	2015 APR 29 P 3:44 RECEIVED OGD
2.	<input checked="" type="checkbox"/> Pit: Subsection F, G or J of 19.15.17.11 NMAC Temporary: <input checked="" type="checkbox"/> Drilling <input type="checkbox"/> Workover <input type="checkbox"/> Permanent <input type="checkbox"/> Emergency <input type="checkbox"/> Cavitation <input type="checkbox"/> P&A <input type="checkbox"/> Multi-Well Fluid Management Low Chloride Drilling Fluid <input type="checkbox"/> yes <input type="checkbox"/> no <input type="checkbox"/> Lined <input type="checkbox"/> Unlined Liner type: Thickness _____ mil <input type="checkbox"/> LLDPE <input type="checkbox"/> HDPE <input type="checkbox"/> PVC <input type="checkbox"/> Other _____ <input type="checkbox"/> String-Reinforced Liner Seams: <input type="checkbox"/> Welded <input type="checkbox"/> Factory <input type="checkbox"/> Other _____ Volume: _____ bbl Dimensions: L _____ x W _____ x D _____	
3.	<input type="checkbox"/> Below-grade tank: Subsection I of 19.15.17.11 NMAC Volume: _____ bbl Type of fluid: _____ Tank Construction material: _____ <input type="checkbox"/> Secondary containment with leak detection <input type="checkbox"/> Visible sidewalls, liner, 6-inch lift and automatic overflow shut-off <input type="checkbox"/> Visible sidewalls and liner <input type="checkbox"/> Visible sidewalls only <input type="checkbox"/> Other _____ Liner type: Thickness _____ mil <input type="checkbox"/> HDPE <input type="checkbox"/> PVC <input type="checkbox"/> Other _____	
4.	<input type="checkbox"/> Alternative Method: Submittal of an exception request is required. Exceptions must be submitted to the Santa Fe Environmental Bureau office for consideration of approval.	
5.	Fencing: Subsection D of 19.15.17.11 NMAC (Applies to permanent pits, temporary pits, and below-grade tanks) <input type="checkbox"/> Chain link, six feet in height, two strands of barbed wire at top (Required if located within 1000 feet of a permanent residence, school, hospital, institution or church) <input type="checkbox"/> Four foot height, four strands of barbed wire evenly spaced between one and four feet <input type="checkbox"/> Alternate. Please specify _____	

6.

Netting: Subsection E of 19.15.17.11 NMAC (*Applies to permanent pits and permanent open top tanks*)

- ☐ Screen ☐ Netting ☐ Other _____
- ☐ Monthly inspections (If netting or screening is not physically feasible)

7.

Signs: Subsection C of 19.15.17.11 NMAC

- ☐ 12"x 24", 2" lettering, providing Operator's name, site location, and emergency telephone numbers
- ☐ Signed in compliance with 19.15.16.8 NMAC

8.

Variances and Exceptions:

Justifications and/or demonstrations of equivalency are required. Please refer to 19.15.17 NMAC for guidance.

Please check a box if one or more of the following is requested, if not leave blank:

- ☐ Variance(s): Requests must be submitted to the appropriate division district for consideration of approval.
- ☐ Exception(s): Requests must be submitted to the Santa Fe Environmental Bureau office for consideration of approval.

9.

Siting Criteria (regarding permitting): 19.15.17.10 NMAC

Instructions: The applicant must demonstrate compliance for each siting criteria below in the application. Recommendations of acceptable source material are provided below. Siting criteria does not apply to drying pads or above-grade tanks.

General siting

Ground water is less than 25 feet below the bottom of a low chloride temporary pit or below-grade tank.

- ☐ NM Office of the State Engineer - iWATERS database search; ☐ USGS; ☐ Data obtained from nearby wells

☐ Yes ☐ No
☐ NA

Ground water is less than 50 feet below the bottom of a Temporary pit, permanent pit, or Multi-Well Fluid Management pit.

NM Office of the State Engineer - iWATERS database search; USGS; Data obtained from nearby wells

☐ Yes ☐ No
☐ NA

Within incorporated municipal boundaries or within a defined municipal fresh water well field covered under a municipal ordinance adopted pursuant to NMSA 1978, Section 3-27-3, as amended. **(Does not apply to below grade tanks)**

- Written confirmation or verification from the municipality; Written approval obtained from the municipality

☐ Yes ☐ No

Within the area overlying a subsurface mine. **(Does not apply to below grade tanks)**

- Written confirmation or verification or map from the NM EMNRD-Mining and Mineral Division

☐ Yes ☐ No

Within an unstable area. **(Does not apply to below grade tanks)**

- Engineering measures incorporated into the design; NM Bureau of Geology & Mineral Resources; USGS; NM Geological Society; Topographic map

☐ Yes ☐ No

Within a 100-year floodplain. **(Does not apply to below grade tanks)**

- FEMA map

☐ Yes ☐ No

Below Grade Tanks

Within 100 feet of a continuously flowing watercourse, significant watercourse, lake bed, sinkhole, wetland or playa lake (measured from the ordinary high-water mark).

- Topographic map; Visual inspection (certification) of the proposed site

☐ Yes ☐ No

Within 200 horizontal feet of a spring or a fresh water well used for public or livestock consumption;

- NM Office of the State Engineer - iWATERS database search; Visual inspection (certification) of the proposed site

☐ Yes ☐ No

Temporary Pit using Low Chloride Drilling Fluid (maximum chloride content 15,000 mg/liter)

Within 100 feet of a continuously flowing watercourse, or any other significant watercourse or within 200 feet of any lakebed, sinkhole, or playa lake (measured from the ordinary high-water mark). (Applies to low chloride temporary pits.)

- Topographic map; Visual inspection (certification) of the proposed site

☐ Yes ☐ No

Within 300 feet from a occupied permanent residence, school, hospital, institution, or church in existence at the time of initial application.

- Visual inspection (certification) of the proposed site; Aerial photo; Satellite image

☐ Yes ☐ No

Within 200 horizontal feet of a spring or a private, domestic fresh water well used by less than five households for domestic or stock watering purposes, or 300feet of any other fresh water well or spring, in existence at the time of the initial application.

NM Office of the State Engineer - iWATERS database search; Visual inspection (certification) of the proposed site

☐ Yes ☐ No

Within 100 feet of a wetland.

- US Fish and Wildlife Wetland Identification map; Topographic map; Visual inspection (certification) of the proposed site

☐ Yes ☐ No

Temporary Pit Non-low chloride drilling fluid

Within 300 feet of a continuously flowing watercourse, or any other significant watercourse, or within 200 feet of any lakebed, sinkhole, or playa lake (measured from the ordinary high-water mark).

- Topographic map; Visual inspection (certification) of the proposed site

☐ Yes ☐ No

Within 300 feet from a permanent residence, school, hospital, institution, or church in existence at the time of initial application.

- Visual inspection (certification) of the proposed site; Aerial photo; Satellite image

☐ Yes ☐ No

Within 500 horizontal feet of a spring or a private, domestic fresh water well used by less than five households for domestic or stock watering purposes, or 1000 feet of any other fresh water well or spring, in the existence at the time of the initial application;

- NM Office of the State Engineer - iWATERS database search; Visual inspection (certification) of the proposed site

☐ Yes ☐ No

Within 300 feet of a wetland.

- US Fish and Wildlife Wetland Identification map; Topographic map; Visual inspection (certification) of the proposed site

☐ Yes ☐ No

Permanent Pit or Multi-Well Fluid Management Pit

Within 300 feet of a continuously flowing watercourse, or 200 feet of any other significant watercourse, or lakebed, sinkhole, or playa lake (measured from the ordinary high-water mark).

- Topographic map; Visual inspection (certification) of the proposed site

☐ Yes ☐ No

Within 1000 feet from a permanent residence, school, hospital, institution, or church in existence at the time of initial application.

- Visual inspection (certification) of the proposed site; Aerial photo; Satellite image

☐ Yes ☐ No

Within 500 horizontal feet of a spring or a fresh water well used for domestic or stock watering purposes, in existence at the time of initial application.

- NM Office of the State Engineer - iWATERS database search; Visual inspection (certification) of the proposed site

☐ Yes ☐ No

Within 500 feet of a wetland.

- US Fish and Wildlife Wetland Identification map; Topographic map; Visual inspection (certification) of the proposed site

☐ Yes ☐ No

10.

Temporary Pits, Emergency Pits, and Below-grade Tanks Permit Application Attachment Checklist: Subsection B of 19.15.17.9 NMAC

Instructions: Each of the following items must be attached to the application. Please indicate, by a check mark in the box, that the documents are attached.

- ☐ Hydrogeologic Report (Below-grade Tanks) - based upon the requirements of Paragraph (4) of Subsection B of 19.15.17.9 NMAC
- ☐ Hydrogeologic Data (Temporary and Emergency Pits) - based upon the requirements of Paragraph (2) of Subsection B of 19.15.17.9 NMAC
- ☐ Siting Criteria Compliance Demonstrations - based upon the appropriate requirements of 19.15.17.10 NMAC
- ☐ Design Plan - based upon the appropriate requirements of 19.15.17.11 NMAC
- ☐ Operating and Maintenance Plan - based upon the appropriate requirements of 19.15.17.12 NMAC
- ☐ Closure Plan (Please complete Boxes 14 through 18, if applicable) - based upon the appropriate requirements of Subsection C of 19.15.17.9 NMAC and 19.15.17.13 NMAC

☐ Previously Approved Design (attach copy of design) API Number: _____ or Permit Number: _____

11.

Multi-Well Fluid Management Pit Checklist: Subsection B of 19.15.17.9 NMAC

Instructions: Each of the following items must be attached to the application. Please indicate, by a check mark in the box, that the documents are attached.

- ☐ Design Plan - based upon the appropriate requirements of 19.15.17.11 NMAC
- ☐ Operating and Maintenance Plan - based upon the appropriate requirements of 19.15.17.12 NMAC
- ☐ A List of wells with approved application for permit to drill associated with the pit.
- ☐ Closure Plan (Please complete Boxes 14 through 18, if applicable) - based upon the appropriate requirements of Subsection C of 19.15.17.9 NMAC and 19.15.17.13 NMAC
- ☐ Hydrogeologic Data - based upon the requirements of Paragraph (4) of Subsection B of 19.15.17.9 NMAC
- ☐ Siting Criteria Compliance Demonstrations - based upon the appropriate requirements of 19.15.17.10 NMAC

☐ Previously Approved Design (attach copy of design) API Number: _____ or Permit Number: _____

12.

Permanent Pits Permit Application Checklist: Subsection B of 19.15.17.9 NMAC

Instructions: Each of the following items must be attached to the application. Please indicate, by a check mark in the box, that the documents are attached.

- ☐ Hydrogeologic Report - based upon the requirements of Paragraph (I) of Subsection B of 19.15.17.9 NMAC
☐ Siting Criteria Compliance Demonstrations - based upon the appropriate requirements of 19.15.17.10 NMAC
☐ Climatological Factors Assessment
☐ Certified Engineering Design Plans - based upon the appropriate requirements of 19.15.17.11 NMAC
☐ Dike Protection and Structural Integrity Design - based upon the appropriate requirements of 19.15.17.11 NMAC
☐ Leak Detection Design - based upon the appropriate requirements of 19.15.17.11 NMAC
☐ Liner Specifications and Compatibility Assessment - based upon the appropriate requirements of 19.15.17.11 NMAC
☐ Quality Control/Quality Assurance Construction and Installation Plan
☐ Operating and Maintenance Plan - based upon the appropriate requirements of 19.15.17.12 NMAC
☐ Freeboard and Overtopping Prevention Plan - based upon the appropriate requirements of 19.15.17.11 NMAC
☐ Nuisance or Hazardous Odors, including H₂S, Prevention Plan
☐ Emergency Response Plan
☐ Oil Field Waste Stream Characterization
☐ Monitoring and Inspection Plan
☐ Erosion Control Plan
☐ Closure Plan - based upon the appropriate requirements of Subsection C of 19.15.17.9 NMAC and 19.15.17.13 NMAC

13.

Proposed Closure: 19.15.17.13 NMAC

Instructions: Please complete the applicable boxes, Boxes 14 through 18, in regards to the proposed closure plan.

Type: ☐ Drilling ☐ Workover ☐ Emergency ☐ Cavitation ☐ P&A ☐ Permanent Pit ☐ Below-grade Tank ☐ Multi-well Fluid Management Pit
☐ Alternative

Proposed Closure Method: ☐ Waste Excavation and Removal
☐ Waste Removal (Closed-loop systems only)
☐ On-site Closure Method (Only for temporary pits and closed-loop systems)
☐ In-place Burial ☐ On-site Trench Burial
☐ Alternative Closure Method

14.

Waste Excavation and Removal Closure Plan Checklist: (19.15.17.13 NMAC) **Instructions:** Each of the following items must be attached to the closure plan. Please indicate, by a check mark in the box, that the documents are attached.

- ☐ Protocols and Procedures - based upon the appropriate requirements of 19.15.17.13 NMAC
☐ Confirmation Sampling Plan (if applicable) - based upon the appropriate requirements of Subsection C of 19.15.17.13 NMAC
☐ Disposal Facility Name and Permit Number (for liquids, drilling fluids and drill cuttings)
☐ Soil Backfill and Cover Design Specifications - based upon the appropriate requirements of Subsection H of 19.15.17.13 NMAC
☐ Re-vegetation Plan - based upon the appropriate requirements of Subsection H of 19.15.17.13 NMAC
☐ Site Reclamation Plan - based upon the appropriate requirements of Subsection H of 19.15.17.13 NMAC

15.

Siting Criteria (regarding on-site closure methods only): 19.15.17.10 NMAC

Instructions: Each siting criteria requires a demonstration of compliance in the closure plan. Recommendations of acceptable source material are provided below. Requests regarding changes to certain siting criteria require justifications and/or demonstrations of equivalency. Please refer to 19.15.17.10 NMAC for guidance.

Ground water is less than 25 feet below the bottom of the buried waste. - NM Office of the State Engineer - iWATERS database search; USGS; Data obtained from nearby wells	<input type="checkbox"/> Yes <input type="checkbox"/> No <input type="checkbox"/> NA
Ground water is between 25-50 feet below the bottom of the buried waste - NM Office of the State Engineer - iWATERS database search; USGS; Data obtained from nearby wells	<input type="checkbox"/> Yes <input type="checkbox"/> No <input type="checkbox"/> NA
Ground water is more than 100 feet below the bottom of the buried waste. - NM Office of the State Engineer - iWATERS database search; USGS; Data obtained from nearby wells	<input type="checkbox"/> Yes <input type="checkbox"/> No <input type="checkbox"/> NA
Within 100 feet of a continuously flowing watercourse, or 200 feet of any other significant watercourse, lakebed, sinkhole, or playa lake (measured from the ordinary high-water mark). - Topographic map; Visual inspection (certification) of the proposed site	<input type="checkbox"/> Yes <input type="checkbox"/> No
Within 300 feet from a permanent residence, school, hospital, institution, or church in existence at the time of initial application. - Visual inspection (certification) of the proposed site; Aerial photo; Satellite image	<input type="checkbox"/> Yes <input type="checkbox"/> No
Within 300 horizontal feet of a private, domestic fresh water well or spring used for domestic or stock watering purposes, in existence at the time of initial application. - NM Office of the State Engineer - iWATERS database; Visual inspection (certification) of the proposed site	<input type="checkbox"/> Yes <input type="checkbox"/> No
Written confirmation or verification from the municipality; Written approval obtained from the municipality	<input type="checkbox"/> Yes <input type="checkbox"/> No
Within 300 feet of a wetland. US Fish and Wildlife Wetland Identification map; Topographic map; Visual inspection (certification) of the proposed site	<input type="checkbox"/> Yes <input type="checkbox"/> No
Within incorporated municipal boundaries or within a defined municipal fresh water well field covered under a municipal ordinance	

adopted pursuant to NMSA 1978, Section 3-27-3, as amended. - Written confirmation or verification from the municipality; Written approval obtained from the municipality	<input type="checkbox"/> Yes <input type="checkbox"/> No
Within the area overlying a subsurface mine. - Written confirmation or verification or map from the NM EMNRD-Mining and Mineral Division	<input type="checkbox"/> Yes <input type="checkbox"/> No
Within an unstable area. - Engineering measures incorporated into the design; NM Bureau of Geology & Mineral Resources; USGS; NM Geological Society; Topographic map	<input type="checkbox"/> Yes <input type="checkbox"/> No
Within a 100-year floodplain. - FEMA map	<input type="checkbox"/> Yes <input type="checkbox"/> No

16.
On-Site Closure Plan Checklist: (19.15.17.13 NMAC) *Instructions: Each of the following items must be attached to the closure plan. Please indicate, by a check mark in the box, that the documents are attached.*

☐ Siting Criteria Compliance Demonstrations - based upon the appropriate requirements of 19.15.17.10 NMAC
☐ Proof of Surface Owner Notice - based upon the appropriate requirements of Subsection E of 19.15.17.13 NMAC
☐ Construction/Design Plan of Burial Trench (if applicable) based upon the appropriate requirements of Subsection K of 19.15.17.11 NMAC
☐ Construction/Design Plan of Temporary Pit (for in-place burial of a drying pad) - based upon the appropriate requirements of 19.15.17.11 NMAC
☐ Protocols and Procedures - based upon the appropriate requirements of 19.15.17.13 NMAC
☐ Confirmation Sampling Plan (if applicable) - based upon the appropriate requirements of 19.15.17.13 NMAC
☐ Waste Material Sampling Plan - based upon the appropriate requirements of 19.15.17.13 NMAC
☐ Disposal Facility Name and Permit Number (for liquids, drilling fluids and drill cuttings or in case on-site closure standards cannot be achieved)
☐ Soil Cover Design - based upon the appropriate requirements of Subsection H of 19.15.17.13 NMAC
☐ Re-vegetation Plan - based upon the appropriate requirements of Subsection H of 19.15.17.13 NMAC
☐ Site Reclamation Plan - based upon the appropriate requirements of Subsection H of 19.15.17.13 NMAC

17.
Operator Application Certification:
 I hereby certify that the information submitted with this application is true, accurate and complete to the best of my knowledge and belief.

Name (Print): _____ Title: _____
 Signature: _____ Date: _____
 e-mail address: _____ Telephone: _____

18.
OCD Approval: ☐ Permit Application (including closure plan) ☒ Closure Plan (only) ☐ OCD Conditions (see attachment)

OCD Representative Signature: [Signature] Approval Date: 05/05/15
 Title: Environmental Engineer OCD Permit Number: _____

19.
Closure Report (required within 60 days of closure completion): 19.15.17.13 NMAC
Instructions: Operators are required to obtain an approved closure plan prior to implementing any closure activities and submitting the closure report. The closure report is required to be submitted to the division within 60 days of the completion of the closure activities. Please do not complete this section of the form until an approved closure plan has been obtained and the closure activities have been completed.

☒ Closure Completion Date: 04/08/2015

20.
Closure Method:
☐ Waste Excavation and Removal ☒ On-Site Closure Method ☐ Alternative Closure Method ☐ Waste Removal (Closed-loop systems only)
☐ If different from approved plan, please explain.

21.
Closure Report Attachment Checklist: *Instructions: Each of the following items must be attached to the closure report. Please indicate, by a check mark in the box, that the documents are attached.*

☒ Proof of Closure Notice (surface owner and division)
☒ Proof of Deed Notice (required for on-site closure for private land only)
☒ Plot Plan (for on-site closures and temporary pits)
☒ Confirmation Sampling Analytical Results (if applicable)
☒ Waste Material Sampling Analytical Results (required for on-site closure)
☐ Disposal Facility Name and Permit Number
☒ Soil Backfilling and Cover Installation
☒ Re-vegetation Application Rates and Seeding Technique
☒ Site Reclamation (Photo Documentation)
 On-site Closure Location: Latitude 35.917536 Longitude -103.915078 NAD: ☒ 1927 ☐ 1983

Operator Closure Certification:

I hereby certify that the information and attachments submitted with this closure report is true, accurate and complete to the best of my knowledge and belief. I also certify that the closure complies with all applicable closure requirements and conditions specified in the approved closure plan.

Name (Print): KAY MADDOX Title: REGULATORY SUPERVISOR

Signature:  Date: 04/24/2015

e-mail address: KAY.MADDOX@WHITING.COM Telephone: 432.686.6709

**WHITING OIL AND GAS CORPORATION
PIT CLOSURE REPORT**

STATE 2028 36 Well #1
API NO 30-021-20632

- 1) The pit will be closed within six (6) months from the date that the drilling or workover rig is released. If necessary, the division district office may grant an extension not to exceed three (3) months.

**The Drlg rig was released 07/04/2014 after drilling this well
Closure extension granted 1/15/2015**

- 2) Surface Owners will be notified by Certified mail at least 72 hours but not more than one week prior to closure of the Temporary pit. The notice shall include well name, API number and location.

Reference attached notification- notified State

- 3) The Appropriate Division District Office (OCD) will be notified verbally and in writing at least 72 hours but not more than one week prior to closure of the Temporary pit. The notice shall include well name, API number and location.

NMOCD was notified via email – reference attached copy of email

- 4) If on site burial is on PRIVATE LAND, Whiting will file a deed notice identifying the exact location of the onsite burial with the county clerk in county where onsite burial occurs

Certified Recorded Deed Notice attached even though State well

- 5) All liquids from the pit will be removed prior to closure. Liquids will be disposed of at the Sundance Services, Inc. Parabo Disposal Facility (Permit No. 010003), unless they are recycled, reused, or reclaimed in a division district office-approved manner.

Liquids from pit evaporated, no removal was required.

- 6) The pit will be stabilized with clean non-waste containing earthen material with a ratio no more than 3:1

Pit was stabilized with non-waste containing earthen material in order to achieve the solidification process. The solidification process was accomplished by using a combination of natural drying and Mechanically mixing. Pit contents were mixed with non-waste, earthen material to a consistency that is deemed safe and stable. The mixing ratio consisted of approximately 3 parts clean soil to 1 part pit contents.

- 7) After stabilization, the contents of the pit will be tested to determine whether concentrations are below standards. A five-point composite sample will be collected. The samples will be sent to an approved laboratory and analyzed for benzene, total BTEX, TPH, the GRO and DRO combined fraction, and chlorides. Assuming water could be encountered around 100', the following should not be exceeded:

- Chlorides (ads determined by EPA method 300.1): 40,000 mg/kg or background concentration, whichever is greater
- TPH (EPA SW-846 method 418.a or other division-approved EPA method): 2500 mg/kg.
- GRO and DRO combined fraction (EPA SW-846 method 8015M): 1000 mg/kg.
- BTEX (EPA SW-846 method 8021B or 8260B or other approved EPA method): 50 mg/kg

- Benzene (EPA SW-846 method 8021B or 8260B or other approved EPA method): 10 mg/kg

A five point composite sample was taken of the pit using sample tools and all samples tested per Subsection B of 19.15.17.1 3(B)(1)(b) results attached.

- 8) If the contents are above the concentration limits after stabilization Whiting will comply with 19.15.17.13.C (Waste Excavation and Removal)

Not necessary

- 9) If it is determined that contents of the pit doesn't exceed the above-specified concentrations, the pit will be covered with compacted, non-waste-containing, earthen material. A division-prescribed soil cover will be constructed and the site will be re-contoured and re-vegetated, per Subsections D, E, F, G, H, of 19.15.17.13 NMAC

The pit material passed solidification and testing standards. The pit area was then back filled with compacted, non-waste containing earthen material.

- 10) All areas associated with the pit that are no longer being used will be substantially restored to the condition that existed prior to oil and gas operations by placement of the soil cover re-contouring to match original contours and surrounding topography, and re-vegetating.

This was done – please see attached pictures

- 11) If an alternative to the re-vegetation requirements is required to prevent erosion, protect fresh water, or protect human health and the environment, this alternative will be proposed to the surface owner. The proposed alternative, with written documentation demonstrating that the surface owner approves the alternative, will be submitted to the division for approval.

No alternative is required

- 12) Soil cover will consist of 4' of non-waste containing earthen material with chloride concentrations less than 600mg/KG including 1' of topsoil

Four feet of non-waste earthen cover was achieved including one foot of suitable material to establish vegetation.

- 13) All contents, including synthetic pit liners, will be buried in place. By folding outer edges of the pit liner to overlap waste material, and then installing a geomembrane liner cover that is 20 mil string reinforced LLDPE, synthetic material, impervious, resistant to ultra violet light, petroleum hydrocarbons, salts, acid and alkaline.

These was done including placing a 20 mil LLDPE liner cover

- 14) Soil cover will be constructed to the site's existing grade and will prevent ponding of water and erosion of the cover material.

This was done – reference attached photos

- 15) The first favorable growing season following pit closure, all disturbed areas associated with the pit and no longer being used will be seeded or planted.

This area will be re-seeded during the next growing season in this area – reference attached letter

- 16) Seeding will be accomplished by drilling on the contour whenever practical, or by other division-approved methods. Vegetative cover will be considered complete when there is a life form ratio of +/- 50% of pre-disturbance levels with at least 70% total plant cover of pre-disturbance level (Excluding Noxious Weeds) OR in accordance to 19.15.17.13.H.5.d

This will be done during the next growing season in this area

- 17) Seeding or planting will be repeated until the required vegetative cover is successfully achieved.

Whiting will comply

- 18) When conditions aren't favorable for the establishment of vegetation (such as during periods of drought), the division will be contacted for approval to delay seeding or planting, or for approval to use additional cultural techniques such as mulching, fertilizing, irrigating, fencing, etc.

Attached letter

- 19) The division will be notified when seeding or planting is completed, and when successful re-vegetation has been achieved.

Whiting will comply

- 20) Place a steel marker at the center of the onsite burial. The marker shall be 4" diameter, at least 4' high and cemented 3' deep. The following will be welded, stamped or otherwise permanently engraved into the marker; operator name, lease name, well number and location, unit letter, section, township, range, and that the marker designates an onsite burial

Reference attached pictures

- 21) Within 60 days of closure, completion, a closure report will be submitted on form C-144, with necessary attachments, to document closure activities, including sampling results, a plot plan, and backfilling details. In this closure report, Whiting will certify that all information in the report and attachments is correct and that Whiting has complied with all applicable closure requirements and conditions specified in the approved Closure Plan. A plat of the temporary pit location will be provided on form C-105.

Kay Maddox

From: Kay Maddox
Sent: Friday, April 03, 2015 11:01 AM
To: Lowe, Leonard, EMNRD (Leonard.Lowe@state.nm.us); Martin, Ed (emartin@slo.state.nm.us)
Cc: Danny Holcomb (djhcomb75@gmail.com); Robert McNaughton
Subject: Pit Closure Notification

Whiting will be closing the temporary pit associated with this well:

State 2028 36 Well # 1
30-021-20632
Section 36, T20N, R28E, UNIT LTTR J
1660 FSL & 1749 FEL
HARDING COUNTY , NM

WILL CLOSE PIT AROUND/ON APRIL 8, 2015

Kay Maddox
Regulatory Supervisor
Whiting Petroleum Corporation
and its wholly owned subsidiary
Whiting Oil and Gas Corporation
400 West Illinois Avenue, Suite 1300
Midland, TX 79701
Direct (432) 686-6709
Cell (432) 638-8475
kay.maddox@whiting.com
www.whiting.com

The information contained in this message may be privileged and confidential and protected from disclosure. If the reader of this message is not the intended recipient, you are hereby notified that any dissemination, distribution or copying of this communication is strictly prohibited. If you have received this communication in error, please notify us immediately by replying to this message and deleting it from your computer.

STATE OF NEW MEXICO

COUNTY OF HARDING

NOTICE OF PIT CLOSURE

In accordance with Section 19.15.17.13.E.4 of the NMOCD , the operator hereby provides notice of an on-site burial of a temporary Oil & Gas drilling pit. All rules and regulations of Rule 19.15.17 have been adhered to.

Lease name: STATE 2028 36
Well No: 1
API No: 30-021-20632
TWN & RGE: TWN 20N RGE 28E Section 36
Unit Letter: J
Footages: 1660 FSL & 1749 FEL
Date of Closure: 04/08/2015

IN WITNESS WHEREOF, the recordation notice of Pit Closure/burial has been executed on the date indicated below by undersigned.

Whiting Petroleum Corporation
And its wholly owned subsidiary
Whiting Oil & Gas Corporation



Kay Maddox - Regulatory Supervisor

STATE OF TEXAS
COUNTY OF MIDLAND

This instrument was acknowledged before me this 13TH day of APRIL, 2015, by

Kay Maddox on behalf of Whiting Oil & Gas Corporation.

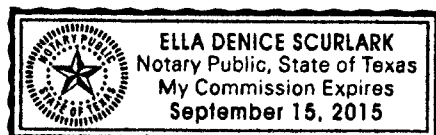

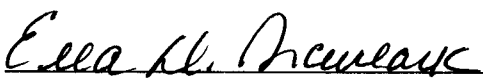

Notary Public

HARDING COUNTY, NM
RECEPTION# 21035
04/22/2015 09:33:33 AM
BK 19 PAGE 11361
1 of 1
BY CJ GARRISON, DEPUTY

Pit Location

Whiting Petroleum Corporation

State 2028 #36-1

T-20-N, R-28E, Section 36 NMPM

Harding County, New Mexico

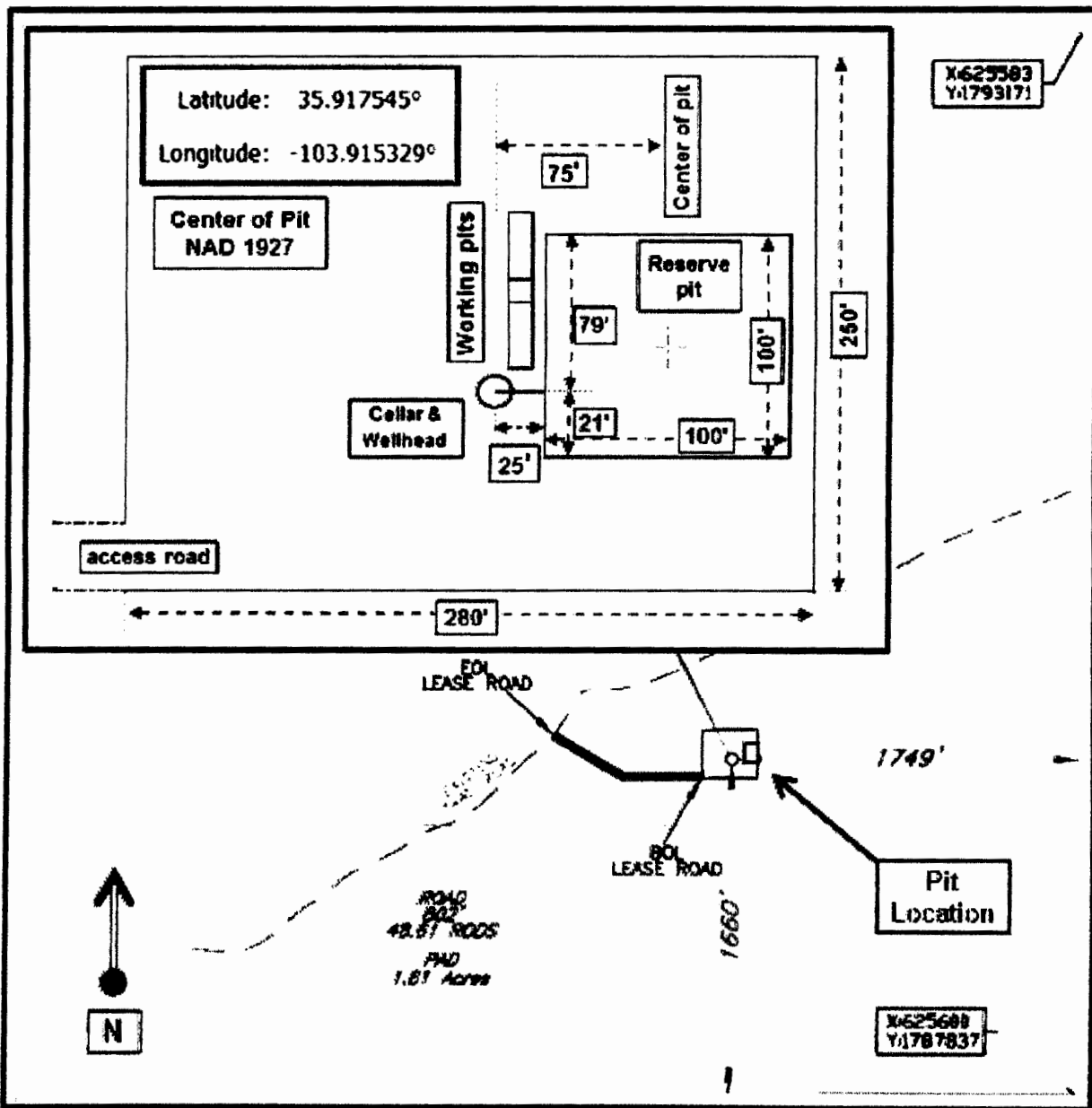

State 2028 36 # 1



PHONE (575) 393-2326 ° 101 E. MARLAND ° HOBBS, NM 88240

November 21, 2014

DANNY HOLCOMB

WHITING OIL & GAS

400 W. ILLINOIS, SUITE 1300

MIDLAND, TX 79701

RE: WEST BRAVO DOME

Enclosed are the results of analyses for samples received by the laboratory on 11/14/14 8:00.

Cardinal Laboratories is accredited through Texas NELAP under certificate number T104704398-13-5. Accreditation applies to drinking water, non-potable water and solid and chemical materials. All accredited analytes are denoted by an asterisk (*). For a complete list of accredited analytes and matrices visit the TCEQ website at www.tceq.texas.gov/field/qa/lab_accred_certif.html.

Cardinal Laboratories is accredited through the State of Colorado Department of Public Health and Environment for:

Method EPA 552.2	Haloacetic Acids (HAA-5)
Method EPA 524.2	Total Trihalomethanes (TTHM)
Method EPA 524.4	Regulated VOCs (V1, V2, V3)

Accreditation applies to public drinking water matrices.

This report meets NELAP requirements and is made up of a cover page, analytical results, and a copy of the original chain-of-custody. If you have any questions concerning this report, please feel free to contact me.

Sincerely,

A handwritten signature in black ink that reads "Celey D. Keene". The signature is written in a cursive, flowing style.

Celey D. Keene

Lab Director/Quality Manager

Analytical Results For:

 WHITING OIL & GAS
 DANNY HOLCOMB
 400 W. ILLINOIS, SUITE 1300
 MIDLAND TX, 79701
 Fax To: NONE

 Received: 11/14/2014
 Reported: 11/21/2014
 Project Name: WEST BRAVO DOME
 Project Number: NONE GIVEN
 Project Location: HARDING COUNTY NM

 Sampling Date: 11/12/2014
 Sampling Type: Soil
 Sampling Condition: Cool & Intact
 Sample Received By: Jodi Henson

Sample ID: DAHL 1927 #121 (H403505-01)

BTEX 8021B		mg/kg		Analyzed By: ms					
Analyte	Result	Reporting Limit	Analyzed	Method Blank	BS	% Recovery	True Value QC	RPD	Qualifier
Benzene*	<0.050	0.050	11/17/2014	ND	1.83	91.4	2.00	8.21	
Toluene*	<0.050	0.050	11/17/2014	ND	1.76	88.2	2.00	6.70	
Ethylbenzene*	<0.050	0.050	11/17/2014	ND	1.75	87.4	2.00	6.66	
Total Xylenes*	<0.150	0.150	11/17/2014	ND	5.27	87.9	6.00	6.78	
Total BTEX	<0.300	0.300	11/17/2014	ND					

Surrogate: 4-Bromofluorobenzene (PIL) 101 % 61-154

Chloride, SM4500Cl-B		mg/kg		Analyzed By: AP					
Analyte	Result	Reporting Limit	Analyzed	Method Blank	BS	% Recovery	True Value QC	RPD	Qualifier
Chloride	<16.0	16.0	11/14/2014	ND	400	100	400	0.00	

TPH 418.1		mg/kg		Analyzed By: CK					
Analyte	Result	Reporting Limit	Analyzed	Method Blank	BS	% Recovery	True Value QC	RPD	Qualifier
TPH 418.1	915	100	11/21/2014	ND	5570	111	5000	1.97	

TPH 8015M		mg/kg		Analyzed By: ms					
Analyte	Result	Reporting Limit	Analyzed	Method Blank	BS	% Recovery	True Value QC	RPD	Qualifier
GRO C6-C10	<10.0	10.0	11/15/2014	ND	187	93.7	200	3.04	
DRO >C10-C28	24.6	10.0	11/15/2014	ND	191	95.6	200	4.30	

Surrogate: 1-Chlorooctane 126 % 47.2-157

Surrogate: 1-Chlorooctadecane 136 % 52.1-176

Cardinal Laboratories

*=Accredited Analyte

PLEASE NOTE: Liability and Damages. Cardinal's liability and client's exclusive remedy for any claim arising, whether based in contract or tort, shall be limited to the amount paid by client for analyses. All claims, including those for negligence and any other cause whatsoever shall be deemed waived unless made in writing and received by Cardinal within thirty (30) days after completion of the applicable service. In no event shall Cardinal be liable for incidental or consequential damages, including, without limitation, business interruptions, loss of use, or loss of profits incurred by client, its subsidiaries, affiliates or successors arising out of or related to the performance of the services hereunder by Cardinal, regardless of whether such claim is based upon any of the above stated reasons or otherwise. Results relate only to the samples identified above. This report shall not be reproduced except in full with written approval of Cardinal Laboratories.

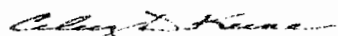

Celey D. Keene, Lab Director/Quality Manager

Analytical Results For:

 WHITING OIL & GAS
 DANNY HOLCOMB
 400 W. ILLINOIS, SUITE 1300
 MIDLAND TX, 79701
 Fax To: NONE

 Received: 11/14/2014
 Reported: 11/21/2014
 Project Name: WEST BRAVO DOME
 Project Number: NONE GIVEN
 Project Location: HARDING COUNTY NM

 Sampling Date: 11/12/2014
 Sampling Type: Soil
 Sampling Condition: Cool & Intact
 Sample Received By: Jodi Henson

Sample ID: STATE 1928 #161 (H403505-02)

BTEX 8021B		mg/kg		Analyzed By: ms					
Analyte	Result	Reporting Limit	Analyzed	Method Blank	BS	% Recovery	True Value QC	RPD	Qualifier
Benzene*	<0.050	0.050	11/17/2014	ND	1.83	91.4	2.00	8.21	
Toluene*	<0.050	0.050	11/17/2014	ND	1.76	88.2	2.00	6.70	
Ethylbenzene*	<0.050	0.050	11/17/2014	ND	1.75	87.4	2.00	6.66	
Total Xylenes*	<0.150	0.150	11/17/2014	ND	5.27	87.9	6.00	6.78	
Total BTEX	<0.300	0.300	11/17/2014	ND					

Surrogate: 4-Bromofluorobenzene (PII) 99.5 % 61-154

Chloride, SM4500Cl-B		mg/kg		Analyzed By: AP					
Analyte	Result	Reporting Limit	Analyzed	Method Blank	BS	% Recovery	True Value QC	RPD	Qualifier
Chloride	3880	16.0	11/14/2014	ND	400	100	400	0.00	

TPH 418.1		mg/kg		Analyzed By: CK					
Analyte	Result	Reporting Limit	Analyzed	Method Blank	BS	% Recovery	True Value QC	RPD	Qualifier
TPH 418.1	497	100	11/21/2014	ND	5570	111	5000	1.97	

TPH 8015M		mg/kg		Analyzed By: ms					
Analyte	Result	Reporting Limit	Analyzed	Method Blank	BS	% Recovery	True Value QC	RPD	Qualifier
GRO C6-C10	<10.0	10.0	11/15/2014	ND	187	93.7	200	3.04	
DRO >C10-C28	<10.0	10.0	11/15/2014	ND	191	95.6	200	4.30	

Surrogate: 1-Chlorooctane 126 % 47.2-157

Surrogate: 1-Chlorooctadecane 141 % 52.1-176

Cardinal Laboratories

*=Accredited Analyte

PLEASE NOTE: Liability and Damages. Cardinal's liability and client's exclusive remedy for any claim arising, whether based in contract or tort, shall be limited to the amount paid by client for analyses. All claims, including those for negligence and any other cause whatsoever shall be deemed waived unless made in writing and received by Cardinal within thirty (30) days after completion of the applicable service. In no event shall Cardinal be liable for incidental or consequential damages, including, without limitation, business interruptions, loss of use, or loss of profits incurred by client, its subsidiaries, affiliates or successors arising out of or related to the performance of the services hereunder by Cardinal, regardless of whether such claim is based upon any of the above stated reasons or otherwise. Results relate only to the samples identified above. This report shall not be reproduced except in full with written approval of Cardinal Laboratories.

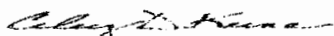

Celey D. Keene, Lab Director/Quality Manager

Analytical Results For:

WHITING OIL & GAS
DANNY HOLCOMB
400 W. ILLINOIS, SUITE 1300
MIDLAND TX, 79701
Fax To: NONE

Received: 11/14/2014
Reported: 11/21/2014
Project Name: WEST BRAVO DOME
Project Number: NONE GIVEN
Project Location: HARDING COUNTY NM

Sampling Date: 11/12/2014
Sampling Type: Soil
Sampling Condition: Cool & Intact
Sample Received By: Jodi Henson

Sample ID: STATE 2028 #361 (H403505-03)

BTEX 80218			mg/kg		Analyzed By: ms				
Analyte	Result	Reporting Limit	Analyzed	Method Blank	BS	% Recovery	True Value QC	RPD	Qualifier
Benzene*	<0.050	0.050	11/17/2014	ND	1.83	91.4	2.00	8.21	
Toluene*	<0.050	0.050	11/17/2014	ND	1.76	88.2	2.00	6.70	
Ethylbenzene*	<0.050	0.050	11/17/2014	ND	1.75	87.4	2.00	6.66	
Total Xylenes*	<0.150	0.150	11/17/2014	ND	5.27	87.9	6.00	6.78	
Total BTEX	<0.300	0.300	11/17/2014	ND					

Surrogate: 4-Bromofluorobenzene (PIL) 98.6 % 61-154

Chloride, SM4500Cl-B			mg/kg		Analyzed By: AP				
Analyte	Result	Reporting Limit	Analyzed	Method Blank	BS	% Recovery	True Value QC	RPD	Qualifier
Chloride	144	16.0	11/14/2014	ND	400	100	400	0.00	

TPH 418.1			mg/kg		Analyzed By: CK				
Analyte	Result	Reporting Limit	Analyzed	Method Blank	BS	% Recovery	True Value QC	RPD	Qualifier
TPH 418.1	482	100	11/21/2014	ND	5570	111	5000	1.97	

TPH 8015M			mg/kg		Analyzed By: ms				
Analyte	Result	Reporting Limit	Analyzed	Method Blank	BS	% Recovery	True Value QC	RPD	Qualifier
GRO C6-C10	<10.0	10.0	11/15/2014	ND	187	93.7	200	3.04	
DRO >C10-C28	<10.0	10.0	11/15/2014	ND	191	95.6	200	4.30	

Surrogate: 1-Chlorooctane 119 % 47.2-157

Surrogate: 1-Chlorooctadecane 132 % 52.1-176

Cardinal Laboratories

*=Accredited Analyte

PLEASE NOTE: Liability and Damages. Cardinal's liability and client's exclusive remedy for any claim arising, whether based in contract or tort, shall be limited to the amount paid by client for analyses. All claims, including those for negligence and any other cause whatsoever shall be deemed waived unless made in writing and received by Cardinal within thirty (30) days after completion of the applicable service. In no event shall Cardinal be liable for incidental or consequential damages, including, without limitation, business interruptions, loss of use, or loss of profits incurred by client, its subsidiaries, affiliates or successors arising out of or related to the performance of the services hereunder by Cardinal, regardless of whether such claim is based upon any of the above stated reasons or otherwise. Results relate only to the samples identified above. This report shall not be reproduced except in full with written approval of Cardinal Laboratories.

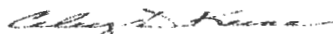

Celey D. Keene, Lab Director/Quality Manager

Analytical Results For:

 WHITING OIL & GAS
 DANNY HOLCOMB
 400 W. ILLINOIS, SUITE 1300
 MIDLAND TX, 79701
 Fax To: NONE

 Received: 11/14/2014
 Reported: 11/21/2014
 Project Name: WEST BRAVO DOME
 Project Number: NONE GIVEN
 Project Location: HARDING COUNTY NM

 Sampling Date: 11/12/2014
 Sampling Type: Soil
 Sampling Condition: Cool & Intact
 Sample Received By: Jodi Henson

Sample ID: GALVESTON 2028 #291 (H403505-04)

BTEX 80218		mg/kg		Analyzed By: ms						
Analyte	Result	Reporting Limit	Analyzed	Method Blank	BS	% Recovery	True Value QC	RPD	Qualifier	
Benzene*	<0.050	0.050	11/18/2014	ND	1.83	91.4	2.00	8.21		
Toluene*	<0.050	0.050	11/18/2014	ND	1.76	88.2	2.00	6.70		
Ethylbenzene*	<0.050	0.050	11/18/2014	ND	1.75	87.4	2.00	6.66		
Total Xylenes*	<0.150	0.150	11/18/2014	ND	5.27	87.9	6.00	6.78		
Total BTEX	<0.300	0.300	11/18/2014	ND						

Surrogate: 4-Bromofluorobenzene (PIL) 99.6 % 61-154

Chloride, SM4500Cl-B		mg/kg		Analyzed By: AP					
Analyte	Result	Reporting Limit	Analyzed	Method Blank	BS	% Recovery	True Value QC	RPD	Qualifier
Chloride	160	16.0	11/14/2014	ND	400	100	400	0.00	

TPH 418.1		mg/kg		Analyzed By: CK					
Analyte	Result	Reporting Limit	Analyzed	Method Blank	BS	% Recovery	True Value QC	RPD	Qualifier
TPH 418.1	328	100	11/21/2014	ND	5570	111	5000	1.97	

TPH 8015M		mg/kg		Analyzed By: ms						
Analyte	Result	Reporting Limit	Analyzed	Method Blank	BS	% Recovery	True Value QC	RPD	Qualifier	
GRO C6-C10	<10.0	10.0	11/15/2014	ND	187	93.7	200	3.04		
DRO >C10-C28	<10.0	10.0	11/15/2014	ND	191	95.6	200	4.30		

Surrogate: 1-Chlorooctane 118 % 47.2-157

Surrogate: 1-Chlorooctadecane 129 % 52.1-176

Cardinal Laboratories

*=Accredited Analyte

PLEASE NOTE: Liability and Damages. Cardinal's liability and client's exclusive remedy for any claim arising, whether based in contract or tort, shall be limited to the amount paid by client for analyses. All claims, including those for negligence and any other cause whatsoever shall be deemed waived unless made in writing and received by Cardinal within thirty (30) days after completion of the applicable service. In no event shall Cardinal be liable for incidental or consequential damages, including, without limitation, business interruptions, loss of use, or loss of profits incurred by client, its subsidiaries, affiliates or successors arising out of or related to the performance of the services hereunder by Cardinal, regardless of whether such claim is based upon any of the above stated reasons or otherwise. Results relate only to the samples identified above. This report shall not be reproduced except in full with written approval of Cardinal Laboratories.

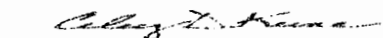

Celey D. Keene, Lab Director/Quality Manager

Analytical Results For:

WHITING OIL & GAS
DANNY HOLCOMB
400 W. ILLINOIS, SUITE 1300
MIDLAND TX, 79701
Fax To: NONE

Received: 11/14/2014
Reported: 11/21/2014
Project Name: WEST BRAVO DOME
Project Number: NONE GIVEN
Project Location: HARDING COUNTY NM

Sampling Date: 11/12/2014
Sampling Type: Soil
Sampling Condition: Cool & Intact
Sample Received By: Jodi Henson

Sample ID: LEWIS 1928 #041 (H403505-05)

BTEX 8021B		mg/kg		Analyzed By: ms					
Analyte	Result	Reporting Limit	Analyzed	Method Blank	BS	% Recovery	True Value QC	RPD	Qualifier
Benzene*	<0.050	0.050	11/18/2014	ND	1.83	91.4	2.00	8.21	
Toluene*	0.084	0.050	11/18/2014	ND	1.76	88.2	2.00	6.70	
Ethylbenzene*	<0.050	0.050	11/18/2014	ND	1.75	87.4	2.00	6.66	
Total Xylenes*	<0.150	0.150	11/18/2014	ND	5.27	87.9	6.00	6.78	
Total BTEX	<0.300	0.300	11/18/2014	ND					

Surrogate: 4-Bromofluorobenzene (PIE) 97.3 % 61-154

Chloride, SM4500Cl-B		mg/kg		Analyzed By: AP					
Analyte	Result	Reporting Limit	Analyzed	Method Blank	BS	% Recovery	True Value QC	RPD	Qualifier
Chloride	704	16.0	11/17/2014	ND	400	100	400	3.92	

TPH 418.1		mg/kg		Analyzed By: CK					
Analyte	Result	Reporting Limit	Analyzed	Method Blank	BS	% Recovery	True Value QC	RPD	Qualifier
TPH 418.1	565	100	11/21/2014	ND	5570	111	5000	1.97	

TPH 8015M		mg/kg		Analyzed By: MS					
Analyte	Result	Reporting Limit	Analyzed	Method Blank	BS	% Recovery	True Value QC	RPD	Qualifier
GRO C6-C10	<10.0	10.0	11/14/2014	ND	212	106	200	1.79	
DRO >C10-C28	<10.0	10.0	11/14/2014	ND	213	107	200	1.12	

Surrogate: 1-Chlorooctane 123 % 47.2-157

Surrogate: 1-Chlorooctadecane 121 % 52.1-176

Cardinal Laboratories

*=Accredited Analyte

PLEASE NOTE: Liability and Damages. Cardinal's liability and client's exclusive remedy for any claim arising, whether based in contract or tort, shall be limited to the amount paid by client for analyses. All claims, including those for negligence and any other cause whatsoever shall be deemed waived unless made in writing and received by Cardinal within thirty (30) days after completion of the applicable service. In no event shall Cardinal be liable for incidental or consequential damages, including, without limitation, business interruptions, loss of use, or loss of profits incurred by client, its subsidiaries, affiliates or successors arising out of or related to the performance of the services hereunder by Cardinal, regardless of whether such claim is based upon any of the above stated reasons or otherwise. Results relate only to the samples identified above. This report shall not be reproduced except in full with written approval of Cardinal Laboratories.

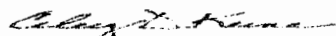

Celey D. Keene, Lab Director/Quality Manager

Notes and Definitions

ND	Analyte NOT DETECTED at or above the reporting limit
RPD	Relative Percent Difference
**	Samples not received at proper temperature of 6°C or below.
***	Insufficient time to reach temperature.
-	Chloride by SM4500Cl-B does not require samples be received at or below 6°C Samples reported on an as received basis (wet) unless otherwise noted on report

Cardinal Laboratories

*=Accredited Analyte

PLEASE NOTE: Liability and Damages. Cardinal's liability and client's exclusive remedy for any claim arising, whether based in contract or tort, shall be limited to the amount paid by client for analyses. All claims, including those for negligence and any other cause whatsoever shall be deemed waived unless made in writing and received by Cardinal within thirty (30) days after completion of the applicable service. In no event shall Cardinal be liable for incidental or consequential damages, including, without limitation, business interruptions, loss of use, or loss of profits incurred by client, its subsidiaries, affiliates or successors arising out of or related to the performance of the services hereunder by Cardinal, regardless of whether such claim is based upon any of the above stated reasons or otherwise. Results relate only to the samples identified above. This report shall not be reproduced except in full with written approval of Cardinal Laboratories.

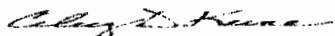

Celey D. Keene, Lab Director/Quality Manager

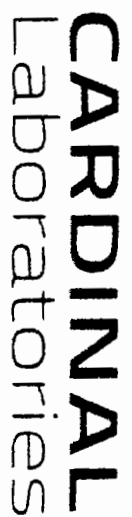

CHAIN-OF-CUSTODY AND ANALYSIS REQUEST

101 East Marland, Hobbs, NM 88240
(575) 393-2326 FAX (575) 393-2476

Company Name: Whiting Oil & Gas Project Manager: Robert McNaughton Address: 400 W Illinois, Suite 1300 City: Midland State: TX Zip: 79701 Phone #: 806-471-5628 Fax #: Project #: West Grand Dene Project Owner: Project Name: West Grand Dene Project Location: Harding Co, NM Sampler Name: Denny Holcomb		P.O. #: Company: Whiting Oil & Gas Attn: Gary Bullock Address: 400 W Illinois, Suite 1300 City: Midland State: TX Zip: 79701 Phone #: Fax #:																																																		
Lab I.D. H403505 Sample I.D. 1 Dakh 1927 * 121 2 Stale 1928 * 161 3 Stale 2028 * 361 4 Galvstn 2028 * 291 5 Lw 1928 * 041		<table border="1" style="width:100%; border-collapse: collapse;"> <tr> <th style="width:10%;">(G)RAB OR (C)OMP</th> <th style="width:10%;"># CONTAINERS</th> <th style="width:10%;">GROUNDWATER</th> <th style="width:10%;">WASTEWATER</th> <th style="width:10%;">MATRIX</th> <th style="width:10%;">PRESERV</th> <th style="width:10%;">SAMPLING</th> </tr> <tr> <td></td> <td></td> <td></td> <td></td> <td>SOIL OIL SLUDGE OTHER</td> <td>ACID/BASE: ICE / COOL OTHER</td> <td>DATE TIME</td> </tr> <tr> <td></td> <td></td> <td></td> <td></td> <td>✓</td> <td>✓</td> <td>11/14/14 3 PM</td> </tr> <tr> <td></td> <td></td> <td></td> <td></td> <td>✓</td> <td>✓</td> <td>11/12/14 1 PM</td> </tr> <tr> <td></td> <td></td> <td></td> <td></td> <td>✓</td> <td>✓</td> <td>11/12/14 1:40 PM</td> </tr> <tr> <td></td> <td></td> <td></td> <td></td> <td>✓</td> <td>✓</td> <td>11/12/14 9:10 AM</td> </tr> <tr> <td></td> <td></td> <td></td> <td></td> <td>✓</td> <td>✓</td> <td>11/12/14 8:50 AM</td> </tr> </table>		(G)RAB OR (C)OMP	# CONTAINERS	GROUNDWATER	WASTEWATER	MATRIX	PRESERV	SAMPLING					SOIL OIL SLUDGE OTHER	ACID/BASE: ICE / COOL OTHER	DATE TIME					✓	✓	11/14/14 3 PM					✓	✓	11/12/14 1 PM					✓	✓	11/12/14 1:40 PM					✓	✓	11/12/14 9:10 AM					✓	✓	11/12/14 8:50 AM
(G)RAB OR (C)OMP	# CONTAINERS	GROUNDWATER	WASTEWATER	MATRIX	PRESERV	SAMPLING																																														
				SOIL OIL SLUDGE OTHER	ACID/BASE: ICE / COOL OTHER	DATE TIME																																														
				✓	✓	11/14/14 3 PM																																														
				✓	✓	11/12/14 1 PM																																														
				✓	✓	11/12/14 1:40 PM																																														
				✓	✓	11/12/14 9:10 AM																																														
				✓	✓	11/12/14 8:50 AM																																														
Relinquished By: <i>D. Holcomb</i> Relinquished By: Date: 11/14/14 Time: 8 AM Received By: <i>Debi Jensen</i> Received By: Date: Time:		Sample Condition Cool <input checked="" type="checkbox"/> Intact <input type="checkbox"/> Free <input checked="" type="checkbox"/> Ices <input type="checkbox"/> No <input type="checkbox"/> Yes <input type="checkbox"/> CHECKED BY: <i>[Signature]</i> REMARKS: d.jholcomb75@gmail.com key.moddex@whiting.com																																																		

Whiting Oil & Gas Corporation
West Bravo Dome Pit Sample Results

Analyte	Thresholds			Results												
	Groundwater at 25-50 ft	Groundwater at 51-100 ft	Groundwater at > 100 ft	Lewis 1928 #051	Lewis 2028 #321	Lewis 2028 #331	Lewis 2028 #341	Galveston 1928 #011	Miera 2130 #352	Miera 2130 #353	Miera 2130 #354	Dahl 1927 #121	State 1928 #161	State 2028 #361	Galveston 2028 #291	Lewis 1928 #041
	10	10	10	<0.05	<0.05	<0.05	<0.05	<0.05	<0.05	<0.05	<0.05	<0.05	<0.05	<0.05	<0.05	<0.05
Benzene	50	50	50	<0.30	<0.30	<0.30	<0.30	<0.30	<0.30	<0.30	<0.30	<0.30	<0.30	<0.30	<0.30	<0.30
Total BTEX																
Chlorides	20,000	40,000	80,000	32	144	736	160	512	592	304	576	<16	3,880	144	160	704
TPH	100	2500	2500	140	508	681	314	280	622	239	182	915	497	482	328	565
GRO	1000	1000	1000	<10	<10	<10	<10	<10	<10	<10	<10	<10	<10	<10	<10	<10
DRO	1000	1000	1000	<10	12.7	<10	<10	<10	<10	<10	<10	24.6	<10	<10	<10	<10
Sample Delivery Date				10/9/14	10/9/14	10/9/14	10/9/14	10/9/14	10/9/14	10/9/14	10/9/14	11/14/14	11/14/14	11/14/14	11/14/14	11/14/14

Samples delivered to Cardinal Labs (Hobbs) 10/9/14

WHITING OIL & GAS CORPORATION**Workover and Completion Report**

Well Name: State 2028 #36-1 Field: Other Date: 04/08/15 Day: 10 Type: Initial Completion
 API: 30-021-20632 Move On Date: 6/27/2014 AFE #: 14-1117-04 Rig: NA Supv DH Depth: 2,360

Present Operation: Well shut in

Csg: 7" - J-55 20# ST&C Liner: N/A
 Rods: N/A Perfs: OPEN HOLE
 Tbg: NONE

[Click to Calc. HP - Hrs](#)

GHG Gas Vol(Mcf)	Dur. Hrs?	#### mcf/d	% of gas	Gas Volume Estimated ??	Producing Method
Total Rig Hrs: 0	Daily Activity		GHG Event Total HP/Hr (Units > 130 HP)	0 for #### hrs	Units <= 130 HP (Count)

4/8/15

MI Hartley Construction dirt equipment to perform reserve pit closure per NMOCD rules. Remove barbed wire fencing and posts. Fold over outside edges of pit liner bottom, cover cuttings with new 20 mil LLDPE liner cap, cover new liner cap with a minimum of 4 feet of dirt cover, MO dirt equipment. NMOCD notified and not present.

4/9/15

Install 4.5" OD steel pit burial marker in center of pit burial (set in concrete).

Will final blade surface and reseed pit closure area during planting season. Danny

Costs:

Expense Account Codes	Capital Account Codes	Comments	Amount
811.94 Contract Services and Equipmer	Hartley Construction		\$ 9,857
811.94 Contract Services and Equipmer	Globe Energy - dewater pit		\$ 2,600.00
811.39 Contract Labor	EWC		\$ 1,800.00

Daily Total: \$ 14,257.00
 Prev. Total:



APRIL 24, 2015

Mr. Leonard Lowe
New Mexico Oil Conservation Division
1220 S. St. Francis Dr
Santa Fe, NM 87505

RE: Pit Closure

Dear Mr. Lowe,

Whiting Oil & Gas shall re-seed the disturbed Pit area for the well listed below. The re-seeding shall occur in the next rainy season documented for Harding County, New Mexico approximately August/September 2015.

If you have additional question please contact me @ 432.686.6709 or kay.maddox@whiting.com
Thank you for your time.

Sincerely,

Kay Maddox
Regulatory Supervisor

STATE 2028 36 Well # 1
30-021-20632
Harding County, New Mexico

*Whiting Petroleum Corporation
and its wholly owned subsidiary
Whiting Oil and Gas Corporation*

400 W. Illinois Avenue, Suite 1300, Midland, TX 79701 Office: 432.686.6700 Fax 432.686.6799



Whiting Oil & Gas Corporation

STATE LEASE WELL NO. 2028 #36-1

UL J. SEC. 36, T20, R28

1660' FSL & 1749' FEL

API #30-021-20632 HARDING CO., NM



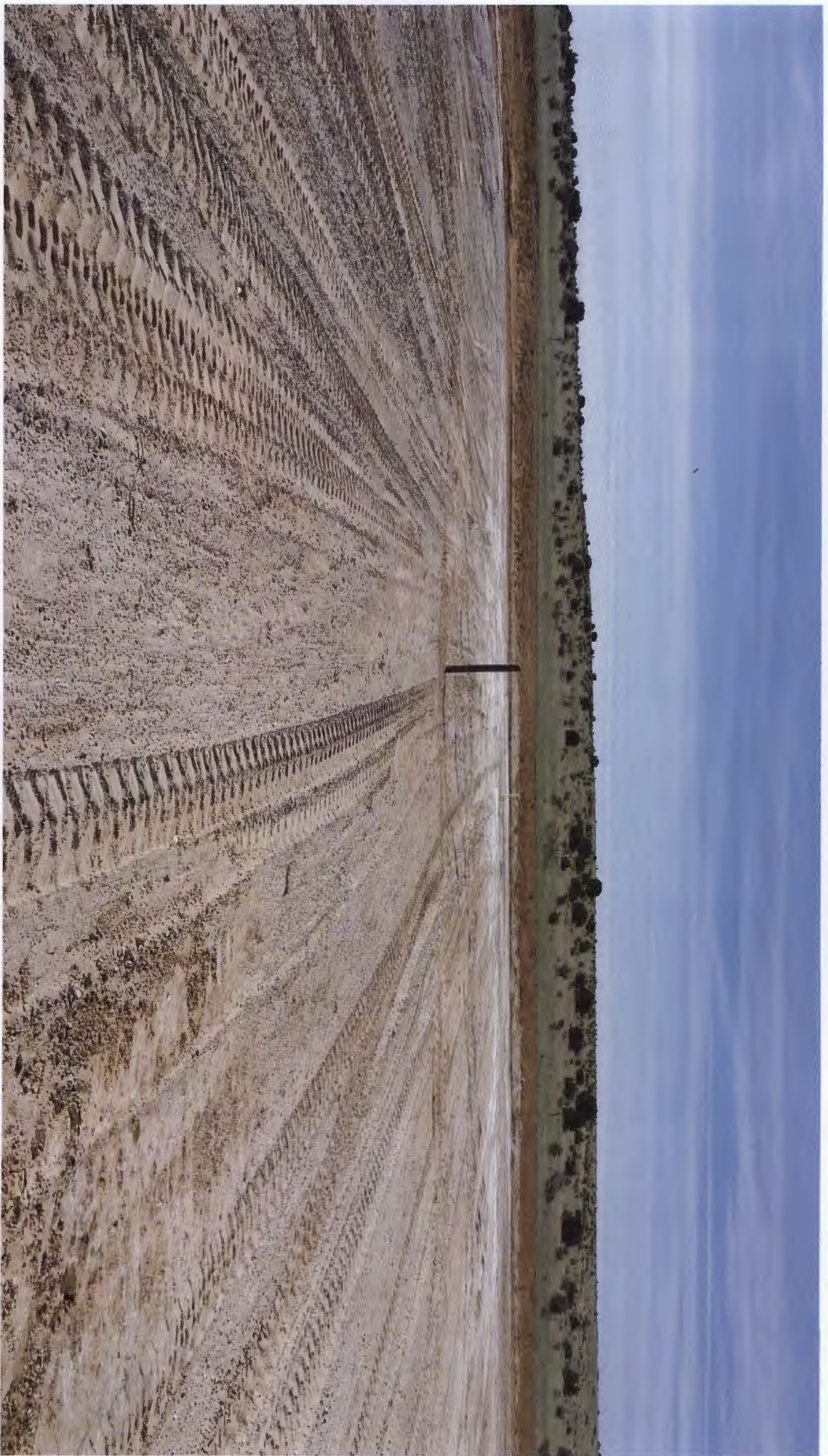







Submit 1 Copy To Appropriate District
Office
District I - (575) 393-6161
1625 N. French Dr., Hobbs, NM 88240
District II - (575) 748-1283
811 S. First St., Artesia, NM 88210
District III - (505) 334-6178
1000 Rio Brazos Rd., Aztec, NM 87410
District IV - (505) 476-3460
1220 S. St. Francis Dr., Santa Fe, NM
87505

State of New Mexico
Energy, Minerals and Natural Resources

OIL CONSERVATION DIVISION
1220 South St. Francis Dr.
Santa Fe, NM 87505

Form C-103
Revised July 18, 2013

SUNDRY NOTICES AND REPORTS ON WELLS (DO NOT USE THIS FORM FOR PROPOSALS TO DRILL OR TO DEEPEN OR PLUG BACK TO A DIFFERENT RESERVOIR. USE "APPLICATION FOR PERMIT" (FORM C-101) FOR SUCH PROPOSALS.)		WELL API NO. 30-021-20632
1. Type of Well: Oil Well <input type="checkbox"/> Gas Well <input checked="" type="checkbox"/> Other <input type="checkbox"/>		5. Indicate Type of Lease STATE <input checked="" type="checkbox"/> FEE <input type="checkbox"/>
2. Name of Operator WHITING OIL AND GAS CORPORATION		6. State Oil & Gas Lease No.
3. Address of Operator 400 W ILLINOIS STE 1300 MIDLAND, TX 79701		7. Lease Name or Unit Agreement Name STATE 2028-36
4. Well Location Unit Letter J 1660 feet from the SOUTH line and 1749 feet from the EAST line Section 36 Township 20N Range 28E NMPM County HARDING		8. Well Number 1
11. Elevation (Show whether DR, RKB, RT, GR, etc.) 5388 GR		9. OGRID Number 25078
		10. Pool name or Wildcat WILDCAT: TUBB CO2 GAS POOL

12. Check Appropriate Box to Indicate Nature of Notice, Report or Other Data

NOTICE OF INTENTION TO:

PERFORM REMEDIAL WORK ☐ PLUG AND ABANDON ☐
TEMPORARILY ABANDON ☐ CHANGE PLANS ☐
PULL OR ALTER CASING ☐ MULTIPLE COMPL ☐
DOWNHOLE COMMINGLE ☐
CLOSED-LOOP SYSTEM ☐
OTHER: ☐

SUBSEQUENT REPORT OF:

REMEDIAL WORK ☐ ALTERING CASING ☐
COMMENCE DRILLING OPNS. ☐ P AND A ☐
CASING/CEMENT JOB ☐
OTHER: ☒ CLOSED TEMPORARY PIT

13. Describe proposed or completed operations. (Clearly state all pertinent details, and give pertinent dates, including estimated date of starting any proposed work). SEE RULE 19.15.7.14 NMAC. For Multiple Completions: Attach wellbore diagram of proposed completion or recompletion.

06/28/2014 SPUD WELL - DRLD 12 1/4" HOLE
06/29/2014 RAN J-55 9 5/8" 36# CSG SET @ 724' W/450 SXS CMT, 14.8 PPG YIELD 1.35 CIRC TO SURFACE TSTD TO 600#
06/30/2014 DRILL TO 2050 - LOST RETURNS, DRILL TO 2360 NO RETURNS, TRIED TO RUN 7" CSG, STUCK AT 1638'
07/04/2014 RELEASED RIG - WELL IS TEMPORARILY ABANDONED. WHITING EVENTUALLY PLANS TO
SQZ FRACTURE ZONE, DRILL TO TD AND COMPLETE WELL
01/15/2015 NMOCD APPROVED 6 MO EXTENSION REQUEST IN ORDER TO GET TEMPORARY DRLG PIT CLOSED
04/08/2015 CLOSED TEMPORARY PIT

Spud Date:

06/28/2014

Rig Release Date:

07/04/2014

I hereby certify that the information above is true and complete to the best of my knowledge and belief.

SIGNATURE

Kay Maddox

TITLE: REGULATORY ANALYST DATE: 04/24/2015

Type or print name Kay Maddox E-mail address: kay.Maddox@Whiting.com PHONE: 432-638-8475

For State Use Only

APPROVED BY:

TITLE

DATE

Conditions of Approval (if any):

DISTRICT I
1625 N. French Dr., Hobbs, NM 88240

DISTRICT II
1301 W. Grand Avenue, Artesia, NM 88210

DISTRICT III
1000 Rio Brazos Rd., Aztec, NM 87410

DISTRICT IV
1220 S. St. Francis Dr., Santa Fe, NM 87505

State of New Mexico

Energy, Minerals, and Natural Resources Department

OIL CONSERVATION DIVISION

1220 South St. Francis Dr.

Santa Fe, New Mexico 87505

Form C-102

Revised October 12, 2005

Submit to Appropriate District Office

State Lease - 4 copies

Fee Lease - 3 copies

☐ AMENDED REPORT

WELL LOCATION AND ACREAGE DEDICATION PLAT

¹ API Number 30-021-20632	² Pool Code 98104	³ Pool Name WILDCAT; Tubb CO ₂ GAS POOL
⁴ Property Code 313331	⁵ Property Name STATE 2028 36	⁶ Well Number 1
⁷ GRID No. 25078	⁸ Operator Name WHITING OIL & GAS CORPORATION	⁹ Elevation 5388'

¹⁰Surface Location

UL or lot no.	Section	Township	Range	Lot Idn	Feet from the	North/South line	Feet from the	East/West line	County
J	36	20 NORTH	28 EAST, N.M.P.M.		1660'	SOUTH	1749'	EAST	HARDING

¹¹Bottom Hole Location If Different From Surface

UL or lot no.	Section	Township	Range	Lot Idn	Feet from the	North/South line	Feet from the	East/West line	County
¹² Dedicated Acres 16.0	¹³ Joint or Infill	¹⁴ Consolidation Code	¹⁵ Order No.						

NO ALLOWABLE WELL BE ASSIGNED TO THIS COMPLETION UNTIL ALL INTERESTS HAVE BEEN CONSOLIDATED OR A NON-STANDARD UNIT HAS BEEN APPROVED BY THE DIVISION

¹⁶ <p>DETAIL NOT TO SCALE</p> <p>280' 250' 250' 280'</p> <p>1.61 ACRES</p> <p>NAD 27 NME ZONE X:623845 Y:1789476 LAT:35°55'03.13" LON:-103°54'54.28"</p> <p>FOI LEASE ROAD</p> <p>EXISTING TRAIL ROAD</p> <p>ROAD 802 48.61 RODS 1.61 Acres</p> <p>BOI LEASE ROAD</p> <p>1749'</p> <p>1660'</p> <p>X:625583 Y:1793171</p> <p>X:625600 Y:1787837</p>	<p>¹⁷OPERATOR CERTIFICATION</p> <p>I hereby certify that the information contained herein is true and complete to the best of my knowledge and belief, and that this organization either owns a working interest or unleased mineral interest in the land including the proposed bottom hole location or has a right to drill this well at this location pursuant to a contract with an owner of such a mineral or working interest, or to a voluntary pooling agreement or a compulsory pooling order heretofore entered by the division.</p> <p><i>KAY MADDOX</i> 5/14/14 Signature Date KAY MADDOX Printed Name</p> <p>¹⁸SURVEYOR CERTIFICATION</p> <p>I hereby certify that the well location shown on this plat was plotted from field notes of actual surveys made by me or under my supervision, and that the same is true and correct to the best of my belief.</p> <p>MAY 13, 2014 Date of Survey Signature and Seal of Professional Surveyor</p> <p>STATE OF NEW MEXICO V. LYNN BEZNER NO. 7920 PROFESSIONAL LAND SURVEYOR</p> <p><i>V. Lynn Bezner</i> Certificate Number V. Lynn Bezner P.S. #7920</p> <p>FILE:LO_STATE_2028_36_1</p>
--	---