

OIL CONSERVATION DIVISION

P. O. BOX 2088

SANTA FE, NEW MEXICO 87501

Form C-101
Revised 10-1-78

NO. OF COPIES RECEIVED	
DISTRIBUTION	9
SANTA FE	1
FILE	1
U.S.G.S.	2
LAND OFFICE <i>SLM</i>	1
OPERATOR	1

APZ # 30-059-20251

5A. Indicate Type of Lease
STATE FEDERAL

5. State Oil & Gas Lease No.

APPLICATION FOR PERMIT TO DRILL, DEEPEN, OR PLUG BACK

1a. Type of Work
b. Type of Well DRILL DEEPEN PLUG BACK
OIL WELL GAS WELL CO2 OTHER SINGLE ZONE MULTIPLE ZONE

2. Name of Operator
Amoco Production Company

3. Address of Operator
P. O. Box 606, Clayton, New Mexico 88415

4. Location of Well
UNIT LETTER G LOCATED 1650 FEET FROM THE North LINE
AND 1650 FEET FROM THE East LINE OF SEC. 15 TWP. 18-N ACC. 35-E WELP#

7. Unit Agreement Name
BDCDGU

8. Form of Lease Name
BDCDGU

9. Well No.
1835 151G

10. Field Name
Bravo Dome 640-Acre Area

17. County
Union

19. Proposed Depth
2900'

19A. Formation
Tubb

20. Rotary or C.T.
Rotary

21. Elevations (show whether DF, HI, etc.)
4568 GL

21A. Kind & Status Plug. Bond
Blanket-on-file

21B. Drilling Contractor
N/A

22. Approx. Date Work will start
August, 1984

PROPOSED CASING AND CEMENT PROGRAM

SIZE OF HOLE	SIZE OF CASING	WEIGHT PER FOOT	SETTING DEPTH	SACKS OF CEMENT	EST. TOP
12-1/4"	9-5/8"	32.30#	700'	Circulate	surface
8-3/4"	7"	15, 20#	2900'	Tieback to 9-5/8"	surface

Propose to drill and equip well in the Tubb formation. After reaching TD logs will be run and evaluated. Perforate and stimulate as necessary in attempting commercial production.

Mud Program: 0 - 700' Native Spud Mud
700 - TD KCL Salt Water Gel-Starch

BOP Diagram attached.

APPROVAL VALID FOR 180 DAYS

PERMIT EXPIRES 2-17-85

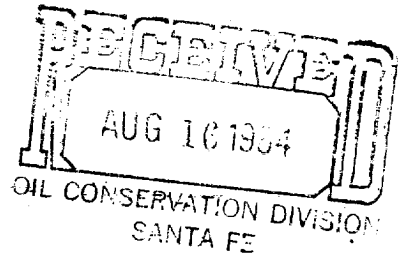

0+5-NMOCD,SF 1-J. R. Barnettt, HOU Rm. 21.156 1-F. J. Nash, HOU Rm. 4.206 1-WF, C 1-WF, 1-Susp, 1-JSM, 1-Amerada 1-Amerigas 1-Cities Service 1-Conoco 1-CO2 in Action 1-Sun 1-Excelsior 1-Tex 1-Exxon

4. ABOVE SPACE DESCRIBE PROPOSED PROGRAM. IF PROPOSAL IS TO DEEPEN OR PLUG BACK, GIVE DATA ON PRESENT PRODUCTIVE ZONE AND PROPOSED NEW PRODUCTIVE ZONE. GIVE BLOWOUT PREVENTER PROGRAM, IF ANY.

I hereby certify that the information above is true and complete to the best of my knowledge and belief.

Signed John D. McElya Title Assist. Admin. Analyst Date 8-14-84

APPROVED BY [Signature] TITLE DISTRICT SUPERVISOR DATE 8-21-84

CONDITIONS OF APPROVAL, IF ANY:

NEW MEXICO OIL CONSERVATION COMMISSION
WELL LOCATION AND ACREAGE DEDICATION PLAT

Form O-100
Superseded 6-21-77
Effective 1-1-78

All distances must be from the outer boundaries of the section.

Operator AMOCO PRODUCTION COMPANY		Well Name Bravo Dome Carbon Dioxide Gas Unit			Well No. 1835151G
Unit Letter G	Section 15	Township T18N	Range R35E	County UNION	
Actual Footage Location of Well: 1650 feet from the NORTH line and 1650 feet from the EAST line					
Ground Level Elev. 4568	Producing Formation Tubb	Pool Bravo Dome 640-Acre Area			Dedicated Acreage: 640 Acres

- Outline the acreage dedicated to the subject well by colored pencil or hachure marks on the plat below.
- If more than one lease is dedicated to the well, outline each and identify the ownership thereof (both as to working interest and royalty).
- If more than one lease of different ownership is dedicated to the well, have the interests of all owners been consolidated by communitization, unitization, force-pooling, etc?

Yes No If answer is "yes," type of consolidation Agreement or Forced Pooling

If answer is "no," list the owners and tract descriptions which have actually been consolidated. (Use reverse side of this form if necessary.) _____

No allowable will be assigned to the well until all interests have been consolidated (by communitization, unitization, forced-pooling, or otherwise) or until a non-standard unit, eliminating such interests, has been approved by the Commission.

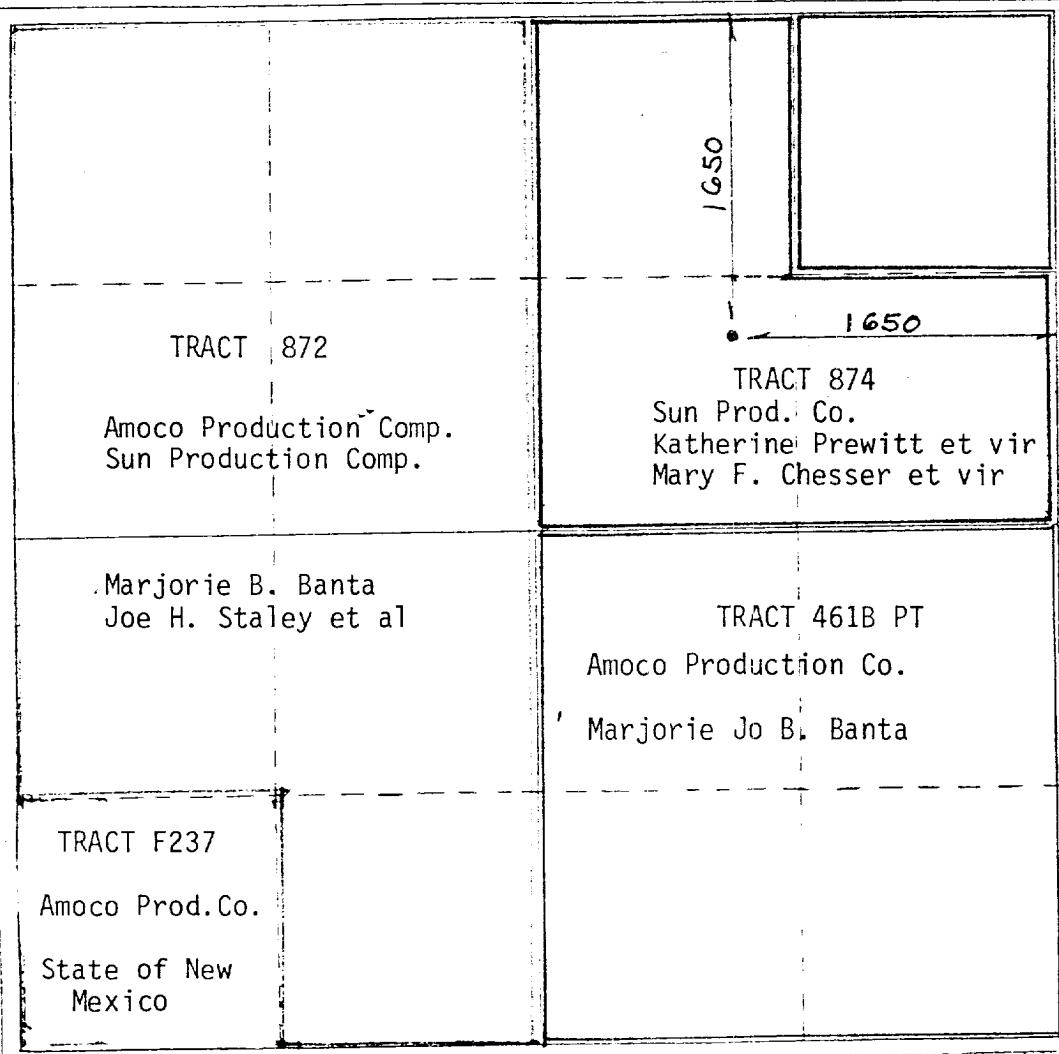

CERTIFICATION

I hereby certify that the information contained herein is true and complete to the best of my knowledge and belief.

Name: John S. McElyea
 Position: Asst. Adm. Analyst
 Company: Amoco Production Company
 Date: 8-14-84

I hereby certify that the well location shown on this plat was plotted from field notes of actual surveys made by me or under my supervision, and that the same is true and correct to the best of my knowledge and belief.

AUG. 13, 1984

Date Received: _____
 Signature: [Signature]
 Registered Professional Engineer
 and/or Land Surveyor
 N.M.L.S. NO. 5103
 Certificate No. _____

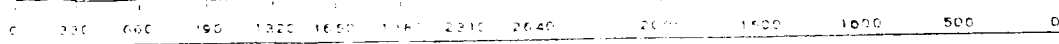

STANDARD 2000 PSI W.P. BOP STACK

1. Blow-out preventers may be manually operated.
2. All equipment must be in good condition, 2,000 psi W.P. (4,000 psi test) minimum.
3. Bell nipple above blow-out preventer shall be same size as casing being drilled through.
4. Kelly cock to be installed on kelly.
5. Full opening safety valve 2,000 psi w.p. (4,000 psi test) minimum must be available on rig floor at all times with proper connection or subs to fit any tool joint in string.
6. Spool or cross may be eliminated if connections are available in the lower part of the blow-out preventer body.
7. Double or space saver type preventers may be used in lieu of two single preventers.
8. BOP rams to be installed as follows:
 - Top preventer - Drill pipe or casing rams
 - Bottom preventer - Blind rams

*Amoco District Superintendent may reverse location of rams.
9. Extensions and hand wheels to be installed and braced at all times.
10. Manifold valves may be gate or plug metal to metal seal 2" minimum.

