



January 28, 2015

AMARILLO  
921 North Bivins  
Amarillo, Texas 79107  
Phone 806.467.0607  
Fax 806.467.0622

Mr. Mike Bratcher  
**NMOCD District 2**  
811 S. 1<sup>st</sup> Street  
Artesia, NM 88210

ARTESIA  
408 West Texas Ave.  
Artesia, New Mexico 88210  
Phone 575.746.8768  
Fax 575.746.8905

Subject: **Soil Assessment and Remediation Work Plan**  
Oxy Permian, LTD  
Riverbend Federal No.8 SWD

HOBBS  
318 East Taylor Street  
Hobbs, New Mexico 88240  
Phone 575.393.4261  
Fax 575.393.4658

Oxy Permian (Oxy) has contracted Talon/LPE (Talon) to perform soil assessment and remediation services at the above referenced location. The results of our soil assessment and proposed remediation activities consist of the following

#### **Incident Date**

The release was discovered on January 7, 2015 at 5:30 am.

MIDLAND  
2901 State Hwy 349  
Midland, Texas 79706  
Phone 432.522.2133  
Fax 432.522.2180

#### **Background Information**

OKLAHOMA CITY  
7700 North Hudson Avenue  
Suite 10  
Oklahoma City, Oklahoma 73116  
Phone 405.486.7030  
Fax 806.467.0622

The Riverbend Federal No. 8 SWD is located approximately ten (10) miles southeast of Malaga, New Mexico. The legal location for this site is Unit Letter D, Section 23, Township 24 South, and Range 29 East. More specifically the latitude and longitude for the release are 32.20900 North and -103.96270 West. A site plan is presented in [Appendix I](#).

SAN ANTONIO  
13111 Lookout Way  
San Antonio, Texas 78233  
Phone 210.265.8025  
Fax 210.568.2191

According to the soil survey provided by the United States Department of Agriculture Natural Resources Conservation Service, the soil in this area is made up of Kermit-Berino fine sands with 0 to 3 percent slopes. Per the New Mexico Bureau of Geology and Mineral Resources, the local surface and shallow geology is Holocene to middle Pleistocene in age. Drainage courses in this area are normally dry. Ground water in the project vicinity is greater than 220-feet according to the New Mexico Office of the State Engineer. See [Appendix II](#) for the referenced groundwater data.

The ranking for this site is 0 based on the following:

Depth to ground water	>100'
Wellhead Protection Area	>1000'
Distance to surface water body	>1000'

ENVIRONMENTAL CONSULTING  
ENGINEERING  
DRILLING  
CONSTRUCTION  
SPILL MANAGEMENT  
GENERAL CONTRACTING

## Incident Description

A 3-inch steel nipple on the discharge gauge failed due to internal corrosion causing a release of 100 barrels of produced water. A vac truck was immediately call to the location and recovered 90 barrel of water. The SWD was shut-in, the nipple replaced and the well brought back into service. (See [Appendix I](#) for the site map).

## Laboratory Results

See [Appendix III](#) for complete report of laboratory results.

January 14, 2015

Sample ID	Depth (feet)	BTEX (mg/kg)	Chlorides (mg/kg)	TPH (mg/kg) GRO	TPH (mg/kg) DRO
S-1	0'	1.87	27200	<10	<10
	1'	<0.300	160	<10	<10
	2'	<0.300	64	<10	<10
	3'	<0.300	16	<10	<10
	4'	<0.300	80	<10	<10
S-2	0'	0.363	24400	<10	<10
	1'	<0.300	1630	<10	<10
	2'	<0.300	32	<10	<10
	3'	<0.300	<16	<10	<10
	4'	<0.300	384	<10	<10
S-3	0'	<0.300	12600	<10	<10
	1'	<0.300	144	<10	<10
	2'	<0.300	208	<10	<10
	3'	<0.300	<16	<10	<10
	4'	<0.300	<16	<10	<10

Based upon the site ranking of 0, NMOCD Recommended Remedial Action Levels (RRAL's) are 50 mg/kg for BTEX, 10 mg for Benzene, and 5,000 mg/kg for TPH. The chloride remediation standard is considered to be 1,000 mg/kg based upon a water table depth greater than 100-feet deep.

### **Proposed Remedial Actions**

- The impacted areas in the vicinity of sample locations S-1 and S-3 will be excavated to a depth of 0.5-feet deep. The impact area in the vicinity of sample point S-2 will be excavated to a depth of 1.5-feet deep.
- All of the excavated material will be hauled to an NMOCD approved solid waste disposal facility for disposal.
- The excavated area will be backfilled with caliche and contoured to match the surrounding location.
- A final report documenting all field activities and lab reports will be provided to the NMOCD Artesia Office including Form C-141.

Should you have any questions or if further information is required, please do not hesitate to contact our office at (575)-746-8768

Respectfully submitted,

TALON/LPE

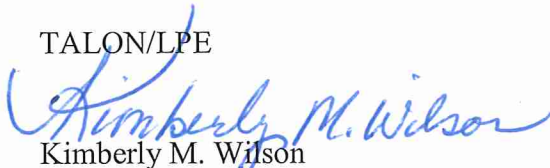

Kimberly M. Wilson  
Project Manager



David J. Adkins  
District Manager

## **APPENDIX I**

### **SITE MAP**



Date: 01/15/2015

Scale: 1" = 50'

Drawn By: TJS

Riverbend Federal 8 SWD Battery

Oxy - NM - North

Eddy County, New Mexico

Figure 1 - Site Plan

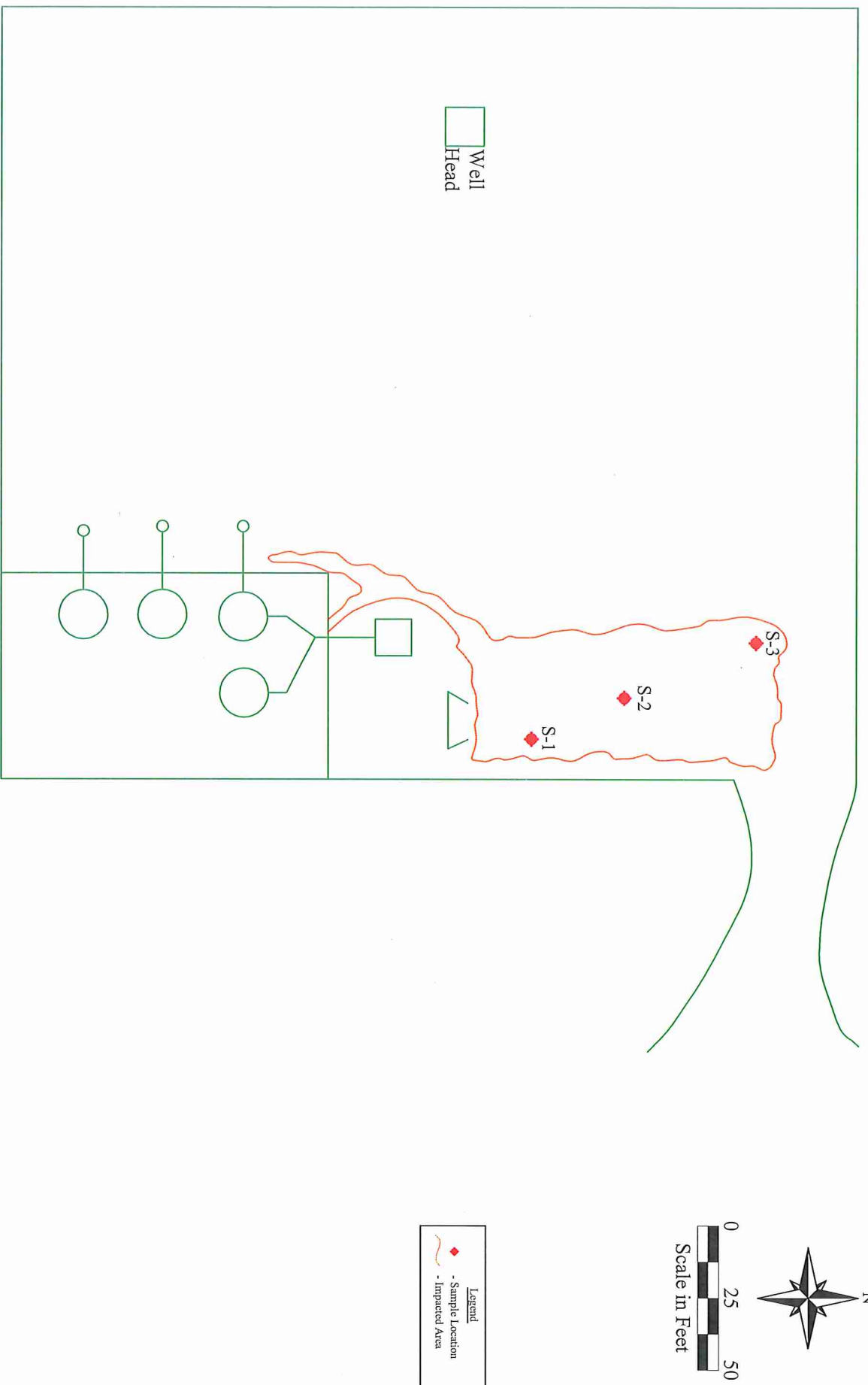

**APPENDIX II**  
**GROUNDWATER DATA**  
**INITIAL C-141**



District I  
1625 N. French Dr., Hobbs, NM 88240  
District II  
811 S. First St., Artesia, NM 88210  
District III  
1000 Rio Brazos Road, Aztec, NM 87410  
District IV  
1220 S. St. Francis Dr., Santa Fe, NM 87505

State of New Mexico  
Energy Minerals and Natural Resources  
Oil Conservation Division  
1220 South St. Francis Dr.  
Santa Fe, NM 87505

Form C-141  
Revised August 8, 2011

Submit 1 Copy to appropriate District Office in  
accordance with 19.15.29 NMAC.

## Release Notification and Corrective Action

### OPERATOR

☒ Initial Report ☐ Final Report

Name of Company: <b>Oxy USA Inc. [16696]</b>	Contact: <b>Chris Jones</b>
Address: <b>102 S. Main St. Carlsbad, NM 88220</b>	Telephone No.: <b>575-628-4121</b>
Facility Name: <b>Riverbend Fed 8 SWD</b>	Facility Type: <b>SWD</b>

Surface Owner: <b>BLM</b>	Mineral Owner: <b>Federal</b>	API No. <b>30-015-28390</b>
---------------------------	-------------------------------	-----------------------------

### LOCATION OF RELEASE

Unit Letter <b>D</b>	Section <b>23</b>	Township <b>24S</b>	Range <b>29E</b>	Feet from the <b>460</b>	North/South Line <b>North</b>	Feet from the <b>330</b>	East/West Line <b>West</b>	County: <b>Eddy</b>
-------------------------	----------------------	------------------------	---------------------	-----------------------------	----------------------------------	-----------------------------	-------------------------------	---------------------

Latitude 32.20900933 Longitude -103.96270639

### NATURE OF RELEASE

Type of Release: <b>Produced Water</b>	Volume of Release <b>100 bbls</b>	Volume Recovered <b>90 bbls</b>
Source of Release: <b>1' Steel Nipple corroded</b>	Date and Hour of Occurrence: <b>1/7/15 5:30 am</b>	Date and Hour of Discovery <b>1/7/15 5:30 am</b>
Was Immediate Notice Given? <input checked="" type="checkbox"/> Yes <input type="checkbox"/> No <input type="checkbox"/> Not Required	If YES, To Whom? <b>Mike Bratcher of NMOCD via telephone</b> <b>Jim Amos of BLM – via email</b>	
By Whom? <b>Kimberly M. Wilson</b>	Date and Hour: <b>1/8/2015 @ 10:10 am</b>	
Was a Watercourse Reached? <input type="checkbox"/> Yes <input checked="" type="checkbox"/> No	If YES, Volume Impacting the Watercourse.	

If a Watercourse was Impacted, Describe Fully.\*

Describe Cause of Problem and Remedial Action Taken.\* **On January 7, 2015 a 1-inch steel nipple on the discharge gauge failed due to internal corrosion causing a release of 100 barrels of produced water. The SWD was shut-in, the nipple replaced and the well brought back into service. A vac truck was immediately called to the location and recovered 90 barrels of water. Talon/LPE was contacted for the correction of this release.**

Describe Area Affected and Cleanup Action Taken.\*

**The area impact area on location affected was the caliche pad measuring approximately 30-feet wide by 100-feet long.**

I hereby certify that the information given above is true and complete to the best of my knowledge and understand that pursuant to NMOCD rules and regulations all operators are required to report and/or file certain release notifications and perform corrective actions for releases which may endanger public health or the environment. The acceptance of a C-141 report by the NMOCD marked as "Final Report" does not relieve the operator of liability should their operations have failed to adequately investigate and remediate contamination that pose a threat to ground water, surface water, human health or the environment. In addition, NMOCD acceptance of a C-141 report does not relieve the operator of responsibility for compliance with any other federal, state, or local laws and/or regulations.

Signature: <b>Chris Jones</b> <small>Digitally signed by Chris Jones DN: cn=Chris Jones o, ou, email=cjones888@yahoo.com, c=US Date: 2015.01.09 14:08:01 -05'00'</small>	<u>OIL CONSERVATION DIVISION</u>	
Printed Name: <b>Chris Jones</b>	Approved by Environmental Specialist:	
Title: <b>HES Specialist</b>	Approval Date:	Expiration Date:
E-mail Address: <b>Christopher.Jones@oxy.com</b>	Conditions of Approval:	Attached <input type="checkbox"/>
Date: <b>1/9/2015</b> Phone: <b>575-628-4121</b>		

\* Attach Additional Sheets If Necessary



# New Mexico Office of the State Engineer

## Water Column/Average Depth to Water

(A CLW##### in the  
POD suffix indicates the  
POD has been replaced  
& no longer serves a  
water right file.)

(R=POD has  
been replaced,  
O=orphaned,  
C=the file is  
closed)

(quarters are 1=NW 2=NE 3=SW 4=SE)

(quarters are smallest to largest) (NAD83 UTM in meters)

(In feet)

POD Number	POD Sub-Code	basin	County	Q 64	Q 16	Q 4	Sec	Tws	Rng	X	Y	Distance	Depth Well	Depth Water	Water Column
<a href="#">C 00863</a>			ED	3	3	1	16	24S	29E	594524	3565091*	3385	220		
<a href="#">C 00863 CLW199506</a>	O		ED	3	3	1	16	24S	29E	594524	3565091*	3385	220		
<a href="#">C 00463</a>		C	ED	4	4	4	17	24S	29E	594332	3564282*	3435	260	4	256
<a href="#">C 02109</a>			ED	1	2	4	19	24S	30E	602130	3563412	4421	130	150	-20

Average Depth to Water: **77 feet**

Minimum Depth: **4 feet**

Maximum Depth: **150 feet**

Record Count: 4

UTMNAD83 Radius Search (in meters):

Easting (X): 597763

Northing (Y): 3564105

Radius: 5000

\*UTM location was derived from PLSS - see Help

The data is furnished by the NMOSE/ISC and is accepted by the recipient with the expressed understanding that the OSE/ISC make no warranties, expressed or implied, concerning the accuracy, completeness, reliability, usability, or suitability for any particular purpose of the data.



**APPENDIX III**  
**LABORATORY RESULTS**



PHONE (575) 393-2326 • 101 E. MARLAND • HOBBS, NM 88240

January 14, 2015

DAVID ADKINS

TALON LPE

408 W. TEXAS AVE.

ARTESIA, NM 88210

RE: RIVERBEND FED 8 SWD BATT

Enclosed are the results of analyses for samples received by the laboratory on 01/09/15 14:50.

Cardinal Laboratories is accredited through Texas NELAP under certificate number T104704398-13-5. Accreditation applies to drinking water, non-potable water and solid and chemical materials. All accredited analytes are denoted by an asterisk (\*). For a complete list of accredited analytes and matrices visit the TCEQ website at [www.tceq.texas.gov/field/qa/lab\\_accred\\_certif.html](http://www.tceq.texas.gov/field/qa/lab_accred_certif.html).

Cardinal Laboratories is accredited through the State of Colorado Department of Public Health and Environment for:

Method EPA 552.2	Haloacetic Acids (HAA-5)
Method EPA 524.2	Total Trihalomethanes (TTHM)
Method EPA 524.4	Regulated VOCs (V1, V2, V3)

Accreditation applies to public drinking water matrices.

This report meets NELAP requirements and is made up of a cover page, analytical results, and a copy of the original chain-of-custody. If you have any questions concerning this report, please feel free to contact me.

Sincerely,

Celey D. Keene

Lab Director/Quality Manager

**Analytical Results For:**

TALON LPE  
DAVID ADKINS  
408 W. TEXAS AVE.  
ARTESIA NM, 88210  
Fax To: (575) 745-8905

Received:	01/09/2015	Sampling Date:	01/08/2015
Reported:	01/14/2015	Sampling Type:	Soil
Project Name:	RIVERBEND FED 8 SWD BATT	Sampling Condition:	Cool & Intact
Project Number:	700608.390.01	Sample Received By:	Jodi Henson
Project Location:	SEC 23, T24S, R29E		

**Sample ID: S - 1 0' (H500076-01)**

BTEX 8021B		mg/kg		Analyzed By: MS					
Analyte	Result	Reporting Limit	Analyzed	Method Blank	BS	% Recovery	True Value QC	RPD	Qualifier
Benzene*	0.209	0.050	01/12/2015	ND	1.59	79.4	2.00	11.9	
Toluene*	0.720	0.050	01/12/2015	ND	1.57	78.5	2.00	10.5	
Ethylbenzene*	0.131	0.050	01/12/2015	ND	1.50	74.9	2.00	12.7	
Total Xylenes*	0.806	0.150	01/12/2015	ND	4.50	74.9	6.00	13.4	
Total BTEX	1.87	0.300	01/12/2015	ND					

Surrogate: 4-Bromofluorobenzene (PID) 93.5 % 61-154

Chloride, SM4500Cl-B		mg/kg		Analyzed By: AP					
Analyte	Result	Reporting Limit	Analyzed	Method Blank	BS	% Recovery	True Value QC	RPD	Qualifier
Chloride	27200	16.0	01/13/2015	ND	416	104	400	0.00	

TPH 8015M		mg/kg		Analyzed By: MS					
Analyte	Result	Reporting Limit	Analyzed	Method Blank	BS	% Recovery	True Value QC	RPD	Qualifier
GRO C6-C10	<10.0	10.0	01/12/2015	ND	191	95.7	200	0.00	
DRO >C10-C28	<10.0	10.0	01/12/2015	ND	194	97.2	200	0.00	

Surrogate: 1-Chlorooctane 88.4 % 47.2-157

Surrogate: 1-Chlorooctadecane 92.9 % 52.1-176

Cardinal Laboratories

\*=Accredited Analyte

PLEASE NOTE: Liability and Damages. Cardinal's liability and client's exclusive remedy for any claim arising, whether based in contract or tort, shall be limited to the amount paid by client for analyses. All claims, including those for negligence and any other cause whatsoever shall be deemed waived unless made in writing and received by Cardinal within thirty (30) days after completion of the applicable service. In no event shall Cardinal be liable for incidental or consequential damages, including, without limitation, business interruptions, loss of use, or loss of profits incurred by client, its subsidiaries, affiliates or successors arising out of or related to the performance of the services hereunder by Cardinal, regardless of whether such claim is based upon any of the above stated reasons or otherwise. Results relate only to the samples identified above. This report shall not be reproduced except in full with written approval of Cardinal Laboratories.



Celey D. Keene, Lab Director/Quality Manager

**Analytical Results For:**

TALON LPE  
DAVID ADKINS  
408 W. TEXAS AVE.  
ARTESIA NM, 88210  
Fax To: (575) 745-8905

Received: 01/09/2015  
Reported: 01/14/2015  
Project Name: RIVERBEND FED 8 SWD BATT  
Project Number: 700608.390.01  
Project Location: SEC 23, T24S, R29E

Sampling Date: 01/08/2015  
Sampling Type: Soil  
Sampling Condition: Cool & Intact  
Sample Received By: Jodi Henson

**Sample ID: S - 1 1' (H500076-02)**

BTEX 8021B			mg/kg		Analyzed By: MS				
Analyte	Result	Reporting Limit	Analyzed	Method Blank	BS	% Recovery	True Value QC	RPD	Qualifier
Benzene*	<0.050	0.050	01/12/2015	ND	1.59	79.4	2.00	11.9	
Toluene*	<0.050	0.050	01/12/2015	ND	1.57	78.5	2.00	10.5	
Ethylbenzene*	<0.050	0.050	01/12/2015	ND	1.50	74.9	2.00	12.7	
Total Xylenes*	<0.150	0.150	01/12/2015	ND	4.50	74.9	6.00	13.4	
Total BTEX	<0.300	0.300	01/12/2015	ND					

Surrogate: 4-Bromofluorobenzene (PID) 95.4 % 61-154

Chloride, SM4500Cl-B			mg/kg		Analyzed By: AP				
Analyte	Result	Reporting Limit	Analyzed	Method Blank	BS	% Recovery	True Value QC	RPD	Qualifier
Chloride	160	16.0	01/13/2015	ND	416	104	400	0.00	

TPH 8015M			mg/kg		Analyzed By: MS				
Analyte	Result	Reporting Limit	Analyzed	Method Blank	BS	% Recovery	True Value QC	RPD	Qualifier
GRO C6-C10	<10.0	10.0	01/12/2015	ND	191	95.7	200	0.00	
DRO >C10-C28	<10.0	10.0	01/12/2015	ND	194	97.2	200	0.00	

Surrogate: 1-Chlorooctane 80.3 % 47.2-157

Surrogate: 1-Chlorooctadecane 85.2 % 52.1-176

Cardinal Laboratories

\*=Accredited Analyte

PLEASE NOTE: Liability and Damages. Cardinal's liability and client's exclusive remedy for any claim arising, whether based in contract or tort, shall be limited to the amount paid by client for analyses. All claims, including those for negligence and any other cause whatsoever shall be deemed waived unless made in writing and received by Cardinal within thirty (30) days after completion of the applicable service. In no event shall Cardinal be liable for incidental or consequential damages, including, without limitation, business interruptions, loss of use, or loss of profits incurred by client, its subsidiaries, affiliates or successors arising out of or related to the performance of the services hereunder by Cardinal, regardless of whether such claim is based upon any of the above stated reasons or otherwise. Results relate only to the samples identified above. This report shall not be reproduced except in full with written approval of Cardinal Laboratories.



Celey D. Keene, Lab Director/Quality Manager

**Analytical Results For:**

TALON LPE  
DAVID ADKINS  
408 W. TEXAS AVE.  
ARTESIA NM, 88210  
Fax To: (575) 745-8905

Received:	01/09/2015	Sampling Date:	01/08/2015
Reported:	01/14/2015	Sampling Type:	Soil
Project Name:	RIVERBEND FED 8 SWD BATT	Sampling Condition:	Cool & Intact
Project Number:	700608.390.01	Sample Received By:	Jodi Henson
Project Location:	SEC 23, T24S, R29E		

**Sample ID: S - 1 2' (H500076-03)**

BTX 8021B			mg/kg		Analyzed By: MS				
Analyte	Result	Reporting Limit	Analyzed	Method Blank	BS	% Recovery	True Value QC	RPD	Qualifier
Benzene*	<0.050	0.050	01/12/2015	ND	1.59	79.4	2.00	11.9	
Toluene*	<0.050	0.050	01/12/2015	ND	1.57	78.5	2.00	10.5	
Ethylbenzene*	<0.050	0.050	01/12/2015	ND	1.50	74.9	2.00	12.7	
Total Xylenes*	<0.150	0.150	01/12/2015	ND	4.50	74.9	6.00	13.4	
Total BTX	<0.300	0.300	01/12/2015	ND					

Surrogate: 4-Bromofluorobenzene (PID) 96.3 % 61-154

Chloride, SM4500Cl-B			mg/kg		Analyzed By: AP				
Analyte	Result	Reporting Limit	Analyzed	Method Blank	BS	% Recovery	True Value QC	RPD	Qualifier
Chloride	64.0	16.0	01/13/2015	ND	416	104	400	0.00	

TPH 8015M			mg/kg		Analyzed By: MS				
Analyte	Result	Reporting Limit	Analyzed	Method Blank	BS	% Recovery	True Value QC	RPD	Qualifier
GRO C6-C10	<10.0	10.0	01/12/2015	ND	191	95.7	200	0.00	
DRO >C10-C28	<10.0	10.0	01/12/2015	ND	194	97.2	200	0.00	

Surrogate: 1-Chlorooctane 82.7 % 47.2-157

Surrogate: 1-Chlorooctadecane 92.2 % 52.1-176

Cardinal Laboratories

\*=Accredited Analyte

PLEASE NOTE: Liability and Damages. Cardinal's liability and client's exclusive remedy for any claim arising, whether based in contract or tort, shall be limited to the amount paid by client for analyses. All claims, including those for negligence and any other cause whatsoever shall be deemed waived unless made in writing and received by Cardinal within thirty (30) days after completion of the applicable service. In no event shall Cardinal be liable for incidental or consequential damages, including, without limitation, business interruptions, loss of use, or loss of profits incurred by client, its subsidiaries, affiliates or successors arising out of or related to the performance of the services hereunder by Cardinal, regardless of whether such claim is based upon any of the above stated reasons or otherwise. Results relate only to the samples identified above. This report shall not be reproduced except in full with written approval of Cardinal Laboratories.



Celey D. Keene, Lab Director/Quality Manager



**Analytical Results For:**

TALON LPE  
DAVID ADKINS  
408 W. TEXAS AVE.  
ARTESIA NM, 88210  
Fax To: (575) 745-8905

Received:	01/09/2015	Sampling Date:	01/08/2015
Reported:	01/14/2015	Sampling Type:	Soil
Project Name:	RIVERBEND FED 8 SWD BATT	Sampling Condition:	Cool & Intact
Project Number:	700608.390.01	Sample Received By:	Jodi Henson
Project Location:	SEC 23, T24S, R29E		

**Sample ID: S - 1 3' (H500076-04)**

BTX 8021B		mg/kg		Analyzed By: MS					
Analyte	Result	Reporting Limit	Analyzed	Method Blank	BS	% Recovery	True Value QC	RPD	Qualifier
Benzene*	<0.050	0.050	01/12/2015	ND	1.59	79.4	2.00	11.9	
Toluene*	<0.050	0.050	01/12/2015	ND	1.57	78.5	2.00	10.5	
Ethylbenzene*	<0.050	0.050	01/12/2015	ND	1.50	74.9	2.00	12.7	
Total Xylenes*	<0.150	0.150	01/12/2015	ND	4.50	74.9	6.00	13.4	
Total BTX	<0.300	0.300	01/12/2015	ND					

Surrogate: 4-Bromofluorobenzene (PID) 94.8 % 61-154

Chloride, SM4500Cl-B		mg/kg		Analyzed By: AP					
Analyte	Result	Reporting Limit	Analyzed	Method Blank	BS	% Recovery	True Value QC	RPD	Qualifier
Chloride	16.0	16.0	01/13/2015	ND	416	104	400	0.00	

TPH 8015M		mg/kg		Analyzed By: MS					
Analyte	Result	Reporting Limit	Analyzed	Method Blank	BS	% Recovery	True Value QC	RPD	Qualifier
GRO C6-C10	<10.0	10.0	01/12/2015	ND	191	95.7	200	0.00	
DRO >C10-C28	<10.0	10.0	01/12/2015	ND	194	97.2	200	0.00	

Surrogate: 1-Chlorooctane 86.2 % 47.2-157

Surrogate: 1-Chlorooctadecane 94.4 % 52.1-176

Cardinal Laboratories

\*=Accredited Analyte

PLEASE NOTE: Liability and Damages. Cardinal's liability and client's exclusive remedy for any claim arising, whether based in contract or tort, shall be limited to the amount paid by client for analyses. All claims, including those for negligence and any other cause whatsoever shall be deemed waived unless made in writing and received by Cardinal within thirty (30) days after completion of the applicable service. In no event shall Cardinal be liable for incidental or consequential damages, including, without limitation, business interruptions, loss of use, or loss of profits incurred by client, its subsidiaries, affiliates or successors arising out of or related to the performance of the services hereunder by Cardinal, regardless of whether such claim is based upon any of the above stated reasons or otherwise. Results relate only to the samples identified above. This report shall not be reproduced except in full with written approval of Cardinal Laboratories.



Celey D. Keene, Lab Director/Quality Manager

### Analytical Results For:

TALON LPE  
DAVID ADKINS  
408 W. TEXAS AVE.  
ARTESIA NM, 88210  
Fax To: (575) 745-8905

Received: 01/09/2015  
Reported: 01/14/2015  
Project Name: RIVERBEND FED 8 SWD BATT  
Project Number: 700608.390.01  
Project Location: SEC 23, T24S, R29E

Sampling Date: 01/08/2015  
Sampling Type: Soil  
Sampling Condition: Cool & Intact  
Sample Received By: Jodi Henson

### Sample ID: S - 1 4' (H500076-05)

BTEX 8021B			mg/kg		Analyzed By: MS				
Analyte	Result	Reporting Limit	Analyzed	Method Blank	BS	% Recovery	True Value QC	RPD	Qualifier
Benzene*	<0.050	0.050	01/12/2015	ND	1.59	79.4	2.00	11.9	
Toluene*	<0.050	0.050	01/12/2015	ND	1.57	78.5	2.00	10.5	
Ethylbenzene*	<0.050	0.050	01/12/2015	ND	1.50	74.9	2.00	12.7	
Total Xylenes*	<0.150	0.150	01/12/2015	ND	4.50	74.9	6.00	13.4	
Total BTEX	<0.300	0.300	01/12/2015	ND					

Surrogate: 4-Bromofluorobenzene (PID) 95.8 % 61-154

Chloride, SM4500Cl-B			mg/kg		Analyzed By: AP				
Analyte	Result	Reporting Limit	Analyzed	Method Blank	BS	% Recovery	True Value QC	RPD	Qualifier
Chloride	80.0	16.0	01/13/2015	ND	416	104	400	0.00	

TPH 8015M			mg/kg		Analyzed By: MS				
Analyte	Result	Reporting Limit	Analyzed	Method Blank	BS	% Recovery	True Value QC	RPD	Qualifier
GRO C6-C10	<10.0	10.0	01/12/2015	ND	191	95.7	200	0.00	
DRO >C10-C28	<10.0	10.0	01/12/2015	ND	194	97.2	200	0.00	

Surrogate: 1-Chlorooctane 82.9 % 47.2-157

Surrogate: 1-Chlorooctadecane 86.6 % 52.1-176

Cardinal Laboratories

\*=Accredited Analyte

PLEASE NOTE: Liability and Damages. Cardinal's liability and client's exclusive remedy for any claim arising, whether based in contract or tort, shall be limited to the amount paid by client for analyses. All claims, including those for negligence and any other cause whatsoever shall be deemed waived unless made in writing and received by Cardinal within thirty (30) days after completion of the applicable service. In no event shall Cardinal be liable for incidental or consequential damages, including, without limitation, business interruptions, loss of use, or loss of profits incurred by client, its subsidiaries, affiliates or successors arising out of or related to the performance of the services hereunder by Cardinal, regardless of whether such claim is based upon any of the above stated reasons or otherwise. Results relate only to the samples identified above. This report shall not be reproduced except in full with written approval of Cardinal Laboratories.



Celey D. Keene, Lab Director/Quality Manager

**Analytical Results For:**

TALON LPE  
DAVID ADKINS  
408 W. TEXAS AVE.  
ARTESIA NM, 88210  
Fax To: (575) 745-8905

Received:	01/09/2015	Sampling Date:	01/08/2015
Reported:	01/14/2015	Sampling Type:	Soil
Project Name:	RIVERBEND FED 8 SWD BATT	Sampling Condition:	Cool & Intact
Project Number:	700608.390.01	Sample Received By:	Jodi Henson
Project Location:	SEC 23, T24S, R29E		

**Sample ID: S - 2 0' (H500076-06)**

BTX 8021B		mg/kg		Analyzed By: MS					
Analyte	Result	Reporting Limit	Analyzed	Method Blank	BS	% Recovery	True Value QC	RPD	Qualifier
Benzene*	<0.050	0.050	01/12/2015	ND	1.59	79.4	2.00	11.9	
Toluene*	<b>0.121</b>	0.050	01/12/2015	ND	1.57	78.5	2.00	10.5	
Ethylbenzene*	<0.050	0.050	01/12/2015	ND	1.50	74.9	2.00	12.7	
<b>Total Xylenes*</b>	<b>0.242</b>	0.150	01/12/2015	ND	4.50	74.9	6.00	13.4	
<b>Total BTX</b>	<b>0.363</b>	0.300	01/12/2015	ND					

Surrogate: 4-Bromofluorobenzene (PID) 98.7 % 61-154

Chloride, SM4500Cl-B		mg/kg		Analyzed By: AP					
Analyte	Result	Reporting Limit	Analyzed	Method Blank	BS	% Recovery	True Value QC	RPD	Qualifier
<b>Chloride</b>	<b>24400</b>	16.0	01/13/2015	ND	416	104	400	0.00	

TPH 8015M		mg/kg		Analyzed By: MS					
Analyte	Result	Reporting Limit	Analyzed	Method Blank	BS	% Recovery	True Value QC	RPD	Qualifier
GRO C6-C10	<10.0	10.0	01/12/2015	ND	191	95.7	200	0.00	
DRO >C10-C28	<10.0	10.0	01/12/2015	ND	194	97.2	200	0.00	

Surrogate: 1-Chlorooctane 85.1 % 47.2-157

Surrogate: 1-Chlorooctadecane 94.4 % 52.1-176

Cardinal Laboratories

\*=Accredited Analyte

PLEASE NOTE: Liability and Damages. Cardinal's liability and client's exclusive remedy for any claim arising, whether based in contract or tort, shall be limited to the amount paid by client for analyses. All claims, including those for negligence and any other cause whatsoever shall be deemed waived unless made in writing and received by Cardinal within thirty (30) days after completion of the applicable service. In no event shall Cardinal be liable for incidental or consequential damages, including, without limitation, business interruptions, loss of use, or loss of profits incurred by client, its subsidiaries, affiliates or successors arising out of or related to the performance of the services hereunder by Cardinal, regardless of whether such claim is based upon any of the above stated reasons or otherwise. Results relate only to the samples identified above. This report shall not be reproduced except in full with written approval of Cardinal Laboratories.



Celey D. Keene, Lab Director/Quality Manager

### Analytical Results For:

TALON LPE  
DAVID ADKINS  
408 W. TEXAS AVE.  
ARTESIA NM, 88210  
Fax To: (575) 745-8905

Received:	01/09/2015	Sampling Date:	01/08/2015
Reported:	01/14/2015	Sampling Type:	Soil
Project Name:	RIVERBEND FED 8 SWD BATT	Sampling Condition:	Cool & Intact
Project Number:	700608.390.01	Sample Received By:	Jodi Henson
Project Location:	SEC 23, T24S, R29E		

### Sample ID: S - 2 1' (H500076-07)

BTEX 8021B		mg/kg		Analyzed By: MS					
Analyte	Result	Reporting Limit	Analyzed	Method Blank	BS	% Recovery	True Value QC	RPD	Qualifier
Benzene*	<0.050	0.050	01/12/2015	ND	1.59	79.4	2.00	11.9	
Toluene*	<0.050	0.050	01/12/2015	ND	1.57	78.5	2.00	10.5	
Ethylbenzene*	<0.050	0.050	01/12/2015	ND	1.50	74.9	2.00	12.7	
Total Xylenes*	<0.150	0.150	01/12/2015	ND	4.50	74.9	6.00	13.4	
Total BTEX	<0.300	0.300	01/12/2015	ND					

Surrogate: 4-Bromofluorobenzene (PID) 96.4 % 61-154

Chloride, SM4500Cl-B		mg/kg		Analyzed By: AP					
Analyte	Result	Reporting Limit	Analyzed	Method Blank	BS	% Recovery	True Value QC	RPD	Qualifier
Chloride	1630	16.0	01/13/2015	ND	416	104	400	0.00	

TPH 8015M		mg/kg		Analyzed By: MS					
Analyte	Result	Reporting Limit	Analyzed	Method Blank	BS	% Recovery	True Value QC	RPD	Qualifier
GRO C6-C10	<10.0	10.0	01/12/2015	ND	191	95.7	200	0.00	
DRO >C10-C28	<10.0	10.0	01/12/2015	ND	194	97.2	200	0.00	

Surrogate: 1-Chlorooctane 82.4 % 47.2-157

Surrogate: 1-Chlorooctadecane 90.9 % 52.1-176

Cardinal Laboratories

\*=Accredited Analyte

PLEASE NOTE: Liability and Damages. Cardinal's liability and client's exclusive remedy for any claim arising, whether based in contract or tort, shall be limited to the amount paid by client for analyses. All claims, including those for negligence and any other cause whatsoever shall be deemed waived unless made in writing and received by Cardinal within thirty (30) days after completion of the applicable service. In no event shall Cardinal be liable for incidental or consequential damages, including, without limitation, business interruptions, loss of use, or loss of profits incurred by client, its subsidiaries, affiliates or successors arising out of or related to the performance of the services hereunder by Cardinal, regardless of whether such claim is based upon any of the above stated reasons or otherwise. Results relate only to the samples identified above. This report shall not be reproduced except in full with written approval of Cardinal Laboratories.



Celey D. Keene, Lab Director/Quality Manager

**Analytical Results For:**

TALON LPE  
DAVID ADKINS  
408 W. TEXAS AVE.  
ARTESIA NM, 88210  
Fax To: (575) 745-8905

Received:	01/09/2015	Sampling Date:	01/08/2015
Reported:	01/14/2015	Sampling Type:	Soil
Project Name:	RIVERBEND FED 8 SWD BATT	Sampling Condition:	Cool & Intact
Project Number:	700608.390.01	Sample Received By:	Jodi Henson
Project Location:	SEC 23, T24S, R29E		

**Sample ID: S -2 2' (H500076-08)**

BTX 8021B			mg/kg		Analyzed By: CK					
Analyte	Result	Reporting Limit	Analyzed	Method Blank	BS	% Recovery	True Value QC	RPD	Qualifier	
Benzene*	<0.050	0.050	01/13/2015	ND	1.74	86.8	2.00	2.77		
Toluene*	<0.050	0.050	01/13/2015	ND	1.70	84.9	2.00	2.67		
Ethylbenzene*	<0.050	0.050	01/13/2015	ND	1.64	82.0	2.00	2.15		
Total Xylenes*	<0.150	0.150	01/13/2015	ND	4.93	82.1	6.00	2.57		
Total BTX	<0.300	0.300	01/13/2015	ND						

Surrogate: 4-Bromofluorobenzene (PID) 94.2 % 61-154

Chloride, SM4500Cl-B		mg/kg		Analyzed By: AP					
Analyte	Result	Reporting Limit	Analyzed	Method Blank	BS	% Recovery	True Value QC	RPD	Qualifier
Chloride	32.0	16.0	01/13/2015	ND	400	100	400	3.92	

TPH 8015M		mg/kg		Analyzed By: MS					
Analyte	Result	Reporting Limit	Analyzed	Method Blank	BS	% Recovery	True Value QC	RPD	Qualifier
GRO C6-C10	<10.0	10.0	01/12/2015	ND	191	95.7	200	0.00	
DRO >C10-C28	<10.0	10.0	01/12/2015	ND	194	97.2	200	0.00	

Surrogate: 1-Chlorooctane 81.8 % 47.2-157

Surrogate: 1-Chlorooctadecane 83.7 % 52.1-176

Cardinal Laboratories

\*=Accredited Analyte

PLEASE NOTE: Liability and Damages. Cardinal's liability and client's exclusive remedy for any claim arising, whether based in contract or tort, shall be limited to the amount paid by client for analyses. All claims, including those for negligence and any other cause whatsoever shall be deemed waived unless made in writing and received by Cardinal within thirty (30) days after completion of the applicable service. In no event shall Cardinal be liable for incidental or consequential damages, including, without limitation, business interruptions, loss of use, or loss of profits incurred by client, its subsidiaries, affiliates or successors arising out of or related to the performance of the services hereunder by Cardinal, regardless of whether such claim is based upon any of the above stated reasons or otherwise. Results relate only to the samples identified above. This report shall not be reproduced except in full with written approval of Cardinal Laboratories.



Celey D. Keene, Lab Director/Quality Manager



**Analytical Results For:**

TALON LPE  
DAVID ADKINS  
408 W. TEXAS AVE.  
ARTESIA NM, 88210  
Fax To: (575) 745-8905

Received:	01/09/2015	Sampling Date:	01/08/2015
Reported:	01/14/2015	Sampling Type:	Soil
Project Name:	RIVERBEND FED 8 SWD BATT	Sampling Condition:	Cool & Intact
Project Number:	700608.390.01	Sample Received By:	Jodi Henson
Project Location:	SEC 23, T24S, R29E		

**Sample ID: S - 2 3' (H500076-09)**

BTX 8021B			mg/kg		Analyzed By: CK				
Analyte	Result	Reporting Limit	Analyzed	Method Blank	BS	% Recovery	True Value QC	RPD	Qualifier
Benzene*	<0.050	0.050	01/13/2015	ND	1.74	86.8	2.00	2.77	
Toluene*	<0.050	0.050	01/13/2015	ND	1.70	84.9	2.00	2.67	
Ethylbenzene*	<0.050	0.050	01/13/2015	ND	1.64	82.0	2.00	2.15	
Total Xylenes*	<0.150	0.150	01/13/2015	ND	4.93	82.1	6.00	2.57	
Total BTX	<0.300	0.300	01/13/2015	ND					

Surrogate: 4-Bromofluorobenzene (PID) 94.2 % 61-154

Chloride, SM4500Cl-B			mg/kg		Analyzed By: AP				
Analyte	Result	Reporting Limit	Analyzed	Method Blank	BS	% Recovery	True Value QC	RPD	Qualifier
Chloride	<16.0	16.0	01/13/2015	ND	400	100	400	3.92	

TPH 8015M			mg/kg		Analyzed By: MS				
Analyte	Result	Reporting Limit	Analyzed	Method Blank	BS	% Recovery	True Value QC	RPD	Qualifier
GRO C6-C10	<10.0	10.0	01/12/2015	ND	191	95.7	200	0.00	
DRO >C10-C28	<10.0	10.0	01/12/2015	ND	194	97.2	200	0.00	

Surrogate: 1-Chlorooctane 84.8 % 47.2-157

Surrogate: 1-Chlorooctadecane 89.0 % 52.1-176

Cardinal Laboratories

\*=Accredited Analyte

PLEASE NOTE: Liability and Damages. Cardinal's liability and client's exclusive remedy for any claim arising, whether based in contract or tort, shall be limited to the amount paid by client for analyses. All claims, including those for negligence and any other cause whatsoever shall be deemed waived unless made in writing and received by Cardinal within thirty (30) days after completion of the applicable service. In no event shall Cardinal be liable for incidental or consequential damages, including, without limitation, business interruptions, loss of use, or loss of profits incurred by client, its subsidiaries, affiliates or successors arising out of or related to the performance of the services hereunder by Cardinal, regardless of whether such claim is based upon any of the above stated reasons or otherwise. Results relate only to the samples identified above. This report shall not be reproduced except in full with written approval of Cardinal Laboratories.



Celey D. Keene, Lab Director/Quality Manager

**Analytical Results For:**

TALON LPE  
DAVID ADKINS  
408 W. TEXAS AVE.  
ARTESIA NM, 88210  
Fax To: (575) 745-8905

Received:	01/09/2015	Sampling Date:	01/08/2015
Reported:	01/14/2015	Sampling Type:	Soil
Project Name:	RIVERBEND FED 8 SWD BATT	Sampling Condition:	Cool & Intact
Project Number:	700608.390.01	Sample Received By:	Jodi Henson
Project Location:	SEC 23, T24S, R29E		

**Sample ID: S - 2 4' (H500076-10)**

BTEX 8021B			mg/kg		Analyzed By: CK				
Analyte	Result	Reporting Limit	Analyzed	Method Blank	BS	% Recovery	True Value QC	RPD	Qualifier
Benzene*	<0.050	0.050	01/13/2015	ND	1.74	86.8	2.00	2.77	
Toluene*	<0.050	0.050	01/13/2015	ND	1.70	84.9	2.00	2.67	
Ethylbenzene*	<0.050	0.050	01/13/2015	ND	1.64	82.0	2.00	2.15	
Total Xylenes*	<0.150	0.150	01/13/2015	ND	4.93	82.1	6.00	2.57	
Total BTEX	<0.300	0.300	01/13/2015	ND					

Surrogate: 4-Bromofluorobenzene (PID) 95.7 % 61-154

Chloride, SM4500Cl-B			mg/kg		Analyzed By: AP				
Analyte	Result	Reporting Limit	Analyzed	Method Blank	BS	% Recovery	True Value QC	RPD	Qualifier
Chloride	384	16.0	01/13/2015	ND	400	100	400	3.92	

TPH 8015M			mg/kg		Analyzed By: MS				
Analyte	Result	Reporting Limit	Analyzed	Method Blank	BS	% Recovery	True Value QC	RPD	Qualifier
GRO C6-C10	<10.0	10.0	01/12/2015	ND	191	95.7	200	0.00	
DRO >C10-C28	<10.0	10.0	01/12/2015	ND	194	97.2	200	0.00	

Surrogate: 1-Chlorooctane 81.9 % 47.2-157

Surrogate: 1-Chlorooctadecane 83.0 % 52.1-176

Cardinal Laboratories

\*=Accredited Analyte

PLEASE NOTE: Liability and Damages. Cardinal's liability and client's exclusive remedy for any claim arising, whether based in contract or tort, shall be limited to the amount paid by client for analyses. All claims, including those for negligence and any other cause whatsoever shall be deemed waived unless made in writing and received by Cardinal within thirty (30) days after completion of the applicable service. In no event shall Cardinal be liable for incidental or consequential damages, including, without limitation, business interruptions, loss of use, or loss of profits incurred by client, its subsidiaries, affiliates or successors arising out of or related to the performance of the services hereunder by Cardinal, regardless of whether such claim is based upon any of the above stated reasons or otherwise. Results relate only to the samples identified above. This report shall not be reproduced except in full with written approval of Cardinal Laboratories.



Celey D. Keene, Lab Director/Quality Manager

### Analytical Results For:

TALON LPE  
DAVID ADKINS  
408 W. TEXAS AVE.  
ARTESIA NM, 88210  
Fax To: (575) 745-8905

Received:	01/09/2015	Sampling Date:	01/08/2015
Reported:	01/14/2015	Sampling Type:	Soil
Project Name:	RIVERBEND FED 8 SWD BATT	Sampling Condition:	Cool & Intact
Project Number:	700608.390.01	Sample Received By:	Jodi Henson
Project Location:	SEC 23, T24S, R29E		

### Sample ID: S - 3 0' (H500076-11)

BTX 8021B		mg/kg		Analyzed By: CK					
Analyte	Result	Reporting Limit	Analyzed	Method Blank	BS	% Recovery	True Value QC	RPD	Qualifier
Benzene*	<0.050	0.050	01/13/2015	ND	1.74	86.8	2.00	2.77	
Toluene*	<0.050	0.050	01/13/2015	ND	1.70	84.9	2.00	2.67	
Ethylbenzene*	<0.050	0.050	01/13/2015	ND	1.64	82.0	2.00	2.15	
Total Xylenes*	<0.150	0.150	01/13/2015	ND	4.93	82.1	6.00	2.57	
Total BTX	<0.300	0.300	01/13/2015	ND					

Surrogate: 4-Bromofluorobenzene (PID) 94.7 % 61-154

Chloride, SM4500Cl-B		mg/kg		Analyzed By: AP					
Analyte	Result	Reporting Limit	Analyzed	Method Blank	BS	% Recovery	True Value QC	RPD	Qualifier
Chloride	12600	16.0	01/13/2015	ND	400	100	400	3.92	

TPH 8015M		mg/kg		Analyzed By: MS					
Analyte	Result	Reporting Limit	Analyzed	Method Blank	BS	% Recovery	True Value QC	RPD	Qualifier
GRO C6-C10	<10.0	10.0	01/12/2015	ND	191	95.7	200	0.00	
DRO >C10-C28	<10.0	10.0	01/12/2015	ND	194	97.2	200	0.00	

Surrogate: 1-Chlorooctane 78.0 % 47.2-157

Surrogate: 1-Chlorooctadecane 85.4 % 52.1-176

Cardinal Laboratories

\*=Accredited Analyte

PLEASE NOTE: Liability and Damages. Cardinal's liability and client's exclusive remedy for any claim arising, whether based in contract or tort, shall be limited to the amount paid by client for analyses. All claims, including those for negligence and any other cause whatsoever shall be deemed waived unless made in writing and received by Cardinal within thirty (30) days after completion of the applicable service. In no event shall Cardinal be liable for incidental or consequential damages, including, without limitation, business interruptions, loss of use, or loss of profits incurred by client, its subsidiaries, affiliates or successors arising out of or related to the performance of the services hereunder by Cardinal, regardless of whether such claim is based upon any of the above stated reasons or otherwise. Results relate only to the samples identified above. This report shall not be reproduced except in full with written approval of Cardinal Laboratories.



Celey D. Keene, Lab Director/Quality Manager

**Analytical Results For:**

TALON LPE  
DAVID ADKINS  
408 W. TEXAS AVE.  
ARTESIA NM, 88210  
Fax To: (575) 745-8905

Received: 01/09/2015  
Reported: 01/14/2015  
Project Name: RIVERBEND FED 8 SWD BATT  
Project Number: 700608.390.01  
Project Location: SEC 23, T24S, R29E

Sampling Date: 01/08/2015  
Sampling Type: Soil  
Sampling Condition: Cool & Intact  
Sample Received By: Jodi Henson

**Sample ID: S - 3 1' (H500076-12)**

BTEX 8021B		mg/kg		Analyzed By: CK					
Analyte	Result	Reporting Limit	Analyzed	Method Blank	BS	% Recovery	True Value QC	RPD	Qualifier
Benzene*	<0.050	0.050	01/13/2015	ND	1.74	86.8	2.00	2.77	
Toluene*	<0.050	0.050	01/13/2015	ND	1.70	84.9	2.00	2.67	
Ethylbenzene*	<0.050	0.050	01/13/2015	ND	1.64	82.0	2.00	2.15	
Total Xylenes*	<0.150	0.150	01/13/2015	ND	4.93	82.1	6.00	2.57	
Total BTEX	<0.300	0.300	01/13/2015	ND					

Surrogate: 4-Bromofluorobenzene (PID) 94.7 % 61-154

Chloride, SM4500Cl-B		mg/kg		Analyzed By: AP					
Analyte	Result	Reporting Limit	Analyzed	Method Blank	BS	% Recovery	True Value QC	RPD	Qualifier
Chloride	144	16.0	01/13/2015	ND	400	100	400	3.92	

TPH 8015M		mg/kg		Analyzed By: MS					
Analyte	Result	Reporting Limit	Analyzed	Method Blank	BS	% Recovery	True Value QC	RPD	Qualifier
GRO C6-C10	<10.0	10.0	01/12/2015	ND	191	95.7	200	0.00	
DRO >C10-C28	<10.0	10.0	01/12/2015	ND	194	97.2	200	0.00	

Surrogate: 1-Chlorooctane 75.8 % 47.2-157

Surrogate: 1-Chlorooctadecane 77.3 % 52.1-176

Cardinal Laboratories

\*=Accredited Analyte

PLEASE NOTE: Liability and Damages. Cardinal's liability and client's exclusive remedy for any claim arising, whether based in contract or tort, shall be limited to the amount paid by client for analyses. All claims, including those for negligence and any other cause whatsoever shall be deemed waived unless made in writing and received by Cardinal within thirty (30) days after completion of the applicable service. In no event shall Cardinal be liable for incidental or consequential damages, including, without limitation, business interruptions, loss of use, or loss of profits incurred by client, its subsidiaries, affiliates or successors arising out of or related to the performance of the services hereunder by Cardinal, regardless of whether such claim is based upon any of the above stated reasons or otherwise. Results relate only to the samples identified above. This report shall not be reproduced except in full with written approval of Cardinal Laboratories.

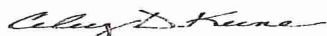

Celey D. Keene, Lab Director/Quality Manager

### Analytical Results For:

TALON LPE  
DAVID ADKINS  
408 W. TEXAS AVE.  
ARTESIA NM, 88210  
Fax To: (575) 745-8905

Received:	01/09/2015	Sampling Date:	01/08/2015
Reported:	01/14/2015	Sampling Type:	Soil
Project Name:	RIVERBEND FED 8 SWD BATT	Sampling Condition:	Cool & Intact
Project Number:	700608.390.01	Sample Received By:	Jodi Henson
Project Location:	SEC 23, T24S, R29E		

### Sample ID: S - 3 2' (H500076-13)

BTEX 8021B			mg/kg		Analyzed By: CK				
Analyte	Result	Reporting Limit	Analyzed	Method Blank	BS	% Recovery	True Value QC	RPD	Qualifier
Benzene*	<0.050	0.050	01/13/2015	ND	1.74	86.8	2.00	2.77	
Toluene*	<0.050	0.050	01/13/2015	ND	1.70	84.9	2.00	2.67	
Ethylbenzene*	<0.050	0.050	01/13/2015	ND	1.64	82.0	2.00	2.15	
Total Xylenes*	<0.150	0.150	01/13/2015	ND	4.93	82.1	6.00	2.57	
Total BTEX	<0.300	0.300	01/13/2015	ND					

Surrogate: 4-Bromofluorobenzene (PID) 92.2 % 61-154

Chloride, SM4500Cl-B			mg/kg		Analyzed By: AP				
Analyte	Result	Reporting Limit	Analyzed	Method Blank	BS	% Recovery	True Value QC	RPD	Qualifier
Chloride	208	16.0	01/13/2015	ND	400	100	400	3.92	

TPH 8015M			mg/kg		Analyzed By: MS				
Analyte	Result	Reporting Limit	Analyzed	Method Blank	BS	% Recovery	True Value QC	RPD	Qualifier
GRO C6-C10	<10.0	10.0	01/12/2015	ND	191	95.7	200	0.00	
DRO >C10-C28	<10.0	10.0	01/12/2015	ND	194	97.2	200	0.00	

Surrogate: 1-Chlorooctane 78.2 % 47.2-157

Surrogate: 1-Chlorooctadecane 78.4 % 52.1-176

Cardinal Laboratories

\*=Accredited Analyte

PLEASE NOTE: Liability and Damages. Cardinal's liability and client's exclusive remedy for any claim arising, whether based in contract or tort, shall be limited to the amount paid by client for analyses. All claims, including those for negligence and any other cause whatsoever shall be deemed waived unless made in writing and received by Cardinal within thirty (30) days after completion of the applicable service. In no event shall Cardinal be liable for incidental or consequential damages, including, without limitation, business interruptions, loss of use, or loss of profits incurred by client, its subsidiaries, affiliates or successors arising out of or related to the performance of the services hereunder by Cardinal, regardless of whether such claim is based upon any of the above stated reasons or otherwise. Results relate only to the samples identified above. This report shall not be reproduced except in full with written approval of Cardinal Laboratories.

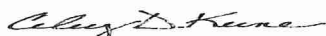

Celey D. Keene, Lab Director/Quality Manager



**Analytical Results For:**

TALON LPE  
DAVID ADKINS  
408 W. TEXAS AVE.  
ARTESIA NM, 88210  
Fax To: (575) 745-8905

Received:	01/09/2015	Sampling Date:	01/08/2015
Reported:	01/14/2015	Sampling Type:	Soil
Project Name:	RIVERBEND FED 8 SWD BATT	Sampling Condition:	Cool & Intact
Project Number:	700608.390.01	Sample Received By:	Jodi Henson
Project Location:	SEC 23, T24S, R29E		

**Sample ID: S - 3 3' (H500076-14)**

BTEX 8021B			mg/kg		Analyzed By: CK				
Analyte	Result	Reporting Limit	Analyzed	Method Blank	BS	% Recovery	True Value QC	RPD	Qualifier
Benzene*	<0.050	0.050	01/13/2015	ND	1.74	86.8	2.00	2.77	
Toluene*	<0.050	0.050	01/13/2015	ND	1.70	84.9	2.00	2.67	
Ethylbenzene*	<0.050	0.050	01/13/2015	ND	1.64	82.0	2.00	2.15	
Total Xylenes*	<0.150	0.150	01/13/2015	ND	4.93	82.1	6.00	2.57	
Total BTEX	<0.300	0.300	01/13/2015	ND					

Surrogate: 4-Bromofluorobenzene (PID) 92.9 % 61-154

Chloride, SM4500Cl-B			mg/kg		Analyzed By: AP				
Analyte	Result	Reporting Limit	Analyzed	Method Blank	BS	% Recovery	True Value QC	RPD	Qualifier
Chloride	<16.0	16.0	01/13/2015	ND	400	100	400	3.92	

TPH 8015M			mg/kg		Analyzed By: MS				
Analyte	Result	Reporting Limit	Analyzed	Method Blank	BS	% Recovery	True Value QC	RPD	Qualifier
GRO C6-C10	<10.0	10.0	01/12/2015	ND	198	98.8	200	3.28	
DRO >C10-C28	<10.0	10.0	01/12/2015	ND	208	104	200	2.79	

Surrogate: 1-Chlorooctane 89.1 % 47.2-157

Surrogate: 1-Chlorooctadecane 84.9 % 52.1-176

Cardinal Laboratories

\*=Accredited Analyte

PLEASE NOTE: Liability and Damages. Cardinal's liability and client's exclusive remedy for any claim arising, whether based in contract or tort, shall be limited to the amount paid by client for analyses. All claims, including those for negligence and any other cause whatsoever shall be deemed waived unless made in writing and received by Cardinal within thirty (30) days after completion of the applicable service. In no event shall Cardinal be liable for incidental or consequential damages, including, without limitation, business interruptions, loss of use, or loss of profits incurred by client, its subsidiaries, affiliates or successors arising out of or related to the performance of the services hereunder by Cardinal, regardless of whether such claim is based upon any of the above stated reasons or otherwise. Results relate only to the samples identified above. This report shall not be reproduced except in full with written approval of Cardinal Laboratories.

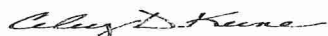

Celey D. Keene, Lab Director/Quality Manager

**Analytical Results For:**

TALON LPE  
DAVID ADKINS  
408 W. TEXAS AVE.  
ARTESIA NM, 88210  
Fax To: (575) 745-8905

Received:	01/09/2015	Sampling Date:	01/08/2015
Reported:	01/14/2015	Sampling Type:	Soil
Project Name:	RIVERBEND FED 8 SWD BATT	Sampling Condition:	Cool & Intact
Project Number:	700608.390.01	Sample Received By:	Jodi Henson
Project Location:	SEC 23, T24S, R29E		

**Sample ID: S - 3 4' (H500076-15)**

BTEX 8021B			mg/kg		Analyzed By: CK				
Analyte	Result	Reporting Limit	Analyzed	Method Blank	BS	% Recovery	True Value QC	RPD	Qualifier
Benzene*	<0.050	0.050	01/13/2015	ND	1.74	86.8	2.00	2.77	
Toluene*	<0.050	0.050	01/13/2015	ND	1.70	84.9	2.00	2.67	
Ethylbenzene*	<0.050	0.050	01/13/2015	ND	1.64	82.0	2.00	2.15	
Total Xylenes*	<0.150	0.150	01/13/2015	ND	4.93	82.1	6.00	2.57	
Total BTEX	<0.300	0.300	01/13/2015	ND					

Surrogate: 4-Bromofluorobenzene (PID) 94.4 % 61-154

Chloride, SM4500Cl-B			mg/kg		Analyzed By: AP				
Analyte	Result	Reporting Limit	Analyzed	Method Blank	BS	% Recovery	True Value QC	RPD	Qualifier
Chloride	<16.0	16.0	01/13/2015	ND	400	100	400	3.92	

TPH 8015M			mg/kg		Analyzed By: MS				
Analyte	Result	Reporting Limit	Analyzed	Method Blank	BS	% Recovery	True Value QC	RPD	Qualifier
GRO C6-C10	<10.0	10.0	01/12/2015	ND	198	98.8	200	3.28	
DRO >C10-C28	<10.0	10.0	01/12/2015	ND	208	104	200	2.79	

Surrogate: 1-Chlorooctane 90.1 % 47.2-157

Surrogate: 1-Chlorooctadecane 102 % 52.1-176

Cardinal Laboratories

\*=Accredited Analyte

PLEASE NOTE: Liability and Damages. Cardinal's liability and client's exclusive remedy for any claim arising, whether based in contract or tort, shall be limited to the amount paid by client for analyses. All claims, including those for negligence and any other cause whatsoever shall be deemed waived unless made in writing and received by Cardinal within thirty (30) days after completion of the applicable service. In no event shall Cardinal be liable for incidental or consequential damages, including, without limitation, business interruptions, loss of use, or loss of profits incurred by client, its subsidiaries, affiliates or successors arising out of or related to the performance of the services hereunder by Cardinal, regardless of whether such claim is based upon any of the above stated reasons or otherwise. Results relate only to the samples identified above. This report shall not be reproduced except in full with written approval of Cardinal Laboratories.

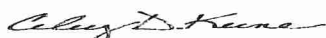

Celey D. Keene, Lab Director/Quality Manager

**Notes and Definitions**

ND	Analyte NOT DETECTED at or above the reporting limit
RPD	Relative Percent Difference
**	Samples not received at proper temperature of 6°C or below.
***	Insufficient time to reach temperature.
-	Chloride by SM4500Cl-B does not require samples be received at or below 6°C Samples reported on an as received basis (wet) unless otherwise noted on report

---

Cardinal Laboratories

\* = Accredited Analyte

PLEASE NOTE: Liability and Damages. Cardinal's liability and client's exclusive remedy for any claim arising, whether based in contract or tort, shall be limited to the amount paid by client for analyses. All claims, including those for negligence and any other cause whatsoever shall be deemed waived unless made in writing and received by Cardinal within thirty (30) days after completion of the applicable service. In no event shall Cardinal be liable for incidental or consequential damages, including, without limitation, business interruptions, loss of use, or loss of profits incurred by client, its subsidiaries, affiliates or successors arising out of or related to the performance of the services hereunder by Cardinal, regardless of whether such claim is based upon any of the above stated reasons or otherwise. Results relate only to the samples identified above. This report shall not be reproduced except in full with written approval of Cardinal Laboratories.

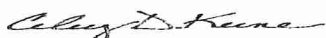

---

Celey D. Keene, Lab Director/Quality Manager



CHAIN-OF-CUSTODY AND ANALYSIS REQUEST

101 East Marland, Hobbs, NM 88240  
(575) 393-2326 FAX (575) 393-2476

Company Name: Talon/LPE		P.O. #:		ANALYSIS REQUEST	
Project Manager: D Adkins		Company: Oxy			
Address: 408 W. Texas Ave.		Attn: Chels Adams			
City: Artesia		Address:			
State: NM		City:			
Zip: 88210		State:			
Phone #: 575-746-8768		Phone #:			
Fax #: 575-746-8905		Fax #:			
Project #: 70660839001		Project Owner: Oxy			
Project Name: Diversified Federal 8500 Bldg		Zip:			
Project Location: SEC 23, T24S, R29E					
Sampler Name: G. Buza					
FOR LAB USE ONLY					
Lab I.D.	Sample I.D.	MATRIX	PRESERV	SAMPLING	
		(G) RAB OR (C) OMP.			
		# CONTAINERS			
		GROUNDWATER			
		WASTEWATER			
		SOIL			
		SLUDGE			
		OTHER:			
		ACID/BASE:			
		ICE / COOL			
		OTHER:			
		DATE	TIME		
		1-8-15	2:11		
		2:15			
		2:18			
		2:31			
		1-8-15	2:26		

PLEASE NOTE: Liability and Damages. Cardinal's liability and clients exclusive remedy for any claim arising whether based in contract or tort, shall be limited to the amount paid by the client for the analysis. All claims including those for negligence and any other cause whatsoever shall be deemed waived unless made in writing and received by Cardinal within 30 days after completion of the applicable service. In no event shall Cardinal be liable for incidental or consequential damages, including without limitation, business interruptions, loss of use, or loss of profits incurred by client, its subsidiaries, affiliates or successors arising out of or related to the performance of services hereunder by Cardinal, regardless of whether such claim is based upon any of the above stated reasons or otherwise.

Relinquished By:	Date: 11/15	Received By:	Date: 11/15
Relinquished By:	Time: 3:50	Received By:	Time: 3:50
Delivered By: (Circle One)		Sample Condition	
Sampler - UPS - Bus - Other:		Cool <input checked="" type="checkbox"/> Intact <input checked="" type="checkbox"/>	Checked By:
		Yes <input checked="" type="checkbox"/> No <input checked="" type="checkbox"/>	(Initials)
		2.40	
		REMARKS:	202
		Phone Result: <input type="checkbox"/> Yes <input type="checkbox"/> No	Add'l Phone #:
		Fax Result: <input type="checkbox"/> Yes <input type="checkbox"/> No	Add'l Fax #:

† Cardinal cannot accept verbal changes. Please fax written changes to (575) 393-2326



## CHAIN-OF-CUSTODY AND ANALYSIS REQUEST

101 East Marland, Hobbs, NM 88240  
(575) 393-2326 FAX (575) 393-2476

ANALYSIS REQUEST										
<b>Company Name:</b> Talon/LPE		<b>P.O. #:</b>								
<b>Project Manager:</b>										
<b>Address:</b> 408 W. Texas Ave.		<b>State:</b> NM		<b>Zip:</b> 88210						
<b>City:</b> Artesia		<b>Phone #:</b> 575-746-8768		<b>Fax #:</b> 575-746-8905						
<b>Project #:</b> 7006083900		<b>Project Owner:</b> OZU								
<b>Project Name:</b> Riverband Federal B SWOP Bldg										
<b>Project Location:</b> S2C 23, T24S, R29E										
<b>Sampler Name:</b> G. Barza										
<b>FOR LAB USE ONLY</b>		<b>MATRIX</b>		<b>PRESERV</b>	<b>SAMPLING</b>					
<b>Lab I.D.</b>	<b>Sample I.D.</b>	(G)RAB OR (C)OMP.	# CONTAINERS	GROUNDWATER	SOIL	SLUDGE	OTHER :	ACID/BASE:	ICE / COOL	OTHER :
		DATE	TIME							
15-10	15-10	G	1	/	/	/	/	/	/	1-8-15 1:30
25-11	25-11	G	1	/	/	/	/	/	/	1-8-15 1:33
35-12	35-12	G	1	/	/	/	/	/	/	1-8-15 1:36
45-13	45-13	G	1	/	/	/	/	/	/	1-8-15 1:40
55-14	55-14	G	1	/	/	/	/	/	/	1-8-15 1:45
65-20	65-20	G	1	/	/	/	/	/	/	1-8-15 1:47
75-21	75-21	G	1	/	/	/	/	/	/	1-8-15 1:51
85-22	85-22	G	1	/	/	/	/	/	/	1-8-15 1:55
95-23	95-23	G	1	/	/	/	/	/	/	1-8-15 2:00
105-24	105-24	G	1	/	/	/	/	/	/	1-8-15 2:03
<small>PLEASE NOTE: Liability and Damages. Cardinal's liability and clients' exclusive remedy for any claim arising whether based in contract or tort, shall be limited to the amount paid by the client for the analysis. All claims including those for negligence and any other causes whatsoever shall be deemed waived unless made in writing and received by Cardinal within 90 days after completion of the applicable service. In no event shall Cardinal be liable for incidental or consequential damages, including without limitation, business interruptions, loss of use, or loss of profits incurred by client, its subsidiaries, affiliates or contractors arising out of or related to the performance of services hereunder by Cardinal, regardless of whether such claim is based upon any of the above stated reasons or otherwise.</small>										
<b>Reinforced By:</b>		<b>Date:</b>		<b>Received By:</b>		<b>Date:</b>		<b>REMARKS:</b>		
								Phone Result: <input type="checkbox"/> Yes <input checked="" type="checkbox"/> No    Add'l Phone #: _____ Fax Result: <input type="checkbox"/> Yes <input checked="" type="checkbox"/> No    Add'l Fax #: _____ OP 66203688 Project 1126420 Trans 0101030106 Sent 2019		
<b>Delivered By: (Circle One)</b>		<b>Time:</b>		<b>Received By:</b>		<b>Time:</b>		<b>CHECKED BY:</b>		
<b>Sampler - UPS - Bus - Other:</b>								Sample Condition Cool / Intact <input checked="" type="checkbox"/> Yes <input type="checkbox"/> No Initials		
								240 1 of 2		

† Cardinal cannot accept verbal changes. Please fax written changes to (575) 393-2326