

Bratcher, Mike, EMNRD

From: Blair, Yvonne B <YBBlair@dcpmidstream.com>
Sent: Friday, October 02, 2015 9:43 AM
To: Bratcher, Mike, EMNRD
Cc: Case, Nicholas L; Landenberger, Dan R; rpair@blm.gov; Walker, Clayton D; Gall, Sarah; Valencia, Israel; Michael, Kelley R; Tillman, Kayla; Pudim, David A
Subject: FW: 20200 LINE LEAK
Attachments: H502572 DCP.pdf; 20200 Line Leak dig.jpg; 20200 C141 and action plan.pdf

Mike

Here is the report from Cardinal Labs. Our construction crew would like to replace 1300 ft. of pipe on our ROW to avoid any further issues with the line. We have removed the affected soil and would like to continue with the replacement of the pipe to the leak area.

Samples were taken at the depths below.

Sample #1 East Side Wall was done at 5 ft.
Sample #2 under pipe 10-11 ft.
Sample #3 West side wall 7-8 ft.

Yvonne Blair
Compliance Coordinator
DCP Midstream
575-361-2406

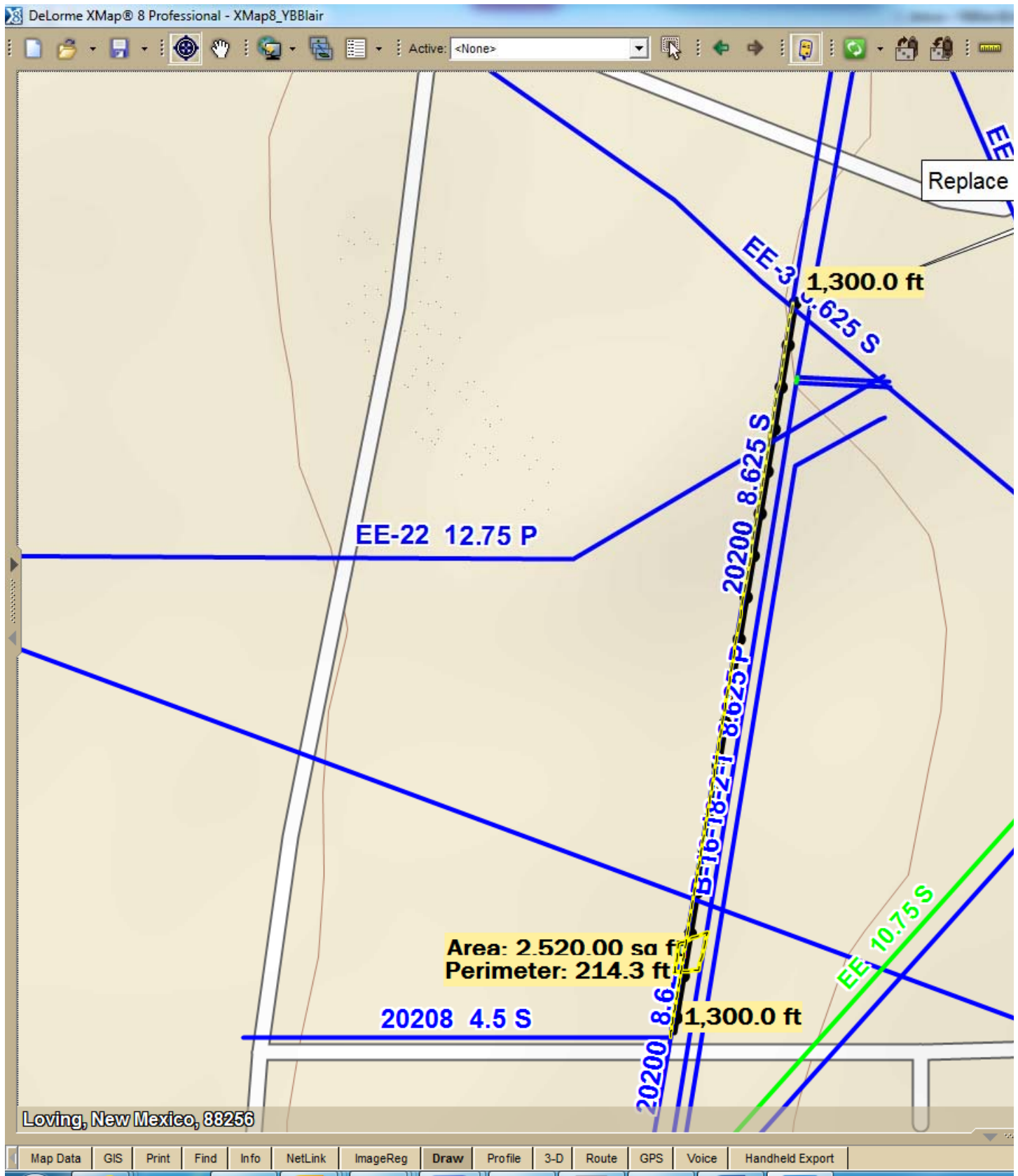

From: Celey Keene [mailto:celey.keene@cardinallabsnm.com]
Sent: Wednesday, September 30, 2015 11:41 AM

To: Blair, Yvonne B
Subject: 20200 LINE LEAK

THANK YOU,

Celey Keene
Lab Director
Cardinal Laboratories
101 East Marland
Hobbs, NM 88240
T: (575) 393-2326
F: (575) 393-2476
e-mail: celey.keene@cardinallabsnm.com

The information contained in this message is confidential and is only intended for the use of the individual/firm named above. If the reader of this message is not the intended recipient or the employee/agent responsible to deliver it to the intended recipient, you are hereby notified that any dissemination, distribution or copying of this communication is strictly prohibited. If you have received this communication in error, please notify us immediately by e-mail or telephone in order to return the message. We would like your feedback about the services you have received from Cardinal Laboratories. Click on the following link to complete a brief survey, <https://www.surveymonkey.com/s/Z7JXYQQ>. Thank you.