

October 10, 2016

Oil Conservation Division
District 2 – Artesia
811 S. First St.
Artesia, NM 88210

**Re: Nervous Horz Com #002H
Sec. 26, T18S-R31E
Eddy County, NM**

Mr. Mike Bratcher,

COG Operating LLC would like to submit the enclosed document for closure of the above captioned well. The plan is in response to the C-141 Initial report dated May 17, 2016.

All work has been completed in accordance with the approved work plan submitted to the NMOCD and the SLO. I have also attached the confirmation samples that were requested as well.

A signed C-141 Final is enclosed for your consideration. Please feel free to contact me with any questions or concerns at (432) 683-7443.

Sincerely,



Robert Grubbs Jr.
Senior Environmental Coordinator

Enclosed

- (1) C-141 Final
- (2) Site Diagram and Summary Table
- (3) Laboratory Analysis

District I
1625 N. French Dr., Hobbs, NM 88240
District II
811 S. First St., Artesia, NM 88210
District III
1000 Rio Brazos Road, Aztec, NM 87410
District IV
1220 S. St. Francis Dr., Santa Fe, NM 87505

State of New Mexico
Energy Minerals and Natural Resources

Oil Conservation Division
1220 South St. Francis Dr.
Santa Fe, NM 87505

Form C-141
Revised August 8, 2011

Submit 1 Copy to appropriate District Office in
accordance with 19.15.29 NMAC.

Release Notification and Corrective Action

OPERATOR

☐ Initial Report ☒ Final Report

Name of Company:	COG Operating LLC	Contact:	Robert McNeill
Address:	600 West Illinois Avenue, Midland TX 79701	Telephone No.	432-683-7443
Facility Name:	NERVOUS HORZ COM #002H	Facility Type:	Tank Battery

Surface Owner:	State	Mineral Owner:	API No.	30-015-37143
----------------	-------	----------------	---------	--------------

LOCATION OF RELEASE

Unit Letter	Section	Township	Range	Feet from the	North/South Line	Feet from the	East/West Line	County
A	26	18S	31E	330	North	530	East	Eddy

Latitude 32.7104416

Longitude 103.8161163

NATURE OF RELEASE

Type of Release: Produced Water	Volume of Release: 22bbls of produced water	Volume Recovered: 12bbls of produced water
Source of Release: 3" steel pipeline	Date and Hour of Occurrence: 05-09-2016 11:30am	Date and Hour of Discovery: 05-09-2016 11:30am
Was Immediate Notice Given? <input type="checkbox"/> Yes <input checked="" type="checkbox"/> No <input checked="" type="checkbox"/> Not Required	If YES, To Whom?	
By Whom?	Date and Hour:	
Was a Watercourse Reached? <input type="checkbox"/> Yes <input checked="" type="checkbox"/> No	If YES, Volume Impacting the Watercourse.	

If a Watercourse was Impacted, Describe Fully.*

Describe Cause of Problem and Remedial Action Taken.*

A 3" steel pipeline failed due to corrosion. Replaced the bad section of pipe with a new joint of 3" steel line.

Describe Area Affected and Cleanup Action Taken.*

The release covered a 50' X 20' area inside the tank battery. All work has been completed per the approved work plan.

I hereby certify that the information given above is true and complete to the best of my knowledge and understand that pursuant to NMOCD rules and regulations all operators are required to report and/or file certain release notifications and perform corrective actions for releases which may endanger public health or the environment. The acceptance of a C-141 report by the NMOCD marked as "Final Report" does not relieve the operator of liability should their operations have failed to adequately investigate and remediate contamination that pose a threat to ground water, surface water, human health or the environment. In addition, NMOCD acceptance of a C-141 report does not relieve the operator of responsibility for compliance with any other federal, state, or local laws and/or regulations.

Signature: 	OIL CONSERVATION DIVISION		
Printed Name: Robert Grubbs Jr.	Approved by Environmental Specialist:		
Title: Senior Environmental Coordinator	Approval Date:	Expiration Date:	
E-mail Address: rgrubbs@concho.com	Conditions of Approval:		Attached <input type="checkbox"/>
Date: October 10, 2016	Phone: 432-683-7443		

* Attach Additional Sheets If Necessary

(30-015-37143) Nervous Horz Com #002H

Lat/Long 32 7104416, -103 8181153

Legend

- Sample Points
- S1 (348 sq ft)
- S2

Site Ranking: 0	
Depth to GW per SEO: >100	
S1	CI-
1'	784
2'	720
3'	352
4'	672
6'	944
8'	1410
10'	48
12'	64
14'	80
S2	CI-
Surface	20000
1'	672
2'	576
3'	32
4'	112
5'	416

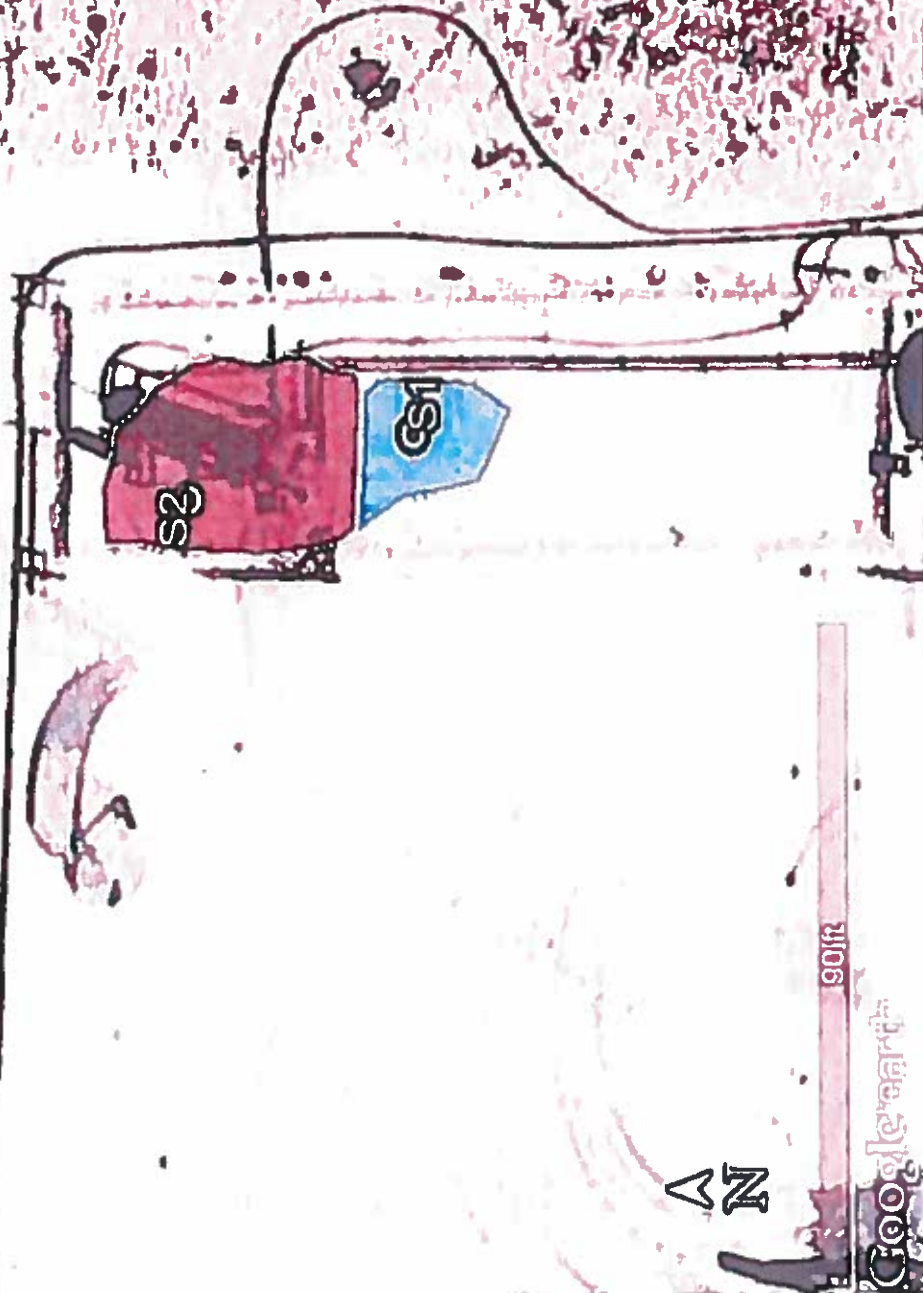

September 22, 2016

DAKOTA NEEL
COG OPERATING
P. O. BOX 1630
ARTESIA, NM 88210

RE: NERVOUS HORZ

Enclosed are the results of analyses for samples received by the laboratory on 09/16/16 15:49.

Cardinal Laboratories is accredited through Texas NELAP under certificate number T104704398-16-8. Accreditation applies to drinking water, non-potable water and solid and chemical materials. All accredited analytes are denoted by an asterisk (*). For a complete list of accredited analytes and matrices visit the TCEQ website at www.tceq.texas.gov/field/ga/lab_accred_certif.html.

Cardinal Laboratories is accredited through the State of Colorado Department of Public Health and Environment for:

Method EPA 552.2	Haloacetic Acids (HAA-5)
Method EPA 524.2	Total Trihalomethanes (TTHM)
Method EPA 524.4	Regulated VOCs (V1, V2, V3)

Accreditation applies to public drinking water matrices.

This report meets NELAP requirements and is made up of a cover page, analytical results, and a copy of the original chain-of-custody. If you have any questions concerning this report, please feel free to contact me.

Sincerely,



Celey D. Keene
Lab Director/Quality Manager

Analytical Results For:COG OPERATING
DAKOTA NEEL
P. O. BOX 1630
ARTESIA NM, 88210
Fax To: NONEReceived: 09/16/2016
Reported: 09/22/2016
Project Name: NERVOUS HORZ
Project Number: NONE GIVEN
Project Location: EDDY COUNTY, NMSampling Date: 09/13/2016
Sampling Type: Soil
Sampling Condition: Cool & Intact
Sample Received By: Jodi Henson**Sample ID: CONFIRMATION SAMPLE 1 0.5' BH (H602082-01)**

Chloride, SM4500Cl-B		mg/kg		Analyzed By: AC						
Analyte	Result	Reporting Limit	Analyzed	Method Blank	BS	% Recovery	True Value QC	RPD	Qualifier	
Chloride	160	16.0	09/22/2016	ND	432	108	400	0.00		

Sample ID: CONFIRMATION SAMPLE 2 0.5' BH (H602082-02)

Chloride, SM4500Cl-B		mg/kg		Analyzed By: AC						
Analyte	Result	Reporting Limit	Analyzed	Method Blank	BS	% Recovery	True Value QC	RPD	Qualifier	
Chloride	64.0	16.0	09/22/2016	ND	432	108	400	0.00		

Cardinal Laboratories

* = Accredited Analyte

PLEASE NOTE: Liability and Damages. Cardinal's liability and client's exclusive remedy for any claim arising, whether based in contract or tort, shall be limited to the amount paid by client for analyses. All claims, including those for negligence and any other cause whatsoever shall be deemed waived unless made in writing and received by Cardinal within thirty (30) days after completion of the applicable service. In no event shall Cardinal be liable for incidental or consequential damages, including, without limitation, business interruptions, loss of use, or loss of profits incurred by client, its subsidiaries, affiliates or successors arising out of or related to the performance of the services hereunder by Cardinal, regardless of whether such claim is based upon any of the above stated reasons or otherwise. Results relate only to the samples identified above. This report shall not be reproduced except in full with written approval of Cardinal Laboratories.



Celey D. Keene, Lab Director/Quality Manager

Notes and Definitions

ND	Analyte NOT DETECTED at or above the reporting limit
RPD	Relative Percent Difference
**	Samples not received at proper temperature of 6°C or below.
***	Insufficient time to reach temperature.
-	Chloride by SM4500Cl-B does not require samples be received at or below 6°C
	Samples reported on an as received basis (wet) unless otherwise noted on report

Cardinal Laboratories***=Accredited Analyte**

PLEASE NOTE: Liability and Damages. Cardinal's liability and client's exclusive remedy for any claim arising, whether based in contract or tort, shall be limited to the amount paid by client for analyses. All claims, including those for negligence and any other cause whatsoever shall be deemed waived unless made in writing and received by Cardinal within thirty (30) days after completion of the applicable service. In no event shall Cardinal be liable for incidental or consequential damages, including, without limitation, business interruptions, loss of use, or loss of profits incurred by client, its subsidiaries, affiliates or successors arising out of or related to the performance of the services hereunder by Cardinal, regardless of whether such claim is based upon any of the above stated reasons or otherwise. Results relate only to the samples identified above. This report shall not be reproduced except in full with written approval of Cardinal Laboratories.



Celey D. Keene, Lab Director/Quality Manager



101 East Marland, Hobbs, NM 88240
(575) 393-2326 FAX (575) 393-2476

CHAIN-OF-CUSTODY AND ANALYSIS REQUEST

Company Name: COG Operating LLC

Project Manager: Dakota Neel

Address: 2208 West Main

City: Artesia

Phone #: 432-215-2783

State: NM Zip: 88210

Project #:

Project Owner:

Project Name:

Nervous Horse

Project Location:

Eddy Co NM

Sampler Name:

Patricia Rich

FOR LAB USE ONLY

Lab I.D.

Sample I.D.

HL002082

1 Confirmation Sample 1 c.s.

2 Confirmation Sample 2 c.s.

Bottom Hole

N/A

MATRIX

PRESERV.

SAMPLING

(G)RAB OR (C)OMP
CONTAINERS
GROUNDWATER
WASTEWATER
SOIL
OIL
SLUDGE
OTHER

ACID/BASE
ICE / COOL
OTHER

DATE
TIME

BTEX

TPH

Chloride

BILL TO

ANALYSIS REQUEST

P.O. #:

Company: COG Operating LLC

Attn: Robert McNeill

Address: 600 W Illinois

City:

Midland

State: TX

Zip: 79701

Phone #: (432) 221-0388

Fax #:

PLEASE NOTE: Liability and Damages: Cardinal's liability and client's exclusive remedy for any claim arising whether based in contract or tort, shall be limited to the amount paid by the client for the analysis. All claims, including those for negligence and any other cause whatsoever shall be deemed waived unless made in writing and received by Cardinal within 30 days after completion of the applicable service. If no event shall Cardinal be liable for incidental or consequential damages, including without limitation, business interruption, loss of use, or loss of profits incurred by client, its subsidiaries, affiliates or successors arising out of or related to the performance of services hereunder by Cardinal, regardless of whether such claim is based upon any of the above stated theories or otherwise.

Received By:

Patricia Rich

Relinquished By:

Patricia Rich

Date: 9/10/10

Time: 1:45

Received By:

Patricia Rich

Phone Result:

Yes

No

Add'l Phone #:

Fax Result:

Yes

No

Add'l Fax #:

Relinquished By:

Patricia Rich

Date: 9/10/10

Time: 1:45

Received By:

Patricia Rich

Phone Result:

Yes

No

Add'l Phone #:

Fax Result:

Yes

No

Add'l Fax #:

Date:

Time:

Received By:

Patricia Rich

Phone Result:

Yes

No

Add'l Phone #:

Fax Result:

Yes

No

Add'l Fax #:

Delivered By: (Circle One)

Sampler - UPS - Bus - Other:

5.22c

Sample Condition

Cool - Intact

Yes

No

Yes

No

Yes

No

Yes

No

Yes

No

3. Please fax written changes to 575-393-2476