

District I
1625 N. French Dr., Hobbs, NM 88240
District II
811 S. First St., Artesia, NM 88210
District III
1000 Rio Brazos Road, Aztec, NM 87410
District IV
1220 S. St. Francis Dr., Santa Fe, NM 87505

State of New Mexico
Energy Minerals and Natural Resources

Oil Conservation Division
1220 South St. Francis Dr.
Santa Fe, NM 87505

Form C-141
Revised August 8, 2011

Submit 1 Copy to appropriate District Office in
accordance with 19.15.29 NMAC.

Release Notification and Corrective Action

OPERATOR

☐ Initial Report ☒ Final Report

Name of Company Yates Petroleum Corporation	Contact Robert Asher	
Address 104 S. 4 th Street	Telephone No. 575-748-1471	
Facility Name Antweil ANU Federal #4-H	Facility Type Battery	
Surface Owner Federal	Mineral Owner Federal	API No. 30-015-40426

LOCATION OF RELEASE

Unit Letter M	Section 29	Township 19S	Range 30E	Feet from the 860	North/South Line South	Feet from the 660	East/West Line West	County Eddy
------------------	---------------	-----------------	--------------	----------------------	---------------------------	----------------------	------------------------	----------------

Latitude 32.62641 Longitude 104.0001

NATURE OF RELEASE

Type of Release Crude Oil	Volume of Release 30 B/O	Volume Recovered 29 B/O
Source of Release Heater Treater	Date and Hour of Occurrence 2/17/2015; AM	Date and Hour of Discovery 2/17/2015; AM
Was Immediate Notice Given? <input checked="" type="checkbox"/> Yes <input type="checkbox"/> No <input type="checkbox"/> Not Required	If YES, To Whom? Mike Bratcher/NMOCD II	
By Whom? Robert Asher/Yates Petroleum Corporation	Date and Hour 2/18/2015; AM (Email)	
Was a Watercourse Reached? <input type="checkbox"/> Yes <input checked="" type="checkbox"/> No	If YES, Volume Impacting the Watercourse.	

If a Watercourse was Impacted, Describe Fully.*

Describe Cause of Problem and Remedial Action Taken.*

The back pressure valve on the heater treater failed, causing the release. Vacuum truck(s) and roustabout crews were called.

Describe Area Affected and Cleanup Action Taken.*

An approximate area of 40' x 120' within the lined and bermed battery, and approximate area of 40' x 40' outside of the battery. The back pressure valve was replaced after a vacuum truck recovered most of the released crude oil (29 B/O). Impacted gravel will be hauled to a NMOCD approved facility. Vertical and horizontal delineation samples will be taken and analysis ran for TPH & BTEX. If initial analytical results for TPH & BTEX are under RRAL's (site ranking is 10) a Final Report, C-141 will be submitted to the OCD requesting closure. **Depth to Ground Water: 50-99' (approximately 90', Section 29, T19S-R30E, per Trend Map), Wellhead Protection Area: No, Distance to Surface Water Body: >1000', SITE RANKING IS 10. Based on attached remedial actions and analytical results, Yates Petroleum Corporation requests closure.**

I hereby certify that the information given above is true and complete to the best of my knowledge and understand that pursuant to NMOCD rules and regulations all operators are required to report and/or file certain release notifications and perform corrective actions for releases which may endanger public health or the environment. The acceptance of a C-141 report by the NMOCD marked as "Final Report" does not relieve the operator of liability should their operations have failed to adequately investigate and remediate contamination that pose a threat to ground water, surface water, human health or the environment. In addition, NMOCD acceptance of a C-141 report does not relieve the operator of responsibility for compliance with any other federal, state, or local laws and/or regulations.

Signature: 	OIL CONSERVATION DIVISION	
Printed Name: Robert Asher	Approved by Environmental Specialist:	
Title: NM Environmental Regulatory Supervisor	Approval Date:	Expiration Date:
E-mail Address: boba@yatespetroleum.com	Conditions of Approval:	Attached <input type="checkbox"/>
Date: October 17, 2016 Phone: 575-748-4217	2RP-2835	

* Attach Additional Sheets If Necessary

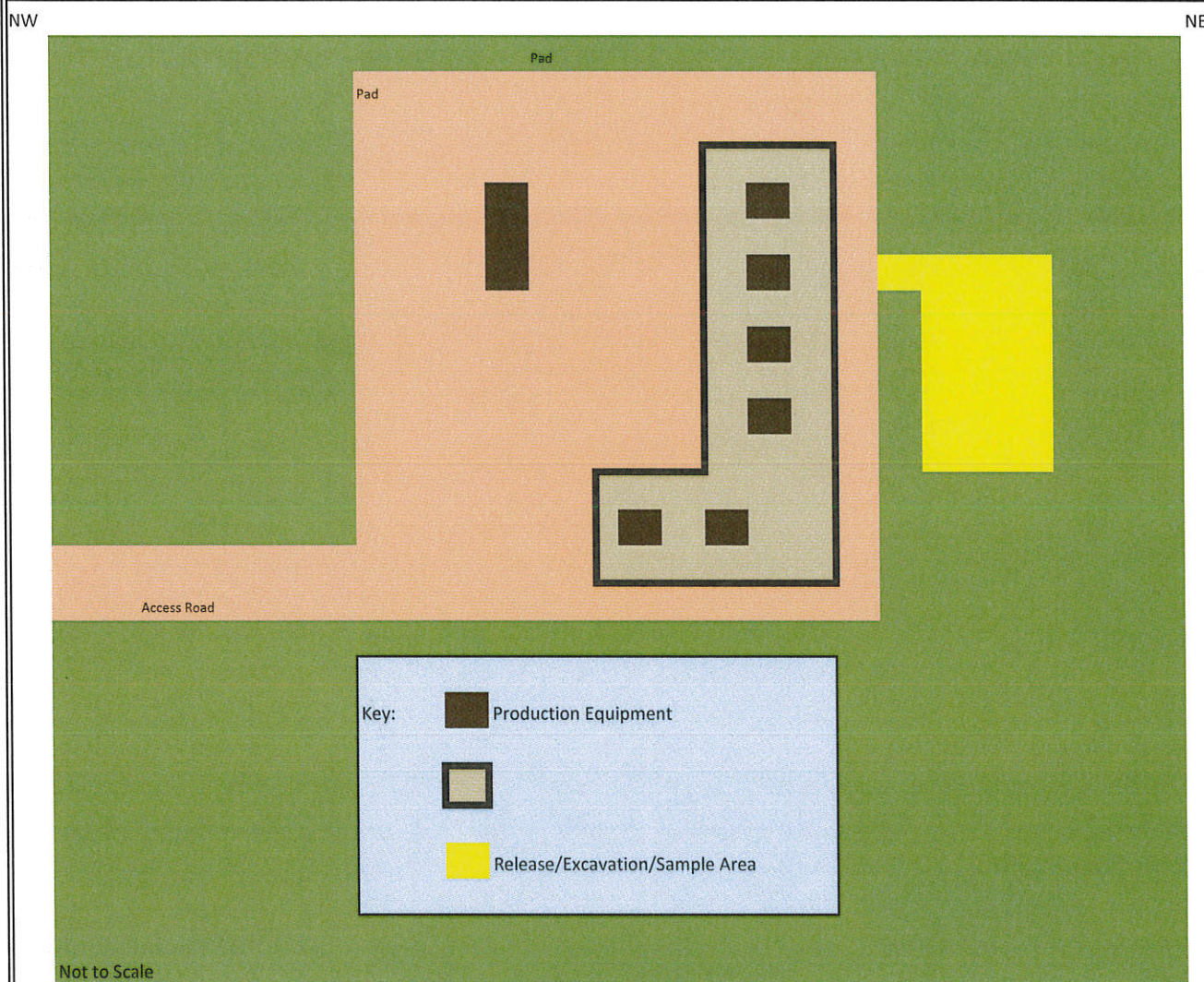

Yates Petroleum Corporation; Antweil ANU Federal #4-H, Section 29, T19S-R30E, Eddy County, New Mexico

Analytical Report-H501073 (Cardinal)	Sample Date	Sample Type	Depth	BTEX	GRO	DRO
C00.25	3/11/2015	Comp/Auger	4"	154.0	1480	25800
C01.0	3/11/2015	Comp/Auger	12"	413.0	3540	7840
C02.0	3/11/2015	Comp/Auger	24"	0.7	<10.0	80.5
Analytical Report-1610351 (Hall)	Sample Date	Sample Type	Depth	BTEX	GRO	DRO
C00.5	10/4/2016	Comp/Auger	6" (30" BSL)	ND	ND	ND

Site Ranking is Ten (10). Depth to Ground Water 50-99' (approx. 90', per ChevronTexaco Trend Map).

All results are ppm. Chlorides for documentation.

Released: 30 B/O; Recovered: 29 B/O. Release Date: 2/17/2015

Impacted soils excavated, hauled to an NMOCD approved facility.



Hall Environmental Analysis Laboratory
4901 Hawkins NE
Albuquerque, NM 87109
TEL: 505-345-3975 FAX: 505-345-4107
Website: www.hallenvironmental.com

October 13, 2016

Robert Asher
Yates Petroleum Corporation
105 South Fourth Street
Artesia, NM 88210
TEL: (575) 748-4111
FAX

RE: Antweil ANU Federal 4H

OrderNo.: 1610351

Dear Robert Asher:

Hall Environmental Analysis Laboratory received 1 sample(s) on 10/7/2016 for the analyses presented in the following report.

These were analyzed according to EPA procedures or equivalent. To access our accredited tests please go to www.hallenvironmental.com or the state specific web sites. In order to properly interpret your results it is imperative that you review this report in its entirety. See the sample checklist and/or the Chain of Custody for information regarding the sample receipt temperature and preservation. Data qualifiers or a narrative will be provided if the sample analysis or analytical quality control parameters require a flag. When necessary, data qualifiers are provided on both the sample analysis report and the QC summary report, both sections should be reviewed. All samples are reported, as received, unless otherwise indicated. Lab measurement of analytes considered field parameters that require analysis within 15 minutes of sampling such as pH and residual chlorine are qualified as being analyzed outside of the recommended holding time.

Please don't hesitate to contact HEAL for any additional information or clarifications.

ADHS Cert #AZ0682 -- NMED-DWB Cert #NM9425 -- NMED-Micro Cert #NM0190

Sincerely,

A handwritten signature in black ink, appearing to read "Andy Freeman", is written over a horizontal line.

Andy Freeman
Laboratory Manager
4901 Hawkins NE
Albuquerque, NM 87109

Analytical Report

Lab Order: 1610351

Date Reported: 10/13/2016

Hall Environmental Analysis Laboratory, Inc.

CLIENT: Yates Petroleum Corporation
Project: Antweil ANU Federal 4H

Lab Order: 1610351**Lab ID:** 1610351-001**Collection Date:** 10/4/2016 8:49:00 AM**Client Sample ID:** C 00.5**Matrix:** SOIL

Analyses	Result	PQL	Qual	Units	DF	Date Analyzed	Batch ID
EPA METHOD 8015M/D: DIESEL RANGE ORGANICS							Analyst: TOM
Diesel Range Organics (DRO)	ND	9.9		mg/Kg	1	10/11/2016 5:30:33 PM	27964
Surr: DNOP	80.8	70-130		%Rec	1	10/11/2016 5:30:33 PM	27964
EPA METHOD 8015D: GASOLINE RANGE							Analyst: NSB
Gasoline Range Organics (GRO)	ND	4.6		mg/Kg	1	10/11/2016 5:02:30 PM	27962
Surr: BFB	93.8	68.3-144		%Rec	1	10/11/2016 5:02:30 PM	27962
EPA METHOD 8021B: VOLATILES							Analyst: NSB
Benzene	ND	0.023		mg/Kg	1	10/11/2016 5:02:30 PM	27962
Toluene	ND	0.046		mg/Kg	1	10/11/2016 5:02:30 PM	27962
Ethylbenzene	ND	0.046		mg/Kg	1	10/11/2016 5:02:30 PM	27962
Xylenes, Total	ND	0.093		mg/Kg	1	10/11/2016 5:02:30 PM	27962
Surr: 4-Bromofluorobenzene	108	80-120		%Rec	1	10/11/2016 5:02:30 PM	27962

Refer to the QC Summary report and sample login checklist for flagged QC data and preservation information.

Qualifiers:	*	Value exceeds Maximum Contaminant Level.	B	Analyte detected in the associated Method Blank
	D	Sample Diluted Due to Matrix	E	Value above quantitation range
	H	Holding times for preparation or analysis exceeded	J	Analyte detected below quantitation limits
	ND	Not Detected at the Reporting Limit	P	Sample pH Not In Range
	R	RPD outside accepted recovery limits	RL	Reporting Detection Limit
	S	% Recovery outside of range due to dilution or matrix	W	Sample container temperature is out of limit as specified

QC SUMMARY REPORT

Hall Environmental Analysis Laboratory, Inc.

WO#: 1610351

13-Oct-16

Client: Yates Petroleum Corporation

Project: Antweil ANU Federal 4H

Sample ID	LCS-27964	SampType:	LCS	TestCode:	EPA Method 8015M/D: Diesel Range Organics					
Client ID:	LCSS	Batch ID:	27964	RunNo:	37844					
Prep Date:	10/10/2016	Analysis Date:	10/11/2016	SeqNo:	1179127	Units:	mg/Kg			
Analyte	Result	PQL	SPK value	SPK Ref Val	%REC	LowLimit	HighLimit	%RPD	RPDLimit	Qual
Diesel Range Organics (DRO)	48	10	50.00	0	96.4	62.6	124			
Surr: DNOP	4.6		5.000		92.8	70	130			

Sample ID	MB-27964	SampType:	MBLK	TestCode:	EPA Method 8015M/D: Diesel Range Organics					
Client ID:	PBS	Batch ID:	27964	RunNo:	37844					
Prep Date:	10/10/2016	Analysis Date:	10/11/2016	SeqNo:	1179128	Units:	mg/Kg			
Analyte	Result	PQL	SPK value	SPK Ref Val	%REC	LowLimit	HighLimit	%RPD	RPDLimit	Qual
Diesel Range Organics (DRO)	ND	10								
Surr: DNOP	10		10.00		101	70	130			

Sample ID	LCS-27994	SampType:	LCS	TestCode:	EPA Method 8015M/D: Diesel Range Organics					
Client ID:	LCSS	Batch ID:	27994	RunNo:	37869					
Prep Date:	10/11/2016	Analysis Date:	10/12/2016	SeqNo:	1179829	Units:	%Rec			
Analyte	Result	PQL	SPK value	SPK Ref Val	%REC	LowLimit	HighLimit	%RPD	RPDLimit	Qual
Surr: DNOP	4.8		5.000		95.2	70	130			

Sample ID	MB-27994	SampType:	MBLK	TestCode:	EPA Method 8015M/D: Diesel Range Organics					
Client ID:	PBS	Batch ID:	27994	RunNo:	37869					
Prep Date:	10/11/2016	Analysis Date:	10/12/2016	SeqNo:	1179830	Units:	%Rec			
Analyte	Result	PQL	SPK value	SPK Ref Val	%REC	LowLimit	HighLimit	%RPD	RPDLimit	Qual
Surr: DNOP	9.8		10.00		98.4	70	130			

Qualifiers:

* Value exceeds Maximum Contaminant Level.	B Analyte detected in the associated Method Blank
D Sample Diluted Due to Matrix	E Value above quantitation range
H Holding times for preparation or analysis exceeded	J Analyte detected below quantitation limits
ND Not Detected at the Reporting Limit	P Sample pH Not In Range
R RPD outside accepted recovery limits	RL Reporting Detection Limit
S % Recovery outside of range due to dilution or matrix	W Sample container temperature is out of limit as specified

QC SUMMARY REPORT

Hall Environmental Analysis Laboratory, Inc.

WO#: 1610351

13-Oct-16

Client: Yates Petroleum Corporation

Project: Antweil ANU Federal 4H

Sample ID	MB-27962	SampType:	MBLK	TestCode:	EPA Method 8015D: Gasoline Range					
Client ID:	PBS	Batch ID:	27962	RunNo:	37863					
Prep Date:	10/10/2016	Analysis Date:	10/11/2016	SeqNo:	1179358	Units:	mg/Kg			
Analyte	Result	PQL	SPK value	SPK Ref Val	%REC	LowLimit	HighLimit	%RPD	RPDLimit	Qual
Gasoline Range Organics (GRO)	ND	5.0								
Surr: BFB	920		1000		91.9	68.3	144			

Sample ID	LCS-27962	SampType:	LCS	TestCode:	EPA Method 8015D: Gasoline Range					
Client ID:	LCSS	Batch ID:	27962	RunNo:	37863					
Prep Date:	10/10/2016	Analysis Date:	10/11/2016	SeqNo:	1179359	Units:	mg/Kg			
Analyte	Result	PQL	SPK value	SPK Ref Val	%REC	LowLimit	HighLimit	%RPD	RPDLimit	Qual
Gasoline Range Organics (GRO)	30	5.0	25.00	0	120	74.6	123			
Surr: BFB	1000		1000		101	68.3	144			

Sample ID	MB-27999	SampType:	MBLK	TestCode:	EPA Method 8015D: Gasoline Range					
Client ID:	PBS	Batch ID:	27999	RunNo:	37885					
Prep Date:	10/11/2016	Analysis Date:	10/12/2016	SeqNo:	1180069	Units:	%Rec			
Analyte	Result	PQL	SPK value	SPK Ref Val	%REC	LowLimit	HighLimit	%RPD	RPDLimit	Qual
Surr: BFB	920		1000		92.3	68.3	144			

Sample ID	LCS-27999	SampType:	LCS	TestCode:	EPA Method 8015D: Gasoline Range					
Client ID:	LCSS	Batch ID:	27999	RunNo:	37885					
Prep Date:	10/11/2016	Analysis Date:	10/12/2016	SeqNo:	1180070	Units:	%Rec			
Analyte	Result	PQL	SPK value	SPK Ref Val	%REC	LowLimit	HighLimit	%RPD	RPDLimit	Qual
Surr: BFB	1000		1000		104	68.3	144			

Qualifiers:

* Value exceeds Maximum Contaminant Level.	B Analyte detected in the associated Method Blank
D Sample Diluted Due to Matrix	E Value above quantitation range
H Holding times for preparation or analysis exceeded	J Analyte detected below quantitation limits
ND Not Detected at the Reporting Limit	P Sample pH Not In Range
R RPD outside accepted recovery limits	RL Reporting Detection Limit
S % Recovery outside of range due to dilution or matrix	W Sample container temperature is out of limit as specified

QC SUMMARY REPORT

Hall Environmental Analysis Laboratory, Inc.

WO#: 1610351

13-Oct-16

Client: Yates Petroleum Corporation

Project: Antweil ANU Federal 4H

Sample ID	MB-27962	SampType: MBLK			TestCode: EPA Method 8021B: Volatiles					
Client ID:	PBS	Batch ID: 27962			RunNo: 37863					
Prep Date:	10/10/2016	Analysis Date: 10/11/2016			SeqNo: 1179392		Units: mg/Kg			
Analyte	Result	PQL	SPK value	SPK Ref Val	%REC	LowLimit	HighLimit	%RPD	RPDLimit	Qual
Benzene	ND	0.025								
Toluene	ND	0.050								
Ethylbenzene	ND	0.050								
Xylenes, Total	ND	0.10								
Surr: 4-Bromofluorobenzene	1.1		1.000		108	80	120			

Sample ID	LCS-27962		SampType: LCS		TestCode: EPA Method 8021B: Volatiles					
Client ID:	LCSS		Batch ID: 27962		RunNo: 37863					
Prep Date:	10/10/2016		Analysis Date: 10/11/2016		SeqNo: 1179393		Units: mg/Kg			
Analyte	Result	PQL	SPK value	SPK Ref Val	%REC	LowLimit	HighLimit	%RPD	RPDLimit	Qual
Benzene	1.1	0.025	1.000	0	105	75.2	115			
Toluene	1.0	0.050	1.000	0	103	80.7	112			
Ethylbenzene	1.0	0.050	1.000	0	104	78.9	117			
Xylenes, Total	3.1	0.10	3.000	0	103	79.2	115			
Surr: 4-Bromofluorobenzene	1.1		1.000		114	80	120			

Sample ID	MB-27999		SampType:	MBLK		TestCode:	EPA Method 8021B: Volatiles				
Client ID:	PBS		Batch ID:	27999		RunNo:	37885				
Prep Date:	10/11/2016		Analysis Date:	10/12/2016		SeqNo:	1180084		Units: %Rec		
Analyte	Result	PQL	SPK value	SPK Ref Val	%REC	LowLimit	HighLimit	%RPD	RPDLimit	Qual	
Surr: 4-Bromofluorobenzene	1.1		1.000		108	80	120				

Sample ID	LCS-27999		SampType: LCS		TestCode: EPA Method 8021B: Volatiles					
Client ID:	LCSS		Batch ID: 27999		RunNo: 37885					
Prep Date:	10/11/2016		Analysis Date: 10/12/2016		SeqNo: 1180085		Units: %Rec			
Analyte	Result	PQL	SPK value	SPK Ref Val	%REC	LowLimit	HighLimit	%RPD	RPDLimit	Qual
Surr: 4-Bromofluorobenzene	1.1		1.000		115	80	120			

Qualifiers:

* Value exceeds Maximum Contaminant Level.	B Analyte detected in the associated Method Blank
D Sample Diluted Due to Matrix	E Value above quantitation range
H Holding times for preparation or analysis exceeded	J Analyte detected below quantitation limits
ND Not Detected at the Reporting Limit	P Sample pH Not In Range
R RPD outside accepted recovery limits	RL Reporting Detection Limit
S % Recovery outside of range due to dilution or matrix	W Sample container temperature is out of limit as specified

Sample Log-In Check List

Client Name: Yates Petroleum Corpora

Work Order Number: 1610351

RcptNo: 1

Received by/date:	<i>[Signature]</i>	10/07/16
Logged By:	Lindsay Mangin	10/7/2016 9:45:00 AM
Completed By:	Lindsay Mangin	10/7/2016 2:55:48 PM
Reviewed By:	<i>aj</i>	10/7/16

Chain of Custody

- Custody seals intact on sample bottles? Yes ☒ No ☐ Not Present ☐
- Is Chain of Custody complete? Yes ☒ No ☐ Not Present ☐
- How was the sample delivered? Courier

Log In

- Was an attempt made to cool the samples? Yes ☒ No ☐ NA ☐
- Were all samples received at a temperature of >0° C to 6.0°C Yes ☒ No ☐ NA ☐
- Sample(s) in proper container(s)? Yes ☒ No ☐
- Sufficient sample volume for indicated test(s)? Yes ☒ No ☐
- Are samples (except VOA and ONG) properly preserved? Yes ☒ No ☐
- Was preservative added to bottles? Yes ☐ No ☒ NA ☐
- VOA vials have zero headspace? Yes ☐ No ☐ No VOA Vials ☒
- Were any sample containers received broken? Yes ☐ No ☒
- Does paperwork match bottle labels? Yes ☒ No ☐
(Note discrepancies on chain of custody)
- Are matrices correctly identified on Chain of Custody? Yes ☒ No ☐
- Is it clear what analyses were requested? Yes ☒ No ☐
- Were all holding times able to be met? Yes ☒ No ☐
(If no, notify customer for authorization.)

of preserved bottles checked for pH: _____
(<2 or >12 unless noted)
Adjusted? _____
Checked by: _____

Special Handling (if applicable)

- Was client notified of all discrepancies with this order? Yes ☐ No ☐ NA ☒

Person Notified:	_____	Date:	_____
By Whom:	_____	Via:	<input type="checkbox"/> eMail <input type="checkbox"/> Phone <input type="checkbox"/> Fax <input type="checkbox"/> In Person
Regarding:	_____		
Client Instructions:	_____		

17. Additional remarks:

18. Cooler Information

Cooler No	Temp °C	Condition	Seal Intact	Seal No	Seal Date	Signed By
1	4.0	Good	Yes			

March 19, 2015

ROBERT ASHER

YATES PETROLEUM CORPORATION

105 S 4th Street

Artesia, NM 88210

RE: ANTWEIL ANU FEDERAL #4-H

Enclosed are the results of analyses for samples received by the laboratory on 03/13/15 11:25.

Cardinal Laboratories is accredited through Texas NELAP under certificate number T104704398-13-5. Accreditation applies to drinking water, non-potable water and solid and chemical materials. All accredited analytes are denoted by an asterisk (*). For a complete list of accredited analytes and matrices visit the TCEQ website at www.tceq.texas.gov/field/qa/lab_accred_certif.html.

Cardinal Laboratories is accredited through the State of Colorado Department of Public Health and Environment for:

Method EPA 552.2	Haloacetic Acids (HAA-5)
Method EPA 524.2	Total Trihalomethanes (TTHM)
Method EPA 524.4	Regulated VOCs (V1, V2, V3)

Accreditation applies to public drinking water matrices.

This report meets NELAP requirements and is made up of a cover page, analytical results, and a copy of the original chain-of-custody. If you have any questions concerning this report, please feel free to contact me.

Sincerely,



Celey D. Keene

Lab Director/Quality Manager

Analytical Results For:

 YATES PETROLEUM CORPORATION
 ROBERT ASHER
 105 S 4th Street
 Artesia NM, 88210
 Fax To: (505) 748-4635

Received:	03/13/2015	Sampling Date:	03/11/2015
Reported:	03/19/2015	Sampling Type:	Soil
Project Name:	ANTWEIL ANU FEDERAL #4-H	Sampling Condition:	Cool & Intact
Project Number:	30-015-40426	Sample Received By:	Celey D. Keene
Project Location:	EDDY COUNTY, NM		

Sample ID: C00.25 N (H500698-01)

BTX 8021B		mg/kg		Analyzed By: ms					
Analyte	Result	Reporting Limit	Analyzed	Method Blank	BS	% Recovery	True Value QC	RPD	Qualifier
Benzene*	4.66	0.500	03/19/2015	ND	2.17	109	2.00	5.29	
Toluene*	43.0	0.500	03/19/2015	ND	1.99	99.3	2.00	4.00	
Ethylbenzene*	34.9	0.500	03/19/2015	ND	1.91	95.3	2.00	6.10	
Total Xylenes*	71.6	1.50	03/19/2015	ND	5.69	94.9	6.00	7.55	
Total BTX	154	3.00	03/19/2015	ND					

Surrogate: 4-Bromofluorobenzene (PIE) 146 % 61-154

TPH 8015M		mg/kg		Analyzed By: MS				S-06	
Analyte	Result	Reporting Limit	Analyzed	Method Blank	BS	% Recovery	True Value QC	RPD	Qualifier
GRO C6-C10	1480	100	03/17/2015	ND	200	100	200	0.434	
DRO >C10-C28	25800	100	03/17/2015	ND	213	106	200	1.78	

Surrogate: 1-Chlorooctane 179 % 47.2-157

Surrogate: 1-Chlorooctadecane 646 % 52.1-176

Cardinal Laboratories

*=Accredited Analyte

PLEASE NOTE: Liability and Damages. Cardinal's liability and client's exclusive remedy for any claim arising, whether based in contract or tort, shall be limited to the amount paid by client for analyses. All claims, including those for negligence and any other cause whatsoever shall be deemed waived unless made in writing and received by Cardinal within thirty (30) days after completion of the applicable service. In no event shall Cardinal be liable for incidental or consequential damages, including, without limitation, business interruptions, loss of use, or loss of profits incurred by client, its subsidiaries, affiliates or successors arising out of or related to the performance of the services hereunder by Cardinal, regardless of whether such claim is based upon any of the above stated reasons or otherwise. Results relate only to the samples identified above. This report shall not be reproduced except in full with written approval of Cardinal Laboratories.



Celey D. Keene, Lab Director/Quality Manager

Analytical Results For:

YATES PETROLEUM CORPORATION
ROBERT ASHER
105 S 4th Street
Artesia NM, 88210
Fax To: (505) 748-4635

Received: 03/13/2015
Reported: 03/19/2015
Project Name: ANTWEIL ANU FEDERAL #4-H
Project Number: 30-015-40426
Project Location: EDDY COUNTY, NM

Sampling Date: 03/11/2015
Sampling Type: Soil
Sampling Condition: Cool & Intact
Sample Received By: Celey D. Keene

Sample ID: C01.0 N (H500698-02)

BTEX 8021B		mg/kg		Analyzed By: ms					
Analyte	Result	Reporting Limit	Analyzed	Method Blank	BS	% Recovery	True Value QC	RPD	Qualifier
Benzene*	19.1	2.00	03/19/2015	ND	2.17	109	2.00	5.29	
Toluene*	160	2.00	03/19/2015	ND	1.99	99.3	2.00	4.00	
Ethylbenzene*	81.4	2.00	03/19/2015	ND	1.91	95.3	2.00	6.10	
Total Xylenes*	152	6.00	03/19/2015	ND	5.69	94.9	6.00	7.55	
Total BTEX	413	12.0	03/19/2015	ND					

Surrogate: 4-Bromofluorobenzene (PIL) 124 % 61-154

TPH 8015M		mg/kg		Analyzed By: MS					
Analyte	Result	Reporting Limit	Analyzed	Method Blank	BS	% Recovery	True Value QC	RPD	Qualifier
GRO C6-C10	3540	50.0	03/17/2015	ND	200	100	200	0.434	
DRO >C10-C28	7840	50.0	03/17/2015	ND	213	106	200	1.78	

Surrogate: 1-Chlorooctane 157 % 47.2-157

Surrogate: 1-Chlorooctadecane 176 % 52.1-176

Cardinal Laboratories

*=Accredited Analyte

PLEASE NOTE: Liability and Damages. Cardinal's liability and client's exclusive remedy for any claim arising, whether based in contract or tort, shall be limited to the amount paid by client for analyses. All claims, including those for negligence and any other cause whatsoever shall be deemed waived unless made in writing and received by Cardinal within thirty (30) days after completion of the applicable service. In no event shall Cardinal be liable for incidental or consequential damages, including, without limitation, business interruptions, loss of use, or loss of profits incurred by client, its subsidiaries, affiliates or successors arising out of or related to the performance of the services hereunder by Cardinal, regardless of whether such claim is based upon any of the above stated reasons or otherwise. Results relate only to the samples identified above. This report shall not be reproduced except in full with written approval of Cardinal Laboratories.



Celey D. Keene, Lab Director/Quality Manager

Analytical Results For:

YATES PETROLEUM CORPORATION
ROBERT ASHER
105 S 4th Street
Artesia NM, 88210
Fax To: (505) 748-4635

Received:	03/13/2015	Sampling Date:	03/11/2015
Reported:	03/19/2015	Sampling Type:	Soil
Project Name:	ANTWEIL ANU FEDERAL #4-H	Sampling Condition:	Cool & Intact
Project Number:	30-015-40426	Sample Received By:	Celey D. Keene
Project Location:	EDDY COUNTY, NM		

Sample ID: C02.0 N (H500698-03)

BTEX 8021B		mg/kg		Analyzed By: ms						
Analyte	Result	Reporting Limit	Analyzed	Method Blank	BS	% Recovery	True Value QC	RPD	Qualifier	
Benzene*	0.105	0.050	03/19/2015	ND	2.17	109	2.00	5.29		
Toluene*	0.382	0.050	03/19/2015	ND	1.99	99.3	2.00	4.00		
Ethylbenzene*	0.094	0.050	03/19/2015	ND	1.91	95.3	2.00	6.10		
Total Xylenes*	<0.150	0.150	03/19/2015	ND	5.69	94.9	6.00	7.55		
Total BTEX	0.704	0.300	03/19/2015	ND						

Surrogate: 4-Bromofluorobenzene (PIE) 102 % 61-154

TPH 8015M		mg/kg		Analyzed By: MS					
Analyte	Result	Reporting Limit	Analyzed	Method Blank	BS	% Recovery	True Value QC	RPD	Qualifier
GRO C6-C10	<10.0	10.0	03/17/2015	ND	200	100	200	0.434	
DRO >C10-C28	80.5	10.0	03/17/2015	ND	213	106	200	1.78	

Surrogate: 1-Chlorooctane 91.4 % 47.2-157

Surrogate: 1-Chlorooctadecane 98.2 % 52.1-176

Cardinal Laboratories

*=Accredited Analyte

PLEASE NOTE: Liability and Damages. Cardinal's liability and client's exclusive remedy for any claim arising, whether based in contract or tort, shall be limited to the amount paid by client for analyses. All claims, including those for negligence and any other cause whatsoever shall be deemed waived unless made in writing and received by Cardinal within thirty (30) days after completion of the applicable service. In no event shall Cardinal be liable for incidental or consequential damages, including, without limitation, business interruptions, loss of use, or loss of profits incurred by client, its subsidiaries, affiliates or successors arising out of or related to the performance of the services hereunder by Cardinal, regardless of whether such claim is based upon any of the above stated reasons or otherwise. Results relate only to the samples identified above. This report shall not be reproduced except in full with written approval of Cardinal Laboratories.



Celey D. Keene, Lab Director/Quality Manager

Notes and Definitions

- S-06 The recovery of this surrogate is outside control limits due to sample dilution required from high analyte concentration and/or matrix interference's.
- ND Analyte NOT DETECTED at or above the reporting limit
- RPD Relative Percent Difference
- ** Samples not received at proper temperature of 6°C or below.
- *** Insufficient time to reach temperature.
- Chloride by SM4500Cl-B does not require samples be received at or below 6°C
Samples reported on an as received basis (wet) unless otherwise noted on report

Cardinal Laboratories

*=Accredited Analyte

PLEASE NOTE: Liability and Damages. Cardinal's liability and client's exclusive remedy for any claim arising, whether based in contract or tort, shall be limited to the amount paid by client for analyses. All claims, including those for negligence and any other cause whatsoever shall be deemed waived unless made in writing and received by Cardinal within thirty (30) days after completion of the applicable service. In no event shall Cardinal be liable for incidental or consequential damages, including, without limitation, business interruptions, loss of use, or loss of profits incurred by client, its subsidiaries, affiliates or successors arising out of or related to the performance of the services hereunder by Cardinal, regardless of whether such claim is based upon any of the above stated reasons or otherwise. Results relate only to the samples identified above. This report shall not be reproduced except in full with written approval of Cardinal Laboratories.



Celey D. Keene, Lab Director/Quality Manager

