



June 27, 2018

#5E27122-BG3

NMOCD District II
Mike Bratcher
1301 W Grand Ave
Artesia, NM 88210

SUBJECT: SOIL REMEDIATION CLOSURE REPORT FOR THE CYPRESS FEE 23 27 9 No. 002H
(2RP-4705-0) , EDDY COUNTY, NEW MEXICO

Dear Mr. Bratcher:

On behalf of Marathon Oil Company (Marathon), Souder, Miller & Associates (SMA) has prepared this CLOSURE REPORT that describes the assessment, delineation and remediation for a release associated with the Cypress Fee 23 27 9 No. 002H ("Cypress Fee No. 2") . The site is in UNIT L, SECTION 9, TOWNSHIP 23S, RANGE 27E, NMPM, Eddy County, New Mexico, on private land. Figure 1 illustrates the vicinity and location of the site. Table 1 summarizes information regarding the release.

| Table 1: Release information and Site Ranking | |
|---|---------------------------------------|
| Name | Cypress Fee 23 27 9 No. 002H |
| Company | Marathon Oil Company |
| Incident Number | 2RP-4705-0 |
| API Number | 30-015-44374 |
| Location | 32.31677158N, -104.20183140W |
| Estimated Date of Release | 4/1/2018 |
| Date Reported to NMOCD | 4/1/2018 |
| Land Owner | Private |
| Reported To | NMOCD District II |
| Source of Release | Transfer Pump |
| Released Material | Produced Water |
| Released Volume | 15 bbls |
| Recovered Volume | 8 bbls |
| Net Release | 7 bbls |
| Nearest Waterway | 0.8 miles Northwest of Cass Draw |
| Depth to Groundwater | Estimated to be greater than 100 feet |
| Nearest Domestic Water Source | Greater than 1,000 feet |
| NMOCD Ranking | 0 |
| SMA Response Dates | 5/22/2018, 6/13/2018 |

1.0 Background

On April 1, 2018, A centerline bottle washout on the water transfer pump at the Cypress Fee No. 2 Facility caused approximately 15 bbl. of produced water to be released around the water transfer pump and a Poseidon tank that has since been removed. A vacuum truck was mobilized and recovered standing fluids and a surficial scrape was completed.

2.0 Site Ranking and Land Jurisdiction

The release site is located approximately 7.32 miles South of Carlsbad, with an elevation of approximately 3,159 feet above sea level. SMA searched the New Mexico State Engineer's Office (NMOSE) online water well database for water wells in the vicinity of the release. Two wells were used to determine the depth to groundwater at this location. Wells C04044 and C00195 show that after elevation correction was performed using topographic maps and aerial photography, the estimated depth to groundwater is between 114 and 161 feet bgs.

Recommended Remediation Action Levels (RRALs) are determined by the site ranking according to the NMOCD *Guidelines for Remediation of Leaks, Spills, and Releases* (1993). Below in Table 2 are the remediation standards and the site ranking for this location. Justification for this site ranking is found in Figure 1 and Appendix B.

Table 2.

| Soil Remediation Standards | 0 to 9 | 10 to 19 | >19 |
|-----------------------------------|-----------------|-----------------|----------------|
| Benzene | 10 PPM | 10 PPM | 10 PPM |
| BTEX | 50 PPM | 50 PPM | 50 PPM |
| TPH | 5000 PPM | 1000 PPM | 100 PPM |

| Depth to Groundwater | NMOCD Numeric Rank |
|--|---------------------------|
| < 50 BGS = 20 | |
| 50' to 99' = 10 | |
| >100' = 0 | 0 |
| Distance to Nearest Surface Water | NMOCD Numeric Rank |
| < 200' = 20 | |
| 200' - 1000' = 10 | |
| >1000' = 0 | 0 |
| Well Head Protection | NMOCD Numeric Rank |
| <1000' (or <200' domestic) = 20 | |
| > 1000' = 0 | 0 |
| Total Site Ranking | 0 |

3.0 Release Characterization

On May 22, 2018, SMA field personnel assessed the release area. The site had previously been scraped by Marathon Oil. Five sample locations (L1-L5) were established by SMA in and around the vicinity of the release to characterize and delineate the release. Samples were collected to a depth of

0.5 feet, with the exception of L2 which was able to be advanced to 1 foot. All samples were collected and processed according to NMOCD soil sampling procedures.

The samples were sent under chain-of-custody protocols to Hall Environmental Analysis Laboratory for analysis for MRO, DRO, and GRO by EPA Method 8015D, BTEX by EPA Method 8021, and Chlorides by Method 300. Sample locations are depicted on Figure 2. All laboratory results are summarized in Table 3. Laboratory reports are included in Appendix C.

Laboratory results indicated high concentration of chlorides at locations L1 (to 0.5 foot) and L3 (surface only), and elevated TPH at the surface of location L5.

4.0 Soil Remediation

On June 13, 2018, after approval from area utilities via 811, SMA field personnel returned to the location with a backhoe service to guide the excavation of soils. Sample locations L1 and L5 were advanced to 1 foot bgs and confirmation samples were collected, as well four sidewall soil samples (SW1-SW4). All other locations were left at the previously-excavated depth of 0.5-foot bgs.

The samples were sent under chain-of-custody protocols to Hall for analysis for MRO, DRO, and GRO by EPA Method 8015D, and Chlorides by Method 300. All closure samples are within NMOCD's recommended remediation action levels (RRAL's). No further action is recommended at this location.

5.0 Scope and Limitations

The scope of our services consisted of the performance of assessment sampling, verification of release stabilization, regulatory liaison, and preparation of this closure report. All work has been performed in accordance with generally accepted professional environmental consulting practices for oil and gas releases in the Permian Basin in New Mexico.

If there are any questions regarding this report, please contact either Austin Weyant at 575-689-8801 or Shawna Chubbuck at 505-325-7535.

Submitted by:

Reviewed by:

SOUDER, MILLER & ASSOCIATES

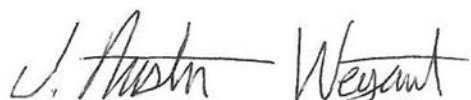

Austin Weyant
Project Scientist



Shawna Chubbuck
Senior Scientist

ATTACHMENTS:

Figures:

Figure 1: Vicinity and Well Head Protection Map

Figure 2: Site and Sample Location Map

Tables:

Table 3: Summary of Sample Results

Appendices:

Appendix A: Form C141 Initial and Final

Appendix B: NMOSE Wells Report

Appendix C: Laboratory Analytical Reports

FIGURE 1
VICINITY AND NMOSE
DATA MAP

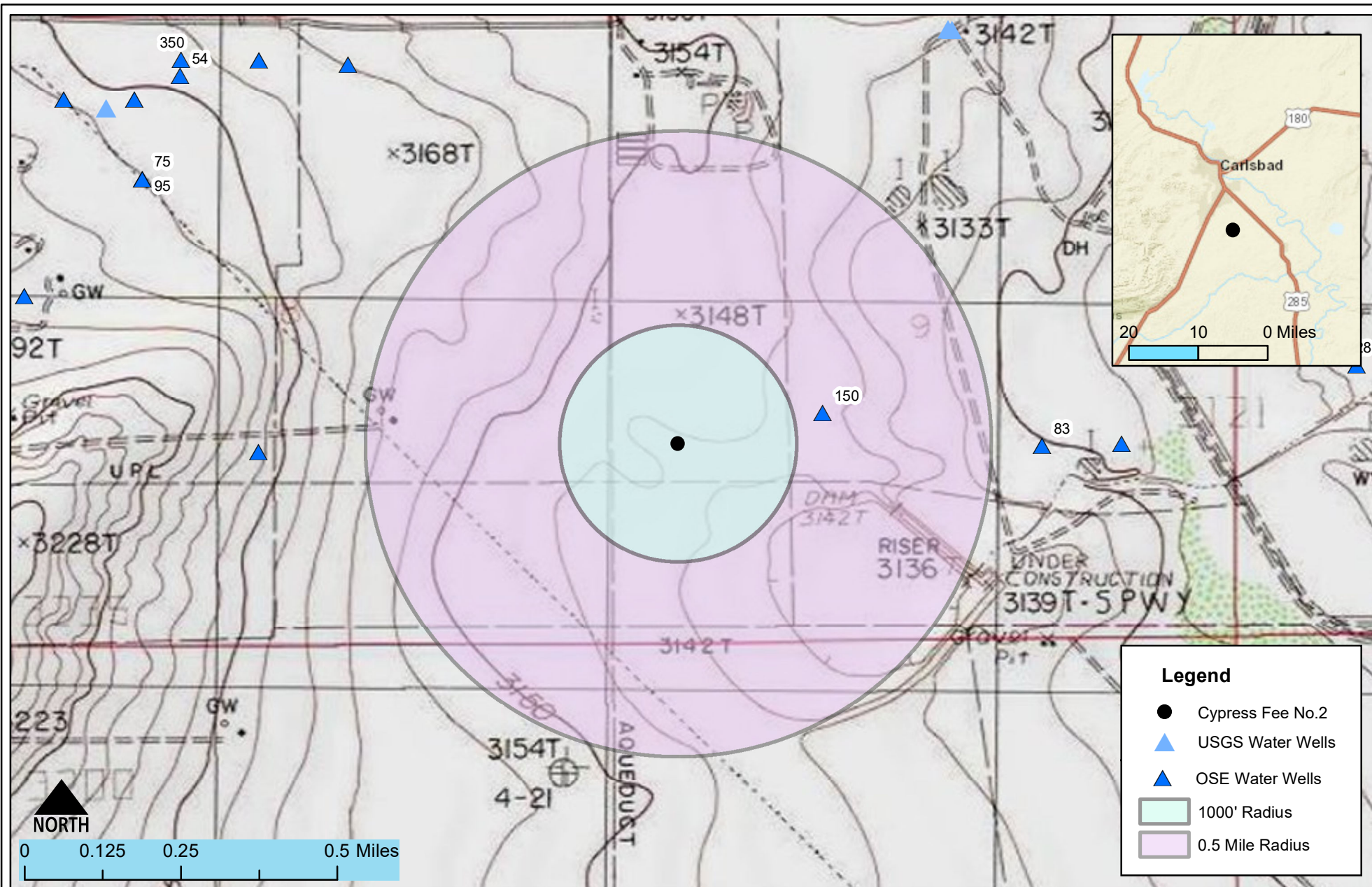

OSE & USGS Vicinity & Well Head Protection Map
Cypress Fee No. 2 - Marathon Oil
Eddy County, New Mexico

Figure 1

| | | | | |
|--|-----------|-------------|-----------|--------------|
| Date Saved: 6/19/2018 | By: _____ | Date: _____ | Revisions | Descr: _____ |
| | By: _____ | Date: _____ | | Descr: _____ |
| Copyright 2015 Souder, Miller & Associates - All Rights Reserved | | | | |

| | |
|----------|------------------------|
| Drawn | Melodie Sanjari |
| Checked | _____ |
| Approved | _____ |



201 South Halaguena Street
Carlsbad, New Mexico 88221
(575) 689-7040
www.soudermiller.com
Serving the Southwest & Rocky Mountains

FIGURE 2
SITE AND SAMPLE
LOCATION MAP

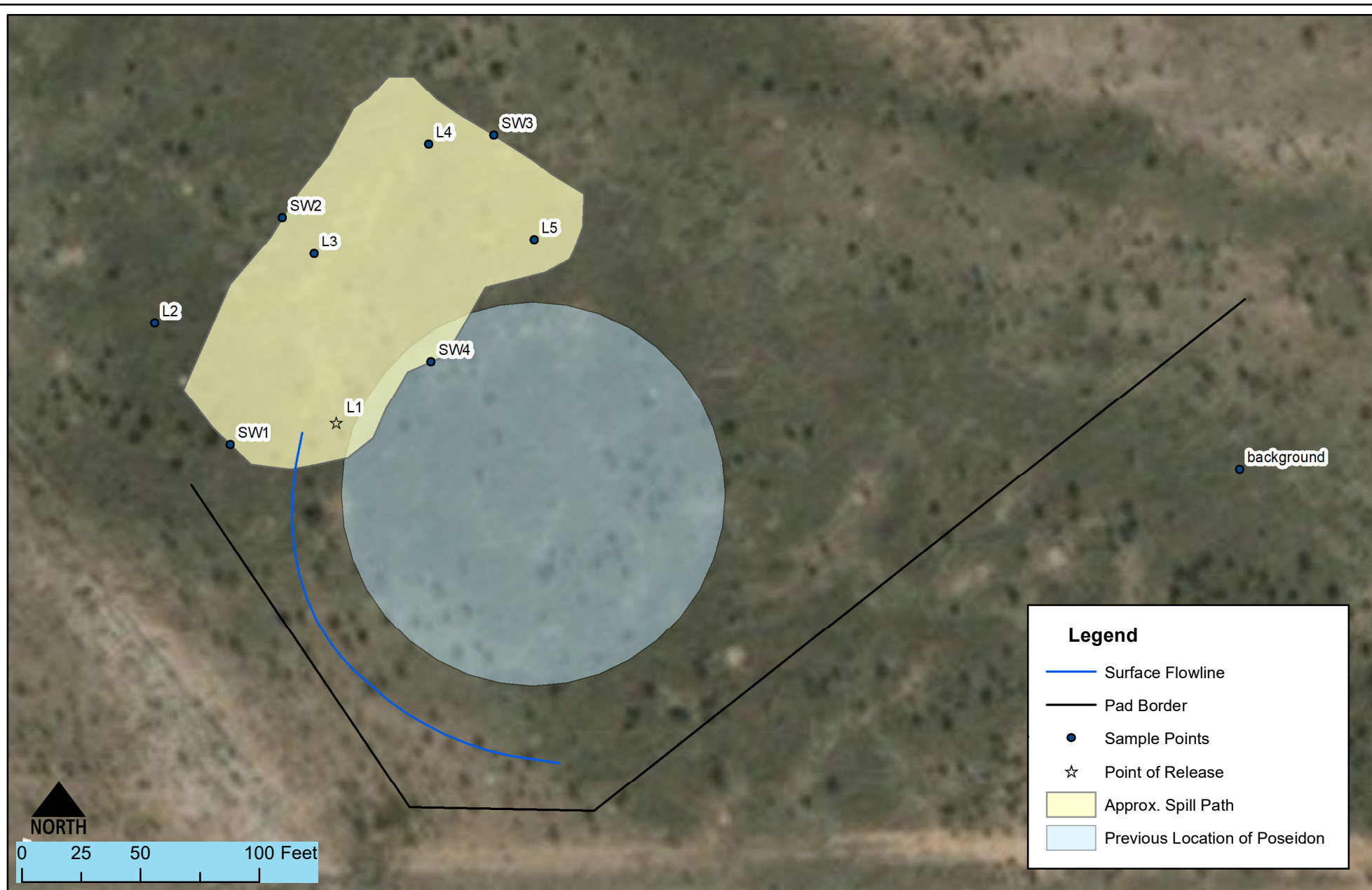

Legend

- Surface Flowline
- Pad Border
- Sample Points
- ☆ Point of Release
- Approx. Spill Path
- Previous Location of Poseidon

Site & Sample Location Map
 Cypress Fee No. 2 - Marathon Oil
 Eddy County, New Mexico

Figure 2

| | | | | |
|--|-----------|-------------|--|---|
| Date Saved: 6/27/2018 Copyright 2015 Souder, Miller & Associates - All Rights Reserved | Revisions | | Drawn _____ Checked _____ Approved _____ | Melodie Sanjari _____ _____ _____ |
| | By: _____ | Date: _____ | | |
| | By: _____ | Date: _____ | | |



201 South Halaguena Street
 Carlsbad, New Mexico 88221
 (575) 689-7040
 www.soudermiller.com
 Serving the Southwest & Rocky Mountains

TABLE 3
SUMMARY SAMPLE RESULTS

Cypress Sample Summary

Table 3

| Sample Number on Figure 2 | Sample Date | Depth (feet bgs) | Completed Action | BTEX mg/Kg | Benzene mg/Kg | GRO mg/Kg | DRO mg/Kg | MRO mg/Kg | Total TPH mg/Kg | Cl- Laboratory mg/Kg |
|---------------------------------|-------------|------------------|------------------|---------------|------------------|--------------|--------------|--------------|--------------------|----------------------------|
| NMOCD RRAL's for Site Ranking 0 | | | | 50 mg/Kg | 10 mg/Kg | | | | 5000 mg/Kg | |
| L1 | 5/22/2018 | surface | excavate | <0.221 | <0.025 | <4.9 | 74 | <50 | 74 | 36000 |
| | 5/22/2018 | 0.5 | excavate | -- | -- | -- | -- | -- | -- | 10000 |
| | 6/13/2018 | 1 | excavate | -- | -- | <4.9 | <9.7 | <48 | <62.6 | 35 |
| L2 | 5/22/2018 | surface | in-situ | <0.215 | 0.024 | <4.8 | 23 | <50 | 23 | 210 |
| | 5/22/2018 | 0.5 | in-situ | -- | -- | -- | -- | -- | -- | 100 |
| | 5/22/2018 | 1 | in-situ | -- | -- | -- | -- | -- | -- | 120 |
| L3 | 5/22/2018 | surface | excavate | <0.221 | <0.025 | <4.9 | 90 | 63 | 153 | 8500 |
| | 5/22/2018 | 0.5 | in-situ | -- | -- | -- | -- | -- | -- | 70 |
| L4 | 5/22/2018 | surface | excavate | <0.207 | <0.023 | <4.6 | 130 | 91 | 221 | 2900 |
| | 5/22/2018 | 0.5 | in-situ | -- | -- | -- | -- | -- | -- | 100 |
| L5 | 5/22/2018 | surface | excavate | <0.206 | <0.023 | <4.6 | 2400 | 3900 | 6300 | 2400 |
| | 5/22/2018 | 0.5 | excavate | -- | -- | -- | -- | -- | -- | 290 |
| | 6/13/2018 | 1 | excavate | -- | -- | <5.0 | <9.3 | <47 | <61.3 | -- |
| SW1 | 6/13/2018 | sidewall | in-situ | -- | -- | <4.8 | <9.8 | <49 | <63.6 | 40 |
| SW2 | 6/13/2018 | sidewall | in-situ | -- | -- | <4.8 | <9.9 | <49 | <63.7 | 190 |
| SW3 | 6/13/2018 | sidewall | in-situ | -- | -- | <4.7 | <9.9 | <50 | <64.6 | 47 |
| SW4 | 6/13/2018 | sidewall | in-situ | -- | -- | <4.8 | <9.8 | <49 | <63.6 | 83 |
| BG | 5/22/2018 | 2 | background | -- | -- | -- | -- | -- | -- | <30 |

APPENDIX A
FORM C141 INITIAL AND FINAL

District I
1625 N. French Dr., Hobbs, NM 88240
District II
811 S. First St., Artesia, NM 88210
District III
1000 Rio Brazos Road, Aztec, NM 87410
District IV
1220 S. St. Francis Dr., Santa Fe, NM 87505

State of New Mexico
Energy Minerals and Natural Resources

Oil Conservation Division
1220 South St. Francis Dr.
Santa Fe, NM 87505

Form C-141
Revised April 3, 2017

Submit 1 Copy to appropriate District Office in
accordance with 19.15.29 NMAC.

Release Notification and Corrective Action

OPERATOR

☒ Initial Report ☐ Final Report

| | | |
|--|---|------------------------|
| Name of Company Marathon Oil Permian LLC | Contact Callie Karrigan | |
| Address 5555 San Felipe Street, Houston, Texas 77056 | Telephone No. 405-202-1028 (cell) 575-297-0956 (office) | |
| Facility Name: Cypress Fee 23 27 9 No. 002H | Facility Type Oil and gas production facilities | |
| Surface: Owner: Fee | Mineral: Owner: Fee | API No. : 30-015-44374 |

LOCATION OF RELEASE

| | | | | | | | | |
|-------------|---------|----------|-------|---------------|------------------|---------------|----------------|--------|
| Unit Letter | Section | Township | Range | Feet from the | North/South Line | Feet from the | East/West Line | County |
| L | 9 | 23S | 27E | 1664 | South | 549 | West | Eddy |

Latitude 32.31677158N Longitude -104.20183140W

NATURE OF RELEASE

| | | |
|--|--|---|
| Type of Release: produced water | Volume of Release: 15 barrels | Volume Recovered: 8 bbls |
| Source of Release: transfer pump | Date and Hour of Occurrence 04/01/2018 unknown | Date and Hour of Discovery 04/01/2018 08:00 am |
| Was Immediate Notice Given? <input checked="" type="checkbox"/> Yes <input type="checkbox"/> No <input type="checkbox"/> Not Required | If YES, To Whom? Crystal Weaver and Mike Bratcher – Eddy County | |
| By Whom? Callie Karrigan | Date and Hour 04/02/2018 07:28 am | |
| Was a Watercourse Reached? <input type="checkbox"/> Yes <input checked="" type="checkbox"/> No | If YES, Volume Impacting the Watercourse. N/A | |
| If a Watercourse was Impacted, Describe Fully.* Not applicable. | | |
| Describe Cause of Problem and Remedial Action Taken.* Operator reported a centerline bottle washout on the water transfer pump at the Cypress Fee 23 27 9 No. 002H facility. Approximately 15 bbls of produced water was released onsite around the parameter of the water transfer pump. | | |
| Describe Area Affected and Cleanup Action Taken.* A vac truck recovered standing fluids. Saturated soil material was removed and disposed at R360. Samples will be collected for lab analysis. | | |
| I hereby certify that the information given above is true and complete to the best of my knowledge and understand that pursuant to NMOCD rules and regulations all operators are required to report and/or file certain release notifications and perform corrective actions for releases which may endanger public health or the environment. The acceptance of a C-141 report by the NMOCD marked as "Final Report" does not relieve the operator of liability should their operations have failed to adequately investigate and remediate contamination that pose a threat to ground water, surface water, human health or the environment. In addition, NMOCD acceptance of a C-141 report does not relieve the operator of responsibility for compliance with any other federal, state, or local laws and/or regulations. | | |
| Callie Karrigan Signature: | OIL CONSERVATION DIVISION | |
| Printed Name: Callie Karrigan | Approved by Environmental Specialist: | |
| Title: HES Environmental Professional | Approval Date: | Expiration Date: |
| E-mail Address: cnkarrigan@marathonoil.com | Conditions of Approval: | Attached <input type="checkbox"/> |
| Date: 4/12/2018 Phone: 405-202-1028(cell) 575-297-0956 (office) | | |

* Attach Additional Sheets If Necessary

APPENDIX B

NMOSE WELLS REPORT



New Mexico Office of the State Engineer

Water Column/Average Depth to Water

(A CLW##### in the POD suffix indicates the POD has been replaced & no longer serves a water right file.)















(R=POD has been replaced, O=orphaned, C=the file is closed)

(quarters are 1=NW 2=NE 3=SW 4=SE)

(quarters are smallest to largest)

(NAD83 UTM in meters)

(In feet)

| POD Number | POD Sub-Code | basin | County | Q Q Q | | | | | | X | Y | Distance | Depth Well | Depth Water | Water Column | |
|-----------------------------------|--------------|-------|--------|-------|----|---|-----|-----|-----|--------|----------|---|------------|-------------|--------------|-----|
| | | | | 64 | 16 | 4 | Sec | Tws | Rng | | | | | | | |
| C 04044 POD1 | | CUB | ED | 3 | 2 | 3 | 09 | 23S | 27E | 575504 | 3575907 |  | 381 | 290 | 150 | 140 |
| C 00195 | | CUB | ED | 4 | 1 | 4 | 09 | 23S | 27E | 576069 | 3575827* |  | 938 | 128 | 83 | 45 |
| C 00420 | C | CUB | ED | | 4 | 2 | 09 | 23S | 27E | 576370 | 3576337* |  | 1339 | 2151 | | |
| C 00323 | | C | ED | | 4 | 4 | 05 | 23S | 27E | 574750 | 3577122* |  | 1348 | 200 | | |
| C 02711 | | C | ED | | 4 | 4 | 05 | 23S | 27E | 574750 | 3577122* |  | 1348 | 170 | 75 | 95 |
| C 03020 | | C | ED | | 4 | 4 | 05 | 23S | 27E | 574750 | 3577122* |  | 1348 | 176 | 135 | 41 |
| C 03799 POD1 | | C | ED | 1 | 3 | 3 | 04 | 23S | 27E | 574981 | 3577170 |  | 1350 | 200 | 51 | 149 |
| C 00109 CLW203096 | O | | ED | 1 | 3 | 3 | 04 | 23S | 27E | 575051 | 3577226* |  | 1400 | 260 | | |
| C 03056 | | C | ED | 1 | 3 | 3 | 04 | 23S | 27E | 575051 | 3577226* |  | 1400 | 60 | 31 | 29 |
| C 01071 | | C | ED | | | 1 | 08 | 23S | 27E | 573751 | 3576499* |  | 1534 | 279 | 95 | 184 |
| C 02191 | | C | ED | | | 1 | 08 | 23S | 27E | 573751 | 3576499* |  | 1534 | 252 | 75 | 177 |
| C 03653 POD1 | | C | ED | 2 | 4 | 4 | 05 | 23S | 27E | 574757 | 3577331 |  | 1549 | 220 | 180 | 40 |
| C 03892 POD1 | | C | ED | 1 | 2 | 1 | 08 | 23S | 27E | 573846 | 3576764 |  | 1590 | 148 | 54 | 94 |
| C 00068 CLW193190 | O | | ED | 3 | 3 | 1 | 10 | 23S | 27E | 576673 | 3576241* |  | 1596 | 175 | | |
| C 02710 | | C | ED | | | 4 | 05 | 23S | 27E | 574550 | 3577318* |  | 1599 | 200 | 72 | 128 |

Average Depth to Water: **91 feet**

Minimum Depth: **31 feet**

Maximum Depth: **180 feet**

Record Count: 15

UTM NAD83 Radius Search (in meters):

Easting (X): 575131

Northing (Y): 3575828

Radius: 1600

*UTM location was derived from PLSS - see Help

The data is furnished by the NMOSE/ISC and is accepted by the recipient with the expressed understanding that the OSE/ISC make no warranties, expressed or implied, concerning the accuracy, completeness, reliability, usability, or suitability for any particular purpose of the data.

APPENDIX C
LABORATORY ANALYTICAL
REPORTS



Hall Environmental Analysis Laboratory
4901 Hawkins NE
Albuquerque, NM 87109
TEL: 505-345-3975 FAX: 505-345-4107
Website: www.hallenvironmental.com

June 06, 2018

Austin Weyant
Souder, Miller & Associates
201 S Halagueno
Carlsbad, NM 88221
TEL: (575) 689-7040
FAX

RE: Cypress

OrderNo.: 1805E14

Dear Austin Weyant:

Hall Environmental Analysis Laboratory received 12 sample(s) on 5/25/2018 for the analyses presented in the following report.

These were analyzed according to EPA procedures or equivalent. To access our accredited tests please go to www.hallenvironmental.com or the state specific web sites. In order to properly interpret your results, it is imperative that you review this report in its entirety. See the sample checklist and/or the Chain of Custody for information regarding the sample receipt temperature and preservation. Data qualifiers or a narrative will be provided if the sample analysis or analytical quality control parameters require a flag. When necessary, data qualifiers are provided on both the sample analysis report and the QC summary report, both sections should be reviewed. All samples are reported, as received, unless otherwise indicated. Lab measurement of analytes considered field parameters that require analysis within 15 minutes of sampling such as pH and residual chlorine are qualified as being analyzed outside of the recommended holding time.

Please don't hesitate to contact HEAL for any additional information or clarifications.

ADHS Cert #AZ0682 -- NMED-DWB Cert #NM9425 -- NMED-Micro Cert #NM0901

Sincerely,

A handwritten signature in black ink, appearing to read 'Andy Freeman', is written over a horizontal line.

Andy Freeman
Laboratory Manager
4901 Hawkins NE
Albuquerque, NM 87109

Hall Environmental Analysis Laboratory, Inc.

Analytical Report

Lab Order **1805E14**

Date Reported: **6/6/2018**

CLIENT: Souder, Miller & Associates

Client Sample ID: L1-Surface

Project: Cypress

Collection Date: 5/22/2018 11:30:00 AM

Lab ID: 1805E14-001

Matrix: SOIL

Received Date: 5/25/2018 9:15:00 AM

| Analyses | Result | PQL | Qual | Units | DF | Date Analyzed | Batch |
|--|--------|--------|------|-------|----|----------------------|---------------------|
| EPA METHOD 300.0: ANIONS | | | | | | | Analyst: MRA |
| Chloride | 36000 | 1500 | | mg/Kg | 1E | 5/31/2018 7:32:16 PM | 38393 |
| EPA METHOD 8015M/D: DIESEL RANGE ORGANICS | | | | | | | Analyst: TOM |
| Diesel Range Organics (DRO) | 74 | 10 | | mg/Kg | 1 | 5/30/2018 4:14:11 PM | 38367 |
| Motor Oil Range Organics (MRO) | ND | 50 | | mg/Kg | 1 | 5/30/2018 4:14:11 PM | 38367 |
| Surr: DNOP | 98.8 | 70-130 | | %Rec | 1 | 5/30/2018 4:14:11 PM | 38367 |
| EPA METHOD 8015D: GASOLINE RANGE | | | | | | | Analyst: NSB |
| Gasoline Range Organics (GRO) | ND | 4.9 | | mg/Kg | 1 | 5/30/2018 1:12:19 AM | 38338 |
| Surr: BFB | 93.3 | 15-316 | | %Rec | 1 | 5/30/2018 1:12:19 AM | 38338 |
| EPA METHOD 8021B: VOLATILES | | | | | | | Analyst: NSB |
| Methyl tert-butyl ether (MTBE) | ND | 0.098 | | mg/Kg | 1 | 5/30/2018 1:12:19 AM | 38338 |
| Benzene | ND | 0.025 | | mg/Kg | 1 | 5/30/2018 1:12:19 AM | 38338 |
| Toluene | ND | 0.049 | | mg/Kg | 1 | 5/30/2018 1:12:19 AM | 38338 |
| Ethylbenzene | ND | 0.049 | | mg/Kg | 1 | 5/30/2018 1:12:19 AM | 38338 |
| Xylenes, Total | ND | 0.098 | | mg/Kg | 1 | 5/30/2018 1:12:19 AM | 38338 |
| Surr: 4-Bromofluorobenzene | 99.6 | 80-120 | | %Rec | 1 | 5/30/2018 1:12:19 AM | 38338 |

Refer to the QC Summary report and sample login checklist for flagged QC data and preservation information.

| | | | | |
|--------------------|-----|---|----|---|
| Qualifiers: | * | Value exceeds Maximum Contaminant Level. | B | Analyte detected in the associated Method Blank |
| | D | Sample Diluted Due to Matrix | E | Value above quantitation range |
| | H | Holding times for preparation or analysis exceeded | J | Analyte detected below quantitation limits |
| | ND | Not Detected at the Reporting Limit | P | Sample pH Not In Range |
| | PQL | Practical Quantitative Limit | RL | Reporting Detection Limit |
| | S | % Recovery outside of range due to dilution or matrix | W | Sample container temperature is out of limit as specified |

Hall Environmental Analysis Laboratory, Inc.

Analytical Report

Lab Order **1805E14**

Date Reported: **6/6/2018**

CLIENT: Souder, Miller & Associates

Client Sample ID: L1-0.5'

Project: Cypress

Collection Date: 5/22/2018 11:36:00 AM

Lab ID: 1805E14-002

Matrix: SOIL

Received Date: 5/25/2018 9:15:00 AM

| Analyses | Result | PQL | Qual | Units | DF | Date Analyzed | Batch |
|---------------------------------|--------|-----|------|-------|-----|----------------------|---------------------|
| EPA METHOD 300.0: ANIONS | | | | | | | Analyst: MRA |
| Chloride | 10000 | 750 | | mg/Kg | 500 | 5/31/2018 7:44:41 PM | 38393 |

Refer to the QC Summary report and sample login checklist for flagged QC data and preservation information.

| | | | | |
|--------------------|-----|---|----|---|
| Qualifiers: | * | Value exceeds Maximum Contaminant Level. | B | Analyte detected in the associated Method Blank |
| | D | Sample Diluted Due to Matrix | E | Value above quantitation range |
| | H | Holding times for preparation or analysis exceeded | J | Analyte detected below quantitation limits |
| | ND | Not Detected at the Reporting Limit | P | Sample pH Not In Range |
| | PQL | Practical Quantitative Limit | RL | Reporting Detection Limit |
| | S | % Recovery outside of range due to dilution or matrix | W | Sample container temperature is out of limit as specified |

Hall Environmental Analysis Laboratory, Inc.

Analytical Report

Lab Order **1805E14**

Date Reported: **6/6/2018**

CLIENT: Souder, Miller & Associates

Client Sample ID: L2-Surface

Project: Cypress

Collection Date: 5/22/2018 11:48:00 AM

Lab ID: 1805E14-003

Matrix: SOIL

Received Date: 5/25/2018 9:15:00 AM

| Analyses | Result | PQL | Qual | Units | DF | Date Analyzed | Batch |
|--|--------|--------|------|-------|----|----------------------|---------------------|
| EPA METHOD 300.0: ANIONS | | | | | | | Analyst: MRA |
| Chloride | 210 | 30 | | mg/Kg | 20 | 5/31/2018 2:50:32 AM | 38393 |
| EPA METHOD 8015M/D: DIESEL RANGE ORGANICS | | | | | | | Analyst: TOM |
| Diesel Range Organics (DRO) | 23 | 10 | | mg/Kg | 1 | 5/30/2018 5:27:15 PM | 38367 |
| Motor Oil Range Organics (MRO) | ND | 50 | | mg/Kg | 1 | 5/30/2018 5:27:15 PM | 38367 |
| Surr: DNOP | 91.9 | 70-130 | | %Rec | 1 | 5/30/2018 5:27:15 PM | 38367 |
| EPA METHOD 8015D: GASOLINE RANGE | | | | | | | Analyst: NSB |
| Gasoline Range Organics (GRO) | ND | 4.8 | | mg/Kg | 1 | 5/30/2018 1:35:36 AM | 38338 |
| Surr: BFB | 90.7 | 15-316 | | %Rec | 1 | 5/30/2018 1:35:36 AM | 38338 |
| EPA METHOD 8021B: VOLATILES | | | | | | | Analyst: NSB |
| Methyl tert-butyl ether (MTBE) | ND | 0.095 | | mg/Kg | 1 | 5/30/2018 1:35:36 AM | 38338 |
| Benzene | ND | 0.024 | | mg/Kg | 1 | 5/30/2018 1:35:36 AM | 38338 |
| Toluene | ND | 0.048 | | mg/Kg | 1 | 5/30/2018 1:35:36 AM | 38338 |
| Ethylbenzene | ND | 0.048 | | mg/Kg | 1 | 5/30/2018 1:35:36 AM | 38338 |
| Xylenes, Total | ND | 0.095 | | mg/Kg | 1 | 5/30/2018 1:35:36 AM | 38338 |
| Surr: 4-Bromofluorobenzene | 98.6 | 80-120 | | %Rec | 1 | 5/30/2018 1:35:36 AM | 38338 |

Refer to the QC Summary report and sample login checklist for flagged QC data and preservation information.

| | | | | |
|--------------------|-----|---|----|---|
| Qualifiers: | * | Value exceeds Maximum Contaminant Level. | B | Analyte detected in the associated Method Blank |
| | D | Sample Diluted Due to Matrix | E | Value above quantitation range |
| | H | Holding times for preparation or analysis exceeded | J | Analyte detected below quantitation limits |
| | ND | Not Detected at the Reporting Limit | P | Sample pH Not In Range |
| | PQL | Practical Quantitative Limit | RL | Reporting Detection Limit |
| | S | % Recovery outside of range due to dilution or matrix | W | Sample container temperature is out of limit as specified |

Hall Environmental Analysis Laboratory, Inc.

Analytical Report

Lab Order **1805E14**

Date Reported: **6/6/2018**

CLIENT: Souder, Miller & Associates

Client Sample ID: L2-0.5

Project: Cypress

Collection Date: 5/22/2018 12:00:00 PM

Lab ID: 1805E14-004

Matrix: SOIL

Received Date: 5/25/2018 9:15:00 AM

| Analyses | Result | PQL | Qual | Units | DF | Date Analyzed | Batch |
|---------------------------------|--------|-----|------|-------|----|----------------------|---------------------|
| EPA METHOD 300.0: ANIONS | | | | | | | Analyst: MRA |
| Chloride | 100 | 30 | | mg/Kg | 20 | 5/31/2018 3:02:57 AM | 38393 |

Refer to the QC Summary report and sample login checklist for flagged QC data and preservation information.

| | | | | |
|--------------------|-----|---|----|---|
| Qualifiers: | * | Value exceeds Maximum Contaminant Level. | B | Analyte detected in the associated Method Blank |
| | D | Sample Diluted Due to Matrix | E | Value above quantitation range |
| | H | Holding times for preparation or analysis exceeded | J | Analyte detected below quantitation limits |
| | ND | Not Detected at the Reporting Limit | P | Sample pH Not In Range |
| | PQL | Practical Quantitative Limit | RL | Reporting Detection Limit |
| | S | % Recovery outside of range due to dilution or matrix | W | Sample container temperature is out of limit as specified |

Hall Environmental Analysis Laboratory, Inc.

Analytical Report

Lab Order **1805E14**

Date Reported: **6/6/2018**

CLIENT: Souder, Miller & Associates

Client Sample ID: L2-1'

Project: Cypress

Collection Date: 5/22/2018 12:15:00 PM

Lab ID: 1805E14-005

Matrix: SOIL

Received Date: 5/25/2018 9:15:00 AM

| Analyses | Result | PQL | Qual | Units | DF | Date Analyzed | Batch |
|---------------------------------|--------|-----|------|-------|----|----------------------|---------------------|
| EPA METHOD 300.0: ANIONS | | | | | | | Analyst: MRA |
| Chloride | 120 | 30 | | mg/Kg | 20 | 5/31/2018 3:15:22 AM | 38393 |

Refer to the QC Summary report and sample login checklist for flagged QC data and preservation information.

| | | | | |
|--------------------|-----|---|----|---|
| Qualifiers: | * | Value exceeds Maximum Contaminant Level. | B | Analyte detected in the associated Method Blank |
| | D | Sample Diluted Due to Matrix | E | Value above quantitation range |
| | H | Holding times for preparation or analysis exceeded | J | Analyte detected below quantitation limits |
| | ND | Not Detected at the Reporting Limit | P | Sample pH Not In Range |
| | PQL | Practical Quantitative Limit | RL | Reporting Detection Limit |
| | S | % Recovery outside of range due to dilution or matrix | W | Sample container temperature is out of limit as specified |

Hall Environmental Analysis Laboratory, Inc.

Analytical Report

Lab Order **1805E14**

Date Reported: **6/6/2018**

CLIENT: Souder, Miller & Associates

Client Sample ID: L3-Surface

Project: Cypress

Collection Date: 5/22/2018 12:32:00 PM

Lab ID: 1805E14-006

Matrix: SOIL

Received Date: 5/25/2018 9:15:00 AM

| Analyses | Result | PQL | Qual | Units | DF | Date Analyzed | Batch |
|--|--------|--------|------|-------|-----|----------------------|---------------------|
| EPA METHOD 300.0: ANIONS | | | | | | | Analyst: MRA |
| Chloride | 8500 | 300 | | mg/Kg | 200 | 5/31/2018 7:57:06 PM | 38393 |
| EPA METHOD 8015M/D: DIESEL RANGE ORGANICS | | | | | | | Analyst: TOM |
| Diesel Range Organics (DRO) | 90 | 10 | | mg/Kg | 1 | 5/30/2018 5:51:31 PM | 38367 |
| Motor Oil Range Organics (MRO) | 63 | 50 | | mg/Kg | 1 | 5/30/2018 5:51:31 PM | 38367 |
| Surr: DNOP | 112 | 70-130 | | %Rec | 1 | 5/30/2018 5:51:31 PM | 38367 |
| EPA METHOD 8015D: GASOLINE RANGE | | | | | | | Analyst: NSB |
| Gasoline Range Organics (GRO) | ND | 4.9 | | mg/Kg | 1 | 5/30/2018 1:59:06 AM | 38338 |
| Surr: BFB | 89.9 | 15-316 | | %Rec | 1 | 5/30/2018 1:59:06 AM | 38338 |
| EPA METHOD 8021B: VOLATILES | | | | | | | Analyst: NSB |
| Methyl tert-butyl ether (MTBE) | ND | 0.098 | | mg/Kg | 1 | 5/30/2018 1:59:06 AM | 38338 |
| Benzene | ND | 0.025 | | mg/Kg | 1 | 5/30/2018 1:59:06 AM | 38338 |
| Toluene | ND | 0.049 | | mg/Kg | 1 | 5/30/2018 1:59:06 AM | 38338 |
| Ethylbenzene | ND | 0.049 | | mg/Kg | 1 | 5/30/2018 1:59:06 AM | 38338 |
| Xylenes, Total | ND | 0.098 | | mg/Kg | 1 | 5/30/2018 1:59:06 AM | 38338 |
| Surr: 4-Bromofluorobenzene | 99.9 | 80-120 | | %Rec | 1 | 5/30/2018 1:59:06 AM | 38338 |

Refer to the QC Summary report and sample login checklist for flagged QC data and preservation information.

| | | | | |
|--------------------|-----|---|----|---|
| Qualifiers: | * | Value exceeds Maximum Contaminant Level. | B | Analyte detected in the associated Method Blank |
| | D | Sample Diluted Due to Matrix | E | Value above quantitation range |
| | H | Holding times for preparation or analysis exceeded | J | Analyte detected below quantitation limits |
| | ND | Not Detected at the Reporting Limit | P | Sample pH Not In Range |
| | PQL | Practical Quantitative Limit | RL | Reporting Detection Limit |
| | S | % Recovery outside of range due to dilution or matrix | W | Sample container temperature is out of limit as specified |

Hall Environmental Analysis Laboratory, Inc.

Analytical Report

Lab Order **1805E14**

Date Reported: **6/6/2018**

CLIENT: Souder, Miller & Associates

Client Sample ID: L3-0.5'

Project: Cypress

Collection Date: 5/22/2018 12:47:00 PM

Lab ID: 1805E14-007

Matrix: SOIL

Received Date: 5/25/2018 9:15:00 AM

| Analyses | Result | PQL | Qual | Units | DF | Date Analyzed | Batch |
|---------------------------------|--------|-----|------|-------|----|----------------------|---------------------|
| EPA METHOD 300.0: ANIONS | | | | | | | Analyst: MRA |
| Chloride | 70 | 30 | | mg/Kg | 20 | 5/31/2018 3:40:11 AM | 38393 |

Refer to the QC Summary report and sample login checklist for flagged QC data and preservation information.

| | | | | |
|--------------------|-----|---|----|---|
| Qualifiers: | * | Value exceeds Maximum Contaminant Level. | B | Analyte detected in the associated Method Blank |
| | D | Sample Diluted Due to Matrix | E | Value above quantitation range |
| | H | Holding times for preparation or analysis exceeded | J | Analyte detected below quantitation limits |
| | ND | Not Detected at the Reporting Limit | P | Sample pH Not In Range |
| | PQL | Practical Quantitative Limit | RL | Reporting Detection Limit |
| | S | % Recovery outside of range due to dilution or matrix | W | Sample container temperature is out of limit as specified |

Hall Environmental Analysis Laboratory, Inc.

Analytical Report

Lab Order **1805E14**

Date Reported: **6/6/2018**

CLIENT: Souder, Miller & Associates

Client Sample ID: L4-Surface

Project: Cypress

Collection Date: 5/22/2018 12:58:00 PM

Lab ID: 1805E14-008

Matrix: SOIL

Received Date: 5/25/2018 9:15:00 AM

| Analyses | Result | PQL | Qual | Units | DF | Date Analyzed | Batch |
|--|--------|--------|------|-------|-----|----------------------|---------------------|
| EPA METHOD 300.0: ANIONS | | | | | | | Analyst: MRA |
| Chloride | 2900 | 150 | | mg/Kg | 100 | 5/31/2018 8:09:30 PM | 38393 |
| EPA METHOD 8015M/D: DIESEL RANGE ORGANICS | | | | | | | Analyst: TOM |
| Diesel Range Organics (DRO) | 130 | 10 | | mg/Kg | 1 | 5/30/2018 6:15:56 PM | 38367 |
| Motor Oil Range Organics (MRO) | 91 | 50 | | mg/Kg | 1 | 5/30/2018 6:15:56 PM | 38367 |
| Surr: DNOP | 99.7 | 70-130 | | %Rec | 1 | 5/30/2018 6:15:56 PM | 38367 |
| EPA METHOD 8015D: GASOLINE RANGE | | | | | | | Analyst: NSB |
| Gasoline Range Organics (GRO) | ND | 4.6 | | mg/Kg | 1 | 5/30/2018 2:22:40 AM | 38338 |
| Surr: BFB | 90.3 | 15-316 | | %Rec | 1 | 5/30/2018 2:22:40 AM | 38338 |
| EPA METHOD 8021B: VOLATILES | | | | | | | Analyst: NSB |
| Methyl tert-butyl ether (MTBE) | ND | 0.092 | | mg/Kg | 1 | 5/30/2018 2:22:40 AM | 38338 |
| Benzene | ND | 0.023 | | mg/Kg | 1 | 5/30/2018 2:22:40 AM | 38338 |
| Toluene | ND | 0.046 | | mg/Kg | 1 | 5/30/2018 2:22:40 AM | 38338 |
| Ethylbenzene | ND | 0.046 | | mg/Kg | 1 | 5/30/2018 2:22:40 AM | 38338 |
| Xylenes, Total | ND | 0.092 | | mg/Kg | 1 | 5/30/2018 2:22:40 AM | 38338 |
| Surr: 4-Bromofluorobenzene | 98.3 | 80-120 | | %Rec | 1 | 5/30/2018 2:22:40 AM | 38338 |

Refer to the QC Summary report and sample login checklist for flagged QC data and preservation information.

| | | | | |
|--------------------|-----|---|----|---|
| Qualifiers: | * | Value exceeds Maximum Contaminant Level. | B | Analyte detected in the associated Method Blank |
| | D | Sample Diluted Due to Matrix | E | Value above quantitation range |
| | H | Holding times for preparation or analysis exceeded | J | Analyte detected below quantitation limits |
| | ND | Not Detected at the Reporting Limit | P | Sample pH Not In Range |
| | PQL | Practical Quantitative Limit | RL | Reporting Detection Limit |
| | S | % Recovery outside of range due to dilution or matrix | W | Sample container temperature is out of limit as specified |

Hall Environmental Analysis Laboratory, Inc.

Analytical Report

Lab Order **1805E14**

Date Reported: **6/6/2018**

CLIENT: Souder, Miller & Associates

Client Sample ID: L4-0.5'

Project: Cypress

Collection Date: 5/22/2018 1:07:00 PM

Lab ID: 1805E14-009

Matrix: SOIL

Received Date: 5/25/2018 9:15:00 AM

| Analyses | Result | PQL | Qual | Units | DF | Date Analyzed | Batch |
|---------------------------------|--------|-----|------|-------|----|----------------------|---------------------|
| EPA METHOD 300.0: ANIONS | | | | | | | Analyst: MRA |
| Chloride | 100 | 30 | | mg/Kg | 20 | 5/31/2018 4:29:48 AM | 38393 |

Refer to the QC Summary report and sample login checklist for flagged QC data and preservation information.

| | | | | |
|--------------------|-----|---|----|---|
| Qualifiers: | * | Value exceeds Maximum Contaminant Level. | B | Analyte detected in the associated Method Blank |
| | D | Sample Diluted Due to Matrix | E | Value above quantitation range |
| | H | Holding times for preparation or analysis exceeded | J | Analyte detected below quantitation limits |
| | ND | Not Detected at the Reporting Limit | P | Sample pH Not In Range |
| | PQL | Practical Quantitative Limit | RL | Reporting Detection Limit |
| | S | % Recovery outside of range due to dilution or matrix | W | Sample container temperature is out of limit as specified |

Hall Environmental Analysis Laboratory, Inc.

Analytical Report

Lab Order **1805E14**

Date Reported: **6/6/2018**

CLIENT: Souder, Miller & Associates

Client Sample ID: L5-Surface

Project: Cypress

Collection Date: 5/22/2018 1:14:00 PM

Lab ID: 1805E14-010

Matrix: SOIL

Received Date: 5/25/2018 9:15:00 AM

| Analyses | Result | PQL | Qual | Units | DF | Date Analyzed | Batch |
|--|--------|--------|------|-------|----|----------------------|---------------------|
| EPA METHOD 300.0: ANIONS | | | | | | | Analyst: MRA |
| Chloride | 2400 | 75 | | mg/Kg | 50 | 6/1/2018 11:54:23 AM | 38393 |
| EPA METHOD 8015M/D: DIESEL RANGE ORGANICS | | | | | | | Analyst: TOM |
| Diesel Range Organics (DRO) | 2400 | 99 | | mg/Kg | 10 | 5/31/2018 8:57:28 AM | 38367 |
| Motor Oil Range Organics (MRO) | 3900 | 490 | | mg/Kg | 10 | 5/31/2018 8:57:28 AM | 38367 |
| Surr: DNOP | 0 | 70-130 | S | %Rec | 10 | 5/31/2018 8:57:28 AM | 38367 |
| EPA METHOD 8015D: GASOLINE RANGE | | | | | | | Analyst: NSB |
| Gasoline Range Organics (GRO) | ND | 4.6 | | mg/Kg | 1 | 5/30/2018 2:46:03 AM | 38338 |
| Surr: BFB | 88.9 | 15-316 | | %Rec | 1 | 5/30/2018 2:46:03 AM | 38338 |
| EPA METHOD 8021B: VOLATILES | | | | | | | Analyst: NSB |
| Methyl tert-butyl ether (MTBE) | ND | 0.091 | | mg/Kg | 1 | 5/30/2018 2:46:03 AM | 38338 |
| Benzene | ND | 0.023 | | mg/Kg | 1 | 5/30/2018 2:46:03 AM | 38338 |
| Toluene | ND | 0.046 | | mg/Kg | 1 | 5/30/2018 2:46:03 AM | 38338 |
| Ethylbenzene | ND | 0.046 | | mg/Kg | 1 | 5/30/2018 2:46:03 AM | 38338 |
| Xylenes, Total | ND | 0.091 | | mg/Kg | 1 | 5/30/2018 2:46:03 AM | 38338 |
| Surr: 4-Bromofluorobenzene | 96.6 | 80-120 | | %Rec | 1 | 5/30/2018 2:46:03 AM | 38338 |

Refer to the QC Summary report and sample login checklist for flagged QC data and preservation information.

| | | | | |
|--------------------|-----|---|----|---|
| Qualifiers: | * | Value exceeds Maximum Contaminant Level. | B | Analyte detected in the associated Method Blank |
| | D | Sample Diluted Due to Matrix | E | Value above quantitation range |
| | H | Holding times for preparation or analysis exceeded | J | Analyte detected below quantitation limits |
| | ND | Not Detected at the Reporting Limit | P | Sample pH Not In Range |
| | PQL | Practical Quantitative Limit | RL | Reporting Detection Limit |
| | S | % Recovery outside of range due to dilution or matrix | W | Sample container temperature is out of limit as specified |

Hall Environmental Analysis Laboratory, Inc.

Analytical Report

Lab Order **1805E14**

Date Reported: **6/6/2018**

CLIENT: Souder, Miller & Associates

Client Sample ID: L5-0.5'

Project: Cypress

Collection Date: 5/22/2018 1:21:00 PM

Lab ID: 1805E14-011

Matrix: SOIL

Received Date: 5/25/2018 9:15:00 AM

| Analyses | Result | PQL | Qual | Units | DF | Date Analyzed | Batch |
|---------------------------------|--------|-----|------|-------|----|----------------------|---------------------|
| EPA METHOD 300.0: ANIONS | | | | | | | Analyst: MRA |
| Chloride | 290 | 30 | | mg/Kg | 20 | 5/31/2018 4:54:38 AM | 38393 |

Refer to the QC Summary report and sample login checklist for flagged QC data and preservation information.

| | | | | |
|--------------------|-----|---|----|---|
| Qualifiers: | * | Value exceeds Maximum Contaminant Level. | B | Analyte detected in the associated Method Blank |
| | D | Sample Diluted Due to Matrix | E | Value above quantitation range |
| | H | Holding times for preparation or analysis exceeded | J | Analyte detected below quantitation limits |
| | ND | Not Detected at the Reporting Limit | P | Sample pH Not In Range |
| | PQL | Practical Quantitative Limit | RL | Reporting Detection Limit |
| | S | % Recovery outside of range due to dilution or matrix | W | Sample container temperature is out of limit as specified |

Hall Environmental Analysis Laboratory, Inc.

Analytical Report

Lab Order **1805E14**

Date Reported: **6/6/2018**

CLIENT: Souder, Miller & Associates

Client Sample ID: Background

Project: Cypress

Collection Date: 5/22/2018 1:47:00 PM

Lab ID: 1805E14-012

Matrix: SOIL

Received Date: 5/25/2018 9:15:00 AM

| Analyses | Result | PQL | Qual | Units | DF | Date Analyzed | Batch |
|---------------------------------|--------|-----|------|-------|----|----------------------|---------------------|
| EPA METHOD 300.0: ANIONS | | | | | | | Analyst: MRA |
| Chloride | ND | 30 | | mg/Kg | 20 | 5/31/2018 5:07:02 AM | 38393 |

Refer to the QC Summary report and sample login checklist for flagged QC data and preservation information.

| | | | | |
|--------------------|-----|---|----|---|
| Qualifiers: | * | Value exceeds Maximum Contaminant Level. | B | Analyte detected in the associated Method Blank |
| | D | Sample Diluted Due to Matrix | E | Value above quantitation range |
| | H | Holding times for preparation or analysis exceeded | J | Analyte detected below quantitation limits |
| | ND | Not Detected at the Reporting Limit | P | Sample pH Not In Range |
| | PQL | Practical Quantitative Limit | RL | Reporting Detection Limit |
| | S | % Recovery outside of range due to dilution or matrix | W | Sample container temperature is out of limit as specified |

QC SUMMARY REPORT

Hall Environmental Analysis Laboratory, Inc.

WO#: 1805E14

06-Jun-18

Client: Souder, Miller & Associates

Project: Cypress

| | | | | | | | | | | | |
|------------|-----------|-----|----------------|-------------|------|-----------|--------------------------|------|--------------|------|--|
| Sample ID | MB-38393 | | SampType: | mblk | | TestCode: | EPA Method 300.0: Anions | | | | |
| Client ID: | PBS | | Batch ID: | 38393 | | RunNo: | 51601 | | | | |
| Prep Date: | 5/30/2018 | | Analysis Date: | 5/31/2018 | | SeqNo: | 1683711 | | Units: mg/Kg | | |
| Analyte | Result | PQL | SPK value | SPK Ref Val | %REC | LowLimit | HighLimit | %RPD | RPDLimit | Qual | |
| Chloride | ND | 1.5 | | | | | | | | | |

| | | | | | | | | | | |
|------------|-----------|-----|--------------------------|-------------|------------------------------------|----------|--------------|------|----------|------|
| Sample ID | LCS-38393 | | SampType: lcs | | TestCode: EPA Method 300.0: Anions | | | | | |
| Client ID: | LCSS | | Batch ID: 38393 | | RunNo: 51601 | | | | | |
| Prep Date: | 5/30/2018 | | Analysis Date: 5/31/2018 | | SeqNo: 1683712 | | Units: mg/Kg | | | |
| Analyte | Result | PQL | SPK value | SPK Ref Val | %REC | LowLimit | HighLimit | %RPD | RPDLimit | Qual |
| Chloride | 14 | 1.5 | 15.00 | 0 | 93.5 | 90 | 110 | | | |

Qualifiers:

* Value exceeds Maximum Contaminant Level.
D Sample Diluted Due to Matrix
H Holding times for preparation or analysis exceeded
ND Not Detected at the Reporting Limit
PQL Practical Quantitative Limit
S % Recovery outside of range due to dilution or matrix

B Analyte detected in the associated Method Blank
E Value above quantitation range
J Analyte detected below quantitation limits
P Sample pH Not In Range
RL Reporting Detection Limit
W Sample container temperature is out of limit as specified

QC SUMMARY REPORT

Hall Environmental Analysis Laboratory, Inc.

WO#: 1805E14

06-Jun-18

Client: Souder, Miller & Associates

Project: Cypress

| | | | | | | | | | | |
|-----------------------------|-----------|-----|--------------------------|-------------|---|----------|--------------|------|----------|------|
| Sample ID | LCS-38367 | | SampType: LCS | | TestCode: EPA Method 8015M/D: Diesel Range Organics | | | | | |
| Client ID: | LCSS | | Batch ID: 38367 | | RunNo: 51593 | | | | | |
| Prep Date: | 5/29/2018 | | Analysis Date: 5/30/2018 | | SeqNo: 1682090 | | Units: mg/Kg | | | |
| Analyte | Result | PQL | SPK value | SPK Ref Val | %REC | LowLimit | HighLimit | %RPD | RPDLimit | Qual |
| Diesel Range Organics (DRO) | 53 | 10 | 50.00 | 0 | 105 | 70 | 130 | | | |
| Surr: DNOP | 4.6 | | 5.000 | | 91.8 | 70 | 130 | | | |

| | | | | | | | | | | |
|--------------------------------|-----------|--------------------------|-----------|---|------|----------|--------------|------|----------|------|
| Sample ID | MB-38367 | SampType: MBLK | | TestCode: EPA Method 8015M/D: Diesel Range Organics | | | | | | |
| Client ID: | PBS | Batch ID: 38367 | | RunNo: 51593 | | | | | | |
| Prep Date: | 5/29/2018 | Analysis Date: 5/30/2018 | | SeqNo: 1682091 | | | Units: mg/Kg | | | |
| Analyte | Result | PQL | SPK value | SPK Ref Val | %REC | LowLimit | HighLimit | %RPD | RPDLimit | Qual |
| Diesel Range Organics (DRO) | ND | 10 | | | | | | | | |
| Motor Oil Range Organics (MRO) | ND | 50 | | | | | | | | |
| Surr: DNOP | 9.9 | | 10.00 | | 99.4 | 70 | 130 | | | |

| | | | | | | | | | | |
|-----------------------------|----------------|-----|--------------------------|-------------|---|----------|--------------|------|----------|------|
| Sample ID | 1805E14-001AMS | | SampType: MS | | TestCode: EPA Method 8015M/D: Diesel Range Organics | | | | | |
| Client ID: | L1-Surface | | Batch ID: 38367 | | RunNo: 51593 | | | | | |
| Prep Date: | 5/29/2018 | | Analysis Date: 5/30/2018 | | SeqNo: 1682961 | | Units: mg/Kg | | | |
| Analyte | Result | PQL | SPK value | SPK Ref Val | %REC | LowLimit | HighLimit | %RPD | RPDLimit | Qual |
| Diesel Range Organics (DRO) | 100 | 9.8 | 49.16 | 74.04 | 58.0 | 62 | 120 | | | S |
| Surr: DNOP | 4.9 | | 4.916 | | 99.7 | 70 | 130 | | | |

| | | | | | | | | | | | |
|-----------------------------|-----------------|-----|----------------|-------------|------|-----------|---|------|--------------|------|--|
| Sample ID | 1805E14-001AMSD | | SampType: | MSD | | TestCode: | EPA Method 8015M/D: Diesel Range Organics | | | | |
| Client ID: | L1-Surface | | Batch ID: | 38367 | | RunNo: | 51593 | | | | |
| Prep Date: | 5/29/2018 | | Analysis Date: | 5/30/2018 | | SeqNo: | 1682962 | | Units: mg/Kg | | |
| Analyte | Result | PQL | SPK value | SPK Ref Val | %REC | LowLimit | HighLimit | %RPD | RPDLimit | Qual | |
| Diesel Range Organics (DRO) | 100 | 10 | 50.10 | 74.04 | 61.3 | 62 | 120 | 2.10 | 20 | S | |
| Surr: DNOP | 5.1 | | 5.010 | | 101 | 70 | 130 | 0 | 0 | | |

Qualifiers:

* Value exceeds Maximum Contaminant Level.
D Sample Diluted Due to Matrix
H Holding times for preparation or analysis exceeded
ND Not Detected at the Reporting Limit
PQL Practical Quantitative Limit
S % Recovery outside of range due to dilution or matrix

B Analyte detected in the associated Method Blank
E Value above quantitation range
J Analyte detected below quantitation limits
P Sample pH Not In Range
RL Reporting Detection Limit
W Sample container temperature is out of limit as specified

QC SUMMARY REPORT

Hall Environmental Analysis Laboratory, Inc.

WO#: 1805E14

06-Jun-18

Client: Souder, Miller & Associates

Project: Cypress

| | | | | | | | | | | |
|-------------------------------|-----------|-----|--------------------------|-------------|--|----------|--------------|------|----------|------|
| Sample ID | MB-38338 | | SampType: MBLK | | TestCode: EPA Method 8015D: Gasoline Range | | | | | |
| Client ID: | PBS | | Batch ID: 38338 | | RunNo: 51580 | | | | | |
| Prep Date: | 5/25/2018 | | Analysis Date: 5/29/2018 | | SeqNo: 1681351 | | Units: mg/Kg | | | |
| Analyte | Result | PQL | SPK value | SPK Ref Val | %REC | LowLimit | HighLimit | %RPD | RPDLimit | Qual |
| Gasoline Range Organics (GRO) | ND | 5.0 | | | | | | | | |
| Surr: BFB | 950 | | 1000 | | 95.1 | 15 | 316 | | | |

| | | | | | | | | | | |
|-------------------------------|-----------|-----|--------------------------|-------------|--|----------|--------------|------|----------|------|
| Sample ID | LCS-38338 | | SampType: LCS | | TestCode: EPA Method 8015D: Gasoline Range | | | | | |
| Client ID: | LCSS | | Batch ID: 38338 | | RunNo: 51580 | | | | | |
| Prep Date: | 5/25/2018 | | Analysis Date: 5/29/2018 | | SeqNo: 1681352 | | Units: mg/Kg | | | |
| Analyte | Result | PQL | SPK value | SPK Ref Val | %REC | LowLimit | HighLimit | %RPD | RPDLimit | Qual |
| Gasoline Range Organics (GRO) | 29 | 5.0 | 25.00 | 0 | 114 | 75.9 | 131 | | | |
| Surr: BFB | 1100 | | 1000 | | 112 | 15 | 316 | | | |

| | | | | | | | | | | |
|-------------------------------|----------------|-----|--------------------------|-------------|--|----------|--------------|------|----------|------|
| Sample ID | 1805E14-001AMS | | SampType: MS | | TestCode: EPA Method 8015D: Gasoline Range | | | | | |
| Client ID: | L1-Surface | | Batch ID: 38338 | | RunNo: 51580 | | | | | |
| Prep Date: | 5/25/2018 | | Analysis Date: 5/29/2018 | | SeqNo: 1681354 | | Units: mg/Kg | | | |
| Analyte | Result | PQL | SPK value | SPK Ref Val | %REC | LowLimit | HighLimit | %RPD | RPDLimit | Qual |
| Gasoline Range Organics (GRO) | 25 | 4.8 | 23.76 | 0 | 104 | 77.8 | 128 | | | |
| Surr: BFB | 980 | | 950.6 | | 103 | 15 | 316 | | | |

| | | | | | | | | | | | |
|-------------------------------|-----------------|-----|----------------|-------------|------|-----------|----------------------------------|------|----------|-------|--|
| Sample ID | 1805E14-001AMSD | | SampType: | MSD | | TestCode: | EPA Method 8015D: Gasoline Range | | | | |
| Client ID: | L1-Surface | | Batch ID: | 38338 | | RunNo: | 51580 | | | | |
| Prep Date: | 5/25/2018 | | Analysis Date: | 5/29/2018 | | SeqNo: | 1681355 | | Units: | mg/Kg | |
| Analyte | Result | PQL | SPK value | SPK Ref Val | %REC | LowLimit | HighLimit | %RPD | RPDLimit | Qual | |
| Gasoline Range Organics (GRO) | 27 | 4.8 | 24.02 | 0 | 112 | 77.8 | 128 | 7.93 | 20 | | |
| Surr: BFB | 990 | | 960.6 | | 103 | 15 | 316 | 0 | 0 | | |

| | | | | | | | | | | |
|------------|-----------|-----|--------------------------|-------------|--|----------|-------------|------|----------|------|
| Sample ID | MB-38366 | | SampType: MBLK | | TestCode: EPA Method 8015D: Gasoline Range | | | | | |
| Client ID: | PBS | | Batch ID: 38366 | | RunNo: 51603 | | | | | |
| Prep Date: | 5/29/2018 | | Analysis Date: 5/30/2018 | | SeqNo: 1682799 | | Units: %Rec | | | |
| Analyte | Result | PQL | SPK value | SPK Ref Val | %REC | LowLimit | HighLimit | %RPD | RPDLimit | Qual |
| Surr: BFB | 930 | | 1000 | | 92.9 | 15 | 316 | | | |

| | | | | | | | | | | |
|------------|-----------|-----|--------------------------|-------------|--|----------|-------------|------|----------|------|
| Sample ID | LCS-38366 | | SampType: LCS | | TestCode: EPA Method 8015D: Gasoline Range | | | | | |
| Client ID: | LCSS | | Batch ID: 38366 | | RunNo: 51603 | | | | | |
| Prep Date: | 5/29/2018 | | Analysis Date: 5/30/2018 | | SeqNo: 1682800 | | Units: %Rec | | | |
| Analyte | Result | PQL | SPK value | SPK Ref Val | %REC | LowLimit | HighLimit | %RPD | RPDLimit | Qual |
| Surr: BFB | 1100 | | 1000 | | 106 | 15 | 316 | | | |

Qualifiers:

| | |
|---|---|
| * Value exceeds Maximum Contaminant Level. | B Analyte detected in the associated Method Blank |
| D Sample Diluted Due to Matrix | E Value above quantitation range |
| H Holding times for preparation or analysis exceeded | J Analyte detected below quantitation limits |
| ND Not Detected at the Reporting Limit | P Sample pH Not In Range |
| PQL Practical Quantitative Limit | RL Reporting Detection Limit |
| S % Recovery outside of range due to dilution or matrix | W Sample container temperature is out of limit as specified |

QC SUMMARY REPORT

Hall Environmental Analysis Laboratory, Inc.

WO#: 1805E14

06-Jun-18

Client: Souder, Miller & Associates

Project: Cypress

| Sample ID MB-38338 | SampType: MBLK | | TestCode: EPA Method 8021B: Volatiles | | | | | | | |
|--------------------------------|---------------------------------|-------|--|-------------|---------------------|----------|-----------|------|----------|------|
| Client ID: PBS | Batch ID: 38338 | | RunNo: 51580 | | | | | | | |
| Prep Date: 5/25/2018 | Analysis Date: 5/29/2018 | | SeqNo: 1681394 | | Units: mg/Kg | | | | | |
| Analyte | Result | PQL | SPK value | SPK Ref Val | %REC | LowLimit | HighLimit | %RPD | RPDLimit | Qual |
| Methyl tert-butyl ether (MTBE) | ND | 0.10 | | | | | | | | |
| Benzene | ND | 0.025 | | | | | | | | |
| Toluene | ND | 0.050 | | | | | | | | |
| Ethylbenzene | ND | 0.050 | | | | | | | | |
| Xylenes, Total | ND | 0.10 | | | | | | | | |
| Surr: 4-Bromofluorobenzene | 1.0 | | 1.000 | | 105 | 80 | 120 | | | |

| Sample ID LCS-38338 | SampType: LCS | | TestCode: EPA Method 8021B: Volatiles | | | | | | | |
|--------------------------------|---------------------------------|-------|--|-------------|---------------------|----------|-----------|------|----------|------|
| Client ID: LCSS | Batch ID: 38338 | | RunNo: 51580 | | | | | | | |
| Prep Date: 5/25/2018 | Analysis Date: 5/29/2018 | | SeqNo: 1681396 | | Units: mg/Kg | | | | | |
| Analyte | Result | PQL | SPK value | SPK Ref Val | %REC | LowLimit | HighLimit | %RPD | RPDLimit | Qual |
| Methyl tert-butyl ether (MTBE) | 0.96 | 0.10 | 1.000 | 0 | 95.7 | 70.1 | 121 | | | |
| Benzene | 0.91 | 0.025 | 1.000 | 0 | 91.3 | 77.3 | 128 | | | |
| Toluene | 0.94 | 0.050 | 1.000 | 0 | 93.6 | 79.2 | 125 | | | |
| Ethylbenzene | 0.93 | 0.050 | 1.000 | 0 | 93.2 | 80.7 | 127 | | | |
| Xylenes, Total | 2.8 | 0.10 | 3.000 | 0 | 94.5 | 81.6 | 129 | | | |
| Surr: 4-Bromofluorobenzene | 1.1 | | 1.000 | | 106 | 80 | 120 | | | |

| Sample ID 1805E14-003AMS | SampType: MS | | TestCode: EPA Method 8021B: Volatiles | | | | | | | |
|---------------------------------|---------------------------------|-------|--|-------------|---------------------|----------|-----------|------|----------|------|
| Client ID: L2-Surface | Batch ID: 38338 | | RunNo: 51580 | | | | | | | |
| Prep Date: 5/25/2018 | Analysis Date: 5/29/2018 | | SeqNo: 1681401 | | Units: mg/Kg | | | | | |
| Analyte | Result | PQL | SPK value | SPK Ref Val | %REC | LowLimit | HighLimit | %RPD | RPDLimit | Qual |
| Methyl tert-butyl ether (MTBE) | 0.83 | 0.093 | 0.9320 | 0 | 88.7 | 56.9 | 130 | | | |
| Benzene | 0.81 | 0.023 | 0.9320 | 0 | 87.4 | 68.5 | 133 | | | |
| Toluene | 0.86 | 0.047 | 0.9320 | 0 | 92.7 | 75 | 130 | | | |
| Ethylbenzene | 0.87 | 0.047 | 0.9320 | 0 | 93.7 | 79.4 | 128 | | | |
| Xylenes, Total | 2.6 | 0.093 | 2.796 | 0 | 94.6 | 77.3 | 131 | | | |
| Surr: 4-Bromofluorobenzene | 0.99 | | 0.9320 | | 106 | 80 | 120 | | | |

| Sample ID 1805E14-003AMSD | SampType: MSD | | TestCode: EPA Method 8021B: Volatiles | | | | | | | |
|----------------------------------|---------------------------------|-------|--|-------------|---------------------|----------|-----------|------|----------|------|
| Client ID: L2-Surface | Batch ID: 38338 | | RunNo: 51580 | | | | | | | |
| Prep Date: 5/25/2018 | Analysis Date: 5/29/2018 | | SeqNo: 1681402 | | Units: mg/Kg | | | | | |
| Analyte | Result | PQL | SPK value | SPK Ref Val | %REC | LowLimit | HighLimit | %RPD | RPDLimit | Qual |
| Methyl tert-butyl ether (MTBE) | 0.86 | 0.092 | 0.9217 | 0 | 93.5 | 56.9 | 130 | 4.21 | 20 | |
| Benzene | 0.80 | 0.023 | 0.9217 | 0 | 86.7 | 68.5 | 133 | 1.89 | 20 | |
| Toluene | 0.84 | 0.046 | 0.9217 | 0 | 91.7 | 75 | 130 | 2.22 | 20 | |
| Ethylbenzene | 0.85 | 0.046 | 0.9217 | 0 | 92.1 | 79.4 | 128 | 2.82 | 20 | |

Qualifiers:

| | |
|---|---|
| * Value exceeds Maximum Contaminant Level. | B Analyte detected in the associated Method Blank |
| D Sample Diluted Due to Matrix | E Value above quantitation range |
| H Holding times for preparation or analysis exceeded | J Analyte detected below quantitation limits |
| ND Not Detected at the Reporting Limit | P Sample pH Not In Range |
| PQL Practical Quantitative Limit | RL Reporting Detection Limit |
| S % Recovery outside of range due to dilution or matrix | W Sample container temperature is out of limit as specified |

QC SUMMARY REPORT

Hall Environmental Analysis Laboratory, Inc.

WO#: 1805E14

06-Jun-18

Client: Souder, Miller & Associates

Project: Cypress

| | | | | | | | | | | |
|----------------------------|-----------------|----------------|-----------|-------------|-----------------------------|----------|-----------|------|----------|------|
| Sample ID | 1805E14-003AMSD | SampType: | MSD | TestCode: | EPA Method 8021B: Volatiles | | | | | |
| Client ID: | L2-Surface | Batch ID: | 38338 | RunNo: | 51580 | | | | | |
| Prep Date: | 5/25/2018 | Analysis Date: | 5/29/2018 | SeqNo: | 1681402 | Units: | mg/Kg | | | |
| Analyte | Result | PQL | SPK value | SPK Ref Val | %REC | LowLimit | HighLimit | %RPD | RPDLimit | Qual |
| Xylenes, Total | 2.6 | 0.092 | 2.765 | 0 | 94.7 | 77.3 | 131 | 1.03 | 20 | |
| Surr: 4-Bromofluorobenzene | 0.98 | | 0.9217 | | 106 | 80 | 120 | 0 | 0 | |

| | | | | | | | | | | |
|----------------------------|-----------|----------------|-----------|-------------|-----------------------------|----------|-----------|------|----------|------|
| Sample ID | MB-38366 | SampType: | MBLK | TestCode: | EPA Method 8021B: Volatiles | | | | | |
| Client ID: | PBS | Batch ID: | 38366 | RunNo: | 51603 | | | | | |
| Prep Date: | 5/29/2018 | Analysis Date: | 5/30/2018 | SeqNo: | 1682840 | Units: | %Rec | | | |
| Analyte | Result | PQL | SPK value | SPK Ref Val | %REC | LowLimit | HighLimit | %RPD | RPDLimit | Qual |
| Surr: 4-Bromofluorobenzene | 1.0 | | 1.000 | | 102 | 80 | 120 | | | |

| | | | | | | | | | | |
|----------------------------|-----------|----------------|-----------|-------------|-----------------------------|----------|-----------|------|----------|------|
| Sample ID | LCS-38366 | SampType: | LCS | TestCode: | EPA Method 8021B: Volatiles | | | | | |
| Client ID: | LCSS | Batch ID: | 38366 | RunNo: | 51603 | | | | | |
| Prep Date: | 5/29/2018 | Analysis Date: | 5/30/2018 | SeqNo: | 1682841 | Units: | %Rec | | | |
| Analyte | Result | PQL | SPK value | SPK Ref Val | %REC | LowLimit | HighLimit | %RPD | RPDLimit | Qual |
| Surr: 4-Bromofluorobenzene | 1.1 | | 1.000 | | 109 | 80 | 120 | | | |

Qualifiers:

* Value exceeds Maximum Contaminant Level.
D Sample Diluted Due to Matrix
H Holding times for preparation or analysis exceeded
ND Not Detected at the Reporting Limit
PQL Practical Quantitative Limit
S % Recovery outside of range due to dilution or matrix

B Analyte detected in the associated Method Blank
E Value above quantitation range
J Analyte detected below quantitation limits
P Sample pH Not In Range
RL Reporting Detection Limit
W Sample container temperature is out of limit as specified

Sample Log-In Check List

Client Name: SMA-CARLSBAD

Work Order Number: 1805E14

RcptNo: 1

Received By: Isaiah Ortiz 5/25/2018 9:15:00 AM

Completed By: Ashley Gallegos 5/25/2018 9:44:17 AM

Reviewed By: SB 05/25/18

Labeled by: ~~IG~~ ~~AG~~ 05/25/18

Chain of Custody

1. Is Chain of Custody complete? Yes ☒ No ☐ Not Present ☐
2. How was the sample delivered? Courier

Log In

3. Was an attempt made to cool the samples? Yes ☒ No ☐ NA ☐
4. Were all samples received at a temperature of >0° C to 6.0°C Yes ☒ No ☐ NA ☐
5. Sample(s) in proper container(s)? Yes ☒ No ☐
6. Sufficient sample volume for indicated test(s)? Yes ☒ No ☐
7. Are samples (except VOA and ONG) properly preserved? Yes ☒ No ☐
8. Was preservative added to bottles? Yes ☐ No ☒ NA ☐
9. VOA vials have zero headspace? Yes ☐ No ☐ No VOA Vials ☒
10. Were any sample containers received broken? Yes ☐ No ☒
11. Does paperwork match bottle labels? Yes ☒ No ☐
(Note discrepancies on chain of custody)
12. Are matrices correctly identified on Chain of Custody? Yes ☒ No ☐
13. Is it clear what analyses were requested? Yes ☒ No ☐
14. Were all holding times able to be met? Yes ☒ No ☐
(If no, notify customer for authorization.)

of preserved bottles checked for pH: 12
(12 or >12 unless noted)
Adjusted? Yes

Checked by: 05/25/18

Special Handling (if applicable)

15. Was client notified of all discrepancies with this order? Yes ☐ No ☐ NA ☒

Person Notified: _____ Date: _____
By Whom: _____ Via: ☐ eMail ☐ Phone ☐ Fax ☐ In Person
Regarding: _____
Client Instructions: _____

16. Additional remarks:

17. Cooler Information

| Cooler No | Temp °C | Condition | Seal Intact | Seal No | Seal Date | Signed By |
|-----------|---------|-----------|-------------|---------|-----------|-----------|
| 1 | 0.9 | Good | Yes | | | |

Turn-Around Time:

Client: SMA-Carlshad.

Mailing Address:

Phone #:

email or Fax#:

QA/QC Package:

☐ Standard

☐ Level 4 (Full Validation)

☐ Standard

Accreditation

☐ NELAP ☐ Other

☐ EDD (Type)

| Date | Time | Matrix | Sample Request ID |
|------|------|--------|-------------------|
|------|------|--------|-------------------|

Matrix

Sample Request ID

| Date | Time |
|------|------|
|------|------|

| | | | |
|-------|-------|-----|------------|
| 22/18 | 11:30 | 805 | L1-Surface |
|-------|-------|-----|------------|

1. 2. 3.

| | | | | | | | | | | | | | | | | | | | | | | | | | | | | | | | | | | | | | | | | | | | | | | | | | | | | | | | | | | | | | | | | | | | | | | | | | | | | | | | | | | | | | | | | | | | | | | | |
|---|---|---|---|---|----|----|----|----|----|----|----|----|----|----|----|----|----|----|----|----|----|----|----|----|----|----|----|----|----|----|----|----|----|----|----|----|----|----|----|----|----|----|----|----|----|----|----|----|----|----|----|----|----|----|----|----|----|----|----|----|----|----|----|----|----|----|----|----|----|----|----|----|----|----|----|----|----|----|----|----|----|----|----|----|----|----|----|----|----|----|----|----|----|----|-----|
| 5 | 6 | 7 | 8 | 9 | 10 | 11 | 12 | 13 | 14 | 15 | 16 | 17 | 18 | 19 | 20 | 21 | 22 | 23 | 24 | 25 | 26 | 27 | 28 | 29 | 30 | 31 | 32 | 33 | 34 | 35 | 36 | 37 | 38 | 39 | 40 | 41 | 42 | 43 | 44 | 45 | 46 | 47 | 48 | 49 | 50 | 51 | 52 | 53 | 54 | 55 | 56 | 57 | 58 | 59 | 60 | 61 | 62 | 63 | 64 | 65 | 66 | 67 | 68 | 69 | 70 | 71 | 72 | 73 | 74 | 75 | 76 | 77 | 78 | 79 | 80 | 81 | 82 | 83 | 84 | 85 | 86 | 87 | 88 | 89 | 90 | 91 | 92 | 93 | 94 | 95 | 96 | 97 | 98 | 99 | 100 |
|---|---|---|---|---|----|----|----|----|----|----|----|----|----|----|----|----|----|----|----|----|----|----|----|----|----|----|----|----|----|----|----|----|----|----|----|----|----|----|----|----|----|----|----|----|----|----|----|----|----|----|----|----|----|----|----|----|----|----|----|----|----|----|----|----|----|----|----|----|----|----|----|----|----|----|----|----|----|----|----|----|----|----|----|----|----|----|----|----|----|----|----|----|----|----|-----|

| | |
|-------|------------|
| 11:48 | 12-surface |
|-------|------------|

1200

1200

| | |
|-------|-------|
| 12:15 | 62-1' |
|-------|-------|

1728

17-01-2017

| | |
|-------|---------|
| 12:47 | 63-0.5' |
|-------|---------|

14-Start

14-Surf.

| | |
|------|---------|
| 1:07 | L4-0.5' |
|------|---------|

15-Sept

15-Surface

| | |
|------|--------|
| 1:21 | 25-0.5 |
| 1:23 | 0.5 |

Backg. v.

Balkgymn.

| | | |
|---------|-------|------------------|
| Date: / | Time: | Relinquished by: |
|---------|-------|------------------|

Relinquished by: _____

by: _____

| | | |
|-------|-------|------------------|
| Date: | Time: | Relinquished by: |
|-------|-------|------------------|

Relinquished by

2



Hall Environmental Analysis Laboratory
4901 Hawkins NE
Albuquerque, NM 87109
TEL: 505-345-3975 FAX: 505-345-4107
Website: www.hallenvironmental.com

June 22, 2018

Austin Weyant
Souder, Miller & Associates
201 S Halagueno
Carlsbad, NM 88221
TEL: (575) 689-7040
FAX

RE: Cypress 2H

OrderNo.: 1806A46

Dear Austin Weyant:

Hall Environmental Analysis Laboratory received 6 sample(s) on 6/15/2018 for the analyses presented in the following report.

These were analyzed according to EPA procedures or equivalent. To access our accredited tests please go to www.hallenvironmental.com or the state specific web sites. In order to properly interpret your results, it is imperative that you review this report in its entirety. See the sample checklist and/or the Chain of Custody for information regarding the sample receipt temperature and preservation. Data qualifiers or a narrative will be provided if the sample analysis or analytical quality control parameters require a flag. When necessary, data qualifiers are provided on both the sample analysis report and the QC summary report, both sections should be reviewed. All samples are reported, as received, unless otherwise indicated. Lab measurement of analytes considered field parameters that require analysis within 15 minutes of sampling such as pH and residual chlorine are qualified as being analyzed outside of the recommended holding time.

Please don't hesitate to contact HEAL for any additional information or clarifications.

ADHS Cert #AZ0682 -- NMED-DWB Cert #NM9425 -- NMED-Micro Cert #NM0901

Sincerely,

A handwritten signature in black ink, appearing to read 'Andy Freeman', is written over a horizontal line.

Andy Freeman
Laboratory Manager
4901 Hawkins NE
Albuquerque, NM 87109

Hall Environmental Analysis Laboratory, Inc.

Analytical Report

Lab Order **1806A46**

Date Reported: **6/22/2018**

CLIENT: Souder, Miller & Associates

Client Sample ID: L1-1

Project: Cypress 2H

Collection Date: 6/13/2018 9:15:00 AM

Lab ID: 1806A46-001

Matrix: SOIL

Received Date: 6/15/2018 9:00:00 AM

| Analyses | Result | PQL | Qual | Units | DF | Date Analyzed | Batch |
|--|--------|--------|------|-------|----|----------------------|---------------------|
| EPA METHOD 300.0: ANIONS | | | | | | | Analyst: smb |
| Chloride | 35 | 30 | | mg/Kg | 20 | 6/21/2018 2:21:44 PM | 38815 |
| EPA METHOD 8015M/D: DIESEL RANGE ORGANICS | | | | | | | Analyst: TOM |
| Diesel Range Organics (DRO) | ND | 9.7 | | mg/Kg | 1 | 6/20/2018 5:05:44 PM | 38767 |
| Motor Oil Range Organics (MRO) | ND | 48 | | mg/Kg | 1 | 6/20/2018 5:05:44 PM | 38767 |
| Surr: DNOP | 105 | 70-130 | | %Rec | 1 | 6/20/2018 5:05:44 PM | 38767 |
| EPA METHOD 8015D: GASOLINE RANGE | | | | | | | Analyst: NSB |
| Gasoline Range Organics (GRO) | ND | 4.9 | | mg/Kg | 1 | 6/20/2018 2:01:21 PM | 38762 |
| Surr: BFB | 80.7 | 15-316 | | %Rec | 1 | 6/20/2018 2:01:21 PM | 38762 |

Refer to the QC Summary report and sample login checklist for flagged QC data and preservation information.

| | | | | |
|--------------------|-----|---|----|---|
| Qualifiers: | * | Value exceeds Maximum Contaminant Level. | B | Analyte detected in the associated Method Blank |
| | D | Sample Diluted Due to Matrix | E | Value above quantitation range |
| | H | Holding times for preparation or analysis exceeded | J | Analyte detected below quantitation limits |
| | ND | Not Detected at the Reporting Limit | P | Sample pH Not In Range |
| | PQL | Practical Quantitative Limit | RL | Reporting Detection Limit |
| | S | % Recovery outside of range due to dilution or matrix | W | Sample container temperature is out of limit as specified |

Hall Environmental Analysis Laboratory, Inc.

Analytical Report

Lab Order **1806A46**

Date Reported: **6/22/2018**

CLIENT: Souder, Miller & Associates

Client Sample ID: SW1

Project: Cypress 2H

Collection Date: 6/13/2018 9:20:00 AM

Lab ID: 1806A46-002

Matrix: SOIL

Received Date: 6/15/2018 9:00:00 AM

| Analyses | Result | PQL | Qual | Units | DF | Date Analyzed | Batch |
|--|--------|--------|------|-------|----|----------------------|---------------------|
| EPA METHOD 300.0: ANIONS | | | | | | | Analyst: smb |
| Chloride | 40 | 30 | | mg/Kg | 20 | 6/21/2018 2:34:08 PM | 38815 |
| EPA METHOD 8015M/D: DIESEL RANGE ORGANICS | | | | | | | Analyst: TOM |
| Diesel Range Organics (DRO) | ND | 9.8 | | mg/Kg | 1 | 6/20/2018 5:27:47 PM | 38767 |
| Motor Oil Range Organics (MRO) | ND | 49 | | mg/Kg | 1 | 6/20/2018 5:27:47 PM | 38767 |
| Surr: DNOP | 109 | 70-130 | | %Rec | 1 | 6/20/2018 5:27:47 PM | 38767 |
| EPA METHOD 8015D: GASOLINE RANGE | | | | | | | Analyst: NSB |
| Gasoline Range Organics (GRO) | ND | 4.8 | | mg/Kg | 1 | 6/20/2018 3:11:56 PM | 38762 |
| Surr: BFB | 83.6 | 15-316 | | %Rec | 1 | 6/20/2018 3:11:56 PM | 38762 |

Refer to the QC Summary report and sample login checklist for flagged QC data and preservation information.

| | | | | |
|--------------------|-----|---|----|---|
| Qualifiers: | * | Value exceeds Maximum Contaminant Level. | B | Analyte detected in the associated Method Blank |
| | D | Sample Diluted Due to Matrix | E | Value above quantitation range |
| | H | Holding times for preparation or analysis exceeded | J | Analyte detected below quantitation limits |
| | ND | Not Detected at the Reporting Limit | P | Sample pH Not In Range |
| | PQL | Practical Quantitative Limit | RL | Reporting Detection Limit |
| | S | % Recovery outside of range due to dilution or matrix | W | Sample container temperature is out of limit as specified |

Hall Environmental Analysis Laboratory, Inc.

Analytical Report

Lab Order **1806A46**

Date Reported: **6/22/2018**

CLIENT: Souder, Miller & Associates

Client Sample ID: SW2

Project: Cypress 2H

Collection Date: 6/13/2018 9:25:00 AM

Lab ID: 1806A46-003

Matrix: SOIL

Received Date: 6/15/2018 9:00:00 AM

| Analyses | Result | PQL | Qual | Units | DF | Date Analyzed | Batch |
|--|--------|--------|------|-------|----|----------------------|---------------------|
| EPA METHOD 300.0: ANIONS | | | | | | | Analyst: smb |
| Chloride | 190 | 30 | | mg/Kg | 20 | 6/21/2018 2:46:32 PM | 38815 |
| EPA METHOD 8015M/D: DIESEL RANGE ORGANICS | | | | | | | Analyst: TOM |
| Diesel Range Organics (DRO) | ND | 9.9 | | mg/Kg | 1 | 6/20/2018 5:50:06 PM | 38767 |
| Motor Oil Range Organics (MRO) | ND | 49 | | mg/Kg | 1 | 6/20/2018 5:50:06 PM | 38767 |
| Surr: DNOP | 94.7 | 70-130 | | %Rec | 1 | 6/20/2018 5:50:06 PM | 38767 |
| EPA METHOD 8015D: GASOLINE RANGE | | | | | | | Analyst: NSB |
| Gasoline Range Organics (GRO) | ND | 4.8 | | mg/Kg | 1 | 6/20/2018 3:35:34 PM | 38762 |
| Surr: BFB | 81.8 | 15-316 | | %Rec | 1 | 6/20/2018 3:35:34 PM | 38762 |

Refer to the QC Summary report and sample login checklist for flagged QC data and preservation information.

| | | | | | |
|--------------------|-----|---|----|---|-------------|
| Qualifiers: | * | Value exceeds Maximum Contaminant Level. | B | Analyte detected in the associated Method Blank | Page 3 of 9 |
| | D | Sample Diluted Due to Matrix | E | Value above quantitation range | |
| | H | Holding times for preparation or analysis exceeded | J | Analyte detected below quantitation limits | |
| | ND | Not Detected at the Reporting Limit | P | Sample pH Not In Range | |
| | PQL | Practical Quantitative Limit | RL | Reporting Detection Limit | |
| | S | % Recovery outside of range due to dilution or matrix | W | Sample container temperature is out of limit as specified | |

Hall Environmental Analysis Laboratory, Inc.

Analytical Report

Lab Order **1806A46**

Date Reported: **6/22/2018**

CLIENT: Souder, Miller & Associates

Client Sample ID: SW3

Project: Cypress 2H

Collection Date: 6/13/2018 9:30:00 AM

Lab ID: 1806A46-004

Matrix: SOIL

Received Date: 6/15/2018 9:00:00 AM

| Analyses | Result | PQL | Qual | Units | DF | Date Analyzed | Batch |
|--|--------|--------|------|-------|----|----------------------|---------------------|
| EPA METHOD 300.0: ANIONS | | | | | | | Analyst: smb |
| Chloride | 47 | 30 | | mg/Kg | 20 | 6/21/2018 2:58:56 PM | 38815 |
| EPA METHOD 8015M/D: DIESEL RANGE ORGANICS | | | | | | | Analyst: TOM |
| Diesel Range Organics (DRO) | ND | 9.9 | | mg/Kg | 1 | 6/20/2018 6:12:23 PM | 38767 |
| Motor Oil Range Organics (MRO) | ND | 50 | | mg/Kg | 1 | 6/20/2018 6:12:23 PM | 38767 |
| Surr: DNOP | 111 | 70-130 | | %Rec | 1 | 6/20/2018 6:12:23 PM | 38767 |
| EPA METHOD 8015D: GASOLINE RANGE | | | | | | | Analyst: NSB |
| Gasoline Range Organics (GRO) | ND | 4.7 | | mg/Kg | 1 | 6/20/2018 6:21:00 PM | 38762 |
| Surr: BFB | 80.5 | 15-316 | | %Rec | 1 | 6/20/2018 6:21:00 PM | 38762 |

Refer to the QC Summary report and sample login checklist for flagged QC data and preservation information.

| | | | | |
|--------------------|-----|---|----|---|
| Qualifiers: | * | Value exceeds Maximum Contaminant Level. | B | Analyte detected in the associated Method Blank |
| | D | Sample Diluted Due to Matrix | E | Value above quantitation range |
| | H | Holding times for preparation or analysis exceeded | J | Analyte detected below quantitation limits |
| | ND | Not Detected at the Reporting Limit | P | Sample pH Not In Range |
| | PQL | Practical Quantitative Limit | RL | Reporting Detection Limit |
| | S | % Recovery outside of range due to dilution or matrix | W | Sample container temperature is out of limit as specified |

Hall Environmental Analysis Laboratory, Inc.

Analytical Report

Lab Order **1806A46**

Date Reported: **6/22/2018**

CLIENT: Souder, Miller & Associates

Client Sample ID: SW4

Project: Cypress 2H

Collection Date: 6/13/2018 9:35:00 AM

Lab ID: 1806A46-005

Matrix: SOIL

Received Date: 6/15/2018 9:00:00 AM

| Analyses | Result | PQL | Qual | Units | DF | Date Analyzed | Batch |
|--|--------|--------|------|-------|----|----------------------|---------------------|
| EPA METHOD 300.0: ANIONS | | | | | | | Analyst: smb |
| Chloride | 83 | 30 | | mg/Kg | 20 | 6/21/2018 3:11:20 PM | 38815 |
| EPA METHOD 8015M/D: DIESEL RANGE ORGANICS | | | | | | | Analyst: TOM |
| Diesel Range Organics (DRO) | ND | 9.8 | | mg/Kg | 1 | 6/20/2018 6:34:50 PM | 38767 |
| Motor Oil Range Organics (MRO) | ND | 49 | | mg/Kg | 1 | 6/20/2018 6:34:50 PM | 38767 |
| Surr: DNOP | 94.2 | 70-130 | | %Rec | 1 | 6/20/2018 6:34:50 PM | 38767 |
| EPA METHOD 8015D: GASOLINE RANGE | | | | | | | Analyst: NSB |
| Gasoline Range Organics (GRO) | ND | 4.8 | | mg/Kg | 1 | 6/20/2018 6:44:36 PM | 38762 |
| Surr: BFB | 83.3 | 15-316 | | %Rec | 1 | 6/20/2018 6:44:36 PM | 38762 |

Refer to the QC Summary report and sample login checklist for flagged QC data and preservation information.

| | | | | | |
|--------------------|-----|---|----|---|-------------|
| Qualifiers: | * | Value exceeds Maximum Contaminant Level. | B | Analyte detected in the associated Method Blank | Page 5 of 9 |
| | D | Sample Diluted Due to Matrix | E | Value above quantitation range | |
| | H | Holding times for preparation or analysis exceeded | J | Analyte detected below quantitation limits | |
| | ND | Not Detected at the Reporting Limit | P | Sample pH Not In Range | |
| | PQL | Practical Quantitative Limit | RL | Reporting Detection Limit | |
| | S | % Recovery outside of range due to dilution or matrix | W | Sample container temperature is out of limit as specified | |

Hall Environmental Analysis Laboratory, Inc.

Analytical Report

Lab Order **1806A46**

Date Reported: **6/22/2018**

CLIENT: Souder, Miller & Associates

Client Sample ID: L5-1

Project: Cypress 2H

Collection Date: 6/13/2018 9:50:00 AM

Lab ID: 1806A46-006

Matrix: SOIL

Received Date: 6/15/2018 9:00:00 AM

| Analyses | Result | PQL | Qual | Units | DF | Date Analyzed | Batch |
|--|--------|--------|------|-------|----|----------------------|---------------------|
| EPA METHOD 8015M/D: DIESEL RANGE ORGANICS | | | | | | | Analyst: TOM |
| Diesel Range Organics (DRO) | ND | 9.3 | | mg/Kg | 1 | 6/20/2018 6:57:09 PM | 38767 |
| Motor Oil Range Organics (MRO) | ND | 47 | | mg/Kg | 1 | 6/20/2018 6:57:09 PM | 38767 |
| Surr: DNOP | 107 | 70-130 | | %Rec | 1 | 6/20/2018 6:57:09 PM | 38767 |
| EPA METHOD 8015D: GASOLINE RANGE | | | | | | | Analyst: NSB |
| Gasoline Range Organics (GRO) | ND | 5.0 | | mg/Kg | 1 | 6/20/2018 7:08:10 PM | 38762 |
| Surr: BFB | 79.4 | 15-316 | | %Rec | 1 | 6/20/2018 7:08:10 PM | 38762 |

Refer to the QC Summary report and sample login checklist for flagged QC data and preservation information.

| | | | | |
|--------------------|-----|---|----|---|
| Qualifiers: | * | Value exceeds Maximum Contaminant Level. | B | Analyte detected in the associated Method Blank |
| | D | Sample Diluted Due to Matrix | E | Value above quantitation range |
| | H | Holding times for preparation or analysis exceeded | J | Analyte detected below quantitation limits |
| | ND | Not Detected at the Reporting Limit | P | Sample pH Not In Range |
| | PQL | Practical Quantitative Limit | RL | Reporting Detection Limit |
| | S | % Recovery outside of range due to dilution or matrix | W | Sample container temperature is out of limit as specified |

QC SUMMARY REPORT

Hall Environmental Analysis Laboratory, Inc.

WO#: 1806A46

22-Jun-18

Client: Souder, Miller & Associates

Project: Cypress 2H

| | | | | | | | | | | |
|------------|-----------|----------------|-----------|-------------|--------------------------|----------|-----------|------|----------|------|
| Sample ID | MB-38815 | SampType: | mbk | TestCode: | EPA Method 300.0: Anions | | | | | |
| Client ID: | PBS | Batch ID: | 38815 | RunNo: | 52139 | | | | | |
| Prep Date: | 6/21/2018 | Analysis Date: | 6/21/2018 | SeqNo: | 1708541 | Units: | mg/Kg | | | |
| Analyte | Result | PQL | SPK value | SPK Ref Val | %REC | LowLimit | HighLimit | %RPD | RPDLimit | Qual |
| Chloride | ND | 1.5 | | | | | | | | |

| | | | | | | | | | | |
|------------|-----------|----------------|-----------|-------------|--------------------------|----------|-----------|------|----------|------|
| Sample ID | LCS-38815 | SampType: | lcs | TestCode: | EPA Method 300.0: Anions | | | | | |
| Client ID: | LCSS | Batch ID: | 38815 | RunNo: | 52139 | | | | | |
| Prep Date: | 6/21/2018 | Analysis Date: | 6/21/2018 | SeqNo: | 1708542 | Units: | mg/Kg | | | |
| Analyte | Result | PQL | SPK value | SPK Ref Val | %REC | LowLimit | HighLimit | %RPD | RPDLimit | Qual |
| Chloride | 14 | 1.5 | 15.00 | 0 | 95.5 | 90 | 110 | | | |

Qualifiers:

* Value exceeds Maximum Contaminant Level.
D Sample Diluted Due to Matrix
H Holding times for preparation or analysis exceeded
ND Not Detected at the Reporting Limit
PQL Practical Quantitative Limit
S % Recovery outside of range due to dilution or matrix

B Analyte detected in the associated Method Blank
E Value above quantitation range
J Analyte detected below quantitation limits
P Sample pH Not In Range
RL Reporting Detection Limit
W Sample container temperature is out of limit as specified

QC SUMMARY REPORT

Hall Environmental Analysis Laboratory, Inc.

WO#: 1806A46

22-Jun-18

Client: Souder, Miller & Associates

Project: Cypress 2H

| | | | | | | | | | | |
|-----------------------------|-----------|-----|--------------------------|-------------|---|----------|--------------|------|----------|------|
| Sample ID | LCS-38767 | | SampType: LCS | | TestCode: EPA Method 8015M/D: Diesel Range Organics | | | | | |
| Client ID: | LCSS | | Batch ID: 38767 | | RunNo: 52095 | | | | | |
| Prep Date: | 6/19/2018 | | Analysis Date: 6/20/2018 | | SeqNo: 1705232 | | Units: mg/Kg | | | |
| Analyte | Result | PQL | SPK value | SPK Ref Val | %REC | LowLimit | HighLimit | %RPD | RPDLimit | Qual |
| Diesel Range Organics (DRO) | 48 | 10 | 50.00 | 0 | 95.7 | 70 | 130 | | | |
| Surr: DNOP | 4.8 | | 5.000 | | 95.2 | 70 | 130 | | | |

| | | | | | | | | | | |
|--------------------------------|-----------|-----|--------------------------|-------------|---|----------|--------------|------|----------|------|
| Sample ID | MB-38767 | | SampType: MBLK | | TestCode: EPA Method 8015M/D: Diesel Range Organics | | | | | |
| Client ID: | PBS | | Batch ID: 38767 | | RunNo: 52095 | | | | | |
| Prep Date: | 6/19/2018 | | Analysis Date: 6/20/2018 | | SeqNo: 1705233 | | Units: mg/Kg | | | |
| Analyte | Result | PQL | SPK value | SPK Ref Val | %REC | LowLimit | HighLimit | %RPD | RPDLimit | Qual |
| Diesel Range Organics (DRO) | ND | 10 | | | | | | | | |
| Motor Oil Range Organics (MRO) | ND | 50 | | | | | | | | |
| Surr: DNOP | 9.8 | | 10.00 | | 98.0 | 70 | 130 | | | |

Qualifiers:

* Value exceeds Maximum Contaminant Level.
D Sample Diluted Due to Matrix
H Holding times for preparation or analysis exceeded
ND Not Detected at the Reporting Limit
PQL Practical Quantitative Limit
S % Recovery outside of range due to dilution or matrix

B Analyte detected in the associated Method Blank
E Value above quantitation range
J Analyte detected below quantitation limits
P Sample pH Not In Range
RL Reporting Detection Limit
W Sample container temperature is out of limit as specified

QC SUMMARY REPORT

Hall Environmental Analysis Laboratory, Inc.

WO#: 1806A46

22-Jun-18

Client: Souder, Miller & Associates

Project: Cypress 2H

| | | | | | | | | | | |
|-------------------------------|-----------|-----|--------------------------|-------------|--|----------|--------------|------|----------|------|
| Sample ID | MB-38762 | | SampType: MBLK | | TestCode: EPA Method 8015D: Gasoline Range | | | | | |
| Client ID: | PBS | | Batch ID: 38762 | | RunNo: 52104 | | | | | |
| Prep Date: | 6/19/2018 | | Analysis Date: 6/20/2018 | | SeqNo: 1705919 | | Units: mg/Kg | | | |
| Analyte | Result | PQL | SPK value | SPK Ref Val | %REC | LowLimit | HighLimit | %RPD | RPDLimit | Qual |
| Gasoline Range Organics (GRO) | ND | 5.0 | | | | | | | | |
| Surr: BFB | 820 | | 1000 | | 81.8 | 15 | 316 | | | |

| | | | | | | | | | | |
|-------------------------------|-----------|-----|--------------------------|-------------|--|----------|--------------|------|----------|------|
| Sample ID | LCS-38762 | | SampType: LCS | | TestCode: EPA Method 8015D: Gasoline Range | | | | | |
| Client ID: | LCSS | | Batch ID: 38762 | | RunNo: 52104 | | | | | |
| Prep Date: | 6/19/2018 | | Analysis Date: 6/20/2018 | | SeqNo: 1705920 | | Units: mg/Kg | | | |
| Analyte | Result | PQL | SPK value | SPK Ref Val | %REC | LowLimit | HighLimit | %RPD | RPDLimit | Qual |
| Gasoline Range Organics (GRO) | 25 | 5.0 | 25.00 | 0 | 101 | 75.9 | 131 | | | |
| Surr: BFB | 900 | | 1000 | | 90.2 | 15 | 316 | | | |

| | | | | | | | | | | |
|-------------------------------|----------------|-----|--------------------------|-------------|--|----------|--------------|------|----------|------|
| Sample ID | 1806A46-001AMS | | SampType: MS | | TestCode: EPA Method 8015D: Gasoline Range | | | | | |
| Client ID: | L1-1 | | Batch ID: 38762 | | RunNo: 52104 | | | | | |
| Prep Date: | 6/19/2018 | | Analysis Date: 6/20/2018 | | SeqNo: 1705924 | | Units: mg/Kg | | | |
| Analyte | Result | PQL | SPK value | SPK Ref Val | %REC | LowLimit | HighLimit | %RPD | RPDLimit | Qual |
| Gasoline Range Organics (GRO) | 27 | 5.0 | 24.80 | 0 | 107 | 77.8 | 128 | | | |
| Surr: BFB | 930 | | 992.1 | | 94.2 | 15 | 316 | | | |

| | | | | | | | | | | |
|-------------------------------|-----------------|-----|--------------------------|-------------|--|----------|--------------|------|----------|------|
| Sample ID | 1806A46-001AMSD | | SampType: MSD | | TestCode: EPA Method 8015D: Gasoline Range | | | | | |
| Client ID: | L1-1 | | Batch ID: 38762 | | RunNo: 52104 | | | | | |
| Prep Date: | 6/19/2018 | | Analysis Date: 6/20/2018 | | SeqNo: 1705925 | | Units: mg/Kg | | | |
| Analyte | Result | PQL | SPK value | SPK Ref Val | %REC | LowLimit | HighLimit | %RPD | RPDLimit | Qual |
| Gasoline Range Organics (GRO) | 29 | 4.9 | 24.39 | 0 | 117 | 77.8 | 128 | 7.29 | 20 | |
| Surr: BFB | 950 | | 975.6 | | 97.2 | 15 | 316 | 0 | 0 | |

Qualifiers:

* Value exceeds Maximum Contaminant Level.
D Sample Diluted Due to Matrix
H Holding times for preparation or analysis exceeded
ND Not Detected at the Reporting Limit
PQL Practical Quantitative Limit
S % Recovery outside of range due to dilution or matrix

B Analyte detected in the associated Method Blank
E Value above quantitation range
J Analyte detected below quantitation limits
P Sample pH Not In Range
RL Reporting Detection Limit
W Sample container temperature is out of limit as specified

Sample Log-In Check List

Client Name: SMA-CARLSBAD

Work Order Number: 1806A46

RcptNo: 1

Received By: Erin Melendrez 6/15/2018 9:00:00 AM

Completed By: Michelle Garcia 6/18/2018 9:06:18 AM

Reviewed By: *SO*

Labeled by SB 06/18/18

UAG

Michelle Garcia

Chain of Custody

1. Is Chain of Custody complete? Yes ☒ No ☐ Not Present ☐
2. How was the sample delivered? Courier

Log In

3. Was an attempt made to cool the samples? Yes ☒ No ☐ NA ☐
4. Were all samples received at a temperature of $>0^{\circ}\text{C}$ to 6.0°C ? Yes ☒ No ☐ NA ☐
5. Sample(s) in proper container(s)? Yes ☒ No ☐
6. Sufficient sample volume for indicated test(s)? Yes ☒ No ☐
7. Are samples (except VOA and ONG) properly preserved? Yes ☒ No ☐
8. Was preservative added to bottles? Yes ☐ No ☒ NA ☐
9. VOA vials have zero headspace? Yes ☐ No ☐ No VOA Vials ☒
10. Were any sample containers received broken? Yes ☐ No ☒
11. Does paperwork match bottle labels?
(Note discrepancies on chain of custody) Yes ☒ No ☐
12. Are matrices correctly identified on Chain of Custody? Yes ☒ No ☐
13. Is it clear what analyses were requested? Yes ☒ No ☐
14. Were all holding times able to be met?
(If no, notify customer for authorization.) Yes ☒ No ☐

of preserved
bottles checked
for pH:

(<2 or >12 unless noted)

Adjusted?

Checked by: *SB 06/18/18*

Special Handling (if applicable)

15. Was client notified of all discrepancies with this order? Yes ☐ No ☐ NA ☒

Person Notified:

Date:

By Whom:

Via:

☐ eMail ☐ Phone ☐ Fax ☐ In Person

Regarding:

Client Instructions:

16. Additional remarks:

17. Cooler Information

| Cooler No | Temp $^{\circ}\text{C}$ | Condition | Seal Intact | Seal No | Seal Date | Signed By |
|-----------|-------------------------|-----------|-------------|---------|-----------|-----------|
| 1 | 5.9 | Good | Yes | | | |

