



Gruy Petroleum Management Co.

600 East Las Colinas Blvd. ♦ Suite 1100 ♦ Irving, TX 75039 ♦ (972) 401-3111 ♦ Fax (972) 443-6450

Mailing Address: P.O. Box 140907 ♦ Irving, TX 75014-0907

A subsidiary of Magnum Hunter Resources, Inc. • A NYSE Listed Company • "MHR"

June 3, 2004

State of New Mexico
Energy, Minerals and Natural Resources
Oil Conservation Division
1220 South Saint Francis Dr.
Santa Fe, NM 87505
Attn: Mr. William V. Jones

RECEIVED

JUN 07 2004

OCB-ARTESIA

Re: Chosa Draw 27 Fed Com # 1
E/2 27 25S-26E Eddy County NM

Dear Mr. Jones:

On May 21, 2004, we had submitted a C-107B application to surface commingle Cottonwood Draw Upper Penn, and Cottonwood Draw Morrow Wildcat pools in the referenced well. It has come to our attention, that we neglected to sign the C-102's enclosed with the application. In this regard enclosed are signed C-102's along with a site facility diagram.

If you have any questions, or require additional information concerning this application, please feel free to contact the undersigned at 972-443-6489.

Sincerely,

Zeno Farris
Manager, Operations Administration

New Mexico Oil Conservation Division
1301 West Grand Avenue
Artesia, NM 88210
Attn: Mr. Bryan Arrant

DISTRICT I

P.O. Box 1880, Hobbs, NM 88241-1880

DISTRICT II

P.O. Drawer DD, Artesia, NM 88211-0719

DISTRICT III

1000 Rio Brazos Rd., Aztec, NM 87410

DISTRICT IV

P.O. BOX 2088, SANTA FE, N.M. 87504-2088

State of New Mexico

Energy, Minerals and Natural Resources Department

OIL CONSERVATION DIVISION

P.O. Box 2088

Santa Fe, New Mexico 87504-2088

Form C-102

Revised February 10, 1994

Submit to Appropriate District Office

State Lease - 4 Copies

Fee Lease - 3 Copies

WELL LOCATION AND ACREAGE DEDICATION PLAT

☐ AMENDED REPORT

API Number 30-015-32918	Pool Code 97354	Pool Name Cottonwood Draw Upper Penn
Property Code	Property Name CHOSA DRAW 27 FEDERAL COM	Well Number 1
OGRID No. 162683	Operator Name GRUY PETROLEUM MANAGEMENT CO.	Elevation 3265'

Surface Location

UL or lot No.	Section	Township	Range	Lot Idn	Feet from the	North/South line	Feet from the	East/West line	County
B	27	25-S	26-E		330'	NORTH	1980'	EAST	EDDY

Bottom Hole Location If Different From Surface

UL or lot No.	Section	Township	Range	Lot Idn	Feet from the	North/South line	Feet from the	East/West line	County
OG	27	25-S	26-E		1817'	NORTH	1613'	EAST	EDDY
Dedicated Acres 320	Joint or Infill N	Consolidation Code C	Order No.						

NO ALLOWABLE WILL BE ASSIGNED TO THIS COMPLETION UNTIL ALL INTERESTS HAVE BEEN CONSOLIDATED
OR A NON-STANDARD UNIT HAS BEEN APPROVED BY THE DIVISION

<p>RECEIVED</p> <p>JUN 07 2004</p> <p>OGD-ARTESIA</p>	<p>3278.9</p> <p>330</p> <p>3257.0</p> <p>1980'</p> <p>Fee</p> <p>1903'</p> <p>3266.4'</p> <p>3255.0'</p> <p>106'</p> <p>1817'</p> <p>1613'</p> <p>Chosa Draw 27 Fed Com 1</p> <p>30-015-32918 NM94840</p> <p>NM92160</p>		<p>OPERATOR CERTIFICATION</p> <p>I hereby certify the the information contained herein is true and complete to the best of my knowledge and belief.</p> <p><i>Zeno Farris</i></p> <p>Signature</p> <p>Zeno Farris</p> <p>Printed Name</p> <p>Manager, Operations Admin</p> <p>Title</p> <p>May 2d, 2004</p> <p>Date</p>
	<p>SURVEYOR CERTIFICATION</p> <p>I hereby certify that the well location shown on this plat was plotted from field notes of actual surveys made by me or under my supervision, and that the same is true and correct to the best of my belief.</p> <p>May 02, 2003</p> <p>Date Surveyed</p> <p>AWB</p> <p>Signature & Seal of Professional Surveyor</p> <p><i>Ronald J. Edson</i></p> <p>03.11.0469</p> <p>Certificate No. RONALD J. EDSON 3239 GARY EDSON 12641</p>		

DISTRICT I

P.O. Box 1880, Hobbs, NM 88241-1880

DISTRICT II

P.O. Drawer DD, Artesia, NM 88211-0719

DISTRICT III

1000 Rio Brazos Rd., Aztec, NM 87410

DISTRICT IV

P.O. BOX 2088, SANTA FE, N.M. 87504-2088

State of New Mexico

Energy, Minerals and Natural Resources Department

OIL CONSERVATION DIVISION

P.O. Box 2088

Santa Fe, New Mexico 87504-2088

Form C-102

Revised February 10, 1994

Submit to Appropriate District Office

State Lease - 4 Copies

Fee Lease - 3 Copies

WELL LOCATION AND ACREAGE DEDICATION PLAT

☐ AMENDED REPORT

API Number 30-015-	Pool Code Pending	Pool Name Cottonwood Draw Morrow Wildcat
Property Code	Property Name CHOSA DRAW 27 FEDERAL COM	Well Number 1
OGRID No. 162683	Operator Name GRUY PETROLEUM MANAGEMENT CO.	Elevation 3265'

Surface Location

UL or lot No.	Section	Township	Range	Lot Idn	Feet from the	North/South line	Feet from the	East/West line	County
B	27	25-S	26-E		330'	NORTH	1980'	EAST	EDDY

Bottom Hole Location If Different From Surface

UL or lot No.	Section	Township	Range	Lot Idn	Feet from the	North/South line	Feet from the	East/West line	County
B	27	25-S	26-E		1817'	NORTH	1613'	EAST	EDDY
Dedicated Acres 320	Joint or Infill N	Consolidation Code C	Order No.						

NO ALLOWABLE WILL BE ASSIGNED TO THIS COMPLETION UNTIL ALL INTERESTS HAVE BEEN CONSOLIDATED
OR A NON-STANDARD UNIT HAS BEEN APPROVED BY THE DIVISION

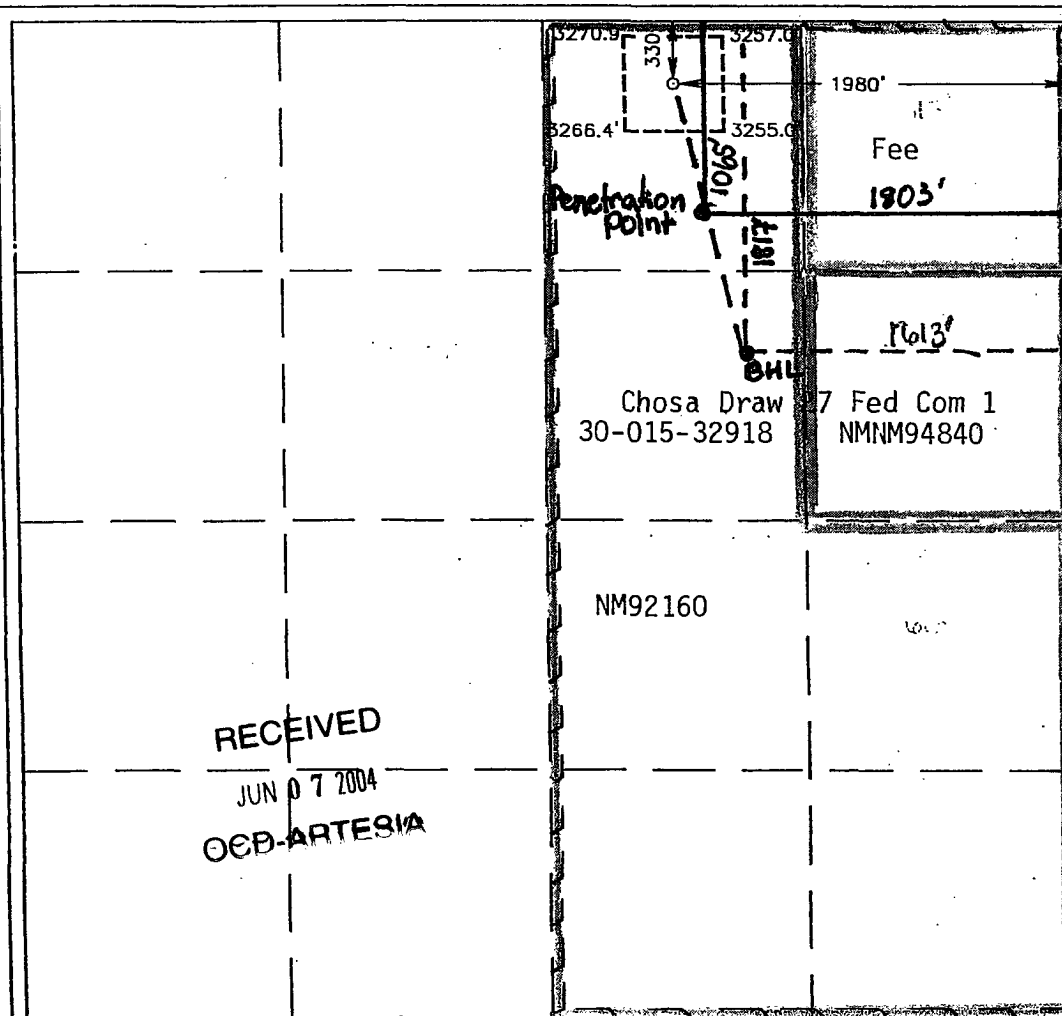

OPERATOR CERTIFICATION

I hereby certify the the information
contained herein is true and complete to the
best of my knowledge and belief.

Zeno Farris
Signature

Zeno Farris
Printed Name

Manager, Operations Admin
Title

Title

May 21, 2004
Date

Date

SURVEYOR CERTIFICATION

I hereby certify that the well location shown
on this plat was plotted from field notes of
actual surveys made by me or under my
supervision, and that the same is true and
correct to the best of my belief.

May 02, 2003

Date Surveyed AWB

Signature & Seal of
Professional Surveyor

Ronald J. Edson
Professional Surveyor
03.11.0469

Certificate No. RONALD J. EDSON 3239
GARY EDSON 12641

RECEIVED
JUN 07 2004
OCD-ARTESIA

ENGINEERING CHART

FILE _____

APPN _____

SUBJECT Chosa Draw 27, Federal Com #1
Site Facility Diagram

DATE 5-22-04BY mdB