

District I
1625 N. French Dr., Hobbs, NM 88240
District II
1301 W. Grand Avenue, Artesia, NM 88210
District III
1000 Rio Brazos Road, Aztec, NM 87410
District IV
1220 S. St. Francis Dr., Santa Fe, NM 87505

State of New Mexico
Energy, Minerals and Natural Resources

Oil Conservation Division
1220 South St. Francis Dr.
Santa Fe, NM 87505

Form C-144
March 12, 2004

For drilling and production facilities, submit to appropriate NMOCD District Office.
For downstream facilities, submit to Santa Fe office.

Pit or Below-Grade Tank Registration or Closure

Is pit or below-grade tank covered by a "general plan"? Yes ☐ No ☒

Type of action: Registration of a pit or below-grade tank ☒ Closure of a pit or below-grade tank ☐

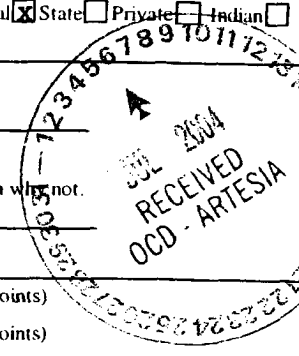
Operator: <u>Marathon Oil Company</u> Telephone: <u>7132963254</u> e-mail address: <u>mfmick@marathonoil.com</u>		
Address: <u>P.O. Box 3128 Houston, Tx. 77253</u>		
Facility or well name: <u>Indian Hills Unit #8</u> API #: <u>30-015-28590</u> U/L or Qtr/Qtr <u>N</u> Sec <u>33</u> T <u>21S</u> R <u>24E</u>		
County: <u>Eddy</u> Latitude _____ Longitude _____ NAD: 1927 <input type="checkbox"/> 1983 <input type="checkbox"/> Surface Owner Federal <input checked="" type="checkbox"/> State <input type="checkbox"/> Private <input type="checkbox"/> Indian <input type="checkbox"/>		
Pit Type: Drilling <input type="checkbox"/> Production <input type="checkbox"/> Disposal <input type="checkbox"/> Workover <input checked="" type="checkbox"/> Emergency <input type="checkbox"/> Lined <input checked="" type="checkbox"/> Unlimited <input type="checkbox"/> Liner type: Synthetic <input type="checkbox"/> Thickness <u>20</u> mil Clay <input type="checkbox"/> Volume _____ bbl	Below-grade tank Volume: _____ bbl Type of fluid: _____ Construction material: _____ Double-walled, with leak detection? Yes <input type="checkbox"/> If not, explain why not. _____	
Depth to ground water (vertical distance from bottom of pit to seasonal high water elevation of ground water.)	Less than 50 feet (20 points) 50 feet or more, but less than 100 feet (10 points) 100 feet or more (0 points) X	
Wellhead protection area. (Less than 200 feet from a private domestic water source, or less than 1000 feet from all other water sources.)	Yes (20 points) No (0 points) X	
Distance to surface water: (horizontal distance to all wetlands, playas, irrigation canals, ditches, and perennial and ephemeral watercourses.)	Less than 200 feet (20 points) 200 feet or more, but less than 1000 feet (10 points) 1000 feet or more (0 points) X	
Ranking Score (Total Points)		

If this is a pit closure: (1) attach a diagram of the facility showing the pit's relationship to other equipment and tanks. (2) Indicate disposal location:

onsite ☒ offsite ☐ If offsite, name of facility _____ (3) Attach a general description of remedial action taken including remediation start date and end date. (4) Groundwater encountered: No ☐ Yes ☐ If yes, show depth below ground surface _____ ft. and attach sample results. (5) Attach soil sample results and a diagram of sample locations and excavations.

I hereby certify that the information above is true and complete to the best of my knowledge and belief. I further certify that the above-described pit or below-grade tank has been/will be constructed or closed according to NMOCD guidelines ☒, a general permit ☐, or an (attached) alternative OCD-approved plan ☐.

Date: 07-01-04

Printed Name/Title: Mike Mick

Signature: m+mick

Adv. Sr. Eng. Tech

Your certification and NMOCD approval of this application/closure does not relieve the operator of liability should the contents of the pit or tank contaminate ground water or otherwise endanger public health or the environment. Nor does it relieve the operator of its responsibility for compliance with any other federal, state, or local laws and/or regulations.

Approval:

Date: 7/9/04

Printed Name/Title: Mike Bratcher / Compliance Officer

Signature: Mike Bratcher

Additional Information- Indian Hills Unit # 8

General

The Indian Hills Unit # 8 SL is located on Federal lands and Federal subsurface. The applied for pit will be constructed with-in the original pit area, with no new surface disturbances. Approx. size 120'x 120' x 4'.

- Topsoil will be stripped and stockpiled for use as the final cover of fill at the time of closure.
- Contents removed from old pit will be stockpiled on a liner to prevent soil contamination.
- A 20 mil. Liner will be installed. Padding will be added if necessary. Liner will be anchored per OCD's guidelines. OCD will be contacted 24 hrs. prior to liner installation.
- All necessary steps will be taken to prevent liner damage.
- Marathon will used a combination of produced and freshwater during drilling, anticipated chloride content of drilling fluids - 10,000 ppm.
- Pit Area will be fence, work access will remain open during operations, closed once rig operations cease.
- All fluids will be removed from pit in a timely manner after operations cease.
- OCD will be contacted when pit closure commences.
- Closure of pit will be performed as per current OCD guidelines for onsite encapsulation. The liner edges shall be folded over the contents and a 40 mil liner shall be installed on top. A min. of 3 foot of clean soil shall be spread over encapsulated pit contents. Stockpiled top soil shall be spread and contoured. Pit area will be re-seeded and re-vegetation promoted.

IHU #8

- ◇ H2S Detection Equipment
- ↗ Wind Direction Indicator
- ⌌ Self Contained Breathing Equip.
- ⊗ Briefing Area

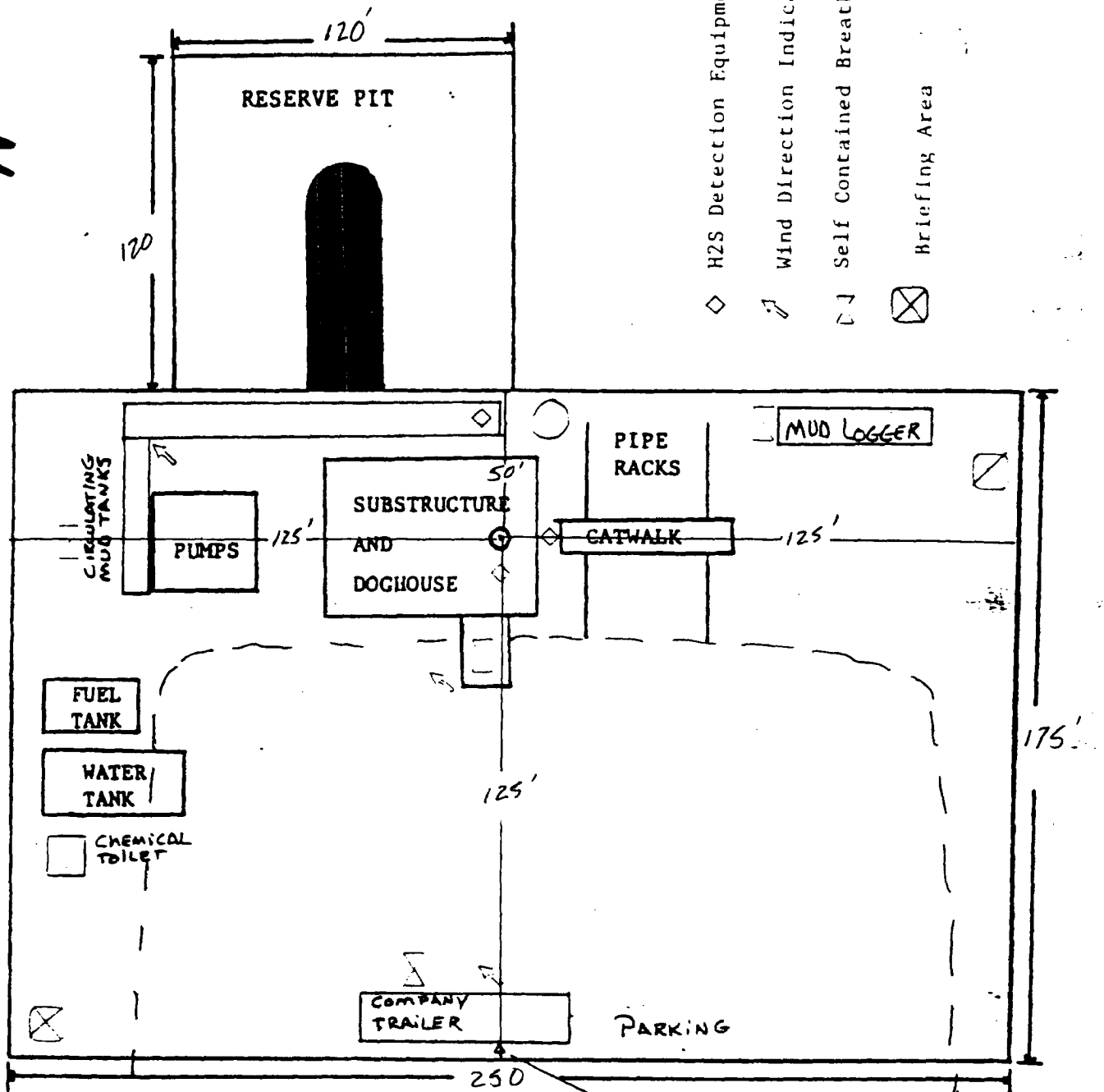

2 APPROXIMATE
AREA OF
EXISTING DRY
HOLE LOCATION

Prevailing Wind Direction
Southwest

Foot-path for emergency
egress

DRY HOLE MARKER FOR
IHU #5