

N.M. Oil Cons. DIV-Dist. 2
1301 W. Grand Avenue
Artesia, NM 88210

Form 3160-3
(April 2004)

UNITED STATES
DEPARTMENT OF THE INTERIOR
BUREAU OF LAND MANAGEMENT

FORM APPROVED
OMB No. 1004-0137
Expires March 31, 2007

APPLICATION FOR PERMIT TO DRILL OR REENTER

1a. Type of work: <input checked="" type="checkbox"/> DRILL <input type="checkbox"/> REENTER		5. Lease Serial No. NM 32322
1b. Type of Well: <input type="checkbox"/> Oil Well <input checked="" type="checkbox"/> Gas Well <input type="checkbox"/> Other <input checked="" type="checkbox"/> Single Zone <input type="checkbox"/> Multiple Zone		6. If Indian, Allottee or Tribe Name
2. Name of Operator McKay Oil Corporation		7. If Unit or CA Agreement, Name and No.
3a. Address PO Box 2014 Roswell, NM 88202-2014	3b. Phone No. (include area code) 505-623-4735	8. Lease Name and Well No. Miller B#3 Fed
4. Location of Well (Report location clearly and in accordance with any State requirements. *) At surface 1980' FSL & 660' FWL At proposed prod. zone		9. API Well No. 30-08-63728
14. Distance in miles and direction from nearest town or post office* Approximately 25 miles		10. Field and Pool, or Exploratory W. Pecos ABO Slope
15. Distance from proposed* location to nearest property or lease line, ft. (Also to nearest drig. unit line, if any) 660'		11. Sec., T. R. M. or Blk. and Survey or Area Lot 3, Sec. 7, T6S, R23E
16. No. of acres in lease 890.38	17. Spacing Unit dedicated to this well 160'	12. County or Parish Chaves
18. Distance from proposed location* to nearest well, drilling, completed, applied for, on this lease, ft.	19. Proposed Depth 4300'	13. State NM
20. BLM/BIA Bond No. on file	21. Elevations (Show whether DF, KDB, RT, GL, etc.) 4208'	22. Approximate date work will start* 11/01/2004
23. Estimated duration 7-10 days	24. Attachments	

The following, completed in accordance with the requirements of Onshore Oil and Gas Order No.1, shall be attached to this form:

- | | |
|---|--|
| 1. Well plat certified by a registered surveyor. | 4. Bond to cover the operations unless covered by an existing bond on file (see Item 20 above). |
| 2. A Drilling Plan. | 5. Operator certification |
| 3. A Surface Use Plan (if the location is on National Forest System Lands, the SUPO shall be filed with the appropriate Forest Service Office). | 6. Such other site specific information and/or plans as may be required by the authorized officer. |

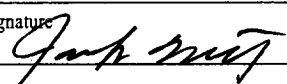
25. Signature 	Name (Printed/Typed) James L. Schultz	Date 10/11/2004
Title Agent		

Approved by (Signature) /s/LARRY D. BRAY	Name (Printed/Typed) /s/LARRY D. BRAY	Date DEC 06 2004
Title Assistant Field Manager, Lands And Minerals	Office ROSWELL FIELD OFFICE	

Application approval does not warrant or certify that the applicant holds legal or equitable title to those rights in the subject lease which would entitle the applicant to conduct operations thereon.
Conditions of approval, if any, are attached.

Title 18 U.S.C. Section 1001 and Title 43 U.S.C. Section 1212, make it a crime for any person knowingly and willfully to make to any department or agency of the United States any false, fictitious or fraudulent statements or representations as to any matter within its jurisdiction.

*(Instructions on page 2)

CEMENT TO COVER ALL OIL,
GAS AND WATER BEARING
ZONES EX. Glaciera

If earthen pits are used in
association with the drilling of this
well, an OCD pit permit must be
obtained prior to pit construction.

DISTRICT I
1625 N. FRENCH DR., HOBBS, NM 88240

DISTRICT II
1301 W. GRAND AVENUE, ARTESIA, NM 88210

DISTRICT III
1000 Rio Brazos Rd., Aztec, NM 87410

DISTRICT IV
1220 S. ST. FRANCIS DR., SANTA FE, NM 87505

State of New Mexico
Energy, Minerals and Natural Resources Department

OIL CONSERVATION DIVISION
1220 SOUTH ST. FRANCIS DR.
Santa Fe, New Mexico 87505

Form C-102
Revised JUNE 10, 2003
Submit to Appropriate District Office
State Lease - 4 Copies
Fee Lease - 3 Copies

WELL LOCATION AND ACREAGE DEDICATION PLAT

☐ AMENDED REPORT

API Number	Pool Code	Pool Name
Property Code	Property Name MILLER FEDERAL B	Well Number 3
OGRID No.	Operator Name McKAY OIL CORPORATION	Elevation 4208'

Surface Location

UL or lot No.	Section	Township	Range	Lot Idn	Feet from the	North/South line	Feet from the	East/West line	County
3	7	6-S	23-E		1980	SOUTH	660	WEST	CHAVES

Bottom Hole Location If Different From Surface

UL or lot No.	Section	Township	Range	Lot Idn	Feet from the	North/South line	Feet from the	East/West line	County
Dedicated Acres 160	Joint or Infill	Consolidation Code	Order No.						

NO ALLOWABLE WILL BE ASSIGNED TO THIS COMPLETION UNTIL ALL INTERESTS HAVE BEEN CONSOLIDATED
OR A NON-STANDARD UNIT HAS BEEN APPROVED BY THE DIVISION

	OPERATOR CERTIFICATION I hereby certify the the information contained herein is true and complete to the best of my knowledge and belief. Signature <u>James Schultz</u> Printed Name Agent Title Date <u>10/11/2004</u>
	SURVEYOR CERTIFICATION I hereby certify that the well location shown on this plat was plotted from field notes of actual surveys made by me or under my supervision, and that the same is true and correct to the best of my belief. SEPTEMBER 15, 2004 Date Surveyed <u>REV 10/8/04</u> JR Signature & Seal of Professional Surveyor GARY EDDSON 04.11.1149 Certificate No. GARY EDDSON 12641

ench Dr., Hobbs, NM 88240
District II
101 W. Grand Avenue, Artesia, NM 88210
District III
1000 Rio Brazos Road, Aztec, NM 87410
District IV
1220 S. St. Francis Dr., Santa Fe, NM 87505

State of New Mexico
Energy Minerals and Natural Resources

Form C-144
June 1, 2004

Oil Conservation Division
1220 South St. Francis Dr.
Santa Fe, NM 87505

For drilling and production facilities, submit to
appropriate NMOCD District Office.
For downstream facilities, submit to Santa Fe
office

Pit or Below-Grade Tank Registration or Closure

Is pit or below-grade tank covered by a "general plan"? Yes ☒ No ☐ Submitted 4/16/04
Type of action: Registration of a pit or below-grade tank ☒ Closure of a pit or below-grade tank ☐

Operator: MCKAY OIL CORPORATION Telephone: 505-623-4795 e-mail address: april@mckayoil.com
Address: PO Box 2014 Roswell, NM 88202-2014
Facility or well name: Miller Federal B #3 API #: _____ U/L or Qtr/Qtr 3 Sec 7 T 6S R 23E
County: CHAVES Latitude _____ Longitude _____ NAD: 1927 ☐ 1983 ☐ Surface Owner Federal ☒ State ☐ Private ☐ Indian ☐

Pit	Below-grade tank	
Type: Drilling <input checked="" type="checkbox"/> Production <input type="checkbox"/> Disposal <input type="checkbox"/> Workover <input type="checkbox"/> Emergency <input type="checkbox"/> Lined <input checked="" type="checkbox"/> Unlined <input type="checkbox"/> Liner type: Synthetic <input type="checkbox"/> Thickness _____ mil Clay <input type="checkbox"/> Pit Volume _____ bbl	Volume: _____ bbl Type of fluid: _____ Construction material: _____ Double-walled, with leak detection? Yes <input type="checkbox"/> If not, explain why not. _____	
Depth to ground water (vertical distance from bottom of pit to seasonal high water elevation of ground water.)	Less than 50 feet	(20 points)
	50 feet or more, but less than 100 feet	(10 points)
	<u>100 feet or more</u>	<u>(0 points)</u>
Wellhead protection area: (Less than 200 feet from a private domestic water source, or less than 1000 feet from all other water sources.)	Yes	(20 points)
	<u>No</u>	<u>(0 points)</u>
Distance to surface water: (horizontal distance to all wetlands, playas, irrigation canals, ditches, and perennial and ephemeral watercourses.)	Less than 200 feet	(20 points)
	200 feet or more, but less than 1000 feet	(10 points)
	<u>1000 feet or more</u>	<u>(0 points)</u>
Ranking Score (Total Points)		0

If this is a pit closure: (1) attach a diagram of the facility showing the pit's relationship to other equipment and tanks. (2) Indicate disposal location: (check the onsite box if you are burying in place) onsite ☒ offsite ☐ If offsite, name of facility _____ (3) Attach a general description of remedial action taken including remediation start date and end date. (4) Groundwater encountered: No ☒ Yes ☐ If yes, show depth below ground surface _____ ft. and attach sample results. (5) Attach soil sample results and a diagram of sample locations and excavations.

Additional Comments:

*This form cannot be processed due to the lack of
and conflicting information*

I hereby certify that the information above is true and complete to the best of my knowledge and belief. I further certify that the above-described pit or below-grade tank has been/will be constructed or closed according to NMOCD guidelines ☒, a general permit ☐, or an (attached) alternative OCD-approved plan ☐.

Date: 10/11/04

Printed Name/Title James L. Schultz, Agent

Signature [Signature]

Your certification and NMOCD approval of this application/closure does not relieve the operator of liability should the contents of the pit or tank contaminate ground water or otherwise endanger public health or the environment. Nor does it relieve the operator of its responsibility for compliance with any other federal, state, or local laws and/or regulations.

Approval:

Printed Name/Title _____

Signature _____

Date: DEC 8 2004

SECTION 7, TOWNSHIP 6 SOUTH, RANGE 23 EAST, N.M.P.M.,
 CHAVES COUNTY, NEW MEXICO

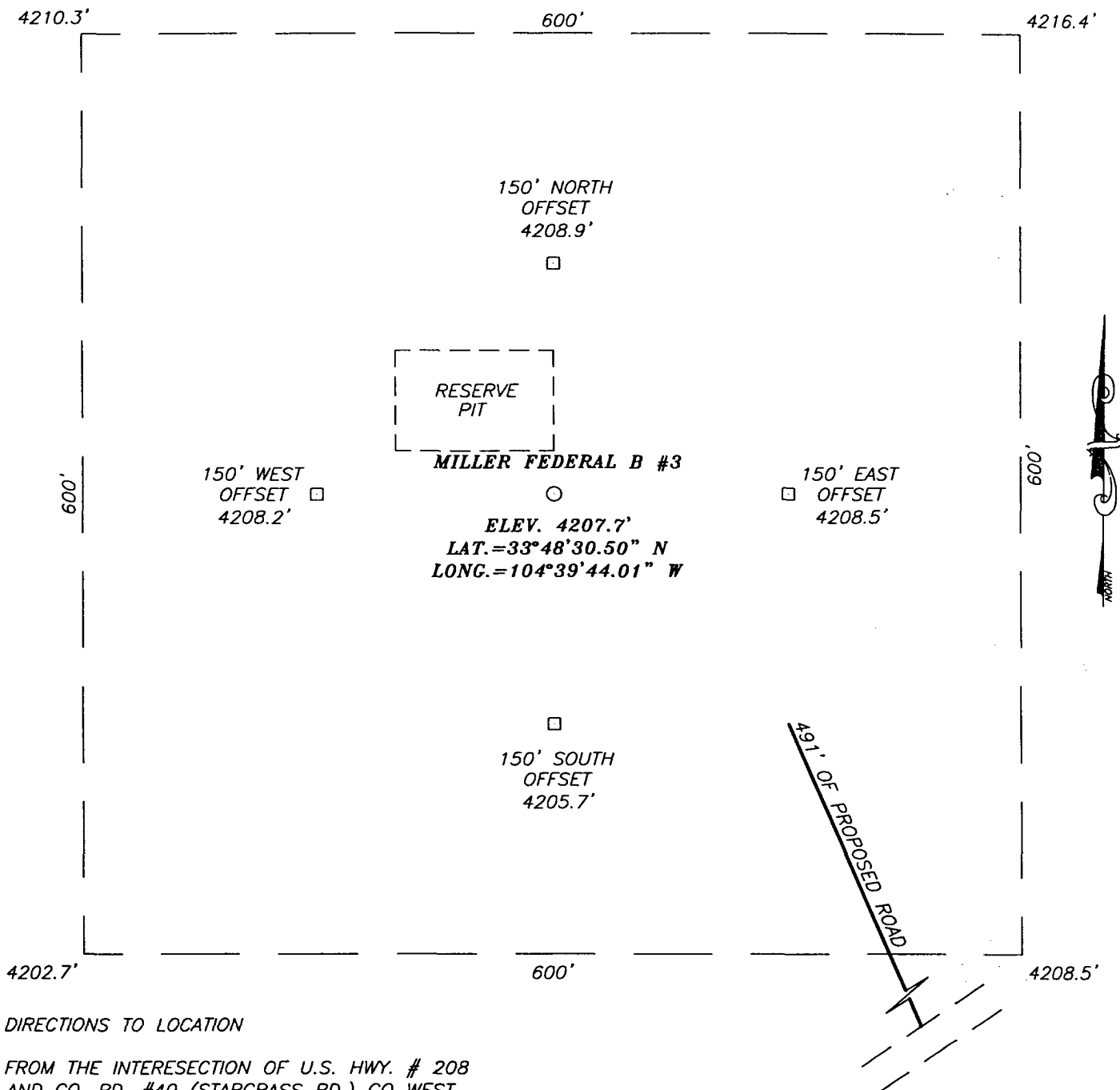

DIRECTIONS TO LOCATION

FROM THE INTERESECTION OF U.S. HWY. # 208 AND CO. RD. #40 (STARGRASS RD.) GO WEST ON CO. RD. #40 FOR APPROX. 2.5 MILES TO A CALICHE ROAD ON THE RIGHT. TURN RIGHT (NORTH) AND GO APPROX. 2.0 MILES, TURN LEFT (WEST) AND GO APPROX. 1.0 MILES, TURN RIGHT (NORTH) AND GO APPROX. 0.15 MILES PAST CATTLEGUARD. TURN WEST AND GO APPROX. 0.6 MILES. PROPOSED LOCATION IS APPROX. 500' NORTH.

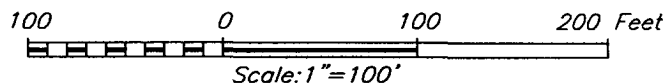

McKAY OIL CORPORATION

MILLER FEDERAL B #3 WELL
 LOCATED 1980 FEET FROM THE SOUTH LINE
 AND 660 FEET FROM THE WEST LINE OF SECTION 7,
 TOWNSHIP 6 SOUTH, RANGE 23 EAST, N.M.P.M.,
 CHAVES COUNTY, NEW MEXICO.

Survey Date: 09/15/04	Sheet 1 of 1 Sheets
W.O. Number: 04.11.1149	Dr By: J.R.
Date: 09/27/04	Disk: CD#10
04111149	Scale: 1"=100'



PROVIDING SURVEYING SERVICES
 SINCE 1948
JOHN WEST SURVEYING COMPANY
 412 N. DAL PASO
 HOBBS, N.M. 88240
 (505) 383-3117

EXHIBIT "C"

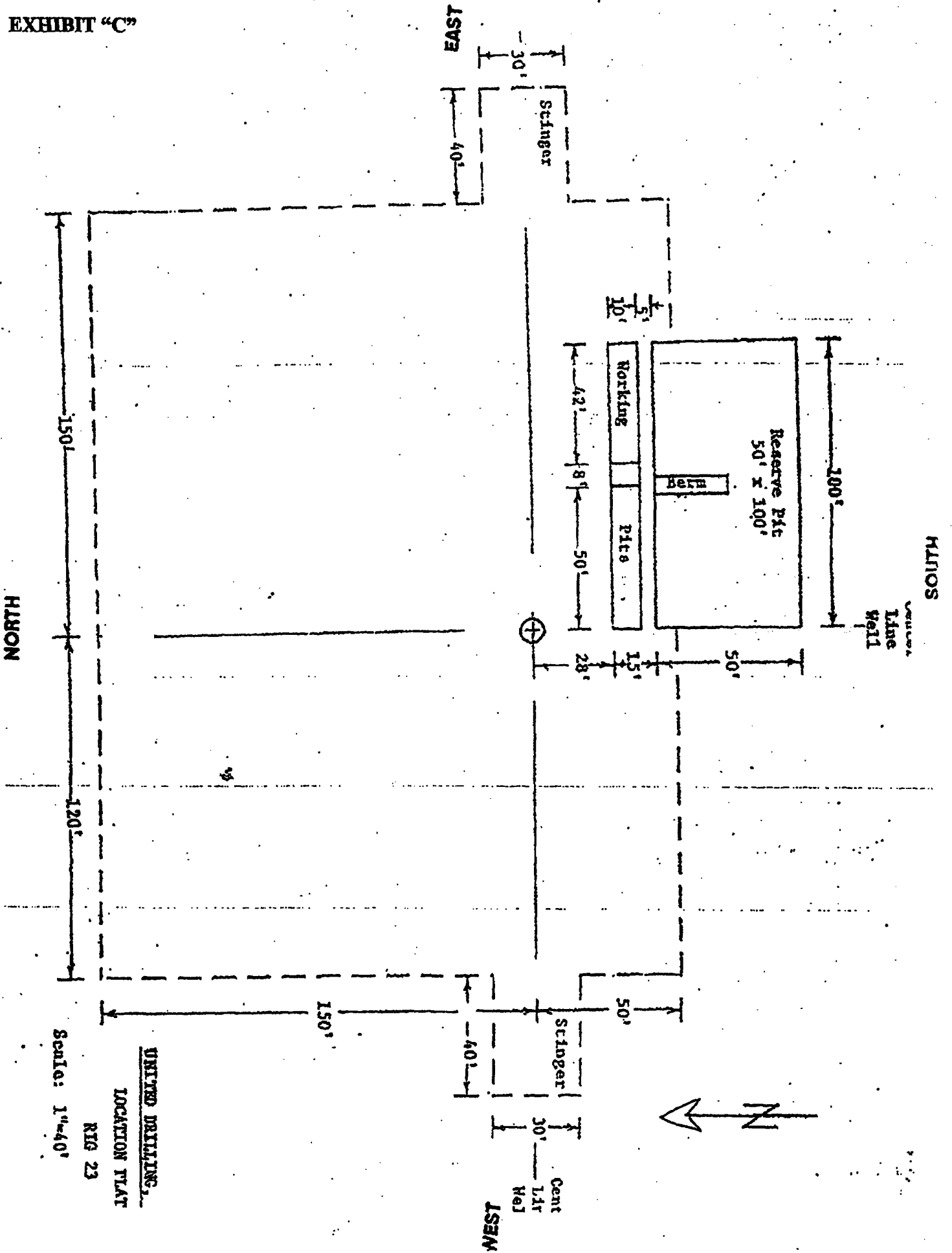

MCKAY OIL COPORATION

Miller B #3

Lot 3 of Section 7, T6S, R23E

Chaves County, New Mexico

EXHIBIT "D"

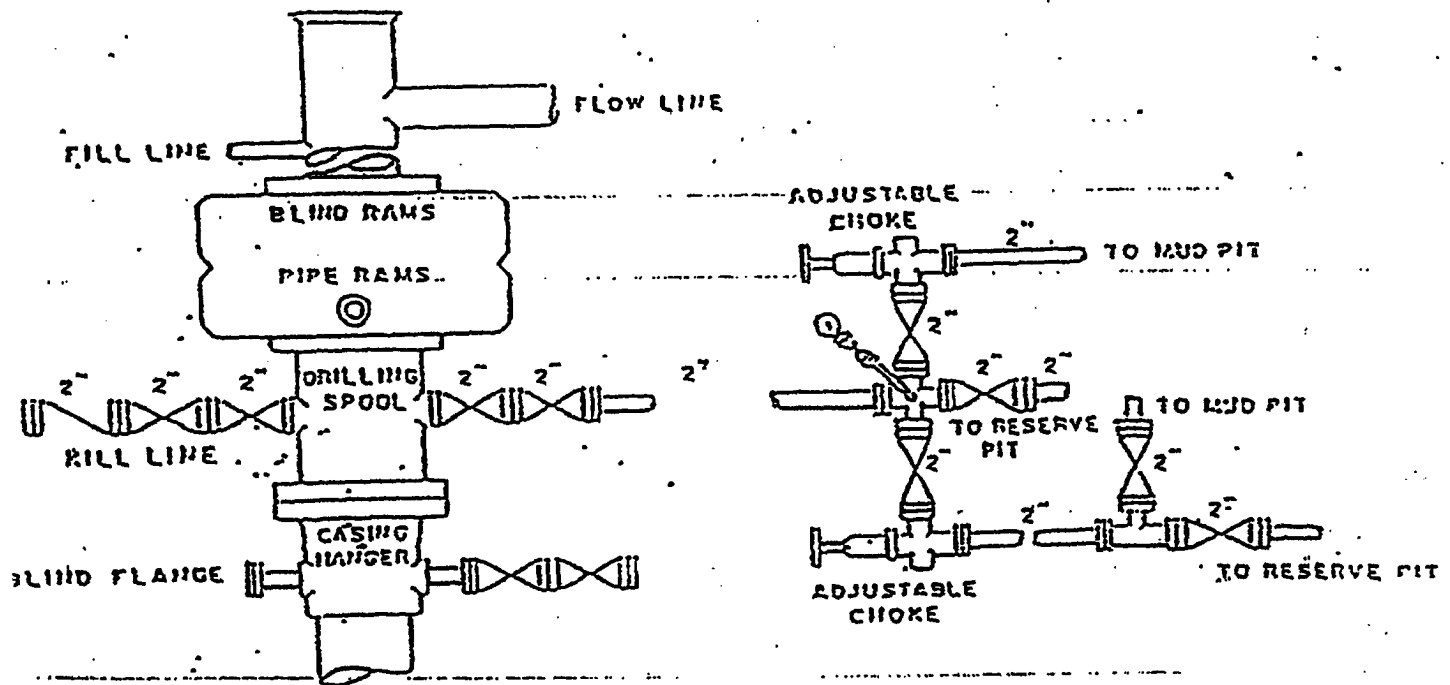

SUPPLEMENTAL DRILLING DATA

MCKAY OIL CORPORATION
MILLER B #3
1980' FSL & 660' FWL Sec. 7, T6S, R23E

Chaves County, New Mexico

The following items supplement Form 3160-3 in accordance with instruction contained in Onshore Oil and Gas Order No. 1:

1. SURFACE FORMATION: San Andres

2. ESTIMATED TOPS OF GEOLOGICAL MARKERS:

Yeso - 931'
Tubb - 2427'
Abo - 2640'

3. ESTIMATED DEPTHS TO WATER, OIL OR GAS FORMATIONS:

Fresh Water - In surface formation above 600'
Gas - In Abo Formation below 2640'

4. PROPOSED CASING PROGRAM:

J-55

12-1/4" hole	8-5/8" X-42	24#	950' +
7-7/8" hole	5-1/2" J-55	15.5#	TD

5. PROPOSED CEMENTING PROGRAM:

Surface to 950'	class "C" - 350 sxs cemented and circulated to surface.
Production Casing	class "C" - 300 sxs cemented with adequate cover.

6. PROPOSED DRILLING PROGRAM:

McKay Oil Corporation proposes to drill and test the ABO formation. Approximately 950' of surface casing will be set and cemented to surface. 5-1/2" production casing will be set and cemented with adequate cover, perforated and stimulated as needed for production.

7. PRESSURE CONTROL EQUIPMENT: Blowout preventer will consist of 2 ram, 2M system. A sketch of the BOP is attached.
8. CIRCULATION MEDIUM: Air Drilling
9. AUXILIARY EQUIPMENT: Full-opening drill string safety valve fit for the drill string in use, will be kept on the rig floor at all times.
10. TESTING, LOGGING AND CORING PROGRAM:
 - Samples: Catch samples from surface to TD.
 - DST's: None.
 - Logging: GR-CNL, Dual Lateral MSFL from surface to TD.
 - Coring: None.
11. ABNORMAL PRESSURES, TEMPERATURES OR HYDROGEN SULFIDE:
None anticipated.
12. ANTICIPATED STARTING DATE: On or before November 1, 2004
Drilling should be completed within 10 days. Completion operations (perforations and stimulation) will follow drilling operations.

**Southwest Petroleum
Land Services, LLC**

100 N. Pennsylvania
Roswell, NM 88203
(505) 622-6713
(505) 622-9282 fax

October 13, 2004

Oil Conservation Division
Bryan Arrant
1301 W. Grand Avenue
Artesia, NM

Re: H2S Contingency Plan-Miller B #3

Bryan,

Please see attached Contingency Plan-H2S for the Miller B #3 located in Sec 7, T6S, R23E 1980' FSL & 660' FWL in Chaves County. Should you need any further information, please contact me at 505-626-6879.

Sincerely,



Jim Schultz
Agent for McKay Oil Corporation

MCKAY OIL CORPORATION
PO BOX 2014
ROSWELL, NM 88202-2014
505-623-4735

HYDROGEN SULFIDE (H₂S) CONTINGENCY PLAN FOR THE
MILLER B #3
LOCATED IN SEC 7, T6S, R23E IN
CHAVES COUNTY, NEW MEXICO

NO HYDROGEN SULFIDE OR OTHER HAZARDOUS GASES OR FLUIDS HAVE
BEEN ENCOUNTERED, REPORTED OR KNOWN TO EXIST AT THIS DEPTH IN
THIS AREA.

MILLER B #3

This is an open drilling Site. H2S monitoring equipment and emergency response equipment will be used within 500' of zones known to contain H2S, including warning signs, wind indicators and H2S monitor. Pumpers carry (MICROPACKS) H2S pocket testers at all times. Pulling units have an H2S indicator that puts off light and alarm on any indication of H2S being present.

MAPS – SEE ATTACHED



CONTOUR INTERVAL:
MESA SW, N.M. - 10'



PROVIDING SURVEYING SERVICES
 SINCE 1946
JOHN WEST SURVEYING COMPANY
 412 N. DAL PASO
 HOBBBS, N.M. 86240
 (505) 383-3117

EMERGENCY PROCEDURES

In the case of a release of gas containing H₂S, the first responder must isolate the area and prevent entry by other persons into the 100 ppm ROE. Additionally the first responder must evacuate any public spaces encompassed by the 100 ppm ROE. First responder must take care not to injure themselves during this operation. Company and or local officials must be contacted to aid in this operation. Evacuation of the public should be beyond the 100 ppm ROE.

All responders must have training in the detection of H₂S measures for protection against the gas, equipment used for protection and emergency response. Additionally, responders must be equipped with H₂S monitors and air packs in order to control the release. Use the “buddy system” to ensure no injuries occur during the response.

IGNITION OF GAS SOURCE

Should control of the well be considered lost and ignition considered, take care to protect against exposure of sulfur Dioxide (SO₂). Intentional ignition must be coordinated with the NMOCD and local officials. Additionally the NM State Police may become involved. NM State Police shall be the Incident Command on scene of any major release. Take care to protect downwind whenever there is an ignition of the gas.

CHARACTERISTICS OF H₂S & SO₂

COMMON NAME	CHEMICAL FORMULA	SPECIFIC GRAVITY	THRESHOLD LIMIT	HAZARDOUS LIMIT	LETHAL CONCENTRATION
HYDROGEN SULFIDE	H ₂ S	1.189 AIR=1	10 PPM ⁴	100 PPM/HR	600 PPM
SULFUR DIOXIDE	SO ₂	2.21 AIR=1	2 PPM	N/A	1000 PPM

CONTACTING AUTHORITIES

McKay Oil Corporation personnel must liaison with local and state agencies to ensure a proper response to a major release. Additionally, the OCD must be notified of the release as soon as possible but no later than 4 hours. Agencies will ask for information such as type and volume of release, wind direction, location of release, etc. be prepared with all information available. The following call list of essential and potential responders must be in coordination with the State of New Mexico’s Hazardous Materials Emergency Response Plan (HMER).

MCKAY OIL CORPORATION CALL LIST

CHAVES COUNTY (505)	OFFICE	CELL PHONE	HOME PHONE
HUMBERTO PEREZ	625-1154	626-8580	627-1985
JIM ROBINSON	625-1154	626-8579	624-1093
APRIL MCKAY	623-4735	626-8575	625-2848

CHAVES COUNTY (505) ROSWELL

STATE POLICE	622-7200
CITY POLICE	911 or 624-6770
SHERIFF'S OFFICE	624-6500
AMBULANCE	911
FIRE DEPARTMENT	624-6800
LEPC (Local Emergency Planning Committee)	Teresa Barncastle 624-6770 ext 129
NMOCD	748-1283
ENMMC (Hospital)	622-8170

N.M. Oil Cons. DIV-Dist. 2
1301 W. Grand Avenue

Form 3160-5
(April 2004)

UNITED STATES
DEPARTMENT OF THE INTERIOR
BUREAU OF LAND MANAGEMENT

Artesia, NM 88210

FORM APPROVED
OMB No. 1004-0137
Expires: March 31, 2007

SUNDRY NOTICES AND REPORTS ON WELLS

Do not use this form for proposals to drill or to re-enter an abandoned well. Use Form 3160-3 (APD) for such proposals.

SUBMIT IN TRIPLICATE- Other instructions on reverse side.

1. Type of Well
☐ Oil Well ☒ Gas Well ☐ Other

2. Name of Operator **McKay Oil Corporation**

3a. Address
PO Box 2014, Roswell, NM 88202-2014

3b. Phone No. (include area code)
505.623.4735

4. Location of Well (Footage, Sec., T., R., M., or Survey Description)
1980' FSL & 660' FWL, Lot 3, Sec 7, T6S, R23E

5. Lease Serial No.
NM 32322

6. If Indian, Allottee or Tribe Name

7. If Unit or CA/Agreement, Name and/or No.

8. Well Name and No.
Miller B Federal 3

9. API Well No.

10. Field and Pool, or Exploratory Area
W. Pecos ABO Slope

11. County or Parish, State
Chaves, NM

12. CHECK APPROPRIATE BOX(ES) TO INDICATE NATURE OF NOTICE, REPORT, OR OTHER DATA

TYPE OF SUBMISSION	TYPE OF ACTION			
<input checked="" type="checkbox"/> Notice of Intent	<input type="checkbox"/> Acidize	<input type="checkbox"/> Deepen	<input type="checkbox"/> Production (Start/Resume)	<input type="checkbox"/> Water Shut-Off
<input type="checkbox"/> Subsequent Report	<input type="checkbox"/> Alter Casing	<input type="checkbox"/> Fracture Treat	<input type="checkbox"/> Reclamation	<input type="checkbox"/> Well Integrity
<input type="checkbox"/> Final Abandonment Notice	<input type="checkbox"/> Casing Repair	<input type="checkbox"/> New Construction	<input type="checkbox"/> Recomplete	<input type="checkbox"/> Other
	<input checked="" type="checkbox"/> Change Plans	<input type="checkbox"/> Plug and Abandon	<input type="checkbox"/> Temporarily Abandon	
	<input type="checkbox"/> Convert to Injection	<input type="checkbox"/> Plug Back	<input type="checkbox"/> Water Disposal	

13. Describe Proposed or Completed Operation (clearly state all pertinent details, including estimated starting date of any proposed work and approximate duration thereof. If the proposal is to deepen directionally or recompleat horizontally, give subsurface locations and measured and true vertical depths of all pertinent markers and zones. Attach the Bond under which the work will be performed or provide the Bond No. on file with BLM/BIA. Required subsequent reports shall be filed within 30 days following completion of the involved operations. If the operation results in a multiple completion or recompleat in a new interval, a Form 3160-4 shall be filed once testing has been completed. Final Abandonment Notices shall be filed only after all requirements, including reclamation, have been completed, and the operator has determined that the site is ready for final inspection.)

Move move access road to southwest corner - see attached EXHIBIT "C". Move proposed pipeline to follow on south side of access road, and from SE corner to existing 6" pipeline - see attached EXHIBIT "B" and pipeline map.

14. I hereby certify that the foregoing is true and correct
Name (Printed/Typed)

James L. Schultz

Signature

Title **Agent**

Date **October 27, 2004**

THIS SPACE FOR FEDERAL OR STATE OFFICE USE

Approved by **/S/LARRY D. BRAY**

Assistant Field Manager
Title **And Minerals**

Date **DEC 06 2004**

Conditions of approval, if any, are attached. Approval of this notice does not warrant or certify that the applicant holds legal or equitable title to those rights in the subject lease which would entitle the applicant to conduct operations thereon.

Office **ROSWELL FIELD OFFICE**

Title 18 U.S.C. Section 1001 and Title 43 U.S.C. Section 1212, make it a crime for any person knowingly and willfully to make to any department or agency of the United States any false, fictitious or fraudulent statements or representations as to any matter within its jurisdiction.

(Instructions on page 2)

EXHIBIT "B"

LOCATION VERIFICATION MAP

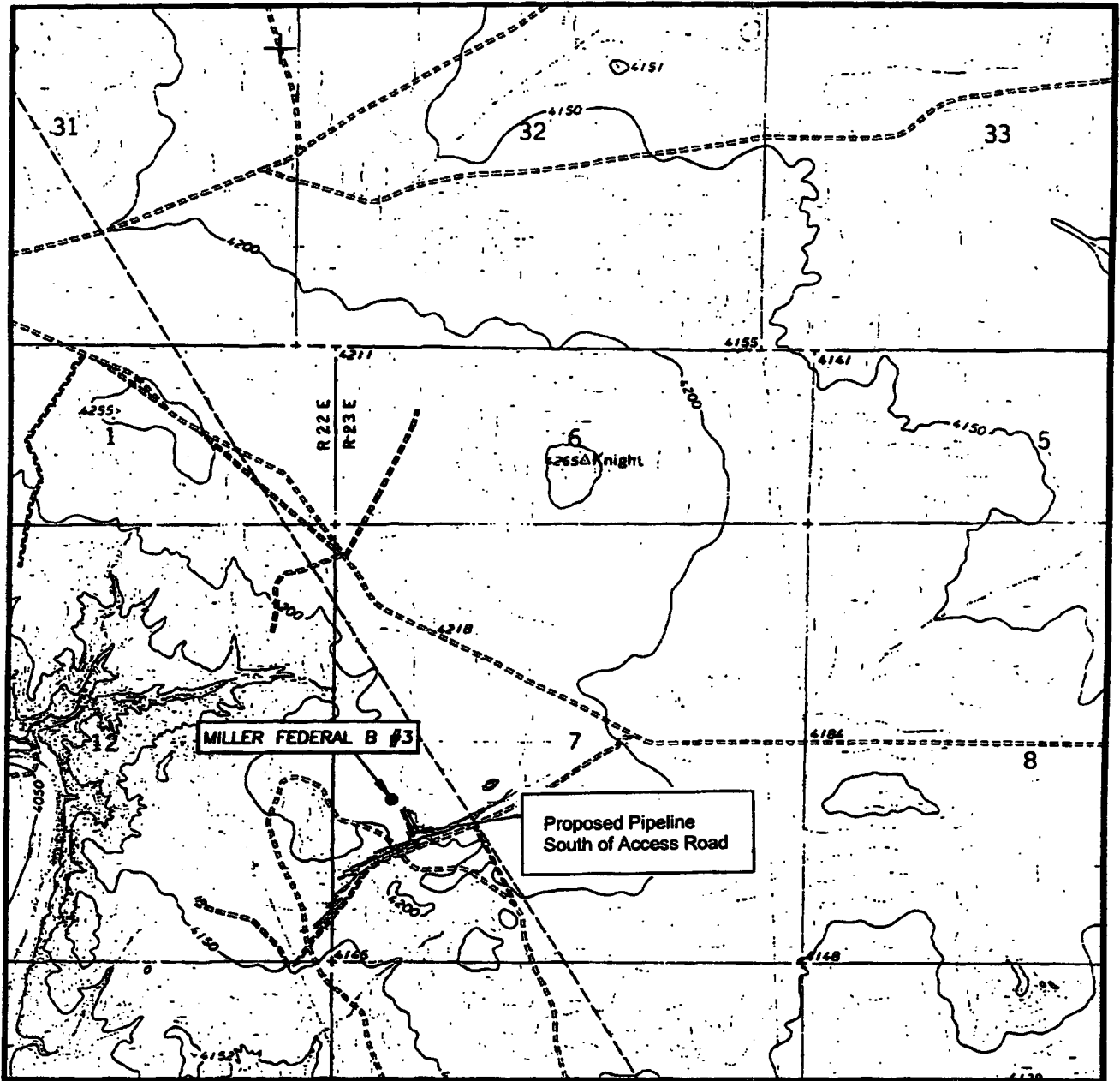

SCALE: 1" = 2000'

CONTOUR INTERVAL:
MESA SW, N.M. - 10'

SEC. 7 TWP. 6-S RGE. 23-E

SURVEY N.M.P.M.

COUNTY CHAVES

DESCRIPTION 1980' FSL & 660' FWL

ELEVATION 4208'

OPERATOR McKAY OIL CORPORATION

LEASE MILLER FEDERAL B

U.S.G.S. TOPOGRAPHIC MAP
MESA SW, N.M.

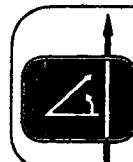

PROVIDING SURVEYING SERVICES
SINCE 1946
JOHN WEST SURVEYING COMPANY
412 N. DAL. PASSO
HOBBS, N.M. 88240
(505) 393-9117

SECTION 7, TOWNSHIP 6 SOUTH, RANGE 23 EAST, N.M.P.M,
CHAVES COUNTY, NEW MEXICO



MILLER FED B #7

MILLER FED #3



MILLER FED B #3



EXISTING 6" PIPELINE

Access Road

Pipeline

EXHIBIT "C"

