

## District I

1625 N. French Dr., Hobbs, NM 88240

## District II

1301 W. Grand Avenue, Artesia, NM 88210

## District III

1000 Rio Brazos Rd., Aztec, NM 87410

## District IV

1220 S. St. Francis Dr., Santa Fe, NM 87505

## State of New Mexico

Energy, Minerals &amp; Natural Resources Department

## OIL CONSERVATION DIVISION

1220 South St. Francis Dr.

Santa Fe, NM 87505

Form C-102

Revised June 10, 2003

Submit to Appropriate District Office

State Lease - 4 Copies

Fee Lease - 3 Copies

☒ AMENDED REPORT

## WELL LOCATION AND ACREAGE DEDICATION PLAT

<sup>1</sup> API Number 30-015-26593	<sup>2</sup> Pool Code 82565	<sup>3</sup> Pool Name PARKWAY ATOKA
<sup>4</sup> Property Code	<sup>5</sup> Property Name EAST BURTON FLAT 36 STATE	<sup>6</sup> Well Number 1S
<sup>7</sup> OGRID No. 154903	Operator Name ST. MARY LAND & EXPLORATION COMPANY	<sup>9</sup> Elevation 3300'

<sup>10</sup> Surface Location

UL or lot no.	Section	Township	Range	Lot Idn	Feet from the	North/South line	Feet from the	East/West line	County
I	36	19S	29E		2240'	S	660'	E	EDDY

<sup>11</sup> Bottom Hole Location If Different From Surface

UL or lot no.	Section	Township	Range	Lot Idn	Feet from the	North/South line	Feet from the	East/West line	County
J	36	19S	29E		1357'	S	1683'	E	EDDY

<sup>12</sup> Dedicated Acres 320	<sup>13</sup> Joint or Infill	<sup>14</sup> Consolidation Code	<sup>15</sup> Order No.
--------------------------------------	-------------------------------	----------------------------------	-------------------------

NO ALLOWABLE WILL BE ASSIGNED TO THIS COMPLETION UNTIL ALL INTERESTS HAVE BEEN CONSOLIDATED OR A NON-STANDARD UNIT HAS BEEN APPROVED BY THE DIVISION

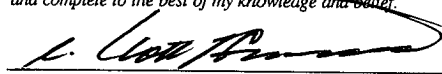
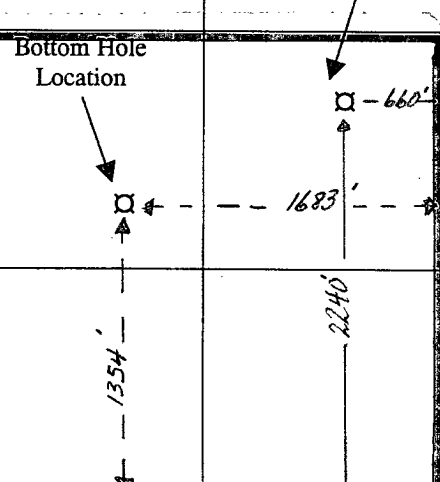
<sup>16</sup> State Lease V-1576	<div style="text-align: center;"> <b>RECEIVED</b>  DEC - 8 2004  OCD-ARTESIA </div>			<sup>17</sup> OPERATOR CERTIFICATION I hereby certify that the information contained herein is true and complete to the best of my knowledge and belief.  Signature L. Scott Hammond Printed Name Senior Landman - Scott.Hammond@stmaryland.com Title and E-mail Address 12/2/04 Date
Dedicated laydown 320-acre spacing unit	<div style="text-align: center;"> Original vertical surface location   </div>			<sup>18</sup> SURVEYOR CERTIFICATION I hereby certify that the well location shown on this plat was plotted from field notes of actual surveys made by me or under my supervision, and that the same is true and correct to the best of my belief. Date of Survey Signature and Seal of Professional Surveyor: See attached C-102 from original vertical hole. Certificate Number

# OIL CONSERVATION DIVISION

P.O. Box 2088  
Santa Fe, New Mexico 87504-2088

DISTRICT I  
Box 1980, Hobbs, NM 88240

DISTRICT II  
P.O. Drawer DD, Artesia, NM 88210

DISTRICT III  
1000 Rio Brazos Rd., Aztec, NM 87410

## WELL LOCATION AND ACREAGE DEDICATION PLAT

All Distances must be from the outer boundaries of the section

Operator SANTA FE ENERGY OPERATING PARTNERS LP.			Lease EAST BURTON FLAT STATE 36		Well No. 1
Unit Letter I	Section 36	Township 19 SOUTH	Range 29 EAST	County NMPM EDDY	
Actual Footage Location of Well: 2240 feet from the SOUTH line and 660 feet from the EAST line					
Ground level Elev. 3329.9	Producing Formation Strawn	Pool East Burton Flat Strawn Gas		Dedicated Acreage: 320 Acres	

- Outline the acreage dedicated to the subject well by colored pencil or inkature marks on the plat below.
- If more than one lease is dedicated to the well, outline each and identify the ownership thereof (both as to working interest and royalty).
- If more than one lease of different ownership is dedicated to the well, have the interest of all owners been consolidated by communitization, unitization, force-pooling, etc?  
☐ Yes ☐ No If answer is "yes" type of consolidation Common ownership  
If answer is "no" list the owners and tract descriptions which have actually been consolidated. (Use reverse side of this form if necessary.)  
No allowable will be assigned to the well until all interests have been consolidated (by communitization, unitization, forced-pooling, or otherwise) or until a non-standard unit, eliminating such interest, has been approved by the Division.

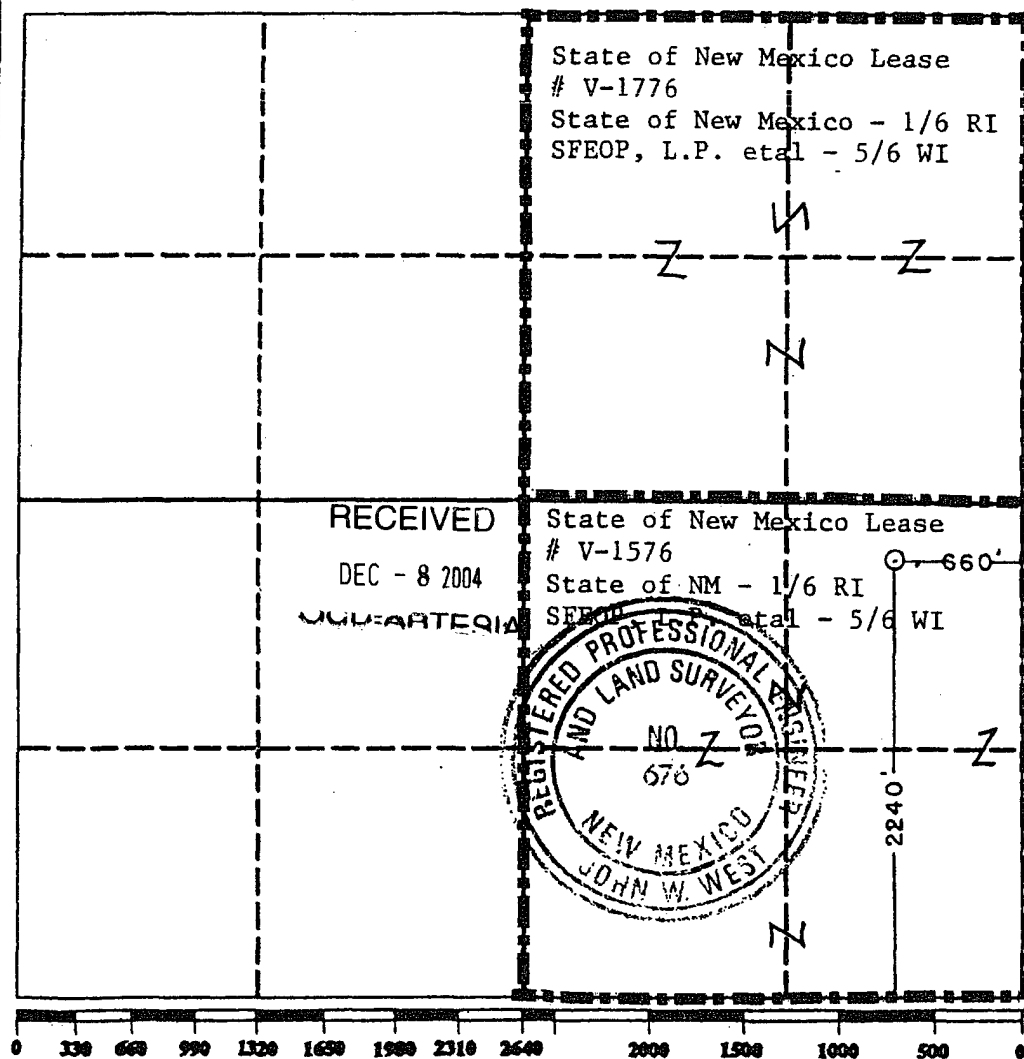

### OPERATOR CERTIFICATION

I hereby certify that the information contained herein is true and complete to the best of my knowledge and belief.

Signature  
*Michael R. Burton*  
Printed Name  
Michael R. Burton  
Position  
Operations Manager  
Company  
Santa Fe Energy Operating Partners, L.P.  
Date  
December 21, 1990

### SURVEYOR CERTIFICATION

I hereby certify that the well location shown on this plat was plotted from field notes of actual surveys made by me or under my supervision, and that the same is true and correct to the best of my knowledge and belief.

Date Surveyed  
12-3-90  
Signature & Seal of Professional Surveyor  
*John W. West*  
Certificate No.  
JOHN W. WEST, 676  
RONALD J. EIDSON, 3239