

State of New Mexico
Energy, Minerals & Natural Resources

Form C-101

March 4, 2004

Submit to appropriate District Office

State Lease - 6 Copies

Fee Lease - 5 Copies

Oil Conservation Division

1220 S. St. Francis Dr.

Santa Fe, NM 87505

RECEIVED

FEB 02 2005

☐ AMENDED REPORT

District I
1625 N. French Dr., Hobbs, NM 88240
District II
1301 W. Grand Avenue, Artesia, NM 88210
District III
1000 Rio Brazos Rd., Aztec, NM 87410
District IV
1220 S. St. Francis Dr., Santa Fe, NM 87505

APPLICATION FOR PERMIT TO DRILL, RE-ENTER, DEEPEN, PLUGBACK, OR ADD A ZONE

¹ Operator Name and Address Nearburg Producing Company 3300 N A St., Bldg 2, Ste 120, Midland, TX 79705		² OGRID Number 015742
		³ API Number 30- 15-28186
⁴ Property Code	⁵ Property Name Big Walt 2 State	⁶ Well No. 3

⁷ Surface Location

UL or lot no.	Section	Township	Range	Lot. Idn	Feet from the	North/South Line	Feet from the	East/West line	County
K	2	22S	24E		1980	South	1980	West	Eddy

⁸ Proposed Bottom Hole Location If Different From Surface

UL or lot no.	Section	Township	Range	Lot. Idn	Feet from the	North/South Line	Feet from the	East/West line	County

⁹ Proposed Pool 1 Indian Basin; Upper Penn. Associated (33685)	¹⁰ Proposed Pool 2
--	-------------------------------

Drilling Pit Location and Other Information

UL or lot no.	Section	Township	Range	Lot. Idn	Feet from the	North/South Line	Feet from the	East/West line	County
K	2	22S	24E		1980	South	1980	West	Eddy
Depth to ground water				Distance from nearest fresh water well			Distance from nearest surface water		
¹¹ Work Type Code Plugback		¹² Well Type Code 0		¹³ Cable/Rotary		¹⁴ Lease Type Code S		¹⁵ Ground Level Elevation 3902	
¹⁶ Multiple No		¹⁷ Proposed Depth 10370		¹⁸ Formation Cisco Canyon		¹⁹ Contractor Lucky		²⁰ Spud Date 2/7/05	

²¹ Proposed Casing and Cement Program

Hole Size	Casing Size	Casing weight/foot	Setting Depth	Sacks of Cement	Estimated TOC
14-3/4	9-5/8	36	1600	1335	Circ to Surface
8-3/4	7	23 & 26	8500	1395	Circ to Surface
6-1/8	4-1/2	11.6	8346-10370	230	
All strands are	existing				

²² Describe the proposed program. If this application is to DEEPEN or PLUG BACK, give the data on the present productive zone and proposed new productive zone. Describe the blowout prevention program, if any. Use additional sheets if necessary.

Propose to plugback the well from the Morrow to the Cisco Canyon formation. Perf. test and Stimulate as necessary to establish production as per attached procedure.

C102 attached.

²³ I hereby certify that the information given above is true and complete to the best of my knowledge and belief. I further certify that the drilling pit will be constructed according to NMOC guidelines ☒ a general permit ☐, or an (attached) alternative OCD-approved plan ☐.

Signature:

Printed name: Sarah Jordan

Title: Production Analyst

E-mail Address: sjordan@nearburg.com

Date: 1/31/05

Phone: 432/686-8235 x 203

OIL CONSERVATION DIVISION

Approved by:

TIM W. GUM

DISTRICT II SUPERVISOR

Approval Date: MAR 14 2005

Expiration Date: MAR 14 2006

Conditions of Approval:

Attached ☐

- 1) MIRU PU. MIRU JSI to RIH w/plug to set in 1.875" on-off tool @ 9,941'. Release from o/o tool. Dump 2 or 3 sx sand.
- 2) RIH w/7" RBP. Set to TA the Morrow. Cover w/sand. POH w/tbg.
- 3) RU JSI to re-perforate the Cisco.
- 4) Acidize.
- 5) Acid Frac
- 6) RIH w/ production equipment and released to production. RDMO workover unit.

District I
PO Box 1980, Hobbs, NM 88240-1980
District II
PO Drawer DD, Artesia, NM 88211-0719
District III
1000 Rio Brazos Rd., Aztec, NM 87410
District IV
PO Box 2088, Santa Fe, NM 87504-2088

State of New Mexico
Energy, Minerals & Natural Resources Department

OIL CONSERVATION DIVISION
PO Box 2088
Santa Fe, NM 87504-2088

Form C-10
Revised February 10, 1999
Instructions on back
Submit to Appropriate District Office
State Lease - 4 Copies
Fee Lease - 3 Copies

☐ AMENDED REPORT

WELL LOCATION AND ACREAGE DEDICATION PLAT

* APT. Number 30-01528186		* Pool Code 33685		* Pool Name Indian Basin, Upper Penn, 155.	
* Property Code BIG WALT STATE		* Property Name			* Well Number 3
* OGRID No. 015742		* Operator Name NEARBURG PRODUCING COMPANY			* Elevation 3902.

¹⁰ Surface Location

UL or lot no.	Section	Township	Range	Lot Idn	Feet from the	North/South line	Feet from the	East/West line	County
K	2	22S	24E		1980	SOUTH	1980	WEST	EDDY

¹¹ Bottom Hole Location If Different From Surface

UL or lot no.	Section	Township	Range	Lot Idn	Feet from the	North/South line	Feet from the	East/West line	County

¹² Dedicated Acres 320	¹³ Joins or Infill	¹⁴ Consolidation Code	¹⁵ Order No.
--------------------------------------	-------------------------------	----------------------------------	-------------------------

NO ALLOWABLE WELL BE ASSIGNED TO THIS COMPLETION UNTIL ALL INTERESTS HAVE BEEN CONSOLIDATED OR A NON-STANDARD UNIT HAS BEEN APPROVED BY THE DIVISION

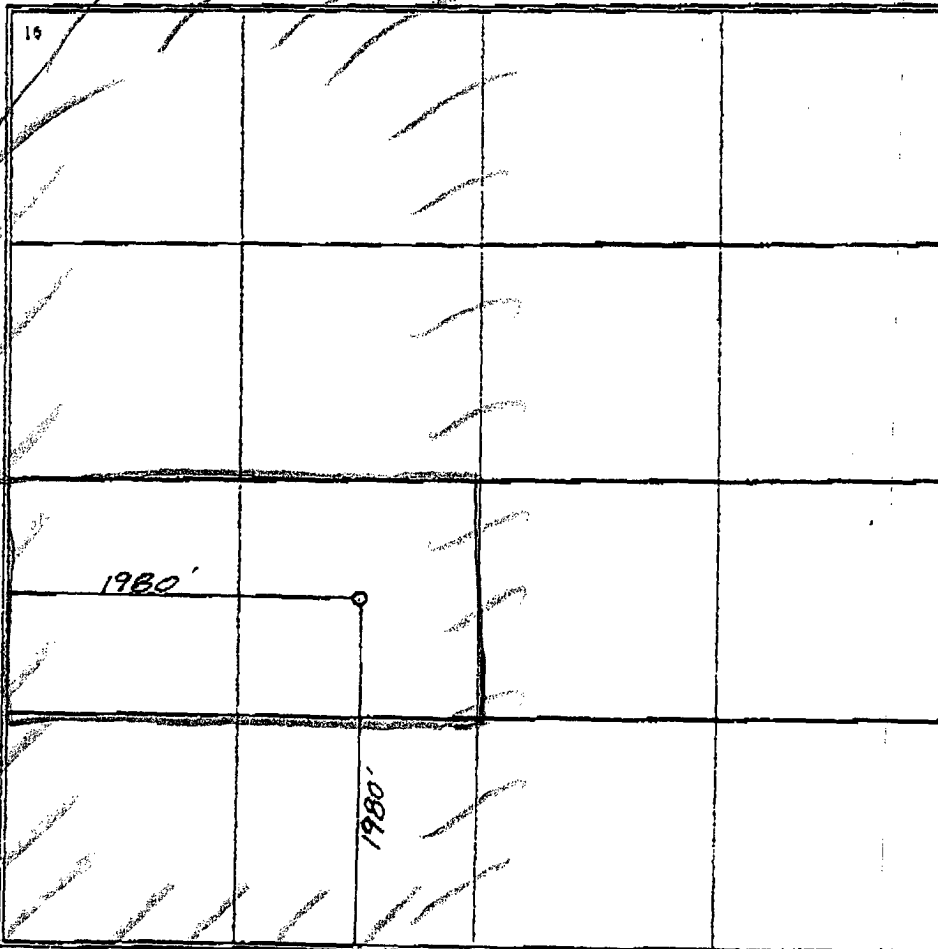

¹⁷ OPERATOR CERTIFICATION

I hereby certify that the information contained herein is true and complete to the best of my knowledge and belief.

[Signature]
Signature
Sarah Jordan
Printed Name
Prod. Analyst
Title
1-31-05
Date

¹⁸ SURVEYOR CERTIFICATION

I hereby certify that the well location shown on this plat was plotted from field notes of actual surveys made by me or under my supervision, and that the same is true and correct to the best of my belief.

OCTOBER 27, 1994
Date of Survey

Signature of Registered Professional Surveyor



Rotating Head (Optional)
Drilling Nipple option
must include a fill-up
line. Do not use kill line
for fill up.

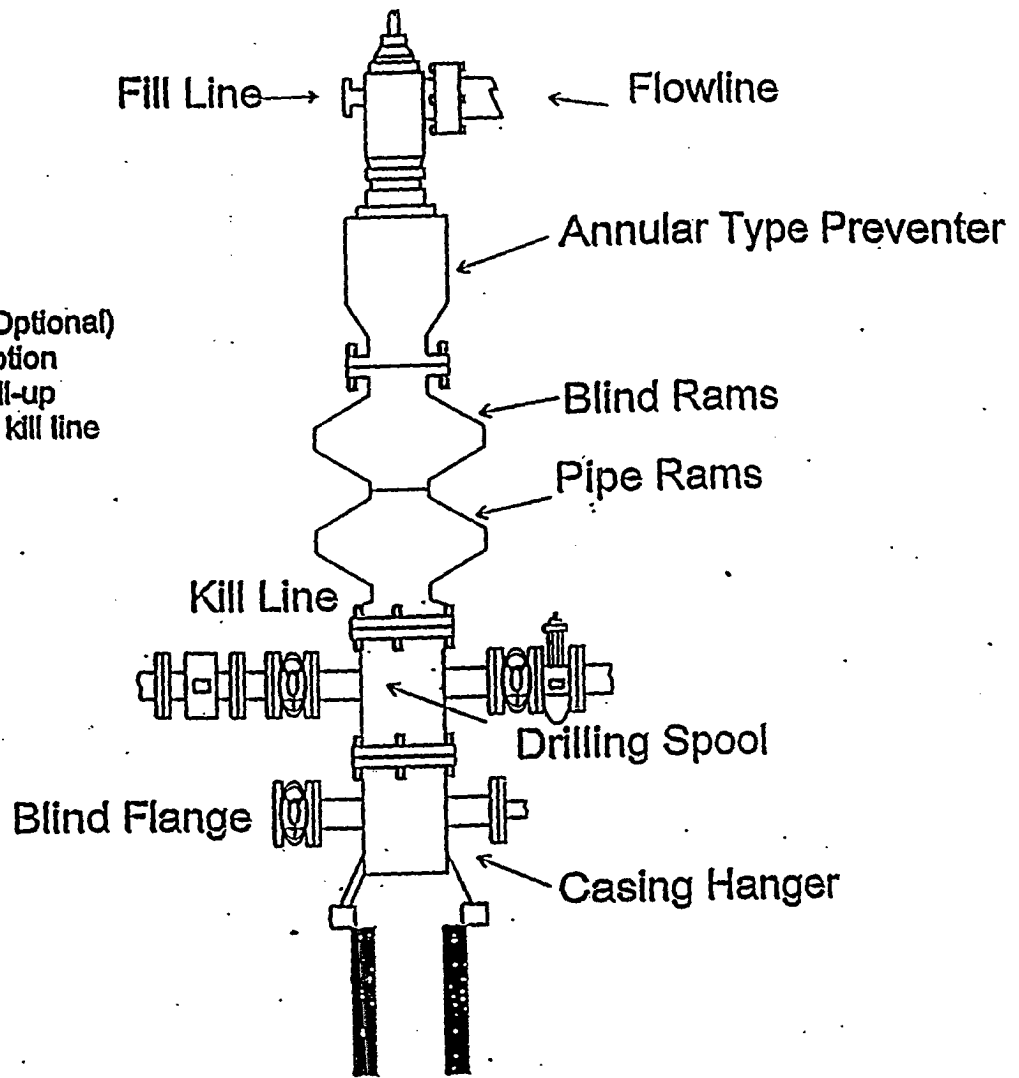

1500 Series

FEARBURG PRODUCING COMP
CHOKE MANIFOLD
5M SERVICE

