

District I
1625 N. French Dr., Hobbs, NM 88240
District II
1301 W. Grand Avenue, Artesia, NM 88210
District III
1000 Rio Brazos Road, Aztec, NM 87410
District IV
1220 S. St. Francis Dr. Santa Fe, NM 87505

State of New Mexico
Energy Minerals and Natural Resources

Form C-144
June 1, 2004

Oil Conservation Division
1220 South St. Francis Dr.
Santa Fe, NM 87505

For drilling and production facilities, submit to appropriate NMOCD District Office.
For downstream facilities, submit to Santa Fe office

MAR 10 2005

Pit or Below-Grade Tank Registration or Closure

Is pit or below-grade tank covered by a "general plan"? Yes X No ☐

Type of action: Registration of a pit or below-grade tank ☐ Closure of a pit or below-grade tank X

Operator: Yates Petroleum Company Telephone: 505-748-4500 e-mail address: mikes@ypc.com
Address: 105 South 4th Street, Artesia, N.M. 88210
Facility or well name: Comanchero BCZ Fed. #1 API #: 30-005-62113 U/L or Qtr/Qtr E Sec 26 T 10S R 34E
County: Chaves Latitude 33.41973 Longitude 104.37868 NAD: 1927 ☐ 1983 X
Surface Owner: Federal ☐ State ☒ Private ☐ Indian ☐

Pit	Below-grade tank
Type: Drilling X Production <input type="checkbox"/> Disposal <input type="checkbox"/> Work over <input type="checkbox"/> Emergency <input type="checkbox"/> Lined X Unlined <input type="checkbox"/> Liner type: Synthetic X Thickness <u>12</u> mil Clay <input type="checkbox"/> Pit Volume <u>12,000</u> bbl	Volume: _____ bbl Type of fluid: _____ Construction material: _____ Double-walled, with leak detection? Yes <input type="checkbox"/> If not, explain why not. _____
Depth to ground water (vertical distance from bottom of pit to seasonal high water elevation of ground water.)	Less than 50 feet (20 points) 50 feet or more, but less than 100 feet (10 points) XXXX 100 feet or more (0 points)
Wellhead protection area: (Less than 200 feet from a private domestic water source, or less than 1000 feet from all other water sources.)	Yes (20 points) No (0 points) XXXX
Distance to surface water: (horizontal distance to all wetlands, playas, irrigation canals, ditches, and perennial and ephemeral watercourses.)	Less than 200 feet (20 points) 200 feet or more, but less than 1000 feet (10 points) 1000 feet or more (0 points) XXXX
	Ranking Score (Total Points) 10 POINTS

If this is a pit closure: (1) Attach a diagram of the facility showing the pit's relationship to other equipment and tanks. (2) Indicate disposal location: (check the onsite box if your are burying in place) onsite X offsite If offsite, name of facility NA. (3) Attach a general description of remedial action taken including remediation start date and end date.
(4) Groundwater encountered: No ☐ Yes ☐ If yes, show depth below ground surface _____ ft. and attach sample results.
(5) Attach soil sample results and a diagram of sample locations and excavations.

Additional Comments: Closure work plan for encapsulation trench. The drilling pit contents will be mixed to stiffen the pit contents. Encapsulation trench will be excavated and lined with a 12 mil. Synthetic liner on former drilling pit site. Drilling pit contents will then be emplaced into the encapsulation trench. A 20 mil. Synthetic liner will then be placed over the pit contents with a min. of a 3' over lap of the underlying trench areas. The encapsulation trenches will then be backfilled back to grade using a min. of 3' of clean soil and like material. A one call & 48 hour notice will be provided to the Oil Conservation Division before pit closure actions begin.

Pit Closure actions to begin by NA. Ending date NA

I hereby certify that the information above is true and complete to the best of my knowledge and belief. I further certify that the above-described pit or below-grade tank has been/will be constructed or closed according to NMOCD guidelines ☐, a general permit X, or an (attached) alternative OCD-approved plan ☐.

Date: 03/09/2005

Printed Name/Title Dan Delp - Regional Signature [Signature]

Your certification and NMOCD approval of this application/closure does not relieve the operator of liability should the contents of the pit or tank contaminate ground water or otherwise endanger public health or the environment. Nor does it relieve the operator of its responsibility for compliance with any other federal, state, or local laws and/or regulations.

Approval: [Signature] Signature [Signature] Date: MAR 9 2005

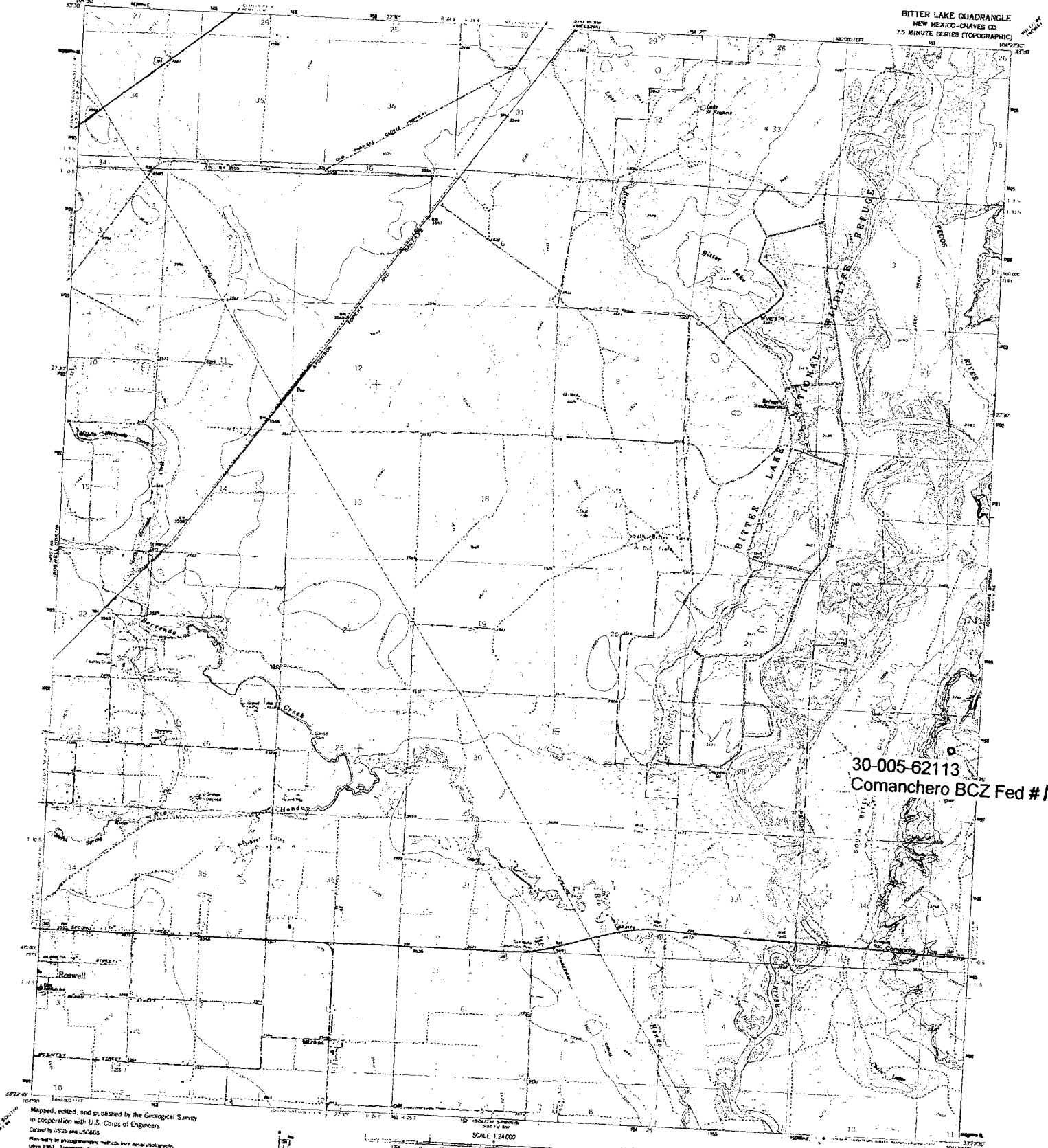

30-005-62113
Comanchero BCZ Fed #1

Maped, edited, and published by the Geological Survey
in cooperation with U. S. Corps of Engineers
Control by USGS and USACE

Plan ready by photogrammetry, methods, and aerial photography
Survey 1961. Topography by stereoscopic survey 1960. Aerial 1962
Photograph corrected on 1967 North American datum.
10,000-foot grid based on New Mexico coordinate system and other
1000-foot Universal Transverse Mercator grid zone
corner U.S. known as Bear
Five red dashed lines indicate uncorrected areas.
Area covered by dashed light blue outline is subject
to change in position
This map is not to be used for navigation
except as a reference map only

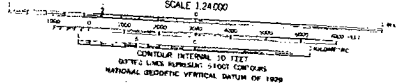
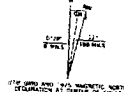

ROAD CLASSIFICATION

Heavy duty	Light duty
Medium duty	Unimproved dirt
U.S. Route	State Route



THIS MAP COMPLETES WITH NATIONAL MAP ACCURACY STANDARDS
FOR SALE BY U. S. GEOLOGICAL SURVEY, DENVER COLORADO 80202, OR RESTON, VIRGINIA 22092
A POLAR ORIENTED TOPOGRAPHIC MAP AND SYMBOLS IS AVAILABLE ON REQUEST

BITTER LAKE, N. MEX.
1:24,000
1962
AMS 510 IV NW - SERIES VIII

30-005-62113 Comanchero 862 Feet. #1

**New Mexico Office of the State Engineer
Well Reports and Downloads**

Township: 10S Range: 26E Sections:

NAD27 X: Y: Zone: Search Radius:

County: Basin: Number: Suffix:

Owner Name: (First) (Last) ☐ Non-Domestic ☐ Domestic
☒ All

Well / Surface Data Report

Avg Depth to Water Report

Water Column Report

Clear Form

WATERS Menu

Help

AVERAGE DEPTH OF WATER REPORT 03/09/2005

Bsn	Tws	Rng	Sec	Zone	X	Y	Wells	(Depth Water in Feet)		
								Min	Max	Avg
RA	10S	26E	28				1	50	50	50
RA	10S	26E	29				1	70	70	70

Record Count: 2