

District I  
1625 N. French Dr., Hobbs, NM 88240  
District II  
1301 W. Grand Avenue, Artesia, NM 88210  
District III  
1000 Rio Brazos Road, Aztec, NM 87410  
District IV  
1220 S. St. Francis Dr., Santa Fe, NM 87505

State of New Mexico  
Energy Minerals and Natural  
Resources

Oil Conservation Division  
1220 South St. Francis Dr.  
Santa Fe, NM 87505

Form C-144  
June 1, 2004

For drilling and production facilities, submit  
to appropriate NMOCD District Office.  
For downstream facilities, submit to Santa Fe  
office

Pit or Below-Grade Tank Registration or Closure

Is pit or below-grade tank covered by a "general plan"? Yes ☒ No ☐

Type of action: Registration of a pit or below-grade tank ☐ Closure of a pit or below-grade tank ☒

Operator: Yates Petroleum Corporation Telephone: 505-748-4500 e-mail address: mikes@ypc.com  
Address: 105. South 4<sup>th</sup> street, Artesia, N.M. 88210  
Facility or well name: Margene AWM Fed. # 3 API #: 30-005-63676 U/L or Qtr/Qtr A Sec 19 T 9s R 26e  
County: Chaves Latitude 33.52293 Longitude 104.33032 NAD: 1927 ☐ 1983 X  
Surface Owner: Federal ☒ State Private Indian ☐

Pit

Type: Drilling ☒ Production ☐ Disposal ☐

Work over ☐ Emergency ☐

Lined ☒ Unlined ☐

Liner type: Synthetic ☒ 12 mil. Thickness NA mil Clay ☐

Pit Volume 15,000 bbl

Below-grade tank

Volume: bbl Type of fluid:

Construction material:

Double-walled, with leak detection? Yes ☐ If not, explain why not.

Depth to ground water (vertical distance from bottom of pit to seasonal  
high water elevation of ground water.)

Less than 50 feet

(20 points)

50 feet or more, but less than 100 feet

(10 points)X

100 feet or more

( 0 points)

Wellhead protection area: (Less than 200 feet from a private domestic  
water source, or less than 1000 feet from all other water sources.)

Yes

(20 points)

No

( 0 points)X

Distance to surface water: (horizontal distance to all wetlands, playas,  
irrigation canals, ditches, and perennial and ephemeral watercourses.)

Less than 200 feet

(20 points)

200 feet or more, but less than 1000 feet

(10 points)

1000 feet or more

( 0 points)

**Ranking Score (Total Points)**

10 Points

**If this is a pit closure:** (1) Attach a diagram of the facility showing the pit's relationship to other equipment and tanks. (2) Indicate disposal location: (check the onsite box if  
you are burying in place) onsite ☒ offsite ☐ If offsite, name of facility. (3) Attach a general description of remedial action taken including  
remediation start date and end date. (4) Groundwater encountered: No ☐ Yes ☐ If yes, show depth below ground surface ft. and attach sample results.  
(5) Attach soil sample results and a diagram of sample locations and excavations.

Additional Comments: Closure workplan for Encapsulation trench. The drilling pit contents will be mixed to stiffen the pit contents. Encapsulation trench will be excavated and  
lined with a 12 mil. Synthetic liner on former drilling pit site. Drilling pit contents will then be emplaced into the encapsulation trench. A 20 mil. Synthetic liner will then be  
placed over the pit contents with a min. of a 3' over lap of the under laying trench area. The encapsulation trenches will then backfilled back to grade using a min. of 3' of  
clean soil and like material. A one call & 48 hour notice will be provide to the Oil Conservation Division before pit closure actions began.

Pit Closure actions to begin by NA. Ending date NA.

I hereby certify that the information above is true and complete to the best of my knowledge and belief. I further certify that the above-described pit or below-grade tank  
has been/will be constructed or closed according to NMOCD guidelines ☐, a general permit ☒, or an (attached) alternative OCD-approved plan ☐.

Date: 3/24/2005

Printed Name/Title Dan Dolan/ Regulatory agent

Signature

Your certification and NMOCD approval of this application/closure does not relieve the operator of liability should the contents of the pit or tank contaminate ground water or  
otherwise endanger public health or the environment. Nor does it relieve the operator of its responsibility for compliance with any other federal, state, or local laws and/or  
regulations.

Approval:

Printed Name/Title

Signature

MAR 29 2005

*New Mexico Office of the State Engineer*  
**Well Reports and Downloads**

Township: 09S Range: 26E Sections:

NAD27 X: Y: Zone: Search Radius:

County: Basin: Number: Suffix:

Owner Name: (First) (Last) ☐ Non-Domestic ☐ Domestic  
☒ All

Well / Surface Data Report

Avg Depth to Water Report

Water Column Report

Clear Form

WATERS Menu

Help

**AVERAGE DEPTH OF WATER REPORT 03/24/2005**

Bsn	Tws	Rng	Sec	Zone	X	Y	Wells	(Depth Water in Feet)		
								Min	Max	Avg
RA	09S	26E	12				1	99	99	99

Record Count: 1

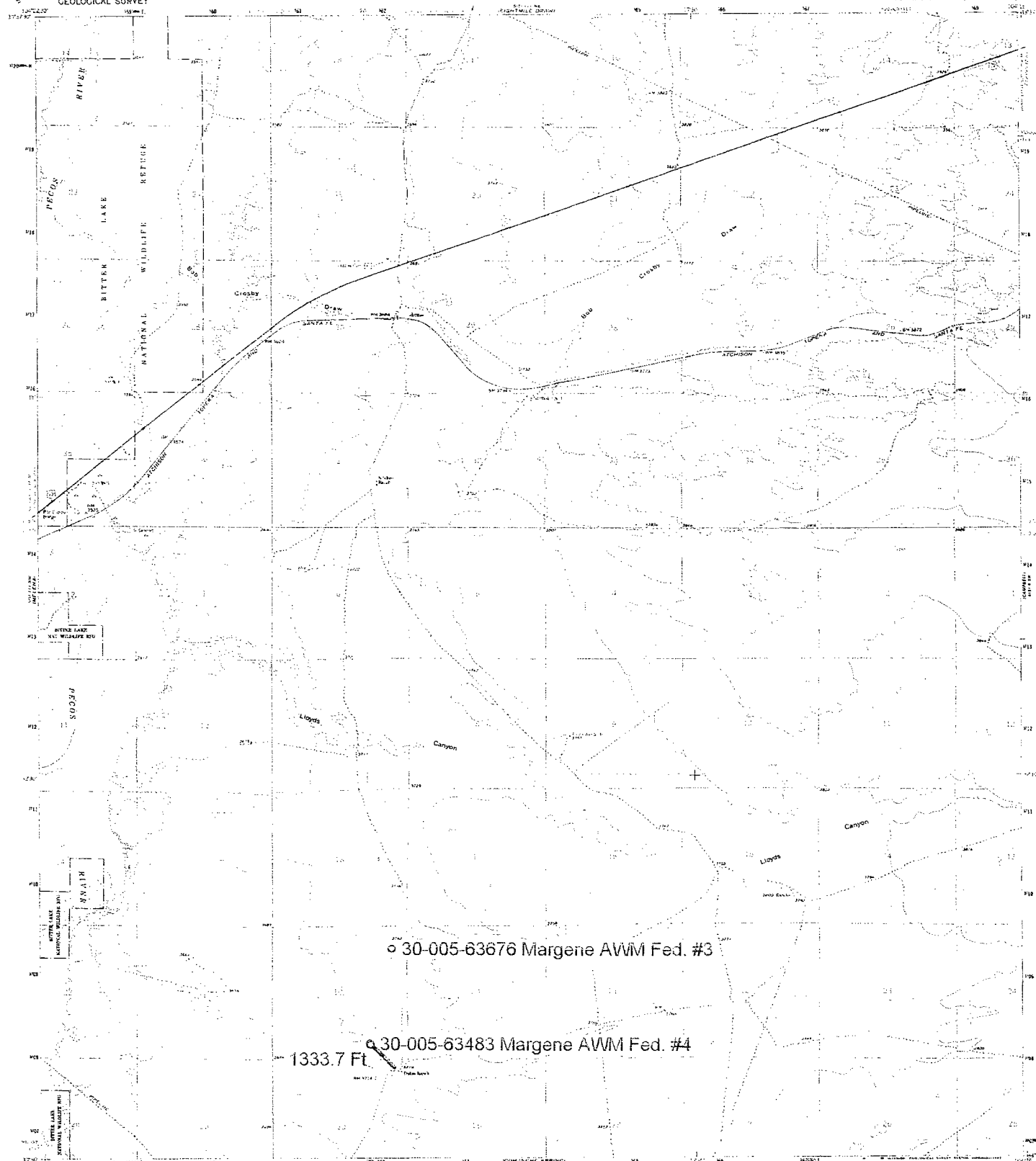

Mapped, edited, and published by the Geological Survey  
Control by USGS and NOAA  
Topography by photogrammetric methods from aerial  
photographs taken 1961. Field checked 1962  
Horizontal projection: 10,000-foot grid ticks based on the  
Mexican coordinate system, east zone 1000 meter  
Universal Transverse Mercator and ticks, zone 13,  
shown in blue. 1927 North American Datum. To place  
on the projected North American Datum 1983 move it a  
projection error of meters south and 48 meters east  
as shown by dashed corner ticks.  
Five red dashed lines indicate selected fence lines.  
There may be minute variations within the boundaries of  
the National or State boundaries shown on this map.

SCALE 1:250,000  
NATIONAL GEODETIC DATUM OF 1929  
THIS MAP COMPLY WITH NATIONAL MAP ACCURACY STANDARDS  
FOR SALE BY U.S. GEOLOGICAL SURVEY, DENVER, COLORADO 80275, OR RESTON, VIRGINIA 22092  
A FOLDER DESCRIBING TOPOGRAPHIC MAPS AND SYMBOLS IS AVAILABLE ON REQUEST

ROAD CLASSIFICATION  
Heavy duty  
Light duty  
Unimproved dirt  
U.S. Route  
ACME, N. MEX.  
N6133-102417-2-3  
1962  
USA 5121 (U.S. MAPS) PAN.

30-005-63481 Dallas AUE St. #5

30-005-63618 Quiniela "AXQ" State #3