

UNITED STATES
DEPARTMENT OF THE INTERIOR
BUREAU OF LAND MANAGEMENTFORM APPROVED
OMB NO. 1004-0135
Expires: July 31, 2010**SUNDRY NOTICES AND REPORTS ON WELLS**
*Do not use this form for proposals to drill or to re-enter an abandoned well. Use form 3160-3 (APD) for such proposals.*5. Lease Serial No.
NMNM103872

6. If Indian, Allottee or Tribe Name

7. If Unit or CA/Agreement, Name and/or No.

SUBMIT IN TRIPLICATE - Other instructions on reverse side.8. Well Name and No.
IMPALA 18 FED COM 1 H9. API Well No.
30-015-3686510. Field and Pool, or Exploratory
CROW FLATS, ABO11. County or Parish, and State
EDDY COUNTY COUNTY, NM

1. Type of Well

☒ Oil Well ☐ Gas Well ☐ Other

2. Name of Operator

COG OPERATING LLC

Contact: KELLY J HOLLY

E-Mail: kholly@conchoresources.com

3a. Address

550 W TEXAS SUITE 1300
MIDLAND, TX 79701

3b. Phone No. (include area code)

Ph: 432-685-4384

4. Location of Well (Footage, Sec., T., R., M., or Survey Description)

Sec 18 T16S R28E 430FSL 430FWL

12. CHECK APPROPRIATE BOX(ES) TO INDICATE NATURE OF NOTICE, REPORT, OR OTHER DATA

TYPE OF SUBMISSION	TYPE OF ACTION			
<input checked="" type="checkbox"/> Notice of Intent	<input type="checkbox"/> Acidize	<input type="checkbox"/> Deepen	<input type="checkbox"/> Production (Start/Resume)	<input type="checkbox"/> Water Shut-Off
<input type="checkbox"/> Subsequent Report	<input type="checkbox"/> Alter Casing	<input type="checkbox"/> Fracture Treat	<input type="checkbox"/> Reclamation	<input type="checkbox"/> Well Integrity
<input type="checkbox"/> Final Abandonment Notice	<input type="checkbox"/> Casing Repair	<input type="checkbox"/> New Construction	<input type="checkbox"/> Recomplete	<input checked="" type="checkbox"/> Other
	<input type="checkbox"/> Change Plans	<input type="checkbox"/> Plug and Abandon	<input type="checkbox"/> Temporarily Abandon	
	<input type="checkbox"/> Convert to Injection	<input type="checkbox"/> Plug Back	<input type="checkbox"/> Water Disposal	

13. Describe Proposed or Completed Operation (clearly state all pertinent details, including estimated starting date of any proposed work and approximate duration thereof. If the proposal is to deepen directionally or recompleat horizontally, give subsurface locations and measured and true vertical depths of all pertinent markers and zones. Attach the Bond under which the work will be performed or provide the Bond No. on file with BLM/BIA. Required subsequent reports shall be filed within 30 days following completion of the involved operations. If the operation results in a multiple completion or recompletion in a new interval, a Form 3160-4 shall be filed once testing has been completed. Final Abandonment Notices shall be filed only after all requirements, including reclamation, have been completed, and the operator has determined that the site is ready for final inspection.)

COG Operating respectfully requests a two year extension of this APD scheduled to expire 12-19-2010.

See revised plans in Attached Figures 1-4. TEN 9/26/11

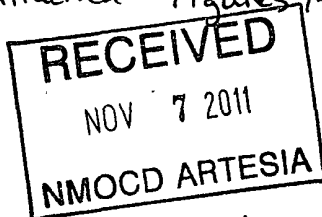
APPROVED FOR 24 MONTH PERIOD
ENDING 12/19/12

EA-09-197

Engineering Review Complete 2/15/11 JH

14. I hereby certify that the foregoing is true and correct.

Electronic Submission #98632 verified by the BLM Well Information System
For COG OPERATING LLC, sent to the Carlsbad

Accepted for record

NMOCD
DEC 02 2011

Name (Printed/Typed) KELLY J HOLLY

Title PERMITTING TECH

Signature (Electronic Submission)

Date 12/06/2010

THIS SPACE FOR FEDERAL OR STATE OFFICE USE

Approved By

Title

SEAS

Date

11-1-11

Conditions of approval, if any, are attached. Approval of this notice does not warrant or certify that the applicant holds legal or equitable title to those rights in the subject lease which would entitle the applicant to conduct operations thereon.

Office

CARLSBAD FIELD OFFICE

Title 18 U.S.C. Section 1001 and Title 43 U.S.C. Section 1212, make it a crime for any person knowingly and willfully to make to any department or agency of the United States any false, fictitious or fraudulent statements or representations as to any matter within its jurisdiction.

** OPERATOR-SUBMITTED ** OPERATOR-SUBMITTED ** OPERATOR-SUBMITTED **

dm

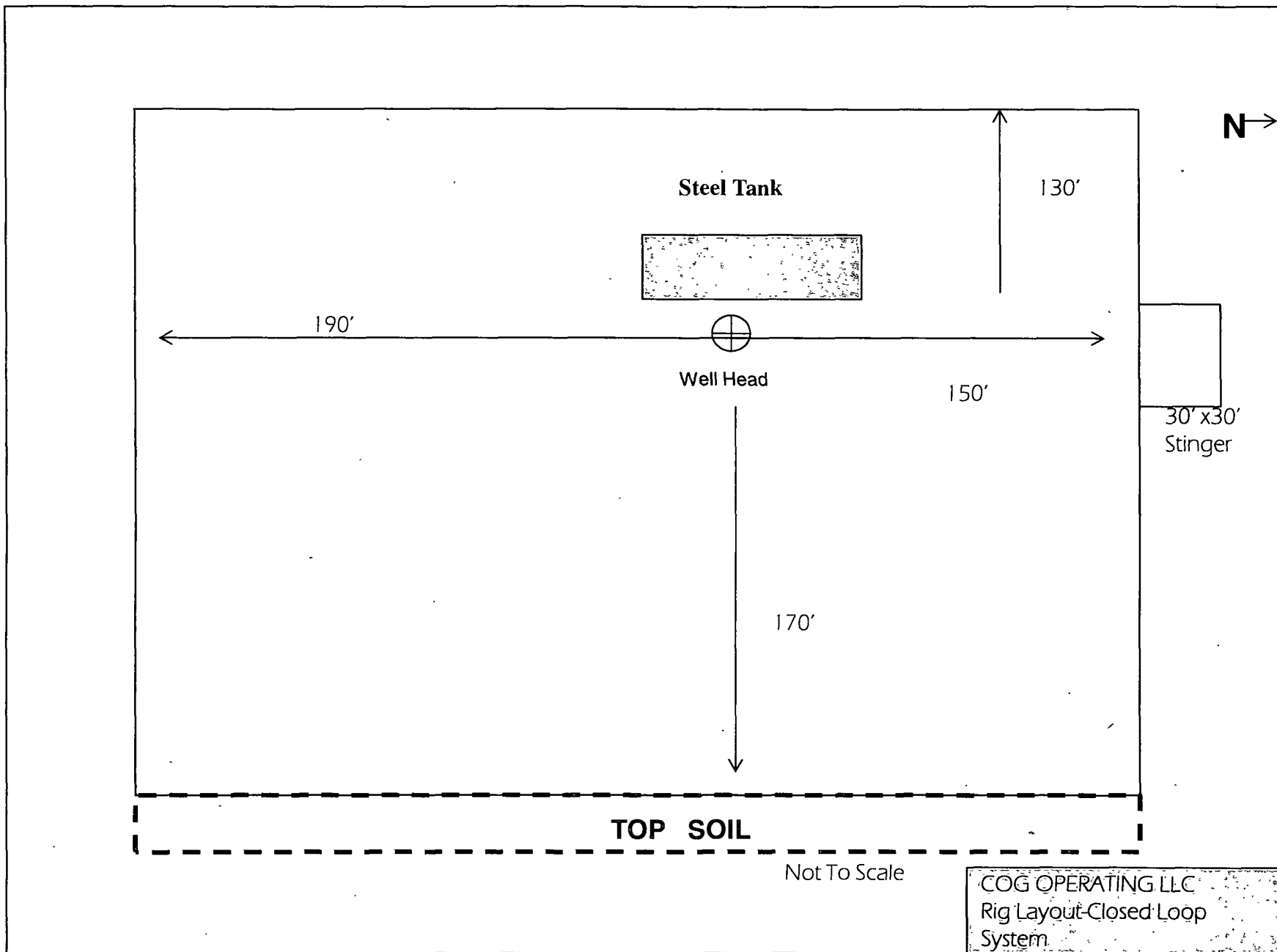

Figure.1

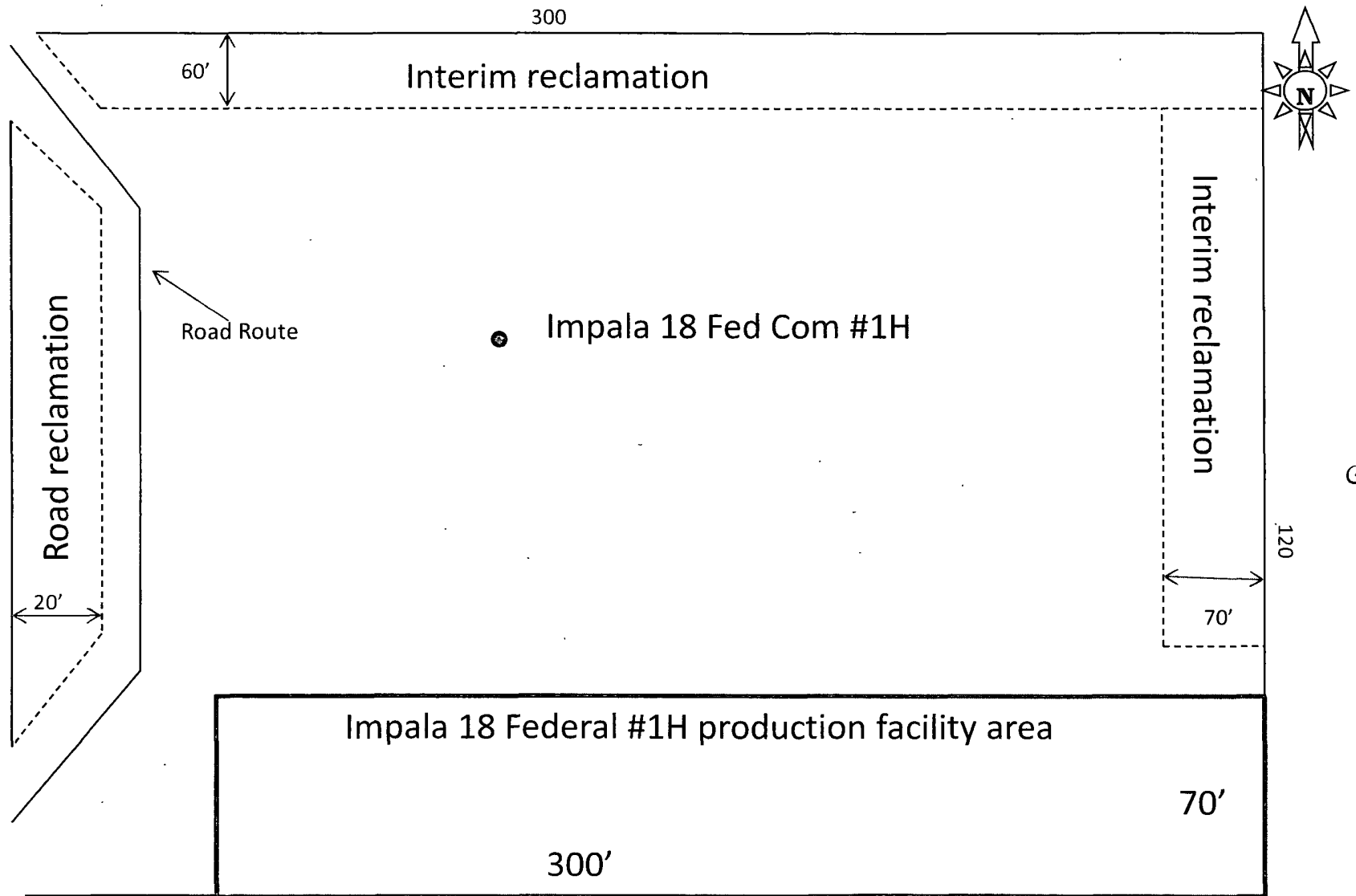

Figure 2

COG OPERATING LLC

550 W. Texas Ave Ste 100 Midland, Texas 79701
(432)-683-7443

Impala 18 Federal Tank Battery

400' FSL, 430' FWL * Sec 18-T16S-R28E
Eddy CO, NM

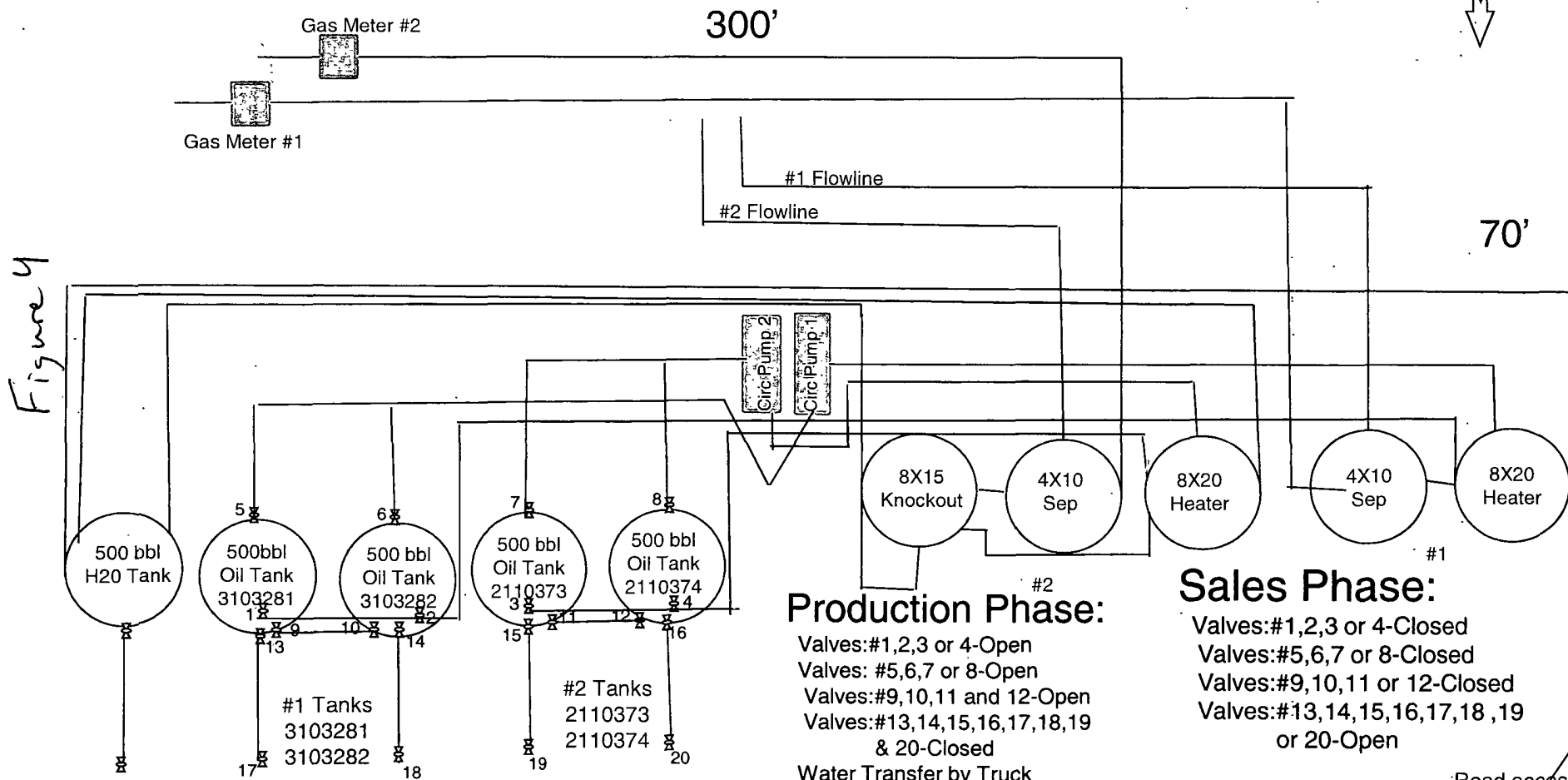

•Battery pad will be approx. 70' x 300'

•Battery will be located on the Impala 18 Fed Com #1H well pad.

•No interim reclamation on battery pad until production or foreseeable production ceases. Reclamation standards will follow Section 10 B from the Surface Use Plan from the Trigg well attached.

Production Phase:

Valves: #1, 2, 3 or 4-Open
Valves: #5, 6, 7 or 8-Open
Valves: #9, 10, 11 and 12-Open
Valves: #13, 14, 15, 16, 17, 18, 19 & 20-Closed

Water Transfer by Truck

Sales Phase:

Valves: #1, 2, 3 or 4-Closed
Valves: #5, 6, 7 or 8-Closed
Valves: #9, 10, 11 or 12-Closed
Valves: #13, 14, 15, 16, 17, 18, 19 or 20-Open

•Road access will be in the Northwest and Southwest corners of the battery as indicated on this map.

Road access

PECOS DISTRICT CONDITIONS OF APPROVAL

OPERATOR'S NAME:	COG OPERATING
LEASE NO.:	NM103871
WELL NAME & NO.:	1-IMPALA 18 FED COM
SURFACE HOLE FOOTAGE:	0430' FSL & 0430' FWL
BOTTOM HOLE FOOTAGE:	0330' FSL & 0330' FEL
LOCATION:	Section 18, T. 16 S., R. 28 E., NMPM
COUNTY:	Eddy County, New Mexico

TABLE OF CONTENTS

Standard Conditions of Approval (COA) apply to this APD. If any deviations to these standards exist or special COAs are required, the section with the deviation or requirement will be checked below.

The previously approved Conditions of Approval for the approved APD still apply. Any additions to the originally approved COAs will be addressed below.

☒ **Special Requirements**

Communitization Agreement

☒ **Drilling**

H2S Requirements per Onshore Order # 6

Logging Requirements

Karst COAs

Roswell Water Basin

Waste Material and Fluids

I. SPECIAL REQUIREMENT(S)

Communitization Agreement

A Communitization Agreement covering the acreage dedicated to this well must be filed for approval with the BLM. The effective date of the agreement shall be prior to any sales.

II. DRILLING

A. DRILLING OPERATIONS REQUIREMENTS

The BLM is to be notified a minimum of 4 hours in advance for a representative to witness:

- a. Spudding well
- b. Setting and/or Cementing of all casing strings
- c. BOPE tests

☒ **Eddy County**

Call the Carlsbad Field Office, 620 East Greene St., Carlsbad, NM 88220,
(575) 361-2822

1. **Although Hydrogen Sulfide has not been reported in this section, it is always a potential hazard. If Hydrogen Sulfide is encountered, please report measured amounts and formations to the BLM.**
2. Unless the production casing has been run and cemented or the well has been properly plugged, the drilling rig shall not be removed from over the hole without prior approval. **If the drilling rig is removed without approval – an Incident of Non-Compliance will be written and will be a “Major” violation.**
3. Floor controls are required for 3M or Greater systems. These controls will be on the rig floor, unobstructed, readily accessible to the driller and will be operational at all times during drilling and/or completion activities. Rig floor is defined as the area immediately around the rotary table; the area immediately above the substructure on

which the draw works are located, this does not include the dog house or stairway area.

4. **The record of the drilling rate along with the GR/N well log run from TD to surface (horizontal well – vertical portion of hole) shall be submitted to the BLM office as well as all other logs run on the borehole 30 days from completion. If available, a digital copy of the logs is to be submitted in addition to the paper copies. The Rustler top and top and bottom of Salt are to be recorded on the Completion Report.**

B. CASING

Changes to the approved APD casing and cement program require submitting a sundry and receiving approval prior to work. Failure to obtain approval prior to work will result in an Incident of Non-Compliance being issued.

Centralizers required on surface casing per Onshore Order 2.III.B.1.f.

Wait on cement (WOC) time prior to drilling out for a primary cement job will be a minimum 18 hours for a water basin, 24 hours in the potash area, or 500 pounds compressive strength, whichever is greater for all casing strings. DURING THIS WOC TIME, NO DRILL PIPE, ETC. SHALL BE RUN IN THE HOLE. Provide compressive strengths including hours to reach required 500 pounds compressive strength prior to cementing each casing string. See individual casing strings for details regarding lead cement slurry requirements.

No pea gravel permitted for remedial or fall back remedial without prior authorization from the BLM engineer.

Medium cave/Karst area

Possible lost circulation in the Grayburg and San Andres Formations.

High pressure gas bursts possible within the Wolfcamp Formation – applies to the pilot hole.

1. **The 13 3/8 inch surface casing shall be set at approximately 500 feet in the Tansill Formation and cemented to the surface.**
 - a. **If cement does not circulate to the surface, the appropriate BLM office shall be notified and a temperature survey utilizing an electronic type temperature survey with surface log readout will be used or a cement bond log shall be run to verify the top of the cement. Temperature survey will be run a minimum of six hours after pumping cement and ideally between 8-10 hours after completing the cement job.**
 - b. **Wait on cement (WOC) time for a primary cement job is to include the lead cement slurry.**

- c. Wait on cement (WOC) time for a remedial job will be a minimum of 4 hours after bringing cement to surface or 500 pounds compressive strength, whichever is greater.
 - d. If cement falls back, remedial cementing will be done prior to drilling out that string.
2. The minimum required fill of cement behind the **9 5/8** inch intermediate casing is:
- ☒ Cement to surface. If cement does not circulate see B.1.a, c-d above. **Wait on cement (WOC) time for a primary cement job is to include the lead cement slurry due to cave/karst concerns.**

If 75% or greater lost circulation occurs while drilling the intermediate casing hole, the cement on the production casing must come to surface with the wait on cement times for a primary cement job to include the lead cement slurry due to cave/karst concerns.

3. The minimum required fill of cement behind the **7** inch production casing is:
- ☒ Cement should tie-back at least 200 feet into previous casing string. Operator shall provide method of verification.

A plug is required at the bottom of the pilot hole – plug to be a minimum of 170' in length. Plug is to be tagged. Recommend that the operator consider placing plug from the bottom of the hole to the kick- off point, which will eliminate the need for the tag on the bottom.

4. The minimum required fill of cement behind the **4 1/2** inch production liner is:
- ☒ No cement will be required – using packer system. No seal test is required as the liner is entirely in the Abo Formation. Liner tie-back of 100' approved.
5. If hardband drill pipe is rotated inside casing, returns will be monitored for metal. If metal is found in samples, drill pipe will be pulled and rubber protectors which have a larger diameter than the tool joints of the drill pipe will be installed prior to continuing drilling operations.

C. PRESSURE CONTROL

1. All blowout preventer (BOP) and related equipment (BOPE) shall comply with well control requirements as described in Onshore Oil and Gas Order No. 2 and API RP 53 Sec. 17.

2. Minimum working pressure of the blowout preventer (BOP) and related equipment (BOPE) required for drilling below the surface casing shoe shall be **2000 (2M) psi**.
 - a. **For surface casing only:** If the BOP/BOPE is to be tested against casing, the wait on cement (WOC) time for that casing is to be met (see WOC statement at start of casing section). Independent service company required.
3. Minimum working pressure of the blowout preventer (BOP) and related equipment (BOPE) required for drilling below the **9 5/8"** intermediate casing shoe shall be **3000 (3M) psi**.
4. The appropriate BLM office shall be notified a minimum of 4 hours in advance for a representative to witness the tests.
 - a. In a water basin, for all casing strings utilizing slips, these are to be set as soon as the crew and rig are ready and any fallback cement remediation has been done. The casing cut-off and BOP installation can be initiated four hours after installing the slips, which will be approximately six hours after bumping the plug. For those casing strings not using slips or where the float does not hold, the minimum wait time before cut-off is eight hours after bumping the plug or when the cement reaches 500 psi compressive strength (including lead when specified), whichever is greater. BOP/BOPE testing can begin after the above conditions are satisfied.
 - b. The tests shall be done by an independent service company utilizing a test plug **not a cup or J-packer**. The operator also has the option of utilizing an independent tester to test without a plug (i.e. against the casing) pursuant to Onshore Order 2 with the pressure not to exceed 70% of the burst rating for the casing. Any test against the casing must meet the WOC time for water basin (18 hours) or potash (24 hours) or 500 pounds compressive strength, whichever is greater, prior to initiating the test (see casing segment as lead cement may be critical item).
 - c. The results of the test shall be reported to the appropriate BLM office.
 - d. All tests are required to be recorded on a calibrated test chart. **A copy of the BOP/BOPE test chart and a copy of independent service company test will be submitted to the appropriate BLM office.**

- e. The BOP/BOPE test shall include a low pressure test from 250 to 300 psi. The test will be held for a minimum of 10 minutes if test is done with a test plug and 30 minutes without a test plug.
- f. BOP/BOPE must be tested by an independent service company within 500 feet of the top of the **Wolfcamp** Formation if the time between the setting of the intermediate casing and reaching this depth exceeds 20 days. This test does not exclude the test prior to drilling out the casing shoe as per Onshore Order No. 2. **Applies to the pilot hole.**
- g. **Effective November 1, 2008, no variances will be granted on reduced pressure tests on the surface casing and BOP/BOPE. Onshore Order 2 requirements will be in effect.**

D. DRILLING MUD

Mud system monitoring equipment, with derrick floor indicators and visual and audio alarms, shall be operating before drilling into the **Wolfcamp** Formation, and shall be used until production casing is run and cemented.

E. DRILL STEM TEST

If drill stem tests are performed, Onshore Order 2.III.D shall be followed.

F. WASTE MATERIAL AND FLUIDS

All waste (i.e. drilling fluids, trash, salts, chemicals, sewage, gray water, etc.) created as a result of drilling operations and completion operations shall be safely contained and disposed of properly at a waste disposal facility. No waste material or fluid shall be disposed of on the well location or surrounding area.

Porto-johns and trash containers will be on-location during fracturing operations or any other crew-intensive operations.

JAL 021611