

Submit 3 Copies To Appropriate District  
Office  
District I  
1625 N. French Dr., Hobbs, NM 88240  
District II  
1301 W. Grand Ave., Artesia, NM 88210  
District III  
1000 Rio Brazos Rd., Aztec, NM 87410  
District IV  
1220 S. St. Francis Dr., Santa Fe, NM  
87505

State of New Mexico  
Energy, Minerals and Natural Resources

Form C-103

June 19, 2008

OIL CONSERVATION DIVISION  
1220 South St. Francis Dr.  
Santa Fe, NM 87505

WELL API NO. 30-015-31018
5. Indicate Type of Lease STATE <input checked="" type="checkbox"/> FEE <input type="checkbox"/>
6. State Oil & Gas Lease No.
7. Lease Name or Unit Agreement Name Imperial State
8. Well Number 3
9. OGRID Number 229137
10. Pool name or Wildcat Loco Hills; Glorieta Yeso

SUNDRY NOTICES AND REPORTS ON WELLS  
(DO NOT USE THIS FORM FOR PROPOSALS TO DRILL OR TO DEEPEN OR PLUG BACK TO A  
DIFFERENT RESERVOIR. USE "APPLICATION FOR PERMIT" (FORM C-101) FOR SUCH  
PROPOSALS.)

1. Type of Well: Oil Well ☒ Gas Well ☐ Other

2. Name of Operator

COG Operating LLC

3. Address of Operator

550 W. Texas Ave., Suite 100 Midland, TX 79701

4. Well Location

Unit Letter J : 1775 feet from the South line and 1650 feet from the East line  
Section 16 Township 17S Range 30E NMPM Eddy County

11. Elevation (Show whether DR, RKB, RT, GR, etc.)  
3675' GR

12. Check Appropriate Box to Indicate Nature of Notice, Report or Other Data

NOTICE OF INTENTION TO:

PERFORM REMEDIAL WORK ☐ PLUG AND ABANDON ☐  
TEMPORARILY ABANDON ☐ CHANGE PLANS ☐  
PULL OR ALTER CASING ☐ MULTIPLE COMPL ☐  
DOWNHOLE COMMINGLE ☐

SUBSEQUENT REPORT OF:

REMEDIAL WORK ☐ ALTERING CASING ☐  
COMMENCE DRILLING OPNS. ☐ P AND A ☐  
CASING/CEMENT JOB ☐

OTHER: Deepen ☒

OTHER: ☐

13. Describe proposed or completed operations. (Clearly state all pertinent details, and give pertinent dates, including estimated date of starting any proposed work). SEE RULE 1103. For Multiple Completions: Attach wellbore diagram of proposed completion or recompletion.

Please see the attached Deepening Procedure

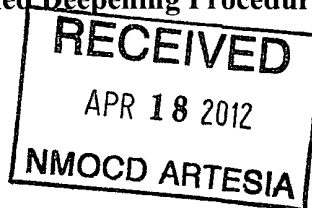

Spud Date:

Rig Release Date:

I hereby certify that the information above is true and complete to the best of my knowledge and belief.

SIGNATURE

TITLE

Lead Regulatory Analyst

DATE

04/16/2012

Type or print name

Kanicia Castillo

E-mail address:

kcastillo@concho.com

PHONE:

432-685-4332

For State Use Only

APPROVED BY:

TITLE

Geologist

DATE

4/19/2012

Conditions of Approval (if any):

## Imperial State #3

### Deepening Procedure

1. MIRU rig.
2. Sqz upper Yeso w/ +/-400sx of Class C neat. Drill out squeeze. Test squeeze to 500 psi for 20 minutes using chart recorder.
3. PU 4-3/4" bit and drill 4-3/4" from 4950' to 6000'.
4. POOH w/ bit and drillstring.
5. RIH w/ logs and log from TD to 4900'.
6. RIH w/ 4", 11.3# casing. See next attachment for general centralizer program.
7. Cement casing from TD to 4750' w/ 115 sxs Class C cmt. Drop plug and open DV tool. Circ cmt off DV tool. Drop plug to close DV tool.
8. PU workstring and RIH and drill out DV tool. POOH and LD workstring.
9. RDMO rig.

### Completion Procedure

1. MIRU rig.
2. RIH/ w/ perforating guns and perforate Yeso from 5800 – 5600 w/ 1 spf, 28 holes.
3. Acidize w/ 2500 gals of 15% HCl. Frac zone w/ 179,800 # of sand. Set plug at 5550'.
4. RIH w/ perforating guns and perforate Yeso from 5500' – 5300'.
5. Acidize w/ 2500 gals of 15% HCl. Frac zone w/ 179,800 # of sand. Set plug at 5350'.
6. RIH w/ perforating guns and perforate Yeso from 5200' – 5000'.
7. Acidize w/ 2500 gals of 15% HCl. Frac zone w/ 179,800 # of sand.
8. RIH and drill out plug at 5350' and 5550'.
9. RIH and cut or back off 4" casing at 4750'. POOH w/ 4" casing. Leave 4" liner from 4750' to 6000' (TD).
10. RIH w/ tbg and locate end of tbg at 4700'.
11. RIH w/ rods and pump.
12. RDMO rig.

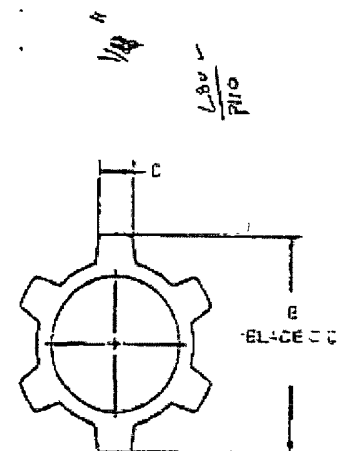
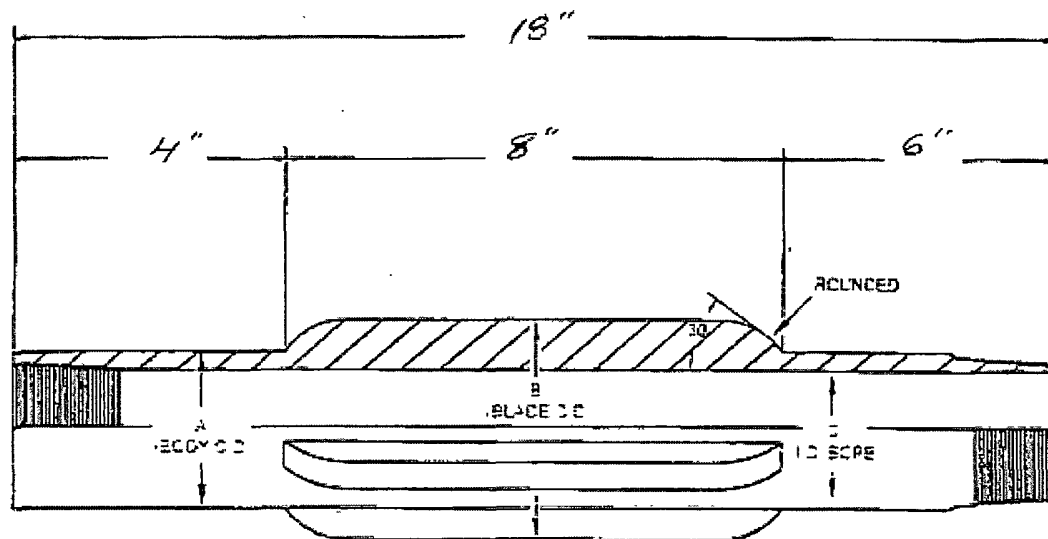

$\pm 0.00$   
 $\pm 0.00$   
 $\pm 0.00$   
 $\pm 0.00$

SIZE	A	B	C	D	E	F	G	DRIFT
4" x 4 3/4" 116"	4.050	4.750	3.347	3/4"				3.303"

 <b>RAY OIL TOOL CO.</b>	
CENTRALIZED INTERCASING	
CLIENT	CONCHO RES
WELL NAME & NO	
CASING	4" P145 116"
MATERIAL	4 3/4 x 3 1/4 x 18" Q105