

DISTRICT I  
1625 N. French Dr., Hobbs, NM 88240

DISTRICT II  
1301 W. Grand Avenue, Artesia, NM 88210

DISTRICT III  
1000 Rio Brazos Rd., Aztec, NM 87410

DISTRICT IV  
1220 S. St. Francis Dr., Santa Fe, NM 87505

RECEIVED

JAN 08 2013

OIL  
NMOGD ARTESIA

State of New Mexico  
Energy, Minerals and Natural Resources Department

Form C-102  
Revised July 18, 2010

Submit one copy to appropriate  
District Office

CONSERVATION DIVISION  
1220 South St. Francis Dr.  
Santa Fe, New Mexico 87505

WELL LOCATION AND ACREAGE DEDICATION PLAT

☐ AMENDED REPORT

API Number	Pool Code	Pool Name
30-015-39795	5690	Big Sinks; Delaware
Property Code	Property Name	Well Number
306402	POKER LAKE UNIT	420H
OGRID No.	Operator Name	Elevation
260737	BOPCO, L.P.	3339'

Surface Location

UL or lot No.	Section	Township	Range	Lot Idn	Feet from the	North/South line	Feet from the	East/West line	County
P	28	25 S	31 E		700	SOUTH	1300	EAST	EDDY

Bottom Hole Location If Different From Surface

UL or lot No.	Section	Township	Range	Lot Idn	Feet from the	North/South line	Feet from the	East/West line	County
A	29	25 S	31 E		382	NORTH	137	EAST	EDDY

Dedicated Acres	Joint or Infill	Consolidation Code	Order No.
320			

NO ALLOWABLE WILL BE ASSIGNED TO THIS COMPLETION UNTIL ALL INTERESTS HAVE BEEN CONSOLIDATED  
OR A NON-STANDARD UNIT HAS BEEN APPROVED BY THE DIVISION

BOTTOM  
HOLE LOCATION  
Lat - N 32°06'26.27"  
Long - W 103°47'30.07"  
NMSPC- N 403212.98  
E 667712.74  
(NAD-27)

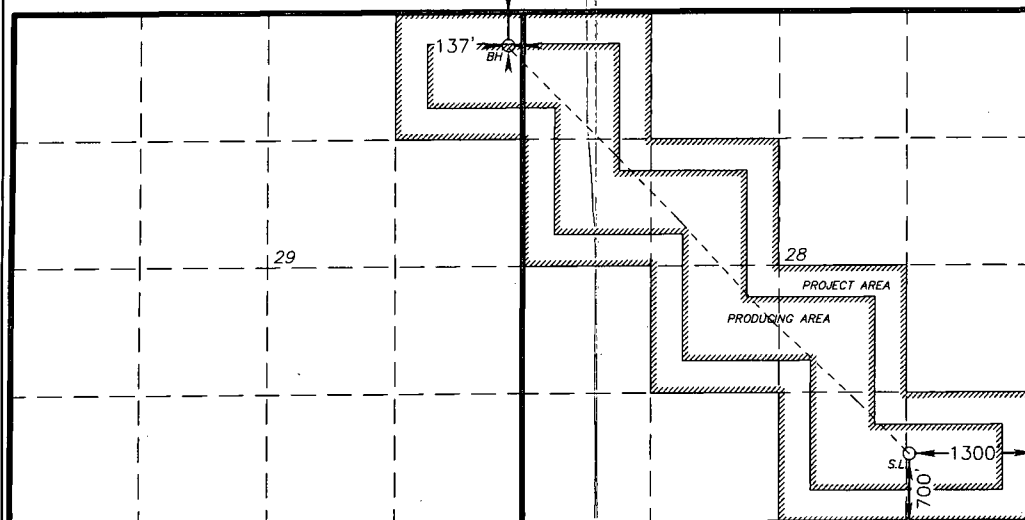

SURFACE LOCATION  
DELAWARE PT  
Lat - N 32°05'44.80"  
Long - W 103°46'41.95"  
NMSPC- N 399009.989  
E 671873.455  
(NAD-27)

OPERATOR CERTIFICATION

I hereby certify that the information contained herein is true and complete to the best of my knowledge and belief, and that this organization either owns a working interest or unleased mineral interest in the land including the proposed bottom hole location or has a right to drill this well at this location pursuant to a contract with an owner of such a mineral or working interest, or to a voluntary pooling agreement or a compulsory pooling order heretofore entered by the division.

*Martyn Robertson* 12/19/12  
Signature Date

Martyn Robertson  
Printed Name  
msrobertson@busspet.com  
Email Address

SURVEYOR CERTIFICATION

I hereby certify that the well location shown on this plat was plotted from field notes of actual surveys made by me or under my supervision, and that the same is true and correct to the best of my belief.

SEP 11 11 2011  
Date Surveyed  
Signature & Seal of Professional Surveyor  
GARY L. JONES  
7977

Certificate No. Gary L. Jones 7977

BASIN SURVEYS 25294