

District I
1625 N. French Dr., Hobbs, NM 88240
Phone: (575) 393-6161 Fax: (575) 393-0720

District II
811 S. First St., Artesia, NM 88210
Phone: (575) 748-1283 Fax: (575) 748-9720

District III
1000 Rio Brazos Road, Aztec, NM 87410
Phone: (505) 334-6178 Fax: (505) 334-6170

District IV
1220 S. St. Francis Dr., Santa Fe, NM 87505
Phone: (505) 476-3460 Fax: (505) 476-3462

State of New Mexico

Form C-101
Revised July 18, 2013

Energy Minerals and Natural Resources

Oil Conservation Division

1220 South St. Francis Dr.

Santa Fe, NM 87505

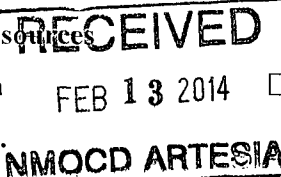

☐ AMENDED REPORT

APPLICATION FOR PERMIT TO DRILL, RE-ENTER, DEEPEN, PLUGBACK, OR ADD A ZONE

1. Operator Name and Address Fasken Oil and Ranch, Ltd. 6101 Holiday Hill Road, Midland, TX 79707		2. OGRID Number 151416
4. Property Code 40391	3. Property Name Klingensmith Fee	5. APL Number 30-015-42069
		6. Well No. 2H

7. Surface Location

UL - Lot	Section	Township	Range	Lot Idn	Feet from	N/S Line	Feet From	E/W Line	County
H	24	20S	24E		2190	North	200	East	Eddy

8. Proposed Bottom Hole Location

UL - Lot	Section	Township	Range	Lot Idn	Feet from	N/S Line	Feet From	E/W Line	County
E	24	20S	24E		2310	North	330	West	Eddy

9. Pool Information

Pool Name N. Seven Rivers; Glorieta-Yeso	Pool Code 97565
---	--------------------

Additional Well Information

11. Work Type N	12. Well Type O	13. Cable/Rotary R	14. Lease Type S	15. Ground Level Elevation 3576' GR
16. Multiple No	17. Proposed Depth 7394' MD; 2650' TVD	18. Formation Glorieta-Yeso	19. Contractor TBD	20. Spud Date 4-1-2014
Depth to Ground water		Distance from nearest fresh water well		Distance to nearest surface water

☒ We will be using a closed-loop system in lieu of lined pits

21. Proposed Casing and Cement Program

Type	Hole Size	Casing Size	Casing Weight/ft	Setting Depth	Sacks of Cement	Estimated TOC
Surface	12 1/4"	9 5/8"	36	800'	600 sx "C"	Surface
Inter.	8 3/4"	7"	26	3050'	500 sx "C"	Surface
Prod. Liner	6 1/8"	4 1/2"	11.60	2850'-7400'	None	N/A

Casing/Cement Program: Additional Comments

Will utilize the packer and port system for the 4 1/2" liner, no cement will be required. Will tie into 7" csg. @ 2850'.
--

22. Proposed Blowout Prevention Program

Type	Working Pressure	Test Pressure	Manufacturer
Annular / Doubleram	3000 / 3000	1500 / 1500	Schaffer / Schaffer

23. I hereby certify that the information given above is true and complete to the best of my knowledge and belief. I further certify that I have complied with 19.15.14.9 (A) NMAC <input type="checkbox"/> and/or 19.15.14.9 (B) NMAC <input type="checkbox"/> , if applicable. Signature: <i>Kim Tyson</i>		OIL CONSERVATION DIVISION	
Printed name: Kim Tyson		Approved By: <i>T. C. Shepard</i>	
Title: Regulatory Analyst		Title: "Geologist"	
E-mail Address: kimt@forl.com		Approved Date: 2-13-2014 Expiration Date: 2-13-2015	
Date: 2-11-2014	Phone: 432-687-1777	Conditions of Approval Attached	

DISTRICT I
1625 N. French Dr., Hobbs, NM 88240
Phone (575) 393-6161 Fax: (575) 393-0720

DISTRICT II
811 S. First St., Artesia, NM 88210
Phone (575) 746-1283 Fax: (575) 746-0720

DISTRICT III
1000 Rio Brazos Rd., Aztec, NM 87410
Phone (505) 334-6178 Fax: (505) 334-6170

DISTRICT IV
1220 S. St. Francis Dr., Santa Fe, NM 87505
Phone (505) 476-3460 Fax: (505) 476-3462

State of New Mexico
Energy, Minerals and Natural Resources Department

Form C-102
Revised August 1, 2011

Submit one copy to appropriate
District Office

OIL CONSERVATION DIVISION
1220 South St. Francis Dr.
Santa Fe, New Mexico 87505

WELL LOCATION AND ACREAGE DEDICATION PLAT

☐ AMENDED REPORT

API Number 30-015-42069	Pool Code 97565	Pool Name N. Seven Rivers; Glorieta-Yeso
Property Code 40391	Property Name KLINGENSMITH FEE	Well Number 2H
OGRID No. 151416	Operator Name FASKEN OIL AND RANCH	Elevation 3576'

Surface Location

UL or lot No.	Section	Township	Range	Lot Idn	Feet from the	North/South line	Feet from the	East/West line	County
H	24	20 S	24 E		2190	NORTH	200	EAST	EDDY

Bottom Hole Location If Different From Surface

UL or lot No.	Section	Township	Range	Lot Idn	Feet from the	North/South line	Feet from the	East/West line	County
E	24	20 S	24 E		2310	NORTH	330	WEST	EDDY

Dedicated Acres	Joint or Infill	Consolidation Code	Order No.
160			

NO ALLOWABLE WILL BE ASSIGNED TO THIS COMPLETION UNTIL ALL INTERESTS HAVE BEEN CONSOLIDATED
OR A NON-STANDARD UNIT HAS BEEN APPROVED BY THE DIVISION

<p>N.: 569492.1 E.: 474471.9 NAD 83</p> <p>2310'</p> <p>B.H.</p> <p>330'</p> <p>N.: 567232.0 E.: 474416.2 NAD 83</p> <p>PROPOSED BOTTOM HOLE LOCATION Lat - N 32°33'36.49" Long - W 104°32'58.03" NMSPCE- N 567576.0 E 474753.4 (NAD-83)</p> <p>N.: 564590.1 E.: 474439.4 NAD 83</p>	<p>N.: 569881.2 E.: 477134.5 NAD 83</p> <p>2190'</p> <p>Penetration Point</p> <p>3582.3'</p> <p>3571.4'</p> <p>200'</p> <p>S.L.</p> <p>3575.4'</p> <p>3583.0'</p> <p>SURFACE LOCATION Lat - N 32°33'37.10" Long - W 104°32'00.53" NMSPCE- N 567627.5 E 479674.3 (NAD-83)</p> <p>N.: 567133.3 E.: 479877.3 NAD 83</p> <p>N.: 564518.7 E.: 477162.1 NAD 83</p>	<p>N.: 569813.0 E.: 479860.6 NAD 83</p> <p>2190'</p> <p>OPERATOR CERTIFICATION I hereby certify that the information contained herein is true and complete to the best of my knowledge and belief, and that this organization either owns a working interest or unleased mineral interest in the land including the proposed bottom hole location or has a right to drill this well at this location pursuant to a contract with an owner of such a mineral or working interest, or to a voluntary pooling agreement or a compulsory pooling order heretofore entered by the division.</p> <p><i>Kim Tyson</i> 2-11-2014 Signature Date</p> <p>Kim Tyson Printed Name kimt@for1.com Email Address</p> <p>SURVEYOR CERTIFICATION I hereby certify that the well location shown on this plat was plotted from field notes of actual surveys made by me or under my supervision, and that the same is true and correct to the best of my belief.</p> <p>DECEMBER 1, 2013 Date Surveyed</p> <p><i>[Signature]</i> Signature & Seal of Professional Surveyor</p> <p>Certificate No. 7977 BASIN SURVEYS</p> <p>500' 1000' 1500' 2000' SCALE: 1" = 1000' WO Num.: 29861</p>
---	---	--

Penetration Piont - 3053' MD; 2715' TVD, 780' FEL & 2241' FNL

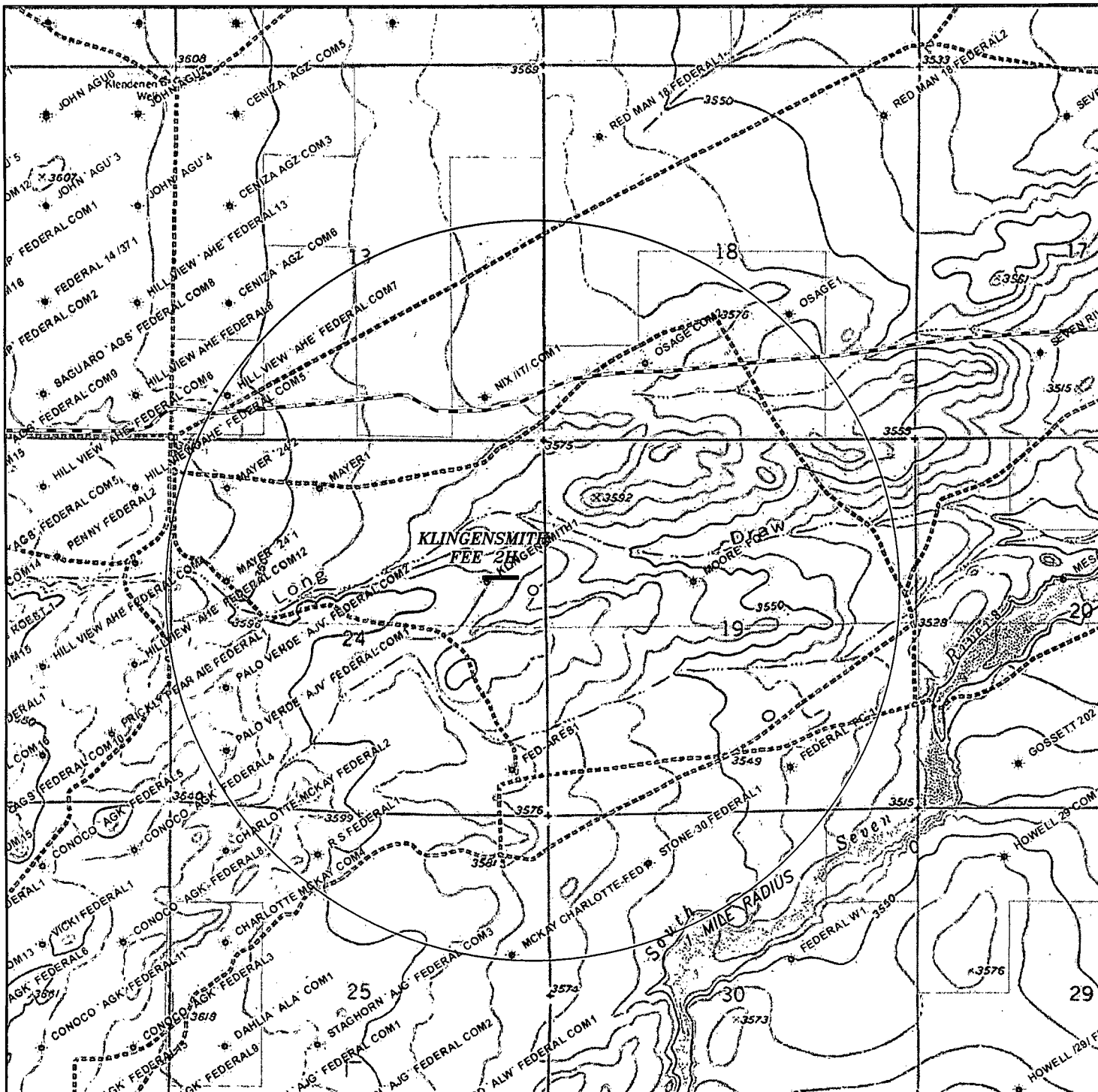

KLINGENSMITH FEE 2H

Located 2190' FNL and 200' FEL
Section 24, Township 20 South, Range 24 East,
N.M.P.M., Eddy County, New Mexico.

basin
surveys
focused on excellence
in the oilfield

P.O. Box 1786
1120 N. West County Rd.
Hobbs, New Mexico 88241
(575) 393-7316 - Office
(575) 392-2206 - Fax
basinsurveys.com

0' 1000' 2000' 3000' 4000'

SCALE: 1" = 2000'

W.O. Number: JMS 29861

Survey Date: 12-17-2013

YELLOW TINT - USA LAND
BLUE TINT - STATE LAND
NATURAL COLOR - FEE LAND

**FASKEN OIL
AND RANCH**

CONTINGENCY PLAN FOR HYDROGEN SULFIDE DISCHARGE
DRILLING OPERATIONS

Fasken Oil and Ranch, Ltd.

303 W. Wall Ave.

Suite 1800

Midland, TX 79701-5116

CONTINGENCY PLAN FOR HYDROGEN SULFIDE DISCHARGE

DRILLING OPERATIONS

- I. **HYDROGEN SULFIDE PHYSICAL PROPERTIES AND TOXICITY** - Hydrogen sulfide is extremely toxic and smells like rotten eggs in low volumes. The acceptable concentration for eight-hour exposure is 10 ppm, which is .001% by volume. Hydrogen sulfide is heavier than air (specific gravity - 1.187) and is colorless. It forms an explosive mixture with air between 4.3 and 46.0 volume percent. Toxicity data for hydrogen sulfide and various gasses are compared in the table below.

Common Name	Chemical Formula	Sp. Gravity (Air =1)	Threshold Limit	Hazardous Limit	Lethal Conc.
Hydrogen Cyanide	HCN	0.94	10 ppm	150 ppm	300 ppm
Hydrogen Sulfide	H ₂ S	1.18	10 ppm *	100 ppm/hr	500 ppm
Sulfur Dioxide	SO ₂	2.21	5 ppm	--	1000 ppm
Chlorine	Cl ₂	2.45	1 ppm	4 ppm/hr	1000 ppm
Carbon Monoxide	CO	0.97	50 ppm	400 ppm/hr	1000 ppm
Carbon Dioxide	CO ₂	1.52	5000 ppm	5%	10%
Methane	CH ₄	0.55	90,000 ppm	Combustible above 5% in air	---

*Threshold Limit - concentration at which it is believed that all workers may be repeatedly exposed day after day without adverse effects, 10 ppm = 1972 ACGIH concentration (American Conference of Governmental Industrial Hygienist) and Occupational Safety and Health Administration (OSHA).

- II. **PHYSICAL EFFECTS OF HYDROGEN SULFIDE** - The physiological effects of hydrogen sulfide are summarized in the table below.

<u>Percent Vol.</u>	<u>Concentration</u> ppm	<u>Physical Effects</u>
0.001	10	Obvious and unpleasant odor.
0.01	100	Kills smell in 3 to 15 minutes; may sting eyes and throat.
0.02	200	Kills smell shortly; stings eyes and throat.
0.05	500	Dizziness; breathing ceases in a few minutes; needs prompt artificial resuscitation.
0.07	700	Unconscious quickly; death will result if not rescued promptly.
0.10	1000	Unconscious at once; followed by death within minutes.

- III. **ACCIDENTAL RELEASE OF HYDROGEN SULFIDE** - The possible release of hydrogen sulfide gas could result from leakage at either wellhead, flow lines, separators or drill string at this drilling location.

- A. In the event of an accidental release, the tool pusher, supervisor or agent of the operator in the vicinity at the time of the discharge will be in charge of all activities on the ground and shall be responsible for the following.
1. Notify all personnel, Company or outside, that are in the area to evacuate as soon as possible. This includes drilling rig crews, roustabout gangs, supervisory personnel, maintenance personnel, sales representatives, farm or ranch hands, visitors and all others that may be in the vicinity.
 2. Notify the County Sheriff's office and the Department of Public Safety, and request their assistance to provide road blocks and direct traffic away from the drilling location. They should also be asked to assist in the evacuation of residents, if any, in affected area.
 3. Alert local Hospital and Fire Department in the event that medical services or ambulance assistance is needed.

4. Call the Drilling Manager in the Midland Office and advise him of the nature and extent of the emergency situation.
 - B. The Drilling Manager or his delegate will notify the appropriate state and federal agencies that the contingency plan has been activated and what level and type of reaction has already been initiated.
 - C. Fasken's Senior Representative or employee on the scene will be in charge and shall initiate measures necessary to bring the gas flow under control securing whatever additional personnel and equipment are necessary to control the flow in the shortest time thereby reducing potential exposure of the general public to hydrogen sulfide.
- IV. **WEATHER CONDITIONS** - Hydrogen sulfide collects in low lying areas during adverse weather conditions such as drizzle, rain, fog, calm winds and snow. These areas should be avoided. Any personnel in such areas should be evacuated and law enforcement personnel should be requested to keep people and traffic from entering. Should moderate winds be blowing hydrogen sulfide from the source of the discharge toward a populated area, residents and other personnel should be evacuated by law enforcement personnel who should then maintain an exclusion perimeter to avoid people from reentering the area until the emergency is over.
- V. **TERMINATION OF EMERGENCY AND FOLLOW-UP PROCEDURES** - Fasken's Senior Representative or employee on the scene, with the cooperation of the Senior Law Enforcement Officer, will declare the emergency terminated when there is no further danger to oilfield personnel or general public. This will occur only after a sufficient number of gas measurements in the vicinity have been made by a qualified technician showing that hydrogen sulfide concentration is below the 10 ppm threshold. In addition, the Operator's Senior Representative or employee will perform the following duties connected with the emergency:
- A. Notify all cooperating law enforcement agencies and emergency medical services that the emergency has been terminated.
 - B. Notify all evacuees that they may return safely to their residences or job sites.
 - C. Make an estimate of damages and/or expenses incurred in the control of the emergency, the evacuation of any persons and the destruction of property, if any, including domestic animals and livestock. He is to make an itemized list of all such damages and/or expenses along with pertinent addresses, and any other specific information pertinent to the situation. He is to deliver this list to the Drilling Manager as soon as possible.
 - D. Under no circumstance are damage estimates, names of affected persons, if any, or any other information pertaining to the incident be given to the press. All inquiries shall be directed to the Drilling Manager in the Midland Office. Public information regarding the emergency will be issued by headquarters office in Midland, Texas.
- VI. Copies of the Contingency Plan are available in Fasken's office in Midland, Texas.
- VII. This plan is subject to approval of the state and federal agencies and shall be revised as required.

Fasken Oil and Ranch, Ltd.

H2S Contingency Plan

Emergency Phone Numbers

Klingensmith Fee No. 2H

Fasken Oil and Ranch, Ltd.

432 687-1777

Key Personnel

Tommy Taylor, Drilling Manager

432 556-2228

Cory Frederick, Drilling Engineer

432-288-0086

Deryl Briles, Drilling Foreman

432 556-4269

Jimmy Davis, Operations Manager

432 557-5668

Hobbs, Lea County, New Mexico

Ambulance

911

State Police

911 or 575 392-5580

Sheriff's Office

911 or 575 396-3611

Fire Department

911 or 575 397-9308

Local Emergency Planning Committee

575 393-2870

New Mexico Oil Conservation Division

575 393-6161

Carlsbad, Eddy County, New Mexico

Ambulance

911

State Police

911 or 575 885-3138

Sheriff's Department

911 or 575 887-7551

Fire Department

911 or 575 885-3125

Local Emergency Planning Committee

575 887-7553

Bureau of Land Management

575 887-6544

New Mexico Oil Conservation Division (Artesia)

575 748-1283

Statewide and National Emergency Numbers

New Mexico Department of Homeland Security And Emergency Management	505 476-9600
New Mexico State Emergency Operations Center (24 Hour Number)	505 476-9635
National Emergency Response Center	800 424-8802

Other Numbers for Emergency Response

Boots & Coots IWC	800 256-9688 or 281 931-8884
Cudd Pressure Control	432 563-3356
MCH Care Star Flight Service (air ambulance)	432 640-4000
Aerocare (air ambulance)	806 725-1111

Job Number:	Yeso	Elevation GL:	3576.00 ft	RKB:	20.00 ft
Company:	Fasken Oil and Ranch, Ltd.	Projection System:	US State Plane 1983		
Lease/Well:	Klingensmith No. 2H	Projection Group:	New Mexico Eastern Zone		
Location:	Southeast New Mexico	Projection Datum:	GRS80		
Rig Name:	N/A	Mag. Declination:	7.73° (C:\HawkEye\IGRF2005.MIF)		
State/Country:	New Mexico/ Eddy	Grid Convergence:	-0.10772 W		
Country:	United States of America	Date:	Thursday, February 06, 2014		
API Number:	N/A				

Calculated by HawkEye Software
Minimum Curvature Method
Vertical Section Plane 269.40°
Northing (US ft): 567627.50 Easting (US ft): 479674.30
Latitude: 32°33'37.0970" N Longitude: -104°32'0.5319" W
Well Location: 2155.78 FNL, 221.45 FEL, Section 24, T20S, R24E, New Mexico Principal Meridian, Eddy County, NM
Direction Reference: Grid North

Measured Depth (Ft)	INC Deg	AZM Deg	TVD (Ft)	EW (Ft)	NS (Ft)	VS (Ft)	Closure (Ft)	Walk Rate */100 Ft	Build Rate */100 Ft	Subsea TVD (Ft)
0.00	0.00	0.00	0.00	0.00	0.00	0.00	0.00	0.00	0.00	-3596.00
100.00	0.00	0.00	100.00	0.00	0.00	0.00	0.00	0.00	0.00	-3496.00
200.00	0.00	0.00	200.00	0.00	0.00	0.00	0.00	0.00	0.00	-3396.00
300.00	0.00	0.00	300.00	0.00	0.00	0.00	0.00	0.00	0.00	-3296.00
400.00	0.00	0.00	400.00	0.00	0.00	0.00	0.00	0.00	0.00	-3196.00
500.00	0.00	0.00	500.00	0.00	0.00	0.00	0.00	0.00	0.00	-3096.00
600.00	0.00	0.00	600.00	0.00	0.00	0.00	0.00	0.00	0.00	-2996.00
700.00	0.00	0.00	700.00	0.00	0.00	0.00	0.00	0.00	0.00	-2896.00
800.00	0.00	0.00	800.00	0.00	0.00	0.00	0.00	0.00	0.00	-2796.00
900.00	0.00	0.00	900.00	0.00	0.00	0.00	0.00	0.00	0.00	-2696.00
1000.00	0.00	0.00	1000.00	0.00	0.00	0.00	0.00	0.00	0.00	-2596.00
1100.00	0.00	0.00	1100.00	0.00	0.00	0.00	0.00	0.00	0.00	-2496.00
1200.00	0.00	0.00	1200.00	0.00	0.00	0.00	0.00	0.00	0.00	-2396.00
1300.00	0.00	0.00	1300.00	0.00	0.00	0.00	0.00	0.00	0.00	-2296.00
1400.00	0.00	0.00	1400.00	0.00	0.00	0.00	0.00	0.00	0.00	-2196.00
1500.00	0.00	0.00	1500.00	0.00	0.00	0.00	0.00	0.00	0.00	-2096.00
1600.00	0.00	0.00	1600.00	0.00	0.00	0.00	0.00	0.00	0.00	-1996.00
1700.00	0.00	0.00	1700.00	0.00	0.00	0.00	0.00	0.00	0.00	-1896.00
1800.00	0.00	0.00	1800.00	0.00	0.00	0.00	0.00	0.00	0.00	-1796.00
1900.00	0.00	0.00	1900.00	0.00	0.00	0.00	0.00	0.00	0.00	-1696.00
2000.00	0.00	0.00	2000.00	0.00	0.00	0.00	0.00	0.00	0.00	-1596.00
2100.00	0.00	0.00	2100.00	0.00	0.00	0.00	0.00	0.00	0.00	-1496.00
2145.90	0.00	0.00	2145.90	0.00	0.00	0.00	0.00	0.00	0.00	-1450.10
2245.90	10.11	263.13	2245.38	-8.74	-1.05	8.75	8.80	-96.87	10.11	-1350.62
2345.90	20.22	263.13	2341.77	-34.68	-4.17	34.73	34.93	0.00	10.11	-1254.23
2445.90	30.34	263.13	2432.08	-77.03	-9.27	77.12	77.58	0.00	10.11	-1163.92
2545.90	40.45	263.13	2513.49	-134.46	-16.19	134.62	135.43	0.00	10.11	-1082.51
2645.90	50.56	263.13	2583.48	-205.19	-24.70	205.43	206.67	0.00	10.11	-1012.52
2745.90	60.67	263.13	2639.88	-287.02	-34.56	287.36	289.09	0.00	10.11	-956.12
2752.66	61.36	263.13	2643.16	-292.89	-35.26	293.24	295.00	0.00	10.11	-952.84
2852.66	71.09	265.63	2683.42	-383.85	-44.13	384.29	386.38	2.50	9.74	-912.58
2952.66	80.86	267.85	2707.63	-480.60	-49.60	481.09	483.15	2.22	9.77	-888.37
3052.66	90.64	269.95	2715.03	-580.18	-51.50	580.68	582.46	2.10	9.78	-880.97
3054.91	90.86	270.00	2715.00	-582.43	-51.50	582.94	584.70	2.08	9.78	-881.00
3154.91	90.86	270.00	2713.50	-682.42	-51.50	682.92	684.36	0.00	0.00	-882.50
3254.91	90.86	270.00	2712.00	-782.41	-51.50	782.90	784.10	0.00	0.00	-884.00
3354.91	90.86	270.00	2710.50	-882.40	-51.50	882.89	883.90	0.00	0.00	-885.50
3454.91	90.86	270.00	2709.01	-982.39	-51.50	982.87	983.73	0.00	0.00	-886.99
3554.91	90.86	270.00	2707.51	-1082.37	-51.50	1082.85	1083.60	0.00	0.00	-888.49
3654.91	90.86	270.00	2706.01	-1182.36	-51.50	1182.84	1183.48	0.00	0.00	-889.99
3754.91	90.86	270.00	2704.51	-1282.35	-51.50	1282.82	1283.39	0.00	0.00	-891.49
3854.91	90.86	270.00	2703.01	-1382.34	-51.50	1382.80	1383.30	0.00	0.00	-892.99
3954.91	90.86	270.00	2701.52	-1482.33	-51.50	1482.79	1483.22	0.00	0.00	-894.48

Measured Depth (Ft)	INC Deg	AZM Deg	TVD (Ft)	EW (Ft)	NS (Ft)	VS (Ft)	Closure (Ft)	Walk Rate */100 Ft	Build Rate */100 Ft	Subsea TVD (Ft)
4054.91	90.86	270.00	2700.02	-1582.32	-51.50	1582.77	1583.16	0.00	0.00	-895.98
4154.91	90.86	270.00	2698.52	-1682.31	-51.50	1682.75	1683.09	0.00	0.00	-897.48
4254.91	90.86	270.00	2697.02	-1782.30	-51.50	1782.74	1783.04	0.00	0.00	-898.98
4354.91	90.86	270.00	2695.52	-1882.28	-51.50	1882.72	1882.99	0.00	0.00	-900.48
4454.91	90.86	270.00	2694.03	-1982.27	-51.50	1982.70	1982.94	0.00	0.00	-901.97
4554.91	90.86	270.00	2692.53	-2082.26	-51.50	2082.69	2082.90	0.00	0.00	-903.47
4654.91	90.86	270.00	2691.03	-2182.25	-51.50	2182.67	2182.86	0.00	0.00	-904.97
4754.91	90.86	270.00	2689.53	-2282.24	-51.50	2282.65	2282.82	0.00	0.00	-906.47
4854.91	90.86	270.00	2688.03	-2382.23	-51.50	2382.64	2382.78	0.00	0.00	-907.97
4954.91	90.86	270.00	2686.54	-2482.22	-51.50	2482.62	2482.75	0.00	0.00	-909.46
5054.91	90.86	270.00	2685.04	-2582.21	-51.50	2582.60	2582.72	0.00	0.00	-910.96
5154.91	90.86	270.00	2683.54	-2682.19	-51.50	2682.59	2682.69	0.00	0.00	-912.46
5254.91	90.86	270.00	2682.04	-2782.18	-51.50	2782.57	2782.66	0.00	0.00	-913.96
5354.91	90.86	270.00	2680.54	-2882.17	-51.50	2882.55	2882.63	0.00	0.00	-915.46
5454.91	90.86	270.00	2679.05	-2982.16	-51.50	2982.54	2982.61	0.00	0.00	-916.95
5554.91	90.86	270.00	2677.55	-3082.15	-51.50	3082.52	3082.58	0.00	0.00	-918.45
5654.91	90.86	270.00	2676.05	-3182.14	-51.50	3182.50	3182.55	0.00	0.00	-919.95
5754.91	90.86	270.00	2674.55	-3282.13	-51.50	3282.49	3282.53	0.00	0.00	-921.45
5854.91	90.86	270.00	2673.05	-3382.12	-51.50	3382.47	3382.51	0.00	0.00	-922.95
5954.91	90.86	270.00	2671.55	-3482.10	-51.50	3482.45	3482.49	0.00	0.00	-924.45
6054.91	90.86	270.00	2670.06	-3582.09	-51.50	3582.44	3582.46	0.00	0.00	-925.94
6154.91	90.86	270.00	2668.56	-3682.08	-51.50	3682.42	3682.44	0.00	0.00	-927.44
6254.91	90.86	270.00	2667.06	-3782.07	-51.50	3782.40	3782.42	0.00	0.00	-928.94
6354.91	90.86	270.00	2665.56	-3882.06	-51.50	3882.39	3882.40	0.00	0.00	-930.44
6454.91	90.86	270.00	2664.06	-3982.05	-51.50	3982.37	3982.38	0.00	0.00	-931.94
6554.91	90.86	270.00	2662.57	-4082.04	-51.50	4082.35	4082.36	0.00	0.00	-933.43
6654.91	90.86	270.00	2661.07	-4182.03	-51.50	4182.34	4182.34	0.00	0.00	-934.93
6754.91	90.86	270.00	2659.57	-4282.01	-51.50	4282.32	4282.32	0.00	0.00	-936.43
6854.91	90.86	270.00	2658.07	-4382.00	-51.50	4382.30	4382.31	0.00	0.00	-937.93
6954.91	90.86	270.00	2656.57	-4481.99	-51.50	4482.29	4482.29	0.00	0.00	-939.43
7054.91	90.86	270.00	2655.08	-4581.98	-51.50	4582.27	4582.27	0.00	0.00	-940.92
7154.91	90.86	270.00	2653.58	-4681.97	-51.50	4682.25	4682.25	0.00	0.00	-942.42
7254.91	90.86	270.00	2652.08	-4781.96	-51.50	4782.24	4782.24	0.00	0.00	-943.92
7354.91	90.86	270.00	2650.58	-4881.95	-51.50	4882.22	4882.22	0.00	0.00	-945.42
7393.87	90.86	270.00	2650.00	-4920.90	-51.50	4921.16	4921.16	0.00	0.00	-946.00

Job Number: Yeso
Company: Fasken Oil and Ranch, Ltd.
Lease/Well: Klingensmith No. 2H
Location: Southeast New Mexico
Rig Name: N/A
State/County: New Mexico/ Eddy
Country: United States of America
API Number: N/A

Elevation (To MSL): 3576.00 ft
RKB: 20.00 ft
Projection System: US State Plane 1983
Projection Group: New Mexico Eastern Zone
Projection Datum: GRS80
Magnetic Declination: 7.73
Grid Convergence: -0.10772 W
Date: Thursday, February 06, 2014

True Vertical Depth

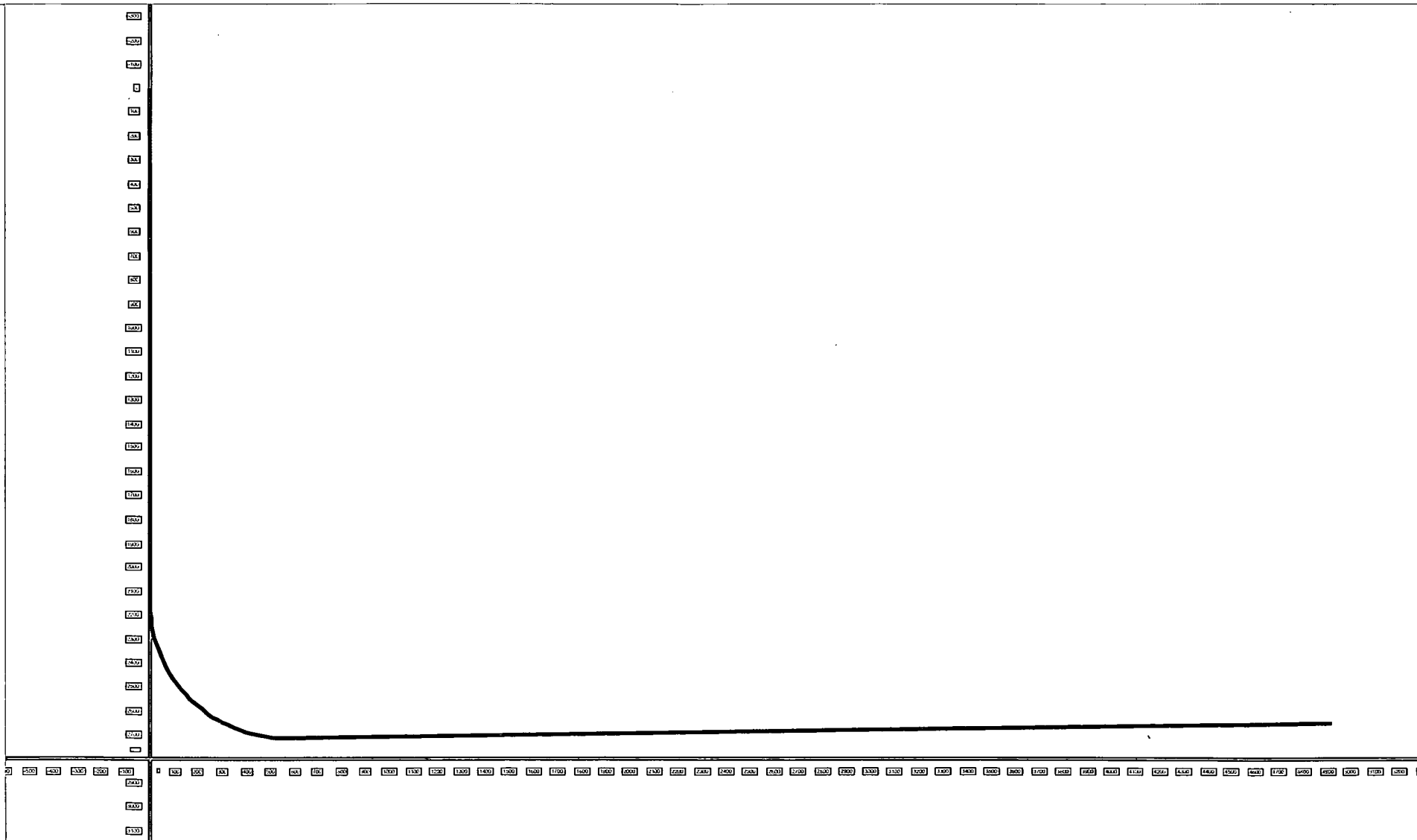

Vertical Section (100 Ft/Div) VSP: 269.40°

Job Number: Yeso
Company: Fasken Oil and Ranch, Ltd.
Lease/Well: Klingensmith No. 2H
Location: Southeast New Mexico
Rig Name: N/A
State/County: New Mexico/ Eddy
Country: United States of America
API Number: N/A

Elevation (To MSL): 3576.00 ft
RKB: 20.00 ft
Projection System: US State Plane 1983
Projection Group: New Mexico Eastern Zone
Projection Datum: GRS80
Magnetic Declination: 7.73
Grid Convergence: -0.10772 W
Date: Thursday, February 06, 2014

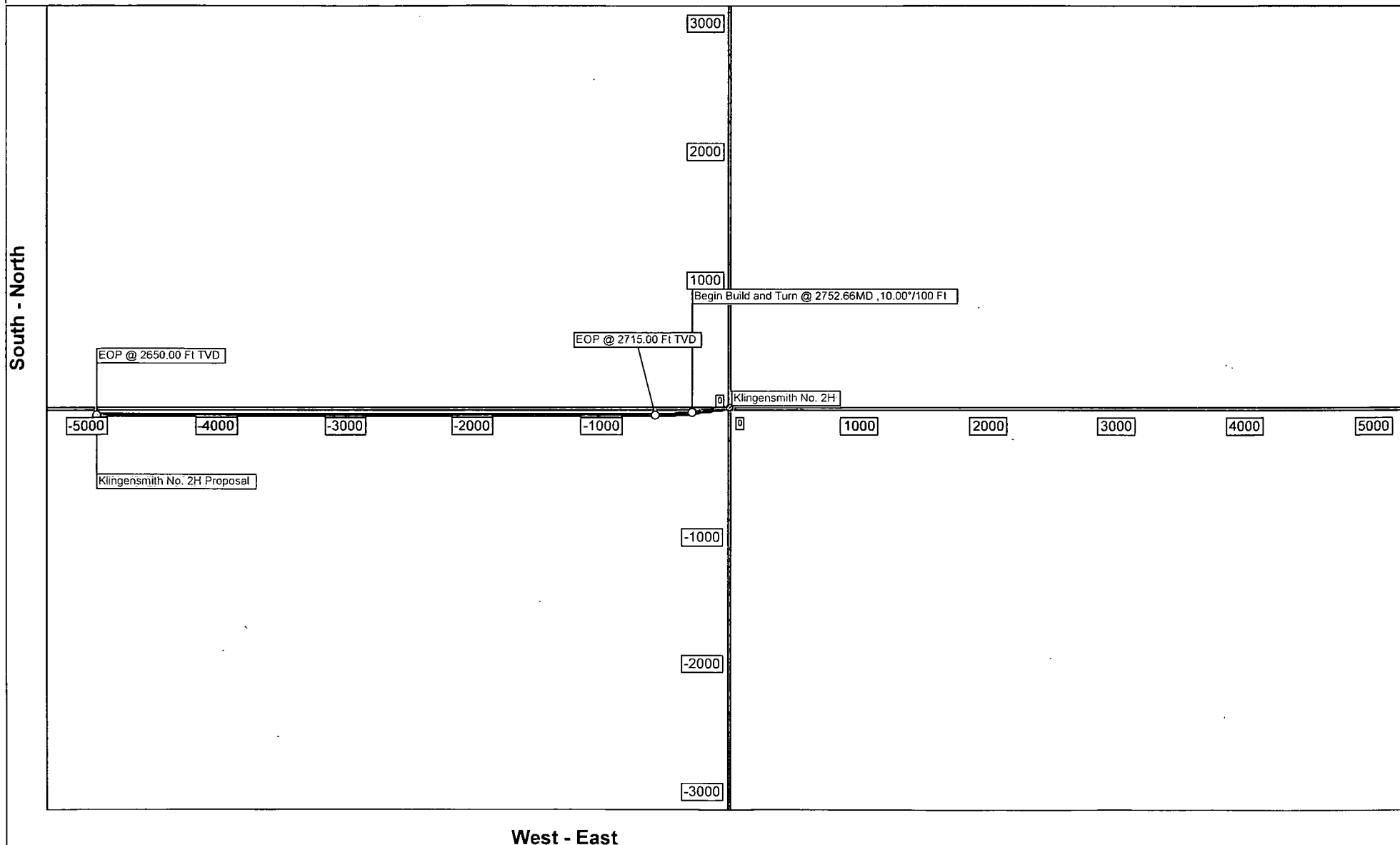



22-141 50 SHEETS
22-142 100 SHEETS
22-144 200 SHEETS

Fasken Oil and Ranch, Ltd.

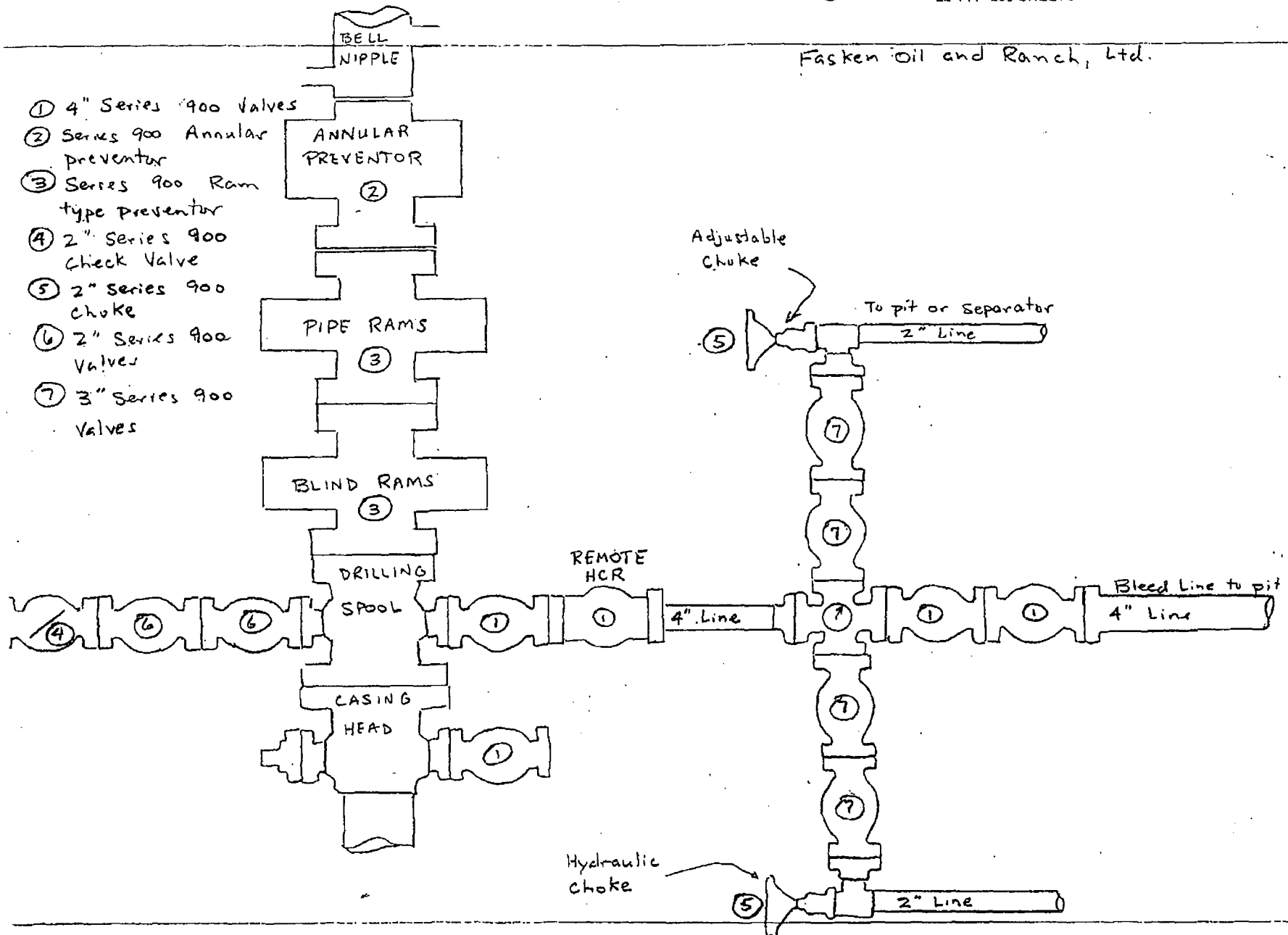

Fasken Oil and Ranch, Ltd.
Klingensmith No. 2H Wellsite Layout
Closed Loop System

