

DISTRICT I  
1625 N. French Dr., Hobbs, NM 88240  
Phone (505) 748-4281 Fax (505) 748-4277

DISTRICT II  
511 S. First St., Artesia, NM 88210  
Phone (505) 748-4281 Fax (505) 748-4277

DISTRICT III  
1000 Rio Brazos Road, Aztec, NM 87410  
Phone (505) 334-6178 Fax (505) 334-6179

DISTRICT IV  
1220 S. St. Francis Dr., Santa Fe, NM 87505  
Phone (505) 476-3460 Fax (505) 476-3462

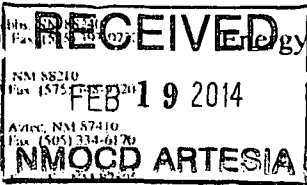

State of New Mexico  
Minerals & Natural Resources Department  
OIL CONSERVATION DIVISION  
1220 South St. Francis Dr.  
Santa Fe, New Mexico 87505

Form C-102  
Revised August 1, 2011  
Submit one copy to appropriate  
District Office

AMENDED REPORT

WELL LOCATION AND ACREAGE DEDICATION PLAT

API Number <b>30-015-42004</b>	Pool Code <b>3250</b>	Pool Name <b>Atoka; Glorieta Yeso</b>
Property Code <b>38804</b>	Property Name <b>ARABIAN 6 FEE</b>	Well Number <b>10H</b>
CGRID No. <b>229137</b>	Operator Name <b>COG OPERATING, LLC</b>	Elevation <b>3446'</b>

Surface Location

Blk. or lot No	Section	Township	Range	Lot Idn	Feet from the	North/South line	Feet from the	East/West line	County
4	31	18-S	26-E		150	SOUTH	210	WEST	EDDY

Bottom Hole Location If Different From Surface

Blk. or lot No	Section	Township	Range	Lot Idn	Feet from the	North/South line	Feet from the	East/West line	County
4	6	19-S	26-E		330	SOUTH	530	WEST	EDDY

Dedicated Acres <b>148.64</b>	Joint or Infill	Consolidation Code	Order No.
----------------------------------	-----------------	--------------------	-----------

NO ALLOWABLE WILL BE ASSIGNED TO THIS COMPLETION UNTIL ALL INTERESTS HAVE BEEN CONSOLIDATED OR A NON-STANDARD UNIT HAS BEEN APPROVED BY THE DIVISION

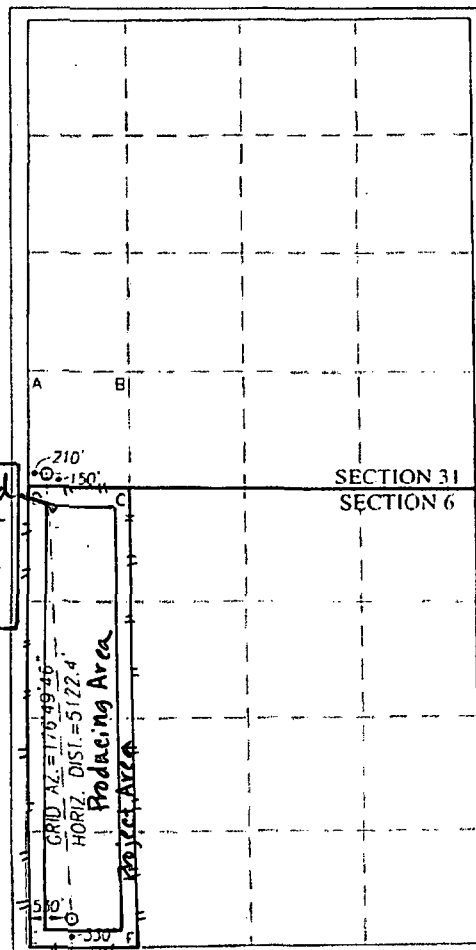

GEODETTIC COORDINATES  
NAD 27 NME

SURFACE LOCATION  
Y=617366.0 N  
X=470764.9 E

LAT. = 32.697202° N  
LONG. = 104.428366° W

BOTTOM HOLE LOCATION  
Y=612252.9 N  
X=471048.1 E

CORNER COORDINATES TABLE

- A - Y=618545.2 N, X=470558.1 E
- B - Y=618543.6 N, X=471726.7 E
- C - Y=617212.7 N, X=471734.5 E
- D - Y=617216.7 N, X=470554.5 E
- E - Y=611917.4 N, X=470515.8 E
- F - Y=611930.8 N, X=471803.5 E

OPERATOR CERTIFICATION

I hereby certify that the information herein is true and complete to the best of my knowledge and belief, and that this organization either owns a working interest or unleased mineral interest in the land including the proposed bottom hole location or has a right to drill this well at this location pursuant to a contract with an owner of such mineral or working interest, or to a voluntary pooling agreement or a compulsory pooling order heretofore entered by the division.

 2-18-14  
Signature Date

Kelly J. Holly  
Printed Name

kholly@concho.com  
E-mail Address

SURVEYOR CERTIFICATION

I hereby certify that the well location shown on this plat was plotted from field notes of actual surveys made by me or under my supervision, and that the same is true and correct to the best of my belief.

DECEMBER 17, 2013

Date of Survey  
Signature & Seal of Professional Surveyor.

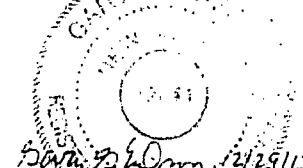

Gary G. Eidson 12/29/13  
Certificate Number  
12041  
107258  
Gary G. Eidson 12041  
3239  
HKL JWSC W/O 13 11 1430