

To Appropriate District Office
 State Lease - 6 copies
 Fee Lease - 5 copies
 District I
 1625 N. French Dr., Hobbs, NM 88240
 District II
 1301 W. Grand Avenue, Artesia, NM 88210
 District III
 1000 Rio Brazos Rd., Aztec, NM 87410
 District IV
 1220 S. St. Francis Dr., Santa Fe, NM 87505

State of New Mexico
 Energy, Minerals and Natural Resources
 Oil Conservation Division
 1220 South St. Francis Dr.
 Santa Fe, NM 87505

Form C-105
 Revised June 10, 2003
 WELL API NO.
 30-015-33916
 5. Indicate Type of Lease
 STATE FEE
 State Oil & Gas Lease No.
 300259

WELL COMPLETION OR RECOMPLETION REPORT AND LOG

1a. Type of Well:
 OIL WELL GAS WELL DRY OTHER _____
 b. Type of Completion:
 NEW WORK DEEPEN PLUG DIFF.
 WELL OVER BACK RESVR. OTHER _____
 2. Name of Operator
 Range Operating New Mexico, Inc.
 3. Address of Operator
 777 Main Street Suite 800 Fort Worth TX 76102
 7. Lease Name or Unit Agreement Name
 Teledyne 12 Federal
 8. Well No.
 001
 9. Pool name or Wildcat
 OCC-ARTESIA

RECEIVED
 OCT 14 2005
 OCC-ARTESIA

4. Well Location
 Unit Letter M : 990 Feet From The South Line and 990 Feet From The West Line
 Section 12 Township 23S Range 28E NMPM County Eddy
 10. Date Spudded 06-28-05 11. Date T.D. Reached 07-09-05 12. Date Compl. (Ready to Prod.) 08-04-05 13. Elevations (DF& RKB, RT, GR, etc.) GR 2995' 14. Elev. Casinghead
 15. Total Depth 6490' 16. Plug Back T.D. 6399' 17. If Multiple Compl. How Many Zones? _____ 18. Intervals Drilled By _____ Rotary Tools X Cable Tools _____
 19. Producing Interval(s), of this completion - Top, Bottom, Name
5866'-6250' Brushy Canyon 20. Was Directional Survey Made Yes
 21. Type Electric and Other Logs Run
Spectral Density/DS Neutron / DLL / MGRD 22. Was Well Cored No

23. CASING RECORD (Report all strings set in well)

CASING SIZE	WEIGHT LB./FT.	DEPTH SET	HOLE SIZE	CEMENTING RECORD	AMOUNT PULLED
8 5/8"	24	591	12 1/4"	550	0
5 1/2	15.5	6487	7 7/8"	1415	0

24. LINER RECORD **25. TUBING RECORD**

SIZE	TOP	BOTTOM	SACKS CEMENT	SCREEN	SIZE	DEPTH SET	PACKER SET
					2 7/8	6131	

26. Perforation record (interval, size, and number)
4866'-5876' & 5912'-5922'
6182'-6192' & 6240'-6250'

27. ACID, SHOT, FRACTURE, CEMENT, SQUEEZE, ETC.

DEPTH INTERVAL	AMOUNT AND KIND MATERIAL USED
<u>5866'-6250'</u>	<u>Frac w/37,338 gals 25# x-link gel w/62,379#'s 16/30 Ottawa & Resin Sand.</u>

28. PRODUCTION

Date First Production	Production Method (Flowing, gas lift, pumping - Size and type pump)	Well Status (Prod. or Shut-in)					
<u>07-25-05</u>	<u>Pumping</u>	<u>Producing</u>					
Date of Test	Hours Tested	Choke Size	Prod'n For Test Period	Oil - Bbl	Gas - MCF	Water - Bbl.	Gas - Oil Ratio
<u>08-04-05</u>	<u>24</u>	<u>Open</u>	<u>26</u>	<u>26</u>	<u>56</u>	<u>323</u>	<u>215</u>
Flow Tubing Press.	Casing Pressure	Calculated 24-Hour Rate	Oil - Bbl.	Gas - MCF	Water - Bbl.	Oil Gravity - API - (Corr.)	
<u>100</u>	<u>100</u>	<u>26</u>	<u>26</u>	<u>56</u>	<u>323</u>	<u>37.2</u>	

29. Disposition of Gas (Sold, used for fuel, vented, etc.)
 Sold _____ Test Witnessed By _____

30. List Attachments _____
 31. I hereby certify that the information shown on both sides of this form as true and complete to the best of my knowledge and belief

Signature Linda C. Stiles Printed Name Linda C. Stiles Title Sr. Engineering Tech Date 09-19-05
 E-mail Address lstiles@rangeresources.com

INSTRUCTIONS

This form is to be filed with the appropriate District Office of the Division not later than 20 days after the completion of any newly-drilled or deepened well. It shall be accompanied by one copy of all electrical and radio-activity logs run on the well and a summary of all special tests conducted, including drill stem tests. All depths reported shall be measured depths. In the case of directionally drilled wells, true vertical depths shall also be reported. For multiple completions, items 25 through 29 shall be reported for each zone. The form is to be filed in quintuplicate except on state land, where six copies are required. See Rule 1105.

INDICATE FORMATION TOPS IN CONFORMANCE WITH GEOGRAPHICAL SECTION OF STATE

Southeastern New Mexico		Northwestern New Mexico	
T. Anhy	T. Cherry Canyon <u>3409</u>	T. Ojo Alamo	T. Penn. "B"
T. Salt	T. Brushy Canyon <u>4727</u>	T. Kirtland-Fruitland	T. Penn. "C"
B. Salt	T. Atoka	T. Pictured Cliffs	T. Penn. "D"
T. Yates	T. Miss	T. Cliff House	T. Leadville
T. 7 Rivers	T. Devonian	T. Menefee	T. Madison
T. Queen	T. Silurian	T. Point Lookout	T. Elbert
T. Grayburg	T. Montoya	T. Mancos	T. McCracken
T. San Andres	T. Simpson	T. Gallup	T. Ignacio Otzte
T. Glorieta	T. McKee	Base Greenhorn	T. Granite
T. Paddock	T. Ellenburger	T. Dakota	T.
T. Blinebry	T. Gr. Wash	T. Morrison	T.
T. Tubb	T. Delaware Sand <u>2662</u>	T. Todilto	T.
T. Drinkard	T. Bone Springs <u>6264</u>	T. Entrada	T.
T. Abo	T.	T. Wingate	T.
T. Wolfcamp	T.	T. Chinle	T.
T. Penn	T.	T. Permian	T.
T. Cisco (Bough C)	T.	T. Penn "A"	T.

OIL OR GAS SANDS OR ZONES

No. 1, from.....to.....
 No. 2, from.....to.....
 No. 3, from.....to.....
 No. 4, from.....to.....

IMPORTANT WATER SANDS

Include data on rate of water inflow and elevation to which water rose in hole.
 No. 1, from.....to.....feet.....
 No. 2, from.....to.....feet.....
 No. 3, from.....to.....feet.....

LITHOLOGY RECORD (Attach additional sheet if necessary)

From	To	Thickness In Feet	Lithology	From	To	Thickness In Feet	Lithology
0	554	554	Alluvium				
554	2722	2168	Salt & Anhydrite				
2722	6317	3595	SS, SLTST, & SH				
6317	6495	178	LS & SH				

INCLINATION REPORT	
1. FIELD NAME East Loving Delaware	2. LEASE NAME Teledyne 12 Fed. #1
3. OPERATOR Range Resources	
4. ADDRESS 777 Main Street, Ft. Worth, Tx. 76102	
5. LOCATION (Section, Block, and Survey) Sec 12, T-23-S, R-28-E, Chaves, N.M.	

*11. Measured Depth (feet)	*12. Course Length (Hundreds of feet)	*13. Angle of Inclination (Degrees)	14. Displacement per Hundred Feet (Sine of Angle x 100)	15. Course Displacement (feet)	16. Accumulative Displacement (feet)
183	183	1.00	1.75	3.20	3.20
406	223	1.00	1.75	3.90	7.10
557	151	1.00	1.75	2.64	9.74
840	283	0.75	1.31	3.70	13.44
1127	287	0.25	.44	1.26	14.70
1418	291	2.00	3.49	10.15	24.85
1673	255	1.00	1.75	4.46	29.31
1960	287	1.25	2.18	6.25	35.56
2247	287	1.75	3.05	8.75	44.31
2534	287	1.75	3.05	8.75	53.06
3234	700	1.50	2.62	23.38	76.44
3715	481	2.00	3.49	16.78	93.22
4191	476	1.00	1.75	8.33	101.55
4671	480	1.00	1.75	8.40	109.95
5149	478	2.00	3.49	16.68	126.63
5649	500	2.00	3.49	17.45	144.08
6255	606	1.00	1.75	10.60	154.68
6450	195	1.00	1.75	8.66	163.34

Accumulative total displacement of well bore at total depth of 6450' 163.34 feet.
 Inclusion measurements were made in: Tubing Casing Open Hole X

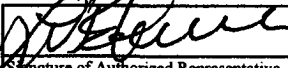
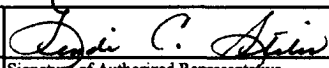
 Signature of Authorized Representative L.V. Bohannon Name of Person and Title (type or print) Adobe Drilling Name of Company Telephone <u>432-552-5553</u> Area Code	 Signature of Authorized Representative Linda C. Stiles Sr Engineering Tech Name of Person and Title (type or print) Range Operating New Mexico, Inc. Name of Company Telephone <u>(817) 810-1908</u> Area Code
---	--

Certified By _____ Date _____

Rhonda Juston 7-11-05

State of New Mexico

Energy, Minerals and Natural Resources Department

DISTRICT I
1685 N. FRENCH DR., BOBBS, NM 86240

DISTRICT II
1901 W. GRAND AVENUE, ARTESIA, NM 88210

DISTRICT III
1000 Rio Brasos Rd., Astec, NM 87410

DISTRICT IV
1220 S. ST. FRANCIS DR., SANTA FE, NM 87505

OIL CONSERVATION DIVISION
1220 SOUTH ST. FRANCIS DR.
Santa Fe, New Mexico 87505

Form C-102
Revised JUNE 10, 2003
Submit to Appropriate District Office
State Lease - 4 Copies
Fee Lease - 3 Copies

WELL LOCATION AND ACREAGE DEDICATION PLAT

AMENDED REPORT

API Number	Pool Code	Pool Name
Property Code	Property Name TELEDYNE 12 FEDERAL	Well Number 1
OGRID No.	Operator Name R.B. OPERATING	Elevation 2995'

Surface Location

UL or lot No.	Section	Township	Range	Lot Idn	Feet from the	North/South line	Feet from the	East/West line	County
M	12	23-S	28-E		990	SOUTH	990	WEST	EDDY

Bottom Hole Location If Different From Surface

UL or lot No.	Section	Township	Range	Lot Idn	Feet from the	North/South line	Feet from the	East/West line	County

Dedicated Acres 40	Joint or Infill	Consolidation Code	Order No.
-----------------------	-----------------	--------------------	-----------

NO ALLOWABLE WILL BE ASSIGNED TO THIS COMPLETION UNTIL ALL INTERESTS HAVE BEEN CONSOLIDATED OR A NON-STANDARD UNIT HAS BEEN APPROVED BY THE DIVISION

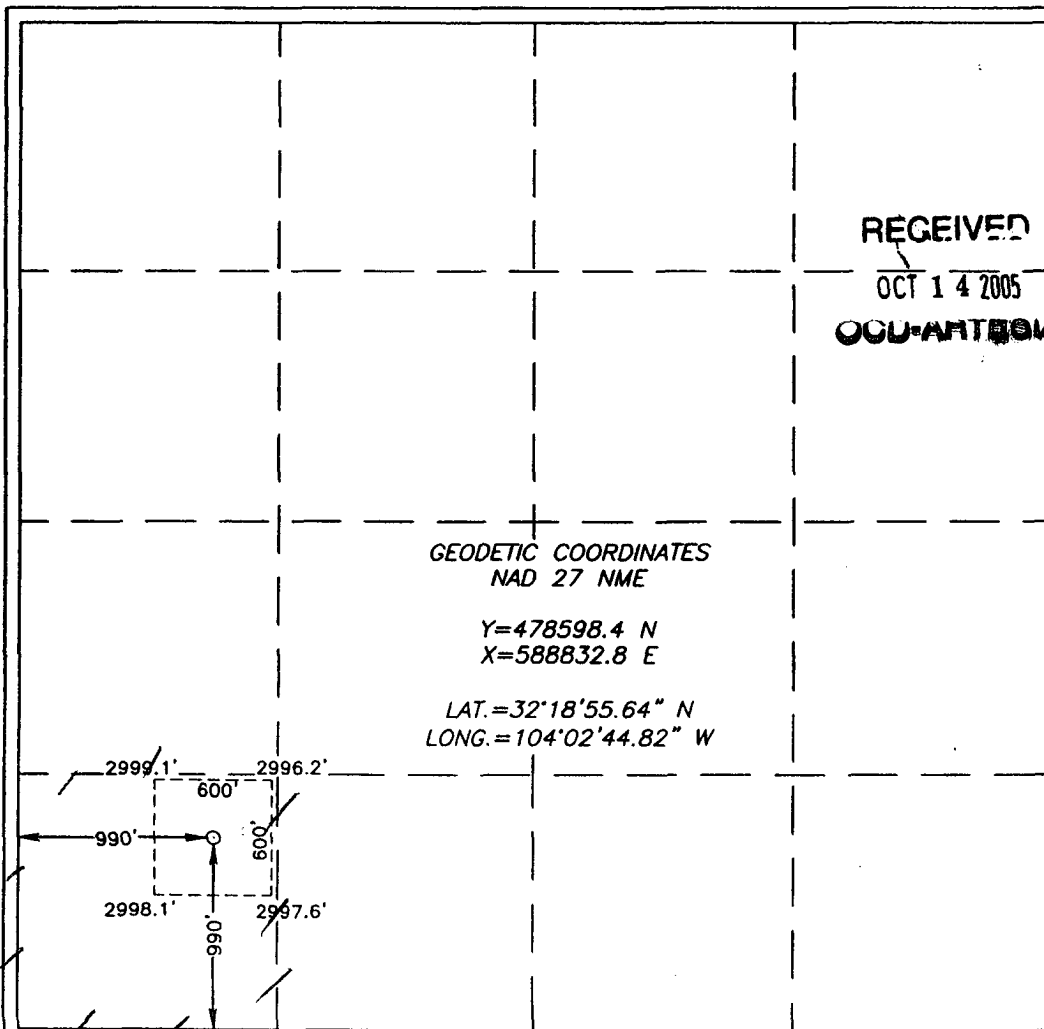

RECEIVED
OCT 14 2005
OCU-ARTESIA

OPERATOR CERTIFICATION

I hereby certify the the information contained herein is true and complete to the best of my knowledge and belief.

D K Robinson
Signature
D K ROBINSON
Printed Name
Dtg Mgr
Title
11/30/04
Date

SURVEYOR CERTIFICATION

I hereby certify that the well location shown on this plat was plotted from field notes of actual surveys made by me or under my supervision and that the same is true and correct to the best of my belief.

OCTOBER 12, 2004

Date Surveyed
Signature & Seal of Professional Surveyor
Ronald J. Edson
Professional Surveyor
NEW MEXICO
Certificate No. RONALD J. EDSON 3239
GARY EDSON 12641



MICROSPHERICALLY FOCUSED
DUAL LATEROLOG

COMPANY RB OPERATING COMPANY WELL TELEDYNE "12" FEDERAL #1 FIELD EAST LOVING DELAWARE COUNTY EDDY STATE NEW MEXICO	COMPANY	RB OPERATING COMPANY			
	WELL	TELEDYNE "12" FEDERAL #1			
	FIELD	EAST LOVING DELAWARE			
	COUNTY	EDDY	STATE	NEW MEXICO	
	Location	990' FSL & 990' FWL SEC 12, T23S, R28E		Other Services:	SPED/CNT
API	30-015-33930		ELEV. K.B.	3008 ft	
SEC.	12	TWP	23S	RGE	28E
Perm. Datum	G.L.		Elev.	2995 ft	
Log measured from	K.B.		13 ft above Permanent Datum.		
			D.F.	3007 ft	
			G.L.	2995 ft	

Date	JULY 08, 2005		
Run No.	ONE		
Bot. Driller	6490 ft.	ft.	ft.
Bot. Logger	6500 ft.	ft.	ft.
First Reading	6498 ft.	ft.	ft.
Last Reading	2500 ft.	ft.	ft.
Log Interval	3998 ft.	ft.	ft.
Csg. Driller	8.625 in. @ 591 ft.	in. @ ft.	in. @ ft.
Csg. Logger	590 ft.	ft.	ft.
Bit Size	7.875 in.	in.	in.
Fluid Type	SALT GEL		
Dens.	10.0 lbm/gal	29 s	lbm/gal s
Visc.			
pH	10.0	N/A cc	cc
Fluid Loss			
Sample Source	MUD PIT/MEASURED		
Rm @Temp.-meas	0.04 ohm-m @ 84 °F	ohm-m @ °F	ohm-m @ °F
Rmf @Temp.-meas	N/A ohm-m @ N/A °F	ohm-m @ °F	ohm-m @ °F
Rmc @Temp.-meas	N/A ohm-m @ N/A °F	ohm-m @ °F	ohm-m @ °F
Rm @BHT -calc	0.03 ohm-m @ 116 °F	ohm-m @ °F	ohm-m @ °F
Rmf @BHT -calc	N/A ohm-m @ N/A °F	ohm-m @ °F	ohm-m @ °F
Last Circ.	JULY 08 - 1145 hrs.	hrs.	hrs.
Max Rec. Temp	116 °F	°F	°F
Operating Time	4.0 hrs.	hrs.	hrs.
Unit#	373	ODESSA	
Loc.			
Recorded By	G. ROBEY		
Witnessed By	M. METCALF		



SPECTRAL PE DENSITY
COMPENSATED NEUTRON LOG

COMPANY RB OPERATING COMPANY
 WELL TELEDYNE "12" FEDERAL #1
 FIELD EAST LOVING DELAWARE
 COUNTY EDDY
 STATE NEW MEXICO

COMPANY RB OPERATING COMPANY
 WELL TELEDYNE "12" FEDERAL #1
 FIELD EAST LOVING DELAWARE
 COUNTY EDDY STATE NEW MEXICO

Location 990' FSL & 990' FWL
SEC 12, T23S, R28E
 Other Services:
MSFL/DLL
 API 30-015-33930
SEC. 12 TWP23S RGE28E
 Perm. Datum G.L. Elev. 2995 ft
 Log measured from K.B. 13 ft above
 Permanent Datum.

ELEV. K.B. 3008 ft
D.F. 3007 ft
G.L. 2995 ft

Date	JULY 08, 2005				
Run No.	ONE				
Bot. Driller	6490 ft.		ft.		ft.
Bot. Logger	6500 ft.		ft.		ft.
First Reading	6463 ft.		ft.		ft.
Last Reading	150 ft.		ft.		ft.
Log Interval	6313 ft.		ft.		ft.
Csg. Driller	8.625 in. @ 591 ft.		in. @ ft.		in. @ ft.
Csg. Logger	590 ft.		ft.		ft.
Bit Size	7.875 in.		in.		in.
Fluid Type	SALT GEL				
Dens.	10.0 lbm/gal	29 s	lbm/gal	s	lbm/gal s
pH	10.0	N/A cc		cc	cc
Sample Source	MUD PIT/MEASURED				
Rm @Temp. -meas	0.04 ohm-m @ 84 °F		ohm-m @ °F		ohm-m @ °F
Rmf @Temp. -meas	N/A ohm-m @ N/A °F		ohm-m @ °F		ohm-m @ °F
Rmc @Temp. -meas	N/A ohm-m @ N/A °F		ohm-m @ °F		ohm-m @ °F
Rm @BHT -calc	0.03 ohm-m @ 116 °F		ohm-m @ °F		ohm-m @ °F
Rmf @BHT -calc	N/A ohm-m @ N/A °F		ohm-m @ °F		ohm-m @ °F
Last Circ.	JULY 08 - 1145 hrs.		- hrs.		- hrs.
Max Rec. Temp	116 °F		°F		°F
Operating Time	4.0 hrs.		hrs.		hrs.
Unit#	373	ODESSA			
Recorded By	G. ROBEY				
Witnessed By	M. METCALF				