

District I -
1625 N. French Dr., Hobbs, NM 88240
District II
1301 W. Grand Avenue, Artesia, NM 88210
District III
1000 Rio Brazos Road, Aztec, NM 87410
District IV
1220 S. St. Francis Dr., Santa Fe, NM 87505

State of New Mexico
Energy Minerals and Natural Resources

Oil Conservation Division
1220 South St. Francis Dr.
Santa Fe, NM 87505

Form C-144
June 1, 2004
For drilling and production facilities, submit to
appropriate NMOCD District Office.
For downstream facilities, submit to Santa Fe
office

Pit or Below-Grade Tank Registration or Closure

Is pit or below-grade tank covered by a "general plan"? Yes No X

Type of action: Registration of a pit or below-grade tank ☐ Closure of a pit or below-grade tank X

Operator: SDX Resources, Inc. Telephone: 432/685-1761 e-mail address: cmorgan@sdxresources.com
Address: PO Box 5061, Midland, TX 79704
Facility or well name: Kersey Williams A Federal #6 API #: 30-015-33872 U/L or Qtr/Qtr G Sec 28 T 17S R28E
County: Eddy 1700' FNL 1700' FEL NAD: 1927 ☐ 1983 ☐ Surface Owner Federal X State ☐ Private ☐ Indian ☐

Pit Type: Drilling X Production <input type="checkbox"/> Disposal <input type="checkbox"/> Workover <input type="checkbox"/> Emergency <input type="checkbox"/> Lined X Unlined <input type="checkbox"/> Liner type: Synthetic X Thickness 12 mil Clay <input type="checkbox"/> Pit Volume bbl	Below-grade tank Volume: bbl Type of fluid: Construction material: Double-walled, with leak detection? Yes <input type="checkbox"/> If not, explain why: <div style="text-align: right;">RECEIVED OCT 19 2005 OCD-ARTESIA</div>	
Depth to ground water (vertical distance from bottom of pit to seasonal high water elevation of ground water.)	Less than 50 feet 50 feet or more, but less than 100 feet 100 feet or more	(20 points) (10 points) (0 points) 0
Vellhead protection area: (Less than 200 feet from a private domestic water source, or less than 1000 feet from all other water sources.)	Yes No	(20 points) (0 points) 0
Distance to surface water: (horizontal distance to all wetlands, playas, irrigation canals, ditches, and perennial and ephemeral watercourses.)	Less than 200 feet 200 feet or more, but less than 1000 feet 1000 feet or more	(20 points) (10 points) (0 points) 0
Ranking Score (Total Points)		0

If this is a pit closure: (1) attach a diagram of the facility showing the pit's relationship to other equipment and tanks. (2) Indicate disposal location: (check the onsite box if you are burying in place) onsite X offsite ☐ If offsite, name of facility (3) Attach a general description of remedial action taken including remediation start date and end date. (4) Groundwater encountered: No ☐ Yes ☐ If yes, show depth below ground surface ft. and attach sample results. (5) Attach soil sample results and a diagram of sample locations and excavations:

Additional Comments:

Propose to mix pit contents with earthen material. Dig & line an encapsulation pit (within the existing reserve area) with a 12 mill synthetic liner. Place mixed contents in encapsulation pit, cap with 20 mill synthetic liner & cover entire area with clean top soil.

I hereby certify that the information above is true and complete to the best of my knowledge and belief. I further certify that the above-described pit or below-grade tank has been/will be constructed or closed according to NMOCD guidelines X, a general permit ☐, or an (attached) alternative OCD-approved plan ☐.

Date: 10/17/05

Printed Name/Title: Chuck Morgan, Engineer

Signature: 

Your certification and NMOCD approval of this application/closure does not relieve the operator of liability should the contents of the pit or tank contaminate ground water or otherwise endanger public health or the environment. Nor does it relieve the operator of its responsibility for compliance with any other federal, state, or local laws and/or regulations.

Approval:

Printed Name/Title:

Field Supervisor

Signature:

OCT 19 2005

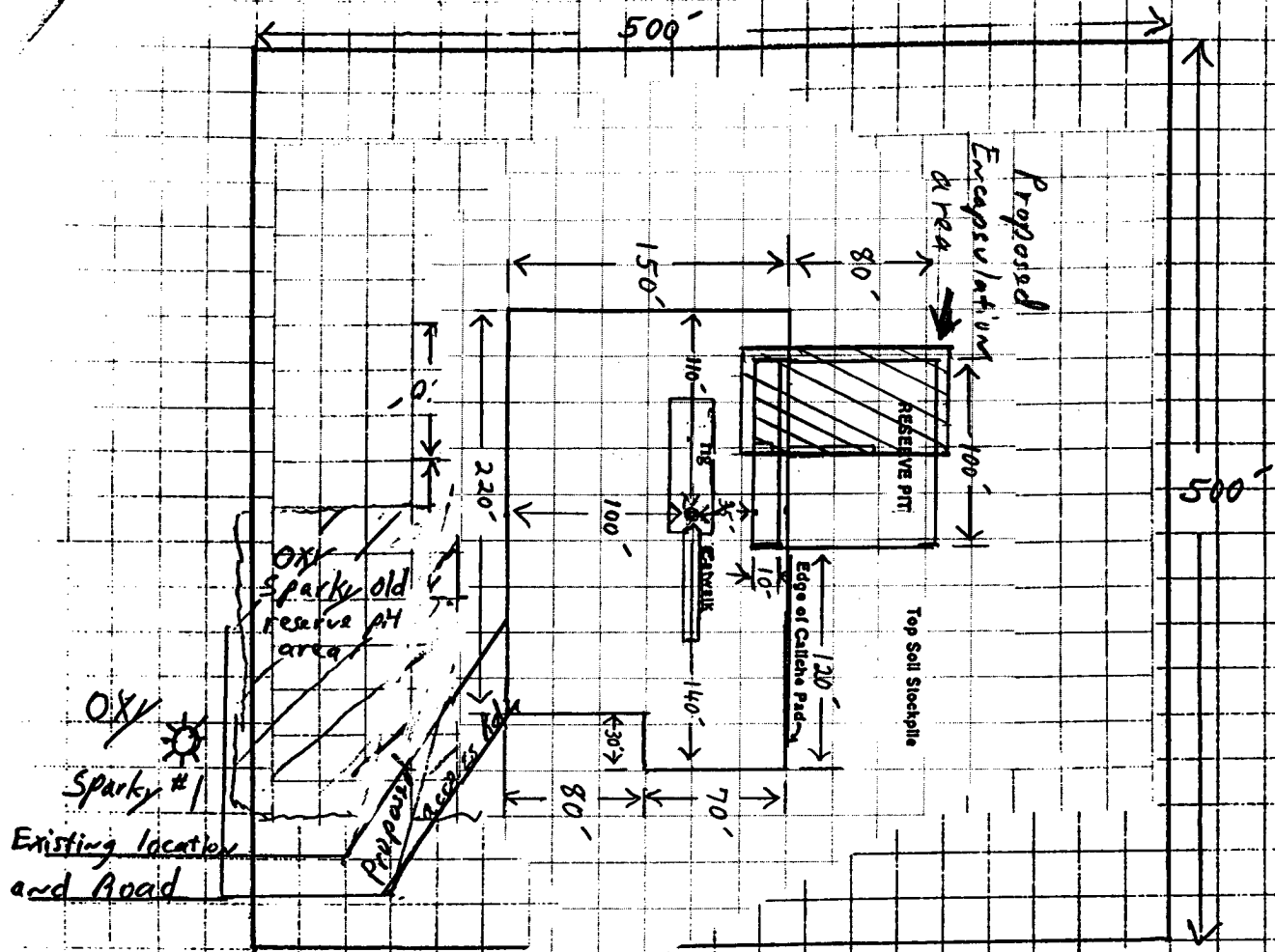

SDX Resources, Inc.
Drilling rig layout

Kersey Williams A
Fed. #6