

Submit 1 Copy To Appropriate District Office
District I
1625 N. French Dr., Hobbs, NM 88240
District II
1301 W. Grand Ave., Artesia, NM 88210
District III
1000 Rio Brazos Rd., Aztec, NM 87410
District IV
1220 S. St. Francis Dr., Santa Fe, NM 87505

State of New Mexico
Energy, Minerals and Natural Resources

Form C-103
October 13, 2009

OIL CONSERVATION DIVISION
1220 South St. Francis Dr.
Santa Fe, NM 87505

WELL API NO. 30-015-44004
5. Indicate Type of Lease STATE <input type="checkbox"/> FEE <input checked="" type="checkbox"/>
6. State Oil & Gas Lease No.
7. Lease Name or Unit Agreement Name Myox 21 State Com
8. Well Number 34H
9. OGRID Number 229137
10. Pool name or Wildcat Purple Sage; Wolfcamp
11. Elevation (Show whether DR, RKB, RT, GR, etc.) 2989.1

SUNDRY NOTICES AND REPORTS ON WELLS
(DO NOT USE THIS FORM FOR PROPOSALS TO DRILL OR TO DEEPEN OR PLUG BACK TO A DIFFERENT RESERVOIR. USE "APPLICATION FOR PERMIT" (FORM C-101) FOR SUCH PROPOSALS.)

1. Type of Well: Oil Well ☒ Gas Well ☐ Other

2. Name of Operator
COG Operating LLC

3. Address of Operator
2208 W. Main Street, Artesia, NM 88210

4. Well Location
Unit Letter N : 200 feet from the South line and 1649 feet from the West line
Section 21 Township 25S Range 28E NMPM Eddy County

12. Check Appropriate Box to Indicate Nature of Notice, Report or Other Data

NOTICE OF INTENTION TO:

PERFORM REMEDIAL WORK ☐ PLUG AND ABANDON ☐
TEMPORARILY ABANDON ☐ CHANGE PLANS ☒
PULL OR ALTER CASING ☐ MULTIPLE COMPL ☐
DOWNHOLE COMMINGLE ☐

OTHER: ☒ BHL & Pool Change

SUBSEQUENT REPORT OF:

REMEDIAL WORK ☐ ALTERING CASING ☐
COMMENCE DRILLING OPNS. ☐ P AND A ☐
CASING/CEMENT JOB ☐

OTHER: ☐

13. Describe proposed or completed operations. (Clearly state all pertinent details, and give pertinent dates, including estimated date of starting any proposed work). SEE RULE 19.15.7.14 NMAC. For Multiple Completions: Attach wellbore diagram of proposed completion or recompletion.

COG Operating LLC respectfully requests approval for the following changes to the original approved APD..

POOL From: WC-05 G-06 S26280500; UPR Wolfcamp 98195
To: Purple Sage; Wolfcamp 98220

BHL From: 200' FNL & 1518' FWL Section 16, T25S, R28E
To: 200' FNL & 1320' FWL Section 16, T25S, R28E

C102 attached.

DRILLING CHANGES: Operator will drill to TD at 19,568' MD.

Spud Date:

Rig Release Date:

I hereby certify that the information above is true and complete to the best of my knowledge and belief.

SIGNATURE Mayte Reyes TITLE: Regulatory Analyst DATE: 8/10/2017

Type or print name: Mayte Reyes E-mail address: mreyes1@conchoresources.com PHONE: (575) 748-6945

For State Use Only

APPROVED BY: Raymond D. Dwyer TITLE: Geologist DATE: 8-11-17

Conditions of Approval (if any):

District I
1625 N. French Dr., Hobbs, NM 88240
Phone: (575) 393-6161 Fax: (575) 393-0720
District II
811 S. First St., Artesia, NM 88210
Phone: (575) 748-1293 Fax: (575) 748-9720
District III
1000 Rio Bravos Road, Aztec, NM 87410
Phone: (505) 334-6178 Fax: (505) 334-6170
District IV
1220 S. St. Francis Dr., Santa Fe, NM 87505
Phone: (505) 476-3460 Fax: (505) 476-3462

State of New Mexico
Energy, Minerals & Natural Resources Department
OIL CONSERVATION DIVISION
1220 South St. Francis Dr.
Santa Fe, NM 87505

Form C-102
Revised August 1, 2011
Submit one copy to appropriate
District Office

☐ AMENDED REPORT

WELL LOCATION AND ACREAGE DEDICATION PLAT

¹ API Number 30-015-44004	² Pool Code 98220	³ Pool Name Purple Sage; Wolfcamp
⁴ Property Code 38521	⁵ Property Name MYOX 21 STATE COM	⁶ Well Number 34H
⁷ OGRID No. 229137	⁸ Operator Name COG OPERATING, LLC.	⁹ Elevation 2978.1

10 Surface Location

UL or lot no.	Section	Township	Range	Lot Idn	Feet from the	North/South line	Feet from the	East/West line	County
N	21	25 S	28 E		200	SOUTH	1649	WEST	EDDY

11 Bottom Hole Location If Different From Surface

UL or lot no.	Section	Township	Range	Lot Idn	Feet from the	North/South line	Feet from the	East/West line	County
D	16	25 S	28 E		200	NORTH	1320	WEST	EDDY

¹² Dedicated Acres 640	¹³ Joint or Infill	¹⁴ Consolidation Code	¹⁵ Order No.
---	-------------------------------	----------------------------------	-------------------------

No allowable will be assigned to this completion until all interests have been consolidated or a non-standard unit has been approved by the division.

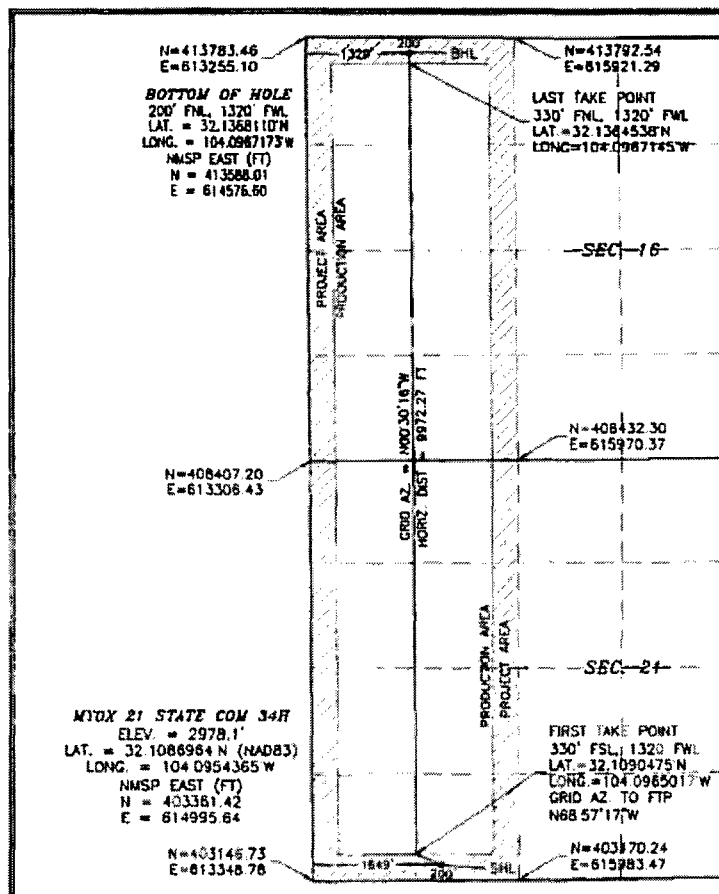

17 OPERATOR CERTIFICATION

I hereby certify that the information contained herein is true and complete to the best of my knowledge and belief, and that this organization either owns a working interest or mineral interest in the land including the proposed bottom hole location or has a right to drill this well at this location pursuant to a contract with an owner of such a mineral or working interest, or to a voluntary pooling agreement or a compulsory pooling order heretofore entered by the division.

Signature: **Mayte Reyes** Date: **8-10-13**

Printed Name: **Mayte Reyes**

E-mail Address: **mreyes1@concho.com**

18 SURVEYOR CERTIFICATION

I hereby certify that the well location shown on this plat was plotted from field notes of actual surveys made by me or under my supervision, and that the same is true and correct to the best of my belief.

Date of Survey: **JUNE 8, 2017**

Signature and Seal: **FILMON F. JARAMILLO**

Certificate Number: **114801E, 1284801D, 1284801D, 12797**
SURVEY NO. **4890D**