

District I
1625 N. French Dr., Hobbs, NM 88240
Phone: (575) 393-6161 Fax: (575) 393-0720
District II
811 S. First St., Artesia, NM 88210
Phone: (575) 748-1283 Fax: (575) 748-9720
District III
1000 Rio Brazos Road, Aztec, NM 87410
Phone: (505) 334-6178 Fax: (505) 334-6170
District IV
1220 S. St. Francis Dr., Santa Fe, NM 87505
Phone: (505) 476-3460 Fax: (505) 476-3462

State of New Mexico
Energy, Minerals & Natural Resources Department
OIL CONSERVATION DIVISION
1220 South St. Francis Dr.
Santa Fe, NM 87505

Form C-102
Revised August 1, 2011
Submit one copy to appropriate
District Office

☐ AMENDED REPORT

WELL LOCATION AND ACREAGE DEDICATION PLAT

¹ API Number 30-015-44897	² Pool Code 96473	³ Pool Name Pierce-Groves Wildcat, Bone Spring	⁴ Property Code 321273	⁵ Property Name POKER LAKE UNIT 18 BRUSHY DRAW	⁶ Well Number 701H
⁷ OGRID No. 260731	⁸ Operator Name BOPCO, L.P.	⁹ Elevation 3163'			

¹⁰ Surface Location

UL or lot no.	Section	Township	Range	Lot Idn	Feet from the	North/South line	Feet from the	East/West line	County
2	18	25 S	30 E		2,310	NORTH	510	WEST	EDDY

¹¹ Bottom Hole Location If Different From Surface

UL or lot no.	Section	Township	Range	Lot Idn	Feet from the	North/South line	Feet from the	East/West line	County
4	19	25 S	30 E		200	SOUTH	330	WEST	EDDY

¹² Dedicated Acres 240	¹³ Joint or Infill 242.62	¹⁴ Consolidation Code	¹⁵ Order No.
--------------------------------------	---	----------------------------------	-------------------------

No allowable will be assigned to this completion until all interests have been consolidated or a non-standard unit has been approved by the division.

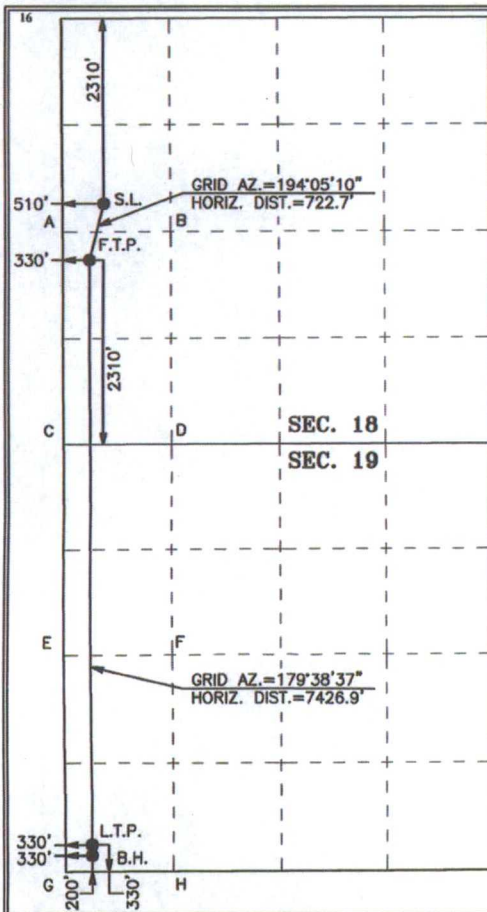

GEODETIC COORDINATES	GEODETIC COORDINATES
NAD 27 NME	NAD 83 NME
SURFACE LOCATION	SURFACE LOCATION
Y = 411,606.7	Y = 411,665.0
X = 625,696.9	X = 666,881.5
LAT. = 32.130972°N	LAT. = 32.131096°N
LONG. = 103.927276°W	LONG. = 103.927761°W
FIRST TAKE POINT	FIRST TAKE POINT
NAD 27 NME	NAD 83 NME
Y = 410,905.8	Y = 410,964.1
X = 625,521.0	X = 666,705.6
LAT. = 32.129047°N	LAT. = 32.129171°N
LONG. = 103.927853°W	LONG. = 103.928337°W

CORNER COORDINATES TABLE

NAD 27 NME	
A - Y = 411,254.3 N, X = 625,189.0 E	
B - Y = 411,260.5 N, X = 626,533.3 E	
C - Y = 408,594.2 N, X = 625,204.2 E	
D - Y = 408,601.2 N, X = 626,548.3 E	
E - Y = 405,935.1 N, X = 625,221.5 E	
F - Y = 405,943.0 N, X = 626,563.0 E	
G - Y = 403,277.4 N, X = 625,238.2 E	
H - Y = 403,285.0 N, X = 626,577.4 E	

CORNER COORDINATES TABLE

NAD 83 NME	
A - Y = 411,312.6 N, X = 666,373.6 E	
B - Y = 411,318.8 N, X = 667,717.9 E	
C - Y = 408,652.4 N, X = 666,388.9 E	
D - Y = 408,659.4 N, X = 667,733.0 E	
E - Y = 405,993.3 N, X = 666,406.3 E	
F - Y = 406,001.2 N, X = 667,747.8 E	
G - Y = 403,335.5 N, X = 666,423.1 E	
H - Y = 403,343.1 N, X = 667,762.3 E	

LAST TAKE POINT	LAST TAKE POINT
NAD 27 NME	NAD 83 NME
Y = 403,609.3	Y = 403,667.4
X = 625,566.1	X = 666,751.0
LAT. = 32.108989°N	LAT. = 32.109113°N
LONG. = 103.927795°W	LONG. = 103.928279°W

BOTTOM HOLE LOCATION	BOTTOM HOLE LOCATION
NAD 27 NME	NAD 83 NME
Y = 403,479.3	Y = 403,537.4
X = 625,566.9	X = 666,751.8
LAT. = 32.108631°N	LAT. = 32.108756°N
LONG. = 103.927794°W	LONG. = 103.928278°W

¹⁷ OPERATOR CERTIFICATION

I hereby certify that the information contained herein is true and complete to the best of my knowledge and belief, and that this organization either owns a working interest or unleased mineral interest in the land including the proposed bottom hole location or has a right to drill this well at this location pursuant to a contract with an owner of such a mineral or working interest, or to a voluntary pooling agreement or a compulsory pooling order heretofore entered by the division.

Stephanie Labadie 1-3-17
Signature Date

Stephanie Labadie
Printed Name

stephanie-labadie@xtoenergy.com
E-mail Address

¹⁸ SURVEYOR CERTIFICATION

I hereby certify that the well location shown on this plat was plotted from field notes of actual surveys made by me or under my supervision, and that the same is true and correct to the best of my belief.

1-3-2018

Date of Survey

Signature and Seal of Professional Surveyor:

MARK DILLON HARP 23786

Certificate Number

2017050629



Rw 4-25-18