

DISTRICT I
1625 N. French Dr., Hobbs, NM 88240

DISTRICT II
811 South First, Artesia, NM 88210

DISTRICT III
1000 Rio Brazos Rd., Aztec, NM 87410

DISTRICT IV
2040 South Pacheco, Santa Fe, NM 87505

State of New Mexico
Energy, Minerals and Natural Resources Department

OIL CONSERVATION DIVISION
PO BOX 2088
Santa Fe, NM 87504-2088



Form C-101
Revised March 17, 1999
Instructions on back
Submit to appropriate District Office
State Lease - 6 Copies
Fee Lease - 5 Copies

☐ AMENDED REPORT

APPLICATION FOR PERMIT TO DRILL, RE-ENTER, DEEPEN, PLUGBACK, OR ADD A ZONE

¹ Operator Name and Address Yates Petroleum Corporation 105 South Fourth Street Artesia, New Mexico 88210		² OGRID Number 025575
		³ API Number 30- 005- 62943
⁴ Property Code	⁵ Property Name Puffer "BDF" St. Com.	⁶ Well No. 2

⁷ Surface Location

Lot	Section	Township	Range	Lot Idn	Feet from the	North/South Line	Feet from the	East/West Line	County
L	24	8S	27E		1980'	South	1250'	West	Chaves

⁸ Proposed Bottom Hole Location If Different From Surface

Lot	Section	Township	Range	Lot Idn	Feet from the	North/South Line	Feet from the	East/West Line	County
⁹ Proposed Pool 1 Wildcat Ordovician						¹⁰ Proposed Pool 2			

¹¹ Work Type Code E	¹² Well Type Code G	¹³ Cable/Rotary R	¹⁴ Lease Type Code S	¹⁵ Ground Level Elevation 3959'
¹⁶ Multiple N	¹⁷ Proposed Depth 6800'	¹⁸ Formation Silurian	¹⁹ Contractor Not Determined	²⁰ Spud Date ASAP

²¹ Proposed Casing and Cement Program

Hole Size	Casing Size	Casing weight/feet	Setting Depth	Sacks of Cement	Estimated TOC
12 1/4"	8 5/8"	24#	1610'	950sx	In Place
7 7/8"	5 1/2"	15.5#	6800'	700sx	In Place

****Cement to cover all oil, gas and waterbearing zones.**

²² Describe the proposed program. If this application is to DEEPEN or PLUG BACK give the data on the present productive zone and proposed new productive zone. Describe the blowout prevention program, if any. Use additional sheets if necessary.

SEE ATTACHED PAGE 2.

²³ I hereby certify that the information given above is true and complete to the best of my knowledge and belief.		OIL CONSERVATION DIVISION	
Signature: <i>Pat Perez</i>		Approved by: <i>James W. Brown</i>	
Printed name: Pat Perez		Title: <i>District Supervisor</i>	
Title: Regulatory Agent		Approval Date: JUN 2 6 2003 Expiration Date: JUN 2 6 2004	
Date: 06/19/03	Phone: (505) /48-14/1	Conditions of Approval Attached <input type="checkbox"/>	

YATES PETROLEUM CORPORATION

Re-entry Procedure

State "BD" SWD #1

Drilling Prognosis

Page 2

This well was originally drilled by BHP Petroleum (Americas) Inc. As the Puffer State "A" #1 pm 2/18/93, and was plugged and abandoned on 4/2/93. Yates's plan is to re-enter the well w/ a pulling unit to drill out the cement plugs in the 8 5/8" casing & in the 7 7/8" open hole down to the original TD of 6,800' then a string of 5 1/2" casing will be run to TD & cemented to 4,400' +/- . The mud that will be used is 9.2-9.5 ppg brine water w/ a 55-70 cp viscosity.

The well will be completed w/ a pulling unit. The formations that a completion will probably be attempted in will be the Silurian @ 6,500' +/-, the Strawn @ 6,350' +/-, the Cisco @ 6,170' +/- or the Wolfcamp f/ 5,600' to 6,000.

District I

1625 N. French Dr., Hobbs, NM 88240

District II

811 South First, Artesia, NM 88210

District III

1000 Rio Brazos Rd., Aztec, NM 87410

District IV

1220 S. St. Francis Dr., Santa Fe, NM 87505

State of New Mexico

Energy, Minerals & Natural Resources Department

Form C-102

Revised August 15, 2000

OIL CONSERVATION DIVISION

1220 South St. Francis Dr.
Santa Fe NM 87505

Submit to Appropriate District Office

State Lease - 4 Copies

Fee Lease - 3 Copies



AMENDED REPORT

WELL LOCATION AND ACREAGE DEDICATION PLAT

¹ API Number 30-	² Pool Code	³ Pool Name
⁴ Property Code	⁵ Property Name Puffer "BDF" St. Com	⁶ Well Number 2
⁷ OGRID No. 025575	⁸ Operator Name Yates Petroleum Corporation	⁹ Elevation

¹⁰ Surface Location

UL or lot no. L	Section 24	Township 8S	Range 27E	Lot Idn	Feet from the 1980'	North/South line South	Feet from the 1250'	East/West line West	County Chaves
---------------------------	----------------------	-----------------------	---------------------	---------	-------------------------------	----------------------------------	-------------------------------	-------------------------------	-------------------------

¹¹ Bottom Hole Location If Different From Surface

UL or lot no.	Section	Township	Range	Lot Idn	Feet from the	North/South line	Feet from the	East/West line	County
¹² Dedicated Acres	¹³ Joint or Infill	¹⁴ Consolidation Code	¹⁵ Order No.						

NO ALLOWABLE WILL BE ASSIGNED TO THIS COMPLETION UNTIL ALL INTERESTS HAVE BEEN CONSOLIDATED OR A
NON-STANDARD UNIT HAS BEEN APPROVED BY THE DIVISION

¹⁶ 		¹⁷ OPERATOR CERTIFICATION I hereby certify that the information contained herein is true and complete to the best of my knowledge and belief.
		Signature Pat Perez Printed Name Regulatory Agent Title 6/19/03 Date
¹⁸ SURVEYOR CERTIFICATION I hereby certify that the well location shown on this plat was plotted from field notes of actual surveys made by me or under my supervision, and that the same is true and correct to the best of my belief. Date of Survey Signature and Seal of Professional Surveyor: See Original Plat		

DISTRICT I

P.O. Box 1980, Hobbs, NM 88240

DISTRICT II

P.O. Drawer DD, Artesia, NM 88210

DISTRICT III

1000 Rio Brazos Rd., Artec, NM 87410

OIL CONSERVATION DIVISION

P.O. Box 2088

Santa Fe, New Mexico 87504-2088

WELL LOCATION AND ACREAGE DEDICATION PLAT

All Distances must be from the outer boundaries of the section

Operator BHP PETROLEUM (AMERICAS) INC.			Lease PUFFER STATE "A"		Well No. 1
Unit Letter L	Section 24	Township 8 SOUTH	Range 27 EAST	County NMNM	CHAVES
Actual Footage Location of Well: 1980 feet from the SOUTH line and 1250 feet from the WEST line					
Ground Level Elev. 3959.2	Producing Formation Montoya	Pool Palma Mesa Siluro-Ordovician	Dedicated Acreage: 320 Acres		

1. Outline the acreage dedicated to the subject well by colored pencil or hatchure marks on the plat below.
2. If more than one lease is dedicated to the well, outline each and identify the ownership thereof (both as to working interest and royalty).
3. If more than one lease of different ownership is dedicated to the well, have the interest of all owners been consolidated by communitization, unitization, force-pooling, etc.?
☐ Yes ☐ No If answer is "yes" type of consolidation Consolidation Agreement Pending

If answer is "no" list of owners and tract descriptions which have actually been consolidated. (Use reverse side of this form necessary.)

No allowable will be assigned to the well unit all interests have been consolidated (by communitization, unitization, forced-pooling, otherwise) or until a non-standard unit, eliminating such interest, has been approved by the Division.

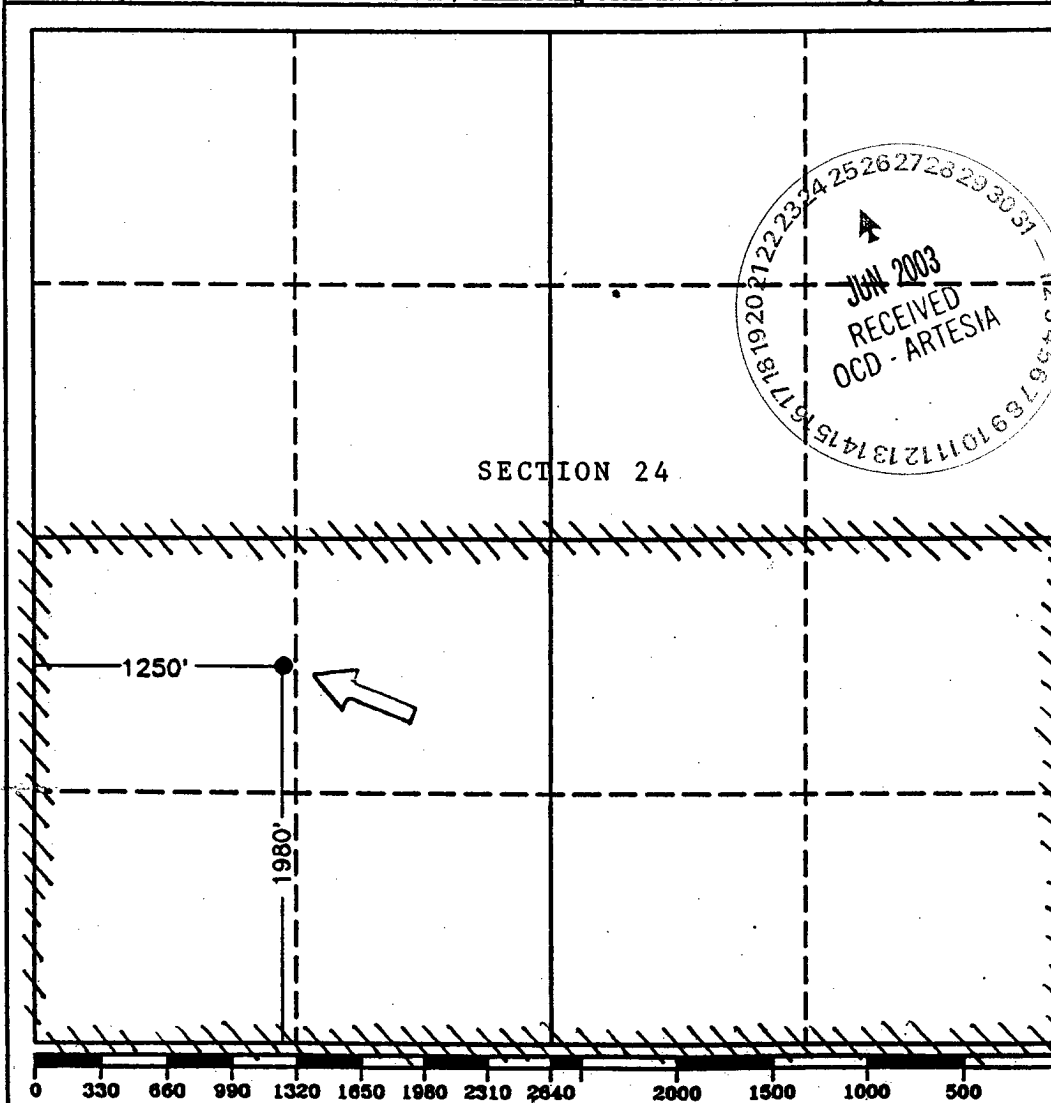

OPERATOR CERTIFICATION

I hereby certify the the information contained herein is true and complete to the best of my knowledge and belief.

Signature Carl Kolbe
Printed Name Carl Kolbe
Position Rep. Agg. Rep.
Company BHP Petroleum (A) Inc
Date 1/7/93

SURVEYOR CERTIFICATION

I hereby certify that the well location shown on this plat was plotted from field notes of actual surveys made by me or under my supervision, and that the same is true and correct to the best of my knowledge and belief.

Date Surveyed
DECEMBER 21, 1992
Signature & Seal of Professional Surveyor

Signature Carl L. Jones
License No. 7917
Commission Expires 12/31/95



Yates Petroleum Corporation

BOP-3

Typical 3,000 psi Pressure System Schematic Annular with Double Ram Preventer Stack

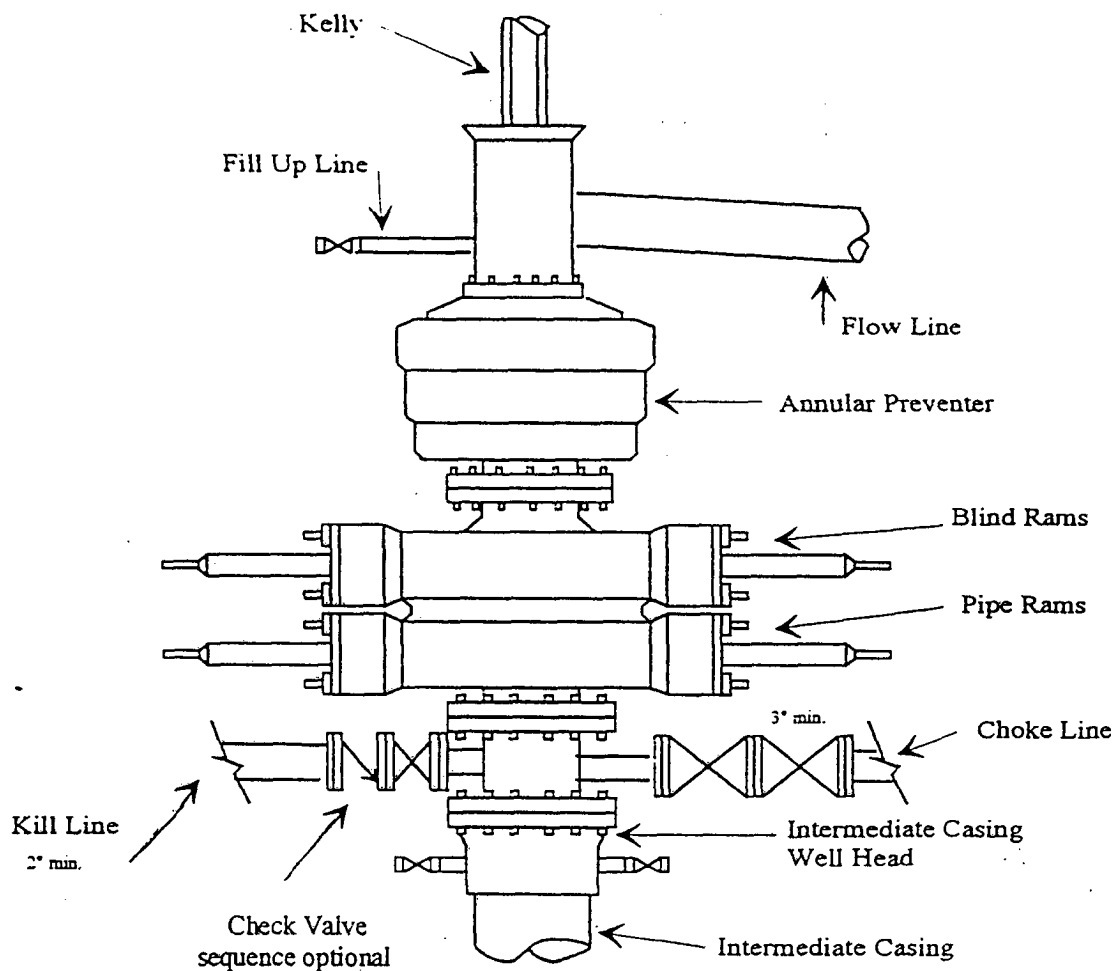

Typical 3,000 psi choke manifold assembly with at least these minimum features

