

UNITED STATES  
DEPARTMENT OF THE INTERIOR  
BUREAU OF LAND MANAGEMENT

OCD-ARTESIA

## WELL COMPLETION OR RECOMPLETION REPORT AND LOG

FORM APPROVED  
OMB NO. 1004-0137  
Expires: March 31, 2007

1a. Type of Well ☒ Oil Well ☐ Gas Well ☐ Dry ☐ Other  
b. Type of Completion ☐ New Well ☐ Work Over ☐ Deepen ☐ Plug Back ☐ Diff. Resvr.,  
Other \_\_\_\_\_

2. Name of Operator  
Bass Enterprises Production Co.

3. Address  
P. O. Box 2760 Midland TX 79702

3.a Phone No. (Include area code)  
(432)683-2277

4. Location of Well (Report location clearly and in accordance with Federal requirements)\*

At Surface SESW 250 FSL, 1980 FWL

At top prod. interval reported below SAME

At total depth SAME

RECEIVED  
DEC 16 2005  
OCD-ARTESIA

5. Lease Serial No.  
NMNM04473

6. If Indian, Allottee or Tribe Name

7. Unit or CA Agreement Name and no.  
NMNM70965

8. Lease Name and Well No.

JAMES RANCH UNIT 87

9. API Well No.

30-015-34277

10. Field and Pool, or Exploratory  
LOS MEDANOS

11. Sec., T., R., M., on Block and  
Survey or Area SEC 6, T23S, R31E

12. County or Parish  
EDDY

13. State  
NM

14. Date Spudded

09/10/2005

15. Date T.D. Reached

10/12/2005

16. Date Completed

☐ D & A ☒ Ready to Prod.  
11/15/2005

17. Elevations (DF, RKB, RT, GL)\*

3301' GL

18. Total Depth: MD 11,340'  
TVD

19. Plug Back T.D.: MD 11,283'  
TVD

20. Depth Bridge Plug Set: MD  
TVD

21. Type of Electric & Other Mechanical Logs Run (Submit copy of each)  
GR-CNL-LDT; GR-AIT

22. Was well cored? ☒ No ☐ Yes (Submit analysis)  
Was DST run? ☒ No ☐ Yes (Submit analysis)  
Directional Survey? ☐ No ☒ Yes (Submit copy)

23. Casing and Liner Record (Report all strings set in well)

Hole Size	Size/Grade	Wt. (#/ft.)	Top (MD)	Bottom (MD)	Stage Cementer Depth	No. of Sk. & Type of Cement	Slurry Vol. (BBL)	Cement Top*	Amount Pulled
14-3/4"	11-3/4"	42#	0	617'		270		0'	
11"	8-5/8"	32#	0	3946'		1020		0'	
7-7/8"	5-1/2"	20#		11324'		2000		2720 BY TS	

24. Tubing Record

Size	Depth Set (MD)	Packer Depth (MD)	Size	Depth Set (MD)	Packer Depth (MD)	Size	Depth Set (MD)	Packer Depth (MD)

25. Producing Intervals

26. Perforation Record

Formation	Top	Bottom	Perforated Interval	Size	No. Holes	Perf. Status
A) BONE SPRING	11,002'	11,016'	11,002' - 11,016'	0.470	14	PRODUCING
B) WOLFCAMP	11,200'	11,210'	11,200' - 11,210'	0.470	10	PRODUCING
C)						
D)						

27. Acid, Fracture, Treatment, Cement Squeeze, Etc.

Depth Interval	Amount and Type of Material
11,002' - 11,210'	2,082 BBLs MEDALLION 3000 + 191,239# 20/40 OTTAWA + 64,090# 20/40 VERSA PROP

28. Production - Interval A

Date First Produced	Test Date	Hours Tested	Test Production	Oil BBL	Gas MCF	Water BBL	Oil Gravity Corr. API	Gas Gravity	Production Method
11/15/05	11/29/05	24	→	137	246	98			FLOW FROM WELL OR RECORD
Choke Size	Tbg. Press. Flwg.	Csg. Press.	24 Hr. Rate	Oil BBL	Gas MCF	Water BBL	Gas : Oil Ratio	Well Status	
16/64"	SI N/A	750	→	137	246	98		FLOW	

Production - Interval B

Date First Produced	Test Date	Hours Tested	Test Production	Oil BBL	Gas MCF	Water BBL	Oil Gravity Corr. API	Gas Gravity	Production Method
11/15/05	11/29/05	24	→	137	246	98			FLOW FROM WELL BY AK
Choke Size	Tbg. Press. Flwg.	Csg. Press.	24 Hr. Rate	Oil BBL	Gas MCF	Water BBL	Gas : Oil Ratio	Well Status	
16/64"	SI N/A	750	→	137	246	98		FLOW	

(See Instructions and spaces for additional data on page 2)

## 28b. Production - Interval C

Date First Produced	Test Date	Hours Tested	Test Production →	Oil BBL	Gas MCF	Water BBL	Oil Gravity Corr. API	Gas Gravity	Production Method
Choke Size	Tbg. Press. Flwg. SI	Csg. Press.	24 Hr. Rate →	Oil BBL	Gas MCF	Water BBL	Gas : Oil Ratio	Well Status	

## 28c. Production - Interval D

Date First Produced	Test Date	Hours Tested	Test Production →	Oil BBL	Gas MCF	Water BBL	Oil Gravity Corr. API	Gas Gravity	Production Method
Choke Size	Tbg. Press. Flwg. SI	Csg. Press.	24 Hr. Rate →	Oil BBL	Gas MCF	Water BBL	Gas : Oil Ratio	Well Status	

## 29. Disposition of Gas (Sold, used for fuel, vented, etc.)

SOLD

## 30. Summary of Porous Zones (Include Aquifers):

Show all important zones or porosity and contents thereof: Cored intervals and all drill-stem tests, including depth interval tested, cushion used, time tool open, flowing and shut-in pressures and recoveries.

## 31. Formation (Log) Markers

Formation	Top	Bottom	Descriptions, Contents, etc.	Name	Top Meas. Depth
				T/RUSTLER	270'
				T/SALT	620'
				B/SALT	3710'
				T/DELAWARE MTN GROUP	3940'

## 32. Additional remarks (include plugging procedure):

THIS WELL IS FLOWING IN CASING.

## 33. Indicate which items have been attached by placing a check in the appropriate boxes:

- ☐ Electrical/Mechanical Logs (1 full set req'd.)   
 ☐ Geological Report   
 ☐ DST Report   
 ☐ Directional Survey  
☐ Sundry Notice for plugging and cement verification   
 ☐ Core Analysis   
 ☐ Other

## 34. I hereby certify that the foregoing and attached information is complete and correct as determined from all available records (see attached instructions)\*

Name (please print) Cindi GoodmanTitle Production ClerkSignature Cindi GoodmanDate 12/01/2005

Title 18 U.S.C. Section 101 and Title 43 U.S.C. Section 1212, make it a crime for any person knowingly and willfully to make to any department or agency of the United States and false, fictitious or fraudulent statements or representations as to any matter within its jurisdiction.

DISTRICT I  
1025 N. French Dr., Hobbs, NM 88240

DISTRICT II  
611 South First, Artesia, NM 88210

DISTRICT III  
1009 Rio Brazos Rd., Artesia, NM 87410

DISTRICT IV  
2040 South Pacheco, Santa Fe, NM 87506

State of New Mexico  
Energy, Minerals and Natural Resources Department

Form C-102  
Revised March 17, 1999

Submit to Appropriate District Office  
State Lease - 4 Copies  
Fee Lease - 3 Copies

OIL CONSERVATION DIVISION

2040 South Pacheco  
Santa Fe, New Mexico 87504-2088

☐ AMENDED REPORT

WELL LOCATION AND ACREAGE DEDICATION PLAT

API Number 30-015-34277	Pool Code 40295	Pool Name LOS MEDANOS BONE SPRING
Property Code 001786	Property Name JAMES RANCH UNIT	Well Number 87
OGRID No. 001801	Operator Name BASS ENTERPRISES PRODUCTION COMPANY	Elevation 3301'

Surface Location

UL or lot No.	Section	Township	Range	Lot Idn	Feet from the	North/South line	Feet from the	East/West line	County
N	6	23 S	31 E		250	SOUTH	1980	WEST	EDDY

Bottom Hole Location If Different From Surface

UL or lot No.	Section	Township	Range	Lot Idn	Feet from the	North/South line	Feet from the	East/West line	County
Dedicated Acres 40	Joint or Infill N	Consolidation Code	Order No.						

NO ALLOWABLE WILL BE ASSIGNED TO THIS COMPLETION UNTIL ALL INTERESTS HAVE BEEN CONSOLIDATED  
OR A NON-STANDARD UNIT HAS BEEN APPROVED BY THE DIVISION

LOT 4 - 40.45 AC.	LOT 3 - 39.90 AC.	LOT 2 - 39.94 AC.	LOT 1 - 39.98 AC.	<p>RECEIVED DEC 16 2005 OCD-ARTESIA</p>	<p><b>OPERATOR CERTIFICATION</b></p> <p>I hereby certify that the information contained herein is true and complete to the best of my knowledge and belief.</p> <p><i>William R. Dannels</i> Signature</p> <p>Printed Name W.R. DANNELS</p> <p>Title DIVISION DRILLING SUPT.</p> <p>Date 11/29/05</p>
LOT 5 - 40.79 AC.					
LOT 6 - 40.96 AC.					
LOT 7 - 41.13 AC.	<p>LAT - N32°19'37.6" LONG - W103°49'08.9"</p> <p>3300.9' 3302.8' 3301.0' 3300.7'</p> <p>250'</p> <p>1980'</p>			<p><b>SURVEYOR CERTIFICATION</b></p> <p>I hereby certify that the well location shown on this plat was plotted from field notes of actual surveys made by me or under my supervision, and that the same is true and correct to the best of my belief.</p> <p>July 28, 2000</p> <p>Date Surveyed</p> <p>Signature of Professional Surveyor <i>GARY L. GORRY</i></p> <p>Professional Surveyor NEW MEXICO W.07986. 0426A Certificate No. Gary L. 7977</p>	

DISTRICT I  
1625 N. French Dr., Hobbs, NM 88240

DISTRICT II  
511 South First, Artesia, NM 88210

DISTRICT III  
1000 Rio Brazos Rd., Artesia, NM 87410

DISTRICT IV  
2040 South Pacheco, Santa Fe, NM 87506

State of New Mexico  
Energy, Minerals and Natural Resources Department

Form C-102  
Revised March 17, 1999

Submit to Appropriate District Office  
State Lease - 4 Copies  
Fee Lease - 3 Copies

OIL CONSERVATION DIVISION

2040 South Pacheco  
Santa Fe, New Mexico 87504-2088

☐ AMENDED REPORT

WELL LOCATION AND ACREAGE DEDICATION PLAT

API Number 30-015-34277	Pool Code 96336	Pool Name LOS MEDANOS WOLFCAMP
Property Code 001 786	Property Name JAMES RANCH UNIT	Well Number 87
OGRID No. 001801	Operator Name BASS ENTERPRISES PRODUCTION COMPANY	Elevation 3301'

Surface Location

UL or lot No.	Section	Township	Range	Lot Idn	Feet from the	North/South line	Feet from the	East/West line	County
N	6	23 S	31 E		250	SOUTH	1980	WEST	EDDY

Bottom Hole Location If Different From Surface

UL or lot No.	Section	Township	Range	Lot Idn	Feet from the	North/South line	Feet from the	East/West line	County
Dedicated Acres 40	Joint or Infill N	Consolidation Code	Order No.						

NO ALLOWABLE WILL BE ASSIGNED TO THIS COMPLETION UNTIL ALL INTERESTS HAVE BEEN CONSOLIDATED  
OR A NON-STANDARD UNIT HAS BEEN APPROVED BY THE DIVISION

LOT 4 - 40.45 AC.	LOT 3 - 39.90 AC.	LOT 2 - 39.94 AC.	LOT 1 - 39.98 AC.	<p>RECEIVED DEC 16 2005 OCU-ARTESIA</p>	<p>OPERATOR CERTIFICATION</p> <p>I hereby certify the the information contained herein is true and complete to the best of my knowledge and belief.</p> <p><u>William R. Dannels</u> Signature</p> <p>Printed Name W.R. DANNELS</p> <p>Title DIVISION DRILLING SUPT.</p> <p>Date 11/29/05</p>
LOT 5 - 40.79 AC.					<p>SURVEYOR CERTIFICATION</p> <p>I hereby certify that the well location shown on this plat was plotted from field notes of actual surveys made by me or under my supervision, and that the same is true and correct to the best of my belief.</p> <p>July 28, 2000</p> <p>Date Surveyed</p> <p>Signature of Surveyor Professional Surveyor GARY L. JENSEN NEW MEXICO W.07940. 0426A Certificate No. Gary L. Jensen 7977</p>
LOT 6 - 40.96 AC.					
LOT 7 - 41.13 AC.					

LAT - N32°19'37.6"  
LONG - W103°49'08.9"

1980'

3300.9'

3302.8'

3301.0'

3300.7'

**SECTION 6, TOWNSHIP 23 SOUTH, RANGE 31 EAST, N.M.P.M.,  
EDDY COUNTY, NEW MEXICO.**

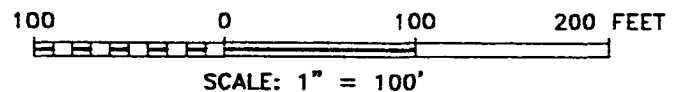
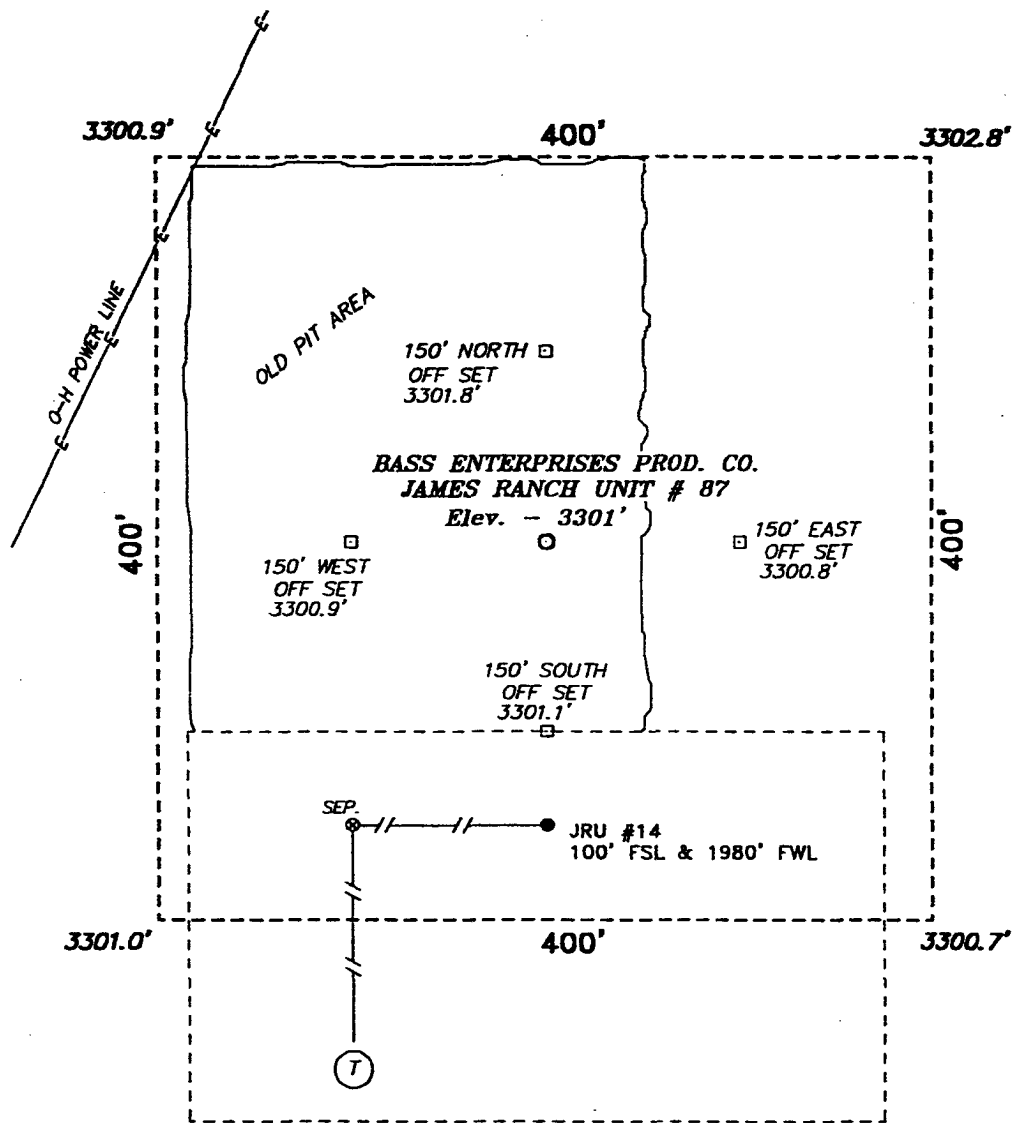

**DIRECTIONS:**

From the intersection to State Hwy #128 and WIPP Road, go East of State Hwy 128; Thence east approx. 3000 feet to a point whihc lies south 800 feet of the location.

**BASIN SURVEYS** P.O. BOX 1786-HOBBS, NEW MEXICO

W.O. Number: 0426

Drawn By: K. GOAD

Date: 08-01-2000 Disk: KJG #123 - 0426A.DWG

**BASS ENTERPRISES PRODUCTION CO.**

REF: JAMES RANCH Unit No. 87 / Well Pad Topo

THE JAMES RANCH Unit No. 87 LOCATED 250' FROM  
THE SOUTH LINE AND 1980' FROM THE WEST LINE OF  
SECTION 6, TOWNSHIP 23 SOUTH, RANGE 31 EAST,  
N.M.P.M., EDDY COUNTY, NEW MEXICO.

Survey Date: 07-28-2000 Sheet 1 of 1 Sheets



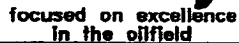
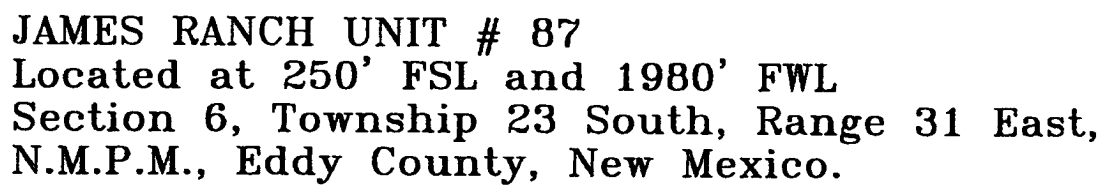

**BASS ENTERPRISES  
PRODUCTION CO.**

## INCLINATION REPORT

DATE: 10/20/05

WELL NAME : JAMES RANCH UNIT #87  
LOCATION: Eddy County, New Mexico  
OPERATOR: BASS ENTERPRISES  
DRILLING CONTRACTOR: GREY WOLF DRILLING COMPANY, LP  
RIG 15

I, Freddie Rios, do hereby certify, that the following inclination report was prepared in the office of GREY WOLF DRILLING COMPANY, LP in Midland, Texas, under my supervision, from records of said well, and is true and correct to the best of my knowledge:

DEGREE	DEPTH	DEGREE	DEPTH	DEGREE	DEPTH	DEGREE	DEPTH
1.25	@ 276	2	@ 3744	.5	7320	.5	10265
.25	@ 625	1	@ 3862	.5	7635	.5	10415
.5	@ 948	.5	@ 4176	.5	7960	.5	10607
.5	@ 1260	.5	@ 4309	.5	7945	.5	10831
.5	@ 1582	.5	@ 4683	1	8341	.5	10999
.5	@ 1774	1	@ 5082	.5	8628	.5	11340
.5	@ 2094	.5	@ 5468	.5	8880		
.5	@ 2440	.5	@ 5860	1	9167		
1	@ 2649	.5	@ 6260	1	9464		
.5	@ 2991	1	@ 6451	.5	9554		
.5	@ 3270	.5	@ 6648	.5	9872		
2.5	@ 3651	.5	7030	1.5	10062		

Drilling Contractor:  
Grey Wolf Drilling Company, LP

By: Freddie Rios  
Freddie Rios

Subscribed and sworn to before me on this 9th day of Nov., 2005.

My Commission Expires: 2-15-06

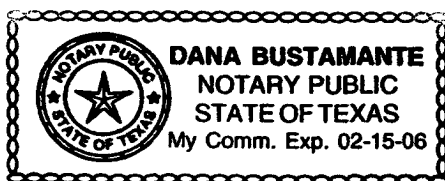

By: Dana Bustamante  
Notary Public