

Submit 3 Copies To Appropriate District Office
District I
1625 N. French Dr., Hobbs, NM 88240
District II
1301 W. Grand Ave., Artesia, NM 88210
District III
1000 Rio Brazos Rd., Aztec, NM 87410
District IV
1220 S. St. Francis Dr., Santa Fe, NM 87505

State of New Mexico
Energy, Minerals and Natural Resources

Form C-103
May 27, 2004

OIL CONSERVATION DIVISION
1220 South St. Francis Dr.
Santa Fe, NM 87505

WELL API NO.	30-005-63703
5. Indicate Type of Lease STATE <input type="checkbox"/> FEE <input checked="" type="checkbox"/>	
6. State Oil & Gas Lease No.	
7. Lease Name or Unit Agreement Name Tyrell 13 Federal Com	
8. Well Number	004
9. OGRID Number	147179
10. Pool name or Wildcat Pecos Slope; Abo	

SUNDRY NOTICES AND REPORTS ON WELLS
(DO NOT USE THIS FORM FOR PROPOSALS TO DRILL OR TO DEEPEN OR PLUG BACK TO A DIFFERENT RESERVOIR. USE "APPLICATION FOR PERMIT" (FORM C-101) FOR SUCH PROPOSALS.)

1. Type of Well: Oil Well ☐ Gas Well ☒ Other ☐

2. Name of Operator
Chesapeake Operating Inc.

3. Address of Operator P.O. Box 11050
Midland, TX 79702-8050

4. Well Location
Unit Letter A : 660 feet from the North line and 800 feet from the East line
Section 13 Township 10S Range 25E NMPM County Chaves

11. Elevation (Show whether DR, RKB, RT, GR, etc.)
3812 GR

Pit or Below-grade Tank Application ☐ or Closure ☒

Pit type Depth to Groundwater 50 + Distance from nearest fresh water well 1000+ Distance from nearest surface water 1000+

Pit Liner Thickness: mil Below-Grade Tank: Volume bbls; Construction Material

12. Check Appropriate Box to Indicate Nature of Notice, Report or Other Data

NOTICE OF INTENTION TO:

PERFORM REMEDIAL WORK ☐ PLUG AND ABANDON ☐
TEMPORARILY ABANDON ☐ CHANGE PLANS ☐
PULL OR ALTER CASING ☐ MULTIPLE COMPL ☐

SUBSEQUENT REPORT OF:

REMEDIAL WORK ☐ ALTERING CASING ☐
COMMENCE DRILLING OPNS. ☐ P AND A ☐
CASING/CEMENT JOB ☐

OTHER: Close drilling pit ☒

OTHER: ☐

13. Describe proposed or completed operations. (Clearly state all pertinent details, and give pertinent dates, including estimated date of starting any proposed work). SEE RULE 1103. For Multiple Completions: Attach wellbore diagram of proposed completion or recompletion.

Chesapeake, respectfully, request permission to close the drilling pit for this well. As per OCD rule 50 we will dig the hole to encapsule mud using 20 mil plastic in pit and 20 mil on top. We will then top with 3' of clean dirt off of site.

I hereby certify that the information above is true and complete to the best of my knowledge and belief. I further certify that any pit or below-grade tank has been/will be constructed or closed according to NMOCD guidelines ☐, a general permit ☐ or an (attached) alternative OCD-approved plan ☒.

SIGNATURE Shay Stricklin TITLE Regulatory Assistant DATE 06/09/2006

Type or print name Shay Stricklin

E-mail address: sstricklin@chkenergy.com

Telephone No. (432)687-2992

For State Use Only

APPROVED BY: [Signature] TITLE DATE JUN 19 2006
Conditions of Approval (if any)



PHONE (505) 397-6388 • FAX (505) 397- 0397 • 1324 W. MARLAND • P.O. BOX 805 • HOBBS, NM 88241-0805
E-MAIL: cbrunson@bbcinternational.com

June 3, 2006

Van Barton
New Mexico Oil Conservation Division
1301 W. Grand Ave.
Artesia, NM 88210

**RE: Chesapeake Operating, Inc. – Deep Burial Closure Request
Tyrell 13 Federal Well #4
Section 11, T10S, R25E, UL: A
Chaves County, NM**

Dear Mr. Barton:

On behalf of Chesapeake Operating, Inc. (Chesapeake), BBC International, Inc. (BBC) respectfully requests to utilize a deep burial trench lined with 20 mil plastic, a 20 mil plastic cap, and three (3) feet of top soil for the closure of the reserve pits located at the above referenced well site.

A water well search of the USGS and State Engineer Office (SEO) online web sites did not locate any water wells in the section in which the well is located. A larger search was conducted for surrounding sections and the adjoining township and range. One water well was located in the adjoining section to the northwest, Section 11, T10S, R25E using the SEO database. The average depth of this well is 158 feet below ground surface. The RA number for this well is 04837. This well is located approximately one mile to the east of the oil well site (see attached diagram and SEO print out).

A ranch house that is approximately two (2) miles north northeast of the well location has a domestic water well with an approximate average depth of 35 feet according to the home owner. However, the Tyrell 13 Federal Well #4 location is located on a hill that is approximately 100 feet higher in elevation according to the GPS instrument used in the search. In addition, the rancher has a windmill located approximately ½ mile south southeast of his house and the depth to water there is approximately 70 feet according to him. The windmill is also lower in elevation by approximately the same 100 feet to the Chesapeake well.

Therefore, utilizing this information, Chesapeake submits this C-103 for approval utilizing deep burial as the method for closure. Thank you for your consideration.

Sincerely,

Cliff P. Brunson, CEI, CRS
President

CPB: jg

Attachments

cc: Brad Blevins-Chesapeake-Hobbs, NM
Shay Stricklin-Chesapeake-Midland, TX



PHONE (505) 397-6388 • FAX (505) 397-0397 • 1324 W. MARLAND • P.O. BOX 805 • HOBBS, NM 88241-0805
E-MAIL: cbrunson@bbcinternational.com

Groundwater Plot

R 25 E

Oil/Gas Well Name: Chesapeake Tyrell 13 Federal Well #4 R 26 E

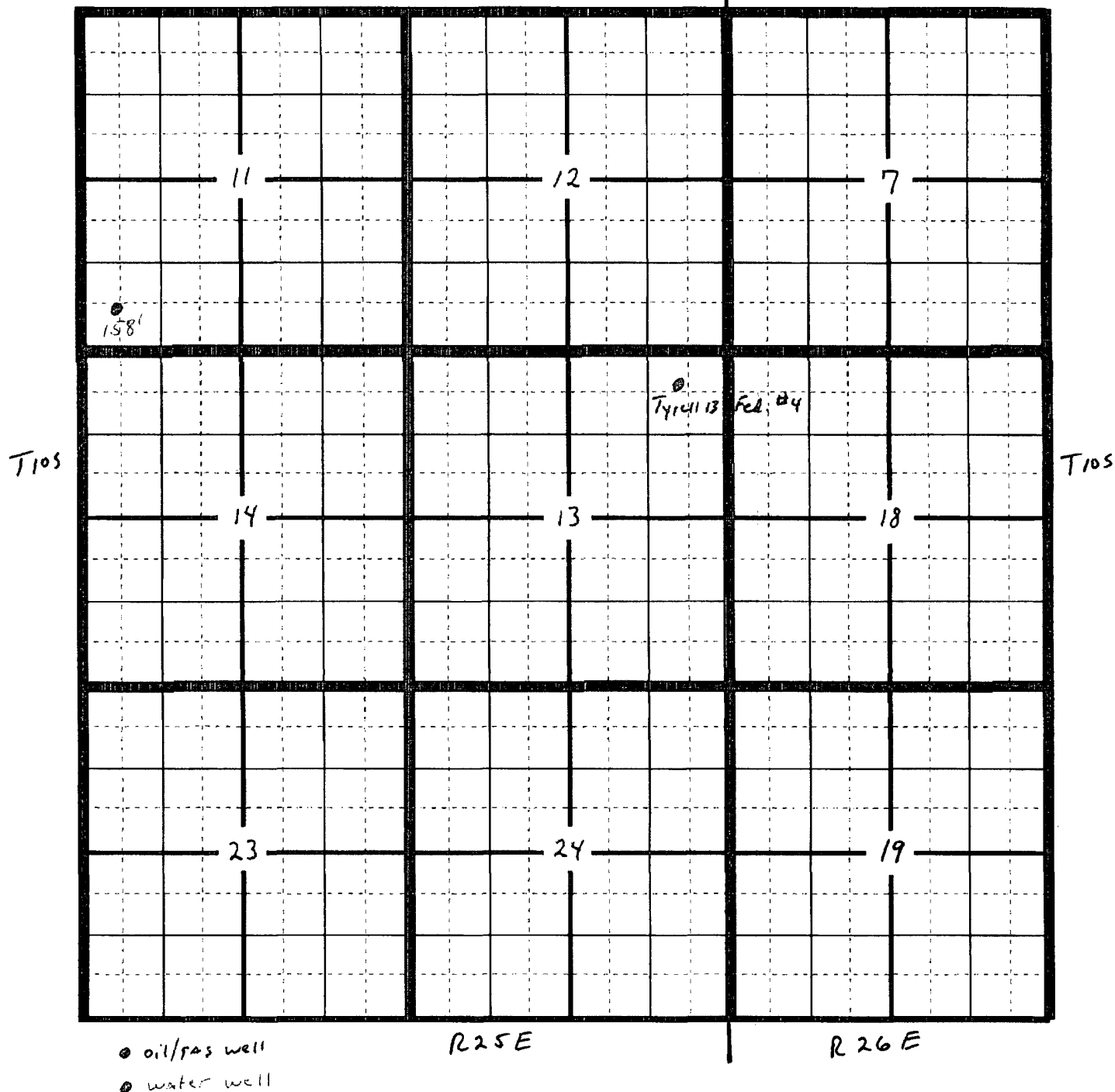

New Mexico Office of the State Engineer
POD Reports and Downloads

Township: 10S Range: 25E Sections: 11

NAD27 X: Y: Zone: Search Radius:

County: CH Basin: Number: Suffix:

Owner Name: (First) (Last) Non-Domestic Domestic All

POD / Surface Data Report

Avg Depth to Water Report

Water Column Report

Clear Form

iWATERS Menu

Help

WATER COLUMN REPORT 06/03/2006

(quarters are 1=NW 2=NE 3=SW 4=SE)
(quarters are biggest to smallest)

POD Number	Tws	Rng	Sec	q	q	q	Zone	X	Y	Depth Well	Depth Water	Water (in feet) Column
RA 04837	10S	25E	11	3	3					207	158	49

Record Count: 1

New Mexico Office of the State Engineer
POD Reports and Downloads

Township: 10S Range: 25E Sections: 11

NAD27 X: Y: Zone: Search Radius:

County: CH Basin: Number: Suffix:

Owner Name: (First) (Last) Non-Domestic Domestic All

POD / Surface Data Report

Avg Depth to Water Report

Water Column Report

Clear Form

WATERS Menu

Help

AVERAGE DEPTH OF WATER REPORT 06/03/2006

Bsn	Tws	Rng	Sec	Zone	X	Y	Wells	(Depth Water in Feet)		
								Min	Max	Avg
RA	10S	25E	11				1	158	158	158

Record Count: 1