

DISTRICT I

1625 N. French Dr., Hobbs, NM 88240

DISTRICT II

1301 W. Grand Avenue, Artesia, NM 88210

DISTRICT III

1000 Rio Brazos Rd., Aztec, NM 87410

DISTRICT IV

1220 St. Francis Dr., Santa Fe, NM 87505

State of New Mexico
Energy, Minerals and Natural Resources Department

OIL CONSERVATION DIVISION

1220 South St. Francis Dr.
Santa Fe, New Mexico 87505

Form C-102

Revised October 12, 2006

Submit to Appropriate District Office

State Lease - 4 Copies

Fee Lease - 3 Copies

☐ AMENDED REPORT

WELL LOCATION AND ACREAGE DEDICATION PLAT

API Number 30-015-35769	Pool Code 24340	Pool Name Fenton Draw (Strawn)
Property Code 001776	Property Name BIG EDDY UNIT	Well Number 169
OGRIID No. 001801	Operator Name BEPCO, L.P.	Elevation 3197'

Surface Location

UL or lot No.	Section	Township	Range	Lot Idn	Feet from the	North/South line	Feet from the	East/West line	County
C	17	21 S	28 E		660	NORTH	1830	WEST	EDDY

Bottom Hole Location If Different From Surface

UL or lot No.	Section	Township	Range	Lot Idn	Feet from the	North/South line	Feet from the	East/West line	County

Dedicated Acres 320	Joint or Infill N	Consolidation Code	Order No.
-------------------------------	-----------------------------	--------------------	-----------

NO ALLOWABLE WILL BE ASSIGNED TO THIS COMPLETION UNTIL ALL INTERESTS HAVE BEEN CONSOLIDATED
OR A NON-STANDARD UNIT HAS BEEN APPROVED BY THE DIVISION

	OPERATOR CERTIFICATION I hereby certify that the information contained herein is true and complete to the best of my knowledge and belief, and that this organization either owns a working interest or unleased mineral interest in the land including the proposed bottom hole location pursuant to a contract with an owner of such a mineral or working interest, or to a voluntary pooling agreement or a compulsory pooling order heretofore entered by the division. Signature: <i>Gary E. Gerhard</i> Date: <i>8/24/06</i> Printed Name: Gary E. Gerhard	
	SURVEYOR CERTIFICATION I hereby certify that the well location shown on this plat was plotted from field notes of actual surveys made by me or under my supervision, and that the same is true and correct to the best of my belief. Date Surveyed: July 07, 2006 Signature: <i>[Signature]</i> Professional Surveyor: 7977 Certificate No.: 6802 Certificate No.: Gary L. Jones 7977	
	BASIN SURVEYS	

**SECTION 17, TOWNSHIP 21 SOUTH, RANGE 28 EAST, N.M.P.M.,
EDDY COUNTY, NEW MEXICO.**

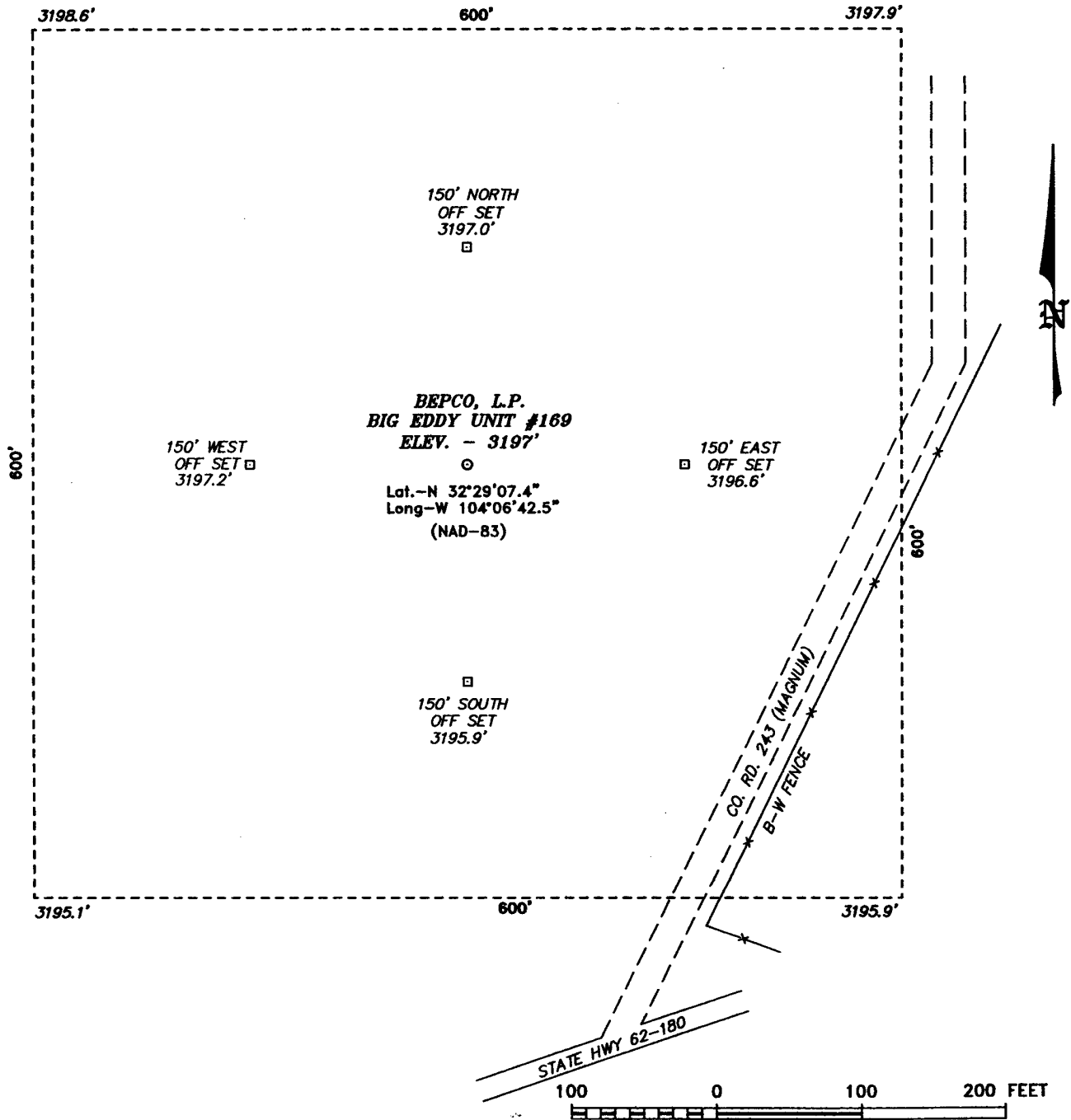

DIRECTIONS TO LOCATION:

FROM THE JUNCTION OF STATE HWY 62-180 AND CO. RD 243 (MAGNUM), PROCEED NORTH ON CO. RD. 243 FOR 0.1 MILE TO PROPOSED LOCATION.

100 0 100 200 FEET
SCALE: 1" = 100'

BASIN SURVEYS P.O. BOX 1786-HOBBS, NEW MEXICO

W.O. Number: 6592 Drawn By: J. M. SMALL

Date: 07-12-2006 Disk: JMS 6592W

BEPCO, L.P.

REF: BIG EDDY UNIT No. 169 / Well Pad Topo

THE BIG EDDY UNIT No. 169 LOCATED 660' FROM
THE NORTH LINE AND 1830' FROM THE WEST LINE OF
SECTION 17, TOWNSHIP 21 SOUTH, RANGE 28 EAST,
N.M.P.M., EDDY COUNTY, NEW MEXICO.

Survey Date: 07-07-2006 Sheet 1 of 1 Sheets

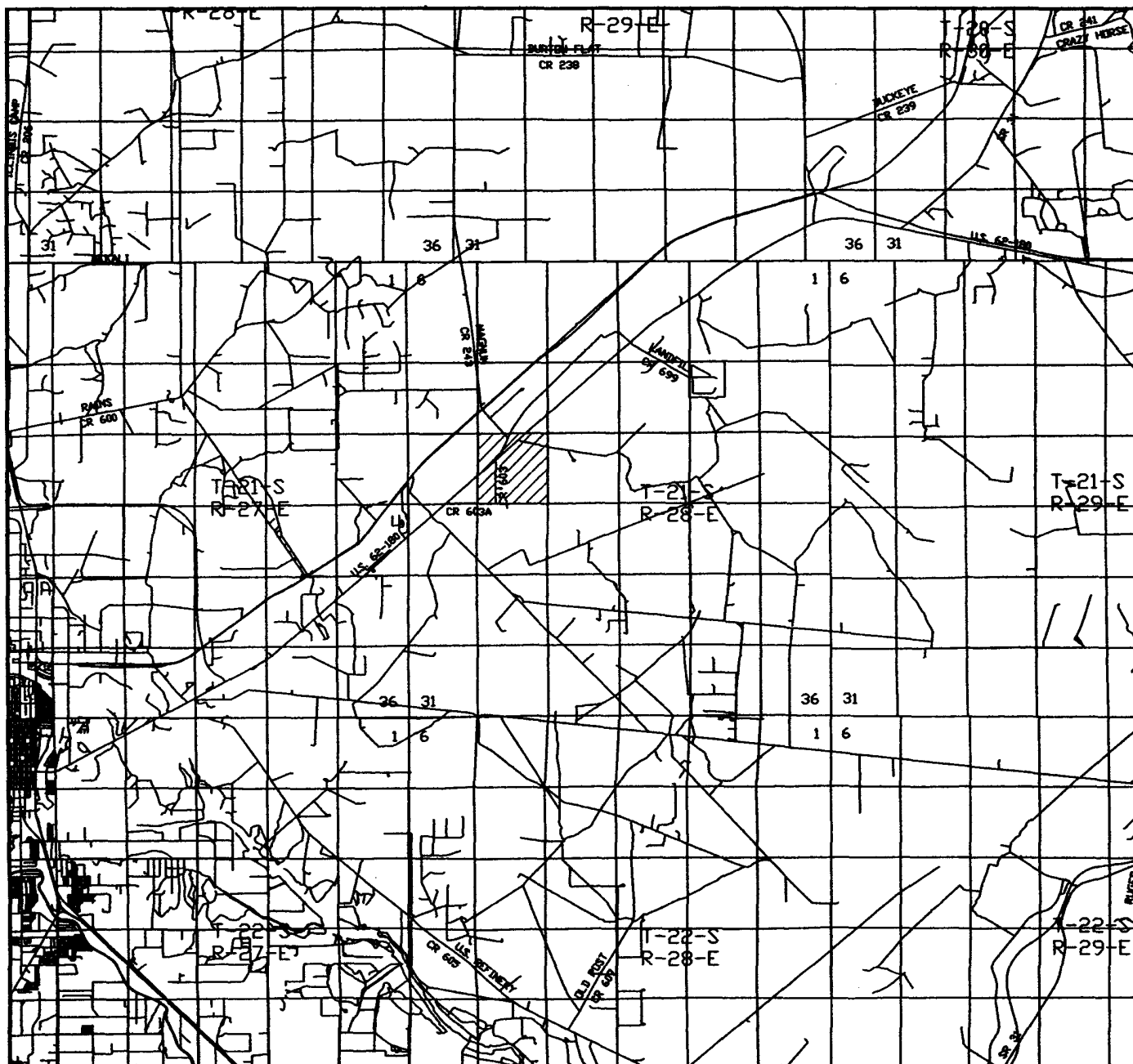

BIG EDDY UNIT #169

Located at 660' FNL and 1830' FWL

Section 17, Township 21 South, Range 28 East,
N.M.P.M., Eddy County, New Mexico.

**basin
surveys**

focused on excellence
in the oilfield

P.O. Box 1786
1120 N. West County Rd.
Hobbs, New Mexico 88241
(505) 393-7316 - Office
(505) 392-3074 - Fax
basinsurveys.com

W.O. Number: 6592T

Survey Date: 07-07-2006

Scale: 1" = 2000'

Date: 07-12-2006

BEPCO, L.P.