

Submit 3 Copies To Appropriate District
Office
District I
1625 N. French Dr., Hobbs, NM 87240
District II
1301 W. Grand Ave., Artesia, NM 88210
District III
1000 Rio Brazos Rd., Aztec, NM 87410
District IV
1220 S. St. Francis Dr., Santa Fe, NM 87505

State of New Mexico
Energy, Minerals and Natural Resources

OIL CONSERVATION DIVISION
1220 South St. Francis Dr.
Santa Fe, NM 87505

Form C-103
May 27, 2004

WELL API NO. 30-015-34487
5. Indicate Type of Lease STATE <input type="checkbox"/> FEE <input checked="" type="checkbox"/>
6. State Oil & Gas Lease No.
7. Lease Name or Unit Agreement Name: Columbia 33 Fee
8. Well Number 1H
9. OGRID Number 7377
10. Pool name or Wildcat Eagle Creek; Wolfcamp (Gas)

SUNDRY NOTICES AND REPORTS ON WELLS (DO NOT USE THIS FORM FOR PROPOSALS TO DRILL OR TO DEEPEN OR PLUG BACK TO A DIFFERENT RESERVOIR. USE "APPLICATION FOR PERMIT" (FORM C-101) FOR SUCH PROPOSALS.)	
1. Type of Well: Oil Well <input type="checkbox"/> Gas Well <input checked="" type="checkbox"/> Other	
2. Name of Operator EOG Resources Inc.	
3. Address of Operator P.O. Box 2267 Midland, Texas 79702	
4. Well Location Unit Letter I ; 1880 feet from the South line and 660 feet from the East line Section 33 Township 16S Range 24E NMPM County Eddy	
11. Elevation (Show whether DR, RKB, RT, GR, etc.) 3714 GR	
Pit or Below-grade Tank Application <input type="checkbox"/> or Closure <input type="checkbox"/> Pit type _____ Depth to Groundwater _____ Distance from nearest fresh water well _____ Distance from nearest surface water _____ Pit Liner Thickness: _____ mil Below-Grade Tank: Volume _____ bbls; Construction Material _____	

12. Check Appropriate Box to Indicate Nature of Notice, Report, or Other Data	
NOTICE OF INTENTION TO: PERFORM REMEDIAL WORK <input type="checkbox"/> PLUG AND ABANDON <input type="checkbox"/> TEMPORARILY ABANDON <input type="checkbox"/> CHANGE PLANS <input type="checkbox"/> PULL OR ALTER CASING <input type="checkbox"/> MULTIPLE COMPLETION <input type="checkbox"/> OTHER: <input type="checkbox"/>	SUBSEQUENT REPORT OF: REMEDIAL WORK <input type="checkbox"/> ALTERING CASING <input type="checkbox"/> COMMENCE DRILLING OPNS. <input type="checkbox"/> PLUG AND ABANDONMENT <input type="checkbox"/> CASING TEST AND CEMENT JOB <input type="checkbox"/> OTHER: completion <input checked="" type="checkbox"/>

13. Describe proposed or completed operations. (Clearly state all pertinent details, and give pertinent dates, including estimated date of starting any proposed work). SEE RULE 1103. For Multiple Completions: Attach wellbore diagram of proposed completion or recompletion.

1/09/07 **MIRU for completion.**
Step rate tested 5 1/2" casing to 7000 psi for 30 min. Test good.
1/26/07 **Perforate from 7623' to 8230', 0.48", 24 holes.**
2/20/07 **Frac w/ 71 bbls 15% HCL acid, 602 bbls XL gel, 90000 lbs 30/70 Brown sand, 36000 lbs 16/30 White sand, 4692 bbls slick water.**
Perforate from 6700' to 7320', 0.54", 21 holes.
Frac w/ 214 bbls 15% HCL acid, 612 bbls XL gel, 89500 lbs 30/70 Brown sand, 37031 lbs 16/30 White sand, 4425 bbls slick water.

I hereby certify that the information above is true and complete to the best of my knowledge and belief. I further certify that any pit or below-grade tank has been/will be constructed or closed according to NMOCD guidelines ☐, a general permit ☐ or an (attached) alternative OCD-approved plan ☐

SIGNATURE Stan Wagner TITLE Regulatory Analyst DATE 02/28/07

Type or print name Stan Wagner E-mail address: _____ Telephone No. 432 686 3689

For State Use Only

BRYAN G. ARRANT
DISTRICT II GEOLOGIST

APPROVED BY _____ TITLE _____ DATE MAR 13 2007

Conditions of Approval, if any:

Submit 3 Copies To Appropriate District
Office
District I
1625 N. French Dr., Hobbs, NM 87240
District II
1301 W. Grand Ave., Artesia, NM 88210
District III
1000 Rio Brazos Rd., Aztec, NM 87410
District IV
1220 S. St. Francis Dr., Santa Fe, NM 87505

State of New Mexico
Energy, Minerals and Natural Resources

OIL CONSERVATION DIVISION
1220 South St. Francis Dr.
Santa Fe, NM 87505

Form C-103
May 27, 2004

WELL API NO. 30-015-34487
5. Indicate Type of Lease STATE <input type="checkbox"/> FEE <input checked="" type="checkbox"/>
6. State Oil & Gas Lease No.

SUNDRY NOTICES AND REPORTS ON WELLS (DO NOT USE THIS FORM FOR PROPOSALS TO DRILL OR TO DEEPEN OR PLUG BACK TO A DIFFERENT RESERVOIR. USE "APPLICATION FOR PERMIT" (FORM C-101) FOR SUCH PROPOSALS.)		7. Lease Name or Unit Agreement Name: Columbia 33 Fee
1. Type of Well: Oil Well <input type="checkbox"/> Gas Well <input checked="" type="checkbox"/> Other		8. Well Number 1H
2. Name of Operator EOG Resources Inc.		9. OGRID Number 7377
3. Address of Operator P.O. Box 2267 Midland, Texas 79702		10. Pool name or Wildcat Eagle Creek; Wolfcamp (Gas)
4. Well Location Unit Letter I ; 1880 feet from the South line and 660 feet from the East line Section 33 Township 16S Range 24E NMPM County Eddy		
11. Elevation (Show whether DR, RKB, RT, GR, etc.) 3714 GR		
Pit or Below-grade Tank Application <input type="checkbox"/> or Closure <input type="checkbox"/> Pit type _____ Depth to Groundwater _____ Distance from nearest fresh water well _____ Distance from nearest surface water _____ Pit Liner Thickness: _____ mil Below-Grade Tank: Volume _____ bbls; Construction Material _____		

12. Check Appropriate Box to Indicate Nature of Notice, Report, or Other Data	
NOTICE OF INTENTION TO: PERFORM REMEDIAL WORK <input type="checkbox"/> PLUG AND ABANDON <input type="checkbox"/> TEMPORARILY ABANDON <input type="checkbox"/> CHANGE PLANS <input type="checkbox"/> PULL OR ALTER CASING <input type="checkbox"/> MULTIPLE COMPLETION <input type="checkbox"/> OTHER: <input type="checkbox"/>	SUBSEQUENT REPORT OF: REMEDIAL WORK <input type="checkbox"/> ALTERING CASING <input type="checkbox"/> COMMENCE DRILLING OPNS. <input type="checkbox"/> PLUG AND ABANDONMENT <input type="checkbox"/> CASING TEST AND CEMENT JOB <input type="checkbox"/> OTHER: completion <input checked="" type="checkbox"/>

13. Describe proposed or completed operations. (Clearly state all pertinent details, and give pertinent dates, including estimated date of starting any proposed work). SEE RULE 1103. For Multiple Completions: Attach wellbore diagram of proposed completion or recompletion.

2/20/07 Perforate from 5770' to 6390', 0.54", 21 holes.
2/21/07 Frac w/ 142 bbls 15% HCL acid, 603 bbls XL gel, 88950 lbs 30/70 Brown sand, 38171 lbs 16/30 White sand, 4421 bbls slick water.
Perforate from 4850' to 5460', 0.54", 21 holes.
Frac w/ 118 bbls 15% HCL acid, 9801 lbs 30/70 Brown sand, 1504 bbls slick water.
Flowback.
2/22/07 RIH w/ 2 3/8" production tubing set @ 5434'. Flowback.
2/24/07 Turned to sales.

I hereby certify that the information above is true and complete to the best of my knowledge and belief. I further certify that any pit or below-grade tank has been/will be constructed or closed according to NMOCD guidelines ☐, a general permit ☐ or an (attached) alternative OCD-approved plan ☐

SIGNATURE Stan Wagner TITLE Regulatory Analyst DATE 02/28/07

Type or print name Stan Wagner

E-mail address:

Telephone No. 432 686 3689

For State Use Only
BRYAN G. ARRAnt
DISTRICT II GEOLOGIST

APPROVED BY _____ TITLE _____ DATE _____

Conditions of Approval, if any:

MAR 13 2007

District I
1825 N. French Dr., Hobbs, NM 88240
District II
1301 W. Grand Avenue, Artesia, NM 88210
District III
1000 Rio Brazos Rd., Aztec, NM 87410
District IV
1220 S. St. Francis Dr., Santa Fe, NM 87505



State of New Mexico
Energy, Minerals & Natural Resources Department
OIL CONSERVATION DIVISION
1220 South St. Francis Dr.
Santa Fe, NM 87505

Month-Year
MAR 12 2007
OCD - ARTESIA, NM

Form C-102
Revised October 12, 2005
Submit to Appropriate District Office
State Lease- 4 Copies
Fee Lease- 3 Copies

☐ AMENDED REPORT

WELL LOCATION AND ACREAGE DEDICATION PLAT

API Number 30-015-34487	Pool Code 96622	Pool Name Eagle Creek; Wolfcamp (Gas)
Property Code 35320	Property Name COLUMBIA 33 FEE	Well Number 1
OGRD No. 7377	Operator Name EOG RESOURCES, INC.	Elevation 3714'

Surface Location

UL or lot no.	Section	Township	Range	Lot 1/4	Feet from the	North/South line	Feet from the	East/West line	County
I	33	16 SOUTH	24 EAST, N.M.P.M.		1880	SOUTH	660	EAST	EDDY

Bottom Hole Location If Different From Surface

UL or lot no.	Section	Township	Range	Lot 1/4	Feet from the	North/South line	Feet from the	East/West line	County
L	33	16 SOUTH	24 EAST, N.M.P.M.		1664	SOUTH	726	WEST	EDDY

Dedicated Acres 320	Joint or Infill	Consolidation Code	Order No.
------------------------	-----------------	--------------------	-----------

No allowable will be assigned to this completion until all interests have been consolidated or a non-standard unit has been approved by the division.

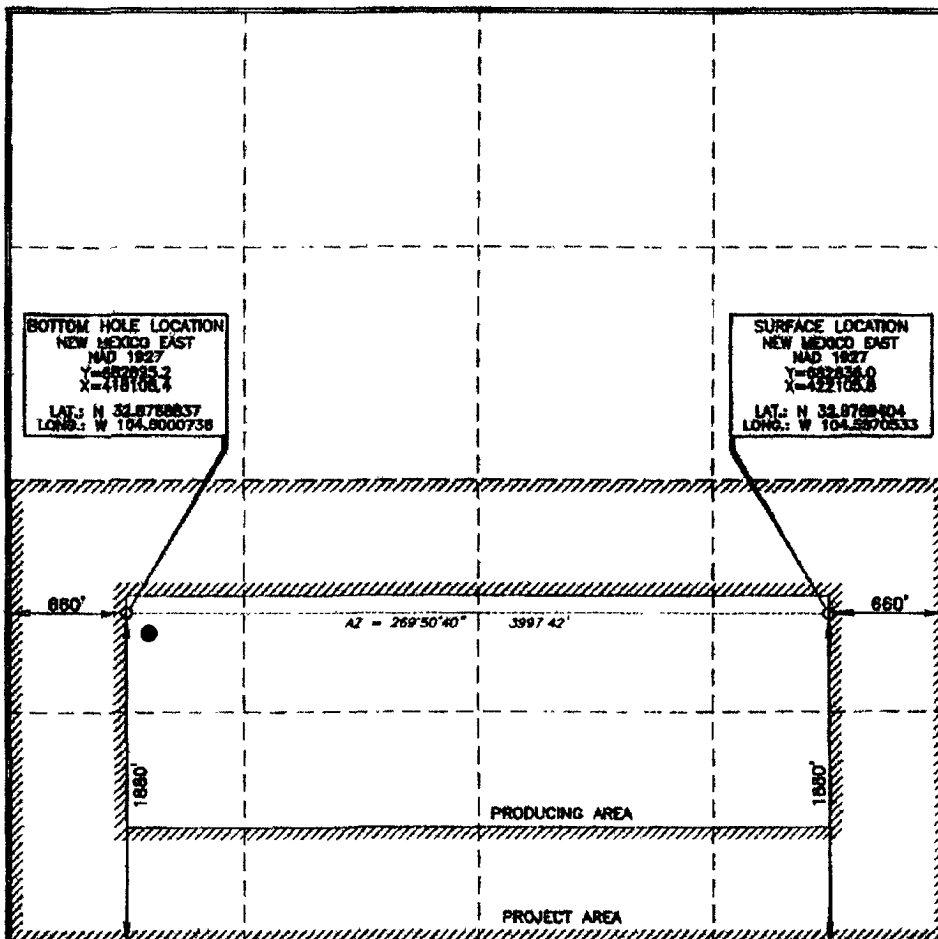

OPERATOR CERTIFICATION

I hereby certify that the information contained herein is true and complete to the best of my knowledge and belief, and that this organization either owns a working interest or unleased mineral interest in the land including the proposed bottom hole location or has a right to drill this well at this location pursuant to a contract with an owner of such a mineral or working interest, or to a voluntary pooling agreement or a compulsory pooling order heretofore entered by the division.

Stan Wagner 3/9/07
Signature Date

Stan Wagner

Printed Name

SURVEYOR CERTIFICATION

I hereby certify that the well location shown on this plat was obtained from field notes or actual survey made by me or under my supervision and that the same is true and correct to the best of my belief.

15079
16079
Date of Survey

Signature and Seal of Professional Surveyor

Terry J. Cook 12/19/05
Certificate Number 16079

WLF 051216ML-a (2006)