



March 28, 2007

HAND-DELIVERED

Mark E. Fesmire, P. E.
Director
Oil Conservation Division
New Mexico Department of Energy,
Minerals and Natural Resources
1220 South Saint Francis Drive
Santa Fe, New Mexico 87505

Re: Application of EOG Resources, Inc. for Administrative Approval of the Simultaneous Dedication of the north 320 acres of Irregular Section 4, Township 16 South, Range 25 East, N.M.P.M., Eddy County, New Mexico to its proposed Meramac B 4 Fee Well No. 1H and the existing Meramac B 4 Fee Well No. 2H.

Dear Mr. Fesmire:

EOG Resources, Inc. is the operator of a standard 320-acre spacing unit in the Cottonwood Creek-Wolfcamp Gas Pool (**Pool Code 75250**) comprised of the north 320 acres of Irregular Section 4, Township 16 South, Range 25 East, N.M.P.M., Eddy County, New Mexico. This spacing unit is dedicated to EOG's Meramac B 4 Fee Well No. 2H which has been horizontally drilled and produces from the Wolfcamp formation.

EOG seeks administrative approval of the simultaneous dedication of this standard 320-acre gas spacing unit to the following two horizontal gas wells:

- A. the existing **Meramec B 4 Fee Well No. 2H (API No. 30-015-35381)** horizontally drilled from a surface location 3400 feet from the South line and 660 feet from the East line to a proposed end point or bottomhole location 3400 feet from the South line and 660 feet from the West line of said Section 4; and
- B. the proposed **Meramec B 4 Fee Well No. 1H (API No. 30-015 -35382)** to be horizontally drilled from a surface location 2517 feet from the North line and 660 feet from the East line to a proposed end point or bottomhole location 2515 feet from the North line and 660 feet from the West line of said Section 4.



Both the penetration point and the bottomhole location for the Meramac B 4 Fee Well No. 2H are at a standard location in the Wolfcamp formation pursuant to Division Rules 104.C (2) (a) and 111.A (7). EOG now intends to horizontally drill and complete its proposed Meramac B 4 Fee Well No. 1H to be drilled to the targeted subsurface end-point or bottomhole location 2515 feet from the North line and 660 feet from the West line (Lot 12) of Section 4. EOG proposes to drill this well in compliance with the set-back requirements of Division Rules 104.C(2)(b) and 111.A(7) for deep gas wells in southeast New Mexico.

Attached hereto as **Exhibit A** is a copy of Division Form C-102 for this well that shows the proposed surface and bottomhole location of the well.

Exhibit B is a map of offset operators around the spacing unit in Section 4. EOG is the only offset operator but certain working interest owners are not common. **Exhibit C** is a list of affected parties as defined by Division Rules. As required by Rule 1210, a copy of this application (with attachments) has been sent to those affected parties in accordance with Rule 1207(A)(5) and they have been advised that if they have an objection to this application it must be filed in writing with the Division's Santa Fe office within twenty days from the date this notice was sent.

The simultaneous dedication of the north 320 acres of said Section 4 to the Meramac B 4 Fee Well Nos. 1H and 2H will afford EOG the opportunity to efficiently produce the Wolfcamp formation under this spacing unit. EOG's proposed simultaneous dedication of these wells does not exceed the number of wells allowed by Division Rule for this spacing unit.

Your attention to this application is appreciated.

Sincerely,

A handwritten signature in black ink that reads "Ocean Munds-Dry".

Ocean Munds-Dry
Attorney for EOG Resources, Inc.

Enclosures



March 28, 2007

CERTIFIED MAIL
RETURN RECEIPT REQUESTED

AFFECTED INTEREST OWNERS

Re: Application of EOG Resources, Inc., for simultaneous dedication,
Eddy County, New Mexico.

Ladies and Gentlemen:

This letter is to advise you that EOG Resources, Inc. has filed the enclosed application with the New Mexico Oil Conservation Division seeking the simultaneous dedication of the proposed Meramac B 4 Fee Well No. 1H and the existing Meramac B 4 Fee Well No. 2H to the north 320 acres of Section 4, Township 16 South, Range 25 East, NMPM, Eddy County, New Mexico.

As an owner of an interest that may be affected by the proposed well, you may object to this application. Objections must be filed in writing within twenty days from this date at the Division's Santa Fe office that is located at 1220 South Saint Francis Drive, Santa Fe, New Mexico. 87505. If no objection is received within this twenty-day period, this application for an unorthodox well location may be approved.

Very truly yours,

Ocean Munds-Dry
ATTORNEY FOR EOG RESOURCES, INC.

Enclosures

District I
1625 N. French Dr., Hobbs, NM 88240
District II
1301 W. Grand Avenue, Artesia, NM 88210
District III
1000 Rio Brazos Rd., Aztec, NM 87410
District IV
1220 S. St. Francis Dr., Santa Fe, NM 87505

State of New Mexico
Energy, Minerals & Natural Resources Department
OIL CONSERVATION DIVISION
1220 South St. Francis Dr.
Santa Fe, NM 87505

Form C-402
Revised October 12, 2005
Submit to Appropriate District Office
State Lease- 4 Copies
Fee Lease- 3 Copies

☐ AMENDED REPORT

WELL LOCATION AND ACREAGE DEDICATION PLAT

API Number 30-015-35382	Pool Code 75250	Pool Name COTTONWOOD CREEK WOLFCAMP (GAS)
Property Code 36264	Property Name MERAMEC "B" 4 FEE	Well Number 1H
OGRID No. 7377	Operator Name EOG RESOURCES, INC.	Elevation 3470'

Surface Location

UL or lot no.	Section	Township	Range	Lot Idn	Feet from the	North/South line	Feet from the	East/West line	County
9	4	16 SOUTH	25 EAST, N.M.P.M.		2517'	NORTH	660'	EAST	EDDY

Bottom Hole Location If Different From Surface

UL or lot no.	Section	Township	Range	Lot Idn	Feet from the	North/South line	Feet from the	East/West line	County
12	4	16 SOUTH	25 EAST, N.M.P.M.		2515'	NORTH	660'	WEST	EDDY

Dedicated Acres 320	Joint or Infill	Consolidation Code	Order No.
-------------------------------	-----------------	--------------------	-----------

No allowable will be assigned to this completion until all interests have been consolidated or a non-standard unit has been approved by the division.

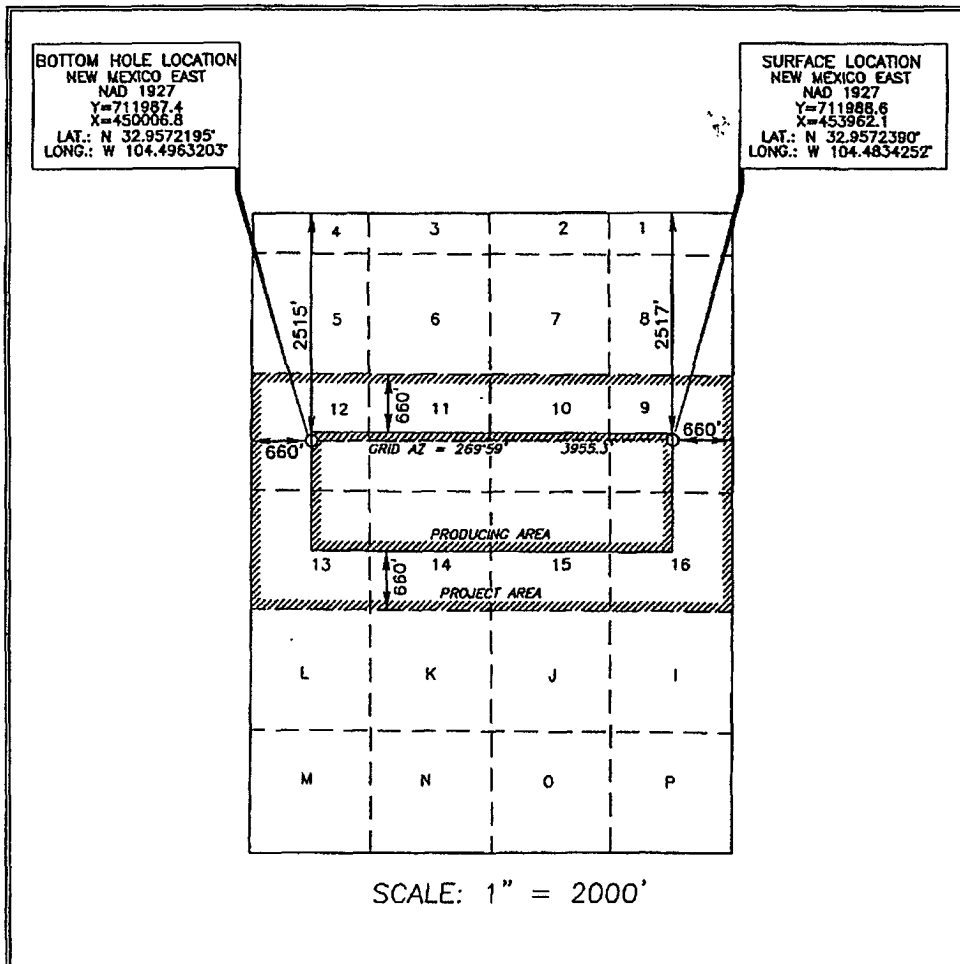

OPERATOR CERTIFICATION

I hereby certify that the information contained herein is true and complete to the best of my knowledge and belief, and that this organization either owns a working interest or unleased mineral interest in the land including the proposed bottom hole location or has a right to drill this well at this location pursuant to a contract with an owner of such a mineral or working interest, or to a voluntary pooling agreement or a compulsory pooling order heretofore entered by the division.

Donny G. Glanton 1/18/07
Signature Date

Donny G. Glanton
Printed Name

SURVEYOR CERTIFICATION

I hereby certify that the well location shown on this plat was plotted from field notes of actual surveys made by me or under my supervision, and that the same is true and correct to the best of my belief.

DECEMBER 06, 2006
Date of Survey

Lenny G. Paul
Signature and Seal of Professional Surveyor

15079
Certificate Number

WOL 061206WL-r (N)

EXHIBIT A

OFFSETS IN SECTION 4

	D	C	B	A	
	E	F	G	H	
⑤	Meramac B4				
EOG + WIO's	L	K ④	J	I	③
	M	N	O	P	

EXHIBIT B

Exhibit C

**Application of EOG Resources, Inc.
Simultaneous Dedication of
North 320 acres of Section 4, Township 16 South, Range 25 East, NMPM
Eddy County, New Mexico**

LCX Energy, LLC
101 N. Marenfeld Suite 200
Midland, Texas 79701

Capstone Oil & Gas Company
P.O. Box 10187
Midland, Texas 79702

CMW Interests, Inc.
24 Smith Road, Suite 405
Midland, Texas 79705

Elger Exploration, Inc.
P.O. Box 2623
Midland, Texas 79702-2623

Parallel Petroleum
Post Office Box 10587
Midland, Texas 79702