

District I  
1625 N. French Dr., Hobbs, NM 88240  
District II  
811 South First, Artesia, NM 88210  
District III  
1000 Rio Brazos Road, Aztec, NM 87410  
District IV  
2040 South Pacheco, Santa Fe, NM 87505

State of New Mexico  
Energy Minerals and Natural Resources

Oil Conservation Division  
2040 South Pacheco  
Santa Fe, NM 87505

Form C-101  
Revised March 17, 1999

Submit to appropriate District Office  
State Lease - 6 Copies  
Fee Lease - 5 Copies

☐ AMENDED REPORT

**APPLICATION FOR PERMIT TO DRILL, RE-ENTER, DEEPEN, PLUGBACK, OR ADD A ZONE**

<sup>1</sup> Operator Name and Address <b>Clayton Williams Energy, Inc. Six Desta Drive, Suite 3000 Midland, TX 79705</b>		<sup>2</sup> OGRID Number <b>25706</b>
<sup>3</sup> Property Code <b>25235</b>	Property Name <b>STATE "20B"</b>	<sup>3</sup> API Number 30 - <b>33069</b>
		<sup>6</sup> Well No. <b>14</b>

<sup>7</sup> Surface Location

UL or lot no.	Section	Township	Range	Lot Idn	Feet from the	North/South line	Feet from the	East/West line	County
<b>A</b>	<b>20</b>	<b>17 S</b>	<b>29 E</b>		<b>330</b>	<b>NORTH</b>	<b>330</b>	<b>EAST</b>	<b>EDDY</b>

<sup>8</sup> Proposed Bottom Hole Location If Different From Surface

UL or lot no.	Section	Township	Range	Lot Idn	Feet from the	North/South line	Feet from the	East/West line	County

<sup>9</sup> Proposed Pool 1

**Empire, East (Yeso) 96610**

<sup>10</sup> Proposed Pool 2

**Grayburg Jackson -7R's,QN,GB,SA (28509)**

<sup>11</sup> Work Type Code <b>N</b>	<sup>12</sup> Well Type Code <b>O</b>	<sup>13</sup> Cable/Rotary <b>R</b>	<sup>14</sup> Lease Type Code <b>S</b>	<sup>15</sup> Ground Level Elevation <b>3604'</b>
<sup>16</sup> Multiple <b>N</b>	<sup>17</sup> Proposed Depth <b>5000'</b>	<sup>18</sup> Formation <b>Yeso Sands</b>	<sup>19</sup> Contractor <b>Key Energy Svcs</b>	<sup>20</sup> Spud Date <b>Upon approval</b>

<sup>21</sup> Proposed Casing and Cement Program

Hole Size	Casing Size	Casing weight/foot	Setting Depth	Sacks of Cement	Estimated TOC
<b>12-1/4"</b>	<b>8-5/8"</b>	<b>24#</b>	<b>@ 300' 400'</b>	<b>300</b>	<b>Surface</b>
<b>7-7/8"</b>	<b>5-1/2"</b>	<b>17#</b>	<b>5000'</b>	<b>935</b>	<b>Surface</b>

<sup>22</sup> Describe the proposed program. If this application is to DEEPEN or PLUG BACK, give the data on the present productive zone and proposed new productive zone.

Describe the blowout prevention program, if any. Use additional sheets if necessary.

- @ 300' Oper. To set surface casing above Salado.**
- 1. Drill a 12-1/4" hole to 400'. Run and set 400' of 8-5/8" 24# J-55 ST&C casing. Cement with 300 sx. of Cl. C cement. Circulate cement to surface.**
  - 2. Drill a 7-7/8" hole to 5000'. Run and set 5000' of 5-1/2" 17# ST&C casing with DV tool @ ±2500'. Cement 1<sup>st</sup> stage with 365 sx. Cl. C 50/50 Poz and cement 2<sup>nd</sup> stage with 570 sx. 35/65 Poz C and tail with 150 sx. Cl. C neat. Circulate cement to surface.**

<sup>23</sup> I hereby certify that the information given above is true and complete to the best of my knowledge and belief.

Signature:

Printed name: **Betsy Luna**

Title: **Engineering Technician**

Date: **10/27/2003**

Phone: **(432) 682-6324**

**B60** OIL CONSERVATION DIVISION

Approved by:

Title:

Approval Date: **OCT 28 2003**

Conditions of Approval:

Attached ☐

**Jim W. Green**  
**District Supervisor**

Expiration Date: **OCT 28 2004**

## DISTRICT I

P.O. Box 1980, Hobbs, NM 88241-1980

## DISTRICT II

P.O. Drawer DD, Artesia, NM 88211-0719

## DISTRICT III

1000 Rio Brazos Rd., Aztec, NM 87410

## DISTRICT IV

P.O. BOX 2088, SANTA FE, N.M. 87504-2088

## State of New Mexico

Energy, Minerals and Natural Resources Department

## OIL CONSERVATION DIVISION

P.O. Box 2088

Santa Fe, New Mexico 87504-2088

Form C-102

Revised February 10, 1994

Submit to Appropriate District Office

State Lease - 4 Copies

Fee Lease - 3 Copies

## WELL LOCATION AND ACREAGE DEDICATION PLAT

☐ AMENDED REPORT

API Number		Pool Code 96610	Pool Name Empire, East (Yeso)
Property Code 25235	Property Name STATE 20 B		Well Number 14
OGRID No. 25706	Operator Name CLAYTON WILLIAMS ENERGY, INC.		Elevation 3604'

## Surface Location

UL or lot No. A	Section 20	Township 17-S	Range 29-E	Lot Idn	Feet from the 330'	North/South line NORTH	Feet from the 330'	East/West line EAST	County EDDY
--------------------	---------------	------------------	---------------	---------	-----------------------	---------------------------	-----------------------	------------------------	----------------

## Bottom Hole Location If Different From Surface

UL or lot No.	Section	Township	Range	Lot Idn	Feet from the	North/South line	Feet from the	East/West line	County
Dedicated Acres		Joint or Infill	Consolidation Code		Order No.				

NO ALLOWABLE WILL BE ASSIGNED TO THIS COMPLETION UNTIL ALL INTERESTS HAVE BEEN CONSOLIDATED  
OR A NON-STANDARD UNIT HAS BEEN APPROVED BY THE DIVISION

	<u>GEODETIC COORDINATES</u> NAD 27 NME Y = 664397.4 N X = 575070.0 E LAT. = 32°49'34.60"N LONG. = 104°05'20.23"W		<b>OPERATOR CERTIFICATION</b> I hereby certify the the information contained herein is true and complete to the best of my knowledge and belief.  Signature Betsy Luna Printed Name Engineering Technician Title Oct. 27, 2003 Date
	<b>SURVEYOR CERTIFICATION</b> I hereby certify that the well location shown on this plat was plotted from field notes of actual surveys made by me or under my supervision and that the same is true and correct to the best of my belief. October 21, 2003 Date Surveyed		
	Signature & Seal of Professional Surveyor  Gary E. Eubank: 10/23/03 03.111141		
	Certificate No. GARY EUBANK 12641		

# VICINITY MAP

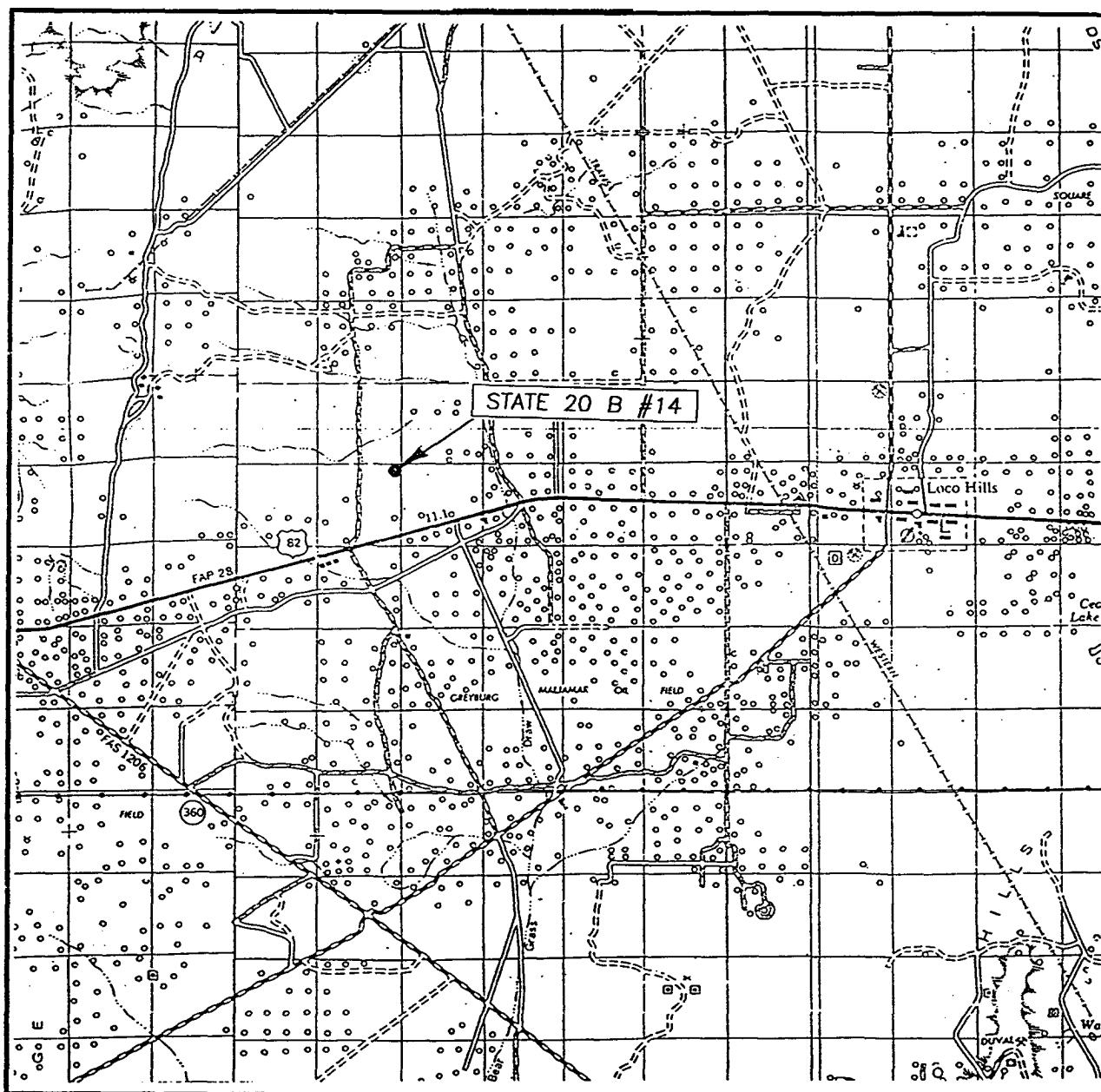

SCALE: 1" = 2 MILES

SEC. 20 TWP. 17-S RGE. 29-E

SURVEY N.M.P.M.

COUNTY EDDY

DESCRIPTION 330' FNL & 330' FEL

ELEVATION 3604'

OPERATOR CLAYTON WILLIAMS ENERGY, INC.

LEASE STATE 20 B

**JOHN WEST SURVEYING**  
**HOBBS, NEW MEXICO**  
**(505) 393-3117**

## DRIVING DIRECTIONS

TURN NORTH OFF STATE HIGHWAY #83 0.6 MILES WEST OF MILE MARKER #126. GO NORTH ON CALICHE RD 0.6 MILES. TURN RIGHT ON CALICHE RD AND GO EAST 0.4 MILES. TURN LEFT ON CALICHE RD AND GO 0.2 MILES. TURN RIGHT AND GO EAST 0.1 MILES TO THE STATE 20B #1 LOCATION. THIS PROPOSED WELL IS APPROXIMATELY 500' NORTH.

[illegible]

CONTOUR INTERVAL: 10'  
RED LAKE SE, N.M.

U.S.G.S. TOPOGRAPHIC MAP  
RED LAKE SE, N.M.

JOHN WEST SURVEYING  
HOBBS, NEW MEXICO  
(505) 393-3117

# BLOWOUT PREVENTER SYSTEM

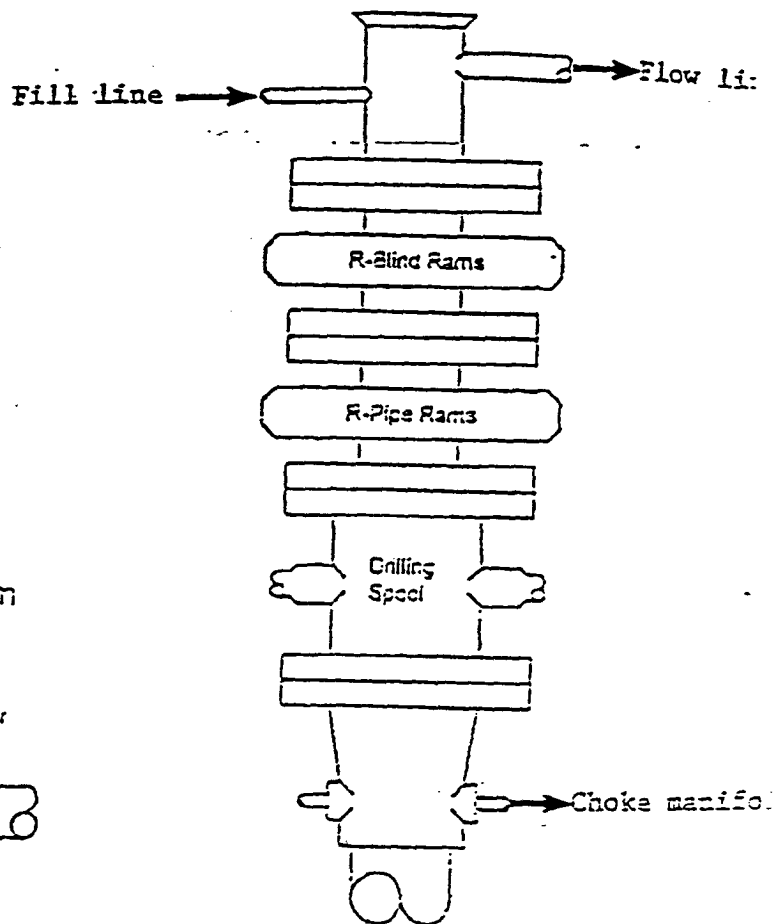

Type 900 Series  
3000 psi WP

Choke Manifold Assembly for 3M WP System

