

RECEIVED

Form 3160-3 NOV 10 2003  
(August 1999)

OCD-ARTESIA

UNITED STATES  
DEPARTMENT OF THE INTERIOR  
BUREAU OF LAND MANAGEMENTN.M. Oil Cons. DIV-Dist. 2  
1301 W. Grand Avenue  
Artesia, NM 882100  
OMB No. 1004-0136  
Expires November 30, 2000

## APPLICATION FOR PERMIT TO DRILL OR REENTER

1a. Type of Work: ☒ DRILL ☐ REENTERb. Type of Well: ☐ Oil Well ☒ Gas Well ☐ Other ☐ Single Zone ☒ Multiple Zone

2. Name of Operator

Yates Petroleum Corporation

3A. Address 105 South Fourth Street  
Artesia, New Mexico 882103b. Phone No. (include area code)  
(505) 748-1471

4. Location of Well (Report location clearly and in accordance with any State requirements. \*)

At surface 860' FSL and 760' FWL

At proposed prod. Zone same as above

14. Distance in miles and direction from nearest town or post office\*

46 miles Southwest of Artesia, New Mexico

15. Distance from proposed\*  
location to nearest  
property or lease line, ft.  
(Also to nearest drig. unit line, if any)

760'

16. No. of Acres in lease

320.00

17. Spacing Unit dedicated to this well

320 S/2

18. Distance from proposed location\*  
to nearest well, drilling, completed,  
applied for, on this lease, ft.

1/2 mile

19. Proposed Depth

8500'

20. BLM/BIA Bond No. on file

NM-2811

21. Elevations (Show whether DF, KDB, RT, GL, etc.)

4329'

22. Approximate date work will start\*

ASAP

23. Estimated duration

30 Days

24. Attachments

ROSWELL CONTROLLED WATER BASIN

The following, completed in accordance with the requirements of Onshore Oil and Gas Order No. 1, shall be attached to this form:

1. Well plat certified by a registered surveyor.
2. A Drilling Plan.
3. A Surface Use Plan (if the location is on National Forest System Lands, the SUPO shall be filed with the appropriate Forest Service Office).

4. Bond to cover the operations unless covered by an existing bond on file (see Item 20 above).
5. Operator certification.
6. Such other site specific information and/or plans as may be required by the authorized office.

25. Signature

Name (Printed/Typed)

Date

Cy Cowan

9/29/03

Title:

Regulatory Agent

Approved by (Signature)

/s/ Joe G. Lara

Name (Printed/Typed)

/s/ Joe G. Lara

Date

6 NOV 2003

Title

ACTING FIELD MANAGER

Office

CARLSBAD FIELD OFFICE

Application approval does not warrant or certify that the applicant holds legal or equitable title to those rights in the subject lease which would entitle the applicant to conduct operations thereon.

Conditions of approval, if any, are attached.

APPROVAL FOR 1 YEAR

Title 18 U.S.C. Section 1001 and Title 43 U.S.C. Section 1212, make it a crime for any person knowingly and willfully to make to any department or agency of the United States any false, fictitious or fraudulent statements or representations as to any matter within its jurisdiction.

\*(Instructions on reverse)

PREVIOUSLY APPROVED

APPROVAL SUBJECT TO  
GENERAL REQUIREMENTS  
AND SPECIAL STIPULATIONS  
ATTACHED

District I  
1625 N. French Dr., Hobbs, NM 88240

State of New Mexico  
Energy, Minerals & Natural Resources Department

Form C-102  
Revised August 15, 2000

District II  
811 South First, Artesia, NM 88210

OIL CONSERVATION DIVISION  
1220 South St. Francis Dr.  
Santa Fe, NM 87505

Submit to Appropriate District Office  
State Lease - 4 Copies  
Fee Lease - 3 Copies

District III  
1000 Rio Brazos Rd., Aztec, NM 87410

District IV  
1220 S. St. Francis Dr., Santa Fe, NM 87505

☐ AMENDED REPORT

WELL LOCATION AND ACREAGE DEDICATION PLAT

<sup>1</sup> API Number	<sup>2</sup> Pool Code	<sup>3</sup> Pool Name <b>Wildcat Mississippian</b>
<sup>4</sup> Property Code	<sup>5</sup> Property Name <b>Federal HQ</b>	<sup>6</sup> Well Number <b>2</b>
<sup>7</sup> OGRID No. <b>025575</b>	<sup>8</sup> Operator Name <b>Yates Petroleum Corporation</b>	<sup>9</sup> Elevation <b>4329'</b>

<sup>10</sup> Surface Location

UL or lot no. <b>M</b>	Section <b>5</b>	Township <b>21S</b>	Range <b>22E</b>	Lot Idn	Feet from the <b>860</b>	North/South line <b>South</b>	Feet from the <b>760</b>	East/West line <b>West</b>	County <b>Eddy</b>
---------------------------	---------------------	------------------------	---------------------	---------	-----------------------------	----------------------------------	-----------------------------	-------------------------------	-----------------------

<sup>11</sup> Bottom Hole Location If Different From Surface

UL or lot no.	Section	Township	Range	Lot Idn	Feet from the	North/South line	Feet from the	East/West line	County
---------------	---------	----------	-------	---------	---------------	------------------	---------------	----------------	--------

<sup>12</sup> Dedicated Acres <b>320</b>	<sup>13</sup> Joint or Infill	<sup>14</sup> Consolidation Code	<sup>15</sup> Order No.
---	-------------------------------	----------------------------------	-------------------------

**SIGN  
HERE**

NO ALLOWABLE WILL BE ASSIGNED TO THIS COMPLETION UNTIL ALL INTERESTS HAVE BEEN CONSOLIDATED OR A  
NON-STANDARD UNIT HAS BEEN APPROVED BY THE DIVISION

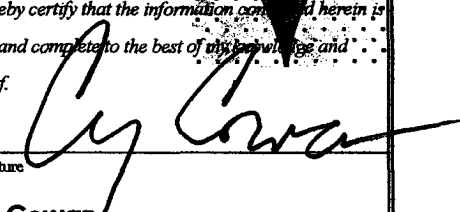
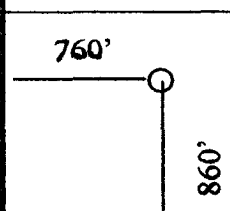
<sup>16</sup>				<sup>17</sup> OPERATOR CERTIFICATION I hereby certify that the information contained herein is true and complete to the best of my knowledge and belief.  Signature <b>Cy Cowan</b> Printed Name <b>Regulatory Agent</b> Title <b>09/29/2003</b> Date
NM - 21012				<sup>18</sup> SURVEYOR CERTIFICATION I hereby certify that the well location shown on this plat was plotted from field notes of actual surveys made by me or under my supervision, and that the same is true and correct to the best of my belief. <b>REFER TO ORIGINAL PLAT</b> Date of Survey Signature and Seal of Professional Surveyor.
				Certificate Number

**District I**

1625 N. French Dr., Hobbs, NM 88240

**District II**

811 South First, Artesia, NM 88210

**District III**

1000 Rio Brazos Rd., Aztec, NM 87410

**District IV**

2040 South Pacheco, Santa Fe, NM 87505

State of New Mexico  
Energy, Minerals & Natural ResourcesOIL CONSERVATION DIVISION  
2040 South Pacheco  
Santa Fe, NM 87505Form C-102  
Revised March 17, 1999Submit to Appropriate District Office  
State Lease - 4 Copies  
Fee Lease - 3 Copies☐ AMENDED REPORT

## WELL LOCATION AND ACREAGE DEDICATION PLAT

API Number		Pool Code		Pool Name Wildcat Mississippian	
Property Code		Property Name FEDERAL HQ			Well Number 2
OGRID No. 025575		Operator Name YATES PETROLEUM CORPORATION			Elevation 4329.

## 10 Surface Location

UL or lot no.	Section	Township	Range	Lot Idn	Feet from the	North/South line	Feet from the	East/West line	County
M	5	21-S	22-E		860	SOUTH	760	WEST	EDDY

## 11 Bottom Hole Location If Different From Surface

UL or lot no.	Section	Township	Range	Lot Idn	Feet from the	North/South line	Feet from the	East/West line	County

12 Dedicated Acres 320	13 Joint or Infill	14 Consolidation Code	15 Order No.
---------------------------	--------------------	-----------------------	--------------

NO ALLOWABLE WILL BE ASSIGNED TO THIS COMPLETION UNTIL ALL INTERESTS HAVE BEEN CONSOLIDATED OR A  
NON-STANDARD UNIT HAS BEEN APPROVED BY THE DIVISION

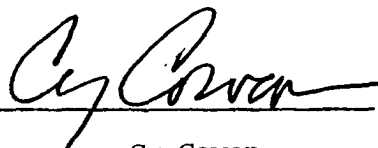
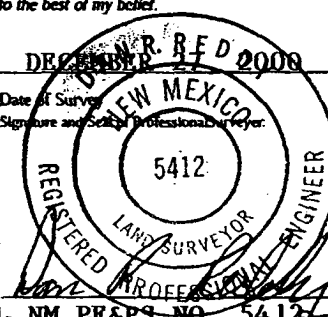
16				<b>17 OPERATOR CERTIFICATION</b> I hereby certify that the information contained herein is true and complete to the best of my knowledge and belief   Signature Cy Cowan Printed Name Regulatory Agent Title Date January 18, 2000
				<b>18 SURVEYOR CERTIFICATION</b> I hereby certify that the well location shown on this plat was plotted from field notes of actual surveys made by me or under my supervision, and that the same is true and correct to the best of my belief.   Date of Survey Signature and Seal of Professional Surveyor
	NM- 21012			
	760'			
	860'			

# YATES PETROLEUM CORPORATION

Federal HQ #2  
860' FSL and 760' FWL  
Section 5-T21S-R22E  
Eddy County, New Mexico

1. The estimated tops of geologic markers are as follows:

Glorieta	1460'
Tubb	2890'
Abo	3530'
Wolfcamp	4370'
Cisco	6320'
Strawn	7620'
Atoka	7820'
Morrow	8170'
Chester	8380'
TD	8500'

2. The estimated depths at which anticipated water, oil or gas formations are expected to be encountered:

Water: 250'-350'  
Oil or Gas: All potential zones.

3. Pressure Control Equipment: BOPE will be installed on the 8 5/8" casing and rated for 3000 BOP systems will be consistent with API RP 53. Pressure tests will be conducted before drilling out from under all casing strings which are set and cemented in place. Blowout Preventor controls will be installed prior to drilling the surface plug and will remain in use until the well is completed or abandoned. Preventors will be inspected and operated at least daily to ensure good mechanical working order, and this inspection recorded on the daily drilling report. See Exhibit B.

## Auxiliary Equipment:

- A. Auxiliary Equipment: Kelly cock, pit level indicators, flow sensor equipment and a sub with full opening valve to fit the drill pipe and collars will be available on the rig floor in the open position at all times for use when kelly is not in use.

4. THE PROPOSED CASING AND CEMENTING PROGRAM:

## A. Casing Program: (All New)

<u>Hole Size</u>	<u>Casing Size</u>	<u>Wt./Ft</u>	<u>Grade</u>	<u>Coupling</u>	<u>Interval</u>	<u>Length</u>
17 1/2"	13 3/8"	48#	H-40	ST&C	0-350'	350'
12 1/4"	8 5/8"	24#	J-55	LT&C	0-1500' 1850'	1500' 1850'
7 7/8"	5 1/2"	17#	J-55	LT&C	0-100'	100'
7 7/8"	5 1/2"	15.5#	J-55	LT&C	100'-6800'	6700'
7 7/8"	5 1/2"	17#	S-95	Lt&C	6800'-8500'	1700'

Minimum Casing Design Factors: Collapse 1.125, Burst 1.0, Joint Strength 1.8

## B. CEMENTING PROGRAM:

Surface casing: 400 sx "C" + 2% CaCL<sub>2</sub> (YLD 1.32 WT 15.6).

WITNESS Intermediate Casing: 750 sx Lite (YLD 2.0 WT 12.2). Tail in w/200 sx "C" + 2% WITNESS  
CaCL<sub>2</sub> (Yld 1.32 Wt. 15.6).

Production Casing: TOC=4200', 775 sx Super "C" modified (Yld 1.63 wt. 13.0).

## 5. MUD PROGRAM AND AUXILIARY EQUIPMENT:

<u>Interval</u>	<u>Type</u>	<u>Weight</u>	<u>Viscosity</u>	<u>Fluid Loss</u>
0-350'	Freshwater Air Mist	8.4	28	N/C
350'-1500' 1850'	Freshwater Air Mist	8.4	28	N/C
1850'-7600'	Cut Brine	8.6-9.2	28	N/C
7600'-TD	Salt Gel/Starch	9.2-9.8	32-38	<10cc

Sufficient mud material(s) to maintain mud properties, control lost circulation and contain a blow out will be available at the well site during drilling operations. Mud will be checked hourly by rig personnel.

## 6. EVALUATION PROGRAM:

Samples: 10' samples out from under surface casing.

Logging: CNL/LDT, DLL w/RXD – TD to casing

Coring: None

DST's: As warranted.

## 7. ABNORMAL CONDITIONS, BOTTOM HOLE PRESSURE, AND POTENTIAL HAZARDS:

Anticipated BHP:

From: 0	TO: 350'	Anticipated Max. BHP: 175 PSI
From: 350'	TO: 1500'	Anticipated Max. BHP: 750 PSI
From: 2050'	TO: 8500'	Anticipated Max. BHP: 3900 PSI

No abnormal pressures or temperatures are anticipated.

Lost Circulation Zones Anticipated: None

H<sub>2</sub>S Zones Anticipated: None Anticipated

## 8. ANTICIPATED STARTING DATE:

Plans are to drill this well as soon as possible after receiving approval. It should take approximately 20 days to drill the well with completion taking another 15 days.

**MULTI-POINT SURFACE USE AND OPERATIONS PLAN  
YATES PETROLEUM CORPORATION**

Federal HQ #2  
860' FSL and 760' FWL  
Section 5,-T21S-R22E  
Eddy County, New Mexico

This plan is submitted with Form 3160-3, Application for Permit to Drill, covering the above described well. The purpose of this plan is to describe the location of the proposed well, the proposed construction activities and operations plan, the magnitude of the surface disturbance involved and the procedures to be followed in rehabilitating the surface after completion of the operations, so that a complete appraisal can be made of the environmental effect associated with the operations.

**1. EXISTING ROADS:**

Exhibit A is a portion of the BLM map showing the well and roads in the vicinity of the proposed location. The proposed wellsite is located approximately 46 miles Southwest of Artesia, New Mexico and the access route to the location is indicated in red and green on Exhibit A.

**DIRECTIONS:**

Go south of Artesia of Highway 285 for approximately 19 miles to Seven Rivers. Turn West on White Pine Road and go to the Marathon Plant Road. CR 401. Turn west on 401 and go 8 miles to CR 400 (old Car Body here) turn right on CR 400 and go approx. 8 miles. After crossing draw an old metal sign will be on the right. Turn right on lease road and 2.2 miles. Turn right here on lease road and go .4 miles to a gate. From here go 1.1 miles. Turn left and go approx. .5 of a mile to the Federal HQ #1. The new road will start going from the southwest corner of the HQ #1 for approx. .3 of a mile the road will then turn right and go approx. .1 of a mile to the southeast corner of the proposed well location.

**2. PLANNED ACCESS ROAD:**

- A. The proposed new access will be approximately .4 of a mile in length from point of origin to the southeast of the drilling pad. The road will lie in an east to west direction.
- B. The new road will be 14 feet in width (driving surface) and will be adequately drained to control runoff and soil erosion.
- C. The new road will be bladed with drainage on one side. Some traffic turnouts will be built.
- D. The route of the road is visible.
- E. Existing roads will be maintained in the same or better condition.

**3. LOCATION OF EXISTING WELL:**

- A. There is drilling activity within a one-mile radius of the wellsite.
- B. Exhibit D shows existing wells within a one-mile radius of the proposed wellsite.

**4. LOCATION OF EXISTING AND/OR PROPOSED FACILITIES:**

- A. There are production facilities on this lease at the present time.
- B. In the event that the well is productive, the necessary production facilities will be installed on the drilling pad. If the well is productive oil, a gas or diesel self-contained unit will be used to provide the necessary power. No power will be required if the well is productive of gas.

5. LOCATION AND TYPE OF WATER SUPPLY:

- A. It is planned to drill the proposed well with a fresh water system. The water will be obtained from commercial sources and will be hauled to the location by truck over the existing and proposed roads shown in Exhibit A.

6. SOURCE OF CONSTRUCTION MATERIALS:

Dirt contractor will locate nearest pit and obtain any permits and materials needed for construction.

7. METHODS OF HANDLING WASTE DISPOSAL:

- A. Drill cuttings will be disposed of in the reserve pits.
- B. Drilling fluids will be allowed to evaporate in the reserve pits until the pits are dry.
- C. Water produced during operations will be collected in tanks until hauled to an approved disposal system, or separate disposal application will be submitted.
- D. Oil produced during operations will be stored in tanks until sold.
- E. Current laws and regulations pertaining to the disposal of human waste will be complied with.
- F. All trash, junk, and other waste materials will be contained in trash cages or bins to prevent scattering and will be removed and deposited in an approved sanitary land fill. Burial on site is not approved.

8. ANCILLARY FACILITIES:

None

9. WELLSITE LAYOUT:

- A. Exhibit C shows the relative location and dimensions of the well pad, the reserve pits, the location of the drilling equipment, rig orientation and access road approach.
- B. The reserve pits will be plastic lined.
- C. A 400' x 400' area has been staked and flagged.

10. PLANS FOR RESTORATION:

- A. After finishing drilling and/or completion operations, all equipment and other material not needed for further operations will be removed. The location will be cleaned of all trash and junk to leave the wellsite in as aesthetically pleasing a condition as possible.
- B. Unguarded pits, if any, containing fluids will be fenced until they have dried and been leveled.
- C. If the proposed well is non-productive, all rehabilitation and/or vegetation requirements of the Bureau of Land Management will be complied with and will be accomplished as expeditiously as possible. All pits will be filled level after they have evaporated and dried.

11. SURFACE OWNERSHIP: Federal Surface, Administered by Bureau of Land Management, Carlsbad, New Mexico.

12. OTHER INFORMATION:

- A. Topography: Refer to the existing archaeological report for a description of the topography, flora, fauna, soil characteristics, dwellings, historical and cultural sites.
- B. The primary surface use is for grazing.

13. OPERATOR'S REPRESENTATIVE:

A. Through A.P.D. Approval:  
  
Cy Cowan, Regulatory Agent  
Yates Petroleum Corporation  
105 South Fourth Street  
Artesia, New Mexico 88210  
Phone (505) 748-1471

B. Through Drilling Operations,  
Completions and Production:  
Pinson McWhorter,  
Operations Manager  
Yates Petroleum Corporation  
105 South Fourth Street  
Artesia, New Mexico 88210  
Phone (505) 748-1471

14. CERTIFICATION:

I hereby certify that I, or persons under my direct supervision, have inspected the proposed drill site and access route, that I am familiar with the conditions which presently exist, that the statements made in this plan are to the best of my knowledge, true and correct, and that the work associated with the operations proposed herein will be performed by Yates Petroleum Corporation and its contractors and subcontractors in conformity with this plan and the terms and conditions under which it is approved. This statement is subject to the provisions of 18 U.S.C. 1001 for the filing of a false statement.

9/29/03

  
Regulatory Agent

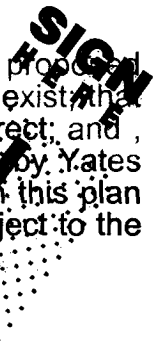

# YATES PETROLEUM CORPORATION

## Federal HQ #2

860' FSL and 760' FWL

Section 5-T21S-R22E

Eddy County, New Mexico

Exhibit "A"

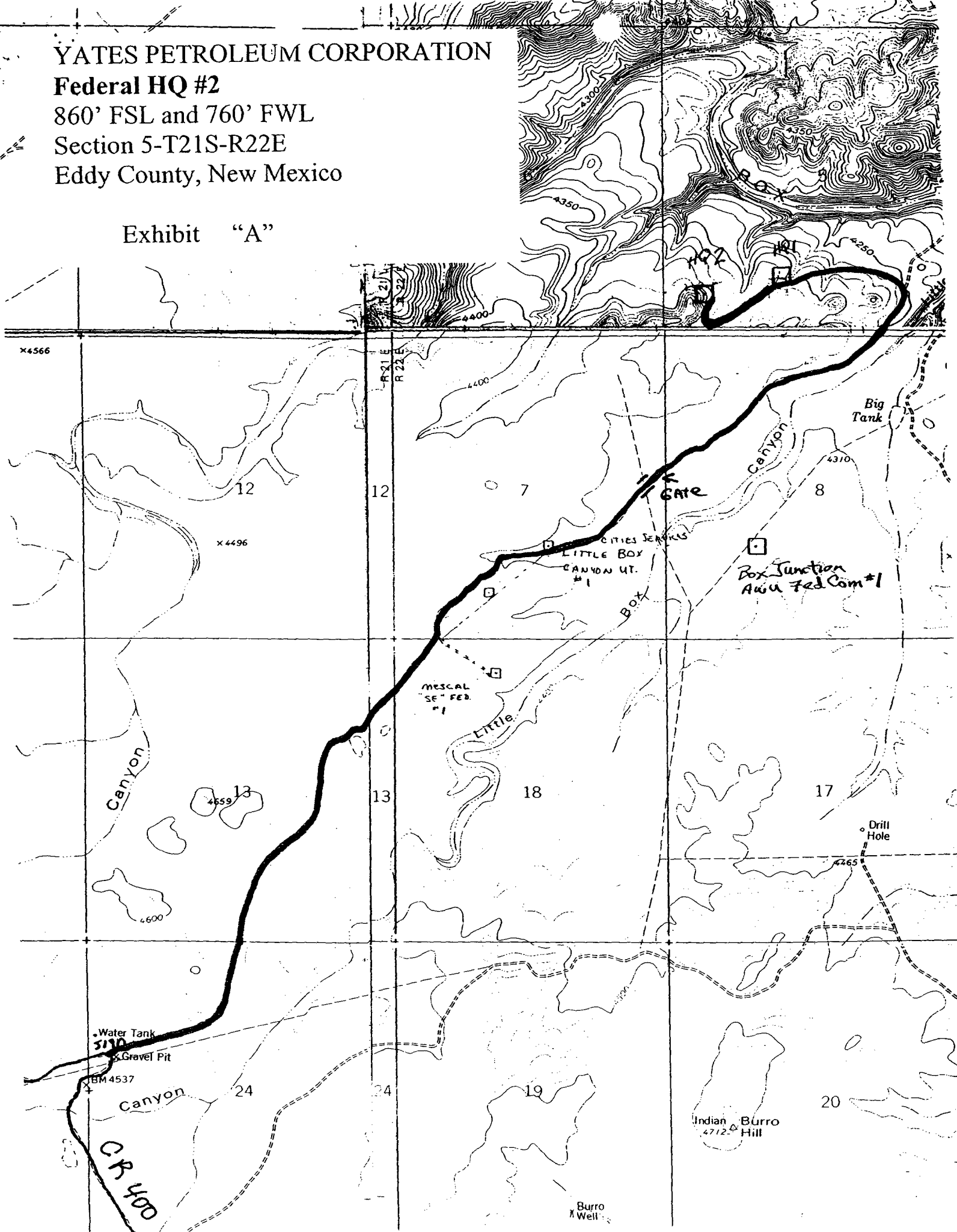

Federal HQ #2  
860' FSL and 760' FWL  
Section 5-T21S-R22E  
Eddy County, New Mexico

Exhibit "B"

**Yates Petroleum Corporation**  
Location Layout for Permian Basin  
Up to 12,000'

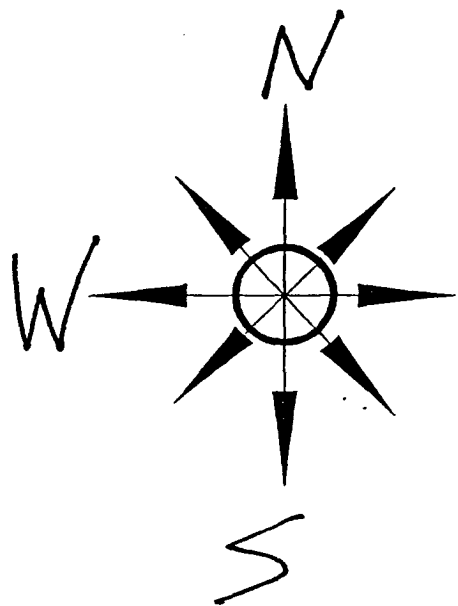

Pits to the West.

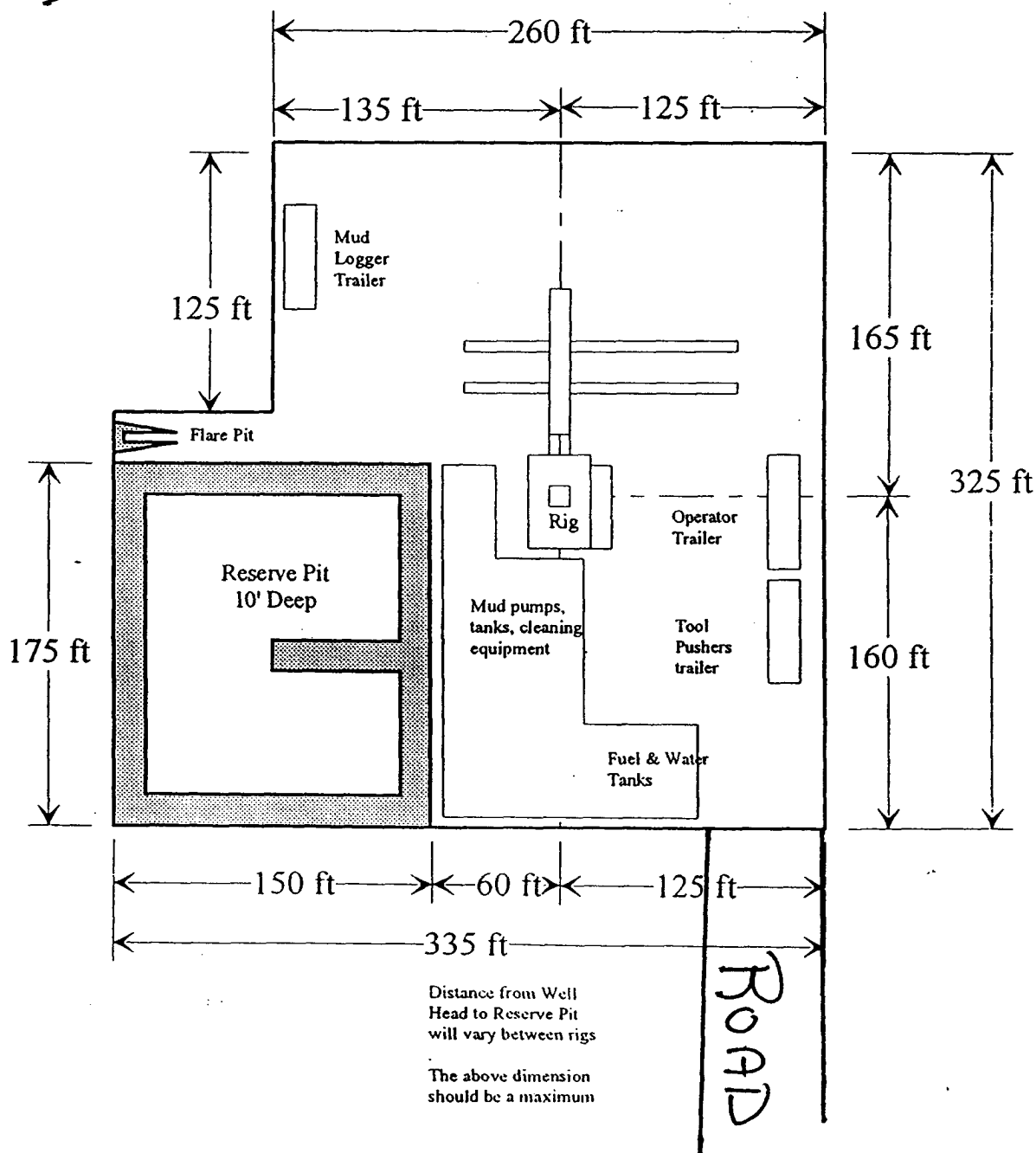
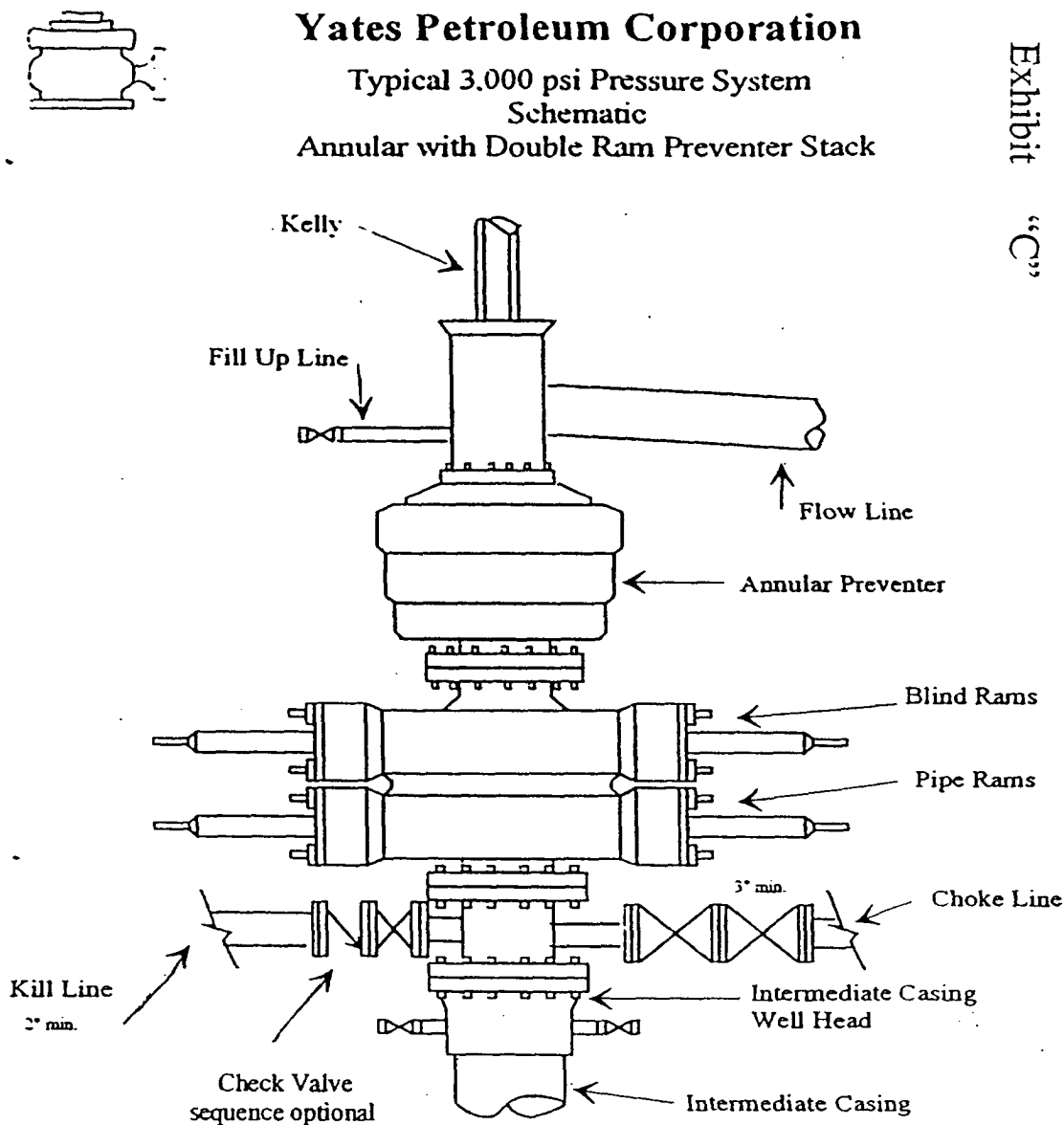

Exhibit "C"

# Yates Petroleum Corporation

Typical 3,000 psi Pressure System  
 Schematic

Annular with Double Ram Preventer Stack



Typical 3,000 psi choke manifold assembly with at least these minimum features

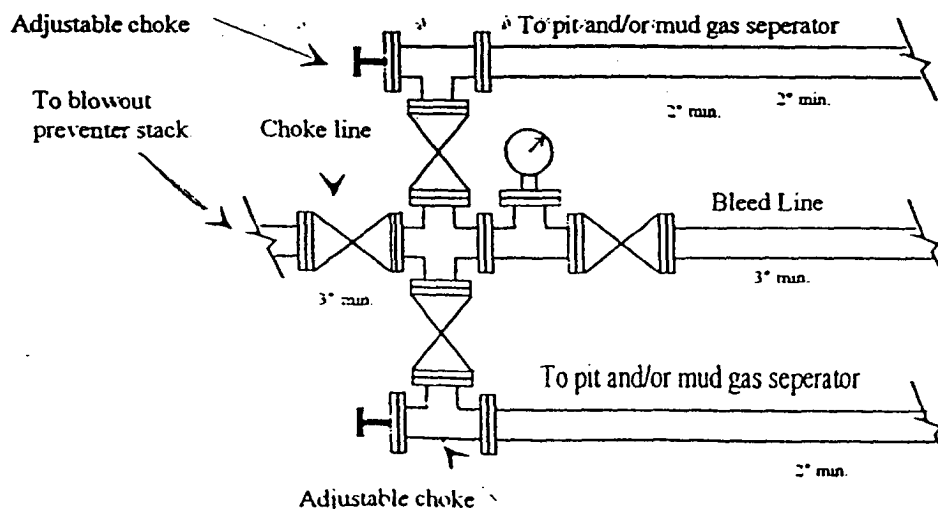

20312  
State 2023 Carol V. Davis  
U.S.

# Eddy County, New Mexico

Exhibit "D"

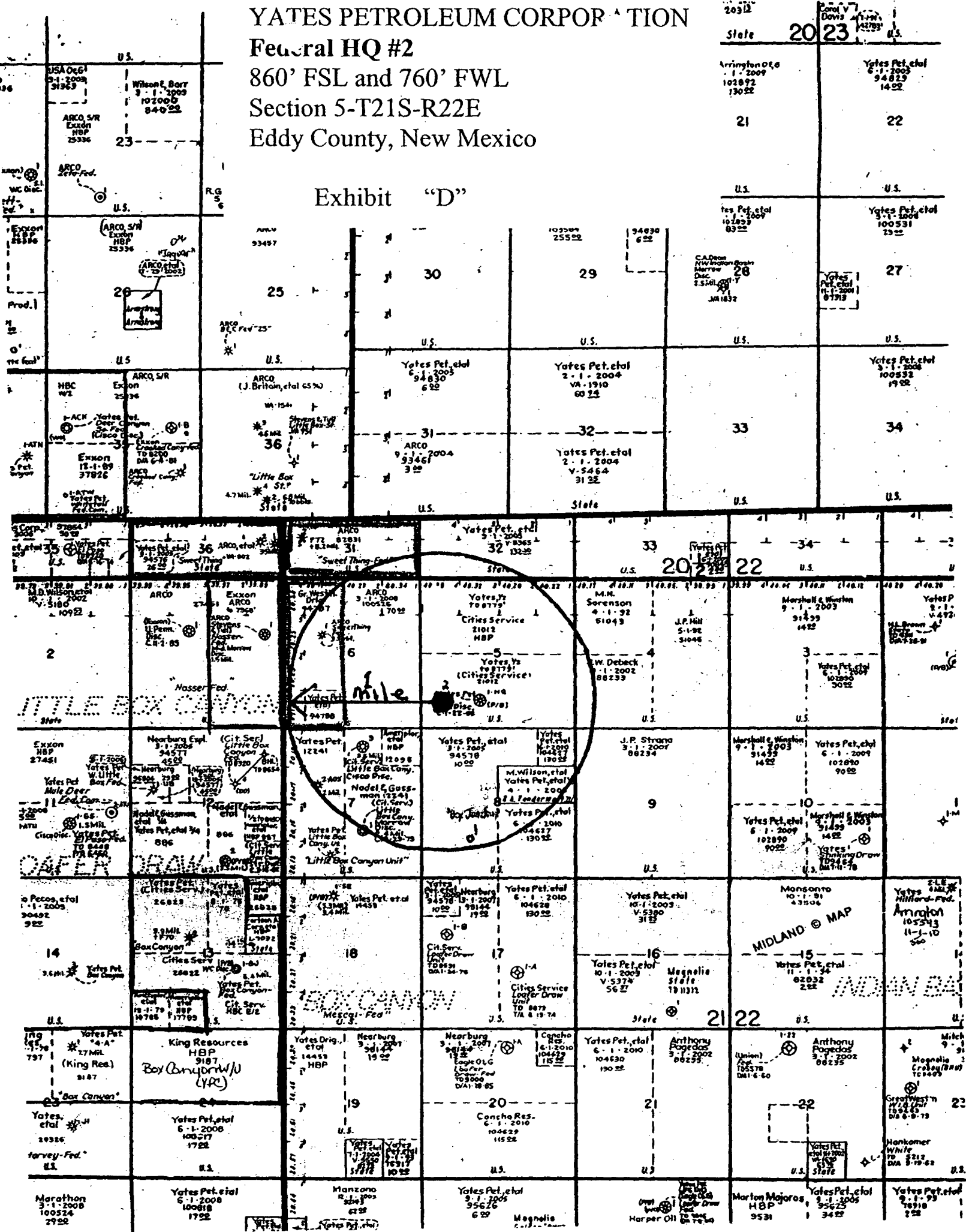

MARTIN YATES, III  
1912 - 1985  
FRANK W. YATES  
1936 - 1986



105 SOUTH FOURTH STREET  
ARTESIA, NEW MEXICO 88210  
TELEPHONE (505) 748-1471

S. P. YATES  
CHAIRMAN OF THE BOARD  
JOHN A. YATES  
PRESIDENT  
PEYTON YATES  
EXECUTIVE VICE PRESIDENT  
RANDY G. PATTERSON  
SECRETARY  
DENNIS G. KINSEY  
TREASURER

**STATEMENT ACCEPTING RESPONSIBILITY FOR OPERATIONS**

The undersigned accepts all applicable terms, conditions, stipulations, and restrictions concerning operations conducted on the leased land or portion thereof, as described below:

Lease No.: NM-21012

Bond Coverage: Individually Bonded

**Legal Description of Land:**

BLM Bond File No.: NM-2811

Federal HQ #2  
860' ESL and 760' FWL S/2  
Section 5, T21S-R22E  
Eddy County, New Mexico

**Formation(s) (if applicable):**

N/A

YATES PETROLEUM CORPORATION

Date: October 20, 2003

  
Regulatory Agent