

RECEIVED
JAN 06 2004
OCD-ARTESIA

N.M. Oil Cons. DIV-Dist. 2
1301 W. Grand Avenue
Artesia, NM 88210

UNITED STATES
DEPARTMENT OF THE INTERIOR
BUREAU OF LAND MANAGEMENT

APPLICATION FOR PERMIT TO DRILL OR REENTER

0
OMB No. 1004-0136
Expires November 30, 2000

5. Lease Serial No.	NM-17208
6. If Indian, Allottee or Tribe Name	Not Applicable
7. If Unit or CA Agreement, Name and No.	Not Applicable
8. Lease Name and Well No.	Dorothy VO Federal #3
9. API Well No.	30-005-63633
10. Field and Pool, or Exploratory	Wildcat Precambrian
11. Sec., T., R., M., or Blk. and Survey or Area	Section 14, T8S-R26E
12. County or Parish	Chaves County
13. State	NM

1a. Type of Work: ☒ DRILL ☐ REENTER

b. Type of Well: ☐ Oil Well ☒ Gas Well ☐ Other ☐ Single Zone ☒ Multiple Zone

2. Name of Operator
Yates Petroleum Corporation

3A. Address **105 South Fourth Street
Artesia, New Mexico 88210**

3b. Phone No. (include area code)
(505) 748-1471

4. Location of Well (Report location clearly and in accordance with any State requirements.)*
At surface **660' FNL and 660' FEL, Unit letter A**
At proposed prod. Zone **same as above**

14. Distance in miles and direction from nearest town or post office*
Approximately twenty (20) miles northeast of Roswell, New Mexico

15. Distance from proposed* location to nearest property or lease line, ft. (Also to nearest drig. unit line, if any)

16. No. of Acres in lease
1266.78

18. Distance from proposed location* to nearest well, drilling, completed, applied for, on this lease, ft.

19. Proposed Depth
5180'

21. Elevations (Show whether DF, KDB, RT, GL, etc.)
3953' GL

22. Approximate date work will start*
ASAP

23. Estimated duration
30 Days

24. Attachments

The following, completed in accordance with the requirements of Onshore Oil and Gas Order No. 1, shall be attached to this form:

- | | |
|--|---|
| 1. Well plat certified by a registered surveyor. | 4. Bond to cover the operations unless covered by an existing bond on file (see Item 20 above). |
| 2. A Drilling Plan. | 5. Operator certification. |
| 3. A Surface Use Plan (if the location is on National Forest System Lands, the SUPO shall be filed with the appropriate Forest Service Office. | 6. Such other site specific information and/or plans as may be required by the authorized office. |

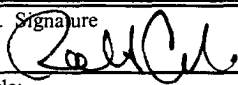
25. Signature 	Name (Printed/Typed) Robert Asher	Date 12/1/03
---	---	------------------------

Title:

Regulatory Agent

Approved by (Signature) /S/LARRY D. BRAY	Name (Printed/Typed) /S/LARRY D. BRAY	Date 1-2-2004
---	--	----------------------

Title Assistant Field Manager, Lease Operations	Office ROSWELL FIELD OFFICE	APPROVED FOR 1 YEAR
--	------------------------------------	----------------------------

Application approval does not warrant or certify that the applicant holds legal or equitable title to those rights in the subject lease which would entitle the applicant to conduct operations thereon.

Conditions of approval, if any, are attached.

Title 18 U.S.C. Section 1001 and Title 43 U.S.C. Section 1212, make it a crime for any person knowingly and willfully to make to any department or agency of the United States any false, fictitious or fraudulent statements or representations as to any matter within its jurisdiction.

*(Instructions on reverse)

APPROVAL SUBJECT TO
GENERAL REQUIREMENTS AND
SPECIAL STIPULATIONS ATTACHED

District I
1625 N. French Dr., Hobbs, NM 88240

District II
811 South First, Artesia, NM 88210

District III
1000 Rio Brazos Rd., Aztec, NM 87410

District IV
1220 S. St. Francis Dr., Santa Fe, NM 87505

State of New Mexico
Energy, Minerals & Natural Resources Department

OIL CONSERVATION DIVISION
1220 South St. Francis Dr.
Santa Fe, NM 87505

Form C-102
Revised August 15, 2000

Submit to Appropriate District Office
State Lease - 4 Copies
Fee Lease - 3 Copies

☐ AMENDED REPORT

WELL LOCATION AND ACREAGE DEDICATION PLAT

¹ API Number	² Pool Code	³ Pool Name Wildcat Precambrian
⁴ Property Code	⁵ Property Name DOROTHY VO FEDERAL	⁶ Well Number 3
⁷ OGRID No. 025575	⁸ Operator Name Yates Petroleum Corporation	⁹ Elevation 3953'

¹⁰ Surface Location

UL or lot no. A	Section 14	Township 8S	Range 26E	Lot Idn	Feet from the 660	North/South line North	Feet from the 660	East/West line East	County Chaves
---------------------------	----------------------	-----------------------	---------------------	---------	-----------------------------	----------------------------------	-----------------------------	-------------------------------	-------------------------

¹¹ Bottom Hole Location If Different From Surface

UL or lot no.	Section	Township	Range	Lot Idn	Feet from the	North/South line	Feet from the	East/West line	County
---------------	---------	----------	-------	---------	---------------	------------------	---------------	----------------	--------

¹² Dedicated Acres 320	¹³ Joint or Infill	¹⁴ Consolidation Code	¹⁵ Order No.
---	-------------------------------	----------------------------------	-------------------------

NO ALLOWABLE WILL BE ASSIGNED TO THIS COMPLETION UNTIL ALL INTERESTS HAVE BEEN CONSOLIDATED OR A
NON-STANDARD UNIT HAS BEEN APPROVED BY THE DIVISION

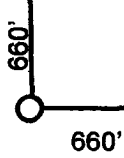
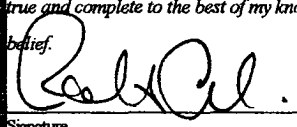
NM-19208					¹⁷ OPERATOR CERTIFICATION I hereby certify that the information contained herein is true and complete to the best of my knowledge and belief.  Signature Robert Asher Printed Name Regulatory Agent Title 12/1/2003 Date
	¹⁸ SURVEYOR CERTIFICATION I hereby certify that the well location shown on this plat was plotted from field notes of actual surveys made by me or under my supervision, and that the same is true and correct to the best of my belief. REFER TO ORIGINAL PLAT Date of Survey Signature and Seal of Professional Surveyor: Certificate Number				

DISTRICT II
911 South First, Artesia, NM 88210

DISTRICT III
1000 Rio Brazos Rd., Aztec, NM 87410

DISTRICT IV
2040 South Pacheco, Santa Fe, NM 87508

Energy, Minerals and Natural Resources Department

Instruction on back
Submit to Appropriate District Office
State Lease - 4 Copies
Fee Lease - 3 Copies

OIL CONSERVATION DIVISION

P.O. Box 2088

Santa Fe, New Mexico 87504-2088

☐ AMENDED REPORT

WELL LOCATION AND ACREAGE DEDICATION PLAT

API Number	Pool Code	Pool Name
		Wildcat Precambrian
Property Code	Property Name	Well Number
	DOROTHY "VO" FEDERAL	3
OGRID No.	Operator Name	Elevation
025575	YATES PETROLEUM CORPORATION	3953

Surface Location

UL or lot No.	Section	Township	Range	Lot Idn	Feet from the	North/South line	Feet from the	East/West line	County
A	14	8S	26E		660	NORTH	660	EAST	CHAVES

Bottom Hole Location If Different From Surface

UL or lot No.	Section	Township	Range	Lot Idn	Feet from the	North/South line	Feet from the	East/West line	County

Dedicated Acres	Joint or Infill	Consolidation Code	Order No.
320			

NO ALLOWABLE WILL BE ASSIGNED TO THIS COMPLETION UNTIL ALL INTERESTS HAVE BEEN CONSOLIDATED
OR A NON-STANDARD UNIT HAS BEEN APPROVED BY THE DIVISION

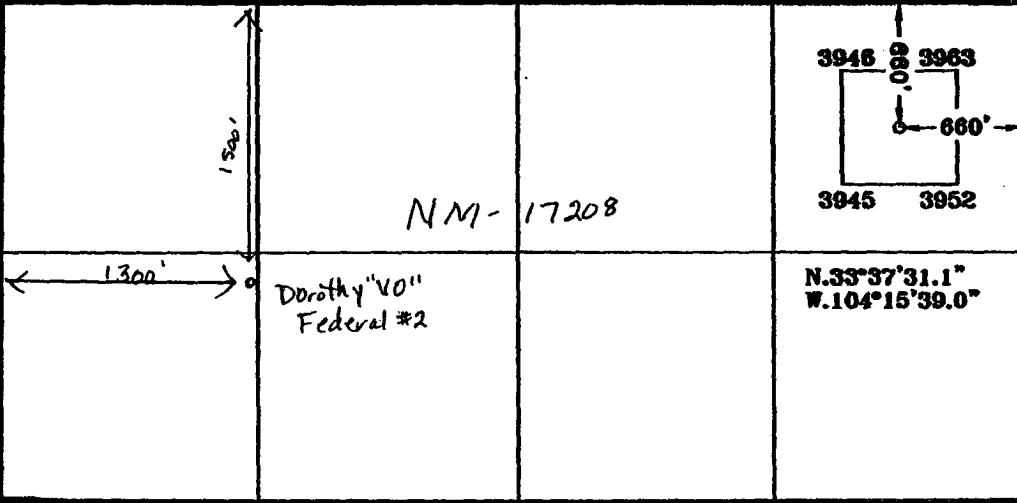
	Dorothy "VO" Federal #2	N.33°37'31.1" W.104°15'39.0"

OPERATOR CERTIFICATION

I hereby certify the the information contained herein is true and complete to the best of my knowledge and belief.

Patricia Perez
Signature

Patricia Perez
Printed Name

Regulatory Agent
Title

7/21/2003
Date

SURVEYOR CERTIFICATION

I hereby certify that the well location shown on this plat was plotted from field notes of actual surveys made by me or under my supervision, and that the same is true and correct to the best of my belief.

7/14/2003
Date Surveyed

Signature & Seal of Professional Surveyor
Herschell L. Jones

Certificate No. Herschell L. Jones RLS 3640
DOROTHY 3
GENERAL SURVEYING COMPANY
PROFESSIONAL

0 330' 660' 990' 1650' 1980' 2310' 2310' 1980' 1650' 990' 660' 330' 0'

YATES PETROLEUM CORPORATION
Dorothy VO Federal #3
660' FNL and 660' FEL
Section 14,T8S-R26E
Chaves County, New Mexico

1. The estimated tops of geologic markers are as follows:

San Andres	1145'	Cisco	5846'
Glorieta	2240'	Strawn	5965'
Yeso	2365'	Mississippian	6200'
Tubb	3816'	Siluro-Devonian	6345'
Abo	4570'	Basement-Granite Wash	6590'
Wolfcamp	5270'	TD	6740'

2. The estimated depths at which anticipated water, oil or gas formations are expected to be encountered:

Water: 150'-200'
Oil or Gas: All potential zones.

3. Pressure Control Equipment: BOPE will be installed on the 8 5/8" casing and rated for 2000 BOP systems will be consistent with API RP 53. Pressure tests will be conducted before drilling out from under all casing strings which are set and cemented in place. Blowout Preventor controls will be installed prior to drilling the surface plug and will remain in use until the well is completed or abandoned. Preventors will be inspected and operated at least daily to ensure good mechanical working order, and this inspection recorded on the daily drilling report. See Exhibit B.

Auxiliary Equipment:

- A. Auxiliary Equipment: Kelly cock, pit level indicators, flow sensor equipment and a sub with full opening valve to fit the drill pipe and collars will be available on the rig floor in the open position at all times for use when kelly is not in use.

4. THE PROPOSED CASING AND CEMENTING PROGRAM:

- A. Casing Program: (All New)

<u>Hole Size</u>	<u>Casing Size</u>	<u>Wt./Ft</u>	<u>Grade</u>	<u>Coupling</u>	<u>Interval</u>
12 1/4	8 5/8"	24#	J-55	ST&C	0-900'
7 7/8"	5 1/2"	15.5#	J-55	ST&C	0-6740'

1. Minimum Casing Design Factors: Collapse 1.125, Burst 1.0, Tensile Strength 1.8
2. Yates Petroleum Corporation requests that a variance be granted in requiring the casing and BOPE to be tested to 2000 PSI to testing the casing and BOPE to 1000 PSI. The rig pumps will be used to test the casing and BOPE. Rig pumps used in this area cannot safely test above 1000 PSI. We would have to go to the greater expense of hiring an independent service to do the testing. Also, the maximum shut-in bottom hole pressure is 1100 PSI. Pressure at the surface is much less. Most of the time the Abo formation requires treatment before it flows.

N O

Dorothy VO Federal #3

Page 2

A. CEMENTING PROGRAM:

Surface Casing: 325 sx Lite "C" (YLD 2.0 WT 12.5). Tail in with 200 sx "C" + 2% CaCL₂ (YLD 1.33 WT 15.6).

Production Casing: 550 sx PVL (YLD 1.34 WT 13.0). TOC 3900'.

5. MUD PROGRAM AND AUXILIARY EQUIPMENT:

<u>Interval</u>	<u>Type</u>	<u>Weight</u>	<u>Viscosity</u>	<u>Fluid Loss</u>
0-1000'	FW GEL,Paper,LCM	8.6 - 9.6	32-36	N/C
1000'-4450	Brine	10.0-10.2	28	N/C
4450'-6740'	Starch/Salt Gel	9.3 -10.2	32-40	<6/cc

Sufficient mud material(s) to maintain mud properties, control lost circulation and contain a blow out will be available at the well site during drilling operations. Mud will be checked hourly by rig personnel.

6. EVALUATION PROGRAM:

Samples: 10' samples out from under surface casing.

Logging: CNL/LDT, W/NGT TD-Surf csg; with CNL/GR up to Surf; DLL/MS
FL TD-Surf csg; BHC Sonic TD-SURF CSG; FMI-TD – Top of Wolfcamp

Coring: None

DST's: As warranted.

7. ABNORMAL CONDITIONS, BOTTOM HOLE PRESSURE, AND POTENTIAL HAZARDS:

Anticipated BHP:

From: 0	TO: 1000'	Anticipated Max. BHP: 400 PSI
From: 1000'	TO: 6740'	Anticipated Max. BHP: 3000 PSI

Abnormal Pressures Anticipated: None

Lost Circulation Zones Anticipated: None.

H₂S Zones Anticipated: None Anticipated

Maximum Bottom Hole Temperature: 110 F

8. ANTICIPATED STARTING DATE:

Plans are to drill this well as soon as possible after receiving approval. It should take approximately 25 days to drill the well with completion taking another 20 days.

MULTI-POINT SURFACE USE AND OPERATIONS PLAN

Dorothy VO Federal #3
660' FNL and 660' FEL
Section 14,T8S-R26E
Chaves County, New Mexico

This plan is submitted with Form 3160-3, Application for Permit to Drill, covering the above described well. The purpose of this plan is to describe the location of the proposed well, the proposed construction activities and operations plan, the magnitude of the surface disturbance involved and the procedures to be followed in rehabilitating the surface after completion of the operations, so that a complete appraisal can be made of the environmental effect associated with the operations.

1. EXISTING ROADS:

Exhibit A is a portion of the BLM map showing the well and roads in the vicinity of the proposed location. The proposed wellsite is located approximately 20 miles northeast of Roswell, New Mexico and the access route to the location is indicated in red and green on Exhibit A.

DIRECTIONS:

Drive northeast of Roswell on Highway 70, approximately 17.5 miles to lease road on the left (north) side. Turn left on road and drive to the Jervis AYB Federal #1 well. The access road is staked on the east side of this location going east for approximately 973.2' (on the north side of a Agave Pipeline). The road will then turn north for approximately 1,114' SE corner of the location.

2. PLANNED ACCESS ROAD:

- A. The proposed new access will be approximately 2087.2' in length from the point of origin to the southeast corner of the drilling pad. The road will lie in a east to west direction, then a north to south direction.
- B. The new road will be 14 feet in width (driving surface) and will be adequately drained to control runoff and soil erosion.
- C. Existing roads will be maintained in the same or better condition.

3. LOCATION OF EXISTING WELL:

- A. There is drilling activity within a one-mile radius of the wellsite.
- B. Exhibit D shows existing wells within a one-mile radius of the proposed wellsite.

4. LOCATION OF EXISTING AND/OR PROPOSED FACILITIES:

- A. There are production facilities on this lease at the present time.
- B. In the event that the well is productive, the necessary production facilities will be installed on the drilling pad. If the well is productive oil, a gas or diesel self-contained unit will be used to provide the necessary power. No power will be required if the well is productive of gas.

5. LOCATION AND TYPE OF WATER SUPPLY:

- A. It is planned to drill the proposed well with a fresh water system. The water will be obtained from commercial sources and will be hauled to the location by truck over the existing and proposed roads shown in Exhibit A.

6. SOURCE OF CONSTRUCTION MATERIALS:

Dirt contractor will locate nearest pit and obtain any permits and materials needed for construction.

7. METHODS OF HANDLING WASTE DISPOSAL:

- A. Drill cuttings will be disposed of in the reserve pits.
- B. Drilling fluids will be allowed to evaporate in the reserve pits until the pits are dry.
- C. Water produced during operations will be collected in tanks until hauled to an approved disposal system, or separate disposal application will be submitted.
- D. Oil produced during operations will be stored in tanks until sold.
- E. Current laws and regulations pertaining to the disposal of human waste will be complied with.
- F. All trash, junk, and other waste materials will be contained in trash cages or bins to prevent scattering and will be removed and deposited in an approved sanitary landfill. Burial on site is not approved.

8. ANCILLARY FACILITIES: NONE

9. WELLSITE LAYOUT:

- A. Exhibit C shows the relative location and dimensions of the well pad, the reserve pits, the location of the drilling equipment, rig orientation and access road approach.
- B. The reserve pits will be plastic lined.
- C. A 400' x 400' area has been staked and flagged.

10. PLANS FOR RESTORATION:

- A. After finishing drilling and/or completion operations, all equipment and other material not needed for further operations will be removed. The location will be cleaned of all trash and junk to leave the wellsite in as aesthetically pleasing a condition as possible.
- B. Unguarded pits, if any, containing fluids will be fenced until they have dried and been leveled.
- C. If the proposed well is non-productive, all rehabilitation and/or vegetation requirements of the Bureau of Land Management will be complied with and will be accomplished as expeditiously as possible. All pits will be filled level after they have evaporated and dried.

11. SURFACE OWNERSHIP: Carl Cooper
Cooper Revocable Trust
P.O. Box 2148
Roswell, New Mexico 88202

An agreement has been reached concerning surface damage.

12. OTHER INFORMATION:

- A. Topography: Refer to the existing archaeological report for a description of the topography, flora, fauna, soil characteristics, dwellings, historical and cultural sites.
- B. The primary surface use is for grazing.

13. OPERATOR'S REPRESENTATIVE:

- | | |
|--|---|
| A. Through A.P.D. Approval:
Robert Asher, Permit Agent
Yates Petroleum Corporation
105 South Fourth Street
Artesia, New Mexico 88210
Phone (505) 748-1471 | B. Through Drilling, Completions & Prod.
Pinson McWhorter, Operations Manager
Yates Petroleum Corporation
105 South Fourth Street
Artesia, New Mexico 88210
Phone (505) 748-1471 |
|--|---|

14. CERTIFICATION:

I hereby certify that I, or persons under my direct supervision, have inspected the proposed drill site and access route, that I am familiar with the conditions which presently exist; that the statements made in this plan are to the best of my knowledge, true and correct; and, that the work associated with the operations proposed herein will be performed by Yates Petroleum Corporation and its contractors and subcontractors in conformity with this plan and the terms and conditions under which it is approved. This statement is subject to the provisions of 18 U.S.C. 1001 for the filing of a false statement.

12/1/2003

Regulatory Agent

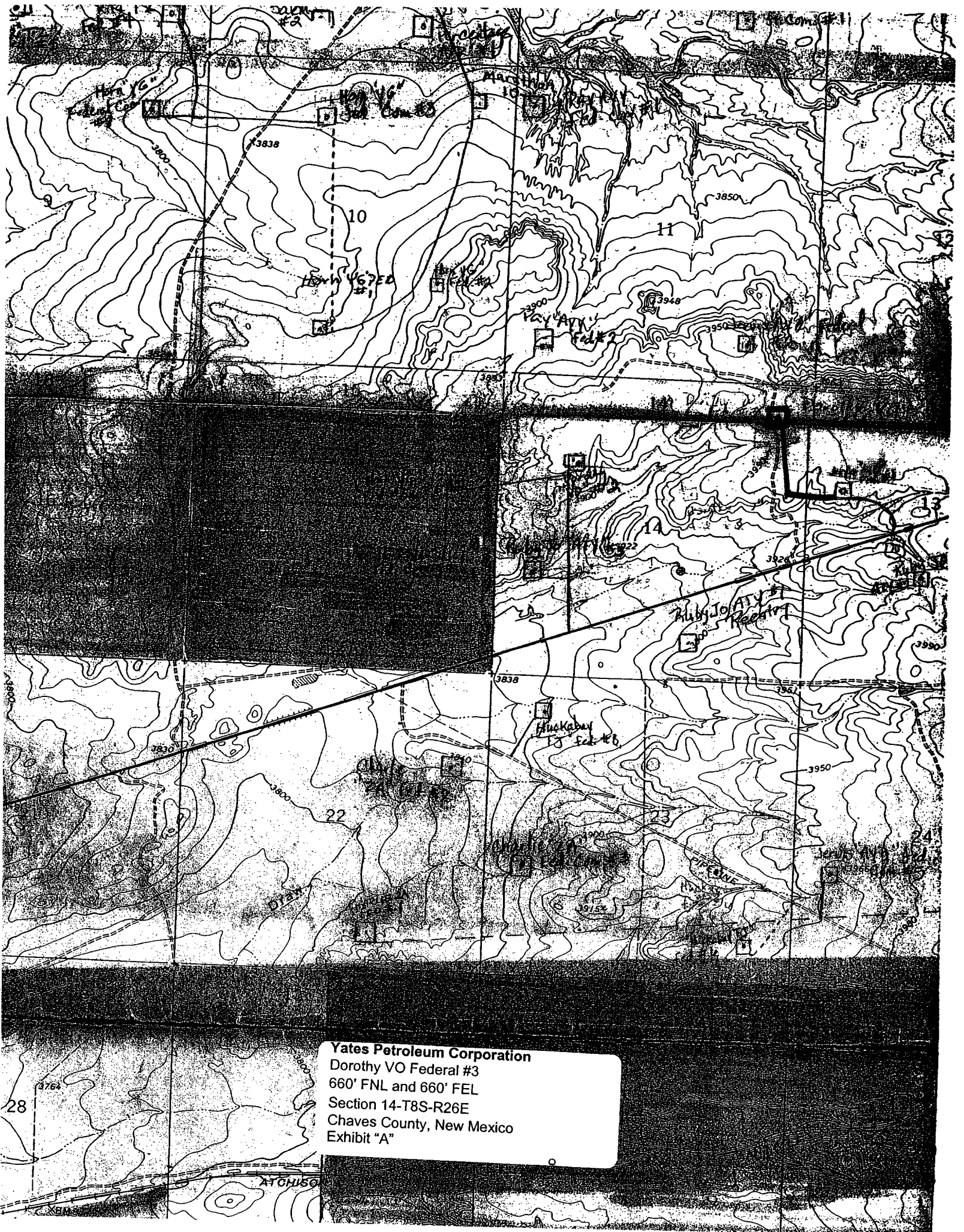

Yates Petroleum Corporation
Dorothy VO Federal #3
660' FNL and 660' FEL
Section 14-T8S-R26E
Chaves County, New Mexico
Exhibit "A"

SECTION 13, TOWNSHIP 8 SOUTH, RANGE 26 EAST, NMPM, CHAVES COUNTY, NEW MEXICO.

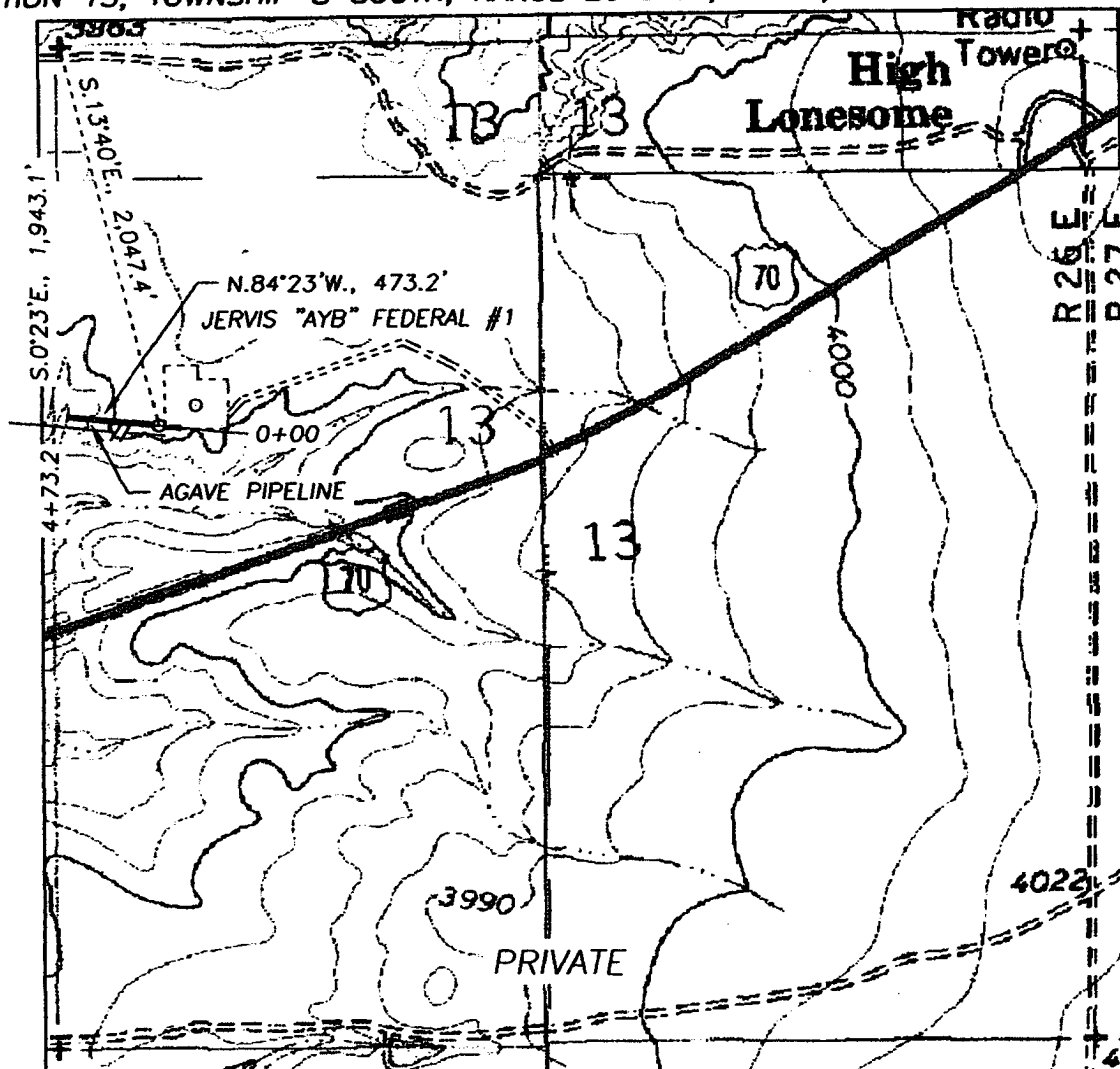

DESCRIPTION:

A LEASE ROAD RIGHT OF WAY 30 FEET WIDE, BEING 15 FEET TO THE LEFT AND RIGHT OF THE FOLLOWING DESCRIBED SURVEY CENTERLINE;

BEGINNING AT STA.0+00, A POINT LOCATED AT THE SOUTHWEST CORNER OF THE EXISTING YATES JERVIS FEDERAL #1 WELL AND BEARING S.13°40'E., 2,047.4 FEET DISTANT FROM THE NORTHWEST CORNER OF SECTION 13, TOWNSHIP 8 SOUTH, RANGE 26 EAST, NMPM, CHAVES COUNTY, NEW MEXICO; THENCE N.84°23'W., 473.2 FEET, ALONG THE NORTH SIDE OF AN EXISTING AGAVE PIPELINE RIGHT OF WAY, TO STA.4+73.2, A POINT LOCATED S.0°23'E., 1,943.1 FEET DISTANT FROM THE NORTHWEST CORNER OF SAID SECTION 13.

473.2 FEET = 28.6788 RODS, MORE OR LESS.

Yates Petroleum Corporation
Dorothy VO Federal #3
660' FNL and 660' FEL
Section 14-T8S-R26E
Chaves County, New Mexico
Exhibit "A-1"

1000' 0 1000' 2000'
Scale: 1" = 1000'

THE PREPARATION OF THIS PLAN AND THE PERFORMANCE OF THE SURVEY UPON WHICH IT IS BASED WERE DONE UNDER MY DIRECTION AND THE PLAT ACCURATELY DEPICTS THE RESULTS OF SAID SURVEY AND MEET THE REQUIREMENTS OF THE STANDARDS FOR LAND SURVEYS IN NEW MEXICO AS ADOPTED BY THE NEW MEXICO STATE BOARD OF REGISTRATION FOR PROFESSIONAL ENGINEERS AND LAND SURVEYORS.

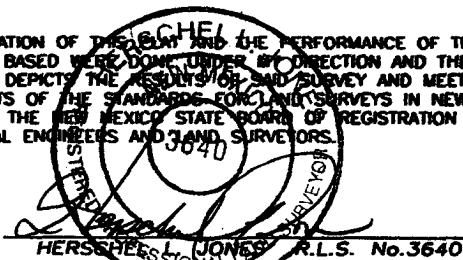

GENERAL SURVEYING COMPANY P.O. BOX 1928
LOVINGTON, NEW MEXICO 88260

YATES PETROLEUM CORP.

LEASE ROAD TO ACCESS THE YATES DOROTHY "VO" FEDERAL #3 WELL, LOCATED IN SECTION 14, TOWNSHIP 8 SOUTH, RANGE 26 EAST, NMPM, CHAVES COUNTY, NEW MEXICO.

Survey Date: 7/14/2003	Sheet 1 of 2 Sheets
Drawn By: Ed Blevins	W.O. Number
Date: 7/14/03	Scale 1" = 1000' DOROTHY 3

SECTION 14, TOWNSHIP 8 SOUTH, RANGE 26 EAST, NMPM, CHAVES COUNTY, NEW MEXICO.

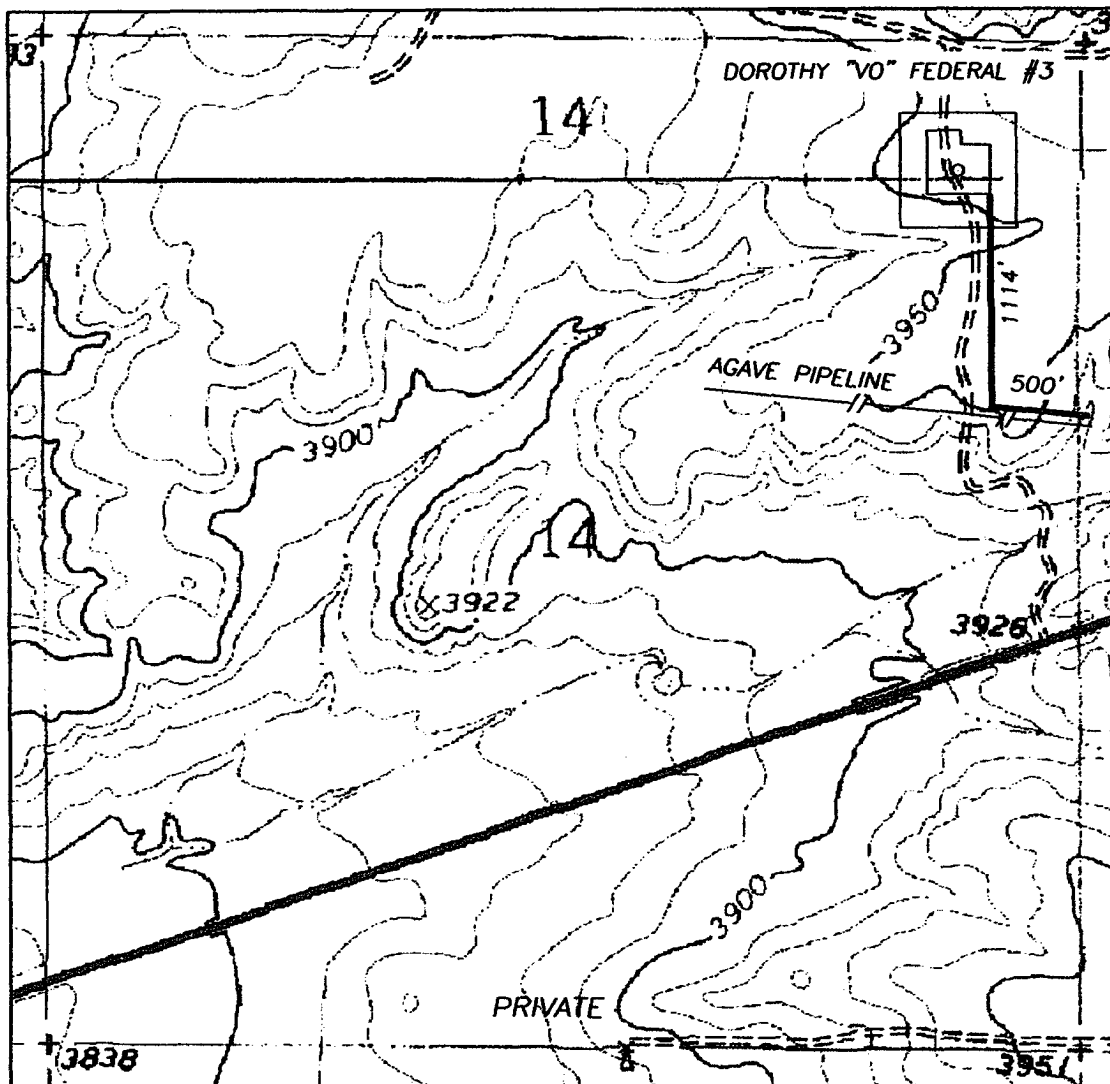

Yates Petroleum Corporation
Dorothy VO Federal #3
660' FNL and 660' FEL
Section 14-T8S-R26E
Chaves County, New Mexico
Exhibit "A-2"

1000' 0 1000' 2000'
Scale 1" = 1000'

THE PREPARATION OF THIS PLAT AND THE PERFORMANCE OF THE SURVEY UPON WHICH IT IS BASED WERE DONE UNDER MY DIRECTION AND THE PLAT ACCURATELY DEPICTS THE RESULTS OF SAID SURVEY AND MEET THE REQUIREMENTS OF THE STANDARDS FOR LAND SURVEYS IN NEW MEXICO AS ADOPTED BY THE NEW MEXICO STATE BOARD OF REGISTRATION FOR PROFESSIONAL ENGINEERS AND LAND SURVEYORS.

HERSCHEL L. JONES P.E.L.S. No. 3640

GENERAL SURVEYING COMPANY P.O. BOX 1928
LOVINGTON, NEW MEXICO 88260

YATES PETROLEUM CORP.

LEASE ROAD TO ACCESS THE YATES DOROTHY VO FEDERAL #3 WELL, LOCATED IN SECTION 14, TOWNSHIP 8 SOUTH, RANGE 26 EAST, NMPM, CHAVES COUNTY, NEW MEXICO.

Survey Date: 7/14/2003

Drawn By: Ed Blevins

Date: 7/14/03

Sheet 2 of 2 Sheets

W.O. Number

Scale 1" = 1000' DOROTHY 3

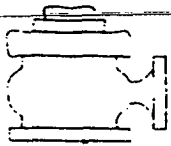

Yates Petroleum Corporation

BOP-2

Typical 2,000 psi Pressure System Schematic

Double Ram Preventer Stack

Yates Petroleum Corporation
Dorothy VO Federal #3
660' FNL and 660' FEL
Section 14-T8S-R26E
Chaves County, New Mexico
Exhibit "B"

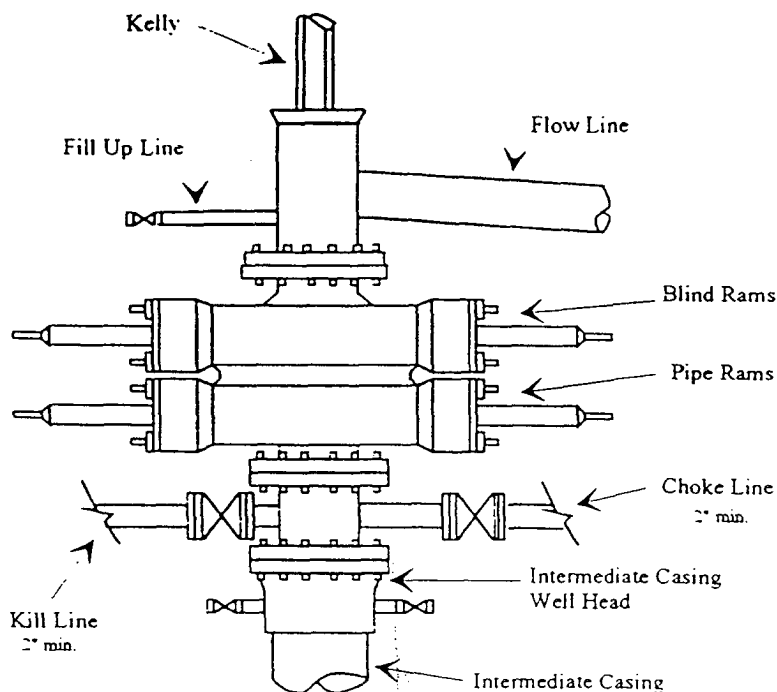

Typical 2,000 psi choke manifold assembly with at least these minimum features

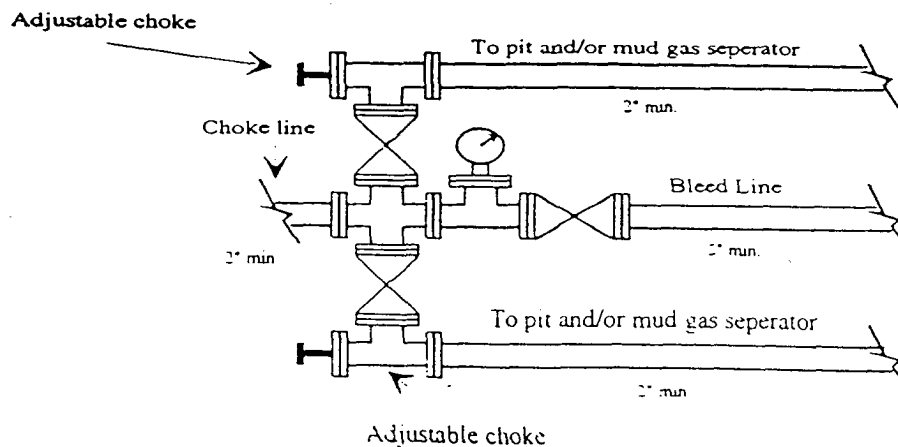

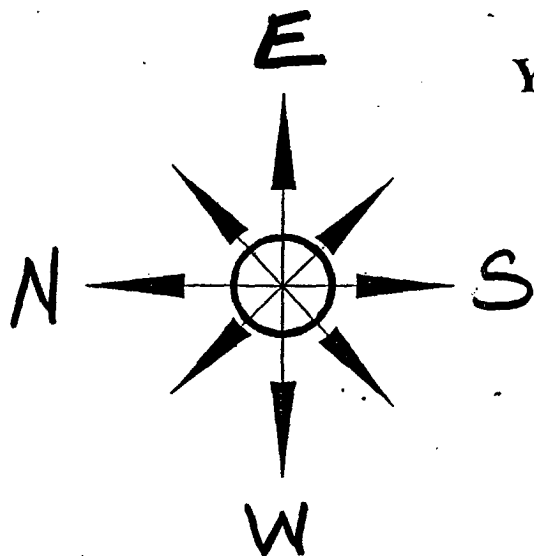

Yates Petroleum Corporation

Location Layout for Permian Basin

Up to 12,000'

Yates Petroleum Corporation

Dorothy VO Federal #3

660' FNL and 660' FEL

Section 14-T8S-R26E

Chaves County, New Mexico

Exhibit "C"

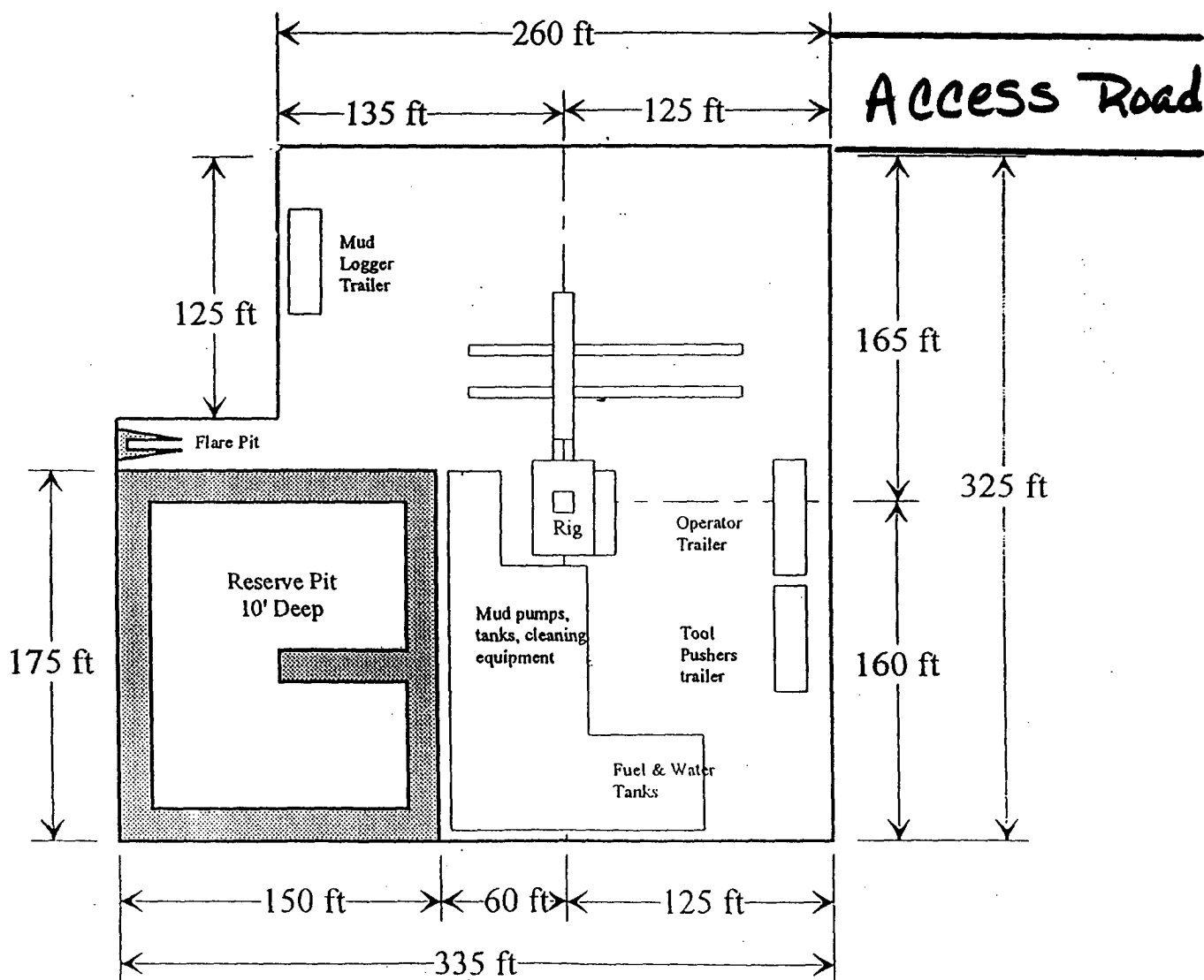

Distance from Well Head to Reserve Pit will vary between rigs

The above dimension should be a maximum

Yates Petroleum Corporation
Dorothy VO Federal #3
660' FNL and 660' FEL
Section 14-T8S-R26E
Chaves County, New Mexico
Exhibit "D"

