

Young N.M. Oil Cons. Div. Dist 2
UNITED STATES DEPARTMENT OF THE INTERIOR
BUREAU OF LAND MANAGEMENT
1301 W. Grand Avenue
Artesia, NM 88210

FORM APPROVED
OMB NO. 1004-0136
Expires: February 28, 1995

0177

5. LEASE DESIGNATION AND SERIAL NO.
NM 17095

APPLICATION FOR PERMIT TO DRILL OR DEEPEN

6. IF INDIAN, ALLOTTEE OR TRIBE NAME

7. UNIT AGREEMENT NAME

8. FARM OR LEASE NAME, WELL NO.
Esperanza 1 Federal Com #3

9. API WELL NO.
30-015-33169

10. FIELD AND POOL, OR WILDCAT
Burton Flat Morrow

11. SEC., T., R., M., OR BLK.
AND SURVEY OR AREA
Sec. 1 T-21S R-27E

12. COUNTY OR PARISH
Eddy

13. STATE
NM

1a. TYPE OF WORK

DRILL ☒

DEEPEN ☐

b. TYPE OF WELL

OIL
WELL ☐

GAS
WELL ☒

OTHER

SINGLE
ZONE ☐

MULTIPLE
ZONE ☐

2. NAME OF OPERATOR

Mewbourne Oil Company 14744

3. ADDRESS AND TELEPHONE NO.

PO Box 5270, Hobbs, New Mexico 88241, 505-393-5905

4. LOCATION OF WELL (Report location clearly and in accordance with any State requirements.)

At surface 1500' FSL & 1260' FEL

At proposed prod. zone
Same

14. DISTANCE IN MILES AND DIRECTION FROM NEAREST TOWN OR POST OFFICE*

4 miles NE of Carlsbad, NM

15. DISTANCE FROM PROPOSED*

LOCATION TO NEAREST
PROPERTY OR LEASE LINE, FT
(Also to nearest drg. unit line, if any)

1260'

16. NO. OF ACRES IN LEASE

320

17. NO. OF ACRES ASSIGNED
TO THIS WELL

320

18. DISTANCE FROM PROPOSED LOCATION*
TO NEAREST WELL, DRILLING, COMPLETED,
OR APPLIED FOR, ON THIS LEASE, FT.

300'

19. PROPOSED DEPTH

14800' 11900'

20. ROTARY OR CABLE TOOLS

Rotary

21. ELEVATIONS (Show whether DF, RT, GR, etc.)

3192' GL

22. APPROX. DATE WORK WILL START*

12/31/03

23.

PROPOSED CASING AND CEMENTING PROGRAM

SIZE OF HOLE	GRADE, SIZE OF CASING	WEIGHT PER FOOT	SETTING DEPTH	QUANTITY OF CEMENT
17 1/2"	13 3/8" H-40	48#	400'	Cird to Surface
12 1/4"	9 5/8" N & J-55	40#	2600'	Cird to Surface
7 7/8"	5 1/2" N-80	17#	11800'	600' above pay

WITNESS

- 1) Location & Elevation Plat (NMOCD Form C102)
- 2) Drilling Program
- 3) Surface Use & Operation Plan
- 4) Schematic Diagram of BOP & Choke Manifold (Exhibit 2 & 2A)
- 5) Map of Existing & Planned access Road & Location. (Exhibits 3 & 3A)
- 6) List of Off-Set wells
- 7) Proposed Drilling Rig Layout (Exhibit 5)
- 8) Proposed Production Facilities (Exhibit 6)
- 9) H2S Contingency Plan (Exhibit 7)

APPROVAL SUBJECT TO
GENERAL REQUIREMENTS
AND SPECIAL STIPULATIONS
ATTACHED

IN ABOVE SPACE DESCRIBE PROGRAM: If proposal is to deepen, give data on present productive zone and proposed new productive zone. If proposal is to drill or deepen directionally, give pertinent data on subsurface locations and measured and true vertical depths. Give blowout preventer program, if any.

24.

SIGNED

N.M. Young

TITLE N.M. Young District Manager

DATE 11/26/03

(This space for Federal or State office use)

PERMIT NO.

APPROVAL DATE

Application approval does not warrant or certify that the applicant holds legal or equitable title to those rights in the subject lease which would entitle the applicant to conduct operations thereon.
CONDITIONS OF APPROVAL, IF ANY:

APPROVED BY

/S/ JOE G. LARA

TITLE

ACTING
FIELD MANAGER

DATE

JAN 07 2004

*See Instructions On Reverse Side

Title 18 U.S.C. Section 1001, makes it a crime for any person knowingly and willfully to make to any department or agency of the United States any false, fictitious or fraudulent statements or representations as to any matter within its jurisdiction.

APPROVAL FOR 1 YEAR

1875 N. French Dr., Hobbs, NM 88240
DISTRICT II
811 South First, Artesia, NM 88210

DISTRICT III
1000 Rio Brazos Rd., Aztec, NM 87410

DISTRICT IV
2040 South Pacheco, Santa Fe, NM 87505

Energy, Minerals and Natural Resources Department

Revised March 17, 1999
Instruction on back
Submit to Appropriate District Office
State Lease - 4 Copies
Fee Lease - 3 Copies

OIL CONSERVATION DIVISION

P.O. Box 2088
Santa Fe, New Mexico 87504-2088

☐ AMENDED REPORT

WELL LOCATION AND ACREAGE DEDICATION PLAT

API Number	Pool Code	Pool Name
		Burton Flat Morrow
Property Code	Property Name	Well Number
	ESPERANZA "1" FEDERAL COM.	3
OGRID No.	Operator Name	Elevation
14744	MEWBOURNE OIL COMPANY	3192

Surface Location

UL or lot No.	Section	Township	Range	Lot Idn	Feet from the	North/South line	Feet from the	East/West line	County
1	1	21S	27E		1500	SOUTH	1260	EAST	EDDY

Bottom Hole Location If Different From Surface

UL or lot No.	Section	Township	Range	Lot Idn	Feet from the	North/South line	Feet from the	East/West line	County

Dedicated Acres	Joint or Infill	Consolidation Code	Order No.
320			

NO ALLOWABLE WILL BE ASSIGNED TO THIS COMPLETION UNTIL ALL INTERESTS HAVE BEEN CONSOLIDATED
OR A NON-STANDARD UNIT HAS BEEN APPROVED BY THE DIVISION

LOT 12	LOT 11	LOT 10	LOT 9
LOT 13	LOT 14	LOT 15	LOT 16

NM 17095
N.32°30'22.3"
W.104°08'18.7"

3189 3188
3194 3191
1260'
1500'

OPERATOR CERTIFICATION
I hereby certify the the information contained herein is true and complete to the best of my knowledge and belief.
Signature N.M. Young
Printed Name District Manager
Title 11/25/03
Date

SURVEYOR CERTIFICATION
I hereby certify that the well location shown on this plat was plotted from field notes of actual surveys made by me or under my supervision, and that the same is true and correct to the best of my belief.
Date Surveyed 11/11/2003
Signature & Seal of Professional Surveyor RENE SCHMIDT
Certificate No. 3640
Certified by Norman Schmitt Jones RLS 3640
GENERAL SURVEYING COMPANY

0 330' 660' 990' 1650' 1980' 2310' 2310' 1980' 1650' 990' 660' 330' 0'

Drilling Program
Mewbourne Oil Company
Esperanza 1 Federal Com #3
1500' FSL & 1260' FEL
Section 1 T-21S R-27E
Eddy County, New Mexico

1. The estimated top of geological markers are as follows:

Delaware	2,865'
Bone Spring	5,365'
Wolfcamp	9,200'
Strawn	10,300'
Atoka	10,900'
Morrow	11,300'

2. Estimated depths of anticipated fresh water, oil, or gas:

Water	Approximately 200'
Hydrocarbons	All zones below Delaware

3. Pressure control equipment:

A 2000 psi working pressure annular BOP will be installed on the 13-3/8" surface casing. A 5000 psi WP Double Ram BOP and a 2500 psi WP Annular will be installed after running 9 5/8" casing. Pressure tests will be conducted prior to drilling out under all casing strings. A 3rd party tester will pressure test all BOPE as required. BOP controls will be installed prior to drilling under surface casing and will remain in use until completion of drilling operations. BOP's will be inspected and operated daily to insure mechanical integrity and the inspection will be recorded on the daily drilling report.

Kelly cock and a sub equipped with a full opening valve sized to fit the drill pipe and collars will be available on the rig floor in the open position when the kelly is not in use.

4. Proposed casing and cementing program:

A. Casing Program:

<u>Hole Size</u>	<u>Casing</u>	<u>Wt/Ft.</u>	<u>Grade</u>	<u>Depth</u>
17-1/2"	13-3/8"	48#	H40	0-400'
12-1/4"	9-5/8"	40#	N80/J55	0-2,600'
8-3/4"	5-1/2"	17#	P110/N80	0-11,900'

Drilling Program

Mewbourne Oil Company

Esperanza 1 Federal Com #3

Page 2

Minimum casing design factors: Collapse 1.125, Burst 1.0, Tensile strength 1.8.

B. Cementing Program

- i. Surface Casing: 300 sacks Class "C" light cement containing ½ #/sk cellophane flakes, 2% CaCl, 5 lbs/sack gilsonite. 200 sacks Class "C" cement containing 2% CaCl.
- ii. Intermediate Casing: 900 sacks 35.65 pozmix cement containing 6% gel, 5 lbs/sack gilsonite. 200 sacks Class "C" cement containing 2% CaCl.
- iii. Production Casing: 600 sacks Class "H" cement containing fluid loss additive, friction reducer additive, compressive strength enhancer, and NaCl. Shallower productive zones may be protected by utilizing a multiple stage cementing tool in the production casing below potentially productive zones and cementing with a light cement slurry.

**Mewbourne Oil Company reserves the right to change cement designs as hole conditions may warrant.*

5. Mud Program:

Fresh per Mickey Young

<u>Interval</u>	<u>Type System</u>	<u>Weight</u>	<u>Viscosity</u>	<u>Fluid Loss</u>
0'-400'	FW spud mud	8.6-9.4	32-34	NA
400'-2600'	Brine water	10.0-10.2	28-30	NA
2600'-9200'	Cut brine water	8.8-9.2	28.30	NA
9200'-11900'	Cut brine water	9.2-9.8	32-42	8-12

(Note: Any additional weight above 8.6 lb/gal would be used to hold back Wolfcamp shale rather than abnormal BHP in the Morrow formation.)

6. Evaluation Program:

Samples: 10'samples from intermediate casing to TD
Logging: Compensated density/dual laterlog from intermediate casing to TD
Coring: As needed for evaluation
Drill Stem Tests: As needed for evaluation

7. Downhole Conditions

Zones of abnormal pressure: None anticipated
Zones of lost circulation: Anticipated in surface and intermediate holes
Maximum bottom hole temperature: 170 degree F
Maximum bottom hole pressure: 8.6 lbs/gal gradient or less

Drilling Program

Mewbourne Oil Company

Esperanza 1 Federal Com #3

Page 3

8. Anticipated Starting Date:

Mewbourne Oil Company intends to drill this well as soon as possible after receiving approval with approximately 45 days involved in drilling operations and an additional 10 days involved in completion operations on the project.

MULTI-POINT SURFACE USE AND OPERATIONS PLAN

MEWBOURNE OIL COMPANY

Esperanza 1 Federal Com #3

1500' FSL & 1260' FEL

Section 1 T-21S R-27E

Eddy County, New Mexico

Lease Number NM-17095

This plan is submitted with Form 3160-3, Application for Permit to Drill, Covering the above described well. The purpose of this plan is to describe the location of the proposed well, the proposed construction activities and operations plan, the magnitude of the surface disturbance involved, and the procedures to be followed in restoring the surface so that a complete appraisal can be made of the environmental impact associated with the proposed operations.

1. Existing Roads:

- A. Exhibit #3 is a road map showing the location of the proposed well. Exhibit #3A is a topographic map showing the location of the proposed well and access road. Existing roads are highlighted in yellow and proposed roads are highlighted in green.
- B. **Directions to location:** From Hobbs, N.M., go west on 62/180 61 miles to MM44. Turn north on Magnum road for appx 1 mile over RR tracks. Continue north 2/10th mile. Turn west on lease road & go appx 1.7 miles. Turn north & go appx 1 mile. Turn east & go 5/10 mile. Turn north 5/10 mile & go on to existing pad. MOC's location is on the SW corner.

2. Proposed Access Road:

No new road will be needed for this operation.

3. Location of Existing Wells:

There are producing wells within the immediate vicinity of the well site. Exhibit #4 shows the proposed well and existing wells within a one mile radius.

4. Location of Existing and/or Proposed Facilities:

- A. There are no MOC production facilities on this lease at the present time.
- B. In the event that the well is productive, production facilities will be located on the well pad.
- C. If the well is productive, restoration plans are as follows:

MULTI-POINT SURFACE USE AND OPERATIONS PLAN

MEWBOURNE OIL COMPANY

Esperanza 1 Federal Com #3

Page 2

- i. The reserve pit will be back-filled after the contents of the pit are allowed to dry (within 10 months after the well is completed).
- ii. Within 90 days of cessation of drilling and completion operations, all equipment not necessary for production operations will be removed. The location will be cleaned of all trash and junk to assure the well site is left as aesthetically pleasing as reasonably possible
- iii. All production vessels left on location will be painted to conform with BLM painting stipulations within 180 days of installation.

5. Location and Type of Water Supply

The well will be drilled with a combination of fresh water and brine water based mud systems. The water will be obtained from commercial suppliers in the area and hauled to the location by transport trucks over existing roads.

6. Source of Construction Materials

All material required for construction of the drill pad and access roads will be obtained from private, state, or federal pits. The construction contractor will be solely responsible for securing construction materials required for this operation and paying any royalties that may be required on those materials.

7. Methods of Handling Waste Disposal:

- A. Drill cuttings not retained for evaluation purposed will be disposed of in the reserve pit.
- B. Drilling fluids will be allowed to evaporate in the reserve pit prior to closure.
- C. Water produced during operations will be disposed of in the reserve pit.
- D. If any liquid hydrocarbons are produced during operations, those liquids will be stored in suitable tanks until sold.
- E. Current regulations regarding the proper disposal of human waste will be followed.
- F. All trash, junk, and other waste materials will be stored in proper containers to prevent dispersal and will be removed to an appropriate facility within one week of cessation of drilling and completion activities.

8. Ancillary Facilities

There are no ancillary facilities within the immediate vicinity of the proposed well site.

MULTI-POINT SURFACE USE AND OPERATIONS PLAN

MEWBOURNE OIL COMPANY

Esperanza 1 Federal Com #3

Page 3

9. Well Site Layout

- A. A diagram of the drill pad is shown in Exhibit #5. Dimensions of the pad, pits, and location of major rig components are shown.
- B. The reserve pit will be lined with a high quality plastic sheeting to prevent migration of fluids.
- C. The pad dimension of 600' X 600' has been staked and flagged.
- D. An archaeological survey has been conducted on the proposed location pad.

10. Plans for Restoration of Surface

- A. Upon cessation of the proposed operations, if the well is abandoned, the location and road will be ripped and re-seeded per BLM guidelines. The reserve pit area, after allowing to dry will be leveled. The entire location will be restored to the original contour as much as reasonable possible. All trash, garbage, and pit lining will be hauled to appropriate disposal to assure the location is aesthetically pleasing as reasonable possible. All restoration work will be completed within 180 days of cessation of activities.
- B. The disturbed area will be restored by re-seeding during the proper growing season with a mixture of native grasses as stipulated by the BLM.
- C. Three sides of the reserve pit will be fenced prior to and during drilling operations. The reserve pit will be fenced on the fourth side after the drilling rig is removed to prevent the endangerment of livestock. The fence will remain in place until the pit area has been leveled and restored.
- D. Upon cessation of the proposed operations, if the well is not abandoned, the reserve pit area will be treated as outlined above within the prescribed amount of time. Any additional caliche required for production facilities will be obtained from a source as described in Section 6.

11. Surface Ownership:

The surface is owned by: Bureau of Land Management

12. Other Information

- A. Topography: Refer to the archaeological report for a detailed description of flora, fauna, soil characteristics, dwellings, and historical or cultural sites.
- B. The primary use of the surface at the location is for grazing of livestock.

MULTI-POINT SURFACE USE AND OPERATIONS PLAN

MEWBOURNE OIL COMPANY

Esperanza 1 Federal Com #3

Page 4

13. Operator's Representative:

A. Through APD approval and drilling operations:

Mickey Young, District Manager
Mewbourne Oil Company
PO Box 5270
Hobbs, NM 88241
505-393-5905

B. Through completion and production operations:

Mickey Young, District Manager
Mewbourne Oil Company
PO Box 5270
Hobbs, NM 88241
505-393-5905

14. Certification

I hereby certify that I, or persons under my direct supervision, have inspected the proposed drill site and access route; that I am familiar with the conditions which currently exist; that the statements made in this plan are to the best of my knowledge, true and correct; and the work associated with the operations proposed herein will be performed by Mewbourne Oil Company, its contractors and subcontractors, in accordance with this plan and the terms and conditions under which it is approved. This statement is subject to the provisions of 18 U.S.C. 1001 for the filing of a false statement.

Date: 11/25/03

Signature: 

Mickey Young, District Manager
Mewbourne Oil Company
PO Box 5270
Hobbs, NM 88241
(505) 393-5905

Mewbourne Oil Company
BOP Schematic for
12 1/4" Hole

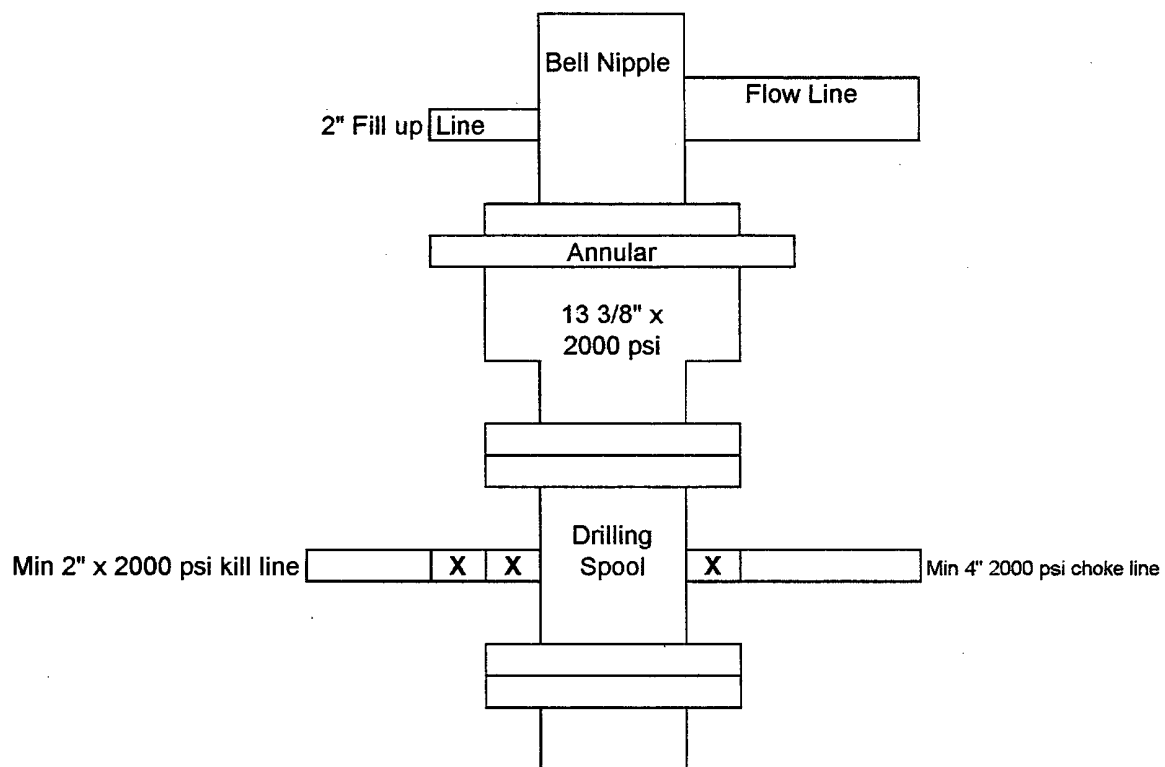

Exhibit #2

Esperanza 1 Federal Com #3
1500' FSL & 1260' FEL
1/21S/27E
Eddy
New Mexico

Mewbourne Oil Company
BOP Schematic for
8 3/4" or 7 7/8" Hole

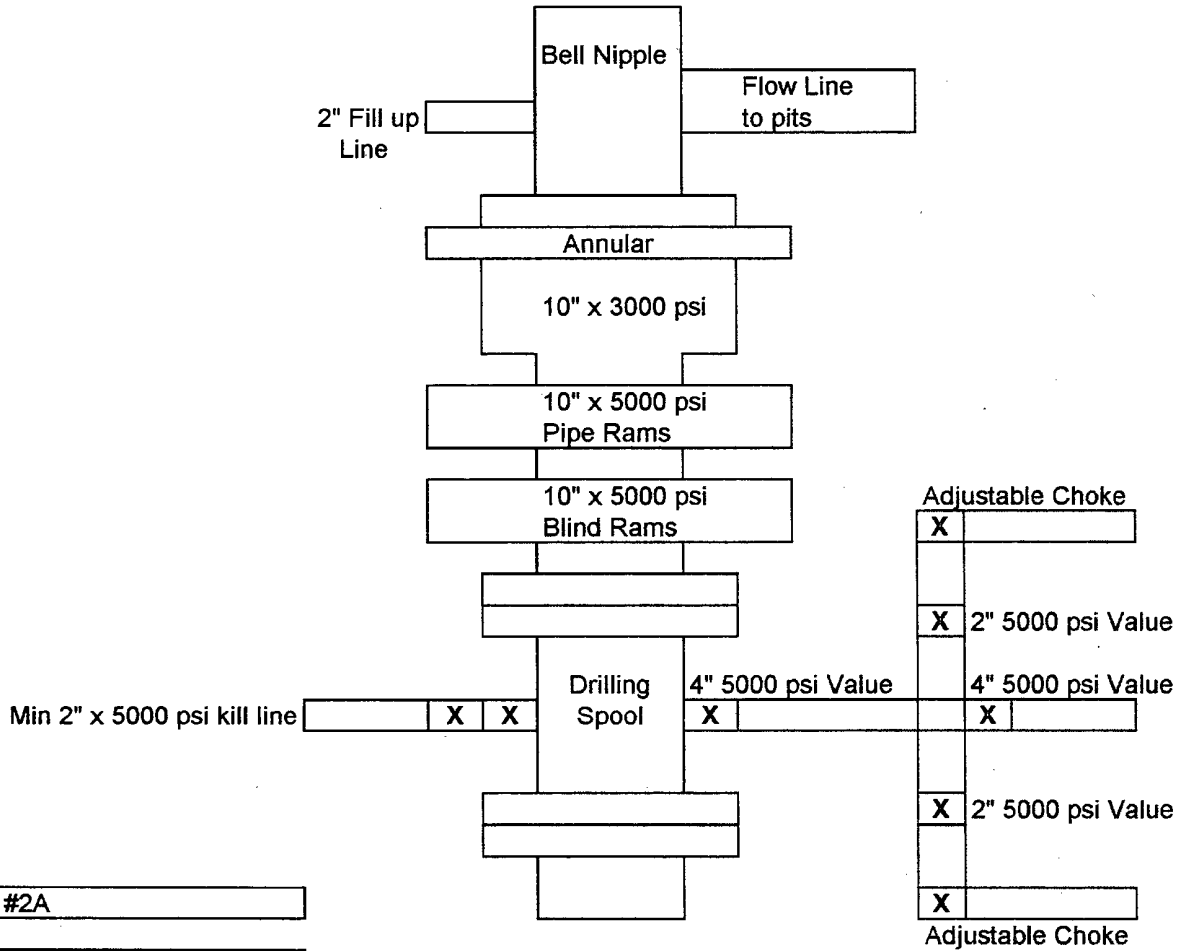

Exhibit #2A

Esperanza 1 Federal Com #3
1500' FSL & 1260' FEL
1/21S/27E
Eddy
New Mexico

Notes Regarding Blowout Preventer

Mewbourne Oil Company

Esperanza 1 Federal #3
1500' FSL & 1260' FEL
Section 1 T-21S R-27E
Eddy County, New Mexico
Lease Number NM-17095

1. Drilling nipple (bell nipple) to be constructed so that it can be removed without the use of a welder through the opening of the rotary table, with minimum internal diameter equal to blowout preventer bore.
2. Blowout preventer and all fittings must be in good condition with a minimum 5000 psi working pressure.
3. Safety valve must be available on the rig floor at all times with proper connections to install in the drill string. Valve must be full bore with minimum 5000 psi working pressure.
4. Equipment through which bit must pass shall be at least as large as internal diameter of the casing.
5. A kelly cock shall be installed on the kelly at all times.
6. Blowout preventer closing equipment to include and accumulator of at least 40 gallon capacity, two independent sources of pressure on closing unit, and meet all other API specifications.

Mewbourne Oil Co.
Exhibit # 3
Esperanza 1 Fed Com # 3
1500' FSL & 1260' FEL
1/21S/27E Eddy NM

Carlsbad, New Mexico, United States

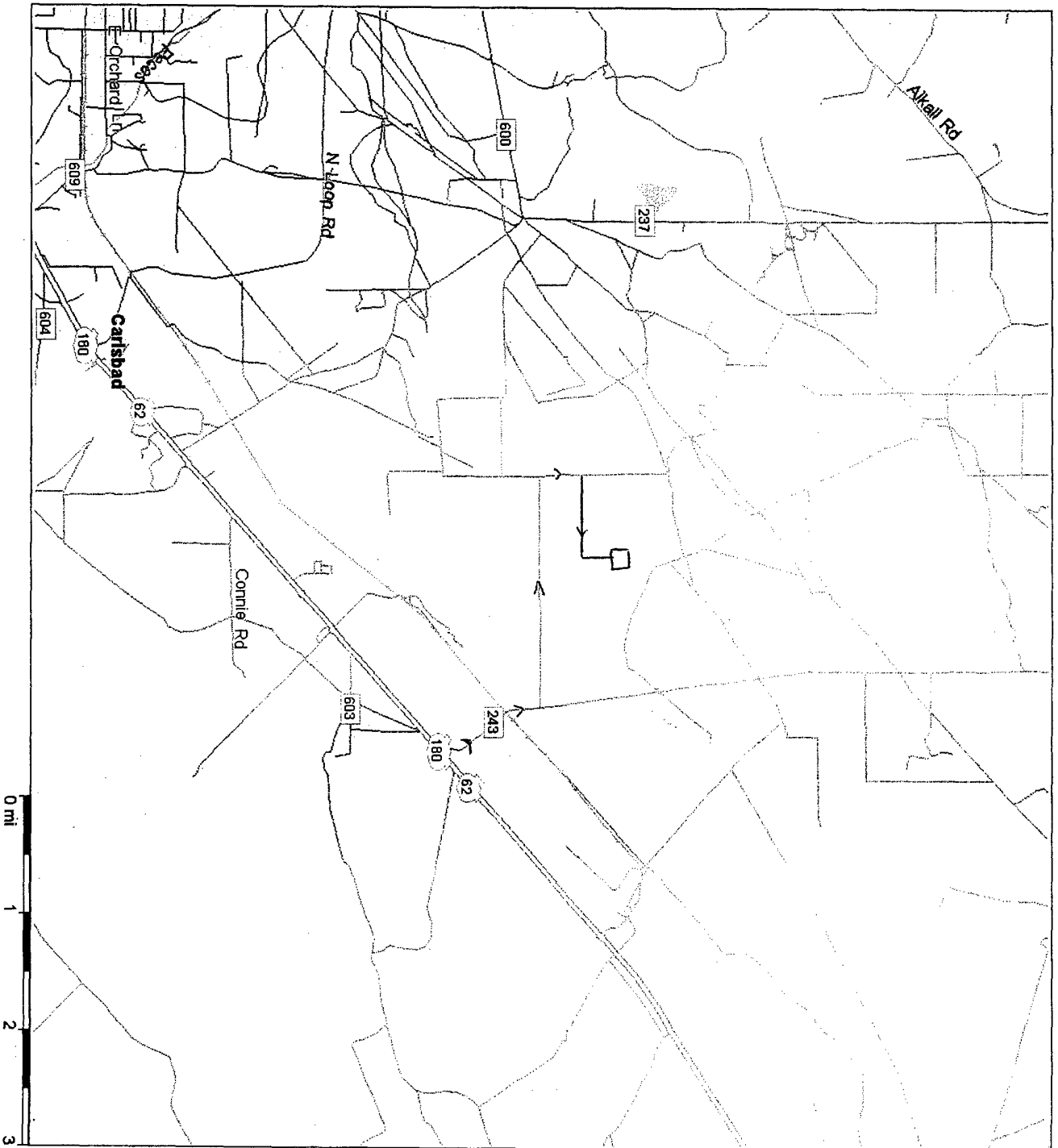

SECTION 1, TOWNSHIP 21 SOUTH, RANGE 27 EAST, NMPM, EDDY COUNTY, NEW MEXICO.

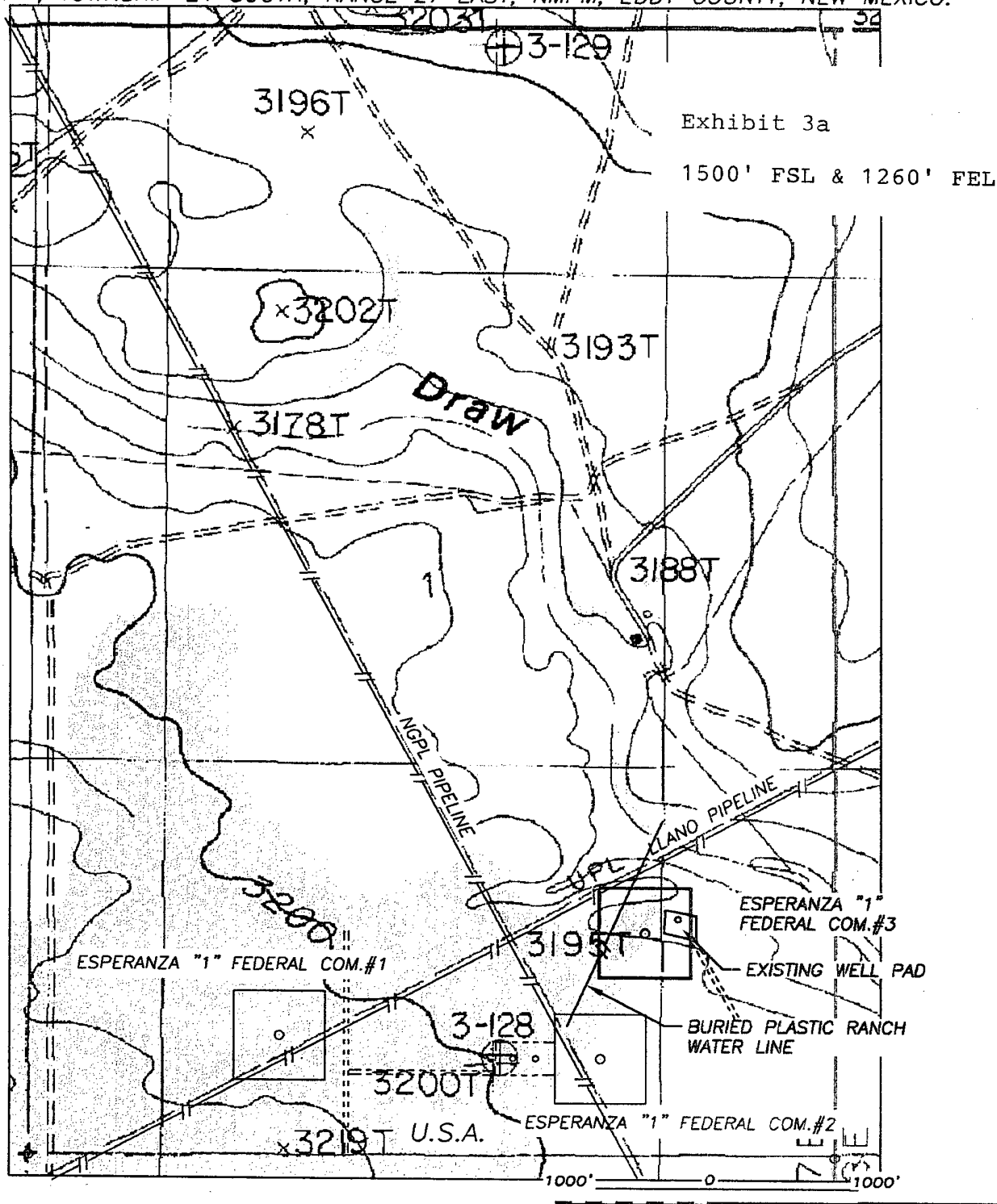

THE PREPARATION OF THIS PLAT AND THE PERFORMANCE OF THE SURVEY UPON WHICH IT IS BASED WERE DONE UNDER MY DIRECTION AND THE PLAT ACCURATELY DEPICTS THE RESULTS OF SAID SURVEY AND MEET THE REQUIREMENTS OF THE STANDARD FOR LAND SURVEYS IN NEW MEXICO AS ADOPTED BY THE NEW MEXICO STATE BOARD OF REGISTRATION FOR PROFESSIONAL ENGINEERS AND LAND SURVEYORS.

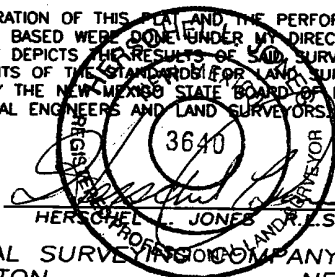

GENERAL SURVEYING COMPANY P.O. BOX 1928
LOVINGTON, NEW MEXICO 88260

MEWBOURNE OIL COMPANY

LEASE ROAD TO ACCESS THE MEWBOURNE ESPERANZA "1" FEDERAL COM.#3 WELL, LOCATED IN SECTION 1, TOWNSHIP 21 SOUTH, RANGE 27 EAST, NMPM, EDDY COUNTY, NEW MEXICO.

Survey Date: 11/11/2003	Sheet 1 of 1 Sheets
Drawn By: Ed Blevins	W.O. Number
Date: 11/11/03	Scale 1" = 1000' ESPE 1-3

Exhibit #4
Status of Wells in Immediate Vicinity
Mewbourne Oil Company
Esperanza 1 Federal Com #3
1500' FSL & 1260' FEL
Section 1 T-21S R-27E
Eddy County, New Mexico
Lease # NM-17095

Section 1 T-21S R-27E

Operator: Permian Resources Inc.
Well Name: Government D #12
Unit letter: I
Status: Producing
Field: Avalon Bone Springs East

Operator: Permian Resources Inc
Well Name: Government D #5
Unit letter: J
Status: Producing
Field: Avalon Bone Springs East

Operator: Permian Resources Inc
Well Name: Government D #7
Unit letter: O
Status: Producing
Field: Avalon Bone Springs East

Mewbourne Oil Company

Exhibit 5

Well Name **Esperanza 1 Federal Com #3**
Footages **1500' FSL & 1260' FEL**
STR **1/21S/27E**
County **Eddy**
State **New Mexico**

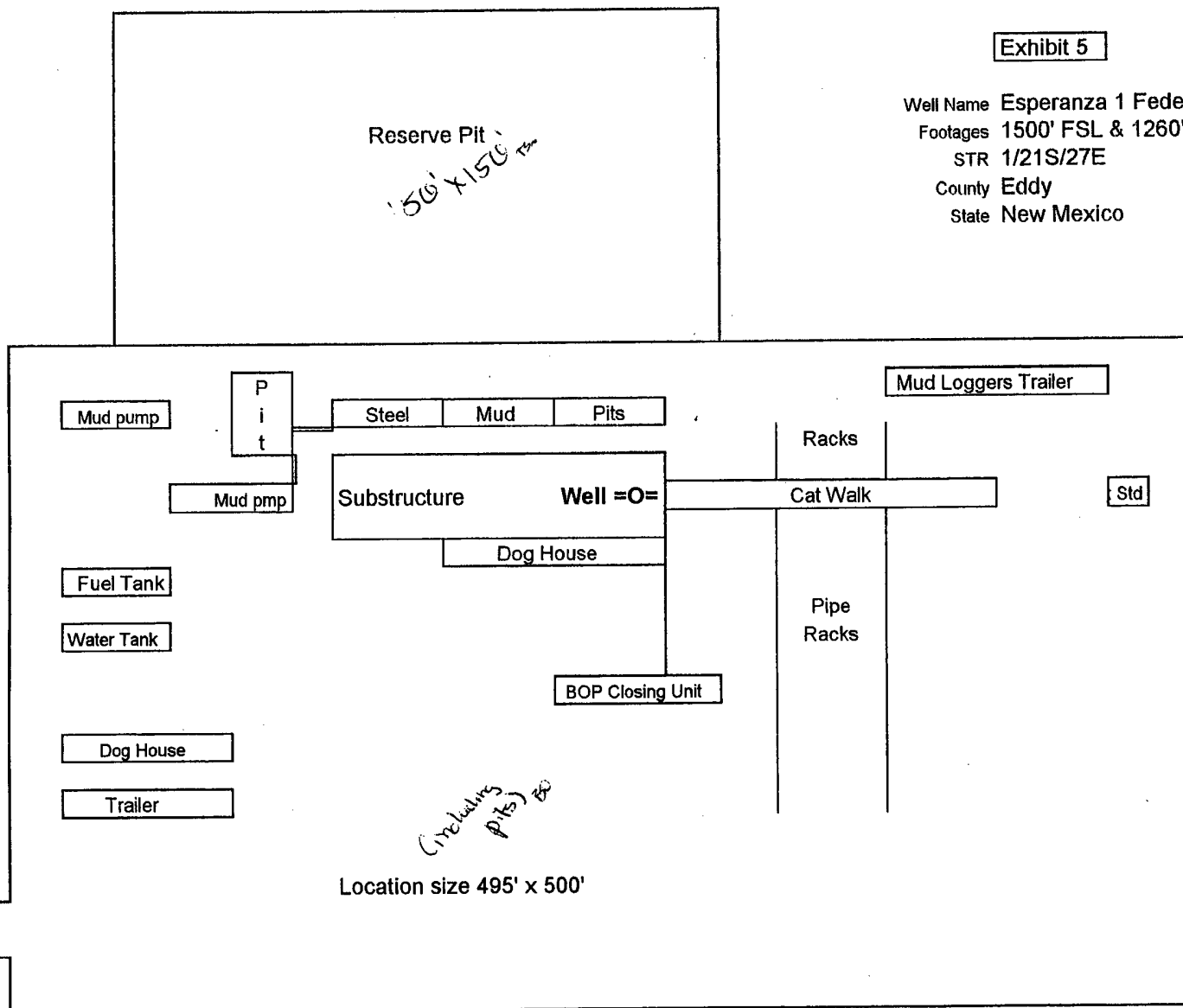

Rig Location Schematic

Proposed Production Facilities Schematic

Mewbourne Oil Company

Exhibit # 6

Proposed Production Facilities Schematic

Esperanza 1 Federal #3

1500' FSL & 1260' FEL

Sec. 1; T-21S; R-27E

Eddy County, NM

Flow Line

Water Line

Oil Dump Line

Gas Sales Line

Sealing Valve

Non Sealing Valve

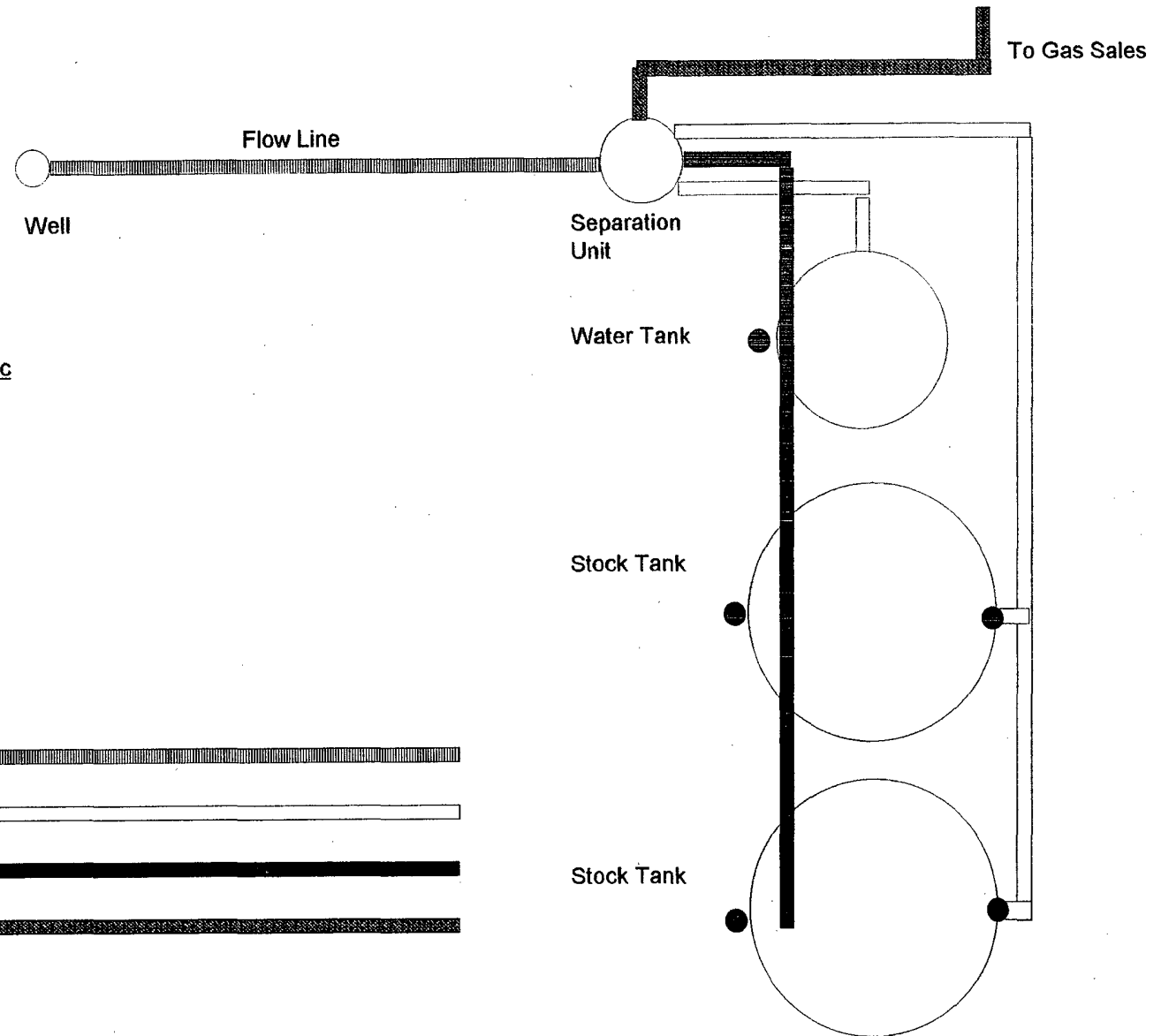

Hydrogen Sulfide Drilling Operations Plan

Mewbourne Oil Company

Esperanza 1 Federal Com #3

1500' FSL & 1260' FEL

Section 1 T-21S R-27E

Eddy County, New Mexico

Lease Number NM-17095

1. Hydrogen Sulfide Training

All personnel, whether regularly assigned, contracted, or employed on an unscheduled basis, will have received training from a qualified instructor in the following areas prior to entering the drilling pad area of the well:

- A. The hazards and characteristics of hydrogen sulfide gas.
- B. The proper use of personal protective equipment and life support systems.
- C. The proper use of hydrogen sulfide detectors, alarms, warning systems, briefing areas, evacuation procedures.
- D. The proper techniques for first aid and rescue operations.

Additionally, supervisory personnel will be trained in the following areas:

- A. The effects of hydrogen sulfide on metal components. If high tensile tubular systems are utilized, supervisory personnel will be trained in their special maintenance requirements.
- B. Corrective action and shut in procedures, blowout prevention, and well control procedures while drilling a well.
- C. The contents of the Hydrogen Sulfide Drilling Operations Plan.

There will be an initial training session prior to encountering a known hydrogen sulfide source. The initial training session shall include a review of the site specific Hydrogen Sulfide Drilling Operations Plan.

2. Hydrogen Sulfide Safety Equipment and Systems

All hydrogen sulfide safety equipment and systems will be installed, tested, and operational prior to drilling below the intermediate casing.

A. Well Control Equipment

- 1. Flare line with automatic igniter or continuous ignition source.
- 2. Choke manifold with minimum of one adjustable choke.
- 3. Blowout preventers equipped with blind rams and pipe rams to accommodate all pipe sizes with properly sized closing unit
- 4. Auxiliary equipment including rotating head and annular type blowout preventer.

B. Protective Equipment for Essential Personnel

Thirty minute self contained work unit located at briefing area as indicated on well site diagram.

C. Hydrogen Sulfide Protection and Monitoring Equipment

Two portable hydrogen sulfide monitors positioned on location for optimum coverage and detection. The units shall have audible sirens to notify personnel when hydrogen sulfide levels exceed 20 ppm.

D. Visual Warning Systems

1. Wind direction indicators as indicated on the well site diagram.
2. Caution signs shall be posted on roads providing access to location. Signs shall be painted a high visibility color with lettering of sufficient size to be readable at reasonable distances from potentially contaminated areas.

3. Mud Program

The mud program has been designed to minimize the amount of hydrogen sulfide entrained in the mud system. Proper mud weight, safe drilling practices, and the use of hydrogen sulfide scavengers will minimize hazards while drilling the well.

4. Metallurgy

All tubular systems, wellheads, blowout preventers, drilling spools, kill lines, choke manifolds, and valves shall be suitable for service in a hydrogen sulfide environment when chemically treated.

5. Communications

Communications in company vehicles and tool pushers are either two way radios or cellular phones.

6. Well Testing

Drill stem testing is not an anticipated requirement for evaluation of this well. A drill stem test is required, it will be conducted with a minimum number of personnel in the immediate vicinity. The test will be conducted during daylight hours only.

**United States Department of the Interior
Bureau of Land Management
Roswell Field Office
2909 West Second Street
Roswell, New Mexico 88201-1287**

Statement Accepting Responsibility for Operations

Operator Name: Mewbourne Oil Company
Street or Box: P.O. Box 5270
City, State: Hobbs, New Mexico
Zip Code: 88241

The undersigned accepts all applicable terms, conditions, stipulations, and restrictions concerning operations conducted of the leased land or portion thereof, as described below.

Lease Number: Lease Number NM-17094

Legal Description of Land: Section 1, T-21S, R-27E, Eddy County, New Mexico. Location 1500' FSL & 1260' FEL..

Formation (if applicable):

Bond Coverage: \$150,000

BLM Bond File: NM1693, Nationwide

Authorized Signature: _____

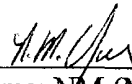
Name: NM (Micky) Young
Title: District Manager
Date: November 25, 2003

MEWBOURNE OIL COMPANY

P.O. BOX 5270
HOBBS, NEW MEXICO 88241
TEL. (505) 393-5905
FAX (505) 397-6252

To: OCD Artesia.

From: Micky Young, Mewbourne Oil Company, Hobbs, N.M.

RE: H2S Letter for the
Esperanza 1 Federal Com #3
1500' FSL & 1260' FEL
Sec. 1 T-21S R-27E
Eddy Co, N.M.

Mewbourne Oil Company is planning to drill the above captioned well. Our research in this area shows no abnormal H2S problems. MOC will have all safety equipment on the rig before the Delaware formation @ 2865.

If any questions or concerns, please call at the below numbers.

Thank you,

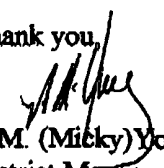
N.M. (Micky) Young
District Manager
Office @ 505-393-5905
Cellular @ 505-390-0999