

RECEIVED

DEC 16 2009

NMOC D ARTESIA

Form 3100
(August 2007)

OCD-ARTESIA

10-125

FORM APPROVED
OMB No. 1004-0137
Expires July 31, 2010UNITED STATES
DEPARTMENT OF THE INTERIOR
BUREAU OF LAND MANAGEMENT

APPLICATION FOR PERMIT TO DRILL OR REENTER

1a. Type of work: <input checked="" type="checkbox"/> DRILL <input type="checkbox"/> REENTER		5. Lease Serial No. NMNM-2538
1b. Type of Well: <input checked="" type="checkbox"/> Oil Well <input type="checkbox"/> Gas Well <input type="checkbox"/> Other <input type="checkbox"/> Single Zone <input type="checkbox"/> Multiple Zone		6. If Indian, Allottee or Tribe Name
2. Name of Operator Nadel and Gussman HEYCO, LLC		7. If Unit or CA Agreement, Name and No.
3a. Address P.O. Box 1936 Roswell N.M. 88202	3b. Phone No. (include area code) (575) 623-6601	8. Lease Name and Well No. Longarm 13 Federal # 1
4. Location of Well (Report location clearly and in accordance with any State requirements *) At surface 660' FSL & 2310' FWL At proposed prod. zone Same		9. API Well No. 30 015 37450
14. Distance in miles and direction from nearest town or post office* 10 miles South & East of Loco Hills, N.M		10. Field and Pool, or Exploratory E. Shugart Delaware
15. Distance from proposed* location to nearest property or lease line, ft. (Also to nearest drig. unit line, if any) 660'	16. No. of acres in lease 120	11. Sec, T R M. or Blk and Survey or Area Sec 13, T18S, R31E
17. Spacing Unit dedicated to this well 40	18. Distance from proposed location* to nearest well, drilling, completed, applied for, on this lease, ft.	12. County or Parish Eddy
19. Proposed Depth 5700'	20. BLM/BIA Bond No. on file NMB000520	13. State NM
21. Elevations (Show whether DF, KDB, RT, GL, etc) 3732'	22. Approximate date work will start* 01/28/2010	23. Estimated duration 30 days

24. Attachments

The following, completed in accordance with the requirements of Onshore Oil and Gas Order No 1, must be attached to this form:

- | | |
|---|---|
| 1. Well plat certified by a registered surveyor. | 4. Bond to cover the operations unless covered by an existing bond on file (see Item 20 above). |
| 2. A Drilling Plan. | 5. Operator certification |
| 3. A Surface Use Plan (if the location is on National Forest System Lands, the SUPO must be filed with the appropriate Forest Service Office) | 6. Such other site specific information and/or plans as may be required by the BLM. |

25. Signature 	Name (Printed/Typed) Keith Cannon	Date 10/27/2009
Title Drilling Superintendent		

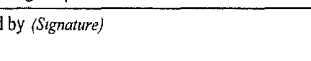
Approved by (Signature) 	Name (Printed/Typed) Is/ Don Peterson	Date DEC 14 2009
Title Is/ Don Peterson		Office CARLSBAD FIELD OFFICE

Application approval does not warrant or certify that the applicant holds legal or equitable title to those rights in the subject lease which would entitle the applicant to conduct operations thereon.
Conditions of approval, if any, are attached

APPROVAL FOR TWO YEARS

Title 18 U.S.C. Section 1001 and Title 43 U.S.C. Section 1212, make it a crime for any person knowingly and willfully to make to any department or agency of the United States any false, fictitious or fraudulent statements or representations as to any matter within its jurisdiction

(Continued on page 2)

*(Instructions on page 2)

Carlsbad Controlled Water Basin

SEE ATTACHED FOR
CONDITIONS OF APPROVALAPPROVAL SUBJECT TO
GENERAL REQUIREMENTS
AND SPECIAL STIPULATIONS
ATTACHED

DISTRICT I
1625 N. FRENCH DR., HOBBS, NM 88240

State of New Mexico
Energy, Minerals and Natural Resources Department

Form C-102
Revised October 12, 2005
Submit to Appropriate District Office
State Lease - 4 Copies
Fee Lease - 3 Copies

DISTRICT II
1301 W. GRAND AVENUE, ARTESIA, NM 88210

OIL CONSERVATION DIVISION
11885 SOUTH ST. FRANCIS DR.
Santa Fe, New Mexico 87505

DISTRICT III
1000 RIO BRAZOS RD., AZTEC, NM 87410

DISTRICT IV
11885 S. ST. FRANCIS DR., SANTA FE, NM 87505

WELL LOCATION AND ACREAGE DEDICATION PLAT

☐ AMENDED REPORT

API Number 30 015 37450	Pool Code 56439 56419	Pool Name E. Shugart Delaware
Property Code 37944	Property Name LONGARM 13 FEDERAL	Well Number 1
OGRID No. 258462	Operator Name NADEL AND GUSSMAN HEYCO, LLC	Elevation 3716'



Surface Location

UL or lot No.	Section	Township	Range	Lot Idn	Feet from the	North/South line	Feet from the	East/West line	County
N	13	18-S	31-E		660	SOUTH	2310	WEST	EDDY

Bottom Hole Location If Different From Surface

UL or lot No.	Section	Township	Range	Lot Idn	Feet from the	North/South line	Feet from the	East/West line	County
Dedicated Acres 40	Joint or Infill	Consolidation Code	Order No.						

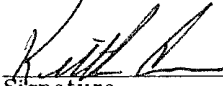
NO ALLOWABLE WILL BE ASSIGNED TO THIS COMPLETION UNTIL ALL INTERESTS HAVE BEEN CONSOLIDATED
OR A NON-STANDARD UNIT HAS BEEN APPROVED BY THE DIVISION

<p>GEODETIC COORDINATES NAD 27 NME Y=634038.7 N X=656731.3 E LAT.=32.742030° N LONG.=103.823595° W</p>				<p>OPERATOR CERTIFICATION <i>I hereby certify that the information herein is true and complete to the best of my knowledge and belief, and that this organization either owns a working interest or unleased mineral interest in the land including the proposed bottom hole location or has a right to drill this well at this location pursuant to a contract with an owner of such mineral or working interest, or to a voluntary pooling agreement or a compulsory pooling order heretofore entered by the division.</i>  10/27/09 Signature Date Keith Cannon Printed Name</p>
<p>NMNM-2538 3713.3' 3717.4' 600' 3714.2' 3720.3' 660'</p>				<p>SURVEYOR CERTIFICATION <i>I hereby certify that the well location shown on this plat was plotted from field notes of actual surveys made by me or under my supervision, and that the same is true and correct to the best of my belief.</i> OCTOBER 8, 2009 Date Surveyed: 10/21/09 Signature & Seal of Professional Surveyor  10-21-09 09110906 Certificate No. Gary G. Eidson 12641 Ronald J. Eidson 3239</p>

SECTION 13, TOWNSHIP 18 SOUTH, RANGE 31 EAST, N.M.P.M.,
EDDY COUNTY, NEW MEXICO

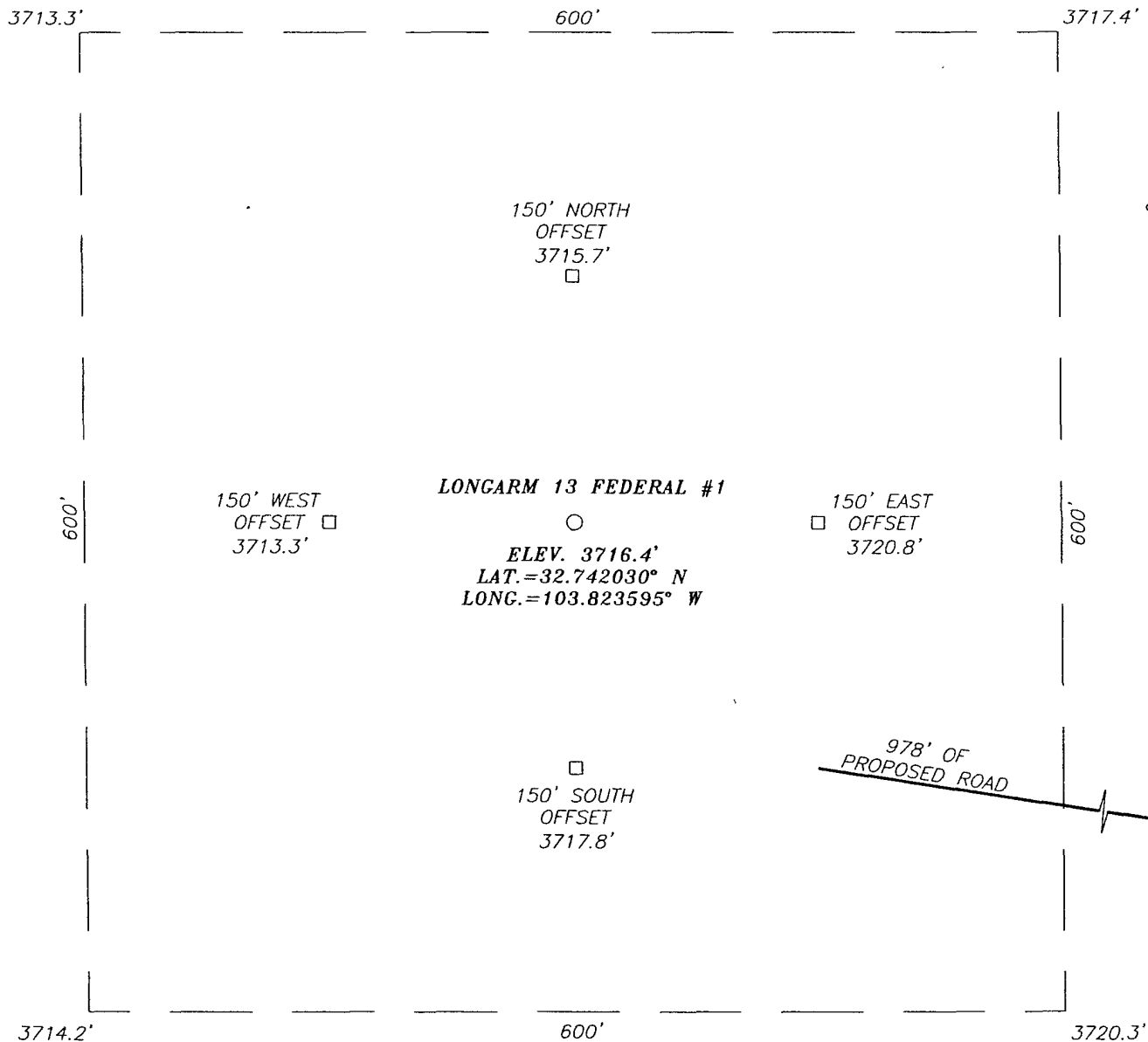

DIRECTIONS TO LOCATION

FROM THE INTERSECTION OF CO. RD. #222 (SHURGART RD) AND CO. RD. #249 (WESTALL) GO SOUTHEAST ON CO. RD. #249 APPROX. 4.0 MILES. TURN LEFT AND GO NORTHEAST APPROX. 0.6 MILES. VEER LEFT AND GO NORTH APPROX. 0.5 MILES. VEER RIGHT AND GO NORTHEAST-EAST APPROX. 0.6 MILES. TURN LEFT AND GO WEST APPROX. 0.2 MILES TO A PROPOSED ROAD SURVEY. FOLLOW ROAD SURVEY 978 FEET NORTHEAST TO THIS LOCATION.

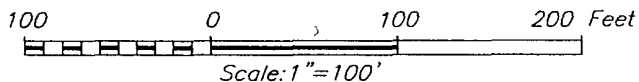

NADEL AND GUSSMAN HEYCO, LLC

LONGARM 13 FEDERAL #1 WELL
LOCATED 660 FEET FROM THE SOUTH LINE
AND 2310 FEET FROM THE WEST LINE OF SECTION 13,
TOWNSHIP 18 SOUTH, RANGE 31 EAST, N.M.P.M.,
EDDY COUNTY, NEW MEXICO.

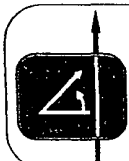

PROVIDING SURVEYING SERVICES
SINCE 1946
JOHN WEST SURVEYING COMPANY
412 N. DAL PASO
HOBBS, N.M. 88240
(575) 393-3117

Survey Date: 10/8/09	Sheet 1 of 1 Sheets
W.O. Number: 09.11.0906	Dr By: LA
Date: 10/13/09	09110906
Scale: 1"=100'	

LOCATION VERIFICATION MAP

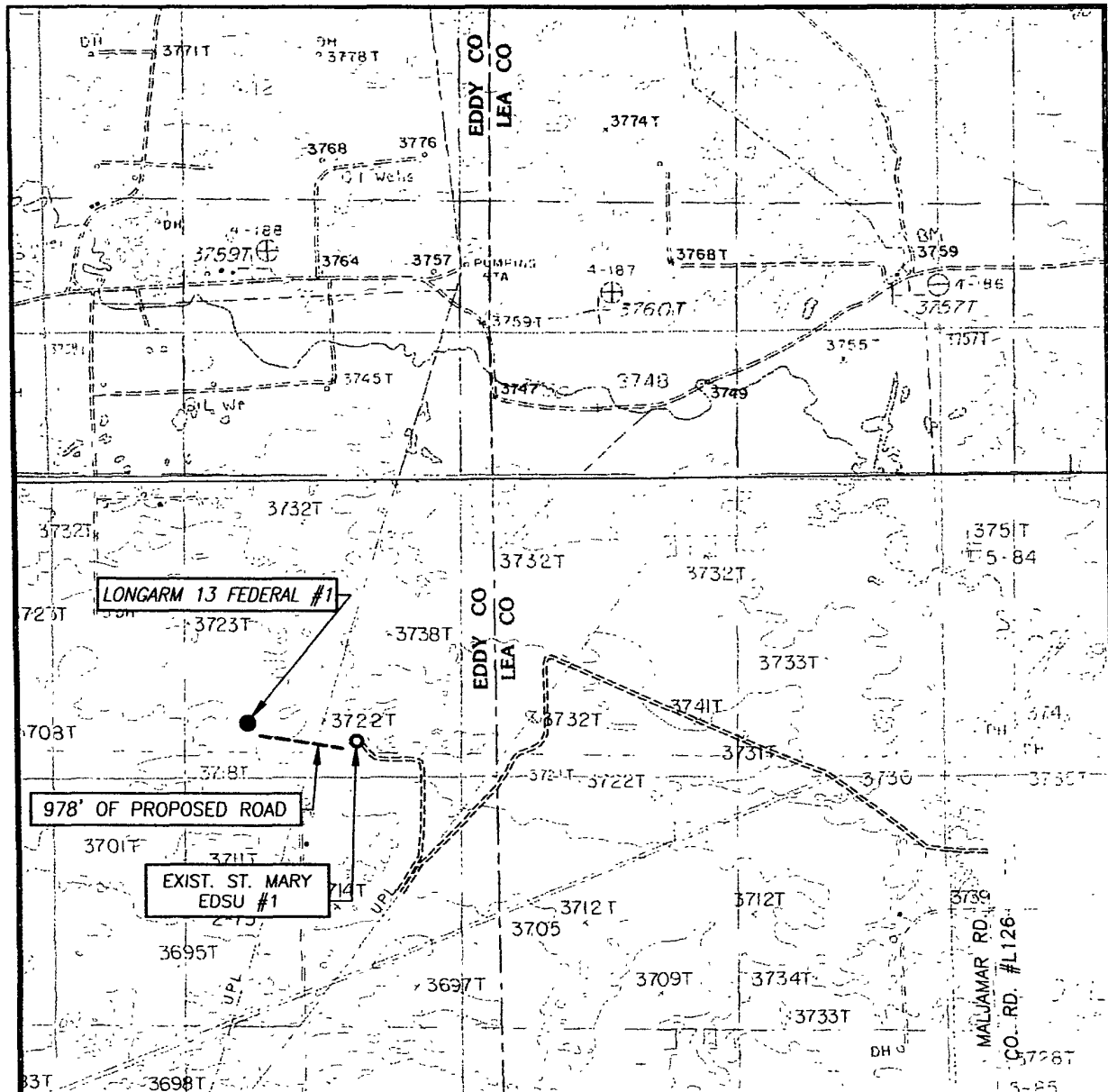

SCALE: 1" = 2000'

CONTOUR INTERVAL:
MALJAMAR, N.M. - 10'
GREENWOOD LAKE, N.M. - 10'

SEC. 13 TWP. 18-S. RGE. 31-E

SURVEY N.M.P.M.

COUNTY EDDY STATE NEW MEXICO

DESCRIPTION 660' FSL & 2310' FWL

ELEVATION 3716'

OPERATOR NADEL AND GUSSMAN HEYCO, LLC

LEASE LONGARM 13 FEDERAL

U.S.G.S. TOPOGRAPHIC MAP
GREENWOOD LAKE, N.M.

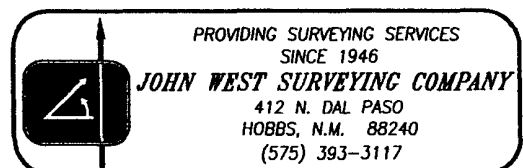

VICINITY MAP

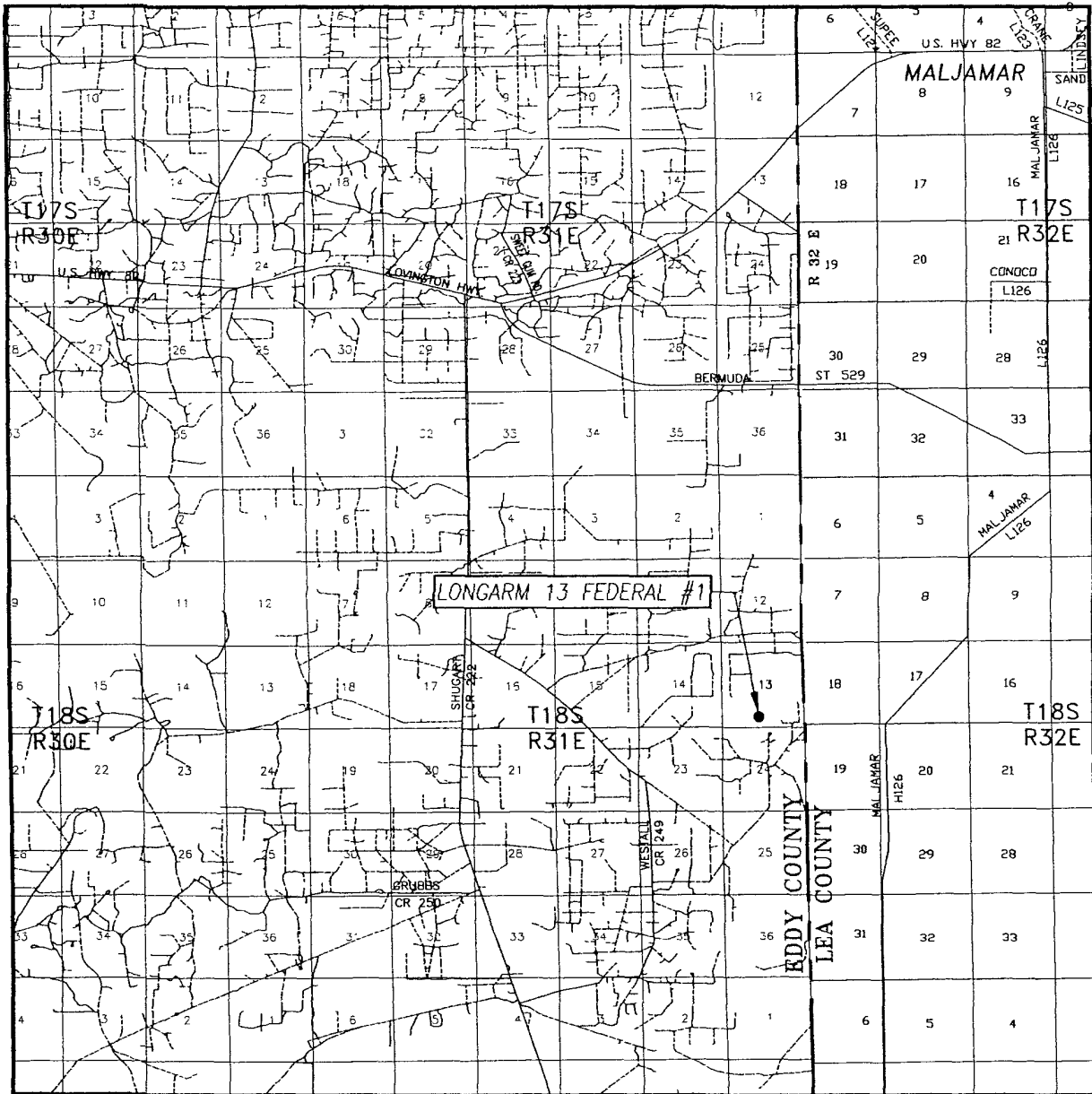

SCALE: 1" = 2 MILES

SEC. 13 TWP. 18-S RGE. 31-E
 SURVEY N.M.P.M.
 COUNTY EDDY STATE NEW MEXICO
 DESCRIPTION 660' FSL & 2310' FWL
 ELEVATION 3716'
 OPERATOR NADEL AND GUSSMAN HEYCO, LLC
 LEASE LONGARM 13 FEDERAL

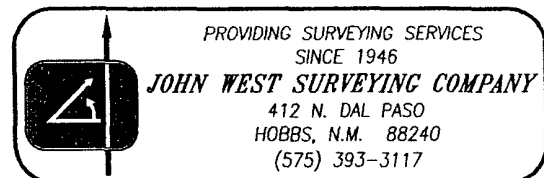

Application
Nadel and Gussman Heyco, LLC
Longarm 13 Federal #1
Sec 13, T18S, R31E
660' FSL' & 2310' FWL
Eddy County, New Mexico

In conjunction with Form 3160-3, Application For Permit To Drill Or Deepen subject well, Nadel and Gussman Heyco, LLC submits the following ten items of pertinent information in accordance with Onshore Oil & Gas Order No. 10.

1. Geologic Name of Surface Formation:
PERMIAN

2. Estimated Tops of Significant Geologic Markers:

<u>Formation</u>	<u>Depth</u>		
Rustler	845' Water	U. San Andres	4525' Oil
Salado	1020'	Cherry Canyon	4685' Oil
Yates	2375' Oil	L. San Andres	4770' Oil
Seven River	2850' Oil	Brushy Canyon	5020' Oil
Bowers	3285' Oil	PTD	5700'
Queen	3530' Oil		
Penrose	3770' Oil		
Grayburg	4115' Oil		
Loco Hills Sand	4255' Oil		
Metex	4405' Oil		
Premier Sand	4500' Oil		

3. Casing Program:

<u>Hole Size</u>	<u>Depth</u>	<u>OD Csg</u>	<u>Weight</u>	<u>Collar</u>	<u>Grade</u>	<u>New/Used</u>
11"	0' - 870'	8 5/8"	24#	ST&C	J-55	New
7 7/8"	0' - 5700'	5 1/2"	17#	ST&C	J-55	New

Safety factors: Burst 1.0 Collapse 1.125 Tension 1.8

4. Cement Program: (Note yields; and dv tool depths if multiple stages)

- a. 8 5/8" Surface Cement to surface with:
Tail - 354 sx C, 2% CaCl, 14.8 ppg, 1.34 cu.ft./sk yield, TOC @ 523' w/ 100% excess.
- b. 5 1/2" Production Cement to 695' with
See COA
Lead - 226 sx 50:50 Poz C, 5% Salt, 10% Bentonite, 0.2% Antifoamer, 11.9 ppg, 2.37 cu.ft./sk yield, TOC @ 670' w/ 30% excess.
Tail - 385 sx C, 1% Calcium Chloride, 14.8 ppg, 1.33 cu.ft./sk yield, TOC @ 3030' w/ 30% excess. *OK*

The above volumes, additives and depths may be revised based on open hole logs, conditions encountered while drilling and on cement field blend tests. The top of cement for the production string is designed to reach approximately 200' above the 8 5/8" casing shoe.

5. Proposed Mud Circulation System

<u>Depth</u>	<u>Mud Wt.</u>	<u>Visc</u>	<u>Fluid Loss</u>	<u>Type System</u>
0' - 870'	8.4 - 8.8	80 - 55	NC	Fresh Water
870' - 5700'	8.8 - 10.0	28 - 30	NC	Brine/Cut Brine Water

The necessary mud products for weight addition and fluid loss control will be on location at all times

No other formations are expected to yield oil, gas, or fresh water in measurable volumes. The surface fresh water sands will be protected by setting 8 5/8" casing at 870' and circulating Cement back to surface. All other intervals will be isolation by setting 5 1/2" casing to total depth and circulating cement 200' up into 8 5/8" casing.

6. Pressure Control Equipment:

The blowout preventor equipment (BOPE) shown in Exhibit #1 will consist of A (3m system) w/ double ram type 3000psi preventor for the 7 7/8" production hole, and a bag type (hydril) preventor (3000psi WP). This unit will be hydraulically operated and the ram type preventor will be equipped with blind rams on top, 4 1/2" drill pipe rams on bottom. The BOP's and Hydril will be tested as per BLM Drilling Operations Order #2. Pipe rams will be Operated and checked each 24hr period and each time drill pipe is out of the hole. These functional Test will be documented on the daily driller log. A flex hose will be use from BOP to choke manifold, (see specification attached), a 2" kill line and 3" choke line will be incorporated In the drilling spool below the ram-type BOP. Other accessory BOP equipment will include a Kelly Cock, floor safety valve, choke line and choke manifold having a 3000psi wp rating.

7. Auxiliary Equipment:

- a. A Kelly Cock will be in the drill string at all times.
- b. A full opening drill pipe stabbing valve having the appropriate Connections will be on the rig floor at all times.
- c. Hydrogen Sulfide detection equipment will be in operation after drilling Out the 8 5/8" casing shoe unit the 5 1/2" casing is cemented. Breathing Equipment will be on location upon drilling the 8 5/8" shoe unit total Depth is reached.
- d. A flex hose from the BOPE to the manifold (specification attached) *See COA*

8. Testing, Logging, & Coring Program: *See COA*

- a. Mud logging unit from 2200' to TD depth
10' samples will be caught by loggers
- b. Possible rotary sidewall cores
- e. Platform express (GR / LDT - CNL - PE / DLL - MCFL / NGT)

9. Abnormal Conditions, Pressures, Temperature, or Potential Hazards:

No abnormal conditions are expected. There is no known presence of H2S in this area. If H2S is encountered the operator will comply with the provisions of Onshore Oil and Gas Order No 6. Lost circulation might occur in the Capitan Reef. All personnel will be familiar with all aspects of safe operation of equipment being used to drill this well. Estimated BHP 2000 psi and estimated BHT 120 F. No H2S is anticipated to be encountered.

10. Anticipated Starting Date & Duration of Operation:

Road and location construction will begin after the BLM has approved the APD. Anticipated spud date will be as soon as possible after BLM approval and as soon as a rig will be available. Move in operations and drilling is expected to take 30 days. If production casing is run then an additional 15 days will be needed to complete well And construct surface facilities and/or lay flow line in order to place well on production.

LOCATION DIAGRAM

Longarm 13 Federal #1
660' FSL & 2310' FSL
SEC 13, T18S, R31E
Eddy Co, NM

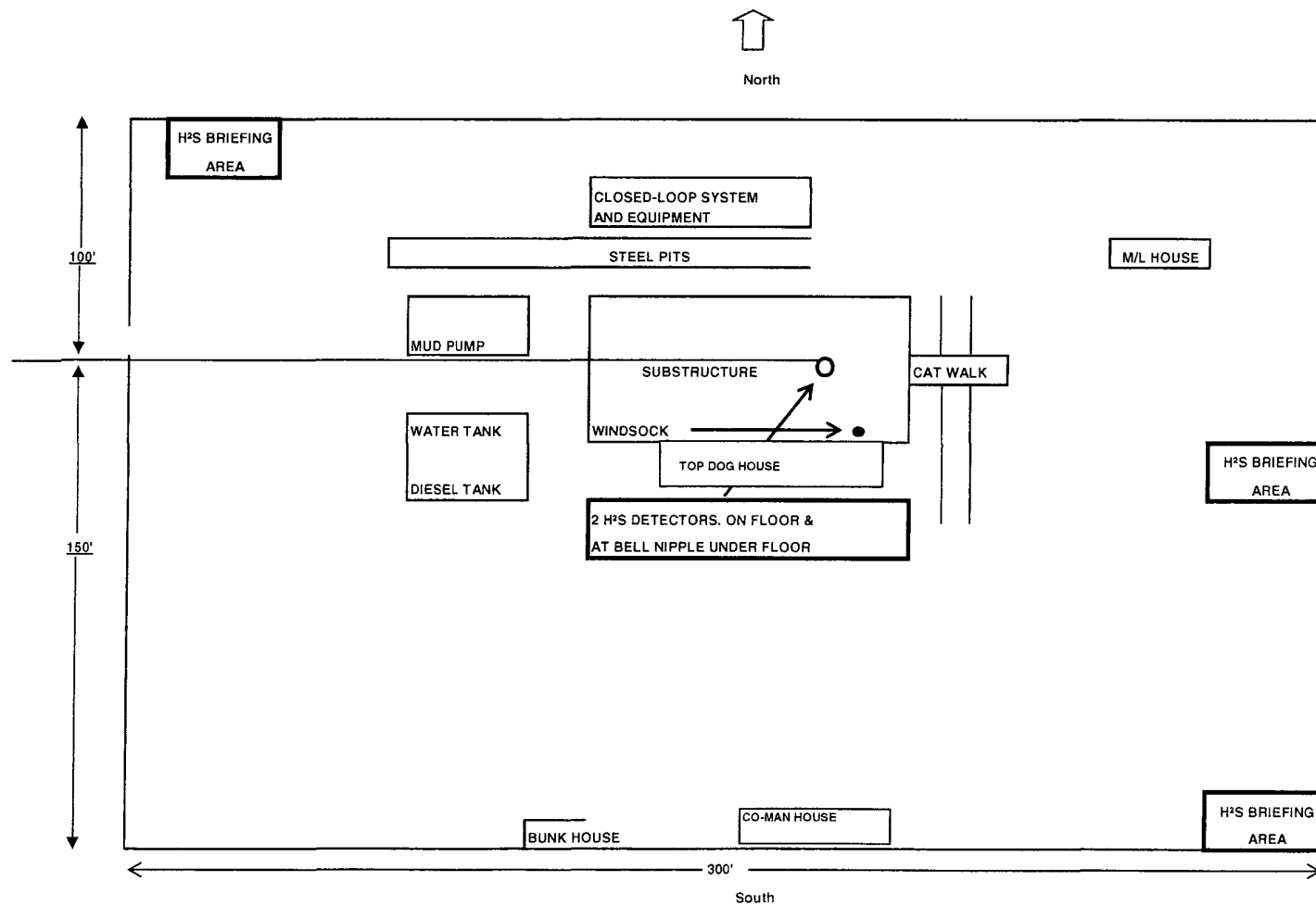

Nadel and Gussman Heyco, LLC

MINIMUM BLOWOUT PREVENTER REQUIREMENTS

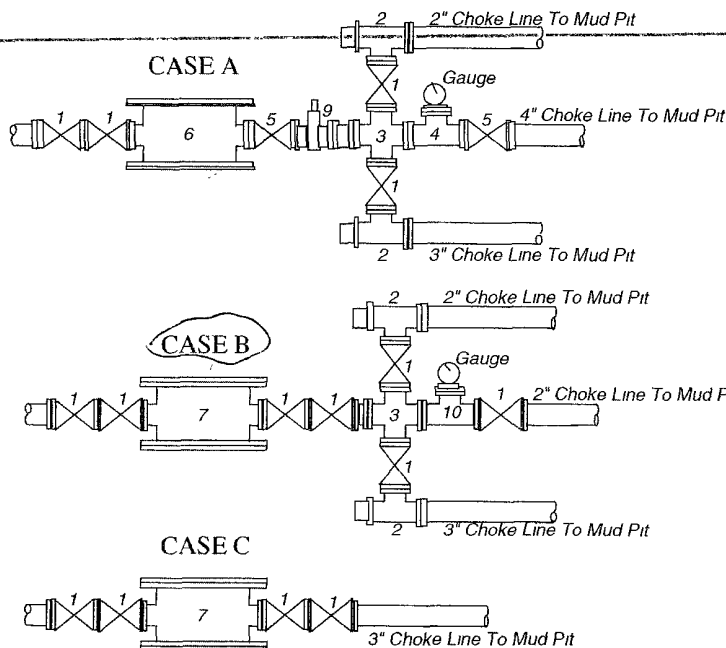
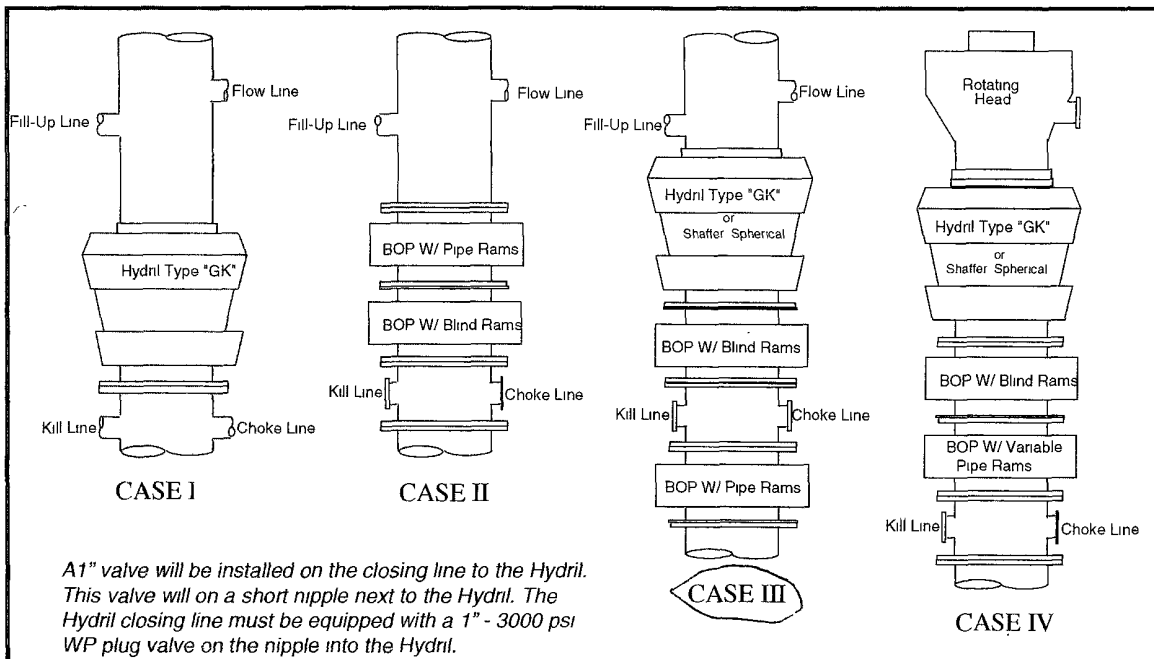

BOP SIZE	BOP CASE	WORKING PRESSURE	CHOKE CASE
13 - 5/8"	II	2000 psi	B
9"	III	3000 psi	B

***Rotating head required**

Bradenhead : _____

Mfr: _____

Size: _____ Type: _____

Legend

- 3" flanged all steel valve must be either Cameron "F", Halliburton Low Torque or Shaffer Flo-Seal.
- 3" flanged adjustable chokes, min. 1" full opening & equipped with hard trim.
- 4" x 2" flanged steel cross.
- 4" flanged steel tee
- 4" flanged all steel valve (Type as in no. 1)
- Drilling Spool with 2" x 4" flanged outlet.
- Drilling Spool with 2" x 2" flanged outlet.
- 2" x 2" flanged steel cross.
- pressure operated gate valve.
- 2" flanged steel tee.

Notes

Choke manifold may be located in any convenient position. Use all steel fittings throughout. Make 90° turns with bull plugged tees only. No field welding will be permitted on any of the components of the choke manifold and related equipment upstream of the chokes. The choke spool and all lines and fittings must be at least equivalent to the test pressure of the preventers required. Independent closing control unit with clearly marked controls to be located on derrick floor near driller's position.

(10-31-96) WTXBOPS.PPT

NADEL AND GUSSMAN HEYCO, L.L.C.
P.O. BOX 1936
ROSWELL N.M. 88202
(575) 623-6601 (Office)
(575) 624-5321 (Fax)

Re: Longarm 13 Federal #1
660' FSL & 2310' FWL
Unit N, Sec. 13, T18S, R31E
Eddy, NM
Rule 118 H2S Exposure

Dear Mr. Ingram

Nadel and Gussman Heyco, LLC have evaluated this well and we do not expect to encounter hydrogen sulfide. However, we will employ a third party monitoring system. We will begin monitoring prior to drilling out the intermediate casing and will continue monitoring the remainder of the well.

Please contact me if you have any additional questions.

Sincerely,

Keith Cannon
Drilling superintendent

Hydrogen Sulfide Drilling Operations Plan
Longarm 13 Federal #1
Sec 13, T18S, R31E
660' FSL & 2310' FWL
Eddy Co. N.M.

1. Company and contract personnel admitted on location should be trained by a qualified H₂S safety instructor to the recognize and handle following:
 - A. Characteristics of H₂S gas
 - B. Physical effects and hazards
 - C. Proper use of safety equipment and life support systems
 - D. Principle and operation of H₂S detectors, warning system and briefing knowledge
 - E. Evacuation procedure, routes and first aid support
 - F. Proper use of 30 minutes Pressure-on-Demand Air Pack
2. H₂S Detection and Alarm Systems
 - A. H₂S detectors and audio alarm system to be located at bell nipple, end of blooie line (mud pit) and on derrick floor or doghouse
3. Windsock and/or Wind Streamers
 - A. Windsock at mud pit area (high enough to be visible)
 - B. Windsock at briefing area (high enough to be visible)
 - C. Windsock at location entrance
4. Condition Flags and Signs
 - A. H₂S warning signs on lease access road into location
 - B. Flags displayed on sign at location entrance
 1. Green flag indicates "Normal Safe Conditions"
 2. Yellow Flag indicates "Potential Pressure and Danger"
 3. Red Flag indicates "Danger - H₂S Present in High Concentrations" *admit only emergency personnel*
5. Well Control Equipment
 - A. See Exhibit #5.
6. Communication
 - A. While working under masks chalkboards will be used for communication
 - B. Hand signals will be used where chalk board is inappropriate
 - C. Two -way radios or cell phones used to communicate off location or minimally in Drilling Foreman's trailer or living quarters
7. Drillstem Testing
 - A. Exhausts watered
 - B. Flare line equipped with electric Igniter/propane pilot light in case gas reaches surface
 - C. If location near dwelling closed DST will be performed
8. Drilling Supervisor required to be familiar with effects of H₂S on tubular goods/mechanical equipment
9. If H₂S encountered, mud system shall be addressed to maintain control of formation. A mud gas separator will be brought into service along with H₂S scavengers, if necessary.

PUBLIC PROTECTION PLAN FOR EMERGENCY CONTACTS

NADEL AND GUSSMAN HEYCO, LLC
Company Personnel

(575) 623-6601

Terry West	Drilling Enrineer	432-682-4429	
		432-238-2874	
Keith Canonon	Drilling Supt.	575-623-6601	
		575-626-1936	
ARTESIA N.M.			
Ambulance		911	
State Police		575-746-5000	
City Police		575-746-5000	
Sheriff's Office		575-746-9888	
Fire Department		575-746-5050 or 575-746-5051	
N.M.O.C.D		575-748-1283	
CARLSBAD N.M.			
Ambulance		911	
State Police		575-885-3137	
City Police		575-885-2111	
Sheriff's Office		575-887-7551	
Fire Department		575-885-3125 or 575-885-2111	
Carlsbad BLM		575-887-6544	
HOBBS N.M.			
Ambulance		911	
State Police		575-392-5588	
City Police		575-397-9265	
Sheriff's Office		575-396-3611	
Fire Department		575-397-9308	
N.M.O.C.D		575-393-6161	
Hobbs BLM		575-393-3612	
ROSWELL N.M.			
Ambulance		911	
State Police		575-622-7200	
City Police		575-624-6770	
Sheriff's Office		575-624-6500	
Fire Department		575-624-6800	
Roswell BLM		575-627-0272	
Flight for Life (Lubbock Tx)			
		806-743-9911	
Aerocare (Lubbock Tx)		806-747-8923	
Med flight air Ambulance (Albuq NM)		505-842-4433	
SB air Med Services (Albuq NM)		505-842-4949	
Boots & Coots IWC			
		800-256-9688 or 281-931-8884	
Cudd Pressure Control		915-699-0139 or 915-563-3356	
BJ Services	(Artesia NM)	575-746-3569	
	(Hobbs NM)	575-392-5556	
New Mexico Emergency Response Commission (Santa Fe)		505-476-9600	
24 Hour		505-827-9126	
New Mexico State Emergency Operations Center		505-476-9635	

Surface Use Plan
Nadel and Gussman Heyco. LLc
Longarm 13 Federal # 1
Section 13, T18S, R31E
660' FSL & 2310' FWL
Eddy County, New Mexico

1. Existing Roads:

Exhibit A is a portion of a New Mexico map showing the location of the proposed location. The location is approximately 10 miles South East of Loco Hills, NM.
From the intersection of US 82 and Co road #222 Go 4.0 miles and turn onto Co Rd 249 (Westall) Go SE approx 4.0 miles. Turn left and go NE approx 0.6 miles.
Veer left and go north approx 0.5 miles. Veer right and go NE-E approx 0.6 miles. Turn left and go west 0.5 miles to location.

2. Planned Access Roads:

0.2 miles' of new road will be built to access this location come in from the west.

3. Location of Existing Wells:

See EXHIBIT B From the surveying company / vicinity map

4. Location of Tank Batteries, Electric Lines, Etc:

a. In the event the well is found productive, the tank battery would be utilized and the necessary production equipment

5. Location and Type of Water Supply:

This location will be drilled using a combination of water mud systems (out line in the drilling program). Water will be obtained from commercial water stations in the area and hauled in by transport truck using the existing and proposed roads shown in the C-102.

6. Source of Construction Material:

All caliche utilized for the drilling pad and proposed access road will be obtained from an existing BLM / State approved pit
Or from prevailing deposits found under the location. All roads will be constructed of 6" rolled and compacted caliche.

7. Methods of Handling Waste Disposal:

- a. All trash, junk, and other waste material will be contained in trash cages or trash bin to prevent scattering. When the job is completed, all contents will be removed and disposed of in an approved sanitary landfill. The wellsite will be cleaned of all waste within 30 days of final completion of the well.
- b. A porto-john will be provided for the rig crews. This equipment will be properly maintained during the drilling operations and will be removed when all operations are complete.
- c. Disposal of fluids to be transported by trucks to a nearby approved disposal.

8. Ancillary Facilities:

N/A

9. Wellsite Layout:

- a. EXHIBIT D shows the relative location and dimensions of the well pad, reserve pits, and major rig components.
- b. The land is relatively flat with sandy soil
- c. The pad and pit area have been staked.

10. Plan for Restoration of the Surface:

a. After drilling and completion operations are completed, all equipment and other materials not needed for further operations will be removed. The location cleaned of all trash to leave the wellsite as pleasant in appearance as possible.

b. If the proposed operation is nonproductive, all restoration and/or vegetation requirements of the BLM will be complied with, and will be accomplished as quickly as possible. All pits will be filled and leveled within 90 days after abandonment.

c. Interim reclamation consists of minimizing the footprint of disturbance by reclaiming all portions of the well site not needed for production operations. Topsoil is respread over areas not needed for production operations and recontoured to the surrounding area and reseeded

11. Other Information:

a. The mineral and surface owner is the Federal Government, Land and Grazing leasing Caviness Cattle co. has been contacted

b. The topography consists of sandy soil with native grasses. No wildlife was observed, but the usual inhabitants of this region are Jackrabbits, Reptiles, Coyotes, etc.

c. There are no ponds, lakes, or rivers in this area.

d. An Archaeological Survey has been made and a copy has been sent to the Carlsbad BLM office. There is no evidence of any significant archaeological, historical, or cultural sites in the area. Further, there are no occupied dwellings or windmills in the area.

e. Should any incidental oil be recovered during testing of this well, this oil will be considered waste oil and not sellable due to contamination by drilling and/or completion fluids.

12. Operator's Representative:

The Nadel and Gussman HEYCO, LLC Company representatives responsible for ensuring compliance of the surface

Use plan are listed below.

Keith Cannon, Drilling Superintendent
Nadel and Gussman Heyco, LLC
P.O. Box 1936
Roswell, NM 88202
(575) 623-6601

Terry West, Drilling Engineer
Nadel and Gussman Permian
601 N. Marienfeld Suite 508
Midland, Tx 79701
(432) 682-4429

October 27, 2009

United States Department of the Interior

BUREAU OF LAND MANAGEMENT
Roswell Resource Area
P.O. Drawer 1857
Roswell, New Mexico 88202-1857

Statement Accepting Responsibilities for Operations

Operator Name: Nadel and Gussman Heyco, LLC
Street or Box: P.O. Box 1936
City, State: Roswell, New Mexico
Zip Code: 88202

The undersigned accepts all applicable terms, conditions, stipulations, and restrictions concerning operations conducted on the leased land or portion thereof, as described below.

Lease No.: NMNM - 2538

Lease Name: Longarm 13 Federal #1
Legal description of land: UL- N, Sec 13, T18S, R31E, Eddy County, New Mexico

Formation(s) (if applicable): Delaware (Cherry Canyon), Loco Hills, Penrose, Queen

Bond Coverage: Statewide Bond

BLM Bond File No.: NM B 000520

Authorized Signature: 

Title: Drilling Superintendent

Date: 10/27/2009

OPERATOR CERTIFICATION

I certify that I, or someone under my direct supervision, have inspected the drill site and access route proposed herein; that I am familiar with the conditions that presently exist; that I have full knowledge of State and Federal Laws applicable to this operation; that the statements made in this APD package are, to the best of my knowledge, true, and correct; and that the work associated with the operations proposed herein will be performed in conformity with this APD package and the terms and conditions under which it is approved. I also certify that I, or the company I represent, am responsible for the operations conducted under this application. These statements are subject to the provisions of 18 U.S.C. 1001 for the filing of false statements. Executed this 27 day of October 2009.

Name: Keith Cannon

Position: Drilling Superintendent

Address: P.O. Box 1936, Roswell, NM 88202

Telephone: 575-623-6601

Email: kcannon@heycoenergy.com

Signed: _____

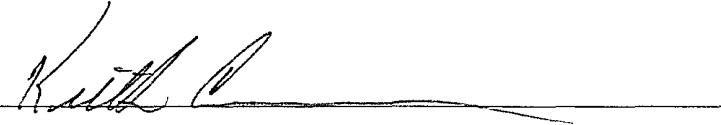
A handwritten signature in black ink, appearing to read "Keith Cannon", is written over a horizontal line.

PECOS DISTRICT CONDITIONS OF APPROVAL

OPERATOR'S NAME:	NADEL & GUSSMAN HEYCO, LLC
LEASE NO.:	NMNM-2538
WELL NAME & NO.:	LONGARM 13 FEDERAL # 1
SURFACE HOLE FOOTAGE:	660' FSL & 2310' FWL
BOTTOM HOLE FOOTAGE:	Same
LOCATION:	Section 13, T. 18 S., R 31E., NMPM
COUNTY:	Eddy County, New Mexico

TABLE OF CONTENTS

Standard Conditions of Approval (COA) apply to this APD. If any deviations to these standards exist or special COAs are required, the section with the deviation or requirement will be checked below.

- ☐ **General Provisions**
- ☐ **Permit Expiration**
- ☐ **Archaeology, Paleontology, and Historical Sites**
- ☐ **Noxious Weeds**
- ☒ **Special Requirements**
 - Lesser Prairie Chicken
 - Ground-level Abandoned Well Marker to avoid raptor perching
- ☒ **Construction**
 - Notification
 - Topsoil
 - Closed Loop System
 - Federal Mineral Material Pits
 - Well Pads
 - Roads
- ☐ **Road Section Diagram**
- ☒ **Drilling**
 - H2S – Onshore Order 6 requirements
 - Logging requirements
- ☐ **Production (Post Drilling)**
 - Well Structures & Facilities
 - Pipelines
 - Electric Lines
- ☒ **Reseeding Procedure/Interim Reclamation**
- ☐ **Final Abandonment/Reclamation**

I. GENERAL PROVISIONS

The approval of the Application For Permit To Drill (APD) is in compliance with all applicable laws and regulations: 43 Code of Federal Regulations 3160; the lease terms, Onshore Oil and Gas Orders, Notices To Lessees, New Mexico Oil Conservation Division (NMOCD) Rules, National Historical Preservation Act As Amended, and instructions and orders of the Authorized Officer. Any request for a variance shall be submitted to the Authorized Officer on Form 3160-5, Sundry Notices and Report on Wells.

II. PERMIT EXPIRATION

If the permit terminates prior to drilling and drilling cannot be commenced within 60 days after expiration, an operator is required to submit Form 3160-5, Sundry Notices and Reports on Wells, requesting surface reclamation requirements for any surface disturbance. However, if the operator will be able to initiate drilling within 60 days after the expiration of the permit, the operator must have set the conductor pipe in order to allow for an extension of 60 days beyond the expiration date of the APD. (Filing of a Sundry Notice is required for this 60 day extension.)

III. ARCHAEOLOGICAL, PALEONTOLOGY & HISTORICAL SITES

Any cultural and/or paleontological resource discovered by the operator or by any person working on the operator's behalf shall immediately report such findings to the Authorized Officer. The operator is fully accountable for the actions of their contractors and subcontractors. The operator shall suspend all operations in the immediate area of such discovery until written authorization to proceed is issued by the Authorized Officer. An evaluation of the discovery shall be made by the Authorized Officer to determine the appropriate actions that shall be required to prevent the loss of significant cultural or scientific values of the discovery. The operator shall be held responsible for the cost of the proper mitigation measures that the Authorized Officer assesses after consultation with the operator on the evaluation and decisions of the discovery. Any unauthorized collection or disturbance of cultural or paleontological resources may result in a shutdown order by the Authorized Officer.

IV. NOXIOUS WEEDS

The operator shall be held responsible if noxious weeds become established within the areas of operations. Weed control shall be required on the disturbed land where noxious weeds exist, which includes the roads, pads, associated pipeline corridor, and adjacent land affected by the establishment of weeds due to this action. The operator shall consult with the Authorized Officer for acceptable weed control methods, which include following EPA and BLM requirements and policies.

V. SPECIAL REQUIREMENT(S)

Timing Limitation Stipulation/Condition of Approval for Lesser Prairie-Chicken:

Oil and gas activities including 3-D geophysical exploration, and drilling will not be allowed in lesser prairie-chicken habitat during the period from March 1st through June 15th annually. During that period, other activities that produce noise or involve human activity, such as the maintenance of oil and gas facilities, geophysical exploration other than 3-D operations; and pipeline, road, and well pad construction, will be allowed except between 3:00 am and 9:00 am. The 3:00 am to 9:00 am restriction will not apply to normal, around-the-clock operations; such as venting, flaring, or pumping, which do not require a human presence during this period. Additionally, no new drilling will be allowed within up to 200 meters of leks known at the time of permitting. Normal vehicle use on existing roads will not be restricted. Exhaust noise from pump jack engines must be muffled or otherwise controlled so as not to exceed 75 db measured at 30 ft. from the source of the noise.

Ground-level Abandoned Well Marker to avoid raptor perching: Upon the plugging and subsequent abandonment of the well, the well marker will be installed at ground level on a plate containing the pertinent information for the plugged well. For more installation details, contact the Carlsbad Field Office at 575-234-5972.

VI. CONSTRUCTION

A. NOTIFICATION

The BLM shall administer compliance and monitor construction of the access road and well pad. Notify the Carlsbad Field Office at (575) 234-5972 at least 3 working days prior to commencing construction of the access road and/or well pad.

When construction operations are being conducted on this well, the operator shall have the approved APD and Conditions of Approval (COA) on the well site and they shall be made available upon request by the Authorized Officer.

B. TOPSOIL

The operator shall stockpile the topsoil of the well pad. The topsoil to be stripped is approximately 6 inches in depth. The topsoil shall not be used to backfill the reserve pit and will be used for interim and final reclamation.

C. CLOSED LOOP SYSTEM

Although this is a closed loop system and no reserve pit or pits will be utilized, the v-door will be on the East side of the location.

Tanks are required for drilling operations: No Pits.

The operator shall properly dispose of drilling contents at an authorized disposal site.

D. FEDERAL MINERAL MATERIALS PIT

If the operator elects to surface the access road and/or well pad, mineral materials extracted during construction of the reserve pit may be used for surfacing the well pad and access road and other facilities on the lease.

Payment shall be made to the BLM prior to removal of any additional federal mineral materials from any site other than the reserve pit. Call the Carlsbad Field Office at (575) 234-5972.

E. WELL PAD SURFACING

Surfacing of the well pad is not required.

If the operator elects to surface the well pad, the surfacing material may be required to be removed at the time of reclamation.

The well pad shall be constructed in a manner which creates the smallest possible surface disturbance, consistent with safety and operational needs.

F. ON LEASE ACCESS ROADS

Road Width

The access road shall have a driving surface that creates the smallest possible surface disturbance and does not exceed fourteen (14) feet in width. The maximum width of surface disturbance, when constructing the access road, shall not exceed thirty (30) feet.

Surfacing

Surfacing material is not required on the new access road driving surface. If the operator elects to surface the new access road or pad, the surfacing material may be required to be removed at the time of reclamation.

Where possible, no improvements should be made on the unsurfaced access road other than to remove vegetation as necessary, road irregularities, safety issues, or to fill low areas that may sustain standing water.

The Authorized Officer reserves the right to require surfacing of any portion of the access road at any time deemed necessary. Surfacing may be required in the event the road deteriorates, erodes, road traffic increases, or it is determined to be beneficial for future field development. The surfacing depth and type of material will be determined at the time of notification.

Crowning

Crowning shall be done on the access road driving surface. The road crown shall have a grade of approximately 2% (i.e., a 1" crown on a 14' wide road). The road shall conform to Figure 1; cross section and plans for typical road construction.

Ditching

Ditching shall be required on both sides of the road.

Turnouts

Vehicle turnouts shall be constructed on the road. Turnouts shall be intervisible with interval spacing distance less than 1000 feet. Turnouts shall be constructed on all blind curves. Turnouts shall conform to the following diagram:

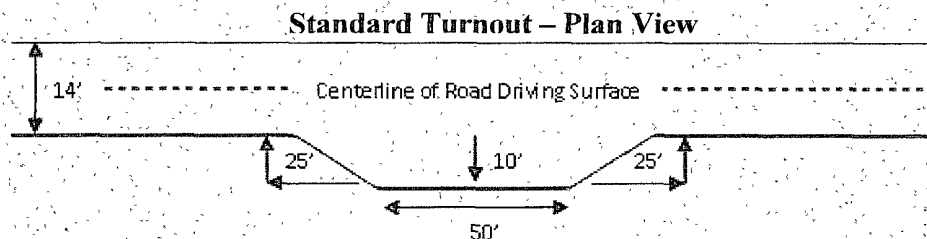

Drainage

Drainage control systems shall be constructed on the entire length of road (e.g. ditches, sidehill outsloping and insloping, lead-off ditches, culvert installation, and low water crossings).

A typical lead-off ditch has a minimum depth of 1 foot below and a berm of 6 inches above natural ground level. The berm shall be on the down-slope side of the lead-off ditch.

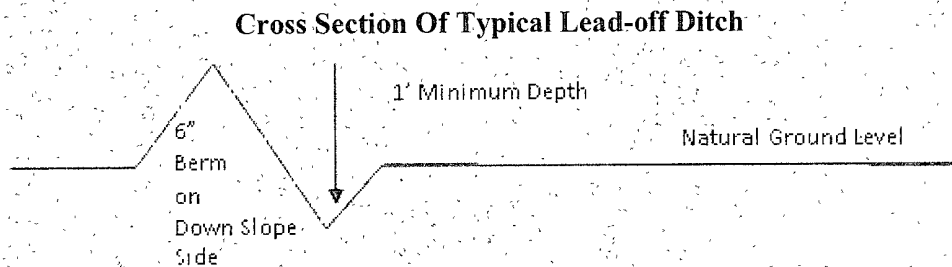

All lead-off ditches shall be graded to drain water with a 1 percent minimum to 3 percent maximum ditch slope. The spacing interval are variable for lead-off ditches and shall be determined according to the formula for spacing intervals of lead-off ditches, but may be amended depending upon existing soil types and centerline road slope (in %);

Formula for Spacing Interval of Lead-off Ditches

Example - On a 4% road slope that is 400 feet long, the water flow shall drain water into a lead-off ditch. Spacing interval shall be determined by the following formula:

$$400 \text{ foot road with } 4\% \text{ road slope: } 400' / 4\% + 100' = 200' \text{ lead-off ditch interval}$$

Culvert Installations

Appropriately sized culvert(s) shall be installed at the deep waterway channel flow crossing.

Cattleguards

An appropriately sized cattleguard(s) sufficient to carry out the project shall be installed and maintained at fence crossing(s).

Any existing cattleguard(s) on the access road shall be repaired or replaced if they are damaged or have deteriorated beyond practical use. The operator shall be responsible for the condition of the existing cattleguard(s) that are in place and are utilized during lease operations.

A gate shall be constructed and fastened securely to H-braces.

Fence Requirement

Where entry is required across a fence line, the fence shall be braced and tied off on both sides of the passageway prior to cutting.

The operator shall notify the private surface landowner or the grazing allotment holder prior to crossing any fence(s).

Public Access

Public access on this road shall not be restricted by the operator without specific written approval granted by the Authorized Officer.

Figure 1 – Cross Sections and Plans For Typical Road Sections

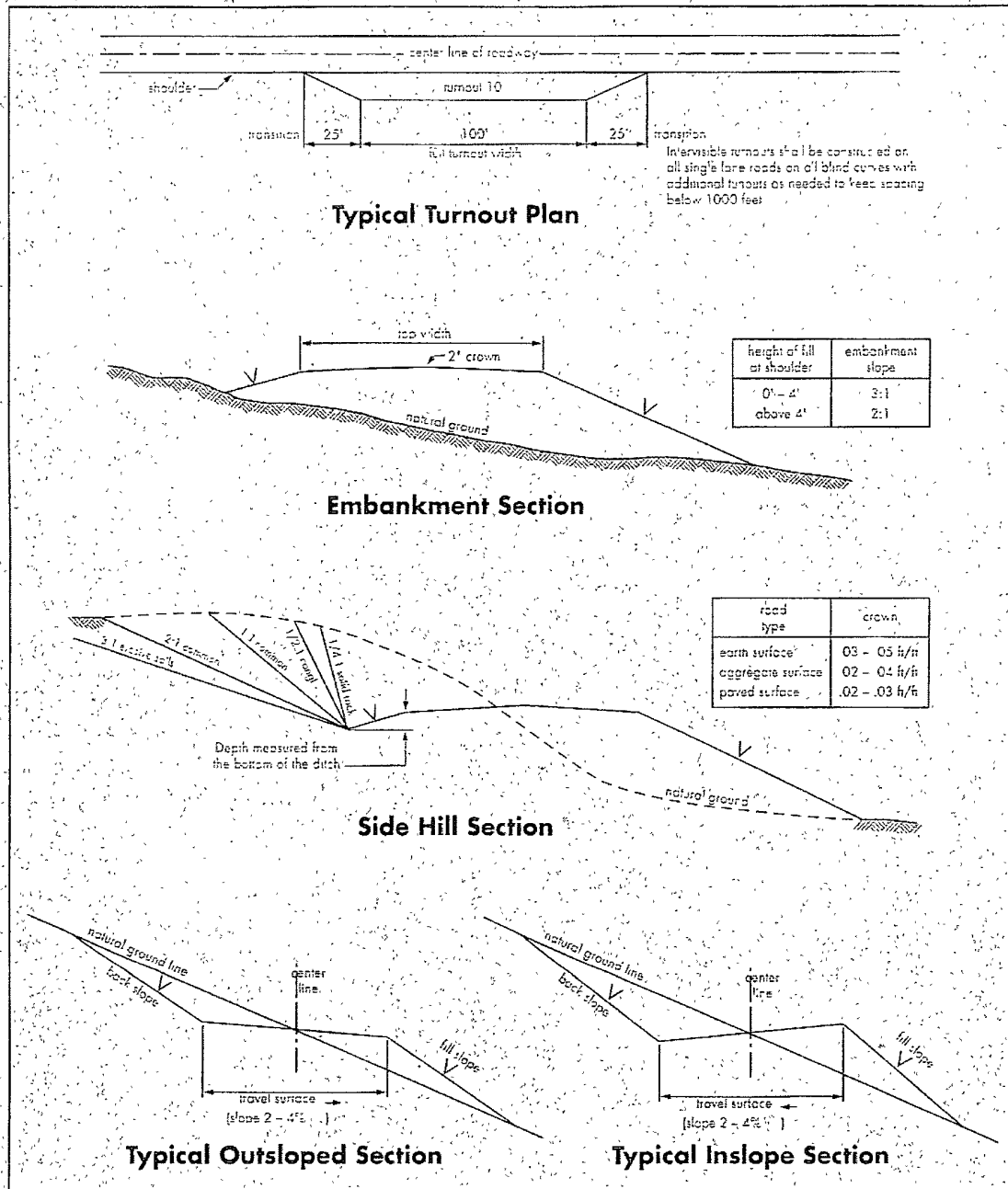

VII. DRILLING

A. DRILLING OPERATIONS REQUIREMENTS

The BLM is to be notified a minimum of 4 hours in advance for a representative to witness:

- a. Spudding well
- b. Setting and/or Cementing of all casing strings
- c. BOPE tests

☒ **Eddy County**

Call the Carlsbad Field Office, 620 East Greene St., Carlsbad, NM 88220,
(575) 361-2822

1. A Hydrogen Sulfide (H₂S) Drilling Plan should be activated 500 feet prior to drilling into the Queen formation. **As a result, the Hydrogen Sulfide area must meet Onshore Order 6 requirements, which includes equipment and personnel/public protection items. If Hydrogen Sulfide is encountered, please provide measured values and formations to the BLM.**
2. Unless the production casing has been run and cemented or the well has been properly plugged, the drilling rig shall not be removed from over the hole without prior approval.
3. Floor controls are required for 3M or Greater systems. These controls will be on the rig floor, unobstructed, readily accessible to the driller and will be operational at all times during drilling and/or completion activities. Rig floor is defined as the area immediately around the rotary table; the area immediately above the substructure on which the draw works is located; this does not include the dog house or stairway area.
4. The record of the drilling rate along with the CAL/GR/N well log run from TD to surface will be submitted to the BLM office as well as all other logs run on the borehole 30 days from completion. If available, a digital copy of the logs is to be submitted in addition to the paper copies. The Rustler top and top and bottom of Salt are to be recorded on the Completion Report.

B. CASING

Changes to the approved APD casing and cement program require submitting a sundry and receiving approval prior to work. Failure to obtain approval prior to work will result in an Incident of Non-Compliance being issued.

Centralizers required on surface casing per Onshore Order 2.III.B.1.f.

Wait on cement (WOC) time for a primary cement job will be a minimum 18 hours for a water basin, 24 hours in the potash area, or 500 pounds compressive strength, whichever is greater for all casing strings. Provide compressive strengths including hours to reach required 500 pounds compressive strength prior to cementing each casing string. See individual casing strings for details regarding lead cement slurry requirements.

No pea gravel permitted for remedial or fall back remedial without prior authorization from the BLM engineer.

**Possible brine and water flows in the Salado Group and the Grayburg Formation.
Possible lost circulation in the Grayburg and San Andres Formations.**

1. The 8-5/8 inch surface casing shall be set at **approximately 870 feet (a minimum of 25 feet into the Rustler Anhydrite and above the salt)** and cemented to the surface.
 - a. If cement does not circulate to the surface, the appropriate BLM office shall be notified and a temperature survey utilizing an electronic type temperature survey with surface log readout will be used or a cement bond log shall be run to verify the top of the cement.
 - b. **Wait on cement (WOC) time for a primary cement job is to include the lead cement slurry.**
 - c. Wait on cement (WOC) time for a remedial job will be a minimum of 4 hours after bringing cement to surface or 500 pounds compressive strength, whichever is greater.
 - d. If cement falls back, remedial cementing will be done prior to drilling out that string.
2. The minimum required fill of cement behind the 5-1/2 inch production casing is:
 - ☒ Cement to surface. If cement does not circulate, contact the appropriate BLM office. **Additional cement may be required as the excess calculated to be 4%.**
3. If hardband drill pipe is rotated inside casing, returns will be monitored for metal. If metal is found in samples, drill pipe will be pulled and rubber protectors which have a larger diameter than the tool joints of the drill pipe will be installed prior to continuing drilling operations.

C. PRESSURE CONTROL

1. All blowout preventer (BOP) and related equipment (BOPE) shall comply with well control requirements as described in Onshore Oil and Gas Order No. 2 and API RP 53 Sec. 17.
2. **Variance approved to use flex line from BOP to choke manifold. Check condition of 3" flexible line from BOP to choke manifold, replace if exterior is damaged or if line fails test. Line to be as straight as possible with no hard bends.**
3. Minimum working pressure of the blowout preventer (BOP) and related equipment (BOPE) required for drilling below the surface casing shoe shall be **3000 (3M) psi**.
4. The appropriate BLM office shall be notified a minimum of 4 hours in advance for a representative to witness the tests.
 - a. The tests shall be done by an independent service company.
 - b. The results of the test shall be reported to the appropriate BLM office.
 - c. All tests are required to be recorded on a calibrated test chart. **A copy of the BOP/BOPE test chart and a copy of independent service company test will be submitted to the appropriate BLM office.**
 - d. The BOP/BOPE test shall include a low pressure test from 250 to 300 psi. The test will be held for a minimum of 10 minutes if test is done with a test plug and 30 minutes without a test plug.

D. DRILL STEM TEST

If drill stem tests are performed, Onshore Order 2.III.D shall be followed.

CRW 111209

VIII. PRODUCTION (POST DRILLING)

A. WELL STRUCTURES & FACILITIES

Placement of Production Facilities

Production facilities should be placed on the well pad to allow for maximum interim recontouring and revegetation of the well location.

Containment Structures

The containment structure shall be constructed to hold the capacity of the entire contents of the largest tank, plus 24 hour production, unless more stringent protective requirements are deemed necessary by the Authorized Officer.

Painting Requirement

All above-ground structures including meter housing that are not subject to safety requirements shall be painted a flat non-reflective paint color
Shale Green, Munsell Soil Color Chart # 5Y 4/2

IX. INTERIM RECLAMATION & RESEEDING PROCEDURE

A. INTERIM RECLAMATION

If the well is a producer, interim reclamation shall be conducted on the well site in accordance with the orders of the Authorized Officer. The operator shall submit a Sundry Notices and Reports on Wells (Notice of Intent), Form 3160-5, prior to conducting interim reclamation.

During the life of the development, all disturbed areas not needed for active support of production operations should undergo interim reclamation in order to minimize the environmental impacts of development on other resources and uses.

Operators should work with BLM surface management specialists to devise the best strategies to reduce the size of the location. Any reductions should allow for remedial well operations, as well as safe and efficient removal of oil and gas.

During reclamation, the removal of caliche is important to increasing the success of revegetating the site. Removed caliche may be used for road repairs, fire walls or for building other roads and locations. In order to operate the well or complete workover operations, it may be necessary to drive, park and operate on restored interim vegetation within the previously disturbed area. Disturbing revegetated areas for production or workover operations will be allowed. If there is significant disturbance and loss of vegetation, the area will need to be revegetated. Communicate with the appropriate BLM office for any exceptions/exemptions if needed.

B. RESEEDING PROCEDURE

Once the well has been drilled, all completion procedures have been accomplished, and all trash removed, reseed the location and all surrounding disturbed areas as follows:

Seed Mixture for LPC Sand/Shinnery Sites

The holder shall seed all disturbed areas with the seed mixture listed below. The seed mixture shall be planted in the amounts specified in pounds of pure live seed (PLS)* per acre. There shall be no primary or secondary noxious weeds in the seed mixture. Seed will be tested and the viability testing of seed will be done in accordance with State law(s) and within nine (9) months prior to purchase. Commercial seed will be either certified or registered seed. The seed container will be tagged in accordance with State law(s) and available for inspection by the authorized officer.

Seed will be planted using a drill equipped with a depth regulator to ensure proper depth of planting where drilling is possible. The seed mixture will be evenly and uniformly planted over the disturbed area (smaller/heavier seeds have a tendency to drop the bottom of the drill and are planted first). The holder shall take appropriate measures to ensure this does not occur. Where drilling is not possible, seed will be broadcast and the area shall be raked or chained to cover the seed. When broadcasting the seed, the pounds per acre are to be doubled. The seeding will be repeated until a satisfactory stand is established as determined by the authorized officer. Evaluation of growth will not be made before completion of at least one full growing season after seeding.

Species to be planted in pounds of pure live seed* per acre:

<u>Species</u>	<u>lb/acre</u>
Plains Bristlegrass	5lbs/A
Sand Bluestem	5lbs/A
Little Bluestem	3lbs/A
Big Bluestem	6lbs/A
Plains Coreopsis	2lbs/A
Sand Dropseed	1lbs/A

**Four-winged Saltbush 5lbs/A

* This can be used around well pads and other areas where caliche cannot be removed.

*Pounds of pure live seed:

Pounds of seed x percent purity x percent germination = pounds pure live seed

X. FINAL ABANDONMENT & REHABILITATION REQUIREMENTS

Upon abandonment of the well and/or when the access road is no longer in service the Authorized Officer shall issue instructions and/or orders for surface reclamation and restoration of all disturbed areas.

On private surface/federal mineral estate land the reclamation procedures on the road and well pad shall be accomplished in accordance with the private surface land owner agreement.