

UNITED STATES
DEPARTMENT OF THE INTERIOR
BUREAU OF LAND MANAGEMENTFORM APPROVED
OMB No 1004-0137
Expires March 31, 2007**SUNDRY NOTICES AND REPORTS ON WELLS**
Do not use this form for proposals to drill or to re-enter an abandoned well. Use Form 3160-3 (APD) for such proposals.

SUBMIT IN TRIPLICATE - Other instructions on page 2.

1 Type of Well

☐ Oil Well ☒ Gas Well ☐ Other2 Name of Operator
Devon Energy Production Co., LP3a Address
20 North Broadway
OKC, OK 731023b Phone No (include area code)
(405)-552-78024 Location of Well (Footage, Sec, T, R, M, or Survey Description)
Sec 10 & 14-T19S-R31E
(See Below)

5 Lease Serial No.

NMNM-055493 & NMNM99039

6. If Indian, Allottee or Tribe Name

7 If Unit of CA/Agreement, Name and/or No

8. Well Name and No

see below

9. API Well No

see below

10 Field and Pool or Exploratory Area

Lusk; Morrow West (Gas)

11 Country or Parish, State

Eddy County, NM

12 CHECK THE APPROPRIATE BOX(ES) TO INDICATE NATURE OF NOTICE, REPORT OR OTHER DATA

TYPE OF SUBMISSION	TYPE OF ACTION			
<input checked="" type="checkbox"/> Notice of Intent	<input type="checkbox"/> Acidize	<input type="checkbox"/> Deepen	<input type="checkbox"/> Production (Start/Resume)	<input type="checkbox"/> Water Shut-Off
<input type="checkbox"/> Subsequent Report	<input type="checkbox"/> Alter Casing	<input type="checkbox"/> Fracture Treat	<input type="checkbox"/> Reclamation	<input type="checkbox"/> Well Integrity
<input type="checkbox"/> Final Abandonment Notice	<input type="checkbox"/> Casing Repair	<input type="checkbox"/> New Construction	<input type="checkbox"/> Recomplete	<input checked="" type="checkbox"/> Other Lease Commingle, Off Lease Measurement & Gas Sales
	<input type="checkbox"/> Change Plans	<input type="checkbox"/> Plug and Abandon	<input type="checkbox"/> Temporarily Abandon	
	<input type="checkbox"/> Convert to Injection	<input type="checkbox"/> Plug Back	<input type="checkbox"/> Water Disposal	

13 Describe Proposed or Completed Operation: Clearly state all pertinent details, including estimated starting date of any proposed work and approximate duration thereof. If the proposal is to deepen directionally or recompleate horizontally, give subsurface locations and measured and true vertical depths of all pertinent markers and zones. Attach the Bond under which the work will be performed or provide the Bond No on file with BLM/BIA. Required subsequent reports must be filed within 30 days following completion of the involved operations. If the operation results in a multiple completion or recompleation in a new interval, a Form 3160-4 must be filed once testing has been completed. Final Abandonment Notices must be filed only after all requirements, including reclamation, have been completed and the operator has determined that the site is ready for final inspection.)

Devon Energy Production Co., LLP respectfully requests approval for lease commingle and off lease sales and measurement of gas hydrocarbon production from the following wells:

- * Acme 10 Fed Com 1: API # 30-015-35063 Sec 10-T19S-R31E Lease NMNM-055493 Lusk; Morrow West (Gas) (80840)
- * Coyote 14 Fed 1: API # 30-015-35071 Sec 14-T19S-R31E Lease NMNM-99039 Lusk; Morrow West (Gas) (80840)
- * Coyote 14 Fed 2Y: API # 30-015-35423 Sec 14-T19S-R31E Lease NMNM-99039 Lusk; Morrow West (Gas) (80840)

Each location has its' own tank battery and EFM. A common gas sales meter associated with a DCP central delivery point (CDP) is located in Sec 14-T19S-R31E approximately 200' west of the Coyote 14 Federal 1. Waste is not induced and no correlative rights are impaired.

Working, royalty, and overriding interest owners have been notified via certified mail (see attached).

SEE ATTACHED FOR
CONDITIONS OF APPROVAL

14 I hereby certify that the foregoing is true and correct

Name (Printed/Typed)
Stephanie A. Ysasaga

Title Sr. Staff Engineering Technician

Signature

Date 11/02/2009

THIS SPACE FOR FEDERAL OR STATE OFFICE USE

Approved by

/s/ JD Whitlock Jr

Title L PET

Date 1/5/2010

Conditions of approval, if any, are attached. Approval of this notice does not warrant or certify that the applicant holds legal or equitable title to those rights in the subject lease which would entitle the applicant to conduct operations thereon.

Office CFO

Title 18 U.S.C. Section 1001 and Title 43 U.S.C. Section 1212, make it a crime for any person knowingly and willfully to make to any department or agency of the United States any false, fictitious or fraudulent statements or representations as to any matter within its jurisdiction.

(Instructions on page 2)

APPLICATION FOR LEASE COMMINGLING & OFF-LEASE MEASUREMENT AND OFF LEASE SALES APPROVAL

State of New Mexico – Santa Fe
Oil Conservation Division
1220 S. St Francis Drive
Santa Fe, New Mexico 87505

Lease commingling proposal for Acme & Coyote leases:

Devon Energy Production Company, LP is requesting approval for lease commingle, off-lease storage and off-lease measurement of hydrocarbon gas production from the Lusk; Morrow West (Gas) (80840) from the following wells:

Federal Lease NMNM-055493

Well Name	Location	API #	Pool 80840	MCFPD	BTU
Acme 10 Fed Com 1	NESE Sec 10-T19S-R31E	30-015-35063	Lusk; Morrow West (Gas)	31	1426

Federal Lease NMNM-99039

Well Name	Location	API #	Pool 80840	MCFPD	BTU
Coyote 14 Fed 1	NWNE Sec 14-T19S-R31E	30-015-35071	Lusk; Morrow West (Gas)	1825	1084
Coyote 14 Fed 2Y	SWNW Sec 14-T19S-R31E	30-015- 35071	Lusk; Morrow West (Gas)	13578	1163

35423

A map (Exhibit A) is enclosed showing the Federal leases and well locations in Section 10 and 14 of T19S R31E. The ownership in the Acme and Coyote leases are not identical; all affected working interest, royalty and overriding royalty owners have been notified of this proposal (Exhibit B).

Gas metering:

The gas hydrocarbon production from the Acme 10 Fed Com 1, Coyote 14 Fed 1 and Coyote 14 Fed 2Y will be the only hydrocarbon being lease commingled, measured and sold off-lease. Each location has its' own facility located in the NESE, NWNE and SWNW of Section 10 and 14 (respectively) in T19S, R31E on Federal Leases NMNM-055493 and NMNM-99039 in Eddy County, New Mexico (see facility diagrams). Each location has its own EFM to verify gas rates. A common gas sales meter associated with a DCP central delivery point (CDP) is located in Sec 14-T19S-R31E approximately 200' west of the Coyote 14 Federal 1 (see Exhibit C). The BLM's interest in all three wells is the same. Waste is not induced and no correlative rights are impaired.

These meters will be calibrated on a regular basis per API, NMOCD and BLM specifications. ROW has been obtained according to Exhibit C to transport gas production to the DCP CDP. The BLM and OCD will be notified of any future changes in the facilities.

Process and Flow Descriptions:

Please see attached diagrams for the proposed Acme 10 Fed Com 1, Coyote 14 Fed 1 and Coyote 14 Fed 2Y batteries. The flow of produced fluids is shown in detail on Exhibit D along with a description of each vessel.

The commingling of production is in the interest of conservation and waste and will result in the most effective, economic means of producing the reserves in place from the affected wells and will not result in reduced royalty or improper measurement of production. The proposed commingling will reduce operating expenses as well as reduce the surface facility footprint and overall emissions.

Devon Energy Production Company, LP understands the requested approval will not constitute the granting of any right-of-way or construction rights not granted by the lease instrument. Additionally, Devon Energy Production Co., LP will submit within 30 days, an application for right-of-way approval to the BLM and NMOCD section in your office, if we have not already done so.

DATE IN	SUSPENSE	ENGINEER	LOGGED IN	TYPE	APP NO
---------	----------	----------	-----------	------	--------

ABOVE THIS LINE FOR DIVISION USE ONLY

NEW MEXICO OIL CONSERVATION DIVISION

- Engineering Bureau -

1220 South St. Francis Drive, Santa Fe, NM 87505



ADMINISTRATIVE APPLICATION CHECKLIST

THIS CHECKLIST IS MANDATORY FOR ALL ADMINISTRATIVE APPLICATIONS FOR EXCEPTIONS TO DIVISION RULES AND REGULATIONS WHICH REQUIRE PROCESSING AT THE DIVISION LEVEL IN SANTA FE

Application Acronyms:

[NSL-Non-Standard Location] [NSP-Non-Standard Proration Unit] [SD-Simultaneous Dedication]
 [DHC-Downhole Commingling] [CTB-Lease Commingling] [PLC-Pool/Lease Commingling]
 [PC-Pool Commingling] [OLS - Off-Lease Storage] [OLM-Off-Lease Measurement]
 [WFX-Waterflood Expansion] [PMX-Pressure Maintenance Expansion]
 [SWD-Salt Water Disposal] [IPI-Injection Pressure Increase]
 [EOR-Qualified Enhanced Oil Recovery Certification] [PPR-Positive Production Response]

[1] TYPE OF APPLICATION - Check Those Which Apply for [A]

[A] Location - Spacing Unit - Simultaneous Dedication
☐ NSL ☐ NSP ☐ SD

Check One Only for [B] or [C]

[B] Commingling - Storage - Measurement
☐ DHC ☒ CTB ☐ PLC ☐ PC ☐ OLS ☒ OLM

[C] Injection - Disposal - Pressure Increase - Enhanced Oil Recovery
☐ WFX ☐ PMX ☐ SWD ☐ IPI ☐ EOR ☐ PPR

[D] Other: Specify _____

[2] NOTIFICATION REQUIRED TO: - Check Those Which Apply, or ☐ Does Not Apply

[A] ☒ Working, Royalty or Overriding Royalty Interest Owners

[B] ☐ Offset Operators, Leaseholders or Surface Owner

[C] ☐ Application is One Which Requires Published Legal Notice

[D] ☒ Notification and/or Concurrent Approval by BLM or SLO
U.S. Bureau of Land Management - Commissioner of Public Lands, State Land Office

[E] ☐ For all of the above, Proof of Notification or Publication is Attached, and/or,

[F] ☐ Waivers are Attached

[3] SUBMIT ACCURATE AND COMPLETE INFORMATION REQUIRED TO PROCESS THE TYPE OF APPLICATION INDICATED ABOVE.

[4] **CERTIFICATION:** I hereby certify that the information submitted with this application for administrative approval is **accurate** and **complete** to the best of my knowledge. I also understand that **no action** will be taken on this application until the required information and notifications are submitted to the Division.

Note: Statement must be completed by an individual with managerial and/or supervisory capacity.

Stephanie A. Ysasaga
 Print or Type Name

Signature

Sr. Staff Engineering Technician
 Title

11/02/2009
 Date

Stephanie.Ysasaga@dmv.com
 e-mail Address

District I
1625 N French Drive, Hobbs, NM 88240
District II
1301 W Grand Ave, Artesia, NM 88210
District III
1000 Rio Brazos Road, Aztec, NM 87410
District IV
1220 S St Francis Dr, Santa Fe, NM
87505

State of New Mexico
Energy, Minerals and Natural Resources Department

Form C-107-B
Revised June 10, 2003

OIL CONSERVATION DIVISION

1220 S. St Francis Drive
Santa Fe, New Mexico 87505

Submit the original
application to the Santa Fe
office with one copy to the
appropriate District Office.

APPLICATION FOR SURFACE COMMINGLING (DIVERSE OWNERSHIP)

OPERATOR NAME. Devon Energy Production Co., LP

OPERATOR ADDRESS 20 North Broadway, Ste 1500

APPLICATION TYPE:

☐ Pool Commingling ☒ Lease Commingling ☐ Pool and Lease Commingling ☒ Off-Lease Storage and Measurement (Only if not Surface Commingled)

LEASE TYPE ☐ Fee ☐ State ☒ Federal

Is this an Amendment to existing Order? ☐ Yes ☒ No If "Yes", please include the appropriate Order No. _____

Have the Bureau of Land Management (BLM) and State Land office (SLO) been notified in writing of the proposed commingling
☐ Yes ☐ No

(A) POOL COMMINGLING

Please attach sheets with the following information

(1) Pool Names and Codes	Gravities / BTU of Non-Commingled Production	Calculated Gravities / BTU of Commingled Production		Calculated Value of Commingled Production	Volumes

(2) Are any wells producing at top allowables? ☐ Yes ☐ No

(3) Has all interest owners been notified by certified mail of the proposed commingling? ☐ Yes ☐ No

(4) Measurement type ☐ Metering ☐ Other (Specify)

(5) Will commingling decrease the value of production? ☐ Yes ☐ No If "yes", describe why commingling should be approved

(B) LEASE COMMINGLING

Please attach sheets with the following information

(1) Pool Name and Code Lusk, Morrow West (Gas) 80840

(2) Is all production from same source of supply? ☒ Yes ☐ No

(3) Has all interest owners been notified by certified mail of the proposed commingling? ☒ Yes ☐ No

(4) Measurement type ☒ Metering ☐ Other (Specify)

(C) POOL and LEASE COMMINGLING

Please attach sheets with the following information

(1) Complete Sections A and E.

(D) OFF-LEASE STORAGE and MEASUREMENT

Please attached sheets with the following information

(1) Is all production from same source of supply? ☒ Yes ☐ No

(2) Include proof of notice to all interest owners

(E) ADDITIONAL INFORMATION (for all application types)

Please attach sheets with the following information

(1) A schematic diagram of facility, including legal location

(2) A plat with lease boundaries showing all well and facility locations Include lease numbers if Federal or State lands are involved

(3) Lease Names, Lease and Well Numbers, and API Numbers

I hereby certify that the information above is true and complete to the best of my knowledge and belief

SIGNATURE [Signature] TITLE Sr Staff Engineering Technician DATE 11/02/2009

TYPE OR PRINT NAME Stephanie A Ysasaga TELEPHONE NO (405)-552-7802

E-MAIL ADDRESS Stephanie.Ysasaga@dmn.com

Acme & Coyote Wells
Off Lease Measurement, Storage & Surface Commingle (Gas)
19S-31E Eddy County, NM

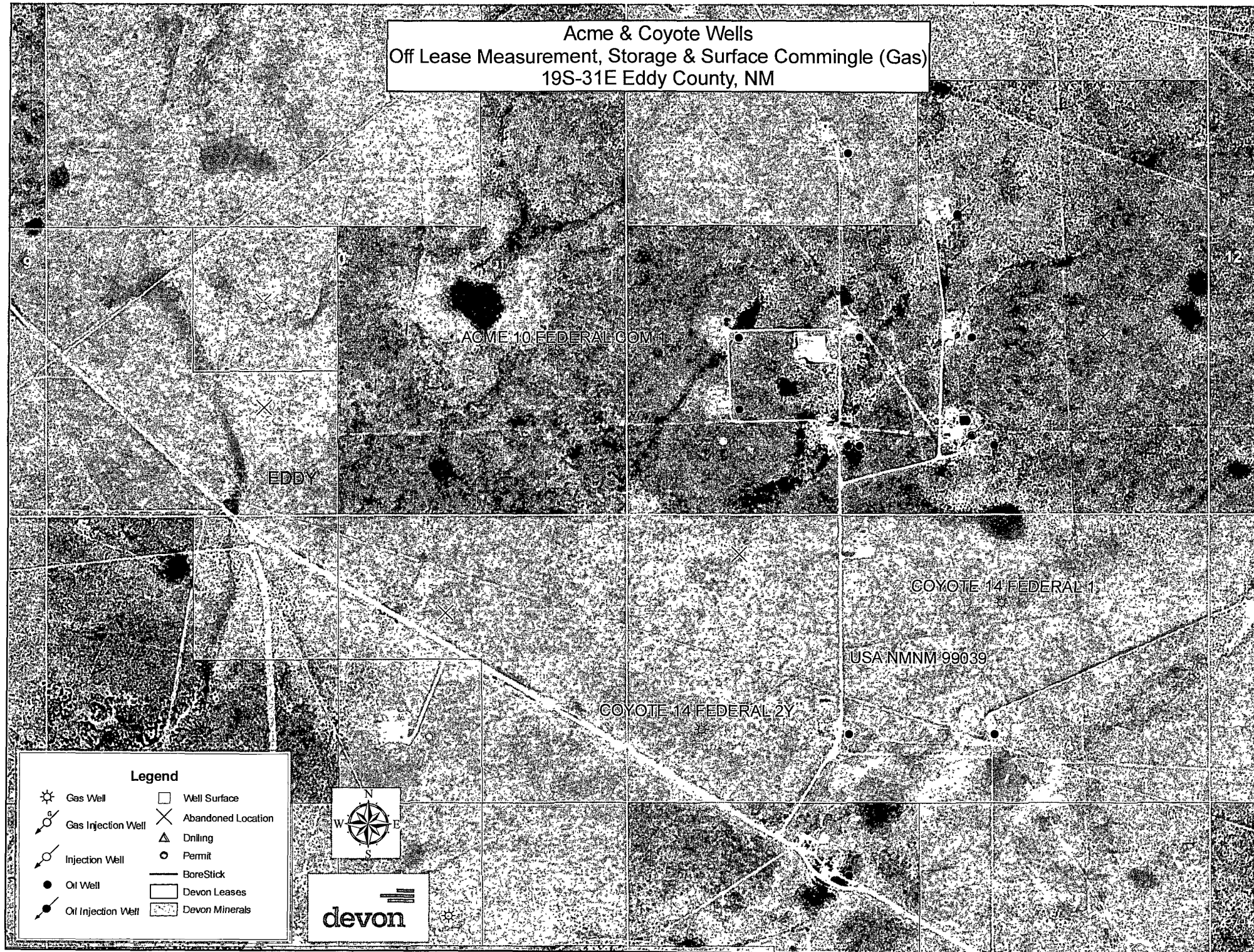

Exhibit B

Marbob Energy Corporation
P O Drawer 227
Artesia, NM 88211-0227
7008-1830-0003-1986-2550

Minerals Management Service Royalty Mgmt Pgrm
P.O Box 5810
Denver, Colorado 80217
7008-1830-0003-1986-2567

Nearburg Exploration Co LLC
3300 North "A" St, Bldg 2, Ste 120
Midland, Texas 79705
7008-1830-0003-1986-2574

COG Oil & Gas LP – Fasken Center Tower II
550 W Texas Ave, Ste 1300
Midland, Texas 79701
7008-1830-0003-1986-2581

Badger Energy Inc
P O Box 1708
Hobbs, NM 88241
7008-1830-0003-1986-2598

Penwell Employee Royalty Pool
200 N. Loraine Suite 1550
Midland, TX 79701
7008-1830-0003-1986-2604

McCombs Energy Ltd – Ricky Haiken VP
5599 San Felipe, Ste 1200
Houston, TX 77056
7008-1830-0003-1986-2611

John Lawrence Thomas
P O Box 863418
Plano, TX 75086
7008-1830-0003-1986-2628

James E Geitgey
P O Box 51451
Midland, TX 79710
7008-1830-0003-1986-2635

C Mark Wheeler
24 Smith Road, Ste 405
Midland, TX 79705
7008-1830-0003-1986-2642

Paul R Barwis c/o Dutton Harris Co
P O Box 230
Midland, Texas 79702
7008-1830-0003-1986-2659

Buffalo Oil Company – BOK - Acct # 11633
P O Box 1588
Tulsa, OK 74101
7008-1830-0003-1986-2666

Sandra Mary Thomas – A Single Woman
789 W. Hellsgate Drive
Strawn, TX 79705
7008-1830-0003-1986-2673

SENDER: COMPLETE THIS SECTION

- ☒ Complete items 1, 2, and 3. Also complete item 4 if Restricted Delivery is desired.
- ☒ Print your name and address on the reverse so that we can return the card to you.
- ☒ Attach this card to the back of the mailpiece, or on the front if space permits.

1. Article Addressed to:

Badger Energy Inc.
P.O. Box 1708
Hobbs, NM 88241

2. Article Number

(Transfer from service label)

7008 1830 0003 1986 2598

PS Form 3811, February 2004

Domestic Return Receipt

102595-02-M-1540

COMPLETE THIS SECTION ON DELIVERY

A. Signature

X *[Signature]*☐ Agent☐ Addressee

B. Received by (Printed Name)

Anita Davanport

C. Date of Delivery

11-17-9

D. Is delivery address different from item 1? ☐ YesIf YES, enter delivery address below: ☐ No

3. Service Type

☐ Certified Mail☐ Express Mail☐ Registered☐ Return Receipt for Merchandise☐ Insured Mail☐ C.O.D.

4. Restricted Delivery? (Extra Fee)

☐ Yes

SENDER: COMPLETE THIS SECTION

- ☒ Complete items 1, 2, and 3. Also complete item 4 if Restricted Delivery is desired.
- ☒ Print your name and address on the reverse so that we can return the card to you.
- ☒ Attach this card to the back of the mailpiece, or on the front if space permits.

1. Article Addressed to:

Buffalo Oil Company - BOK - Acct # 11633
P.O. Box 1588
Tulsa, OK 74101

2. Article Number

(Transfer from service label)

7008 1830 0003 1986 2666

PS Form 3811, February 2004

Domestic Return Receipt

102595-02-M-1540

COMPLETE THIS SECTION ON DELIVERY

A. Signature

X *[Signature]*☐ Agent☐ Addressee

B. Received by (Printed Name)

C. Date of Delivery

D. Is delivery address different from item 1? ☐ YesIf YES, enter delivery address below: ☐ No

NOV 16 2009

3. Service Type

☐ Certified Mail☒ Express Mail☐ Registered☐ Return Receipt for Merchandise☐ Insured Mail☐ C.O.D.

4. Restricted Delivery? (Extra Fee)

☐ Yes

SENDER: COMPLETE THIS SECTION

- ☒ Complete items 1, 2, and 3. Also complete item 4 if Restricted Delivery is desired.
- ☒ Print your name and address on the reverse so that we can return the card to you.
- ☒ Attach this card to the back of the mailpiece, or on the front if space permits.

1. Article Addressed to:

John Lawrence Thomas
P.O. Box 863418
Plano, TX 75086

2. Article Number

(Transfer from service label)

7008 1830 0003 1986 2628

PS Form 3811, February 2004

Domestic Return Receipt

102595-02-M-1540

COMPLETE THIS SECTION ON DELIVERY

A. Signature

X *[Signature]*☐ Agent☐ Addressee

B. Received by (Printed Name)

C. Date of Delivery

11/16/09

D. Is delivery address different from item 1? ☐ YesIf YES, enter delivery address below: ☐ No

3. Service Type

☐ Certified Mail☐ Express Mail☐ Registered☐ Return Receipt for Merchandise☐ Insured Mail☐ C.O.D.

4. Restricted Delivery? (Extra Fee)

☐ Yes

SENDER: COMPLETE THIS SECTION

- ☐ Complete items 1, 2, and 3. Also complete item 4 if Restricted Delivery is desired.
- ☐ Print your name and address on the reverse so that we can return the card to you.
- ☐ Attach this card to the back of the mailpiece, or on the front if space permits.

1. Article Addressed to:

Penwell Employee Royalty Pool
200 N. Loraine Suite 1550
Midland, TX 79701

2. Article Number

(Transfer from service label)

7008 1830 0003 1986 2604

PS Form 3811, February 2004

Domestic Return Receipt

102595-02-M-1540

COMPLETE THIS SECTION ON DELIVERY

A. Signature

X

Caren Copeland

☐ Agent☐ Addressee

B. Received by (Printed Name)

Caren Copeland

C. Date of Delivery

D. Is delivery address different from item 1? ☐ YesIf YES, enter delivery address below: ☐ No

3. Service Type

☐ Certified Mail☐ Express Mail☐ Registered☐ Return Receipt for Merchandise☐ Insured Mail☐ C.O.D.

4. Restricted Delivery? (Extra Fee)

☐ Yes

SENDER: COMPLETE THIS SECTION

- ☐ Complete items 1, 2, and 3. Also complete item 4 if Restricted Delivery is desired.
- ☐ Print your name and address on the reverse so that we can return the card to you.
- ☐ Attach this card to the back of the mailpiece or on the front if space permits.

1. Article Addressed to:

COG Oil & Gas LP - Fasken Center Tower II
550 W Texas Ave, Ste 1300
Midland, Texas 79701

2. Article Number

(Transfer from service label)

7008 1830 0003 1986 2581

PS Form 3811, February 2004

Domestic Return Receipt

102595-02-M-1540

COMPLETE THIS SECTION ON DELIVERY

A. Signature

X

L Koeningor

☐ Agent☐ Addressee

B. Received by (Printed Name)

L Koeningor

C. Date of Delivery

D. Is delivery address different from item 1? ☐ YesIf YES, enter delivery address below: ☐ No

3. Service Type

☐ Certified Mail☐ Express Mail☐ Registered☐ Return Receipt for Merchandise☐ Insured Mail☐ C.O.D.

4. Restricted Delivery? (Extra Fee)

☐ Yes

SENDER: COMPLETE THIS SECTION

- ☐ Complete items 1, 2, and 3. Also complete item 4 if Restricted Delivery is desired.
- ☐ Print your name and address on the reverse so that we can return the card to you.
- ☐ Attach this card to the back of the mailpiece, or on the front if space permits.

1. Article Addressed to:

Marbob Energy Corporation
P.O. Drawer 227
Artesia, NM 88211-0227

2. Article Number

(Transfer from service label)

7008 1830 0003 1986 2550

PS Form 3811, February 2004

Domestic Return Receipt

102595-02-M-1540

COMPLETE THIS SECTION ON DELIVERY

A. Signature

X

Misti McLurg

☐ Agent☐ Addressee

B. Received by (Printed Name)

MISTI MCLURG

C. Date of Delivery

D. Is delivery address different from item 1? ☐ YesIf YES, enter delivery address below: ☐ No

3. Service Type

☐ Certified Mail☐ Express Mail☐ Registered☐ Return Receipt for Merchandise☐ Insured Mail☐ C.O.D.

4. Restricted Delivery? (Extra Fee)

☐ Yes

SENDER: COMPLETE THIS SECTION

- ☒ Complete items 1, 2, and 3. Also complete item 4 if Restricted Delivery is desired.
- ☒ Print your name and address on the reverse so that we can return the card to you.
- ☒ Attach this card to the back of the mailpiece, or on the front if space permits.

1. Article Addressed to:

Sandra Mary Thomas -- A Single Woman
789 W. Hellsgate Drive
Strawn, TX 79705

2. Article Number

(Transfer from service label)

7008 1830 0003 1986 2673

PS Form 3811, February 2004

Domestic Return Receipt

102595-02-M-1540

COMPLETE THIS SECTION ON DELIVERY

A. Signature

x *S. M. Thomas*☐ Agent☒ Addressee

B. Received by (Printed Name)

S. M. Thomas

C. Date of Delivery

11-16-09

D. Is delivery address different from item 1? ☐ YesIf YES, enter delivery address below: ☒ No

3. Service Type

☐ Certified Mail☐ Express Mail☐ Registered☐ Return Receipt for Merchandise☐ Insured Mail☐ C.O.D.

4. Restricted Delivery? (Extra Fee)

☐ Yes

SENDER: COMPLETE THIS SECTION

- ☒ Complete items 1, 2, and 3. Also complete item 4 if Restricted Delivery is desired.
- ☒ Print your name and address on the reverse so that we can return the card to you.
- ☒ Attach this card to the back of the mailpiece, or on the front if space permits.

1. Article Addressed to:

C. Mark Wheeler
24 Smith Road, Ste 405
Midland, TX 79705

2. Article Number

(Transfer from service label)

7008 1830 0003 1986 2642

PS Form 3811, February 2004

Domestic Return Receipt

102595-02-M-1540

COMPLETE THIS SECTION ON DELIVERY

A. Signature

x *C. Mark Wheeler*☐ Agent☐ Addressee

B. Received by (Printed Name)

C. Mark Wheeler

C. Date of Delivery

11/16/09

D. Is delivery address different from item 1? ☐ YesIf YES, enter delivery address below: ☐ No

3. Service Type

☐ Certified Mail☐ Express Mail☐ Registered☐ Return Receipt for Merchandise☐ Insured Mail☐ C.O.D.

4. Restricted Delivery? (Extra Fee)

☐ Yes

SENDER: COMPLETE THIS SECTION

- ☒ Complete items 1, 2, and 3. Also complete item 4 if Restricted Delivery is desired.
- ☒ Print your name and address on the reverse so that we can return the card to you.
- ☒ Attach this card to the back of the mailpiece, or on the front if space permits.

1. Article Addressed to:

Nearburg Exploration Co. LLC
3300 North "A" St, Bldg 2, Ste 120
Midland, Texas 79705

2. Article Number

(Transfer from service label)

7008 1830 0003 1986 2574

PS Form 3811, February 2004

Domestic Return Receipt

102595-02-M-1540

COMPLETE THIS SECTION ON DELIVERY

A. Signature

x *D. Walton*☐ Agent☐ Addressee

B. Received by (Printed Name)

D. Walton

C. Date of Delivery

11-16-09

D. Is delivery address different from item 1? ☐ YesIf YES, enter delivery address below: ☐ No

3. Service Type

☐ Certified Mail☐ Express Mail☐ Registered☐ Return Receipt for Merchandise☐ Insured Mail☐ C.O.D.

4. Restricted Delivery? (Extra Fee)

☐ Yes

SENDER: COMPLETE THIS SECTION		COMPLETE THIS SECTION ON DELIVERY	
<p><input checked="" type="checkbox"/> Complete items 1, 2, and 3. Also complete item 4 if Restricted Delivery is desired.</p> <p><input checked="" type="checkbox"/> Print your name and address on the reverse so that we can return the card to you.</p> <p><input checked="" type="checkbox"/> Attach this card to the back of the mailpiece, or on the front if space permits.</p>		<p>A. Signature <div style="display: flex; justify-content: space-between;"> X <i>Billy Forney</i> <input checked="" type="checkbox"/> Agent <input type="checkbox"/> Addressee </div> </p> <p>B. Received by (Printed Name) <i>Billy Forney</i> </p> <p>C. Date of Delivery <i>11/16/09</i> </p> <p>D. Is delivery address different from item 1? <input type="checkbox"/> Yes If YES, enter delivery address below: <input type="checkbox"/> No </p>	
<p>1. Article Addressed to:</p> <p>McCombs Energy Ltd – Ricky Haiken VP 5599 San Felipe, Ste 1200 Houston, TX 77056</p>		<p>3. Service Type <div style="display: flex; justify-content: space-between;"> <input type="checkbox"/> Certified Mail <input type="checkbox"/> Express Mail </div> <div style="display: flex; justify-content: space-between;"> <input type="checkbox"/> Registered <input type="checkbox"/> Return Receipt for Merchandise </div> <div style="display: flex; justify-content: space-between;"> <input type="checkbox"/> Insured Mail <input type="checkbox"/> C.O.D. </div> </p> <p>4. Restricted Delivery? (Extra Fee) <input type="checkbox"/> Yes</p>	
<p>2. Article Number (Transfer from service label)</p>		<p>7008 1830 0003 1986 2611</p>	
<p>PS Form 3811, February 2004</p>		<p>Domestic Return Receipt</p>	
<p>102595-02-M-1540</p>		<p>102595-02-M-1540</p>	

SENDER: COMPLETE THIS SECTION		COMPLETE THIS SECTION ON DELIVERY	
<p><input checked="" type="checkbox"/> Complete items 1, 2, and 3. Also complete item 4 if Restricted Delivery is desired.</p> <p><input checked="" type="checkbox"/> Print your name and address on the reverse so that we can return the card to you.</p> <p><input checked="" type="checkbox"/> Attach this card to the back of the mailpiece, or on the front if space permits.</p>		<p>A. Signature <div style="display: flex; justify-content: space-between;"> X <i>[Signature]</i> <input type="checkbox"/> Agent <input type="checkbox"/> Addressee </div> </p> <p>B. Received by (Printed Name) <i>[Signature]</i> </p> <p>C. Date of Delivery <i>11/16/2009</i> </p> <p>D. Is delivery address different from item 1? <input type="checkbox"/> Yes If YES, enter delivery address below: <input type="checkbox"/> No </p>	
<p>1. Article Addressed to:</p> <p>Minerals Management Service Royalty Mgmt Pgrm P.O. Box 5810 Denver, Colorado 80217</p>		<p>3. Service Type <div style="display: flex; justify-content: space-between;"> <input type="checkbox"/> Certified Mail <input type="checkbox"/> Express Mail </div> <div style="display: flex; justify-content: space-between;"> <input type="checkbox"/> Registered <input type="checkbox"/> Return Receipt for Merchandise </div> <div style="display: flex; justify-content: space-between;"> <input type="checkbox"/> Insured Mail <input type="checkbox"/> C.O.D. </div> </p> <p>4. Restricted Delivery? (Extra Fee) <input type="checkbox"/> Yes</p>	
<p>2. Article Number (Transfer from service label)</p>		<p>7008 1830 0003 1986 2567</p>	
<p>PS Form 3811, February 2004</p>		<p>Domestic Return Receipt</p>	
<p>102595-02-M-1540</p>		<p>102595-02-M-1540</p>	

SENDER: COMPLETE THIS SECTION		COMPLETE THIS SECTION ON DELIVERY	
<p><input checked="" type="checkbox"/> Complete items 1, 2, and 3. Also complete item 4 if Restricted Delivery is desired.</p> <p><input checked="" type="checkbox"/> Print your name and address on the reverse so that we can return the card to you.</p> <p><input checked="" type="checkbox"/> Attach this card to the back of the mailpiece, or on the front if space permits.</p>		<p>A. Signature <div style="display: flex; justify-content: space-between;"> X <i>Kristy Franklin</i> <input type="checkbox"/> Agent <input checked="" type="checkbox"/> Addressee </div> </p> <p>B. Received by (Printed Name) <i>Kristy Franklin</i> </p> <p>C. Date of Delivery <i>11/12</i> </p> <p>D. Is delivery address different from item 1? <input type="checkbox"/> Yes If YES, enter delivery address below: <input type="checkbox"/> No </p>	
<p>1. Article Addressed to:</p> <p>James E Geitgey P.O. Box 51451 Midland, TX 79710</p>		<p>3. Service Type <div style="display: flex; justify-content: space-between;"> <input type="checkbox"/> Certified Mail <input type="checkbox"/> Express Mail </div> <div style="display: flex; justify-content: space-between;"> <input type="checkbox"/> Registered <input type="checkbox"/> Return Receipt for Merchandise </div> <div style="display: flex; justify-content: space-between;"> <input type="checkbox"/> Insured Mail <input type="checkbox"/> C.O.D. </div> </p> <p>4. Restricted Delivery? (Extra Fee) <input type="checkbox"/> Yes</p>	
<p>2. Article Number (Transfer from service label)</p>		<p>7008 1830 0003 1986 2635</p>	
<p>PS Form 3811, February 2004</p>		<p>Domestic Return Receipt</p>	
<p>102595-02-M-1540</p>		<p>102595-02-M-1540</p>	

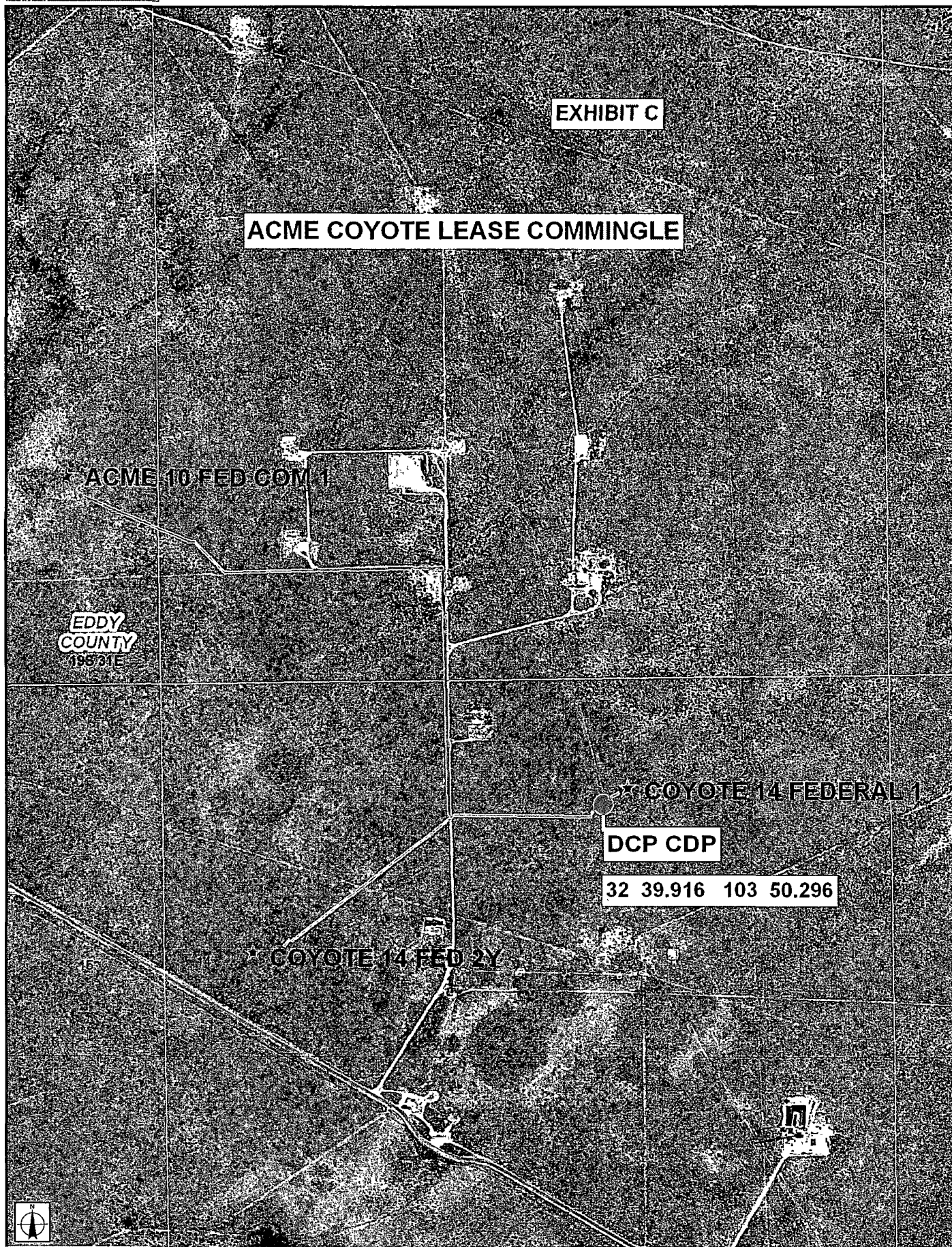

Acme 10 Fed Com #1
Sec 10, T195, R31E
1480 FSL & 660 FEL
Eddy Co. N.M.

Devon Energy
Acme 10 Fed Com #1
Allocation Gas Meter
NNNM 055493

Devon Energy
Coyote 14 Fed Com #1
Allocation Gas Meter

Coyote 14 Fed Com
#1

Sec 14, T195, R31E
810 FSL & 1905 FEL
Eddy Co. N.M.
NNNM 99039

DGP
CDA

Sec 14, T195, R31E

E

Devon Energy, Coyote 14 #24
Allocation Gas meter

Coyote 14 Fed Com #24
Sec 14, T195, R31E
1980 FSL & 760 FEL
Eddy Co, N.M.
NNNM 99039

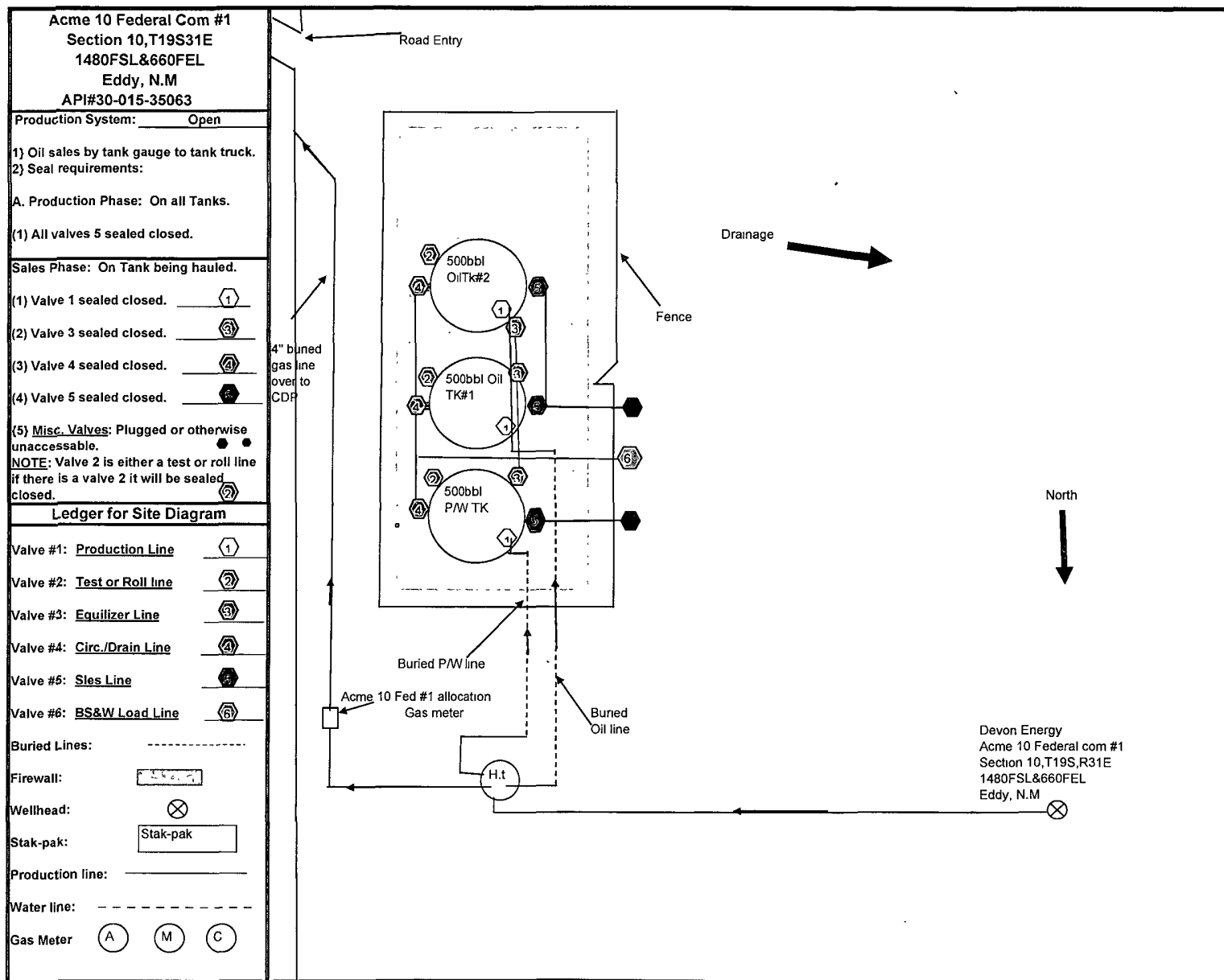

Coyote 14 Fed #1
 Section 14,T19S,R31E
 810FNL&1905FEL
 Eddy, N.M
 API# 30-015-35071







Production System: Open

- 1) Oil sales by tank gauge to tank truck.
- 2) Seal requirements:







A. Production Phase: On all Tanks.

(1) All valves 5 sealed closed.

Sales Phase: On Tank being hauled.

- (1) Valve 1 sealed closed. 
 - (2) Valve 3 sealed closed. 
 - (3) Valve 4 sealed closed. 
 - (4) Valve 5 sealed closed. 
 - (5) Misc. Valves: Plugged or otherwise unaccessible. 
- NOTE: Valve 2 is either a test or roll line if there is a valve 2 it will be sealed closed. 

Ledger for Site Diagram

- | | |
|-------------------------------------|---|
| Valve #1: <u>Production Line</u> |  |
| Valve #2: <u>Test or Roll line</u> |  |
| Valve #3: <u>Equilizer Line</u> |  |
| Valve #4: <u>Circ./Drain Line</u> |  |
| Valve #5: <u>Sles Line</u> |  |
| Valve #6: <u>BS&W Load Line</u> |  |

Buried Lines: -----

Firewall: 

Wellhead: 

Stak-pak: 

Production line: -----

Water line: - - - - -

Gas Meter   

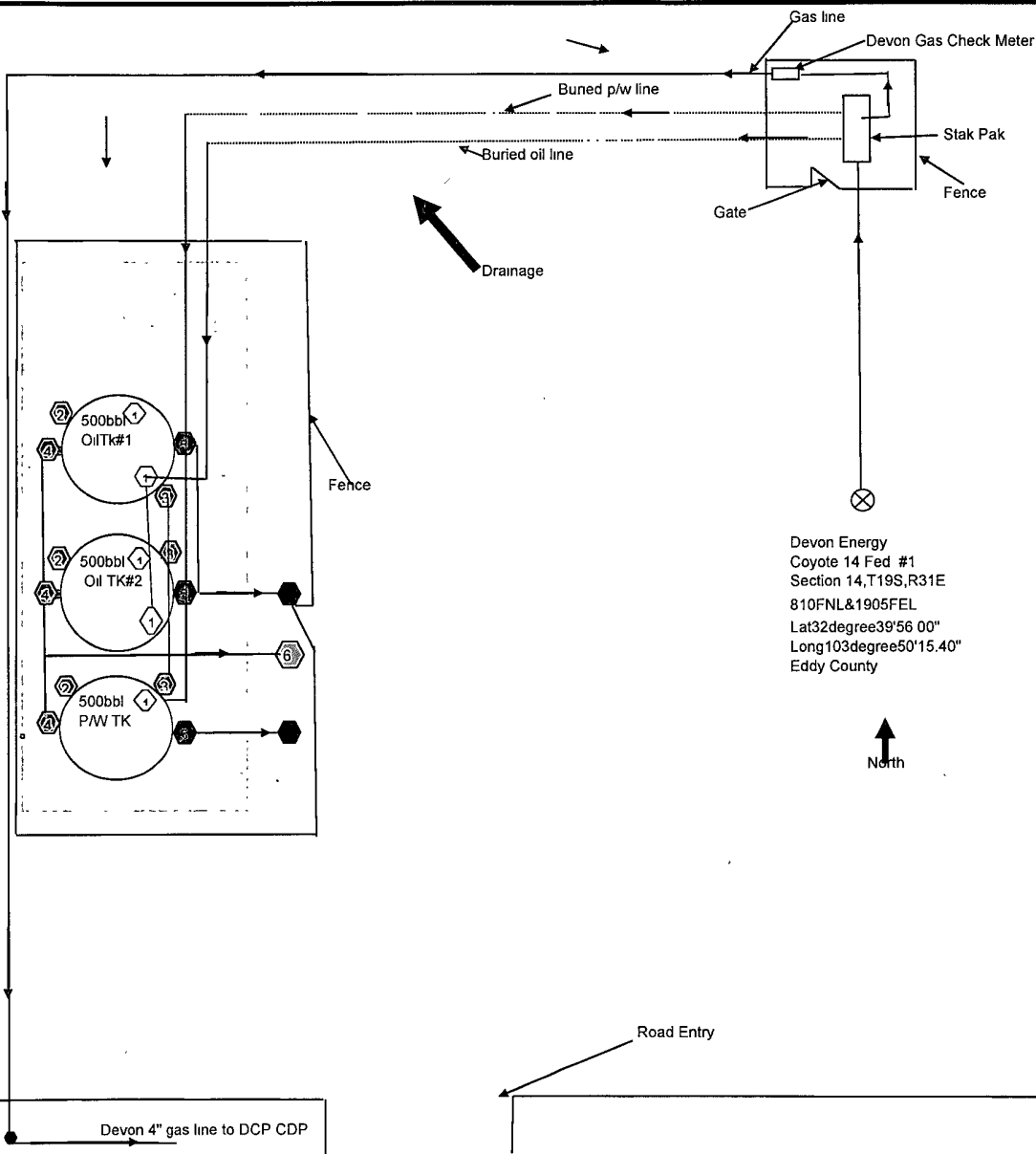

Coyote 14 Federal 2Y
Section 14, T19S, R31E
1980FNL & 760FWL
Eddy, N.M
API# 30-015-35423

Production System: Open

- 1) Oil sales by tank gauge to tank truck.
- 2) Seal requirements:
 - A. Production Phase: On all Tanks.
 - (1) All valves 5 sealed closed.
 - (2) Valves 3 open
 - (3) Valves 2 & 4 closed
 - (4) Valve 1 open on tk producing into

Sales Phase: On Tank being hauled.

- (1) Valve 1 sealed closed. ☐
 - (2) Valve 3 sealed closed. ☐
 - (3) Valve 4 sealed closed. ☐
 - (4) Valve 5 sealed closed. ☐
 - (5) Misc. Valves: Plugged or otherwise unaccessible. ☐
- NOTE: Valve 2 is either a test or roll line if there is a valve 2 it will be sealed closed. ☐

Ledger for Site Diagram

- Valve #1: Production Line ☐
- Valve #2: Test or Roll line ☐
- Valve #3: Equalizer Line ☐
- Valve #4: Circ./Drain Line ☐
- Valve #5: Sies Line ☐
- Valve #6: BS&W Load Line ☐

Buried Lines: -----

Firewall: ☐

Wellhead: ☐

Stak-pak: ☐

Production line: -----

Water line: -----

Gas Meter ☐ ☐ ☐

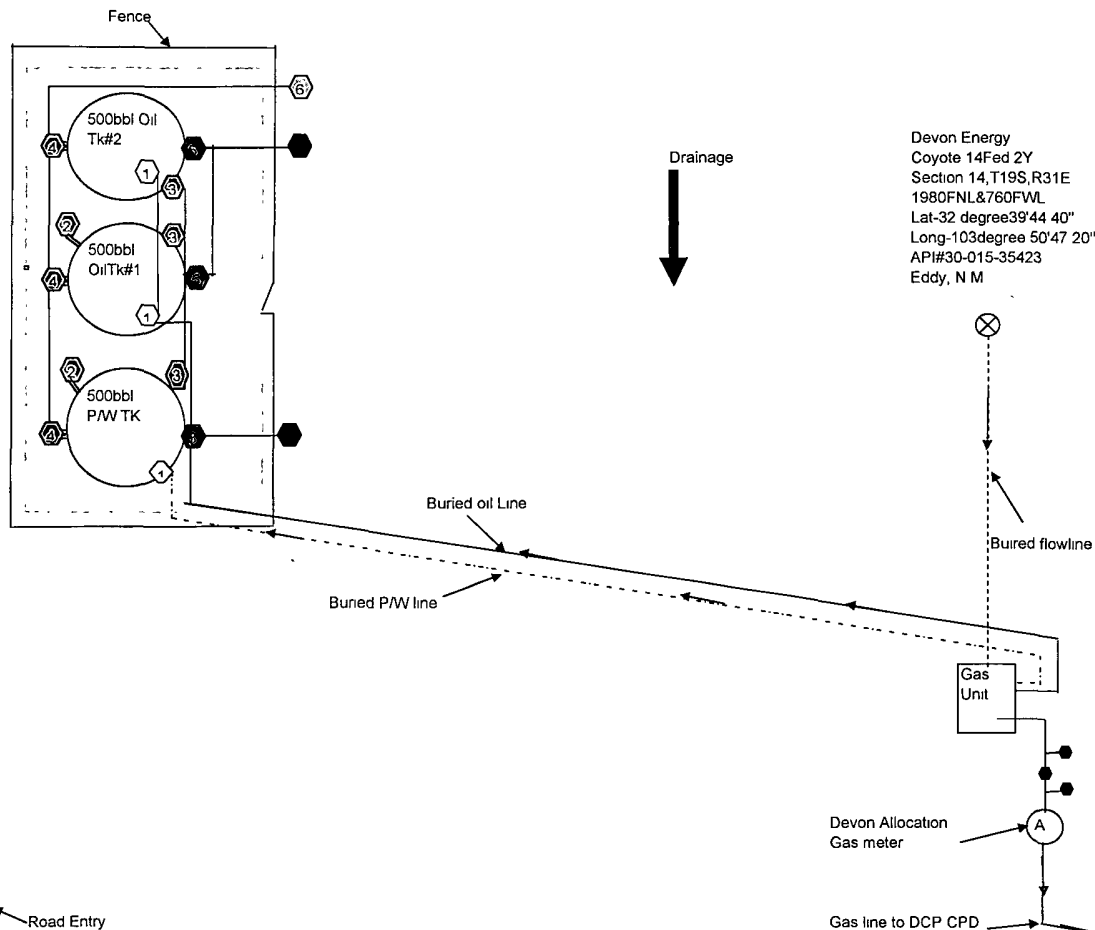

OFF LEASE PRODUCTION - EDDY COUNTY

	01/01/09	02/01/09	03/01/09	04/01/09	05/01/09	06/01/09	07/01/09	08/01/09
Well Name	Sum Est Gas	Sum Est Gas	Sum Est Gas	Sum Est Gas	Sum Est Gas	Sum Est Gas	Sum Est Gas	Sum Est Gas
ACME 10 FED COM 1 (BONE SPRING)	125.77	120.05	117.06	100.2	91.82	93.21	90.09	30.48
COYOTE 14 FEDERAL 1	11,602.17	7,750.45	6,510.34	5,156.58	1,997.89	2,621.47	4,970.5	1,825.22
COYOTE 14 FEDERAL 2Y	12,666.2	12,539.98	14,613.58	12,086.05	13,267.29	13,197.16	13,577.91	4,258.9



Laboratory Services, Inc.

2609 West Marland
Hobbs, New Mexico 88240

Telephone: (575) 397-3713

H

FOR: Devon Energy
P. O. Box 250
Artesia, New Mexico 88211-0250

SAMPLE:
IDENTIFICATION Acme 10 Fed. #1
COMPANY: Devon Energy
LEASE:
PLANT:

SAMPLE DATA: DATE SAMPLED:
ANALYSIS DATE: 7/31/09
PRESSURE - PSIA
SAMPLE TEMP. °F
ATMOS. TEMP. °F

GAS (XX) LIQUID ()
SAMPLED BY:
ANALYSIS BY: Vickie Sullivan

REMARKS:

COMPONENT ANALYSIS

COMPONENT	MOL PERCENT	GPM
Hydrogen Sulfide (H2S)		
Nitrogen (N2)	2.744	
Carbon Dioxide (CO2)	0.424	
Methane (C1)	67.649	
Ethane (C2)	13.292	3.546
Propane (C3)	7.709	2.119
I-Butane (IC4)	1.102	0.360
N-Butane (NC4)	2.956	0.930
I-Pentane (IC5)	1.029	0.376
N-Pentane (NC5)	1.006	0.363
Hexane Plus (C6+)	<u>2.089</u>	<u>0.907</u>
	100.000	8.601

BTU/CU.FT. - DRY 1426
AT 14.650 DRY 1421
AT 14.650 WET 1396
AT 14.73 DRY 1429
AT 14.73 WET 1404

MOLECULAR WT. 24.9615

SPECIFIC GRAVITY -
CALCULATED 0.857
MEASURED

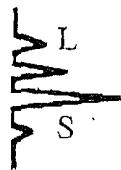

Laboratory Services, Inc.

 2609 West Marland
 Hobbs, New Mexico 88240

Telephone: (575) 397-3713

H

 FOR: Devon Energy
 P. O. Box 250
 Artesia, New Mexico 88211-0250

 SAMPLE: Sta. #67712094
 IDENTIFICATION Coyote 14 Fed. #1
 COMPANY: Devon Energy
 LEASE:
 PLANT:

 SAMPLE DATA: DATE SAMPLED: 11/24/08 2:30 pm
 ANALYSIS DATE: 11/26/08
 PRESSURE - PSIA 723
 SAMPLE TEMP. °F 71
 ATMOS. TEMP. °F 70

 GAS (XX) LIQUID ()
 SAMPLED BY: Robert Hernandez
 ANALYSIS BY: Vickie Sullivan

REMARKS:

COMPONENT ANALYSIS

COMPONENT	MOL PERCENT	GPM
Hydrogen Sulfide (H2S)		
Nitrogen (N2)	1.731	
Carbon Dioxide (CO2)	5.628	
Methane (C1)	80.395	
Ethane (C2)	7.442	1.986
Propane (C3)	3.101	0.852
I-Butane (IC4)	0.362	0.118
N-Butane (NC4)	0.705	0.222
I-Pentane (IC5)	0.164	0.060
N-Pentane (NC5)	0.158	0.057
Hexane Plus (C6+)	0.314	0.136
	100.000	3.431

 BTU/CU.FT. - DRY 1084
 AT 14.650 DRY 1081
 AT 14.650 WET 1062
 AT 14.73 DRY 1087
 AT 14.73 WET 1068

MOLECULAR WT. 20.6053

 SPECIFIC GRAVITY -
 CALCULATED 0.711
 MEASURED



Laboratory Services, Inc.

2609 West Marland
Hobbs, New Mexico 88240

Telephone: (575) 397-3713

H

FOR: Devon Energy
P. O. Box 250
Artesia, New Mexico 88211-0250

SAMPLE: Sta. #677-12-068
IDENTIFICATION Coyote 14 Fed. 2 Y
COMPANY: Devon Energy
LEASE:
PLANT:

SAMPLE DATA: DATE SAMPLED: 10/17/08 3:00 pm
ANALYSIS DATE: 10/21/08
PRESSURE – PSIA 34
SAMPLE TEMP. °F 81
ATMOS. TEMP. °F

GAS (XX) LIQUID ()
SAMPLED BY: Jared Pittman/AFM
ANALYSIS BY: Vickie Sullivan

REMARKS: H2S = 0

COMPONENT ANALYSIS

COMPONENT	MOL PERCENT	GPM
Hydrogen Sulfide (H2S)	0.000	
Nitrogen (N2)	0.479	
Carbon Dioxide (CO2)	0.664	
Methane (C1)	85.825	
Ethane (C2)	7.714	2.058
Propane (C3)	3.190	0.877
I-Butane (IC4)	0.407	0.133
N-Butane (NC4)	0.798	0.251
I-Pentane (IC5)	0.236	0.086
N-Pentane (NC5)	0.224	0.081
Hexane Plus (C6+)	0.463	0.201
	100.000	3.687
BTU/CU.FT. – DRY	1163	MOLECULAR WT. 19.3796
AT 14.650 DRY	1160	
AT 14.650 WET	1139	
AT 14.73 DRY	1166	
AT 14.73 WET	1146	
SPECIFIC GRAVITY –		
CALCULATED	0.668	
MEASURED		

PROPERTY DECK	MO/YR	-----PROPERTY NAME-----	DESCRIPTION	INFLATED INTEREST	TYPE	PAY STAT	EX CL	WP CRT	PY CD	RT CD	LAST DATE CHANGED	LEASE INTEREST
23661-010 AA	12/08	COYOTE 14 FED 1	MD(CORR) (EFF1STPROD 11/24/08)D									
	14343	CONSOL	MARBOB ENERGY CORPORATION P O DRAWER 227 ARTESIA NM 88211-0227 85-0232108	.20312500	1-WI	PA					3/11/09	.20312500
	53612	CONSOL	MINERALS MANAGEMENT SERVICE ROYALTY MANAGEMENT PROGRAM PO BOX 5810 DENVER CO 80217-5810 84-0848646	.12500000	2-ROY	GF					3/11/09	.12500000
	326109	CONSOL	PENWELL EMPLOYEE ROYALTY POOL 200 N LORAIN SUITE 1550 MIDLAND TX 79701- 75-2223190	.00150000	3-ORR	PA					3/11/09	.00150000
	338946	CONSOL	JOHN LAWRENCE THOMA A SINGLE MAN P O BOX 863418 PLANO TX 75086- 114-52-8727	.00300000	3-ORR	PA					3/11/09	.00300000
	338947	CONSOL	SANDRA MARY THOMA A SINGLE WOMAN 789 W HELLSGATE DR STRAWN TX 76475- 085-44-5320	.00300000	3-ORR	PA					3/11/09	.00300000
	425973	CONSOL	JAMES E GEITGEY P O BOX 51451 MIDLAND TX 79710-1451 286-68-2705	.00500000	3-ORR	PA					3/11/09	.00500000
	425974	CONSOL	C MARK WHEELER 24 SMITH ROAD, STE 405 MIDLAND TX 79705- 460-04-7167	.00250000	3-ORR	PA					3/11/09	.00250000
	425975	CONSOL	PAUL R BARWIS % DUTTON HARRIS & CO PO BOX 230 MIDLAND TX 79702- 169-46-4748	.00500000	3-ORR	PA					3/11/09	.00500000
	999001	CONSOL	DEVON ENERGY PRODUCTION CO LP 20 NORTH BROADWAY OKLAHOMA CITY OK 73102-8260 73-1577174	.64125000	1-WI	CO					3/11/09	.64125000
	999001	CONSOL	DEVON ENERGY PRODUCTION CO LP 20 NORTH BROADWAY OKLAHOMA CITY OK 73102-8260 73-1577174	.01062500	3-ORR	PA					3/11/09	.01062500
TOTAL:				INFT. INT: 1.00000000	RECV. INT: 1.00000000				LSE. INT: 1.00000000			

PROPERTY DECK MO/YR	OWNER SQ	BURDEN	PROPERTY NAME	DESCRIPTION	INFLATED INTEREST	TYPE	PAY STAT	EX CL	WP CRT	PY CD	RT CD	LAST DATE CHANGED	LEASE INTEREST
23661-021 AA	05/07	COYOTE 14	FED 2Y	MD W/BURDENS(1STPRD 5-5-07)DAL									
	14343	1	CONSOL	MARBOB ENERGY CORPORATION P O DRAWER 227 ARTESIA NM 88211-0227 85-0232108	.20312500	1-WI	PA					11/07/07	.20312500
	53612	1	CONSOL	MINERALS MANAGEMENT SERVICE ROYALTY MANAGEMENT PROGRAM PO BOX 5810 DENVER CO 80217-5810 84-0848646	.12500000	2-ROY	GF					11/07/07	.12500000
	326109		CONSOL	PENWELL EMPLOYEE ROYALTY POOL 200 N LORAIN SUITE 1550 MIDLAND TX 79701- 75-2223190	.00150000	3-ORR	PA					11/07/07	.00150000
	338946	1	CONSOL	JOHN LAWRENCE THOMA A SINGLE MAN P O BOX 863418 PLANO TX 75086- 114-52-8727	.00300000	3-ORR	PA					2/16/09	.00300000
	338947	1	CONSOL	SANDRA MARY THOMA A SINGLE WOMAN 789 W HELLSGATE DR STRAWN TX 76475- 085-44-5320	.00300000	3-ORR	PA					2/16/09	.00300000
	425973	1	CONSOL	JAMES E GEITGEY P O BOX 51451 MIDLAND TX 79710-1451 286-68-2705	.00500000	3-ORR	PA					2/16/09	.00500000
	425974	1	CONSOL	C MARK WHEELER 24 SMITH ROAD, STE 405 MIDLAND TX 79705- 460-04-7167	.00250000	3-ORR	PA					2/16/09	.00250000
	425975	1	CONSOL	PAUL R BARWIS % DUTTON HARRIS & CO PO BOX 230 MIDLAND TX 79702- 169-46-4748	.00500000	3-ORR	PA					2/16/09	.00500000
	999001	1	CONSOL	DEVON ENERGY PRODUCTION CO LP 20 NORTH BROADWAY OKLAHOMA CITY OK 73102-8260 73-1577174	.64125000	1-WI	CO					2/16/09	.64125000
	999001	1	CONSOL	DEVON ENERGY PRODUCTION CO LP 20 NORTH BROADWAY OKLAHOMA CITY OK 73102-8260 73-1577174	.01062500	3-ORR	CO					2/16/09	.01062500
TOTAL:					INFT. INT: 1.00000000	RECV. INT: 1.00000000					LSE. INT: 1.00000000		

PROPERTY DECK	MO/YR	OWNER SQ	BURDEN	PROPERTY NAME	DESCRIPTION	INFLATED INTEREST	PAY TYPE	EX CL	WP CRT	PY CD	RT CD	LAST DATE CHANGED	LEASE INTEREST
23663-010	AA	07/07	ACME 10	FED COM 1	BPO(EFF1STPRD 12.5% <3MMCF) DAL								
14343	1	CONSOL	MARBOB ENERGY CORPORATION P O DRAWER 227 ARTESIA NM 88211-0227 85-0232108		.17617186	1-WI	PA					5/14/08	.17617186
14343		CONSOL	MARBOB ENERGY CORPORATION P O DRAWER 227 ARTESIA NM 88211-0227 85-0232108		.00155555	3-ORR	PA					5/14/08	.00155555
53612		CONSOL	MINERALS MANAGEMENT SERVICE ROYALTY MANAGEMENT PROGRAM PO BOX 5810 DENVER CO 80217-5810 84-0848646		.12500000	2-ROY	GF					3/24/09	.12500000
122638	1	CONSOL	NEARBURG EXPLORATION CO LLC NEARBURG PRODUCING COMPANY P O BOX 678100 DALLAS TX 75267-8100 75-2626152		.01406250	3-ORR	ST					9/01/09	.01406250
304023	1	CONSOL	COG OIL & GAS LP TEXAS LIMITED PARTNERSHIP P O BOX 849929 DALLAS TX 75284-9929 14-1913261		.16000000	1-WI	PA					9/01/09	.16000000
322275		CONSOL	BADGER ENERGY INC P O BOX 1708 HOEBBS NM 88241- 85-0483481		.02852259	1-WI	PA					9/01/09	.02852259
326109		CONSOL	PENWELL EMPLOYEE ROYALTY POOL 200 N LORAIN SUITE 1550 MIDLAND TX 79701- 75-2223190		.00018750	3-ORR	ST					9/04/09	.00018750
332371		CONSOL	MCCOMBS ENERGY LTD A TEXAS LIMITED PARTNERSHIP MCCOMBS ENERGY GP LLC GEN PTNR RICKY HAIKIN VICE PRESIDENT 5599 SAN FELIPE STE 1200 HOUSTON TX 77056- 74-2861751		.19750000	1-WI	PA					9/04/09	.19750000
346397		CONSOL	HEIRS & DEVISEES OF ALVIN HILL		.02500000	3-ORR	ST					9/04/09	.02500000
356716		CONSOL	JOHN L THOMA P O BOX 863418 PLANO TX 75086- 114-52-8727		.00075000	3-ORR	ST					9/04/09	.00075000

3300 North "A" St, Bldg. 2, Ste 120
Midland, TX 79705

Fasken Center, Tower II
550 W Texas Ave, Ste. 1300
Midland, TX 79701

**Bureau of Land Management
Carlsbad Field Office
620 East Greene Street
Carlsbad, New Mexico 88220
575-234-5972**

Off-Lease Measurement, Sales and Surface Commingling

Conditions of Approval

Approval of surface commingling and off-lease sales and/or measurement is subject to the following conditions of approval:

1. This agency shall be notified of any change in sales method or location of sales point.
2. This agency shall be notified of any spill or discharge as required by NTL-3A.
3. This agency reserves the right to modify or rescind approval whenever it determines continued use of the approved method may adversely affect the surface or subsurface environments.
4. This approval is subject to like approval by the New Mexico Oil Conservation Division.
5. Additional wells and/or leases require additional commingling approvals.
6. This approval does not constitute right-of-way approval for any off-lease activities. Within 30 days, an application for right-of-way approval must be submitted to the Realty Section if not already done.
7. Approval for combining production from various sources is a privilege which is granted to lessees for the purpose of aiding conservation and extending the economic life of leases. Applicants should be cognizant that failure to operate in accordance with the provisions outlined in the Authorized Officer's conditions of approval and/or subsequent stipulations or modifications will subject such approval to revocation.
8. All above-ground structures not subject to safety requirements shall be painted by the holder to blend with the natural color of the landscape. The paint used shall be color which simulates "standard Environmental Colors" – Shale Green, Munsell Soil Color No. 5Y 4/2.