

UNITED STATES **OCD-ARTESIA**
DEPARTMENT OF THE INTERIOR
BUREAU OF LAND MANAGEMENT

FORM APPROVED
OMB No. 1004-0037
Expires: March 31, 2007

RECEIVED

JAN 21 2010

SUNDRY NOTICES AND REPORTS ON WELLS

Do not use this form for proposals to drill or to re-enter an abandoned well. Use Form 3160-3 (APD) for such proposals.

SUBMIT IN TRIPLICATE- Other instructions on reverse side.

1 Type of Well
☒ Oil Well ☐ Gas Well ☐ Other

2 Name of Operator
COG Operating LLC

3a Address
550 W. Texas Ave., Suite 1300 Midland, TX 79701

3b Phone No. (include area code)
432-685-4385

4 Location of Well (Footage, Sec, T., R., M., or Survey Description)
990' FNL & 330' FEL, SEC. 22, T17S, R31E, Unit A

5. Lease Serial No.

NMLC-029419A

6. If Indian, Allottee or Tribal Name

N/A

7 If Unit or CA/Agreement, Name and/or No

NMNM-71030C

8. Well Name and No.

SKELLY UNIT #982

9. API Well No.

30-015-36515

10. Field and Pool, or Exploratory Area

FREN; GLORIETA-YESO 26770

11 County or Parish, State

EDDY, NM

12. CHECK APPROPRIATE BOX(ES) TO INDICATE NATURE OF NOTICE, REPORT, OR OTHER DATA

TYPE OF SUBMISSION	TYPE OF ACTION			
<input checked="" type="checkbox"/> Notice of Intent	<input type="checkbox"/> Acidize	<input type="checkbox"/> Deepen	<input type="checkbox"/> Production (Start/Resume)	<input type="checkbox"/> Water Shut-Off
<input type="checkbox"/> Subsequent Report	<input type="checkbox"/> Alter Casing	<input type="checkbox"/> Fracture Treat	<input type="checkbox"/> Reclamation	<input type="checkbox"/> Well Integrity
<input type="checkbox"/> Final Abandonment Notice	<input type="checkbox"/> Casing Repair	<input type="checkbox"/> New Construction	<input type="checkbox"/> Recomplete	<input checked="" type="checkbox"/> Other
	<input type="checkbox"/> Change Plans	<input type="checkbox"/> Plug and Abandon	<input type="checkbox"/> Temporarily Abandon	MOVE
	<input type="checkbox"/> Convert to Injection	<input type="checkbox"/> Plug Back	<input type="checkbox"/> Water Disposal	LOCATION

13 Describe Proposed or Completed Operation (clearly state all pertinent details, including estimated starting date of any proposed work and approximate duration thereof. If the proposal is to deepen directionally or recompleat horizontally, give subsurface locations and measured and true vertical depths of all pertinent markers and zones. Attach the Bond under which the work will be performed or provide the Bond No. on file with BLM/BIA. Required subsequent reports shall be filed within 30 days following completion of the involved operations. If the operation results in a multiple completion or recompleat in a new interval, a Form 3160-4 shall be filed once testing has been completed. Final Abandonment Notices shall be filed only after all requirements, including reclamation, have been completed, and the operator has determined that the site is ready for final inspection.)

The present location for this well is:

990' FNL & 330' FEL, SEC. 22, T17S, R31E, Unit A

COG respectfully requests permission to move this location to:

875' FNL & 510' FEL, SEC. 22, T17S, R31E, Unit A

This move is requested because the original location is due to a buried pipeline.

An original C-102 is attached for your review.

14 I hereby certify that the foregoing is true and correct
Name (Printed/Typed)

Robyn M. Odom

Title **Regulatory Analyst**

Signature

Robyn M. Odom

Date

12/29/2009

THIS SPACE FOR FEDERAL OR STATE OFFICE USE

Approved by

Owen Lofton

Title

Date

JAN 15 2010

Conditions of approval, if any, are attached. Approval of this notice does not warrant or certify that the applicant holds legal or equitable title to those rights in the subject lease which would entitle the applicant to conduct operations thereon.

Office

CARLSBAD FIELD OFFICE

Title 18 U.S.C. Section 1001 and Title 43 U.S.C Section 1212, make it a crime for any person knowingly and willfully to make to any department or agency of the United States any false, fictitious or fraudulent statements or representations as to any matter within its jurisdiction.

(Instructions on page 2)

M2

DISTRICT I
1625 N. FRENCH DR., HOBBS, NM 88240

State of New Mexico
Energy, Minerals and Natural Resources Department

Form C-102

DISTRICT II
1301 W. GRAND AVENUE, ARTESIA, NM 88210

OIL CONSERVATION DIVISION

Revised October 12, 2005
Submit to Appropriate District Office
State Lease - 4 Copies
Fee Lease - 3 Copies

DISTRICT III
1000 RIO BRAZOS RD., AZTEC, NM 87410

11885 SOUTH ST. FRANCIS DR.
Santa Fe, New Mexico 87505

DISTRICT IV
11885 S. ST. FRANCIS DR., SANTA FE, NM 87505

WELL LOCATION AND ACREAGE DEDICATION PLAT

☐ AMENDED REPORT

API Number 30-015-36515	Pool Code 26770	Pool Name FREN; GLORIETA-YESO
Property Code 305607	Property Name SKELLY UNIT	Well Number 982
OGRID No. 229137	Operator Name COG OPERATING, LLC	Elevation 3870'

Surface Location

UL or lot No. A	Section 22	Township 17-S	Range 31-E	Lot Idn	Feet from the 875	North/South line NORTH	Feet from the 510	East/West line EAST	County EDDY
--------------------	---------------	------------------	---------------	---------	----------------------	---------------------------	----------------------	------------------------	----------------

Bottom Hole Location If Different From Surface

UL or lot No.	Section	Township	Range	Lot Idn	Feet from the	North/South line	Feet from the	East/West line	County
Dedicated Acres 40	Joint or Infill	Consolidation Code	Order No.						

NO ALLOWABLE WILL BE ASSIGNED TO THIS COMPLETION UNTIL ALL INTERESTS HAVE BEEN CONSOLIDATED
OR A NON-STANDARD UNIT HAS BEEN APPROVED BY THE DIVISION

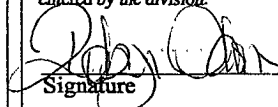
<p>GEODETIC COORDINATES NAD 27 NME Y=664129.2 N X=648467.1 E LAT.=32.824845° N LONG.=103.850025° W</p>	<p>SEE DETAIL</p> <p>DETAIL</p> <p>3870.4' 3874.5' 600' 3865.3' 3867.5'</p>	<p>OPERATOR CERTIFICATION</p> <p>I hereby certify that the information herein is true and complete to the best of my knowledge and belief, and that this organization either owns a working interest or unleased mineral interest in the land including the proposed bottom hole location or has a right to drill this well at this location pursuant to a contract with an owner of such mineral or working interest, or to a voluntary pooling agreement or a compulsory pooling order heretofore entered by the division.</p> <p> 12/29/2009 Signature Date Robyn Odom Printed Name</p> <p>SURVEYOR CERTIFICATION</p> <p>I hereby certify that the well location shown on this plat was plotted from field notes of actual surveys made by me or under my supervision, and that the same is true and correct to the best of my belief.</p> <p>DECEMBER 23 2009 Date Surveyed Signature & Seal of Professional Surveyor 3239 09-11-1327 Certificate No. GARY EIDSON 12641 RONALD EIDSON 3239</p>
--	---	---

SECTION 22, TOWNSHIP 17 SOUTH, RANGE 31 EAST, N.M.P.M.,
EDDY COUNTY, NEW MEXICO

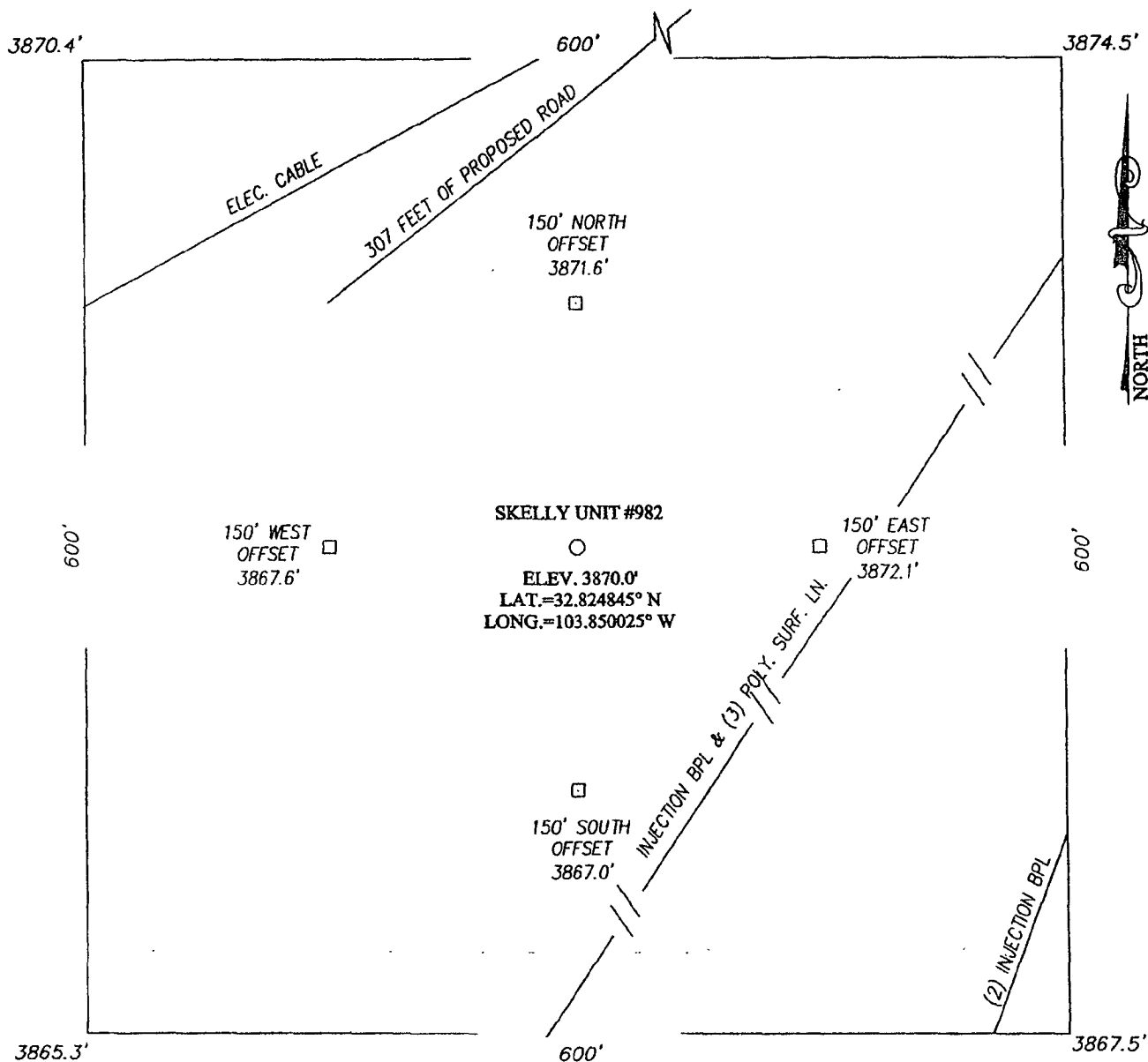

DIRECTIONS TO LOCATION

FROM THE INTERSECTION OF U.S. HWY. #82 CO. RD. #223 (SWEET GUM RD.) GO NORTHEAST ON U.S. HWY. #82 APPROX. 1.4 MILES. TURN LEFT AND GO NORTHWEST APPROX. 0.5 MILES TO CHEVRON SKELLY UNIT #947 WELL. FOLLOW PROPOSED ROAD SURVEY SOUTHWEST APPROX. 307 FEET FROM CHEVRON SKELLY UNIT #947 WELL TO THIS LOCATION.

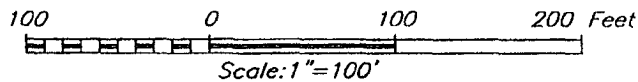

COG OPERATING, LLC

SKELLY UNIT #982 WELL
LOCATED 875 FEET FROM THE NORTH LINE
AND 510 FEET FROM THE EAST LINE OF SECTION 22,
TOWNSHIP 17 SOUTH, RANGE 31 EAST, N.M.P.M.,
EDDY COUNTY, NEW MEXICO.

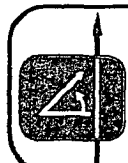

PROVIDING SURVEYING SERVICES
SINCE 1946
JOHN WEST SURVEYING COMPANY
412 N. DAL PASO
HOBBS, N.M. 88240
(575) 393-3117

Survey Date: 12/22/09	Sheet 1 of 1 Sheets
W.O. Number: 09.11.1327	Dr By: DSS
Date: 12/23/09	09111327
	Scale: 1"=100'

VICINITY MAP

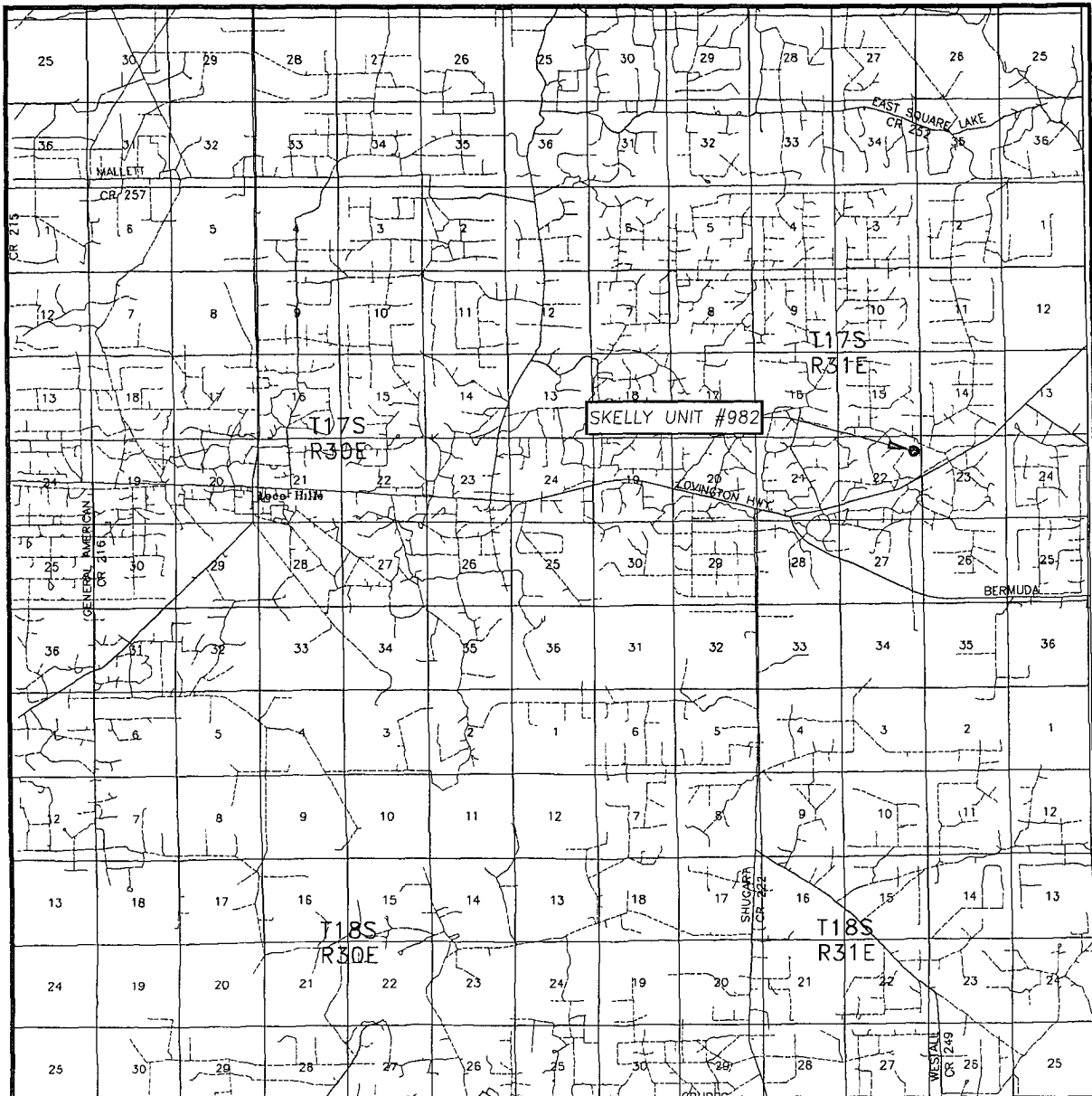

SCALE: 1" = 2 MILES

SEC. 22 TWP. 17-S RGE. 31-E
 SURVEY _____ N.M.P.M. _____
 COUNTY EDDY STATE NEW MEXICO
 DESCRIPTION 990' FNL & 330' FEL
 ELEVATION 3868'
 COG
 OPERATOR OPERATING, LLC
 LEASE SKELLY UNIT

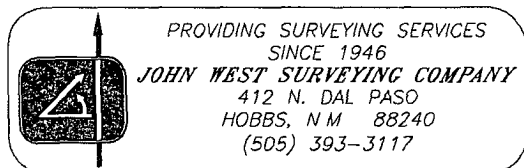

LOCATION VERIFICATION MAP

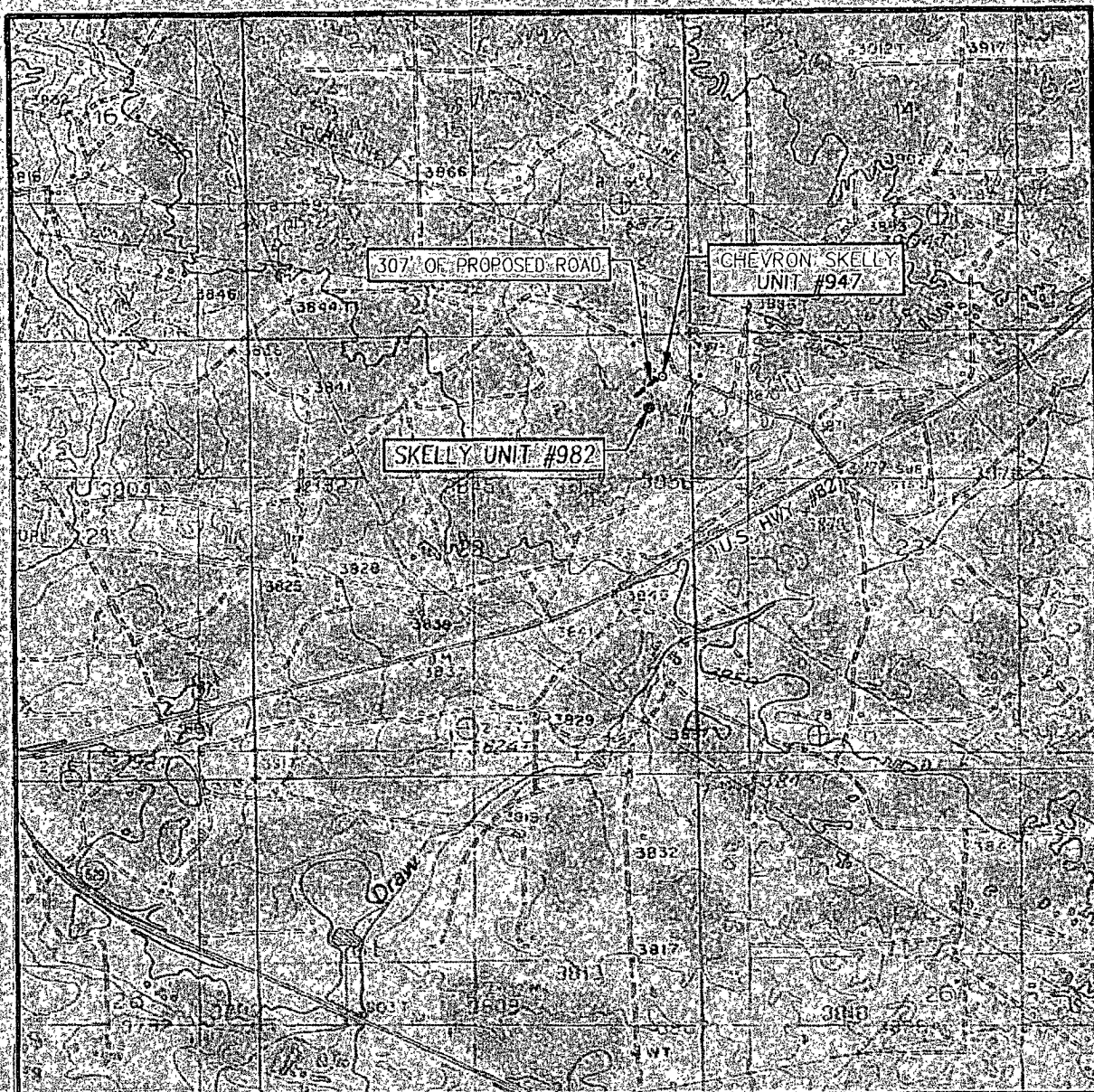

SCALE: 1" = 2000'

CONTOUR INTERVAL
MALJAMAR, N.M. = 10'

SEC. 22 TWP. 17-S RGE. 31-E

SURVEY N.M.P.M.

COUNTY: EDDY STATE: NEW MEXICO

DESCRIPTION: 875' ENL. & 510' FEL

ELEVATION: 3870'

OPERATOR: COG OPERATING, LLC

LEASE: SKELLY UNIT

U.S.G.S. TOPOGRAPHIC MAP
MALJAMAR, N.M.

