

7020

Oil Cons
UNITED STATES N.M. DIV-DIST 2
DEPARTMENT OF THE INTERIOR Grand Avenue
BUREAU OF LAND MANAGEMENT Artesia, NM 88210 328

SUBMIT IN TRIPLICATE
Other instructions on
reverse side)FORM APPROVED
OMB NO. 1004-0136
Expires: February 28, 1995

APPLICATION FOR PERMIT TO DRILL OR DEEPEN

1a. TYPE OF WORK

DRILL ☒DEEPEN ☐

b. TYPE OF WELL

OIL
WELL ☐GAS
WELL ☒

OTHER

SINGLE
ZONE ☒MULTIPLE
ZONE ☐

2. NAME OF OPERATOR

Mewbourne Oil Company

3. ADDRESS AND TELEPHONE NO.

P.O. Box 5270, Hobbs, NM 88241 (505)393-5905

4. LOCATION OF WELL (Report location clearly and in accordance with any State requirements.)

At surface 1450' FNL & 660' FWL

At proposed prod. zone

14. DISTANCE IN MILES AND DIRECTION FROM NEAREST TOWN OR POST OFFICE*

4 Mile NE of Carlsbad

15. DISTANCE FROM PROPOSED*
LOCATION TO NEAREST
PROPERTY OR LEASE LINE, FT.
(Also to nearest drig. unit line, if any)

660'

16. NO. OF ACRES IN LEASE

320

17. NO. OF ACRES ASSIGNED
TO THIS WELL

320

18. DISTANCE FROM PROPOSED LOCATION*
TO NEAREST WELL, DRILLING, COMPLETED,
OR APPLIED FOR, ON THIS LEASE, FT.

2660

19. PROPOSED DEPTH

11900

20. ROTARY OR CABLE TOOLS

Rotary

21. ELEVATIONS (Show whether DF, RT, GR, etc.)

3255

Carlsbad Controlled Water Basin

22. APPROX. DATE WORK WILL START*

02/28/03

23.

PROPOSED CASING AND CEMENTING PROGRAM

SIZE OF HOLE	GRADE, SIZE OF CASING	WEIGHT PER FOOT	SETTING DEPTH	QUANTITY OF CEMENT
17-1/2"	H40, 13-3/8"	48#	400'	400 sacks, Circulate to Surface
12-1/4"	J-55, 8-5/8"	32#	2600'	800 sacks Circulate to Surface
7-7/8"	N80, 5-1/2"	17#	11,900'	600 sacks

Mewbourne Oil Company proposes to drill this well to a depth sufficient to test the Morrow Formation for the presence of hydrocarbons. If determined to be productive, the well will be equipped with 5-1/2" production casing to total depth. If determined to be nonproductive, the well will be plugged and abandoned in accordance with regulatory guidelines. Specific plans are outlined in the following attachments.

- 1) Location and Elevation Plat (NMOCD Form C102)
- 2) Drilling Program
- 3) Surface Use and Operation Plan
- 4) Schematic Diagram of Blowout Preventer and Choke Manifold (Exhibits 2 & 2A)
- 5) Map of existing and Planned Access Road and Location (Exhibits 3 & 3A)
- 6) List of Offset Wells
- 7) Proposed Drilling Rig Layout (Exhibit 5)
- 8) Proposed Production Facilities Layout (Exhibit 6)
- 9) Hydrogen Sulfide Contingency Plan (Exhibit 7)

**APPROVAL SUBJECT TO
GENERAL REQUIREMENTS AND
SPECIAL STIPULATIONS
ATTACHED**

IN ABOVE SPACE DESCRIBE PROGRAM: If proposal is to deepen, give data on present productive zone and proposed new productive zone. If proposal is to drill or deepen directionally, give pertinent data on subsurface locations and measured and true vertical depths. Give blowout preventer program, if any.

24.

SIGNED

TITLE Drilling Foreman

DATE 01/28/03

(This space for Federal or State office use)

PERMIT NO.

APPROVAL DATE

Application approval does not warrant or certify that the applicant holds legal or equitable title to those rights in the subject lease which would entitle the applicant to conduct operations thereon.
CONDITIONS OF APPROVAL, IF ANY:

FOR

APPROVED BY /s/ Mary J. Rugwell

TITLE

FIELD MANAGER

DATE

MAR 04 2003

*See Instructions On Reverse Side

APPROVAL FOR 1 YEAR

Title 18 U.S.C. Section 1001, makes it a crime for any person knowingly and willfully to make to any department or agency of the United States any false, fictitious or fraudulent statements or representations as to any matter within its jurisdiction.

DISTRICT II
811 South First, Artesia, NM 88210

DISTRICT III
1000 Rio Brazos Rd., Aztec, NM 87410

DISTRICT IV
2040 South Pacheco, Santa Fe, NM 87505

OIL CONSERVATION DIVISION
P.O. Box 2088
Santa Fe, New Mexico 87504-2088

☐ AMENDED REPORT

WELL LOCATION AND ACREAGE DEDICATION PLAT

API Number	Pool Code	Pool Name
		Burton Flat Morrow
Property Code	Property Name	Well Number
	ESPERANZA "11" FEDERAL COM.	3
OGRID No.	Operator Name	Elevation
14744	MEWBOURNE OIL COMPANY	3255

Surface Location

UL or lot No.	Section	Township	Range	Lot Idn	Feet from the	North/South line	Feet from the	East/West line	County
E	11	21S	27E		1450	NORTH	660	WEST	EDDY

Bottom Hole Location If Different From Surface

UL or lot No.	Section	Township	Range	Lot Idn	Feet from the	North/South line	Feet from the	East/West line	County
Dedicated Acres	Joint or Infill	Consolidation Code	Order No.						
320									

NO ALLOWABLE WILL BE ASSIGNED TO THIS COMPLETION UNTIL ALL INTERESTS HAVE BEEN CONSOLIDATED
OR A NON-STANDARD UNIT HAS BEEN APPROVED BY THE DIVISION

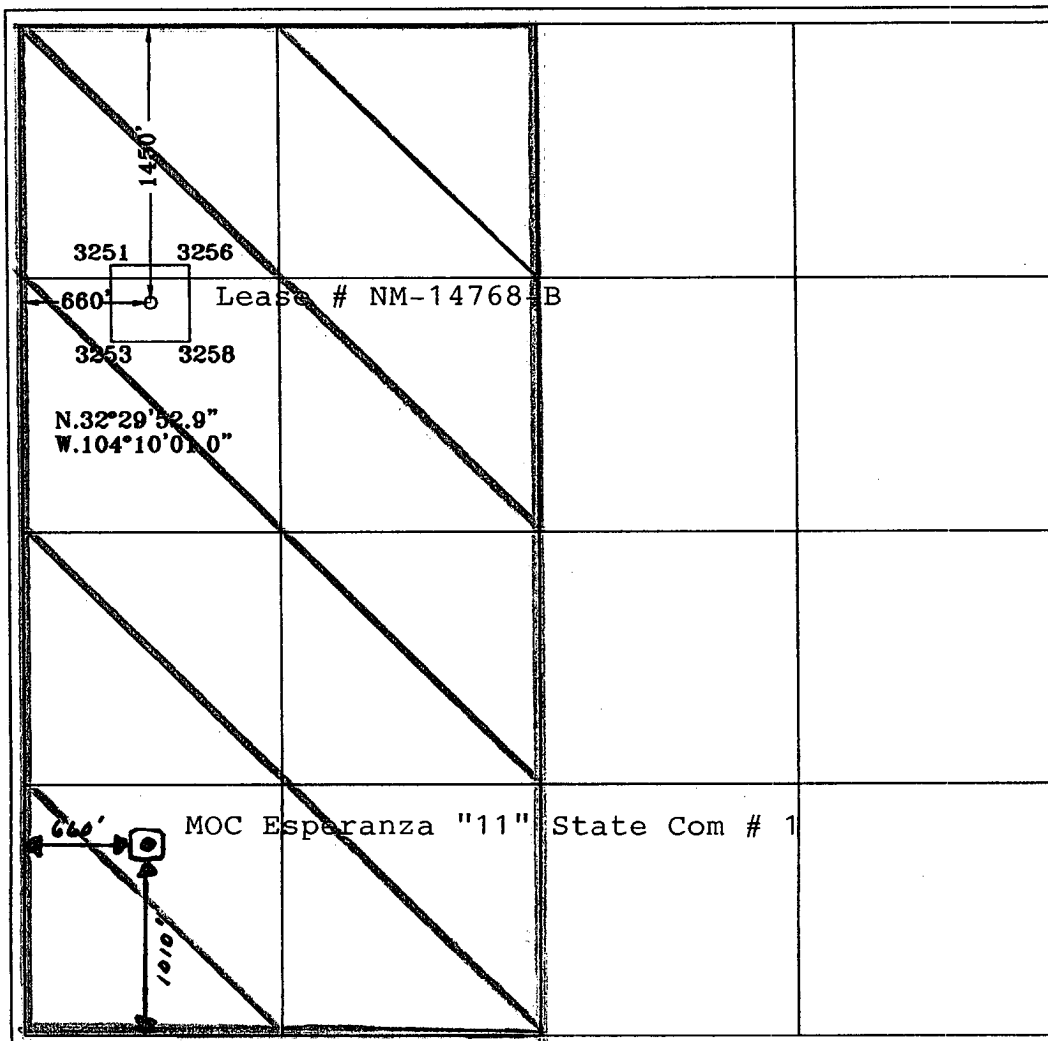
	<p>OPERATOR CERTIFICATION</p> <p>I hereby certify the the information contained herein is true and complete to the best of my knowledge and belief.</p> <p><i>Terry Burke</i> Signature Terry Burke Printed Name Drlg Foreman Title January 28, 2003 Date</p> <p>SURVEYOR CERTIFICATION</p> <p>I hereby certify that the well location shown on this plat was plotted from field notes of actual surveys made by me or under my supervision, and that the same is true and correct to the best of my belief.</p> <p>10/31/2002 Date Surveyed Signature & Seal of Professional Surveyor <i>Herschel L. Jones</i> Herschel L. Jones Professional Surveyor New Mexico 3640 Certificate No. Herschel L. Jones RLS 3640 ESPERANZA 11 GENERAL SURVEYING COMPANY</p>
--	---

Mewbourne Oil Company
BOP Schematic for
12 1/4" Hole

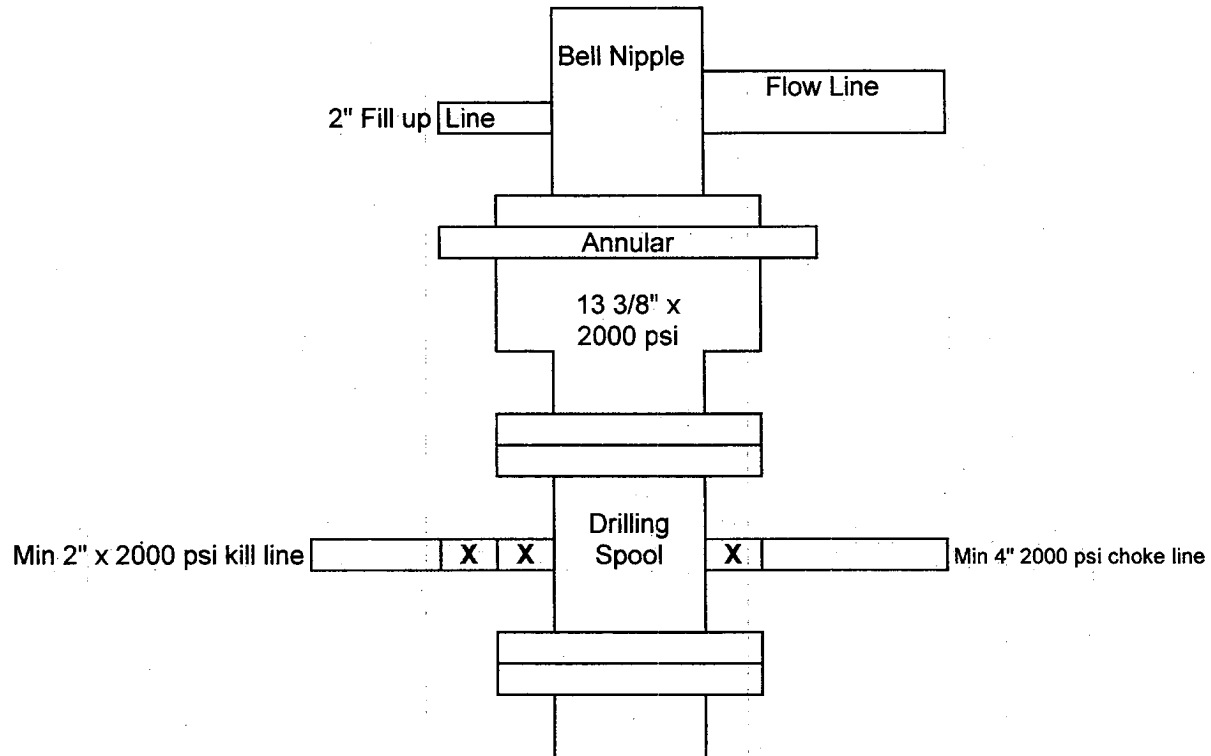

Exhibit #2

Esperanza "11" Federal Com # 3
1450' FNL & 660' FWL
Sec.11-21S; R27E
Eddy County, New Mexico

Mewbourne Oil Company

BOP Scematic for
8 3/4" or 7 7/8" Hole

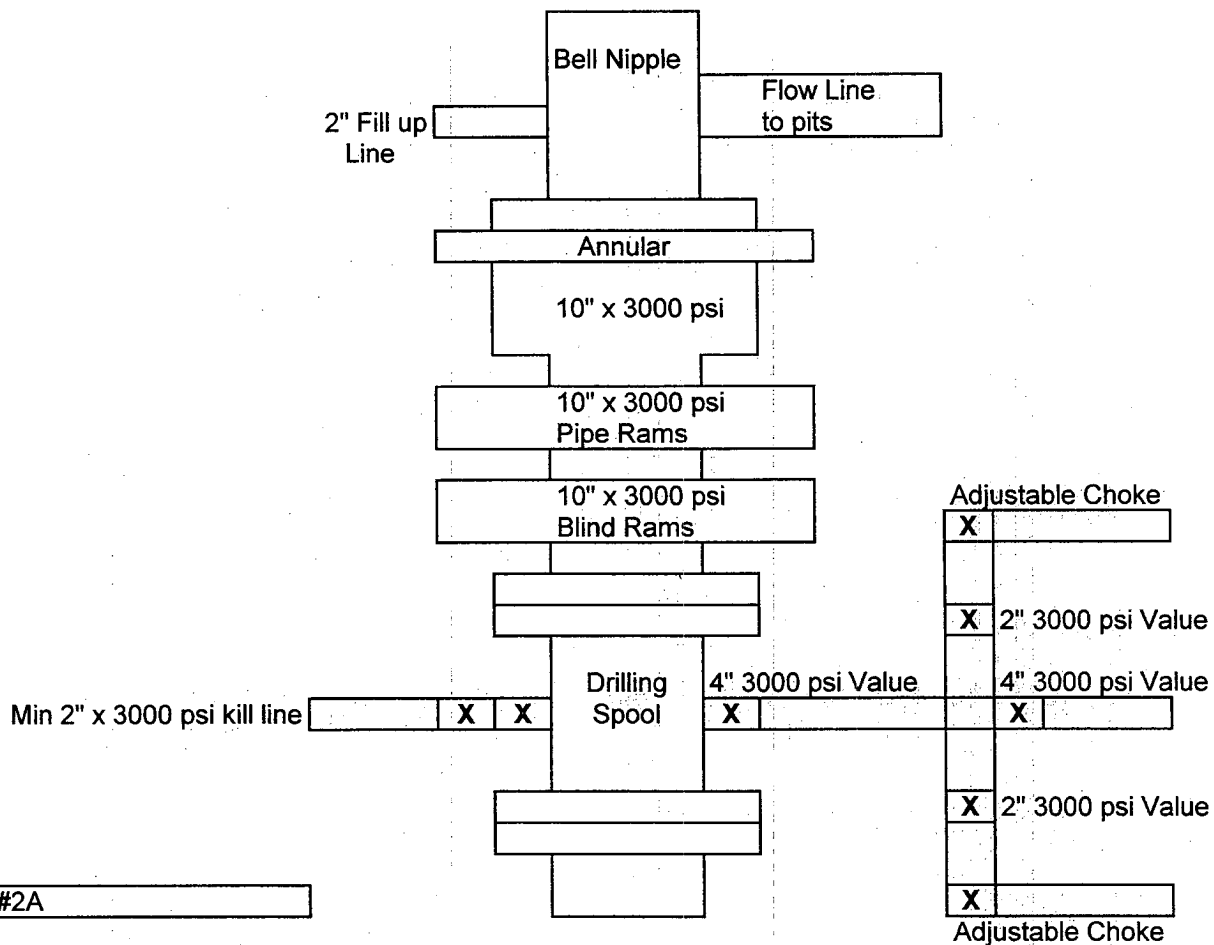

Exhibit #2A

Esperanza "11" Federal Com # 3
1450' FNL & 660' FWL
Sec.11; T21S; R27E
Eddy County, New Mexico